

City of Las Vegas
Office Of The City Clerk
400 Stewart Avenue
Las Vegas, Nevada 89101

RECEIVED
CITY CLERK

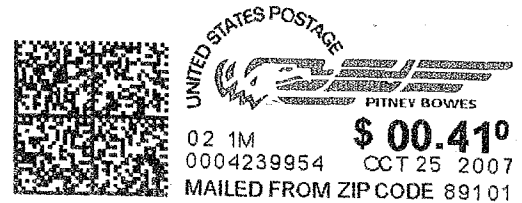

Return Service Requested

Official Notice of Public Hearing

2007 OCT 31 A 10:39

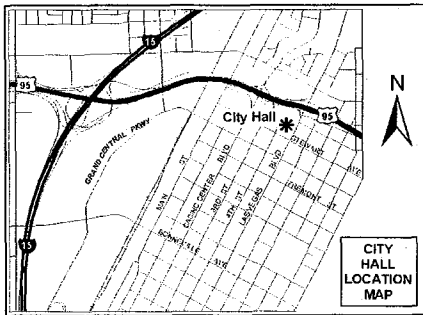

If you wish to file your protest or support on this request, check the appropriate box below and return this card in an envelope with postage to the Office Of The City Clerk at the address listed above or fax this side of this card to (702) 382-4803. If you would like to contact your Council Representative, please call (702) 229-6405.

I SUPPORT
this Request

I OPPOSE
this Request

Please use available blank space on card for your comments.
VAR-24260

PAQUETTE PAUL E & KAREN
1641 CHARLES LAM CT
LAS VEGAS NV 89117-1441

Submitted after final agenda

3 Item

8511731441 0063

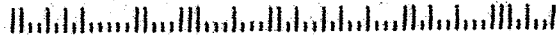

Submission date

Date 10-31-07 Item 150

City of Las Vegas
Office Of The City Clerk
400 Stewart Avenue
Las Vegas, Nevada 89101

Return Service Requested Official Notice of Public Hearing

RECEIVED
CITY CLERK

2007 NOV -2 A 11: 02



UNITED STATES POSTAGE
PITNEY BOWES
02 1M \$ 00.41⁰
0004239954 OCT 25 2007
MAILED FROM ZIP CODE 89101

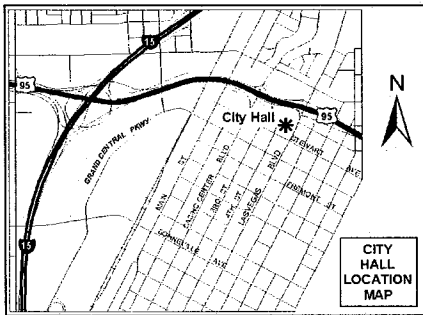

If you wish to file your protest or support on this request, check the appropriate box below and return this card in an envelope with postage to the Office Of The City Clerk at the address listed above or fax this side of this card to (702) 382-4803. If you would like to contact your Council Representative, please call (702) 229-6405



I SUPPORT
this Request



I OPPOSE
this Request

Please use available blank space on card for your comments.

VAR-24260

VALLONE JOHN P
1896 CO HYW NN
WEST BEND WI 53095-9712

530959712 R001



Stamp/Postmark

Date 11-02-07 from 150

RECEIVED
CITY CLERK

2007 NOV -2 A 7 44

City of Las Vegas
Office Of The City Clerk
400 Stewart Avenue
Las Vegas, Nevada 89101

Return Service Requested Official Notice of Public Hearing

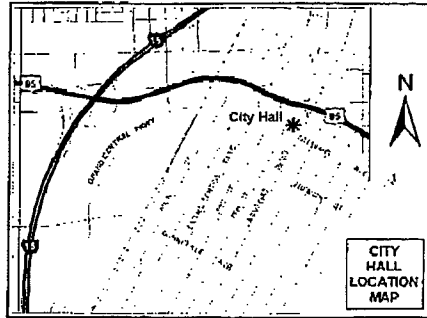

If you wish to file your protest or support on this request, check the appropriate box below and return this card in an envelope with postage to the Office Of The City Clerk at the address listed above or fax this side of this card to (702) 382-4803. If you would like to contact your Council Representative, please call (702) 229-6405



I SUPPORT
this Request



I OPPOSE
this Request

Please use available blank space on card for your comments.

VAR-24260

M. D. A.
THE NEIGHBORHOOD ALLIANCE
8911781948 0052

GREEN TRUST
GREEN HILLIARD W & MARY O TRS
1870 BLACKWATER CT
LAS VEGAS NV 89117-1948



11/02/2007 FRI 07:43 LTX/RX NO 65141 001

Salvatore & Antoinette Castrogiovanni
1721 Charles Lam Ct.
Las Vegas, NV. 89117

RECEIVED
OCT 22 2007

October 20, 2007

To: My Neighbors

As you know I have requested a variance from The City Of Las Vegas and that took place On October 11 2007 and they have denied variance.

We now have reduced home to meet code on rear yard set back and side set back.

We still need a variance for a front yard set back of 20 feet, rather than 30 feet.

You are reviewing my plans as I am coming to you one by one and I need you to please sign your name that you approve of it.

Sincerely,

Salvatore Castrogiovanni

Names of my neighbors on Charles Lam Ct.-----Approve of it

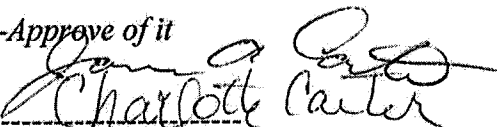
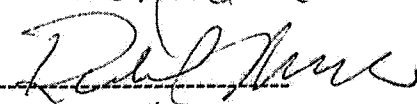
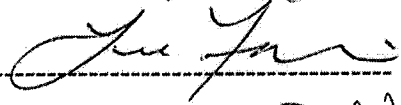
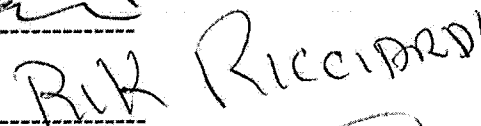
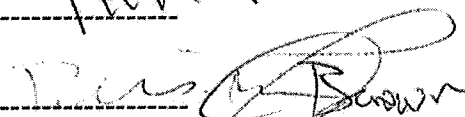
1701 ❖ JEROME & CHARLOTTE CARTER 
1621 ❖ Richard MARINO 
1700 ❖ Lee Fair 
1720 ❖ RIK Riccardi 
1620 ❖ Fred + Pamela Brown 

11-07-07 150

❖ Paul & Piquette (1641)

❖ Subota Corp 1721

❖ _____

❖ _____

VAR-24260 11-07-07 CC

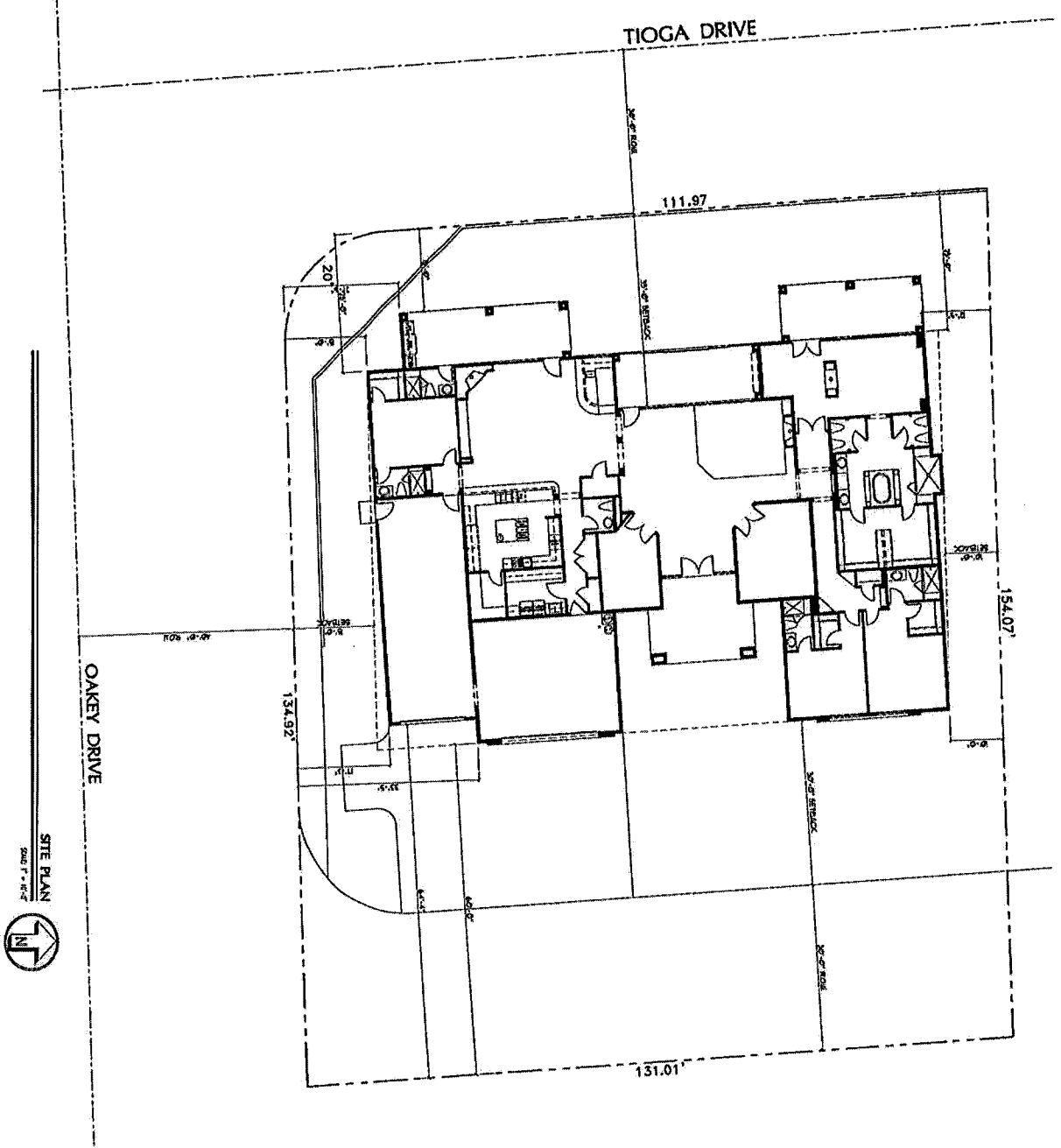

SITE PLAN
Scale 1/8" = 1'-0"

SHEET INDEX

A-1	ARCHITECTURAL
A-2	FOUNDATION PLAN
A-3	ROOF PLAN
A-4	MECHANICAL PLAN
A-5	ELECTRICAL PLAN
A-6	EXTERIOR ELEVATIONS
A-7	INTERIOR ELEVATIONS
A-8	SECTION
A-9	DETAILS
A-10	CONSTRUCTION NOTES
A-11	STRUCTURAL NOTES
A-12	FOUNDATION PLAN
A-13	ROOF PLAN
A-14	MECHANICAL PLAN
A-15	ELECTRICAL PLAN
A-16	EXTERIOR ELEVATIONS
A-17	INTERIOR ELEVATIONS
A-18	SECTION
A-19	DETAILS
A-20	CONSTRUCTION NOTES
A-21	STRUCTURAL NOTES
A-22	FOUNDATION PLAN
A-23	ROOF PLAN
A-24	MECHANICAL PLAN
A-25	ELECTRICAL PLAN
A-26	EXTERIOR ELEVATIONS
A-27	INTERIOR ELEVATIONS
A-28	SECTION
A-29	DETAILS
A-30	CONSTRUCTION NOTES
A-31	STRUCTURAL NOTES
A-32	FOUNDATION PLAN
A-33	ROOF PLAN
A-34	MECHANICAL PLAN
A-35	ELECTRICAL PLAN
A-36	EXTERIOR ELEVATIONS
A-37	INTERIOR ELEVATIONS
A-38	SECTION
A-39	DETAILS
A-40	CONSTRUCTION NOTES
A-41	STRUCTURAL NOTES
A-42	FOUNDATION PLAN
A-43	ROOF PLAN
A-44	MECHANICAL PLAN
A-45	ELECTRICAL PLAN
A-46	EXTERIOR ELEVATIONS
A-47	INTERIOR ELEVATIONS
A-48	SECTION
A-49	DETAILS
A-50	CONSTRUCTION NOTES
A-51	STRUCTURAL NOTES
A-52	FOUNDATION PLAN
A-53	ROOF PLAN
A-54	MECHANICAL PLAN
A-55	ELECTRICAL PLAN
A-56	EXTERIOR ELEVATIONS
A-57	INTERIOR ELEVATIONS
A-58	SECTION
A-59	DETAILS
A-60	CONSTRUCTION NOTES
A-61	STRUCTURAL NOTES
A-62	FOUNDATION PLAN
A-63	ROOF PLAN
A-64	MECHANICAL PLAN
A-65	ELECTRICAL PLAN
A-66	EXTERIOR ELEVATIONS
A-67	INTERIOR ELEVATIONS
A-68	SECTION
A-69	DETAILS
A-70	CONSTRUCTION NOTES
A-71	STRUCTURAL NOTES
A-72	FOUNDATION PLAN
A-73	ROOF PLAN
A-74	MECHANICAL PLAN
A-75	ELECTRICAL PLAN
A-76	EXTERIOR ELEVATIONS
A-77	INTERIOR ELEVATIONS
A-78	SECTION
A-79	DETAILS
A-80	CONSTRUCTION NOTES
A-81	STRUCTURAL NOTES
A-82	FOUNDATION PLAN
A-83	ROOF PLAN
A-84	MECHANICAL PLAN
A-85	ELECTRICAL PLAN
A-86	EXTERIOR ELEVATIONS
A-87	INTERIOR ELEVATIONS
A-88	SECTION
A-89	DETAILS
A-90	CONSTRUCTION NOTES
A-91	STRUCTURAL NOTES
A-92	FOUNDATION PLAN
A-93	ROOF PLAN
A-94	MECHANICAL PLAN
A-95	ELECTRICAL PLAN
A-96	EXTERIOR ELEVATIONS
A-97	INTERIOR ELEVATIONS
A-98	SECTION
A-99	DETAILS
A-100	CONSTRUCTION NOTES

RECEIVED
OCT 22 2007

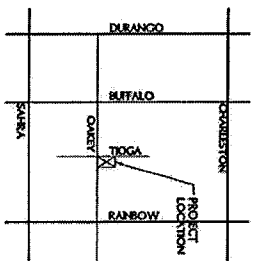

MR. AND MRS. SAM CASTROGIOVANI
1721 CHARLES LAM CT,
LAS VEGAS, NEVADA

SAM CASTROGIOVANI
3198 MONACO SHORES DR.
LAS VEGAS, NEVADA 89117
(702) 303-1075

APPLICABLE REGIONAL CODES:
2006 INTERNATIONAL RESIDENTIAL CODE
2006 INTERNATIONAL BUILDING CODE
2006 INTERNATIONAL PLUMBING CODE
2006 INTERNATIONAL MECHANICAL CODE
2006 INTERNATIONAL ELECTRICAL CODE
2006 INTERNATIONAL FIRE CODE
2006 INTERNATIONAL ENERGY CODE
2006 INTERNATIONAL SCHEDULING CODE
NEVADA CODE AMENDMENTS

A-1

Siba Plan

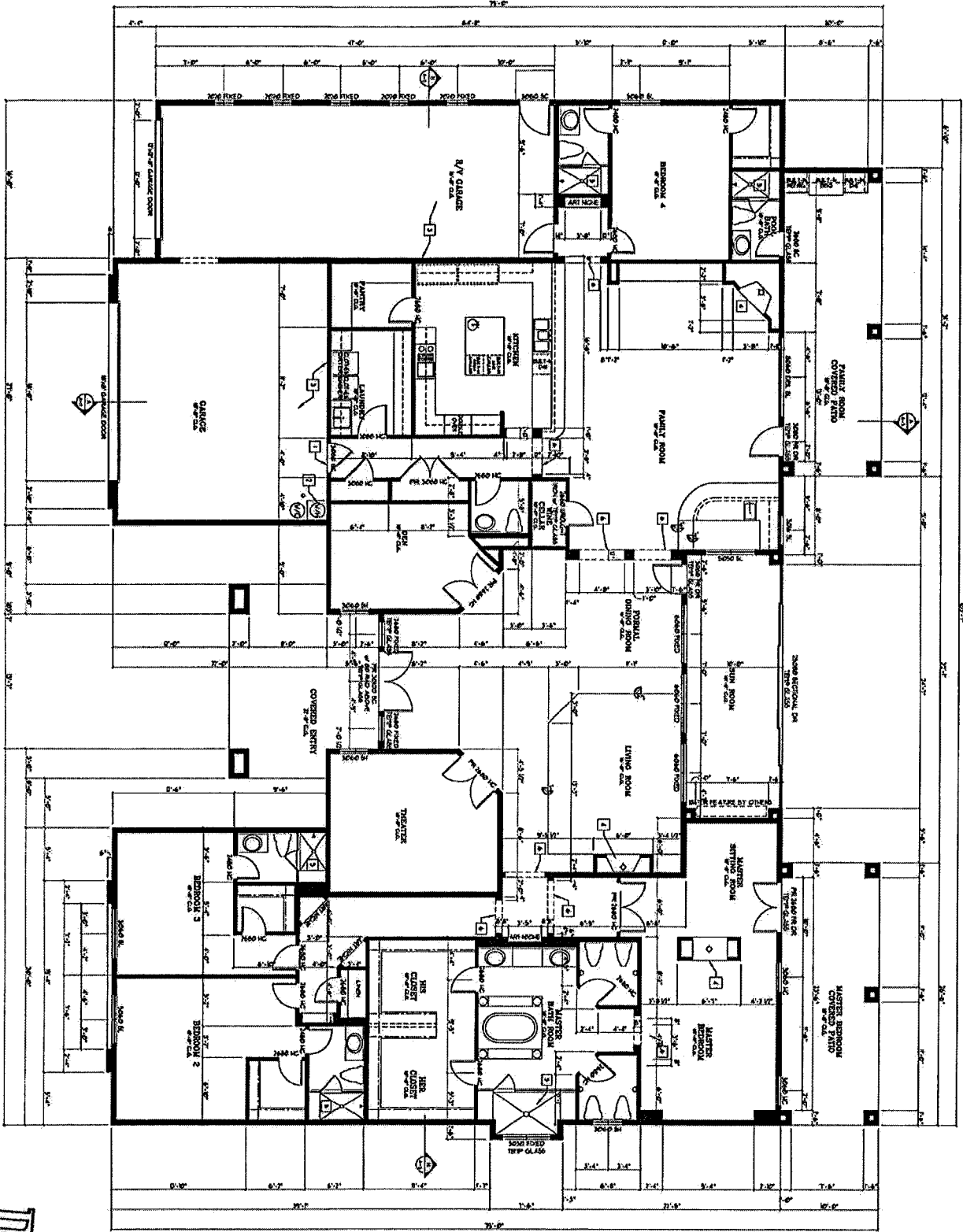

FIRST FLOOR PLAN

VAR-24260 11-07-07 CC

KEY NOTES

1. ALL DIMENSIONS ARE TO FACE UNLESS NOTED OTHERWISE.
2. FINISHES TO BE DETERMINED BY CLIENT.
3. ALL WALLS TO BE 1/2" MIN. THICK UNLESS NOTED OTHERWISE.
4. ALL DOORS TO BE 2'0" MIN. CLEARANCE UNLESS NOTED OTHERWISE.
5. ALL WINDOWS TO BE 2'0" MIN. CLEARANCE UNLESS NOTED OTHERWISE.
6. ALL CEILING HEIGHTS TO BE 8'0" UNLESS NOTED OTHERWISE.
7. ALL FLOOR FINISHES TO BE DETERMINED BY CLIENT.
8. ALL WALL FINISHES TO BE DETERMINED BY CLIENT.
9. ALL CEILING FINISHES TO BE DETERMINED BY CLIENT.
10. ALL ELECTRICAL SYMBOLS TO BE AS SHOWN ON SHEET E-1.
11. ALL PLUMBING SYMBOLS TO BE AS SHOWN ON SHEET P-1.
12. ALL MECHANICAL SYMBOLS TO BE AS SHOWN ON SHEET M-1.
13. ALL FINISHES TO BE DETERMINED BY CLIENT.
14. ALL DIMENSIONS ARE TO FACE UNLESS NOTED OTHERWISE.
15. ALL WALLS TO BE 1/2" MIN. THICK UNLESS NOTED OTHERWISE.
16. ALL DOORS TO BE 2'0" MIN. CLEARANCE UNLESS NOTED OTHERWISE.
17. ALL WINDOWS TO BE 2'0" MIN. CLEARANCE UNLESS NOTED OTHERWISE.
18. ALL CEILING HEIGHTS TO BE 8'0" UNLESS NOTED OTHERWISE.
19. ALL FLOOR FINISHES TO BE DETERMINED BY CLIENT.
20. ALL WALL FINISHES TO BE DETERMINED BY CLIENT.
21. ALL CEILING FINISHES TO BE DETERMINED BY CLIENT.
22. ALL ELECTRICAL SYMBOLS TO BE AS SHOWN ON SHEET E-1.
23. ALL PLUMBING SYMBOLS TO BE AS SHOWN ON SHEET P-1.
24. ALL MECHANICAL SYMBOLS TO BE AS SHOWN ON SHEET M-1.
25. ALL FINISHES TO BE DETERMINED BY CLIENT.

WALL SCHEDULE

NO.	DESCRIPTION	THICKNESS	FINISH
1	EXTERIOR WALL	8" CMU	EIFS
2	INTERIOR WALL	1/2" GYP	PAINT
3	GLASS WALL	1/2" GYP	GLASS
4	CONCRETE WALL	12" CONC	EIFS
5	CEILING	5" GYP	PAINT
6	FLOOR	4" CONC	FINISH

DOOR SCHEDULE

NO.	DESCRIPTION	FINISH
1	EXTERIOR DOOR	WOOD
2	INTERIOR DOOR	WOOD
3	GLASS DOOR	GLASS
4	SLIDING DOOR	WOOD
5	SCREEN DOOR	SCREEN

WINDOW SCHEDULE

NO.	DESCRIPTION	FINISH
1	EXTERIOR WINDOW	EIFS
2	INTERIOR WINDOW	PAINT
3	GLASS WINDOW	GLASS
4	SCREEN WINDOW	SCREEN

FINISH SCHEDULE

NO.	DESCRIPTION	FINISH
1	EXTERIOR WALL	EIFS
2	INTERIOR WALL	PAINT
3	CEILING	PAINT
4	FLOOR	FINISH

NOTES

1. ALL DIMENSIONS ARE TO FACE UNLESS NOTED OTHERWISE.
2. FINISHES TO BE DETERMINED BY CLIENT.
3. ALL WALLS TO BE 1/2" MIN. THICK UNLESS NOTED OTHERWISE.
4. ALL DOORS TO BE 2'0" MIN. CLEARANCE UNLESS NOTED OTHERWISE.
5. ALL WINDOWS TO BE 2'0" MIN. CLEARANCE UNLESS NOTED OTHERWISE.
6. ALL CEILING HEIGHTS TO BE 8'0" UNLESS NOTED OTHERWISE.
7. ALL FLOOR FINISHES TO BE DETERMINED BY CLIENT.
8. ALL WALL FINISHES TO BE DETERMINED BY CLIENT.
9. ALL CEILING FINISHES TO BE DETERMINED BY CLIENT.
10. ALL ELECTRICAL SYMBOLS TO BE AS SHOWN ON SHEET E-1.
11. ALL PLUMBING SYMBOLS TO BE AS SHOWN ON SHEET P-1.
12. ALL MECHANICAL SYMBOLS TO BE AS SHOWN ON SHEET M-1.
13. ALL FINISHES TO BE DETERMINED BY CLIENT.
14. ALL DIMENSIONS ARE TO FACE UNLESS NOTED OTHERWISE.
15. ALL WALLS TO BE 1/2" MIN. THICK UNLESS NOTED OTHERWISE.
16. ALL DOORS TO BE 2'0" MIN. CLEARANCE UNLESS NOTED OTHERWISE.
17. ALL WINDOWS TO BE 2'0" MIN. CLEARANCE UNLESS NOTED OTHERWISE.
18. ALL CEILING HEIGHTS TO BE 8'0" UNLESS NOTED OTHERWISE.
19. ALL FLOOR FINISHES TO BE DETERMINED BY CLIENT.
20. ALL WALL FINISHES TO BE DETERMINED BY CLIENT.
21. ALL CEILING FINISHES TO BE DETERMINED BY CLIENT.
22. ALL ELECTRICAL SYMBOLS TO BE AS SHOWN ON SHEET E-1.
23. ALL PLUMBING SYMBOLS TO BE AS SHOWN ON SHEET P-1.
24. ALL MECHANICAL SYMBOLS TO BE AS SHOWN ON SHEET M-1.
25. ALL FINISHES TO BE DETERMINED BY CLIENT.

SAM CASTROGIOVANI
3198 MONACO SHORES DR.
LAS VEGAS, NEVADA 89117
(702) 303-1075

MR. AND MRS. SAM CASTROGIOVANNI
1721 CHARLES LAM CT,
LAS VEGAS, NEVADA

RECEIVED
OCT 22 2007
A-2

First Floor Plan

Sheet No.