

ANTELOPE WAY

PARKING ANALYSIS
 TOTAL PARKING REQUIRED (116)
 PARKING PROVIDED (105)

7-11

WEST CHARLESTON BLVD.



ADDRESS RANGE 7002 - 7034
 USES & PARKING
 1/13/07 AS PER ZONING & LHM

Property Size: Approx. 24,000 sq. ft.

SUP-25259
12/06/07 PC

FIESTA SQUARE PARKING ANALYSIS
 11.20.07

OFFICE BUSINESS PARK

OFFICE BUSINESS PARK

RECEIVED
 OCT 23 2007

Fiesta Discount Market 7010 and 7012 W. Charleston

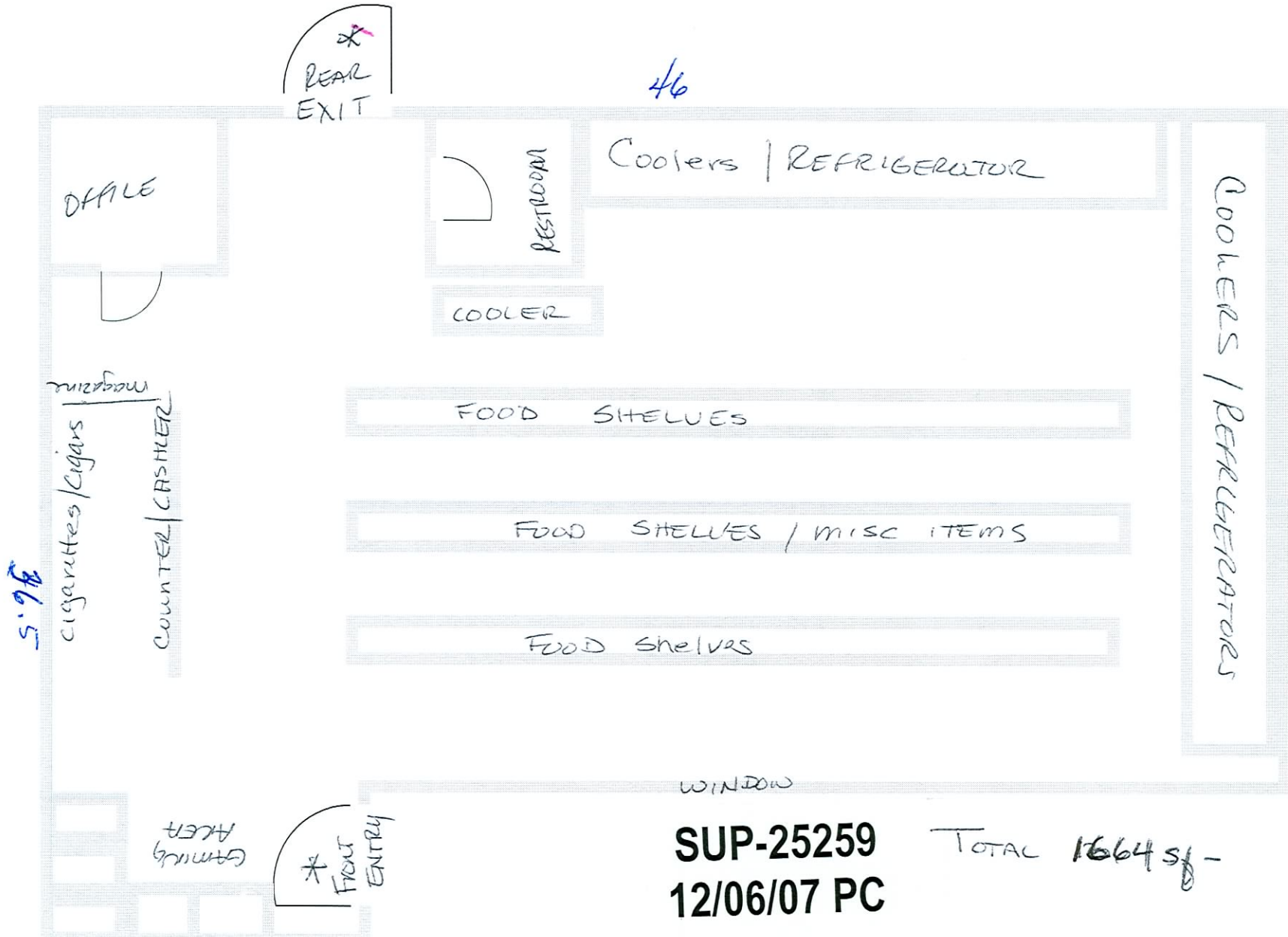

SUP-25259
12/06/07 PC

TOTAL 1664 sf -

RECEIVED
OCT 23 2007

