

**PLANNING & DEVELOPMENT DEPARTMENT**

RECEIVED  
OCT 30 2007

**STATEMENT OF FINANCIAL INTEREST**

Case Number: **ZON-25342** APN: 139-34-710-05A, 55, 56 AND 139-34-810-052  
Name of Property Owner: CRAIG KENNY  
Name of Applicant: SKME  
Name of Representative: JAWA STUDIO

To the best of your knowledge, does the Mayor or any member of the City Council or Planning Commission have any financial interest in this or any other property with the property owner, applicant, the property owner or applicant's general or limited partners, or an officer of their corporation or limited liability company?

\_\_\_\_\_ Yes

/  No

If yes, please indicate the member of the City Council or Planning Commission who is involved and list the name(s) of the person or persons with whom the City Official holds an interest. Also list the Assessor's Parcel Number if the property in which the interest is held is different from the case parcel.

City Official: \_\_\_\_\_

Partner(s): \_\_\_\_\_

APN: \_\_\_\_\_

Signature of Property Owner: [Signature]

Print Name: Craig Kenny

Subscribed and sworn before me

This 31<sup>st</sup> day of October, 2007

[Signature]  
Notary Public in and for said County and State

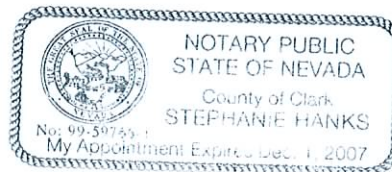

PLANS

NO.	
DATE	
BY	
CHKD	
APP'D	

© Copyright 2007 Jawa Studio, Inc.  
 All rights reserved. No part of this document may be reproduced, stored in a retrieval system, or transmitted in any form or by any means, electronic, mechanical, photocopying, recording, or by any information storage and retrieval system, without the prior written permission of Jawa Studio, Inc.

PROJECT / ADDRESS

**Kenny law office**  
 Clark Avenue & S. 8th St.  
 Las Vegas, Nevada

DATE: 12.04.07  
 DRAWN BY: DE/JW  
 CHECKED BY: DE/JW  
 PROJECT NO: 07008  
 SHEET NO: A0.0

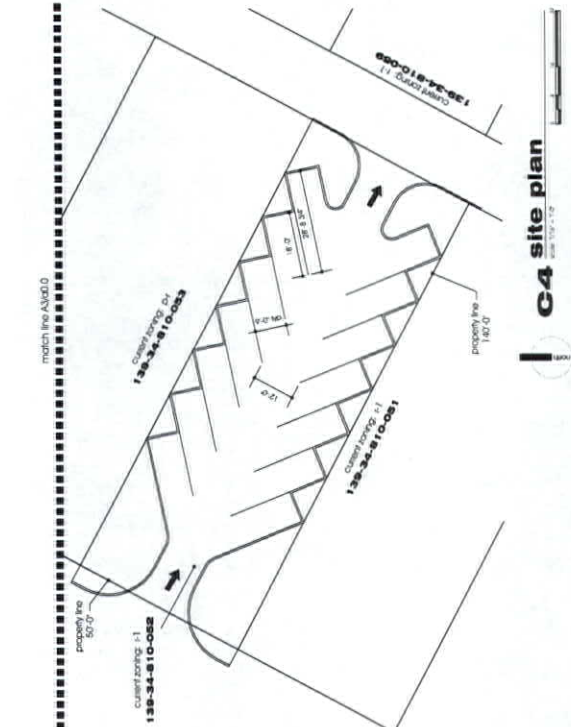

**site information**

area: 81,000 s.f. (0.84 acres)  
 building foot print: 7,000 s.f.  
 coverage: 8.6%  
 parking: 17,000 s.f. @ 3,000 s.f./space  
 parking spaces: 5.7  
 parking provided: 5.7  
 (incl. 2 accessible spaces)

**vicinity map**

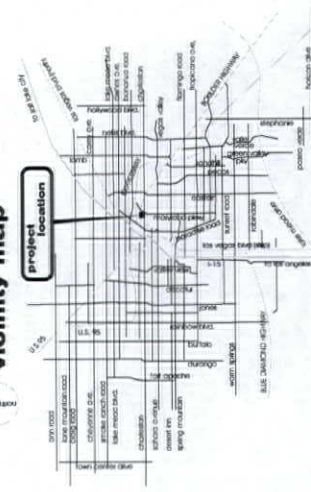

**ZON-25342**  
**12/20/07 PC**  
**REVISED**

RECEIVED  
 DEC 05 2007