



**PLANNING & DEVELOPMENT DEPARTMENT**

**STATEMENT OF FINANCIAL INTEREST**

Case Number: SUP-24723 APN: 139-34-612-085 (new)  
139-34-612-065 thru 067 (old, per deed)

Name of Property Owner: Shirazi LLC

Name of Applicant: Jon Baktari

Name of Representative: Greg Borgel

To the best of your knowledge, does the Mayor or any member of the City Council or Planning Commission have any financial interest in this or any other property with the property owner, applicant, the property owner or applicant's general or limited partners, or an officer of their corporation or limited liability company?

Yes

No

If yes, please indicate the member of the City Council or Planning Commission who is involved and list the name(s) of the person or persons with whom the City Official holds an interest. Also list the Assessor's Parcel Number if the property in which the interest is held is different from the case parcel.

City Official: \_\_\_\_\_

Partner(s): \_\_\_\_\_

APN: \_\_\_\_\_

Signature of Property Owner: *Jon Baktari*

Print Name: Jon Baktari

Subscribed and sworn before me

This 17<sup>th</sup> day of September, 2007

*Rosemary Congero*  
Notary Public in and for said County and State

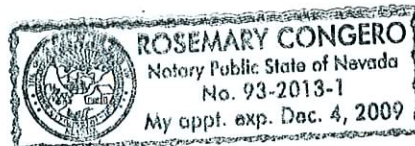

RECEIVED

SEP 21 2007



REVISIONS PER PLANNING DEPARTMENT, AB 08-14-98  
 REVISIONS PER ARCHITECT, AB 08-17-98

**SOUTHWICK**  
 INC. ASSOCIATES

**CAMPAGE PLACE**  
 321 BEATTY STREET  
 LAS VEGAS, NEVADA

DATE: 08-24-08  
 DRAWN BY: BWS  
 PROJECT NO: 08143

**L1.02**

STEWART AVENUE

PUBLIC ALLEY

9TH ST

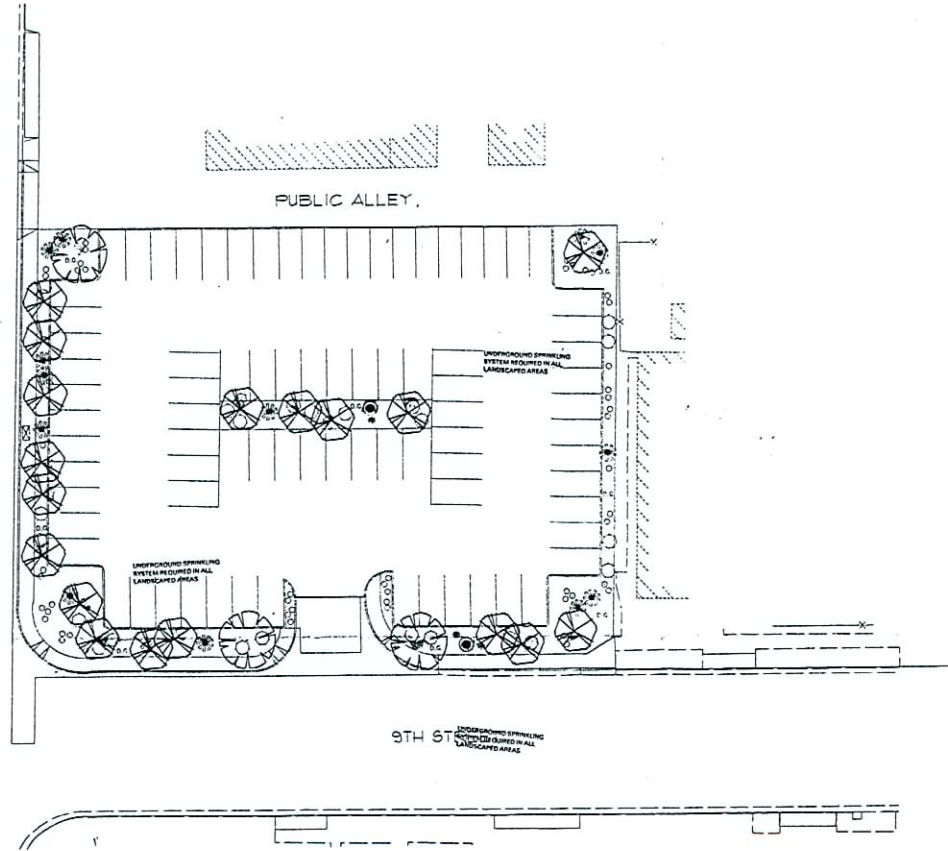

**PLANTING LEGEND** (QUANTITY TOTALS INCLUDE DORM SIZES)

SYMBOL	BOTANICAL/COMMON NAME	SIZE	QTY.	SYMBOL	BOTANICAL/COMMON NAME	SIZE	QTY.
	FRAXINUS VELUTINA 'MOCKSTO'	4"	1		ASPIDISTRA ELATIOR	1 GAL	28
	MOCKSTO ASH	1 1/2" GAL			HYSTERIS CORYMBOSA 'COMPACTA'	5 GAL	44
	AGAVE STENOPHYLLA	24" BOX	19		PSEUDOTSUGA SITCHENSIS	8" TALL	10
	CERCOCARPUS HYBRID 'DESERT FUSSELL'	24" BOX	41		AGAVE PARRYI	5 GAL	50
	DESERT FUSSELL				CONOCLINIUM EPLANDIERI	1 GAL	81
	WASHINGTONIA ROBUSTA	20" TALL	5		FELICEA CAPILLARIS 'REGAL FEST'	1 GAL	32
	MORCAN FAN PALM				FELICEA PYCNOS	5 GAL	56
	CUPRESSUS SEMPERVIRENS 'STRICTA'	24" BOX	23		SALVIA GREGGIA	5 GAL	38
	ITALIAN CYPRESS				AUTUMN SAGE		
	AMPELOPSIS UNEDO 'COMPACTA'	24" BOX	4		LANTANA SPP. 'TRAILING YELLOW'	1 GAL	850
	PITOSPORUM TOBIRA 'WHEELER'S DWARF'	5 GAL	30		TRAILING YELLOW LANTANA	24" O.C.	
	DWARF POOR ORANGE						
	LEUCOPHYLLUM REVOLUTUM 'SIERRA MAGIC PINK'	5 GAL	36				
	SIERRA MAGIC PINK RANGER						

ATTENTION  
 NO FINAL INSPECTION WITHOUT  
 ZONING APPROVAL  
 APPROVED LANDSCAPING PLAN  
 10/7/08  
 Planning & Development Department

D.B. NOTE:  
 INSTALL A 2" LAYER OF 1/2" SCREENED GRANULAR FILL  
 DECATING ROCK CONTROLS IN ALL PLANTERS  
 UNDER ALL TREES AND SHRUBS. AVAILABLE THROUGH  
 WATKINS BROTHERS (702) 463-4086. BEFORE  
 PLACING GRANITE CONTACT SUB-GRADE TO ROCK AND  
 APPLY A PRE-DERIGENT FIBERGLASS TO SOIL. AFTER  
 PLACING ROCKS, HAVE SMOOTH NET TO EXPOSE TOPS.  
 ALLOW TO DRY, THEN APPLY A SECONDARY APPLICATION OF  
 PRE-DERIGENT FIBERGLASS TO TOP OF ROCK. KEEP  
 TOP OF ROCK 1" BELOW ADJACENT WALKS AND CURBS.  
 DO NOT ALLOW ROCK TO TOUCH THE TRUNK OF ANY  
 PLANT. INSTALL AFTER INSTALLATION OF PLANT MATERIAL.  
 SEE D.L. 2, SHEET L3.01



SCALE 1" = 30'-0"

**SUP-24723**  
**11/08/07 PC**

SEP 21 2007