



PROJECT INFORMATION

Jurisdiction:	City of Las Vegas
Site Area:	1,536,847 SF (36.43 Acres) - must be verified
Total Building Area:	438,033 SF
Parking Required:	1,803 SPACES (4,001 / 1,000 SF)
Parking Provided:	2,307 SPACES (5.51 / 1,000 SF) - surface 200 SPACES - underground
HC Parking Required:	2,322 SPACES - total
HC Parking Provided:	34 SPACES (7 VAN ACCESSIBLE) - surface 4 SPACES (4 VAN ACCESSIBLE) - underground 44 SPACES (11 VAN ACCESSIBLE) - total
Parking Stall Dimensions:	9' Width x 11' Deep (18' w/ permitted overhang)
Floor Area/Site Area:	28.57%

LANDSCAPING LEGEND

Size	Landscaping Material
30' x 30'	California Anemone
24' x 24'	Alamo Pine
36' x 36'	Ukiah on Iron Palm
1/4" x 1/4"	Groundcover Rock
5' Circle	Red Tuco

Planters areas to be covered in decomposed granite or other approved material

EXISTING ZONING: R-CI
EXISTING GP: MEDIUM-LOW RESIDENTIAL

EXISTING ZONING: R - PD3
EXISTING GP: MEDIUM RESIDENTIAL

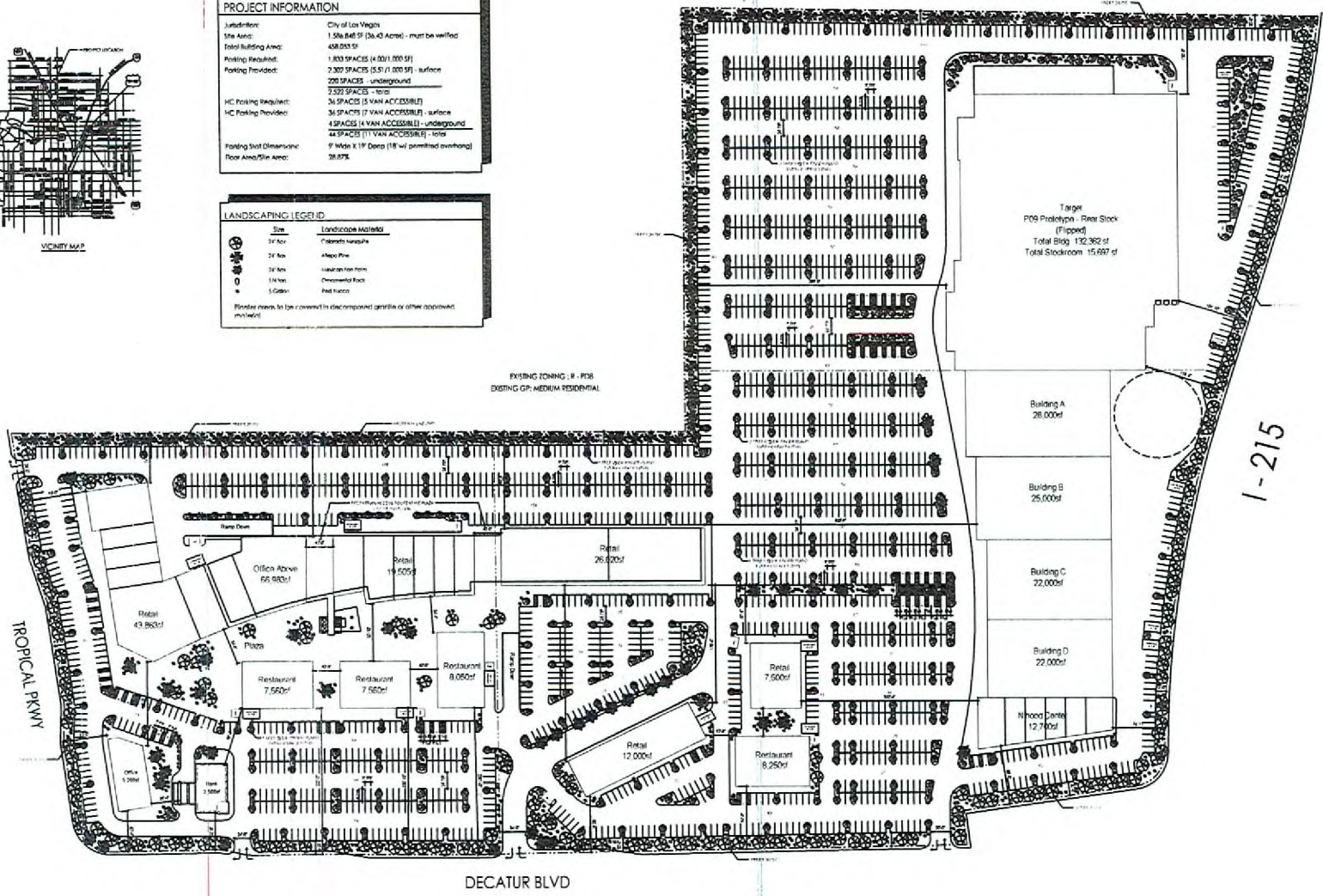

SITE/LANDSCAPE PLAN • Decatur/Tropical • June 12, 2007

JAMES S. TROCH ARCHITECT, INC.
1551 Ponce de Leon Las Vegas, Nevada 89115
(702) 433-4400

R&S INVESTMENTS
11111 W. Sahara Ave. Suite 100
Las Vegas, NV 89135

RECEIVED

JUL 09 2007

ZON-22583
REVISED
07/26/07 PC

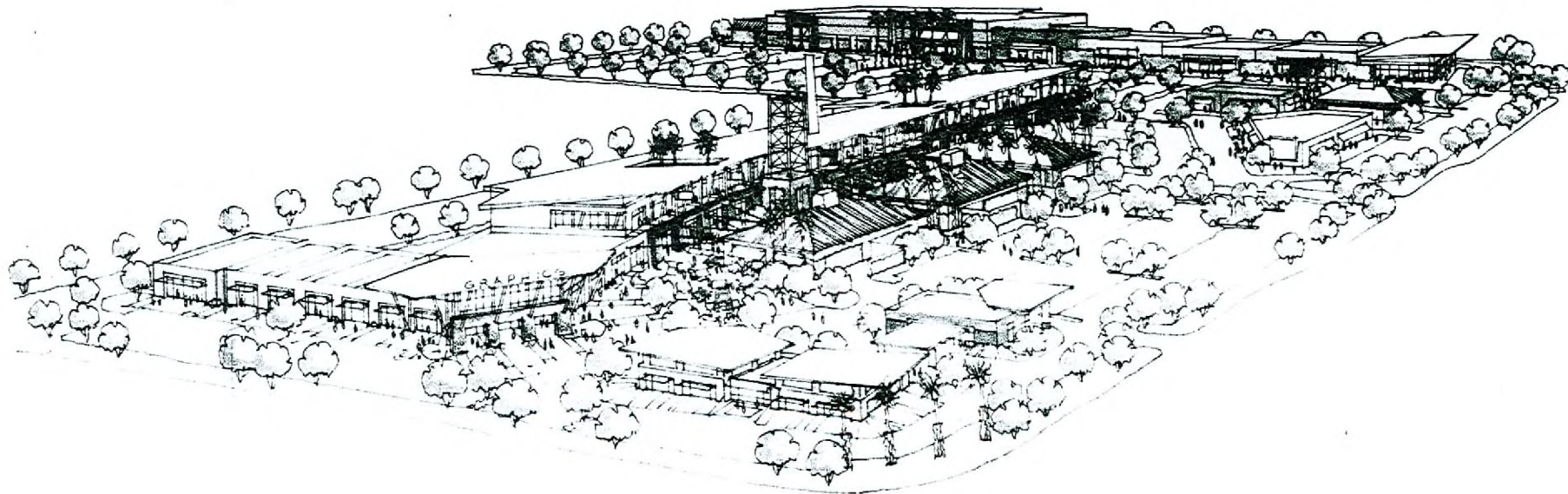

RECEIVED
JUN 12 2007

NOTE: The information is conceptual and subject to adjustments pending further verification and Client, Tenant, and Governmental Agency approvals. No warranties or guarantees of any kind are given or implied.
HTH Architects - Copyright 2007

ZON-22583
07/26/07 PC

Decatur & Tropical
Aerial Perspective
06.11.07

HTH
Architects