

KEYNOTES	
#	description
1	1/4" STUCCO ON PAPERBACKED MESH (SAND FINISH)
2	ALUMINUM STOREFRONT GLAZING - SEE DOOR + WINDOW SCHEDULE
3	LINE OF MECHANICAL EQUIPMENT BEYOND
4	LINE OF ROOF BEYOND
5	PAINTED STEEL PIPE COLUMN
6	STUCCO COLUMN
7	DOOR - SEE PLAN AND SCHEDULE
8	DECORATIVE STEEL FINISH
9	STUCCO CONTROL JOINT
10	STUCCO REVEAL
11	DRIVE-THRU WINDOW

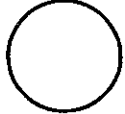

REVISIONS

NO.	DATE	DESCRIPTION
1		
2		
3		

JOHN
OGUN
DUMC. ARCHITECT

14711 W. OGDEN ROAD • 1401 LAS VEGAS NV, 89131 (702) 916-4663

RECEIVED

RESTAURANT PAD
2501 East Sahara
for Eagle Group, LLC
City of Las Vegas Nevada

DATE	BY
09/13/07	PC

steel no. A2

VAR-23547
SDR-23545
09/13/07 PC

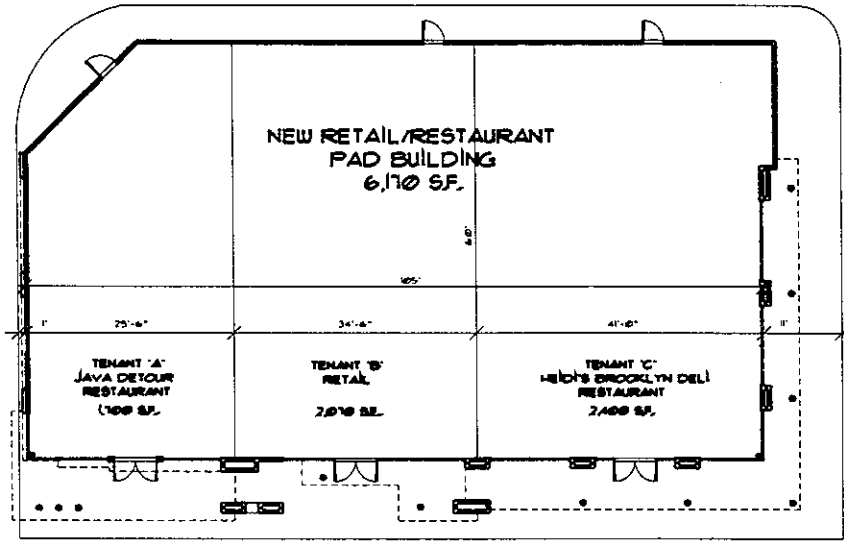

① FLOOR PLAN
SCALE: 1/8" = 1'-0"

RECEIVED

VAR-23547
SDR-23545
09/13/07 PC

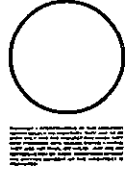

REVISIONS
A
A

JOHN
COULI
DUMC. ARCHITECT
13471 W. COYENCO ROAD, #201 LAS VEGAS, NV, 89119 (702) 736-4863

RESTAURANT PAD
2301 East Sahara
for Eagle Group, L.L.C.
City of Las Vegas Nevada

DATE	09/13/07
PROJ. NO.	23545
DRWN. BY	
CHKD. BY	

sheet no.
A3