



PLANNING & DEVELOPMENT DEPARTMENT

STATEMENT OF FINANCIAL INTEREST

Case Number: **SUP-25032** APN: 162-08-410-010

Name of Property Owner: 3140 Valley View LLC

Name of Applicant: Ramzi Suliman

Name of Representative: law Offices of Jay Brown

To the best of your knowledge, does the Mayor or any member of the City Council or Planning Commission have any financial interest in this or any other property with the property owner, applicant, the property owner or applicant's general or limited partners, or an officer of their corporation or limited liability company?

Yes No

If yes, please indicate the member of the City Council or Planning Commission who is involved and list the name(s) of the person or persons with whom the City Official holds an interest. Also list the Assessor's Parcel Number if the property in which the interest is held is different from the case parcel.

City Official: _____

Partner(s): _____

APN: _____

Signature of Property Owner: *[Handwritten Signature]*

Print Name: Farid Mahbobia- Fard

Subscribed and sworn before me

This 4th day of October, 20 07
Esperanza Barboza Flores
Notary Public in and for said County and State



VALLEY VIEW BLVD S.

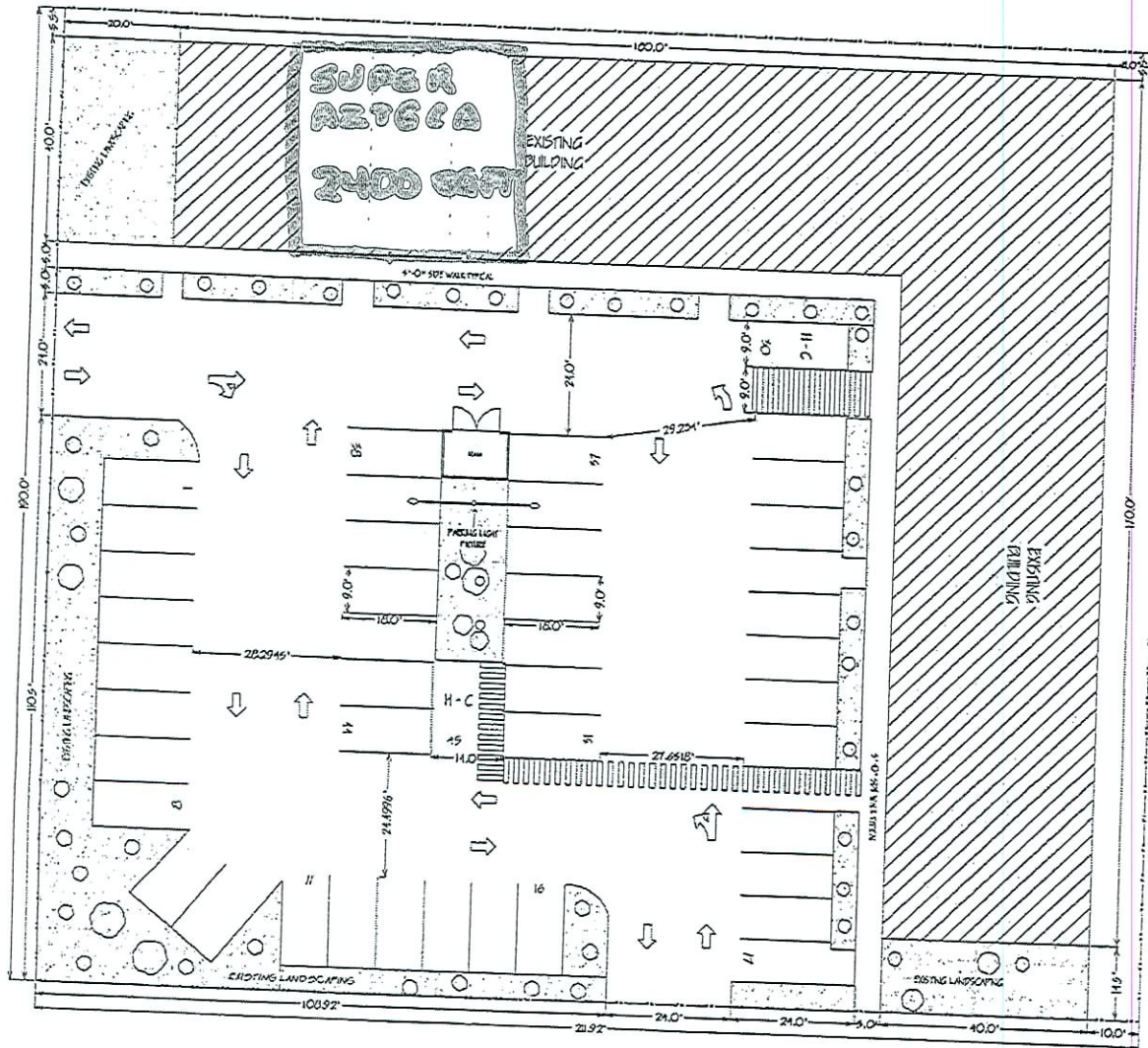

CAPELLA AVENUE

Aztec Mini Mart
3140 Valley View Blvd # 3.4.5 Las Vegas, Nevada 89104

SITE INFORMATION

APN # 162-08-410-002
 ZONING C-1
 SITE AREA 0.924 ACRES
 SITE AREA 40,249.44 SQ. FT.
 SITE COVERAGE 30.81%

BUILDING INFORMATION

TOTAL BUILDING 12,400 sq. ft.
 OCCUPANCY CLASSIFICATION M
 TYPE OF CONSTRUCTION V-B
 FIRE SPRINKLERS NO
 BUILDING HEIGHT 18'-0"
 BUILDING ALLOWABLE 30'-0"
 PROPOSED TENANT AREA 2,400 sq. ft.
 ALLOWABLE AREA 9,000 SQ. FT.
 OCCUPANT LOAD 80
 EXITS PROVIDED 2
 SET BACKS AS SHOWN
 CODE IBC 2003

PARKING

STALL SIZE 9'-0" X 18'-0"
 PARKING 45 PROVIDED

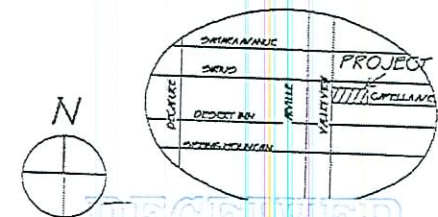

3-20-06
 4-10-06

* SITE PLAN *
 ATI AC CONSTRUCTION LTD

RECEIVED
 OCT 08 2007

SUP-25032
11/29/07 PC

A-

super AZTECA mini mart
3140 s valley view blv Units 3-5
las vegas N.V 89102
tel: 702-307-8058
ramzi suleman

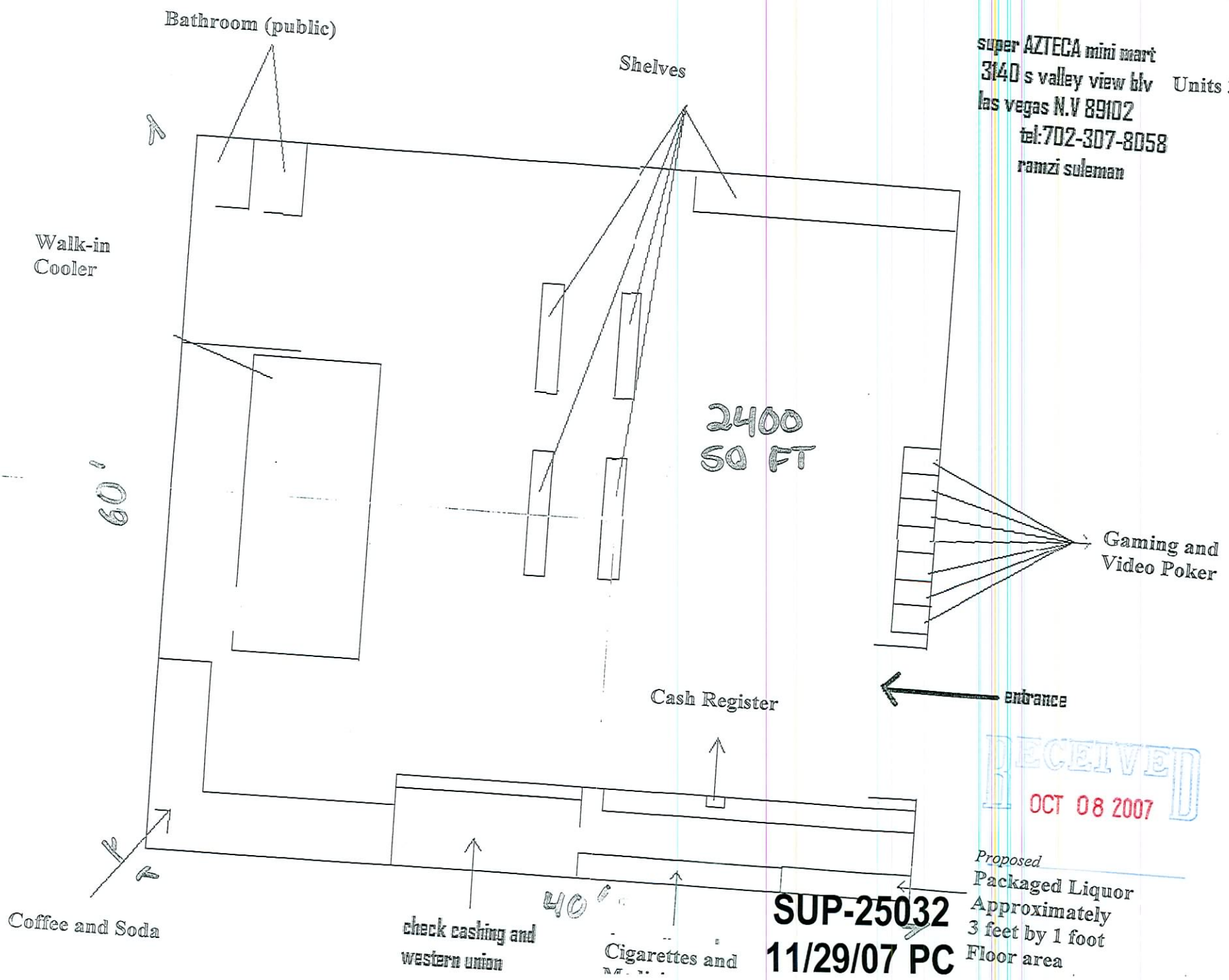

2400
SQ FT

60'

40'

RECEIVED
OCT 08 2007

SUP-25032
11/29/07 PC

Proposed
Packaged Liquor
Approximately
3 feet by 1 foot
Floor area

Coffee and Soda

check cashing and
western union

Cigarettes and

Cash Register

Gaming and
Video Poker

entrance

Walk-in
Cooler

Bathroom (public)

Shelves