

TIGER PAW COURT
(PRIVATE STREET & PUE)

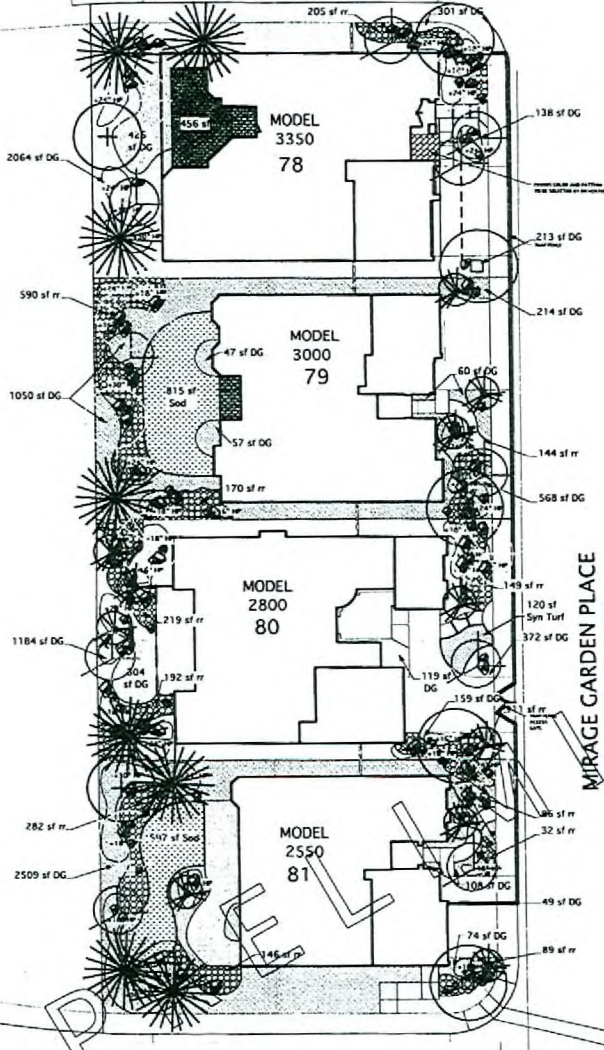

PANTHERA PLACE
(PRIVATE STREET & PUE)

MIRAGE GARDEN PLACE
(PRIVATE STREET & PUE)

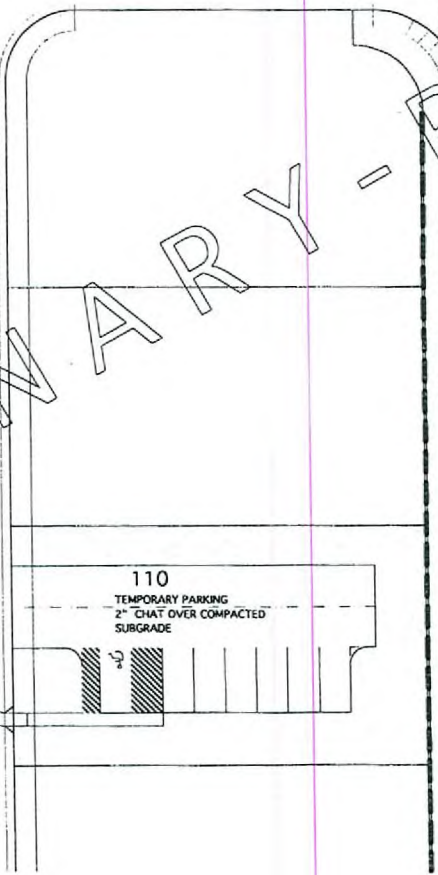

TREE & GROUND COVERAGE PLAN

LEGEND

QUANT.	SYMBOL	SPECIES	COMMON NAME	SIZE	DEPTH
		Pinus edulis	Mandell Pine	24" Box, 36" Box	8"
		Chitalpa tashkentensis	Flowering Chitalpa	24" Box, 36" Box	8"
		Quercus ilex	Holly Oak	24" Box, 36" Box	8"
		Prunus c. 'Atropurpurea'	Purple Leaf Plum	24" Box, 36" Box	8"
		Ligustrum lucidum	Glossy Privet	24" Box, 36" Box	8"
		Washingtonia robusta	American Fan Palm	Number 10	8"
		Acacia salicoides	Shrubby Acacia	24" Box, 36" Box	8"
		River Rock	4" Round Rock		
		Grass Pavers			

DG1: 30% Mulch, 70% screened, Vista Gold, 2" depth
 rr1: 30% Mulch, 70% screened, Vista Gold, 2" depth after compaction
 DG2: 30% Mulch, 70% screened, Vista Gold, 2" depth
 rr2: 30% Mulch, 70% screened, Vista Gold, 2" depth
 DG3: Rock Mulch, 7-4" screened, Red Granite, 2-4" depth
 rr3: 30% Mulch, 70% screened, Red Granite, 2-4" depth
 Turf: 3 seed minimum fescue blend sod Poly Estery flush along all turf edges. Curves to be smooth and uniform.
 Synthetic Turf: 45-50 or min fiber weight w/ drainage holes 6" OC min and fibers to be stain resistant. Eight year minimum life guarantee. Provide sample & specs for later approval. Poly estery flush along all turf edges.

Notes:

- 1) All plant material to meet appropriate Municipal approved species list.
- 2) All trees to be 24" box unless noted otherwise on plan.
- 3) All shrubs to be planted a minimum of 3' back of walk unless approved otherwise by Landscape Architect in writing.
- 4) Contractor shall not make plant substitutions, plant relocations or changes to the irrigation system without written authorization from D R Horton and the Landscape Architect.
- 5) See landscape and irrigation detail sheets for proper construction installation.
- 6) All irrigation mainlines, zone valves, valve connections and PVC laterals to be inspected by D R Horton Landscape Superintendent for sizing & location prior to backfill around these components.
- 7) Sucker growth on all trees is to be removed.
- 8) All trees that are short and bushy shall be pruned at a minimum of 3/4 of the trunk height to force new growth upward. Lx Olive, Mesquite, Palo Verde, Texas Mtn, Laurel, etc.
- 9) Landscape Architect and D R Horton Site Representative to inspect all irrigation zones prior to rock installation. Contractor must notify L/A and D R Horton Site Rep. at least 24hrs prior to rock install.

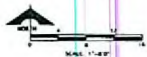

ROC-23275
09-05-07 CC
RECEIVED
JUL 7 2007



LANDSCAPE ARCHITECTURE
IRRIGATION DESIGN
PAUL PLANNING
COMPUTER WAG. INC.



BAVARIA
D R Horton, Inc.
MODEL LANDSCAPE PLAN
M-11