

PLANNING & DEVELOPMENT DEPARTMENT

STATEMENT OF FINANCIAL INTEREST

Case Number: WVR-22255 APN: 125-19-201-001, 003

Name of Property Owner: Day Star Ventures LLC

Name of Applicant: Wagner Homes

Name of Representative: Paul Wagner

To the best of your knowledge, does the Mayor or any member of the City Council or Planning Commission have any financial interest in this or any other property with the property owner, applicant, the property owner or applicant's general or limited partners, or an officer of their corporation or limited liability company?

Yes

No

If yes, please indicate the member of the City Council or Planning Commission who is involved and list the name(s) of the person or persons with whom the City Official holds an interest. Also list the Assessor's Parcel Number if the property in which the interest is held is different from the case parcel.

City Official: _____

Partner(s): _____

APN: _____

Signature of Property Owner: 

Print Name: Paul Wagner

Subscribed and sworn before me

This 24th day of May, 2007
Larae Obenauf
Notary Public in and for said County and State



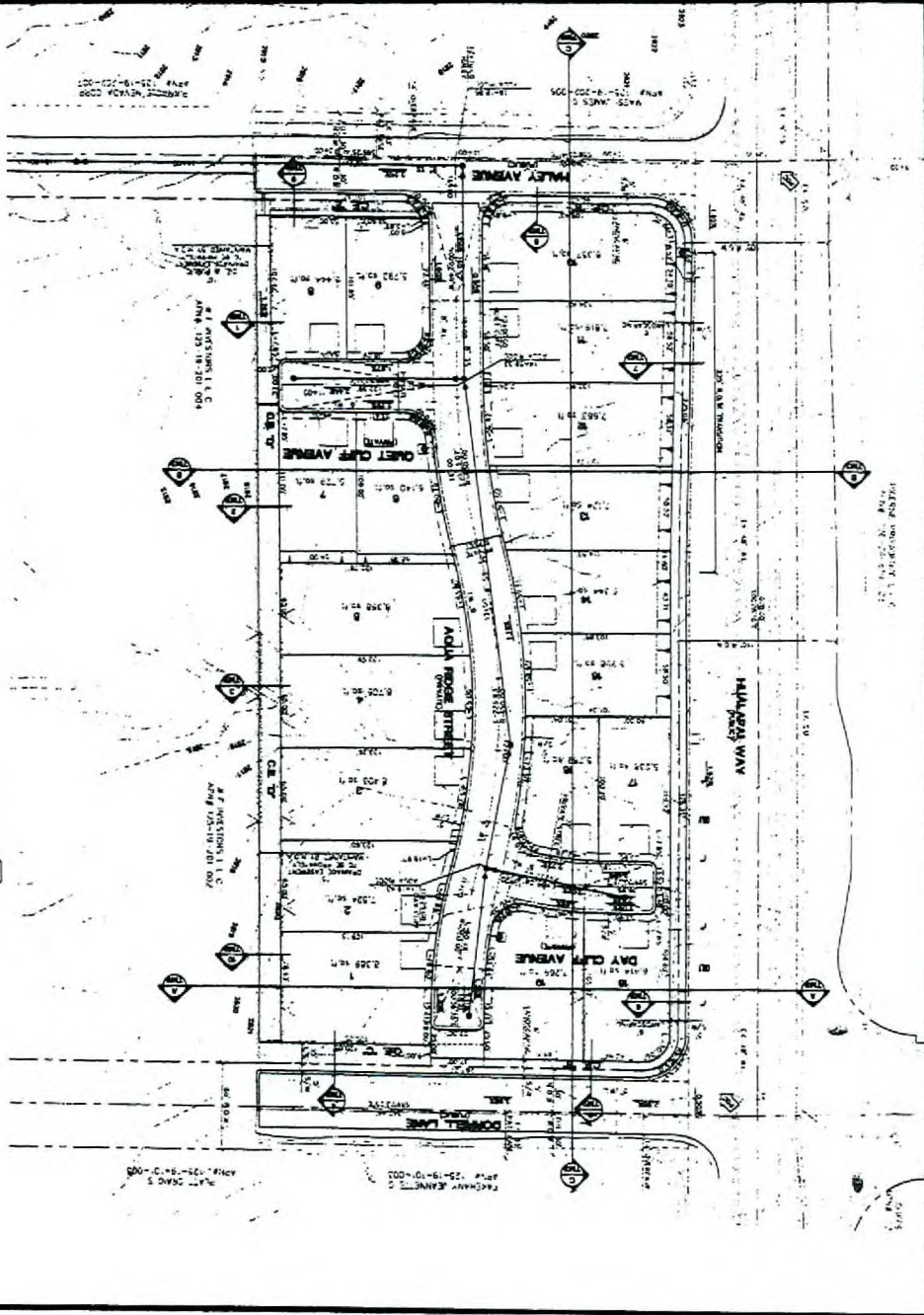

WVR 22255
 SDR-22253
 07/12/07 PC

Underground Call
 Before you Dig
 1-800-485-5829

Overhead Call
 Before you Dig
 1-800-485-5829

GENERAL NOTES

1. THE ENGINEER HAS CONDUCTED VISUAL GENERAL SURVEY OF THE PROJECT AND HAS FOUND THE INFORMATION TO BE SUFFICIENT FOR THE PRELIMINARY DESIGN.
2. THE ENGINEER HAS CONDUCTED VISUAL GENERAL SURVEY OF THE PROJECT AND HAS FOUND THE INFORMATION TO BE SUFFICIENT FOR THE PRELIMINARY DESIGN.
3. THE ENGINEER HAS CONDUCTED VISUAL GENERAL SURVEY OF THE PROJECT AND HAS FOUND THE INFORMATION TO BE SUFFICIENT FOR THE PRELIMINARY DESIGN.
4. THE ENGINEER HAS CONDUCTED VISUAL GENERAL SURVEY OF THE PROJECT AND HAS FOUND THE INFORMATION TO BE SUFFICIENT FOR THE PRELIMINARY DESIGN.
5. THE ENGINEER HAS CONDUCTED VISUAL GENERAL SURVEY OF THE PROJECT AND HAS FOUND THE INFORMATION TO BE SUFFICIENT FOR THE PRELIMINARY DESIGN.
6. THE ENGINEER HAS CONDUCTED VISUAL GENERAL SURVEY OF THE PROJECT AND HAS FOUND THE INFORMATION TO BE SUFFICIENT FOR THE PRELIMINARY DESIGN.
7. THE ENGINEER HAS CONDUCTED VISUAL GENERAL SURVEY OF THE PROJECT AND HAS FOUND THE INFORMATION TO BE SUFFICIENT FOR THE PRELIMINARY DESIGN.
8. THE ENGINEER HAS CONDUCTED VISUAL GENERAL SURVEY OF THE PROJECT AND HAS FOUND THE INFORMATION TO BE SUFFICIENT FOR THE PRELIMINARY DESIGN.
9. THE ENGINEER HAS CONDUCTED VISUAL GENERAL SURVEY OF THE PROJECT AND HAS FOUND THE INFORMATION TO BE SUFFICIENT FOR THE PRELIMINARY DESIGN.
10. THE ENGINEER HAS CONDUCTED VISUAL GENERAL SURVEY OF THE PROJECT AND HAS FOUND THE INFORMATION TO BE SUFFICIENT FOR THE PRELIMINARY DESIGN.

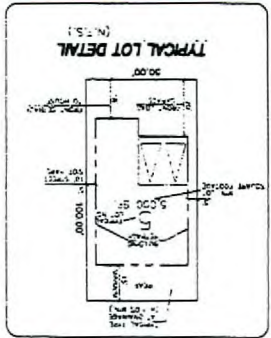

REVISIONS SHEET

NO.	DATE	DESCRIPTION
1	07/12/07	ISSUED FOR PERMITS
2	07/12/07	REVISIONS
3	07/12/07	REVISIONS
4	07/12/07	REVISIONS
5	07/12/07	REVISIONS
6	07/12/07	REVISIONS
7	07/12/07	REVISIONS
8	07/12/07	REVISIONS
9	07/12/07	REVISIONS
10	07/12/07	REVISIONS

GRAPHIC SCALE

KEY MAP

NOTE DATA

DATE: 07/12/07
 TIME: 10:00 AM
 LOCATION: 1000 201 2733

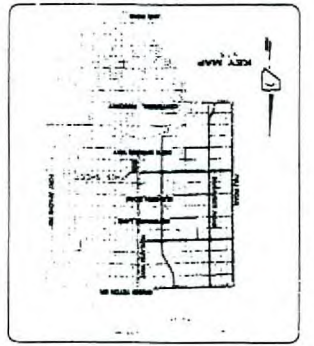

PROJECT BENCHMARK

THE BENCHMARK IS A CONCRETE PILE DRIVEN TO A DEPTH OF 10 FEET INTO THE BED ROCK. THE BENCHMARK IS LOCATED AT THE CORNER OF HALSTEAD WAY AND DAY DAWN RIDGE II.

DATE OF SURVEY

07/12/07

NEVADA HOMES GROUP
 CITY OF LAS VEGAS

DAY DAWN RIDGE II

TENTATIVE MAP

DESIGNED BY: [Name]
 CHECKED BY: [Name]
 SCALE: 1" = 40'

DATE: 07/12/07

1000 201 2733

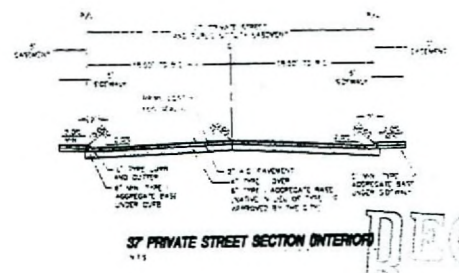
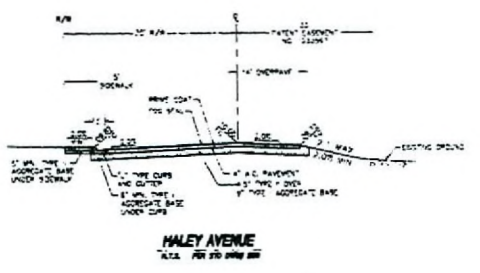
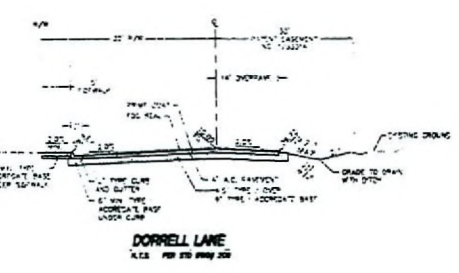
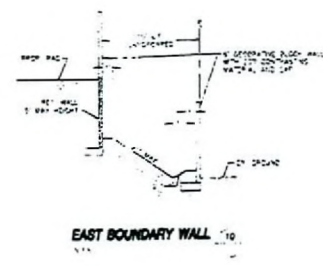
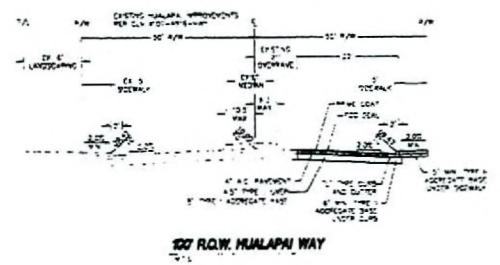
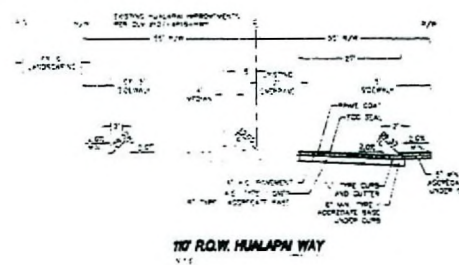
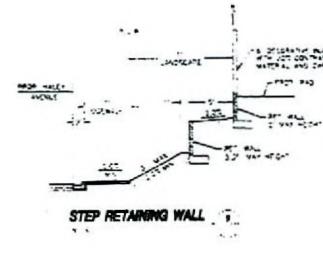
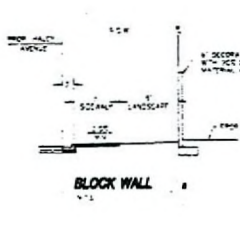
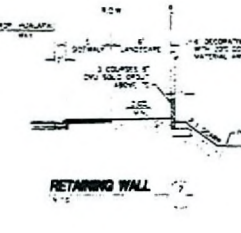
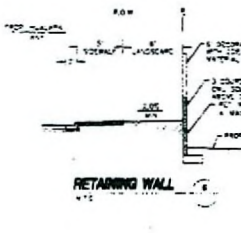
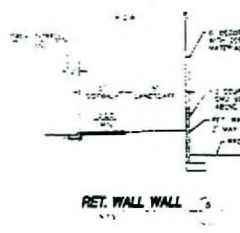
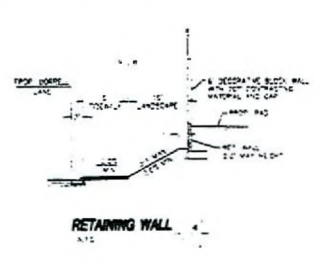
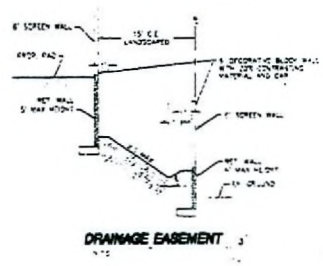
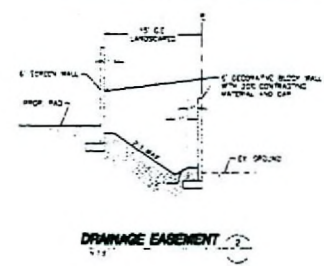
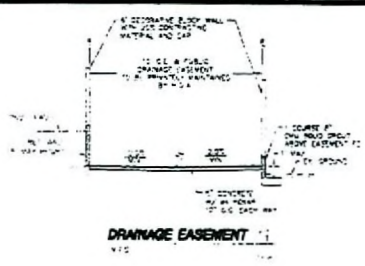

<p>NEVADA HOMES GROUP 1775 SOUTH PARKWAY SUITE 100 LAS VEGAS, NEVADA 89102 (702) 337-1975</p>		<p>CITY OF LAS VEGAS 111 SOUTH MAIN STREET SUITE 100 LAS VEGAS, NEVADA 89101 (702) 258-1000 FAX (702) 258-1047 WWW.NVHOMES.COM</p>	
<p>TENTATIVE MAP</p>		<p>DAY DAWN RIDGE II</p>	
<p>DESIGNED BY: DATE: APR 13</p>	<p>CHECKED BY: DATE: APR 13</p>	<p>SCALE: 1/4" = 1'-0"</p>	<p>SHEET NO.: 2 OF 3 SHEETS</p>
<p>RECEIVED MAY 20 2007</p>			

WVR-22255
 SDR-22253
 07/12/07 PC

CROSS SECTION A

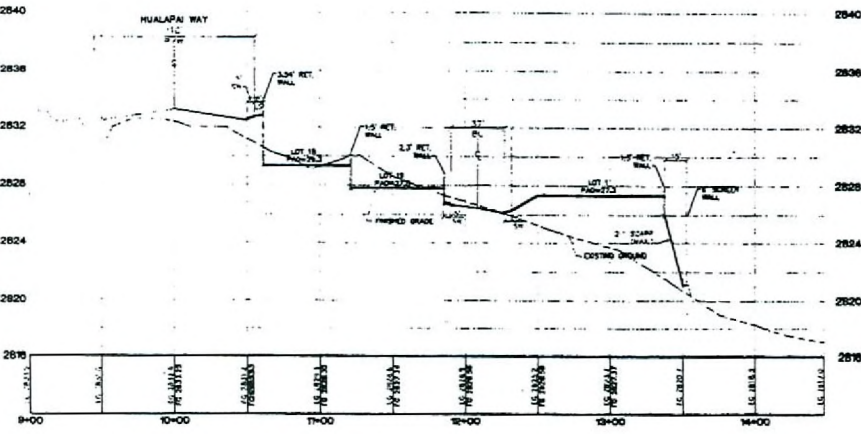

CROSS SECTION B

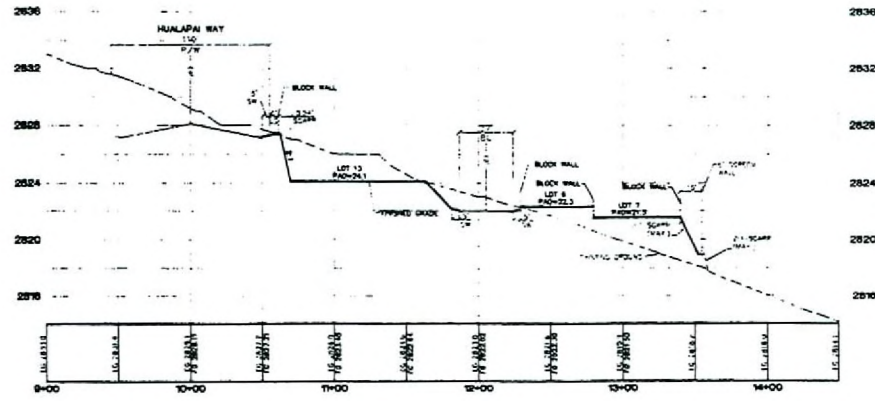

CROSS SECTION C

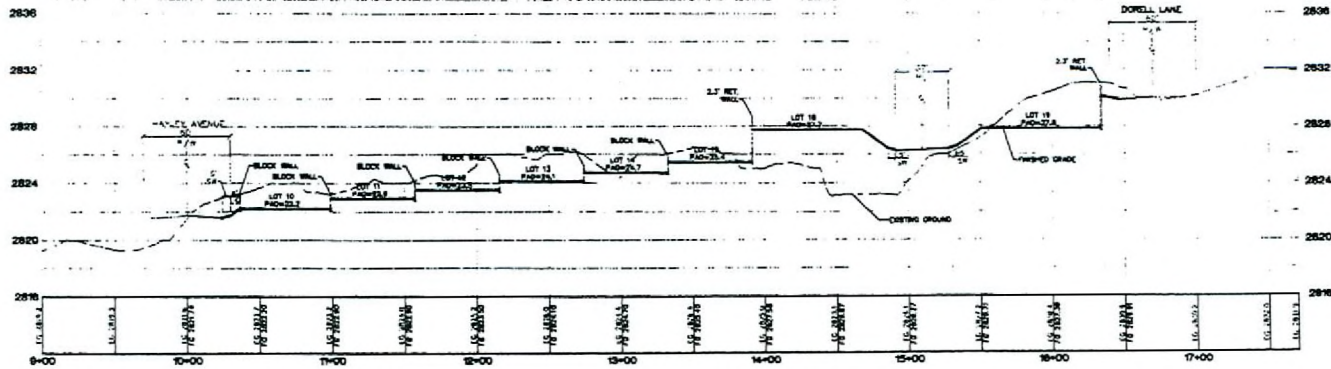

<p>NEVADA HOMES GROUP 1177 SOUTH LAMORF BOULEVARD LAS VEGAS, NEVADA 89144-5148 (702) 271-7711</p>		<p>CITY OF LAS VEGAS 100 SOUTH MAIN STREET LAS VEGAS, NEVADA 89101 (702) 251-1234</p>	
<p>TENTATIVE MAP CROSS SECTIONS</p>		<p>DAY DAWN RIDGE II</p>	
<p>DESIGNED BY WVR</p>	<p>CHECKED BY SDR</p>	<p>DATE APR 10</p>	<p>SCALE 1" = 40'</p>
<p>PROJECT NO. WVR-22255</p>		<p>SHEET NO. 1 OF 1</p>	

WVR-22255
 SDR-22253
 07/12/07 PC

RECEIVED

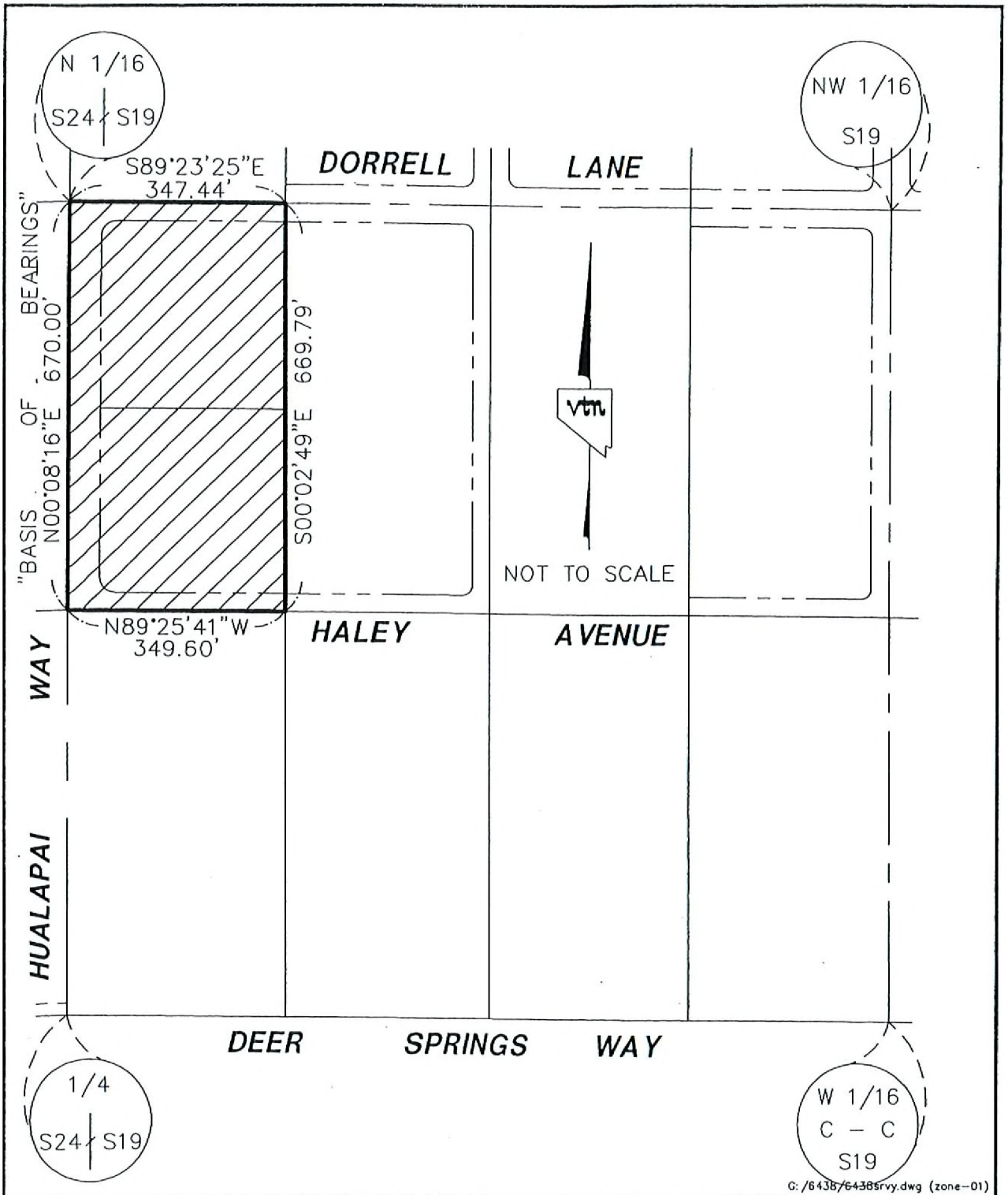

G:/6438/6438rvy.dwg (zone-01)

vtn nevada

2727 S. RAINBOW BOULEVARD
 LAS VEGAS, NEVADA 89146-5148

EXHIBIT TO ACCOMPANY
 LEGAL DESCRIPTION

ZONING

SCALE	HORZ. NONE
	VERT. NA
W.O. NO.	6438
DRAWN BY:	VCL
DATE:	5/18/05
SHEET	1 OF 1