



PLANNING & DEVELOPMENT DEPARTMENT

STATEMENT OF FINANCIAL INTEREST

Case Number: **EOT-22659** APN: 139-27-708-001 and 002

Name of Property Owner: Cielo Vista, LLC

Name of Applicant: Kaston Craft

To the best of your knowledge, does the Mayor or any member of the City Council or Planning Commission have any financial interest in this or any other property with the property owner, applicant, the property owner or applicant's general or limited partners, or an officer of their corporation or limited liability company?

Yes

No

If yes, please indicate the member of the City Council or Planning Commission who is involved and list the name(s) of the person or persons with whom the City Official holds an interest. Also list the Assessor's Parcel Number if the property in which the interest is held is different from the case parcel.

City Official: _____

Partner(s): _____

APN: _____

Signature of Property Owner: [Handwritten Signature]

Print Name: STEVEN M. HARTLEY MEMBER - CIELO VISTA, LLC

Subscribed and sworn before me

This 15th day of June, 2007

Notary Public in and for said County and State

King County, WA

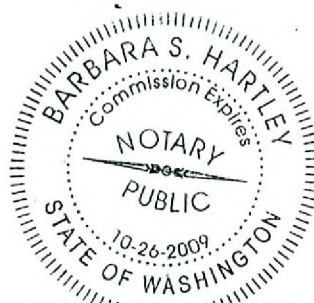

JUN 15 2007

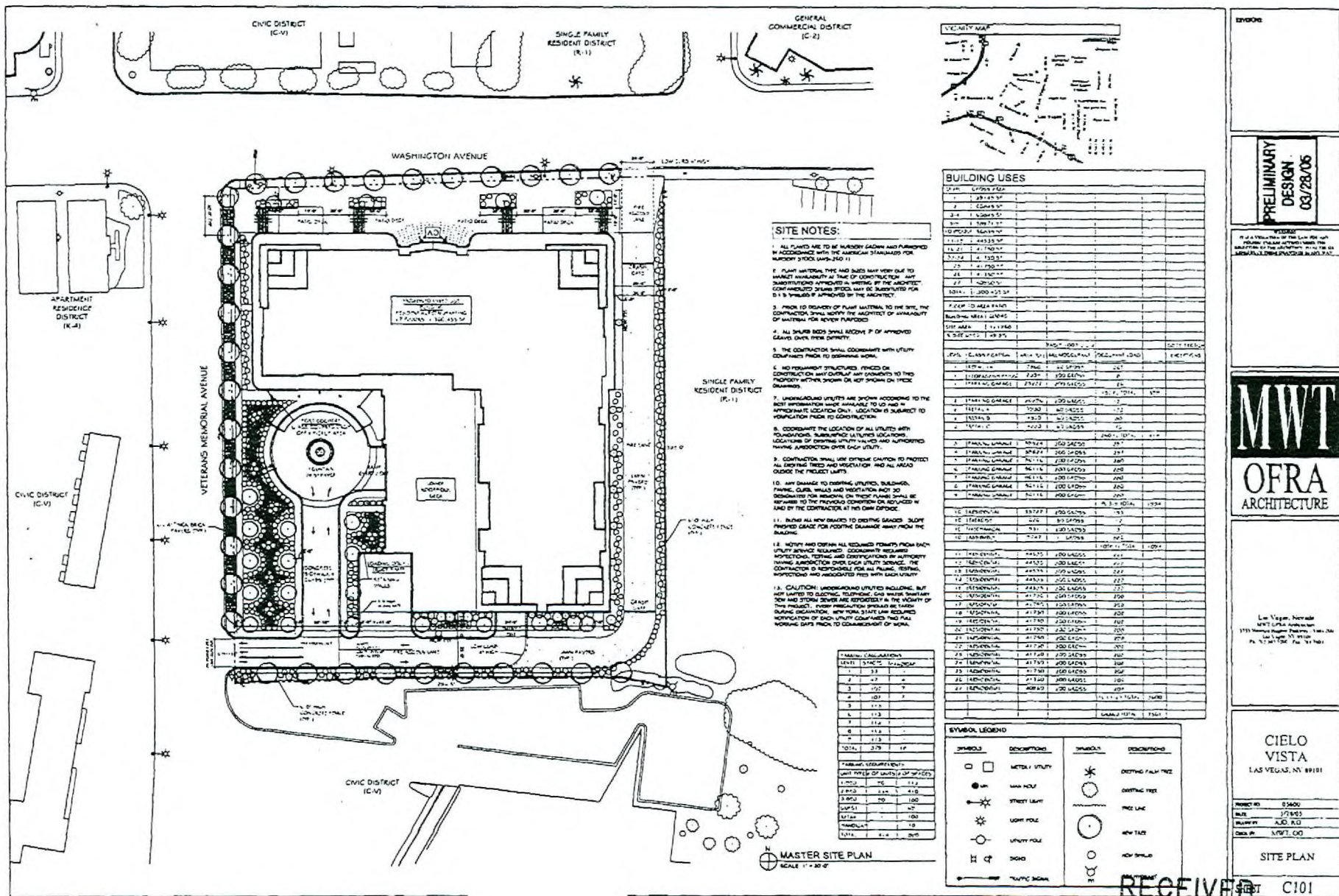

SITE NOTES:

1. ALL PLANTS ARE TO BE INVENTORY GARDEN AND FINISHED IN ACCORDANCE WITH THE AUSTRIAN STANDARDS FOR NURSERY STOCK (LAW 11).
2. PLANT MATERIALS ARE TO BE INVENTORY GARDEN AND FINISHED IN ACCORDANCE WITH THE AUSTRIAN STANDARDS FOR NURSERY STOCK (LAW 11).
3. PRIOR TO DELIVERY OF PLANT MATERIAL TO THE SITE, THE CONTRACTOR SHALL VERIFY THE ARCHITECT OF AVAILABILITY OF MATERIAL FOR NURSERY STOCK.
4. ALL SHURB BEDS SHALL RECEIVE P OF APPROVED GRAVE COVER PER DEFINITY.
5. THE CONTRACTOR SHALL COORDINATE WITH UTILITY COMPANIES PRIOR TO BEGINNING WORK.
6. NO PERMANENT STRUCTURES, TREES OR CONSTRUCTION ON ANY OVERLAP ARE ALLOWED TO THIS PROPERTY UNLESS SHOWN OR NOT SHOWN ON THESE DRAWINGS.
7. UNDERGROUND UTILITIES ARE SHOWN ACCORDING TO THE BEST INFORMATION MADE AVAILABLE TO US AND IS APPROVED TO LOCATE ONLY. LOCATION IS SUBJECT TO VERIFICATION PRIOR TO CONSTRUCTION.
8. COORDINATE THE LOCATION OF ALL UTILITIES WITH FOUNDATIONS, SUBSEQUENT UTILITIES LOCATIONS, LOCATIONS OF EXISTING UTILITY VALVES AND APPROVED TRAVEL JURISDICTION OVER EACH UTILITY.
9. CONTRACTOR SHALL USE EXTREME CAUTION TO PROTECT ALL EXISTING TREES AND VEGETATION AND ALL AREAS OUTSIDE THE PROJECT LIMITS.
10. ANY DAMAGE TO EXISTING UTILITIES, BUILDINGS, FENCES, CURBS, WALLS AND VEGETATION MUST BE REPAIRED FOR REPAIRS ON THESE PLANS SHALL BE REPAIRED TO THE PREVIOUS CONDITION OR IMPROVED AS SHOWN BY THE CONTRACTOR AT HIS OWN EXPENSE.
11. IN ALL AREAS SUBJECT TO EXISTING GRADES, SHOWN FINISHED GRADE FOR ADDITIONAL DAMAGE AWAY FROM THE BUILDING.
12. VERIFY AND OBTAIN ALL REQUIRED PERMITS FROM EACH UTILITY SERVICE REQUIRED. COORDINATE REQUIRED INSPECTIONS, TESTS AND CERTIFICATIONS BY AUTHORITY HAVING JURISDICTION OVER EACH UTILITY SERVICE. THE CONTRACTOR IS RESPONSIBLE FOR ALL PLUMB, ELECTRICAL, MECHANICAL AND ASSOCIATED FEES WITH EACH UTILITY SERVICE.
13. CAUTION: UNDERGROUND UTILITIES INCLUDING, BUT NOT LIMITED TO ELECTRIC, TELEPHONE, GAS WATER, SEWERAGE AND STORM SEWER ARE LOCATED IN THE VICINITY OF THIS PROJECT. PRIOR TO CONSTRUCTION, THE CONTRACTOR SHALL OBTAIN ALL REQUIRED NOTIFICATION OF EACH UTILITY COMPANY AND SHALL NOTIFY EACH PARTY TO COORDINATION OF WORK.

FINISHED CALCULATIONS

1	1.00	1.00	1.00
2	1.00	1.00	1.00
3	1.00	1.00	1.00
4	1.00	1.00	1.00
5	1.00	1.00	1.00
6	1.00	1.00	1.00
7	1.00	1.00	1.00
8	1.00	1.00	1.00
9	1.00	1.00	1.00
10	1.00	1.00	1.00
11	1.00	1.00	1.00
12	1.00	1.00	1.00
13	1.00	1.00	1.00
14	1.00	1.00	1.00
15	1.00	1.00	1.00
16	1.00	1.00	1.00
17	1.00	1.00	1.00
18	1.00	1.00	1.00
19	1.00	1.00	1.00
20	1.00	1.00	1.00
21	1.00	1.00	1.00
22	1.00	1.00	1.00
23	1.00	1.00	1.00
24	1.00	1.00	1.00
25	1.00	1.00	1.00
26	1.00	1.00	1.00
27	1.00	1.00	1.00
28	1.00	1.00	1.00
29	1.00	1.00	1.00
30	1.00	1.00	1.00
31	1.00	1.00	1.00
32	1.00	1.00	1.00
33	1.00	1.00	1.00
34	1.00	1.00	1.00
35	1.00	1.00	1.00
36	1.00	1.00	1.00
37	1.00	1.00	1.00
38	1.00	1.00	1.00
39	1.00	1.00	1.00
40	1.00	1.00	1.00
41	1.00	1.00	1.00
42	1.00	1.00	1.00
43	1.00	1.00	1.00
44	1.00	1.00	1.00
45	1.00	1.00	1.00
46	1.00	1.00	1.00
47	1.00	1.00	1.00
48	1.00	1.00	1.00
49	1.00	1.00	1.00
50	1.00	1.00	1.00
TOTAL	378	11	11

BUILDING USES

AREA	AREA (SQ FT)	AREA (SQ METERS)	AREA (SQ FEET)	AREA (SQ METERS)
1. GARAGE	1,200	111.48	1,200	111.48
2. OFFICE	1,200	111.48	1,200	111.48
3. OFFICE	1,200	111.48	1,200	111.48
4. OFFICE	1,200	111.48	1,200	111.48
5. OFFICE	1,200	111.48	1,200	111.48
6. OFFICE	1,200	111.48	1,200	111.48
7. OFFICE	1,200	111.48	1,200	111.48
8. OFFICE	1,200	111.48	1,200	111.48
9. OFFICE	1,200	111.48	1,200	111.48
10. OFFICE	1,200	111.48	1,200	111.48
11. OFFICE	1,200	111.48	1,200	111.48
12. OFFICE	1,200	111.48	1,200	111.48
13. OFFICE	1,200	111.48	1,200	111.48
14. OFFICE	1,200	111.48	1,200	111.48
15. OFFICE	1,200	111.48	1,200	111.48
16. OFFICE	1,200	111.48	1,200	111.48
17. OFFICE	1,200	111.48	1,200	111.48
18. OFFICE	1,200	111.48	1,200	111.48
19. OFFICE	1,200	111.48	1,200	111.48
20. OFFICE	1,200	111.48	1,200	111.48
21. OFFICE	1,200	111.48	1,200	111.48
22. OFFICE	1,200	111.48	1,200	111.48
23. OFFICE	1,200	111.48	1,200	111.48
24. OFFICE	1,200	111.48	1,200	111.48
25. OFFICE	1,200	111.48	1,200	111.48
26. OFFICE	1,200	111.48	1,200	111.48
27. OFFICE	1,200	111.48	1,200	111.48
28. OFFICE	1,200	111.48	1,200	111.48
29. OFFICE	1,200	111.48	1,200	111.48
30. OFFICE	1,200	111.48	1,200	111.48
31. OFFICE	1,200	111.48	1,200	111.48
32. OFFICE	1,200	111.48	1,200	111.48
33. OFFICE	1,200	111.48	1,200	111.48
34. OFFICE	1,200	111.48	1,200	111.48
35. OFFICE	1,200	111.48	1,200	111.48
36. OFFICE	1,200	111.48	1,200	111.48
37. OFFICE	1,200	111.48	1,200	111.48
38. OFFICE	1,200	111.48	1,200	111.48
39. OFFICE	1,200	111.48	1,200	111.48
40. OFFICE	1,200	111.48	1,200	111.48
41. OFFICE	1,200	111.48	1,200	111.48
42. OFFICE	1,200	111.48	1,200	111.48
43. OFFICE	1,200	111.48	1,200	111.48
44. OFFICE	1,200	111.48	1,200	111.48
45. OFFICE	1,200	111.48	1,200	111.48
46. OFFICE	1,200	111.48	1,200	111.48
47. OFFICE	1,200	111.48	1,200	111.48
48. OFFICE	1,200	111.48	1,200	111.48
49. OFFICE	1,200	111.48	1,200	111.48
50. OFFICE	1,200	111.48	1,200	111.48

SYMBOL LEGEND

SYMBOL	DESCRIPTION	SYMBOL	DESCRIPTION
□	METAL UTILITY	*	EXISTING PALM TREE
○	MAN HOLE	○	EXISTING TREE
⊙	STREET LIGHT	—	PIPE LINE
⊕	LIGHT POLE	○	NEW TREE
⊖	UTILITY POLE	○	NEW SHrub
⊗	SEWER	○	
⊘	TRAFFIC SIGNAL	○	

PRELIMINARY DESIGN 03/28/06

MWT OFRA ARCHITECTURE

Las Vegas, Nevada
1775 North Boulder Parkway, Suite 200
Las Vegas, NV 89102
P: 702.735.7400 F: 702.735.7401

CIELO VISTA
LAS VEGAS, NV 89111

PROJECT NO: E5400
DATE: 07/05
DRAWN BY: AJD, KJD
CHECKED BY: MWT, OJD

SITE PLAN

RECEIVED
C101

EOT-22659
08-01-07 CC

JUN 15 2007