

SECTION A

SCALE: 1/8" = 1'-0"



Startec
 Startec Consulting Inc.
 224 W. 19th St.
 New York, NY 10011
 Tel: 212.258.4115
 Fax: 212.258.4142
 www.startec.com

Developed by
FAIRFIELD RESIDENTIAL, LLC
 CENTENNIAL CONDOMINIUMS



Project Number:	TS6100435
File Name:	09-13-07-TMP.dwg
Drawn by:	CLV
Checked by:	CLV
Scale:	1/8" = 1'-0"
Revision:	0
Sheet:	02 of 04

RECEIVED
 JUL 30 2007

TMP-23525
09/13/07 PC

TENTATIVE MAP
 SECTIONS AND DETAILS



NO.	DATE	BY	CHKD	APP'D

Client: FAIRFIELD RESIDENTIAL, LLC
 CENTENNIAL CONDOMINIUMS

TENTATIVE MAP
 SECTIONS AND DETAILS

Printed Scale



Project Number:	185100435		
File Name:	20422-10 Plans.dwg		
DATE	TIME	DATE	TIME
Drawing No. TM 3			
CLVS			
Revision	Sheet		
0			

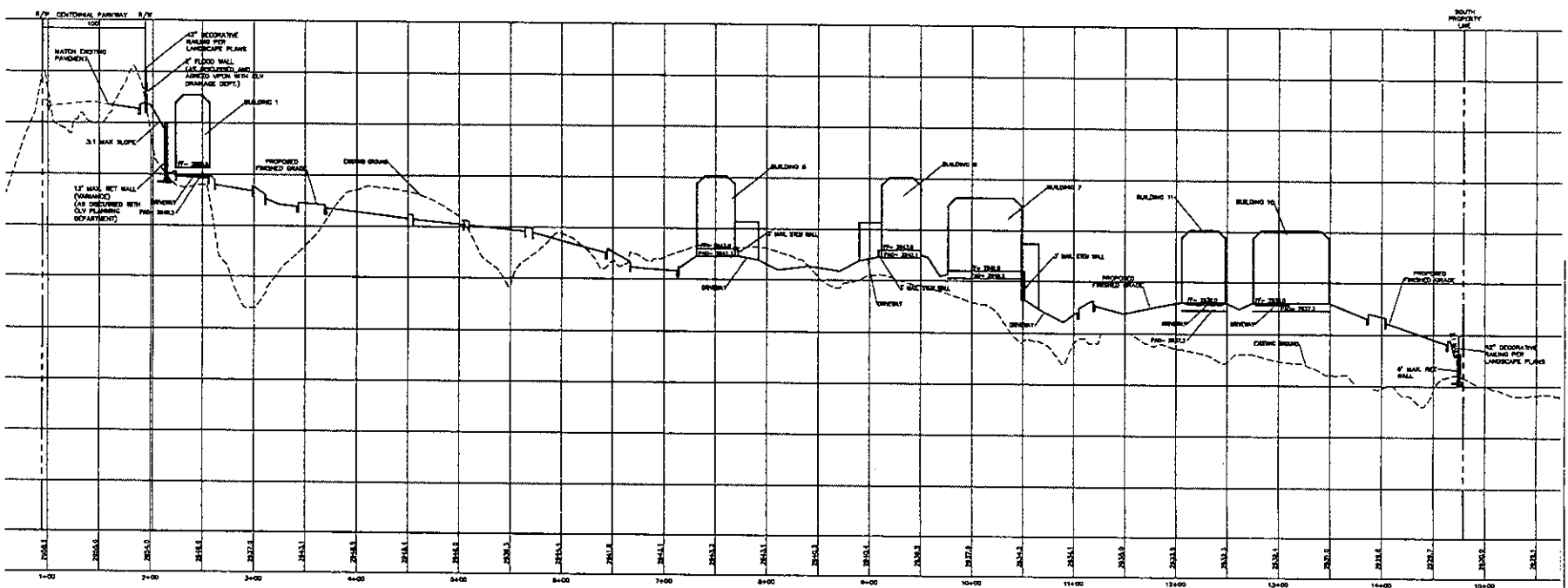

SECTION B
 SEE SHEET - 17
 SHEET - 7

RECEIVED
 JUL 9 6 2007

TMP-23525
09/13/07 PC

1/17/2007 10:41 AM C:\Users\matt\Documents\Projects\20422-10\20422-10.dwg

-42" HIGH TUBULAR
STEEL RAILING @ 4"
ON CENTER OR
EQUAL AS PER
APPROVED
LANDSCAPE PLANS

-**COLOR TO BE
SOFT GREEN OR AS
APPROVED PER
LANDSCAPE PLANS

-**COLOR TO MATCH
BUILDING PATIOS
ALONG CENTENNIAL
PKWY.

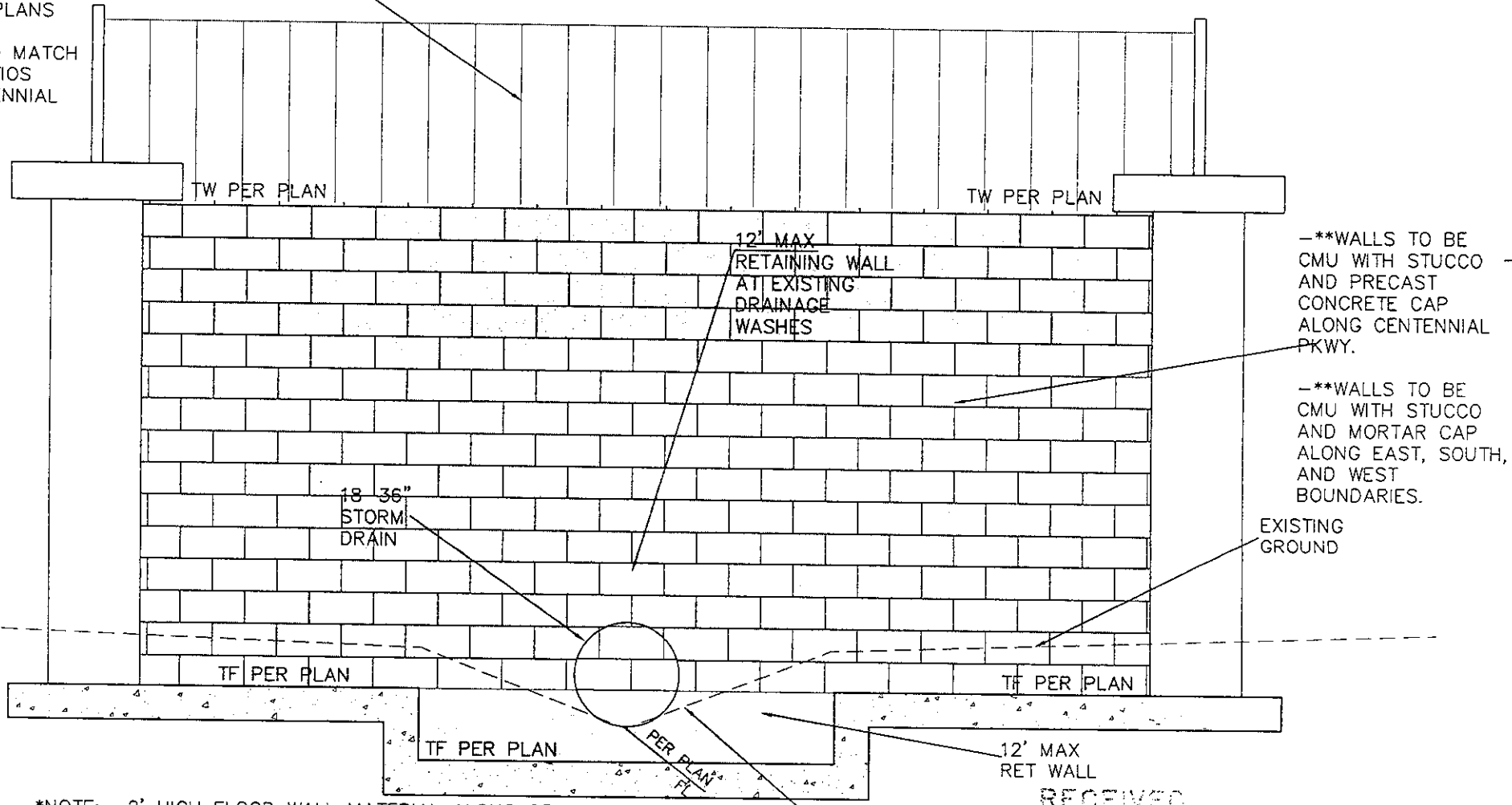

-**WALLS TO BE
CMU WITH STUCCO
AND PRECAST
CONCRETE CAP
ALONG CENTENNIAL
PKWY.

-**WALLS TO BE
CMU WITH STUCCO
AND MORTAR CAP
ALONG EAST, SOUTH,
AND WEST
BOUNDARIES.

EXISTING
GROUND

*NOTE: 2' HIGH FLOOD WALL MATERIAL ALONG CENTENNIAL
PARKWAY TO BE SPLIT FACE OR EQUAL PER APPROVED
LANDSCAPE PLANS.

**ALL MATERIAL, TEXTURES, AND COLORS OF PERIMETER WALLS
ARE SUBJECT TO CHANGE PER APPROVED LANDSCAPE PLANS.

RETAINING WALL DETAIL

NTS

6
TM4

TMP-23525
09/13/07 PC