



PLANNING & DEVELOPMENT DEPARTMENT

STATEMENT OF FINANCIAL INTEREST

Case Number: **VAR-21632** APN: 163-03-501-003

Name of Property Owner: Charles & Virginia Ghormley, Trustees of the RMH Trust

Name of Applicant: Charles Ghormley

Name of Representative: Nevada Power Company-Michelle Baltz

To the best of your knowledge, does the Mayor or any member of the City Council or Planning Commission have any financial interest in this or any other property with the property owner, applicant, the property owner or applicant's general or limited partners, or an officer of their corporation or limited liability company?

Yes

No

If yes, please indicate the member of the City Council or Planning Commission who is involved and list the name(s) of the person or persons with whom the City Official holds an interest. Also list the Assessor's Parcel Number if the property in which the interest is held is different from the case parcel.

City Official: _____

Partner(s): _____

APN: _____

Signature of Property Owner: *Charles Ghormley*

Print Name: Charles Ghormley

Subscribed and sworn before me

This 26th day of April, 2007

Mario Gomez
Notary Public in and for said County and State
MARIO Gomez



NO.	DATE	BY	REVISION

SITE PLAN
CHARLESTON SUBSTATION

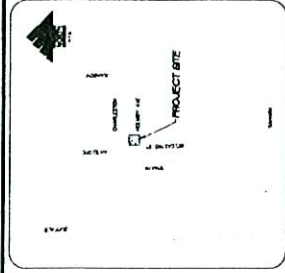

LANDSCAPE MATERIAL SCHEDULE

SIC	DESCRIPTION	BOTANICAL NAME	QUANTITY	SYMBOL	COMMENT
1" HOD	OLD SHAWT WASH	N/A	30339 SF	[Symbol]	3" HOD
3 SIL	RED WOOD	HEPTAPALIS PARVIFLORA	103 LA	[Symbol]	
14" B&A	SEVEN OAK PALM	WALBERTHIA SEBIFERA	53 LA	[Symbol]	4" HOD/14" H&A

NOTE:
 THESE DIMENSIONS ARE CONCEPTUAL IN NATURE AND
 INTENDED TO PROVIDE A GENERAL IDEA OF THE
 SITUATION. ALL DIMENSIONS ARE TO FACE UNLESS
 OTHERWISE NOTED. DIMENSIONS MAY VARY DUE TO SITE SPECIFIC
 CONDITIONS. CITY OF LAS VEGAS SPECIFICATIONS.

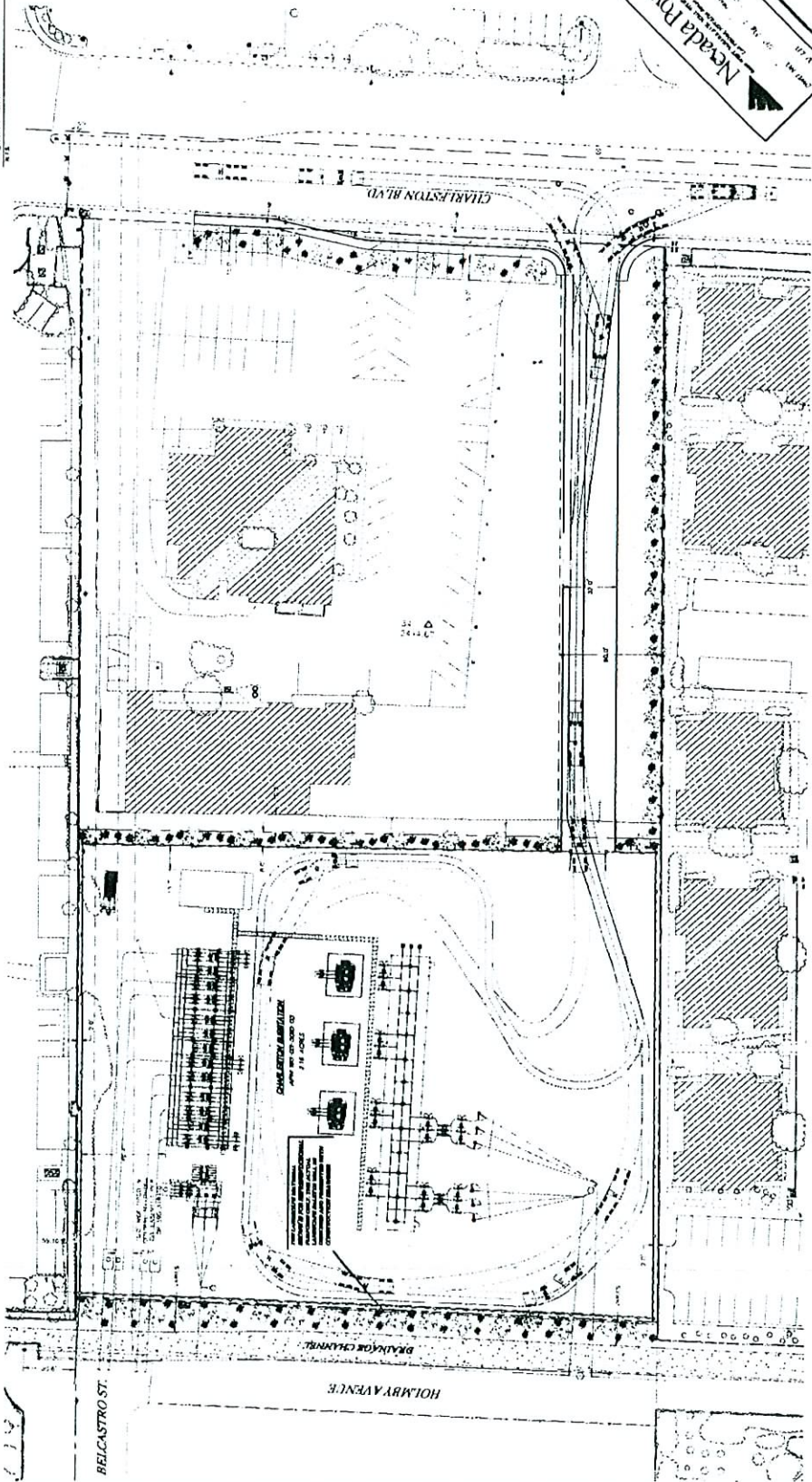

RECEIVED
Fig 1

APR 01 2007

VAR-21632
05/24/07 PC