

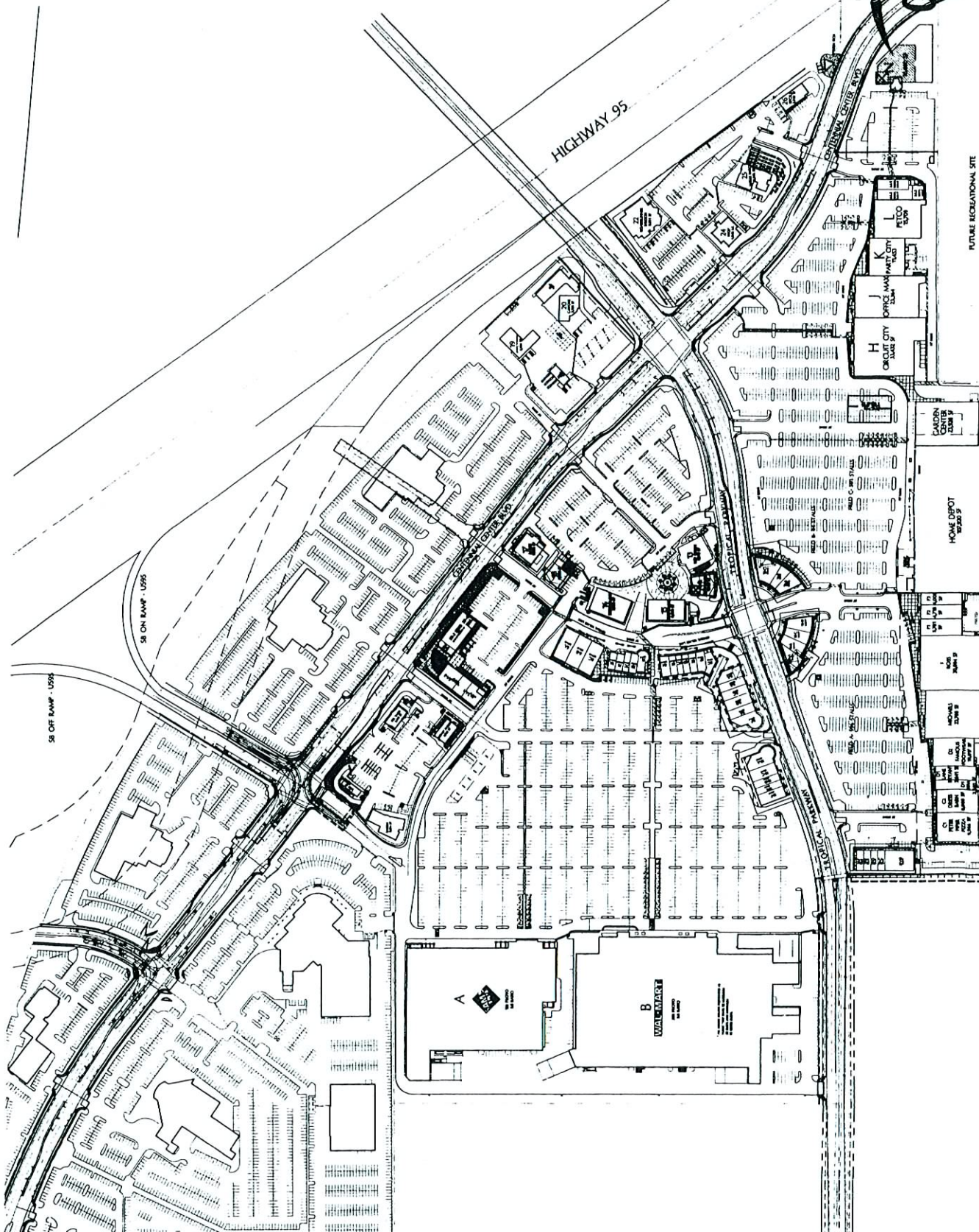

RECEIVED  
MAY 14 2007

SUP-21954  
06/28/07 PC



**EQUIPMENT LEGEND:**

- (1) 12 BURNER GAS STOVE
- (2) 12" WIDE SINK
- (3) 12" WIDE SINK
- (4) 12" WIDE SINK
- (5) 12" WIDE SINK
- (6) 12" WIDE SINK
- (7) 12" WIDE SINK
- (8) 12" WIDE SINK
- (9) 12" WIDE SINK
- (10) 12" WIDE SINK
- (11) 12" WIDE SINK
- (12) 12" WIDE SINK
- (13) 12" WIDE SINK
- (14) 12" WIDE SINK
- (15) 12" WIDE SINK
- (16) 12" WIDE SINK
- (17) 12" WIDE SINK
- (18) 12" WIDE SINK
- (19) 12" WIDE SINK
- (20) 12" WIDE SINK
- (21) 12" WIDE SINK
- (22) 12" WIDE SINK
- (23) 12" WIDE SINK
- (24) 12" WIDE SINK
- (25) 12" WIDE SINK
- (26) 12" WIDE SINK
- (27) 12" WIDE SINK
- (28) 12" WIDE SINK
- (29) 12" WIDE SINK
- (30) 12" WIDE SINK
- (31) 12" WIDE SINK
- (32) 12" WIDE SINK
- (33) 12" WIDE SINK
- (34) 12" WIDE SINK
- (35) 12" WIDE SINK
- (36) 12" WIDE SINK
- (37) 12" WIDE SINK
- (38) 12" WIDE SINK
- (39) 12" WIDE SINK

**WALL LEGEND:**

- (1) 1/2" GA. STEEL STUDS AT 24" O.C.
- (2) 1/2" GA. STEEL STUDS AT 24" O.C.
- (3) 1/2" GA. STEEL STUDS AT 24" O.C.
- (4) 1/2" GA. STEEL STUDS AT 24" O.C.
- (5) 1/2" GA. STEEL STUDS AT 24" O.C.
- (6) 1/2" GA. STEEL STUDS AT 24" O.C.
- (7) 1/2" GA. STEEL STUDS AT 24" O.C.
- (8) 1/2" GA. STEEL STUDS AT 24" O.C.
- (9) 1/2" GA. STEEL STUDS AT 24" O.C.
- (10) 1/2" GA. STEEL STUDS AT 24" O.C.
- (11) 1/2" GA. STEEL STUDS AT 24" O.C.
- (12) 1/2" GA. STEEL STUDS AT 24" O.C.
- (13) 1/2" GA. STEEL STUDS AT 24" O.C.
- (14) 1/2" GA. STEEL STUDS AT 24" O.C.
- (15) 1/2" GA. STEEL STUDS AT 24" O.C.
- (16) 1/2" GA. STEEL STUDS AT 24" O.C.
- (17) 1/2" GA. STEEL STUDS AT 24" O.C.
- (18) 1/2" GA. STEEL STUDS AT 24" O.C.
- (19) 1/2" GA. STEEL STUDS AT 24" O.C.
- (20) 1/2" GA. STEEL STUDS AT 24" O.C.
- (21) 1/2" GA. STEEL STUDS AT 24" O.C.
- (22) 1/2" GA. STEEL STUDS AT 24" O.C.
- (23) 1/2" GA. STEEL STUDS AT 24" O.C.
- (24) 1/2" GA. STEEL STUDS AT 24" O.C.
- (25) 1/2" GA. STEEL STUDS AT 24" O.C.
- (26) 1/2" GA. STEEL STUDS AT 24" O.C.
- (27) 1/2" GA. STEEL STUDS AT 24" O.C.
- (28) 1/2" GA. STEEL STUDS AT 24" O.C.
- (29) 1/2" GA. STEEL STUDS AT 24" O.C.
- (30) 1/2" GA. STEEL STUDS AT 24" O.C.
- (31) 1/2" GA. STEEL STUDS AT 24" O.C.
- (32) 1/2" GA. STEEL STUDS AT 24" O.C.
- (33) 1/2" GA. STEEL STUDS AT 24" O.C.
- (34) 1/2" GA. STEEL STUDS AT 24" O.C.
- (35) 1/2" GA. STEEL STUDS AT 24" O.C.
- (36) 1/2" GA. STEEL STUDS AT 24" O.C.
- (37) 1/2" GA. STEEL STUDS AT 24" O.C.
- (38) 1/2" GA. STEEL STUDS AT 24" O.C.
- (39) 1/2" GA. STEEL STUDS AT 24" O.C.
- (40) 1/2" GA. STEEL STUDS AT 24" O.C.
- (41) 1/2" GA. STEEL STUDS AT 24" O.C.
- (42) 1/2" GA. STEEL STUDS AT 24" O.C.
- (43) 1/2" GA. STEEL STUDS AT 24" O.C.
- (44) 1/2" GA. STEEL STUDS AT 24" O.C.
- (45) 1/2" GA. STEEL STUDS AT 24" O.C.
- (46) 1/2" GA. STEEL STUDS AT 24" O.C.
- (47) 1/2" GA. STEEL STUDS AT 24" O.C.
- (48) 1/2" GA. STEEL STUDS AT 24" O.C.
- (49) 1/2" GA. STEEL STUDS AT 24" O.C.
- (50) 1/2" GA. STEEL STUDS AT 24" O.C.
- (51) 1/2" GA. STEEL STUDS AT 24" O.C.
- (52) 1/2" GA. STEEL STUDS AT 24" O.C.
- (53) 1/2" GA. STEEL STUDS AT 24" O.C.
- (54) 1/2" GA. STEEL STUDS AT 24" O.C.
- (55) 1/2" GA. STEEL STUDS AT 24" O.C.
- (56) 1/2" GA. STEEL STUDS AT 24" O.C.
- (57) 1/2" GA. STEEL STUDS AT 24" O.C.
- (58) 1/2" GA. STEEL STUDS AT 24" O.C.
- (59) 1/2" GA. STEEL STUDS AT 24" O.C.
- (60) 1/2" GA. STEEL STUDS AT 24" O.C.
- (61) 1/2" GA. STEEL STUDS AT 24" O.C.
- (62) 1/2" GA. STEEL STUDS AT 24" O.C.
- (63) 1/2" GA. STEEL STUDS AT 24" O.C.
- (64) 1/2" GA. STEEL STUDS AT 24" O.C.
- (65) 1/2" GA. STEEL STUDS AT 24" O.C.
- (66) 1/2" GA. STEEL STUDS AT 24" O.C.
- (67) 1/2" GA. STEEL STUDS AT 24" O.C.
- (68) 1/2" GA. STEEL STUDS AT 24" O.C.
- (69) 1/2" GA. STEEL STUDS AT 24" O.C.
- (70) 1/2" GA. STEEL STUDS AT 24" O.C.
- (71) 1/2" GA. STEEL STUDS AT 24" O.C.
- (72) 1/2" GA. STEEL STUDS AT 24" O.C.
- (73) 1/2" GA. STEEL STUDS AT 24" O.C.
- (74) 1/2" GA. STEEL STUDS AT 24" O.C.
- (75) 1/2" GA. STEEL STUDS AT 24" O.C.
- (76) 1/2" GA. STEEL STUDS AT 24" O.C.
- (77) 1/2" GA. STEEL STUDS AT 24" O.C.
- (78) 1/2" GA. STEEL STUDS AT 24" O.C.
- (79) 1/2" GA. STEEL STUDS AT 24" O.C.
- (80) 1/2" GA. STEEL STUDS AT 24" O.C.
- (81) 1/2" GA. STEEL STUDS AT 24" O.C.
- (82) 1/2" GA. STEEL STUDS AT 24" O.C.
- (83) 1/2" GA. STEEL STUDS AT 24" O.C.
- (84) 1/2" GA. STEEL STUDS AT 24" O.C.
- (85) 1/2" GA. STEEL STUDS AT 24" O.C.
- (86) 1/2" GA. STEEL STUDS AT 24" O.C.
- (87) 1/2" GA. STEEL STUDS AT 24" O.C.
- (88) 1/2" GA. STEEL STUDS AT 24" O.C.
- (89) 1/2" GA. STEEL STUDS AT 24" O.C.
- (90) 1/2" GA. STEEL STUDS AT 24" O.C.
- (91) 1/2" GA. STEEL STUDS AT 24" O.C.
- (92) 1/2" GA. STEEL STUDS AT 24" O.C.
- (93) 1/2" GA. STEEL STUDS AT 24" O.C.
- (94) 1/2" GA. STEEL STUDS AT 24" O.C.
- (95) 1/2" GA. STEEL STUDS AT 24" O.C.
- (96) 1/2" GA. STEEL STUDS AT 24" O.C.
- (97) 1/2" GA. STEEL STUDS AT 24" O.C.
- (98) 1/2" GA. STEEL STUDS AT 24" O.C.
- (99) 1/2" GA. STEEL STUDS AT 24" O.C.
- (100) 1/2" GA. STEEL STUDS AT 24" O.C.

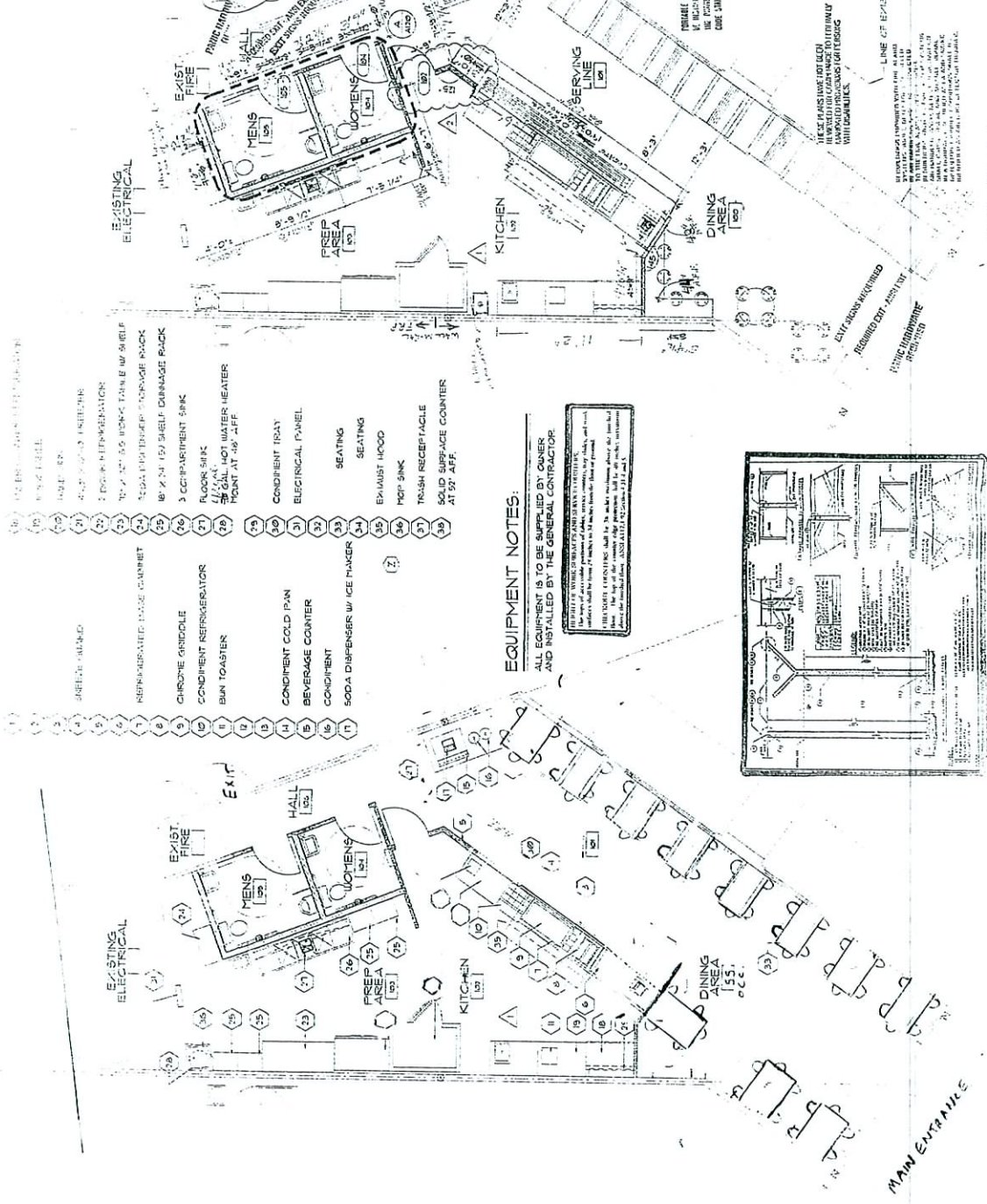

**EQUIPMENT NOTES:**

ALL EQUIPMENT IS TO BE SUPPLIED BY OWNER AND INSTALLED BY THE GENERAL CONTRACTOR.

THESE PLANS HAVE NOT BEEN REVIEWED FOR COMPLIANCE WITH LOCAL ORDINANCES.

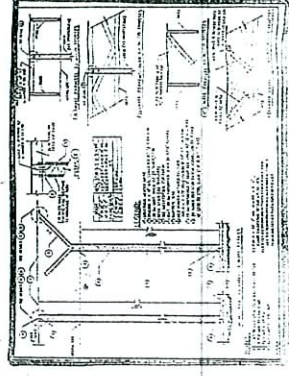

**EQUIPMENT PLAN**

SCALE: 1/8" = 1'-0"



**FLOOR PLAN**

SCALE: 1/8" = 1'-0"



SUP-21954

Name	Sq.Ft.
Sam's Club #6257	137,881
Wal-Mart #2884	210,751
Big O Tires, Inc.	5,366
Terrible Herbst, Inc., a NV Corp.	6,500
Roadrunner Saloon	7,500
IHOP #1617	4,002
Wells Fargo Bank - 103632 Mac#A0149-061	5,553
KFC Store ID X527062 - Site #12-1717	3,500
Montana Meat Company	4,500
Starbucks Coffee Co. #6568	1,489
The Honey Baked Ham Co. Store #1105	2,525
Del Taco #871	2,303
Dotty's	3,686
Fanco	2,730
Centennial Quilts	1,704
Sally Beauty Co. #2683	1,592
Payless Shoe Source #4281RL	2,536
Red Robin Gourmet Burgers	6,500
Vallarta's Inc.	3,998
Max & Erma's	6,500
Mike's Restaurant	7,347
Sushi Loca	4,000
Desert Springs / Nationwide Pool	4,988
MoneyTree, Inc. - Store #089	2,748
Armed Forces Career Center	999
CSK Auto, Inc. #4160	5,581
Cumorah Credit Union	3,500
Hallmark Retail Inc. #767	4,248
Liberty Realty	3,874
Centennial Hills Chiropractic	1,068
Allstate Insurance	1,182
EB Games #3519	1,006
Absolute Foot Care Specialists	1,325
Kwik Kopy Business Center #150	1,669
Big Apple Cleaners	1,209
Elegant Nails	1,001
Supercuts, Inc. #9528	1,106
Dairy Queen	1,211
Port of Subs	1,670
Market Grille Cafe	1,471
Baja Fresh Mexican Grill	2,330
Designer Tan	1,992
Mark Rich's New York Pizza & Pasta	2,111
Wok's Inn	2,494
Vacant	2073
RadioShack #019491	2,892
Timeless Image RX, dba Solana Spa	2,320

Centennial Family Dental	2,387
Advanced Eyecare Center	2,166
3 Day Blinds Inc.	2,450
L&L Hawaiian Barbecue	1,747
Atlanta Bread	3,996
Centennial Hills Salon & Day Spa	6,218
Vacant	1,241
H & R Block	1,235
Claire's Boutique #5941	1,272
Peter Piper Pizza	9,966
Dress Barn/Dress Barn Woman	8,008
Lane Bryant #6806	5,641
Bath & Body Works, Inc. #42017309	2,540
Famous Footwear #2138	10,017
Dior Fine Furniture, Inc., a NV Corp.	4,488
Vacant	5,983
Premier Maytag	4,000
Best Mattress	2,762
Sideline Sports	3,386
Nationwide Insurance	1,266
Home Depot Garden Center	23,938
Michaels Stores, Inc. #2777	23,795
Ross Stores, Inc. #542	30,094
Home Depot USA, Inc. #3305	107,920
Circuit City #3425	33,432
OfficeMax, Inc. Store #1225	23,364
Party City Corp.	11,453
Petco #1105	15,709
	839,005

4,777 parking  
spaces for  
the entire center



SUP-21954 - APPLICANT: JOSEPH ANTHONY PIERRO - OWNER: CENTENNIAL CENTRE, LLC  
7920 WEST TROPICAL PARKWAY, SUITE #170  
JUNE 28, 2007 PLANNING COMMISSION

06/13/07