



PLANNING & DEVELOPMENT DEPARTMENT

STATEMENT OF FINANCIAL INTEREST

Case Number: VAR-23144 APN: 139-31-201-004 & 003

Name of Property Owner: Ernest A. Becker III and Mary Elizabeth Becker Family Trust

Name of Applicant: Arbys

Name of Representative: John Burke Architect

To the best of your knowledge, does the Mayor or any member of the City Council or Planning Commission have any financial interest in this or any other property with the property owner, applicant, the property owner or applicant's general or limited partners, or an officer of their corporation or limited liability company?

Yes No

If yes, please indicate the member of the City Council or Planning Commission who is involved and list the name(s) of the person or persons with whom the City Official holds an interest. Also list the Assessor's Parcel Number if the property in which the interest is held is different from the case parcel.

City Official: SAM DUNNAM

Partner(s): John Burke

APN: 162-32-202-009

Signature of Property Owner: Mary E. Becker
Print Name: Mary E. Becker, Trustee

Subscribed and sworn before me

This 9th day of July, 2007

Rachelle Papon
Notary Public in and for said County and State
CLARK NEVADA



MEADOWS

DECATUR

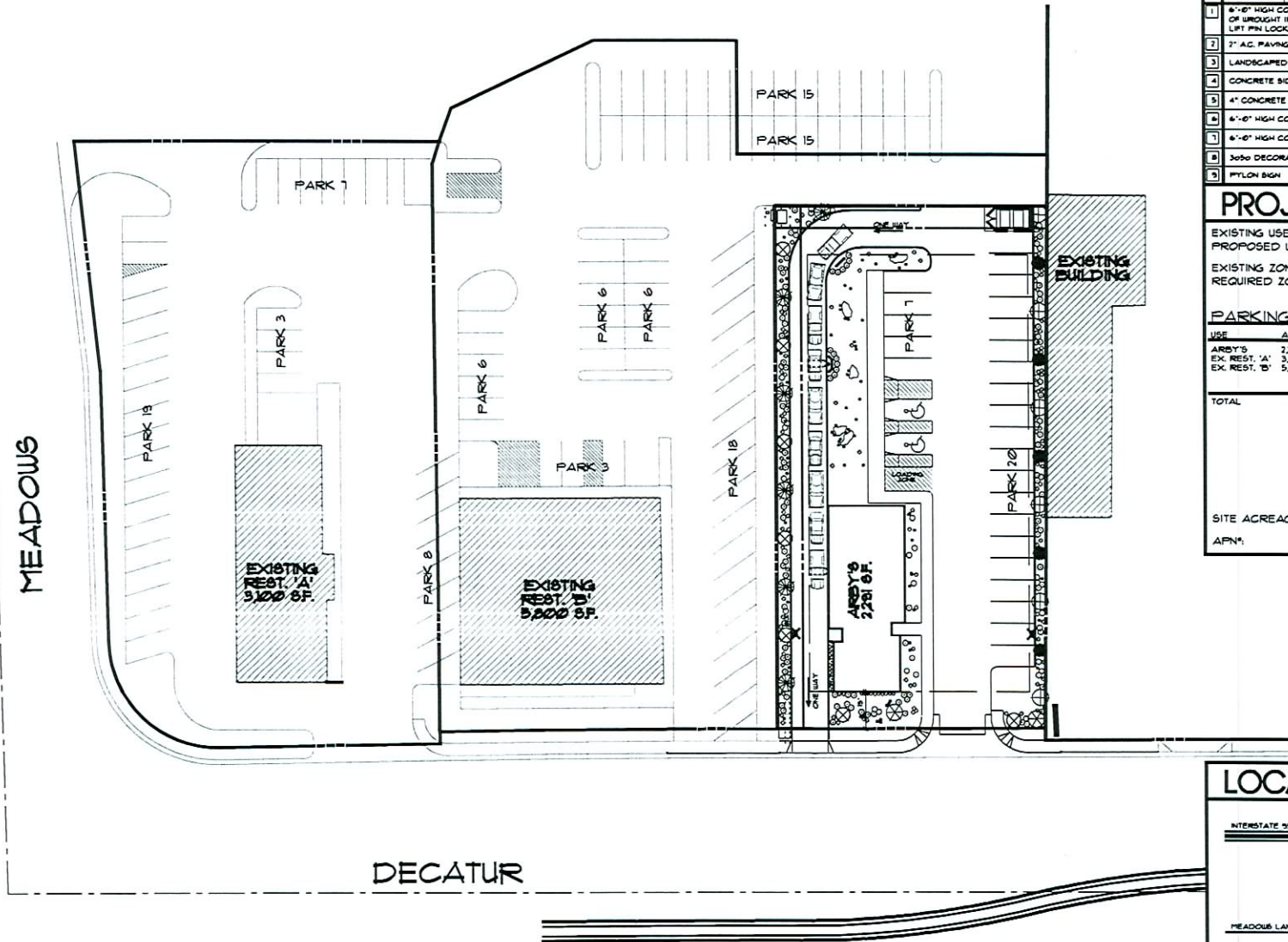

1

SITE/LANDSCAPING PLAN

SCALE: 1" = 20'-0"

KEYNOTES

| # | description |
|---|---|
| 1 | 6'-0" HIGH CONCRETE BLOCK TRASH ENCLOSURE WITH PAIR OF WROUGHT IRON GATES WITH STAMPED METAL BACKING AND LIFT PIN LOCKLATCH |
| 2 | 7" AC. PAVING |
| 3 | LANDSCAPED AREA - BY OTHERS |
| 4 | CONCRETE SIDEWALK CURB & GUTTER AS PER CITY OF HENDERSON |
| 5 | 4" CONCRETE SIDEWALK W/ROCKBALL FINISH |
| 6 | 6'-0" HIGH CONCRETE BLOCK WALL |
| 7 | 6'-0" HIGH CONCRETE BLOCK WALL |
| 8 | 3050 DECORATIVE WROUGHT IRON MAN GATE W/ KEY LOCK & LEVER |
| 9 | PYLON SIGN |

PROJECT DATA

EXISTING USE: ARBY'S RESTAURANT
 PROPOSED USE: ARBY'S RESTAURANT
 EXISTING ZONING: C2
 REQUIRED ZONING: C2

PARKING SUMMARY

| USE | AREA | FACTOR | PK. REQ. | PK. PROVIDED |
|---------------|-----------|---------------------------------------|----------------|----------------|
| ARBY'S | 2,281 SF. | 1/100 SF. | 23 | |
| EX. REST. 'A' | 3,100 SF. | 1/100 SF. | 31 | |
| EX. REST. 'B' | 5,000 SF. | 1/50 PUBLIC - 1/100 SF. REMAINING GFA | 73 | |
| TOTAL | | | 127 SF. | 133 SF. |

SITE ACREAGE: 24,586 SF = .56 ACRES (NET)
 APN#: 139-31-201-004

LOCATION

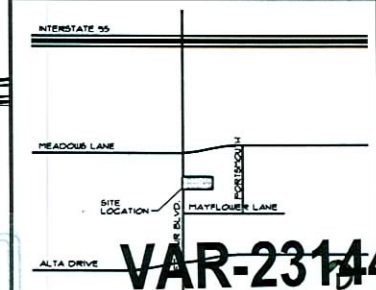

VAR-23144

08/23/07 PC

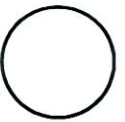

DATE: 08/23/07
 TIME: 10:00 AM
 DRAWN BY: [Signature]
 CHECKED BY: [Signature]

REVISED
 [Signature]

John C. Bunc, architect
 3471 W. COVENDO ROAD, SUITE 100, LAS VEGAS, NV, 89118 (702) 916-1863

ARBY'S REMODEL STORE #592
 315 S. DECATUR BLVD.
 CITY OF LAS VEGAS NEVADA

| DATE | PROJ. NO. | DRAWN BY | CHECKED BY |
|----------|-----------|----------|------------|
| 10/01/07 | 10001-03 | | |

sheet no. **A1.1**

RECEIVED
 JUL 11 2007