



**PLANNING & DEVELOPMENT DEPARTMENT**

**STATEMENT OF FINANCIAL INTEREST**

Case Number: **SUP-22298** APN: 125-20-114-007

Name of Property Owner: Arizona Investors, LLC

Name of Applicant: Arizona Investors, LLC

Name of Representative: Todd Kessler

To the best of your knowledge, does the Mayor or any member of the City Council or Planning Commission have any financial interest in this or any other property with the property owner, applicant, the property owner or applicant's general or limited partners, or an officer of their corporation or limited liability company?

           Yes            SM No

If yes, please indicate the member of the City Council or Planning Commission who is involved and list the name(s) of the person or persons with whom the City Official holds an interest. Also list the Assessor's Parcel Number if the property in which the interest is held is different from the case parcel.

City Official: \_\_\_\_\_

Partner(s): \_\_\_\_\_

APN: \_\_\_\_\_

Signature of Property Owner: [Handwritten Signature]

Print Name: STEVEN A. MAUL

Subscribed and sworn before me

This 30th day of May, 2007  
Marilyn Saldana  
Notary Public in and for said County and State



<b>BANK (FINANCIAL INSTITUTION)</b> Building 3,185 SF Required Parking (1/250 A.C. or 60%) 16 Spaces (Total)	<b>ARBY'S (RESTAURANT)</b> Building 3,272 SF 1,538 SF Required Parking (1/250 A.C. of Public Use, 1/200 A.C. of Retail, 1/750 A.C. of Office, 1/750 A.C. of Other, 1/750 A.C. of Other) 63 Spaces (Total) 500 Public = 33 Spaces 1,000 Retail = 10 Spaces 1,000 Office = 10 Spaces 400 Other = 40 Spaces	<b>TIAMERS (RESTAURANT/TAVERN/BAR)</b> Building 3,272 SF 1,538 SF Required Parking (1/250 A.C. of Public Use, 1/200 A.C. of Retail, 1/750 A.C. of Office, 1/750 A.C. of Other, 1/750 A.C. of Other) 61 Spaces (Total) 500 Public = 33 Spaces 1,000 Retail = 10 Spaces 1,000 Office = 10 Spaces 400 Other = 40 Spaces	<b>FUTURE RETAIL (CONVENIENCE STORE)</b> Building 4,246 SF Required Parking (1/250 A.C. or 60%) 17 Spaces (Total)	<b>CASH AMERICA (RETAIL)</b> Building 6,472 SF Required Parking (1/715 A.C. or 60%) 37 Spaces (Total)
---	--	--	--	--

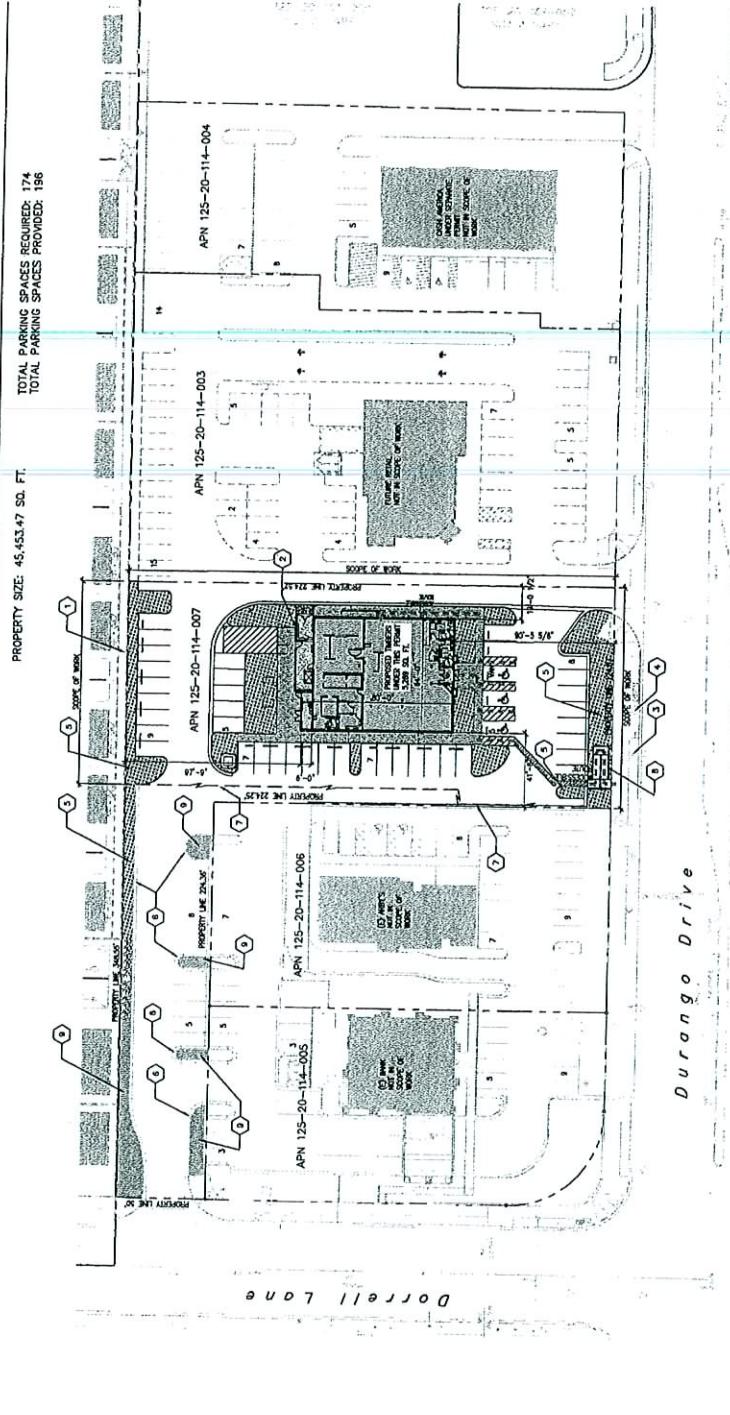

2 SITE PLAN  
1/32" = 1'-0"

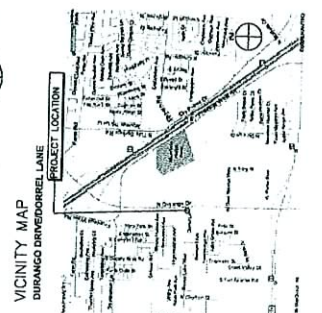

**SITE PLAN NOTES**

1. PROVIDE COPY FOR APNS ON THE DRAWING IS 112
2. CONTRACTOR SHALL COORDINATE THIS SHEET WITH ALL OTHER SHEETS PRIOR TO CONSTRUCTION AND BEING ANY DISCREPANCIES IN THE EXISTING UTILITIES.

**SHEET KEYNOTES**

1. EXISTING CURB WALL
2. 8'-0" HIGH CURB WALL AT BACK OF PAVEMENT
3. EXISTING LIGHT POLE DETAIL
4. EXISTING TREE DETAIL
5. NEW LANDSCAPING, SEE LANDSCAPE PLAN AL-10
6. EXISTING CURB, SEE CIVIL PLAN
7. SWIFT AND MATCH EXISTING A.C. SEE CIVIL DRAWINGS
8. NEW ACCESSIBLE RAMP FOR ONE DRIVEWAY, SEE ALSO DETAILS 11 & 12 ON SHEET AL-10
9. EXISTING LANDSCAPING

**CONTRACTOR**

RESILIN BUILDERS  
GENERAL CONTRACTOR  
LICENSE # 91548  
5025 POLARIS AVENUE  
LAS VEGAS, NEVADA 89115  
TEL: (702) 790-3000  
FAX: (702) 790-3008  
www.resilinbuilders.com

Project:  
**TIMBERS AT MONTECITO**  
DURANGO DRIVE/DORRELL LANE  
APN: 125-20-114-007

Drawn By: TERRY/CAN  
Checked By: TERRY/CAN  
Date: 05/30/2007  
Scale: AS1.00

**RECEIVED**  
MAY 30 2007



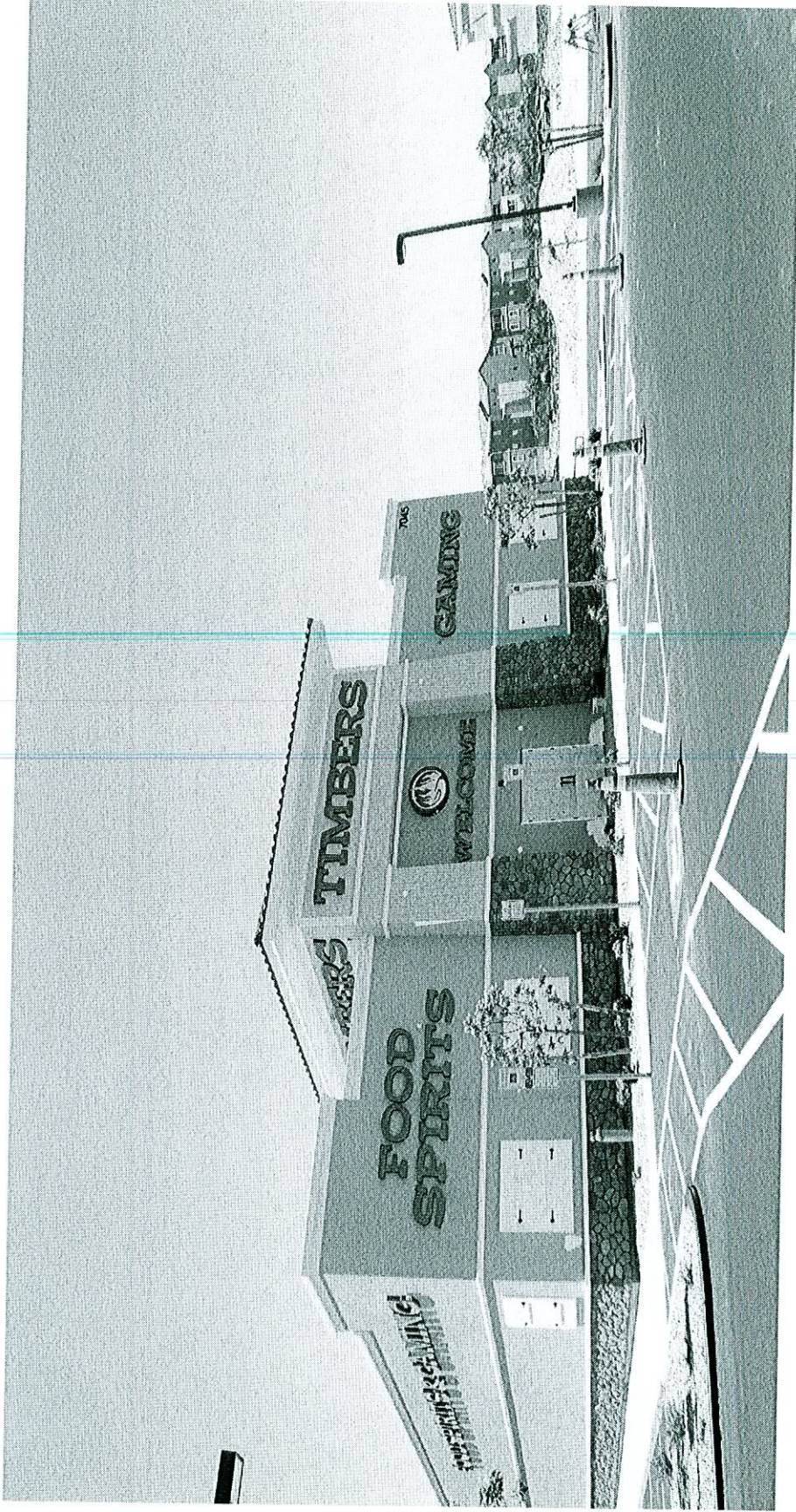

SUP-22298 - APPLICANT/OWNER: ARIZONA INVESTORS  
7045 NORTH DURANGO DRIVE  
JUNE 28, 2007 PLANNING COMMISSION

06/19/07



SUP-22298 - APPLICANT/OWNER: ARIZONA INVESTORS  
7045 NORTH DURANGO DRIVE  
JUNE 28, 2007 PLANNING COMMISSION

06/19/07