



PLANNING & DEVELOPMENT DEPARTMENT

STATEMENT OF FINANCIAL INTEREST

Case Number: **ZON-22583** APN: 12525501010, 12525601022 & 023

Name of Property Owner: Decatur IV LLC

Name of Applicant: James E. Stroh Architect, Inc.

Name of Representative: James E. Stroh Architect, Inc.

To the best of your knowledge, does the Mayor or any member of the City Council or Planning Commission have any financial interest in this or any other property with the property owner, applicant, the property owner or applicant's general or limited partners, or an officer of their corporation or limited liability company?

 Yes

 X No

If yes, please indicate the member of the City Council or Planning Commission who **is** involved and list the name(s) of the person or persons with whom the City Official holds an interest. Also list the Assessor's Parcel Number if the property in which the interest **is** held is different from the case parcel.

City Official: _____

Partner(s): _____

APN: _____

Signature of Property Owner: [Handwritten Signature]

Print Name: R. PHILIP NOORAFCHIA

Subscribed and sworn before me

This 5th day of June, 2007

Teresa Cargill
Notary Public in and for said County and State



EXISTING ZONING: R-C
EXISTING CP: MEDIUM-LOW RESIDENTIAL

PROJECT INFORMATION

City of Las Vegas
 1.666,815 SF (24,000 ACRES) - must be verified
 483,003 SF
 1,000 SPACES (1,000/1,000 SF)
 1,000 SPACES (1,000/1,000 SF) - surface
 200 SPACES - 1,000
 2,000 SPACES - 1,000
 30 SPACES (5 MIN ACCESSIBLE) - surface
 30 SPACES (7 MIN ACCESSIBLE) - surface
 40 SPACES (11 MIN ACCESSIBLE) - 1,000
 10 SPACES (11 MIN ACCESSIBLE) - 1,000
 28.07%

HC Parking Required:
 HC Parking Provided:

Floor Area/Use Area:
 28.07%

LANDSCAPING LEGEND

Size
 2" x 2" box
 2" x 4" box
 4" x 4" box
 4" x 8" box
 1" x 1" box
 5' circle
 5' radius

Landscaping Materials
 Concrete Materials
 Asphalt Pave
 Mexican Tan Trim
 Ornamental Brick
 Red Tiles

Former areas to be covered in decomposed granite or other approved material.

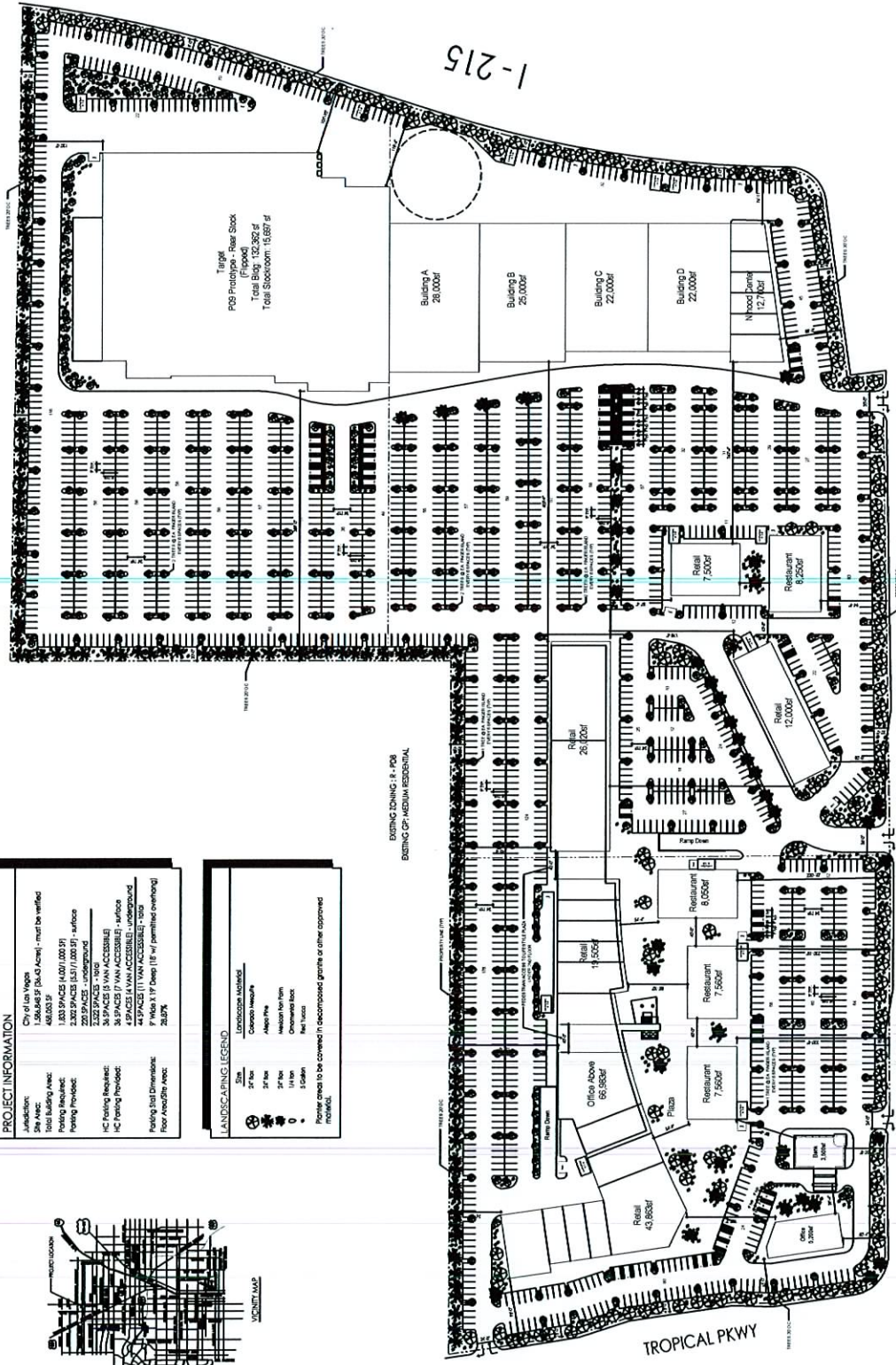

EXISTING ZONING: R - PDR
EXISTING CP: MEDIUM RESIDENTIAL



SITE/LANDSCAPE PLAN • Decatur/Tropical • June 12, 2007

R&S INVESTMENTS
 ARCHITECTURE AND
 LANDSCAPE ARCHITECTURE P.L.L.C.

RECEIVED

JUL 09 2007

ZON-22583
 REVISED
 07/26/07 PC

LANDSCAPE ARCHITECTURE P.L.L.C.
 1945 Paradise Ave., Las Vegas, Nevada 89102
 (702) 433-1480



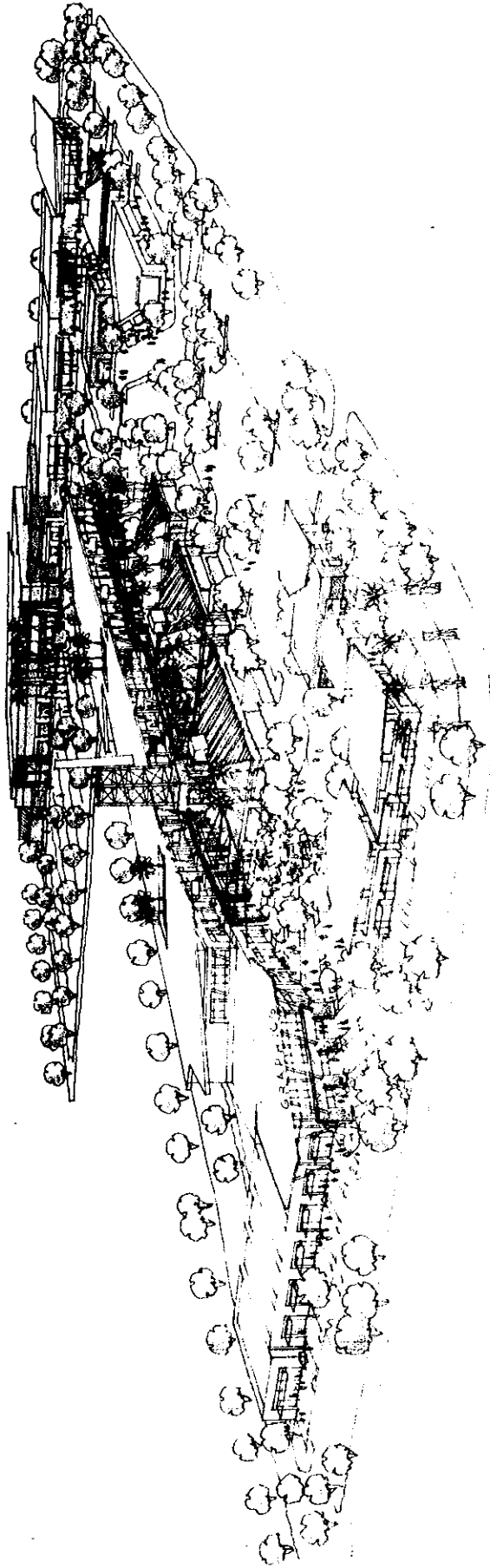

HTH ARCHITECTS
JUN 12 2007

Decatur & Tropical
Aerial Perspective
06.11.07
HTH
Architects

ZON-22583
07/26/07 PC

NOTE: This information is conceptual and subject to adjustments pending further verification and Client, Town, and Governmental Agency approvals. No warrants or guarantees of any kind are given or implied.
HTH Architects • Copyright 2007