



NO.	DATE	BY	REVISION
1			
2			
3			
4			
5			
6			
7			
8			
9			
10			

**KB HOME NEVADA Inc.**  
 1440 S. RAYBURN AVE.  
 LAS VEGAS, NV 89102  
 (702) 884-1000

CITY OF LAS VEGAS  
 PLANNING DEPARTMENT  
 225 N. RAYBURN AVE., SUITE 100  
 LAS VEGAS, NV 89101

**SITE DEVELOPMENT PLAN**  
**CUFFS EDGE**  
**POD 201 & 203**

DATE	NO.	BY	REVISION
12/15/07	1	JK	ISSUED FOR PERMITTING
08/15/07	2	JK	REVISED PER CITY COMMENTS
07/15/07	3	JK	REVISED PER CITY COMMENTS
06/15/07	4	JK	REVISED PER CITY COMMENTS
05/15/07	5	JK	REVISED PER CITY COMMENTS
04/15/07	6	JK	REVISED PER CITY COMMENTS
03/15/07	7	JK	REVISED PER CITY COMMENTS
02/15/07	8	JK	REVISED PER CITY COMMENTS
01/15/07	9	JK	REVISED PER CITY COMMENTS
12/15/06	10	JK	REVISED PER CITY COMMENTS

SHEET NO. **SDP**  
 1 OF 1 SHEETS  
 PROJECT NO.

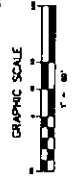
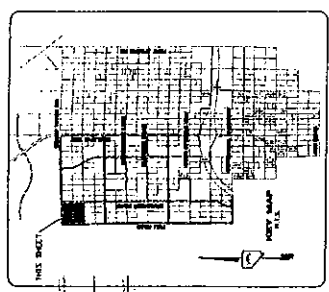

**DEVELOPER**  
 KB HOME NEVADA Inc.  
 1440 S. RAYBURN AVE.  
 LAS VEGAS, NV 89102  
 (702) 884-1000

**REG DATA**

APPLY	12/15/07	NO. OF UNITS	201
APPLY	12/15/07	NO. OF UNITS	203
APPLY	12/15/07	NO. OF UNITS	204
APPLY	12/15/07	NO. OF UNITS	205
APPLY	12/15/07	NO. OF UNITS	206
APPLY	12/15/07	NO. OF UNITS	207
APPLY	12/15/07	NO. OF UNITS	208
APPLY	12/15/07	NO. OF UNITS	209
APPLY	12/15/07	NO. OF UNITS	210
APPLY	12/15/07	NO. OF UNITS	211
APPLY	12/15/07	NO. OF UNITS	212
APPLY	12/15/07	NO. OF UNITS	213
APPLY	12/15/07	NO. OF UNITS	214
APPLY	12/15/07	NO. OF UNITS	215
APPLY	12/15/07	NO. OF UNITS	216
APPLY	12/15/07	NO. OF UNITS	217
APPLY	12/15/07	NO. OF UNITS	218
APPLY	12/15/07	NO. OF UNITS	219
APPLY	12/15/07	NO. OF UNITS	220

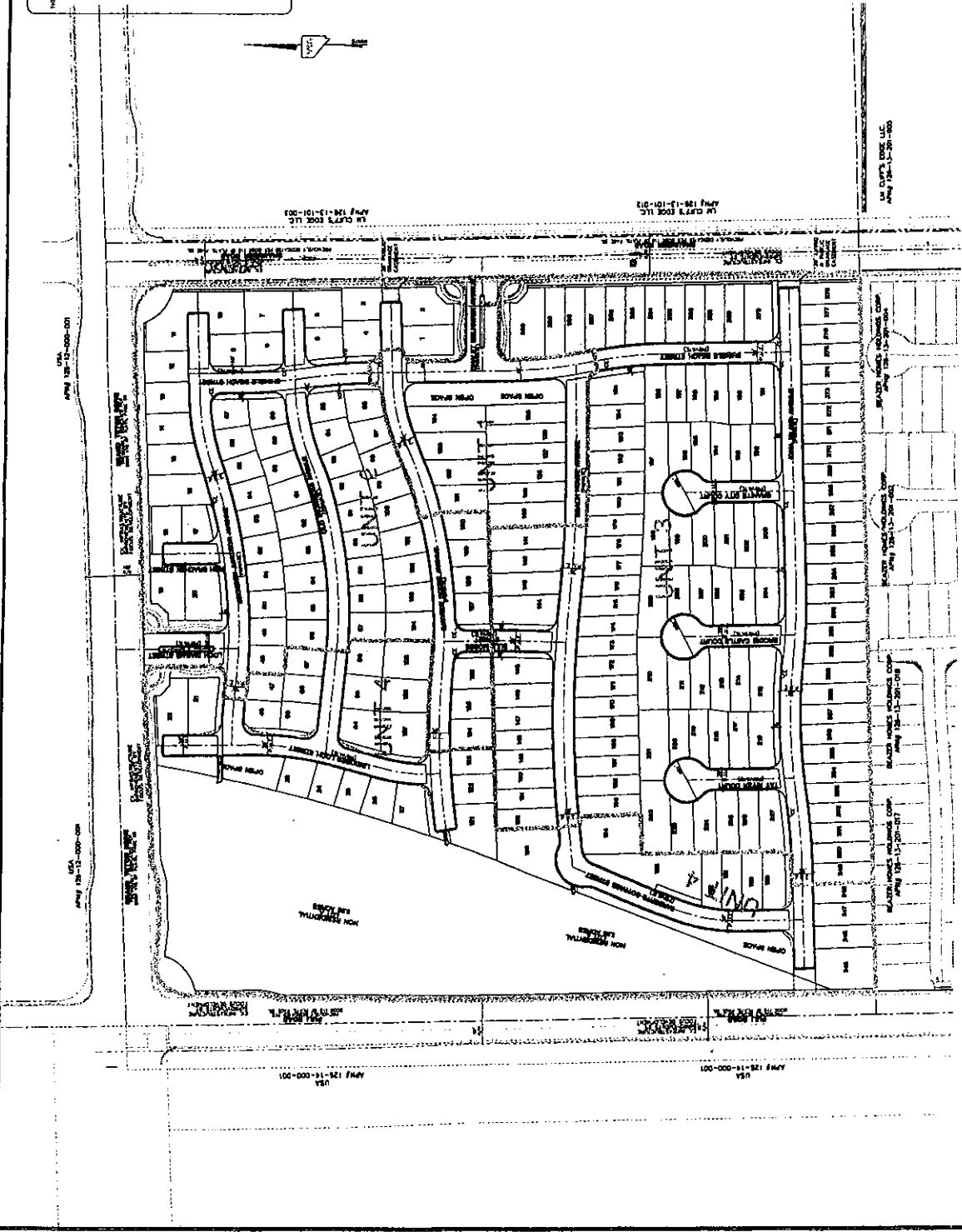

JUN 15 2007  
 JUN 15 2007

**ROC-22642**  
**07/26/07 PC**