

PROJECT INFORMATION

A.P.N. 139 34-810-050
EXISTING ZONING: R-1
GROSS LAND AREA: 7,000 S.F. (160 AC.)
TOTAL BUILDING AREA: 4,266 S.F.
LOT COVERAGE: 60%

BUILDING INFORMATION

1st FLOOR	
LOBBY / ATRIUM:	426 S.F.
ELEV / STAIR #1:	120 S.F.
STAIRWAY #2:	72 S.F.
STORAGE #A:	72 S.F.
STORAGE #B:	265 S.F.
STORAGE #C:	42 S.F.
TOTAL:	937 S.F.
2nd FLOOR	
OFFICE:	4,439 S.F.
TOTAL:	4,379 S.F.
TOTAL BUILDING:	5,376 S.F.
PARKING:	3,331 S.F.

PARKING ANALYSIS

REQUIRED PARKING	
1st FLOOR	937 S.F.
2nd FLOOR	4,439 S.F.
TOTAL:	5,376 S.F.
5,376 S.F. / 300 SF = 17.92 OR 18 SPACES	
PROVIDED PARKING	
COVERED PARKING:	3 FULL SIZE
	1 H.C. VAN
	1 COMPACT
ALLEY PARKING:	2 FULL SIZE
ALLEY PARKING:	1 COMPACT
TOTAL:	8 SPACES

PLANTING LEGEND

	PHOENIX DACTYLIFERA	DATE PALM - FRUITLESS	25'
	SILK TREES	INDOOR - ORNAMENTAL	24" BOX
	PHOTINIA FRASERI	FRASERS PHOTINIA	5 GAL
	RAPHANOLEPIS INDICA	INDIAN HAWTHORN	5 GAL
	LANTANA MONTEVDENSIS	TRAILING LANTANA	5 GAL
	LAGERSTROEMIA INDICA	GRAPE MYRTLE	5 GAL

HARD SCAPE MATERIAL

DECOMPOSED COLORED GRAVEL
3/4" MINUS SCREEN DESERT GOLD
IN ALL PLANTING AREAS
BOULDER - 10" MIN.

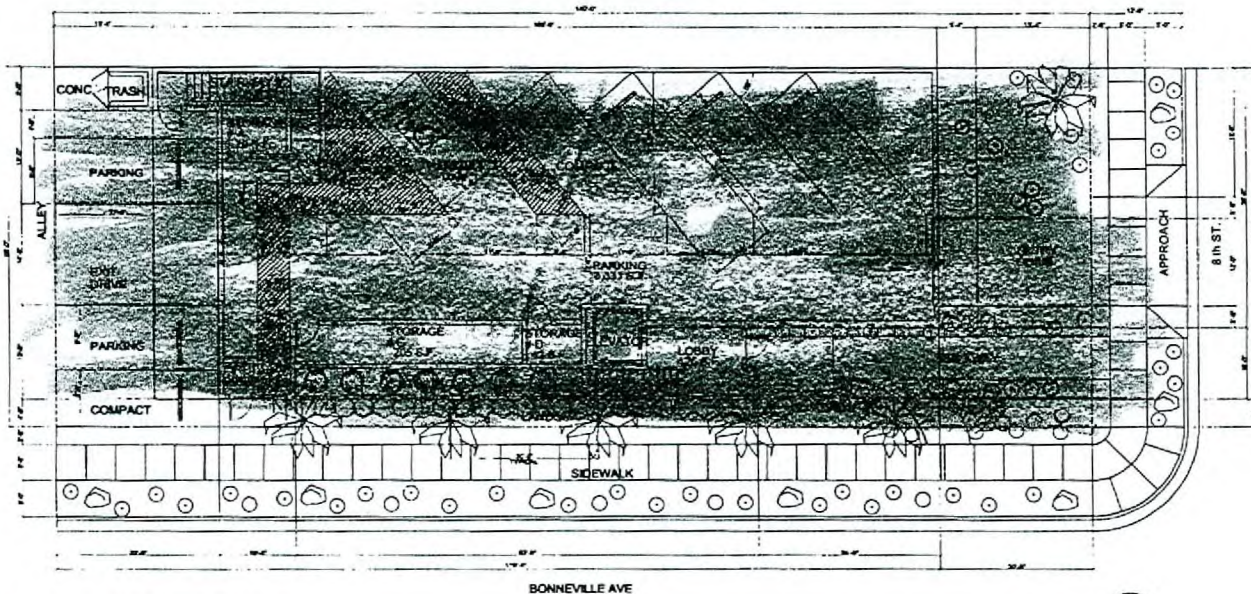

REVISIONS	BY

BRYAN CONSTRUCTION INC.
STATE LICENSE # 21874
308 S. 11th
LAS VEGAS, NEVADA
(702) 882-1137
Fax: (702) 882-7070

CONCEPT PLANS
LUIS ROJAS LAW OFFICES
802 E. BONNEVILLE AVE.
LAS VEGAS, NEVADA

DATE: 12/26/2006
BY: [Signature]
SCALE: 1/8" = 1'-0"
111295

C1

ZON-20397 VAR-20398
VAR-20399 SDR-19675

04/12/07 PC

RECEIVED

MAR 8 8 2007