

11145 e. eastern - suite 130
henderson, nv 89052
p 702.456.1070
f 702.456.7020

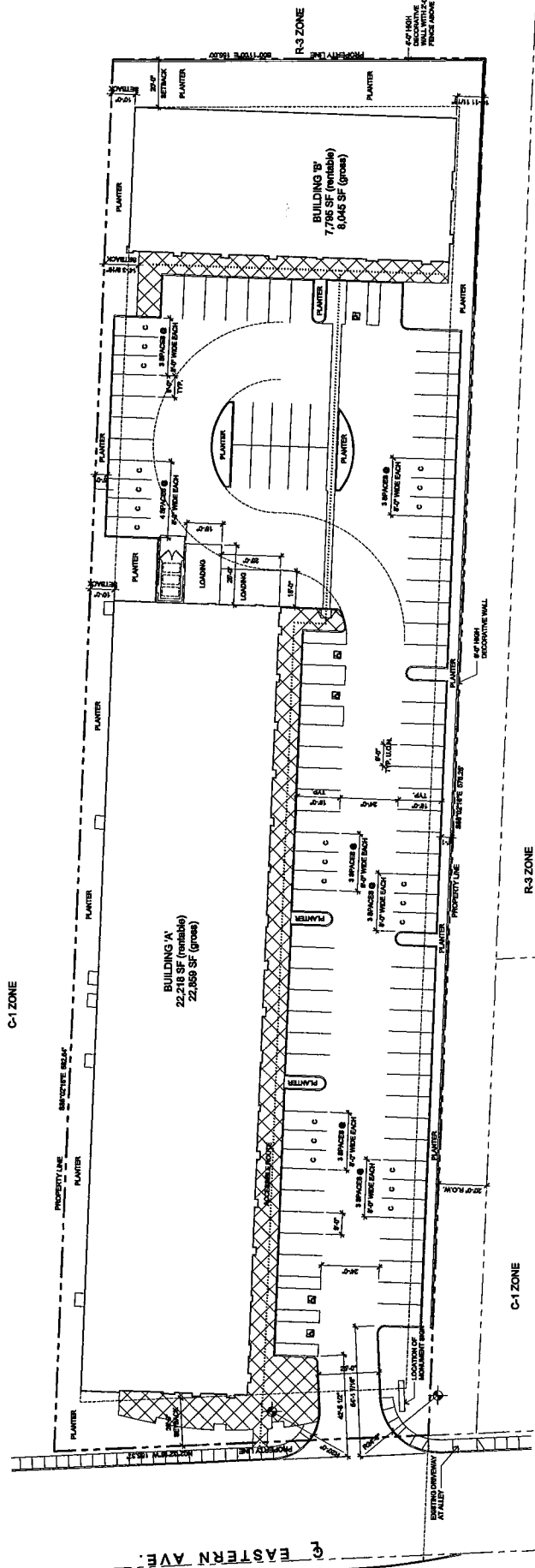

SITE DATA

SITE AREA (NET) 89,470 SF
 BLOCK AREA 84,348 SF
 FLOOR AREA RATIO: 208

PHASING ANALYSIS
 108 SPACES REQUIRED - GENERAL RETAIL
 187,200 SF, 24,188 SF
 90 SPACES REQUIRED - SUPER CLUB, PUBLIC HEATING
 187,700 SF, 2,000 SF
 78 SPACES REQUIRED - FINANCIAL INSTITUTION
 187,200 SF, 1,300 SF
 167 SPACES REQUIRED - TOTAL

SPACES PROVIDED - ACCESSIBLE
 8 SPACES
 SPACES PROVIDED - STANDARD
 78 SPACES
 SPACES PROVIDED - TOTAL
 108 SPACES (87.2% REMEDIATION)

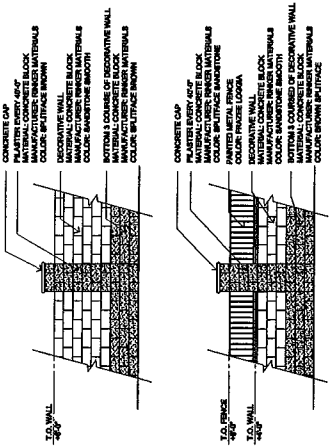

TYPICAL DECORATIVE WALL ELEVATIONS
 SCALE: 1/4" = 1'-0"

SITE PLAN

SCALE: 1" = 20'-0"

2006 SEP - 1 A 10: 30

RECEIVED
 CITY CLERK

RECEIVED

AUG 31 2006

6-30-06 SHT A1

SUP-13884

VAR-13881 SUP-13882

VAR-14355 SDR-13880

REVISED 09/06/06 CC

SITE PLAN
 Retail Center
 Eastern & Bonanza

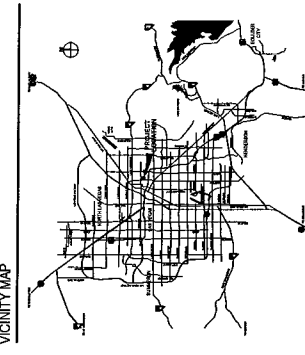

VICINITY MAP

R-3 ZONE

C-1 ZONE

Submitted after final agenda

Date 9/1/06 Item 163-167

