



PLANNING & DEVELOPMENT DEPARTMENT

STATEMENT OF FINANCIAL INTEREST

Case Number: ZON-14420 APN: 138-08-401-008, -009

Name of Property Owner: JUNGER, ET AL

Name of Applicant: WALKER LANDSCAPE

To the best of your knowledge, does the Mayor or any member of the City Council or Planning Commission have any financial interest in this or any other property with the property owner, applicant, the property owner or applicant's general or limited partners, or an officer of their corporation or limited liability company?

Yes

No

If yes, please indicate the member of the City Council or Planning Commission who is involved and list the name(s) of the person or persons with whom the City Official holds an interest. Also list the Assessor's Parcel Number if the property in which the interest is held is different from the case parcel.

City Official: \_\_\_\_\_

Partner(s): \_\_\_\_\_

APN: \_\_\_\_\_

Signature of Property Owner: [Handwritten Signature]

Print Name: MONIKA SCHMIDT

Subscribed and sworn before me

This 13 day of June, 2006

Carrie L. Price  
Notary Public in and for said County and State

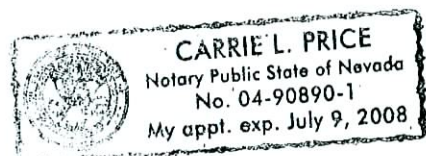

**BUILDING LEGEND**

- BLDG ONE  
1000 SF - 4000 SF MEDICAL OFFICE
- BLDG TWO  
1000 SF - 4000 SF MEDICAL OFFICE
- BLDG THREE  
1000 SF - 4000 SF MEDICAL OFFICE
- BLDG FOUR  
1000 SF - 4000 SF MEDICAL OFFICE
- BLDG FIVE  
1000 SF - 4000 SF MEDICAL OFFICE

**SITE INFORMATION**

- JURISDICTION  
CITY OF LAS VEGAS
- CURRENT ZONING  
M-1.5 (MIXED USE AND OFFICE)
- PROPOSED ZONING  
M-1.5 (MIXED USE AND OFFICE)
- BUILDING  
MIXED USE AND OFFICE
- BUILDING FOOTPRINT / NET AREA  
TOTAL SITE AREA  
TOTAL BUILDING FOOTPRINT / NET AREA  
ALLOWABLE COVERED AREA BY  
PARKING REQUIREMENTS (PROFESSIONAL OFFICE)
- BLDG ONE (LEVEL ONE)  
1000 SF - 4000 SF  
PARKING REQUIRED -  
PARKING REQUIRED -  
BLDG TWO (THREE)  
1000 SF - 4000 SF  
PARKING REQUIRED -  
PARKING REQUIRED -  
BLDG FIVE  
1000 SF - 4000 SF  
PARKING REQUIRED -  
PARKING REQUIRED -  
TOTAL PARKING REQUIRED (PROFESSIONAL OFFICE)  
TOTAL PARKING PROVIDED  
TOTAL PARKING REQUIRED (PROFESSIONAL OFFICE)  
ACCESSIBLE SPACES PROVIDED  
ACCESSIBLE SPACES PROVIDED  
BUILDING HEIGHT MAX  
MINIMUM SET BACK  
CHEYENNE AVENUE  
DAPPLE GREY ROAD  
NORTH SIDE

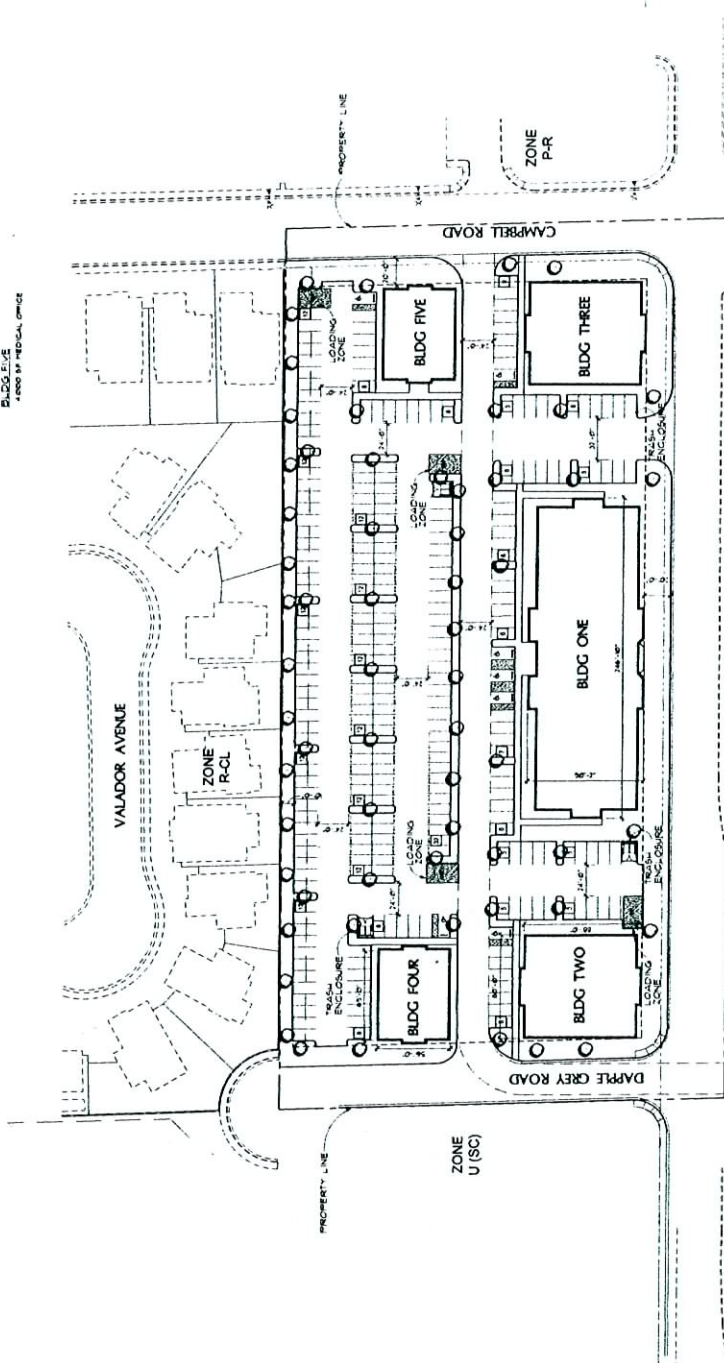

**VICINITY MAP**



**CHEYENNE/ CAMPBELL PROFESSIONAL MEDICAL CENTER**

CHEYENNE & CAMPBELL, LAS VEGAS

PROJECT # 06-008  
DATE 06-13-06



NTS  
CARPENTER SELLERS ASSOCIATES  
1000 SOUTH MAIN STREET, SUITE 1000, LAS VEGAS, NV 89101  
TEL: 702-735-1000 FAX: 702-735-1001 WWW.CSAAS.COM

SD-1

**ZON-14420**  
**07/27/06 PC**

JUN 15 2006