



PLANNING & DEVELOPMENT DEPARTMENT

STATEMENT OF FINANCIAL INTEREST

Case Number: ZON-14378 APN: 139-36-303-~~001~~ & 003

Name of Property Owner: Clark County School District & Housing Authority City Of Las Vegas

Name of Applicant: Clark County School District

To the best of your knowledge, does the Mayor or any member of the City Council, Planning Commission, or a Hearings Officer have any financial interest in this or any other property with the property owner, applicant, the property owner or applicant's general or limited partners, or an officer of their corporation or limited liability company?

 Yes XX No

If yes, please indicate the member of the City Council, Planning Commission or Hearings Officer who is involved and list the name(s) of the person or persons with whom the City Official holds an interest. Also list the Assessor's Parcel Number if the property in which the interest is held is different from the case parcel.

City Official: NA

Partner(s): NA NA

APN: NA

Signature of Property Owner/Authorized Agent: *Parviz Ghadiri*

Parviz Ghadiri, Executive Director,
City Of Las Vegas Housing Authority

Subscribed and sworn before me

This 20th day of April, 2006

Ursula Ritchie
Notary Public in and for said County and State

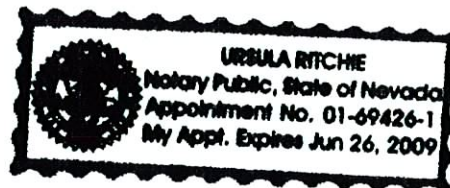



PLANNING & DEVELOPMENT DEPARTMENT

STATEMENT OF FINANCIAL INTEREST

Case Number: ZON-14378 APN: 139-36-303-001 & 002

Name of Property Owner: Clark County School District & Housing Authority City Of Las Vegas

Name of Applicant: Clark County School District

To the best of your knowledge, does the Mayor or any member of the City Council, Planning Commission, or a Hearings Officer have any financial interest in this or any other property with the property owner, applicant, the property owner or applicant's general or limited partners, or an officer of their corporation or limited liability company?

 Yes XX No

If yes, please indicate the member of the City Council, Planning Commission or Hearings Officer who is involved and list the name(s) of the person or persons with whom the City Official holds an interest. Also list the Assessor's Parcel Number if the property in which the interest is held is different from the case parcel.

City Official: NA

Partner(s): NA NA

APN: NA

Signature of Property Owner/Authorized Agent: 

Subscribed and sworn before me J. P. Gerner, Associate Superintendent, Facilities Division, Clark County School District

This 21st day of April, 2006

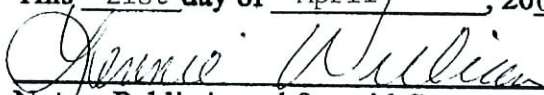
Notary Public in and for said County and State



RAFAEL RIVER PARK

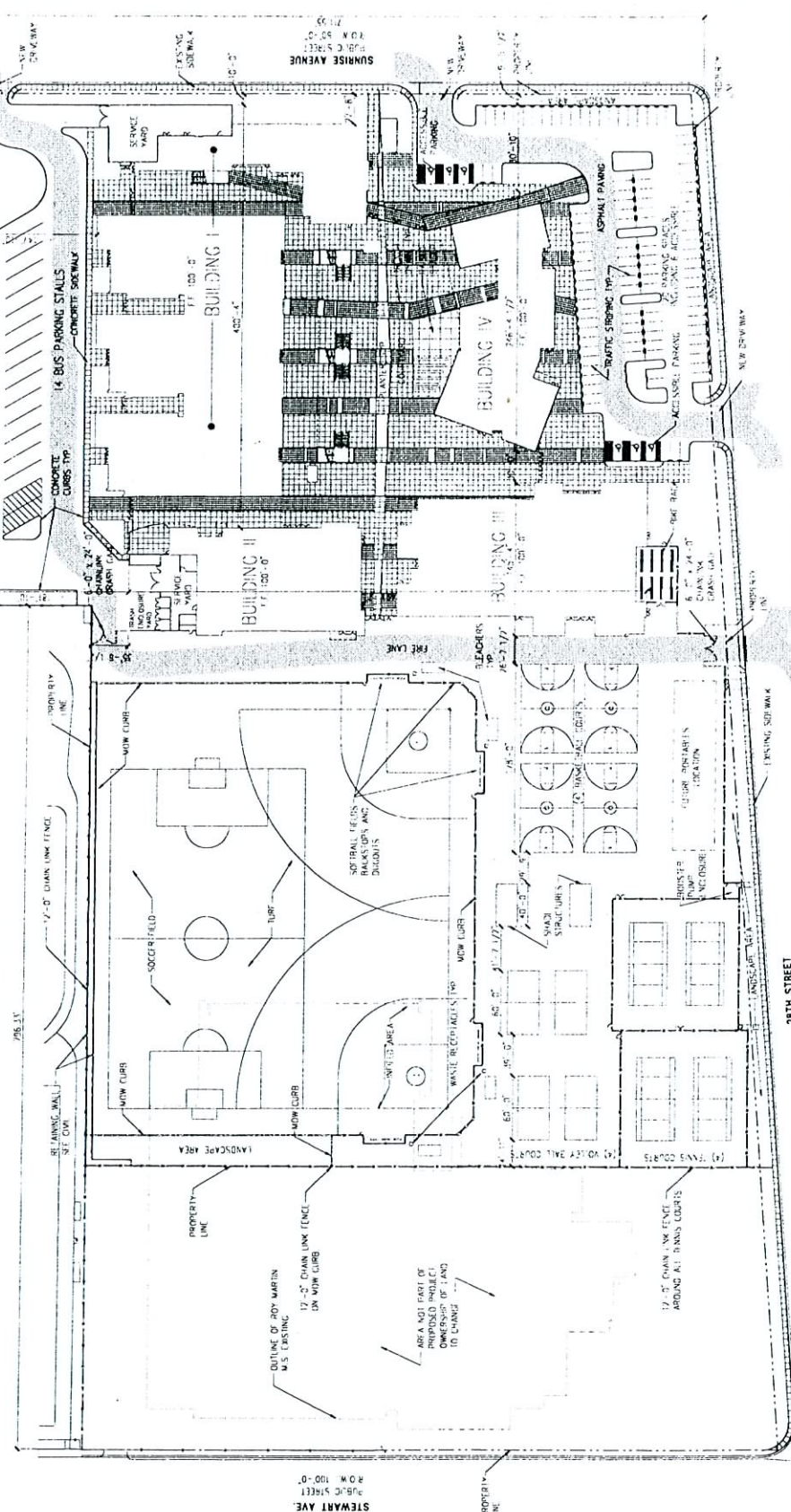

PROJECT SUMMARY		PROJECT VICINITY	
PARCEL AREA	68,846 S.F. (1.57 ACRES) EXPOS		
BUILDING AREA	98,706 S.F. (2.25 ACRES) NET		
COMBINED ROOF AREA	198,211 S.F.		
SITE COVER PAGE	587,066 S.F. / 13.4 ACRES S.F. - 17.0%		
NUMBER OF GENERAL CLASSROOMS	47	<p>2 SPACES FOR CLASSROOM PLUS 22 SPARE SPACES 7 x 12' - 8' x 10' - 114 22 SPACES TOTAL INCLUDING 6 ACCESSIBLE SPACES (SPACES: 6'-0" W. x 10'-0" D. 100')</p>	
PARKING PROVIDED	72 SPACES	<p>PARKING TO BUILDING RATIO: 72 / 10,824 S.F. = 1 SPACE / 1,082 S.F.</p>	

ZON-14378
07/27/06 PC
REVISED

SITE PLAN
SCALE: 1" = 50'-0"

REV.	DESCRIPTION	DATE	BY

CLARK COUNTY SCHOOL DISTRICT
CONSTRUCTION MANAGEMENT 4878 E. 8th STREET, LAS VEGAS, NEVADA 89127

ROY MARTIN MIDDLE SCHOOL REPLACEMENT

SITE PLAN

AS1.01

2480 EAST TOMPKINS AVENUE
SUITE 222
LAS VEGAS, NEVADA 89121
(702) 435-1150

ARCHITECTURE Design Planning

ARTS - POSITY
LAS VEGAS, NEVADA 89121
(702) 435-1150