



TEMPORARY SIGN PERMIT

TSP-49243

Description of Sign(s): TSP-49243- Temporary Sign Permit for one (1) 4-foot by 20-foot banner located in landscape area along Rainbow Boulevard, ten (10) 2-foot by 18-inch signs in landscape areas along Rainbow Boulevard and Oakey Boulevard, and five(5) 3-foot by 14-foot flags with two in the landscape area along Oakey Blvd and three in landscape area along Rainbow Blvd for the business at 1801 S. Rainbow Boulevard, Ste 130 from 05/01/13 through 06/29/13.

Applicant: Factory Direct Mattress & Furniture
1801 S Rainbow Blvd, Suite 130
Las Vegas, NV 89146
(702)233-1128 x

Parcel(s): 163-03-703-007

Ward(s): WARD 1 (LOIS TARKANIAN)

Type of Signs:

- Pennants
- Balloons
- Streamers
- Searchlights
- Portable
- Other

THIS PERMIT SHALL BE POSTED IN A CONSPICUOUS PLACE

THIS PERMIT IS APPROVED PURSUANT TO TITLE 19.16.170A OF THE LAS VEGAS MUNICIPAL CODE, SUBJECT TO THE FOLLOWING CONDITIONS:

- 1) THE TEMPORARY SIGN PERMIT SHALL BE VALID FOR 60 DAYS FROM MAY 1, 2013 TO JUNE 29, 2013.
- 2) ALL TEMPORARY SIGNS SHALL BE SET BACK FROM ANY STREET INTERSECTION OR DRIVEWAY OR OTHERWISE LOCATED IN ORDER TO NOT CREATE A SIGHT RESTRICTION.
- 3) ALL TEMPORARY SIGNAGE SHALL BE SO LOCATED AS TO NOT CREATE A NUISANCE TO NEARBY PROPERTIES AS A RESULT OF FACTORS SUCH AS EXCESSIVE ILLUMINATION, GLARE, OR NOISE.
- 4) ALL TEMPORARY SIGNAGE SHALL CONFORM TO THE SUBMITTED SITE PLAN.
- 5) THE APPLICANT SHALL DISPLAY A COPY OF THIS TEMPORARY SIGN PERMIT DURING NORMAL BUSINESS HOURS.
- 6) ALL TEMPORARY IMPROVEMENTS MADE TO THIS SITE AND THE ABUTTING STREETS SHALL BE REMOVED UPON EXPIRATION OF THE PERMIT.
- 7) ALL APPLICABLE CITY CODE REQUIREMENTS SHALL BE SATISFIED.
- 8) THE APPLICANT SHALL BE RESPONSIBLE FOR LEAVING THE SITE FREE OF DEBRIS, LITTER, OR ANY OTHER EVIDENCE OF THE SIGNAGE UPON EXPIRATION OF THE PERMIT.
- 9) NO SIGNS SHALL BE LOCATED IN THE PUBLIC RIGHT-OF-WAY.

PLEASE NOTE:

On August 15, 2012, the City Council approved an Ordinance which extends on a temporary basis the display periods for temporary special event signs. Under this Ordinance, temporary special event signs approved between August 16, 2012 and June 30, 2014 may be displayed by the same business license holder on the same lot up to eight times in any one calendar year. The aggregate time of display of such signs shall not exceed one hundred eighty days in any one calendar year.

Unless otherwise extended or modified by ordinance, the display period of temporary special event signs approved on or after July 1, 2014 shall be subject to the applicable calendar-year limitations that would be in effect independent of this Ordinance.

THIS PERMIT SHALL BE POSTED IN A CONSPICUOUS PLACE



DEPARTMENT OF PLANNING

APPLICATION / PETITION FORM

Application/Petition For: FACTORY DIRECT MATTRESS & FURNITURE, For temporary sign
 Project Address (Location) 1801 S. Rainbow L. Vegas NV 89146
 Project Name _____ Proposed Use _____
 Assessor's Parcel #(s) 163-03-703-007 Ward # 1
 General Plan: existing _____ proposed _____ Zoning: existing C-1 proposed N/A
 Commercial Square Footage _____ Floor Area Ratio _____
 Gross Acres 0.87 Lots/Units _____ Density _____
 Additional Information _____

PROPERTY OWNER TRI-LIN HOZONINGS LLC Contact _____
 Address 1801 S. Rainbow Blvd # 270 Phone: 702 943-0900 Fax: (702) 243-0342
 City LAS VEGAS State NV Zip 89146
 E-mail Address FLIN@linassoc.com

APPLICANT FACTORY Direct Mattres & Furniture Contact MEHMET
 Address 1801 S. Rainbow Phone: 702 233-1128 Fax: 233-1148
 City L. VEGAS State NV Zip 89146
 E-mail Address RIZAK49@gmail.com

REPRESENTATIVE SAME AS ABOVE Contact _____
 Address _____ Phone: _____ Fax: _____
 City _____ State _____ Zip _____
 E-mail Address _____

I certify that I am the applicant and that the information submitted with this application is true and accurate to the best of my knowledge and belief. I understand that the City is not responsible for inaccuracies in information presented, and that inaccuracies, false information or incomplete application may cause the application to be rejected. I further certify that I am the owner or purchaser (or option holder) of the property involved in this application, or the lessee or agent fully authorized by the owner to make this submission, as indicated by the owner's signature below.

Property Owner Signature* [Signature]

* An authorized agent may sign in lieu of the property owner for Final Maps, Tentative Maps, and Parcel Maps.

Print Name Francis LM

Subscribed and sworn before me
 This 30th day of April, 20 13
Andrea Willet

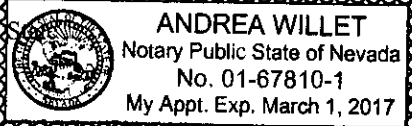
Notary Public in and for said County and State of Nevada

 ANDREA WILLET
 Notary Public State of Nevada
 No. 01-67810-1
 My Appt. Exp. March 1, 2017

FOR DEPARTMENT USE ONLY

Case #	<u>TSP-49243</u>
Meeting Date:	_____
Total Fee: \$	<u>100.00</u>
Date Received:*	<u>5/1/13</u>
Received By:	<u>[Signature]</u>

*The application will not be deemed complete until the submitted materials have been reviewed by the Department of Planning for consistency with applicable sections of the Zoning Ordinance.

I Mehmet KARABAC

Running #
1801. S. RAINBOW as Furniture & Mattress
ASK permit
for Banner, Flags, signs

MAY 1 - JUNE 29 - (13)

Mehmet Karabac

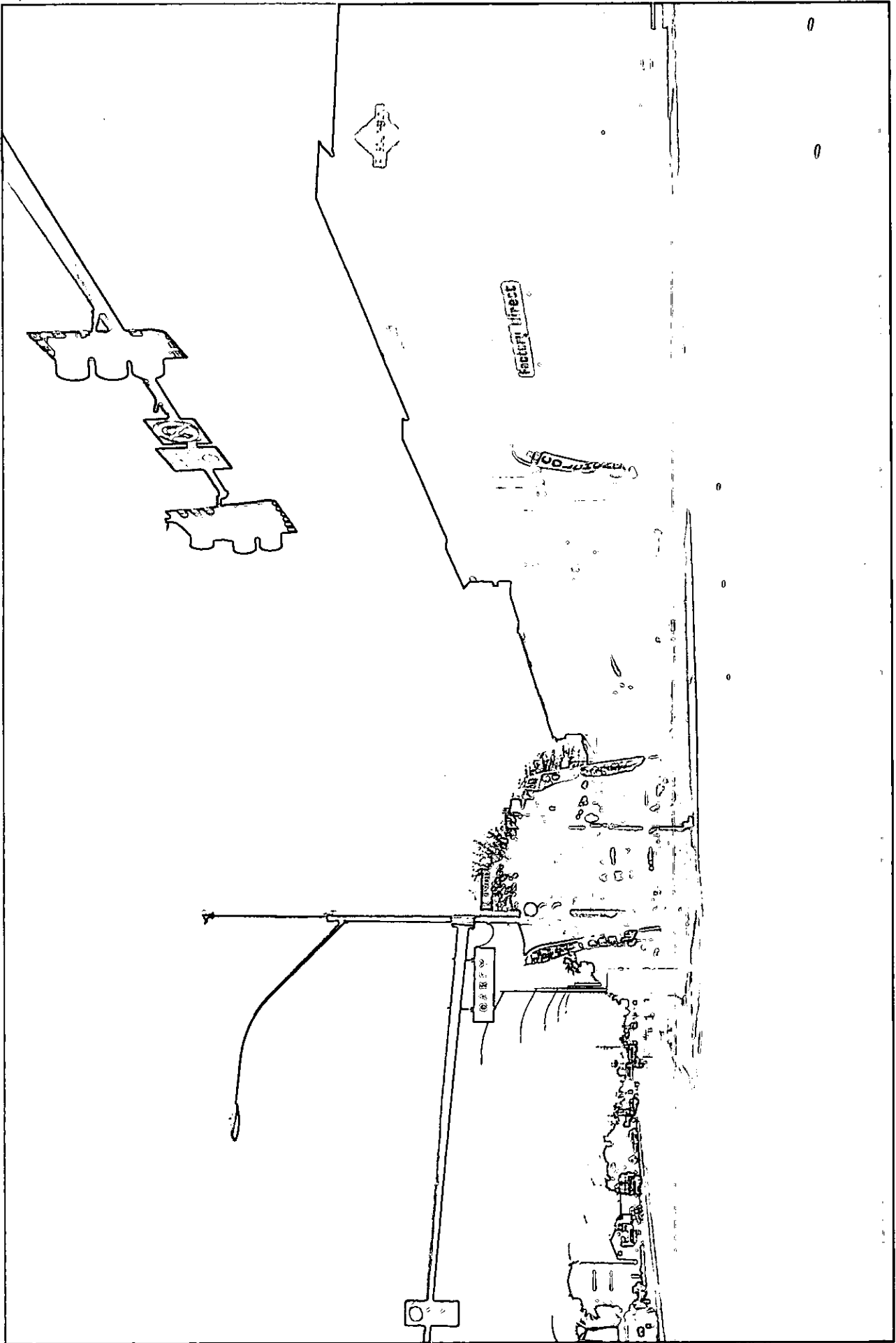

RECEIVED

MAY 01 2013

BARTOLO

Factory Direct

RES
SALE

SE
VENDER
COPROFOTOC

04.30.2013

RECEIVED

MAY 01 2013

Factory Direct
MATTRESS & FURNITURE
BRIDALELEGANT
Affordable Elegance for that Special Occasion
BARTOLO
PHYSICAL THERAPY
ADDITIONAL PARKING IN REAR

1801

Warehouse
Liquidation Sale

Furniture
Liquidation

FACTORY DIRECT
MATTRESS
FURNITURE
UP TO
70% OFF

FACTORY DIRECT
MATTRESS
FURNITURE
UP TO
70% OFF

FACTORY DIRECT
MATTRESS
FURNITURE
UP TO
70% OFF
CORNER OF RAINBOW & OAKLEY

RECEIVED
MAY 01 2013

MAY 30 2013

RECEIVED
MAY 01 2013

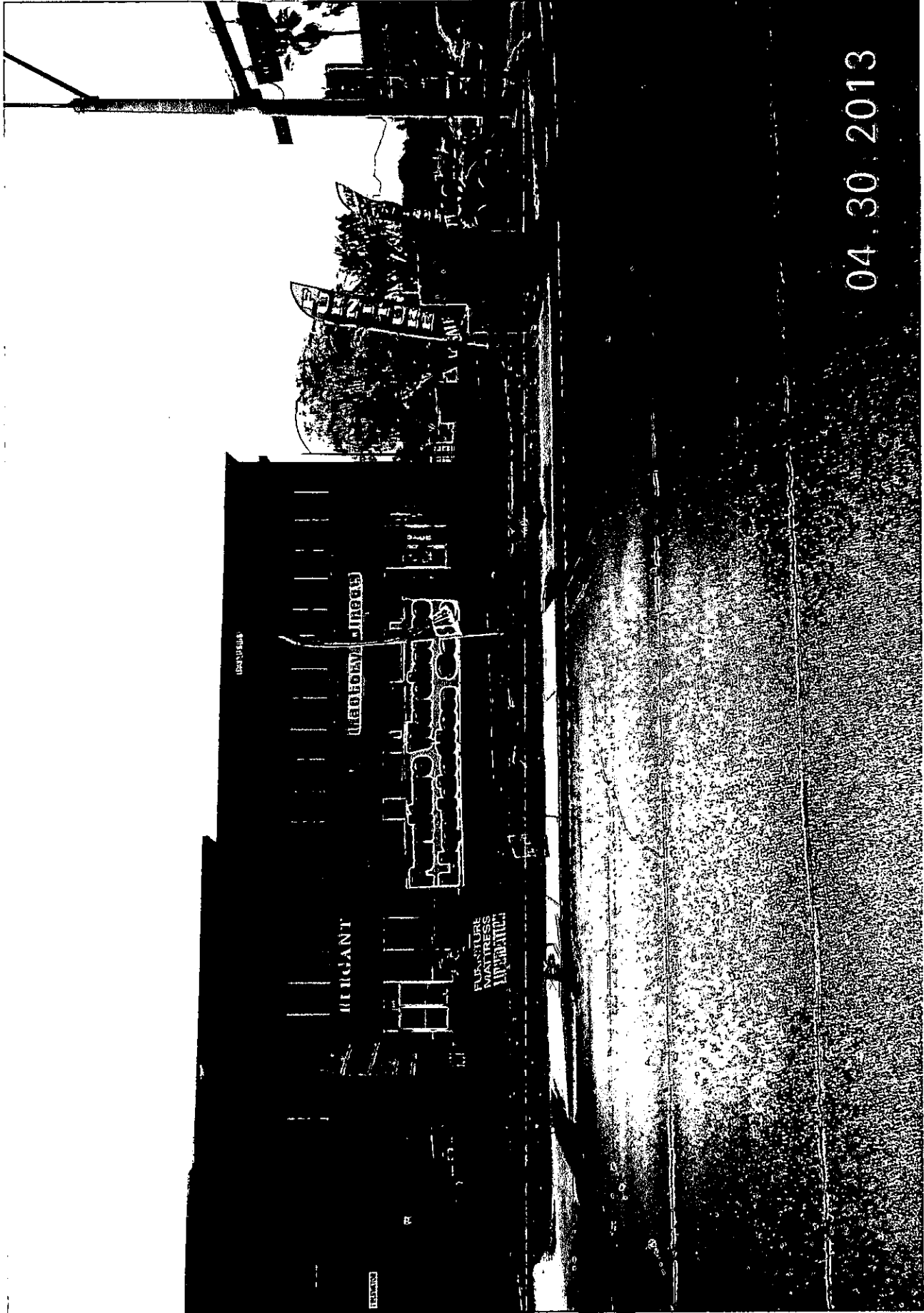

04.30.2013

BARTOLO

Fratturo Warehouses
Liquidation Sale

04 30 2013

RECEIVED

MAY 01 2013



FACTORY/DIRECT
MATTRESS
FURNITURE
UP TO
70% OFF
233-1128
CORNER OF HUNTERS & OAKLEY

FACTORY DIRECT
MATTRESS
FURNITURE
UP TO
70% OFF
CORNER OF HUNTERS & OAKLEY

Factory Direct

ELEGANT

RECEIVED
MAY 01 2013

04.30.2013

①

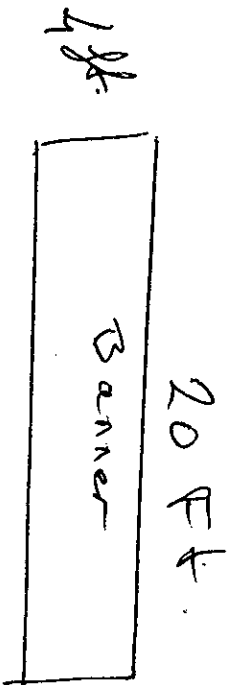

② - ③

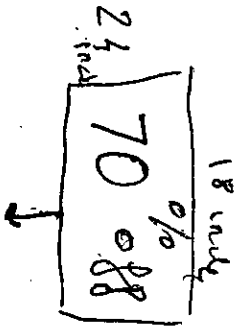

10 pcs

④

1488

by ③

4 pcs long flags

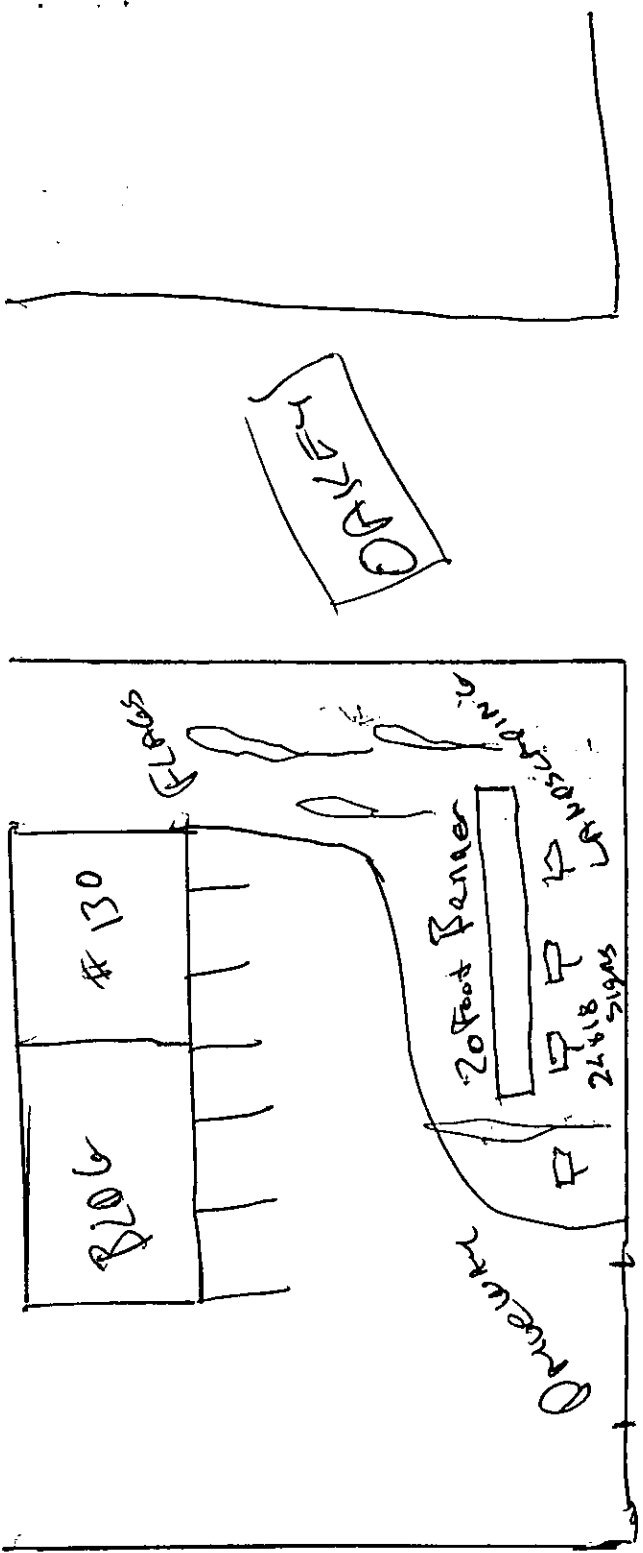

UNIVERSITY

RAINBOW BLVD

W
S
N
E

RECEIVED

MAY 01 2013

①

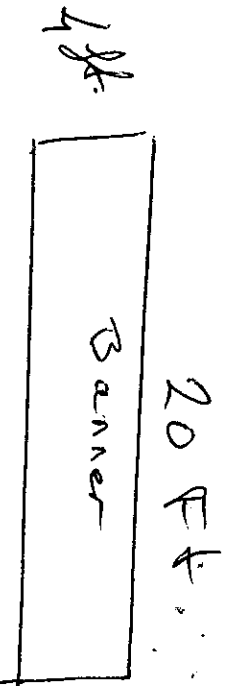

② - ③

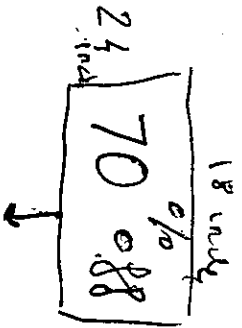

10 pcs

④

1488

by ③

4 pcs long flags