

2012 ELECTION CYCLE - EARLY VOTING TRAILER – FLOOR PLAN –
4854 LONE MOUNTAIN ROAD

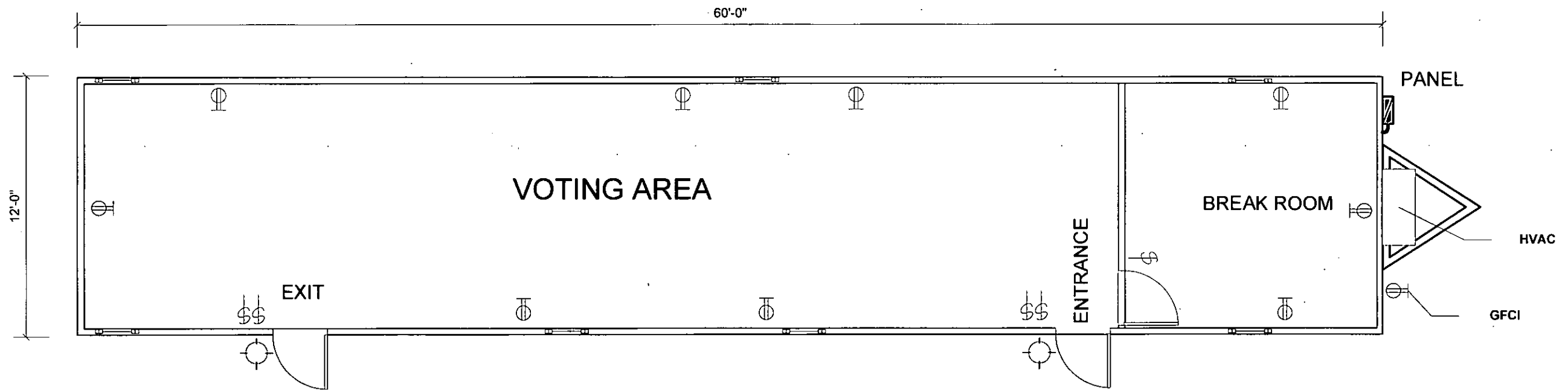

SCALE:
3/16" = 1' 0"



RECEIVED
AUG 1 5 2012

2012 ELECTIN CYCLE – EARLY VOTING TRAILER SITE – 4854 W. LONE MOUNTAIN RD.

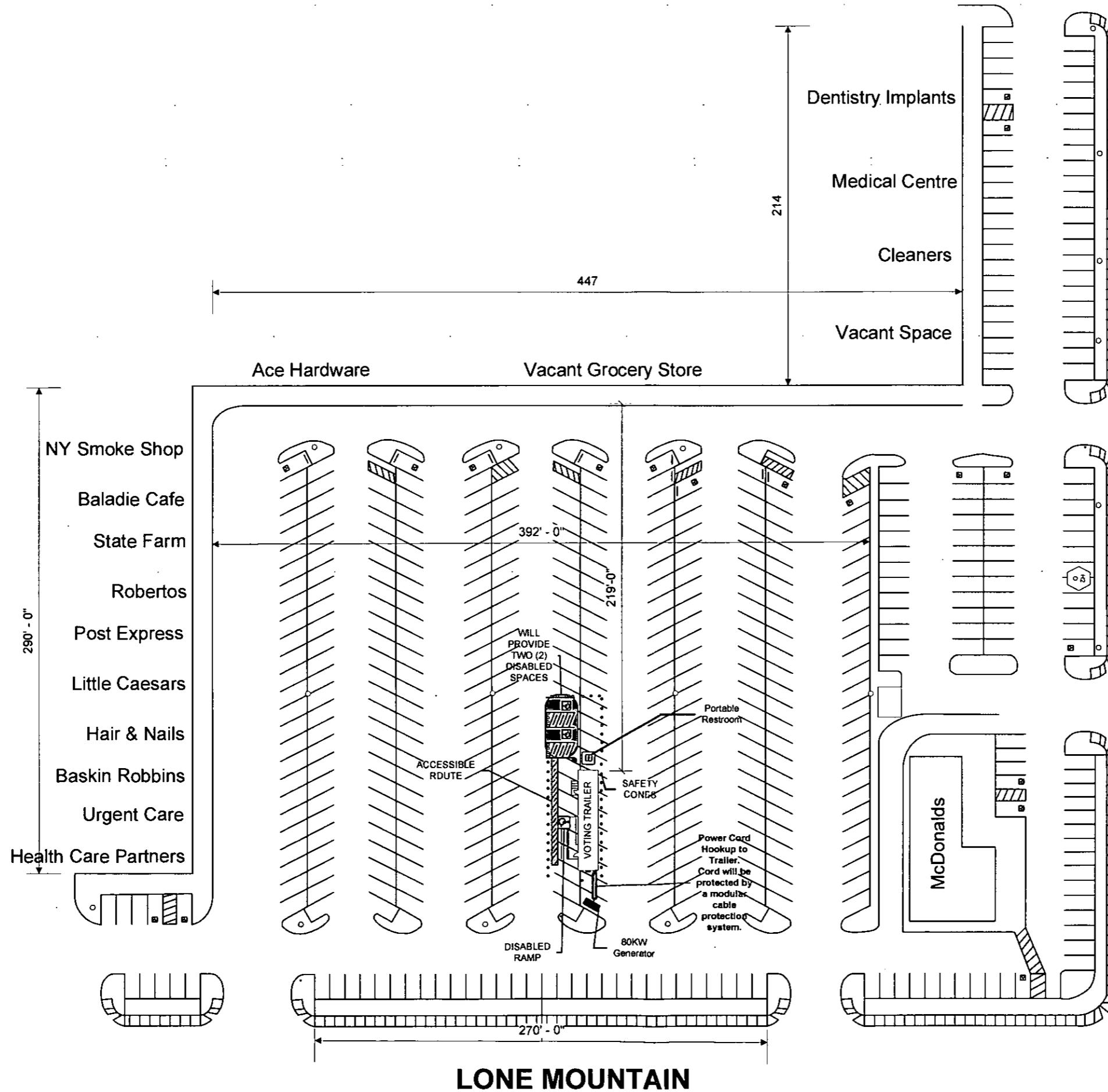
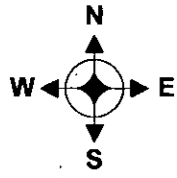

DECATUR

LONE MOUNTAIN

RECEIVED
AUG 15

2012 ELECTIN CYCLE – EARLY VOTING TRAILER SITE – 4854 W. LONE MOUNTAIN RD.

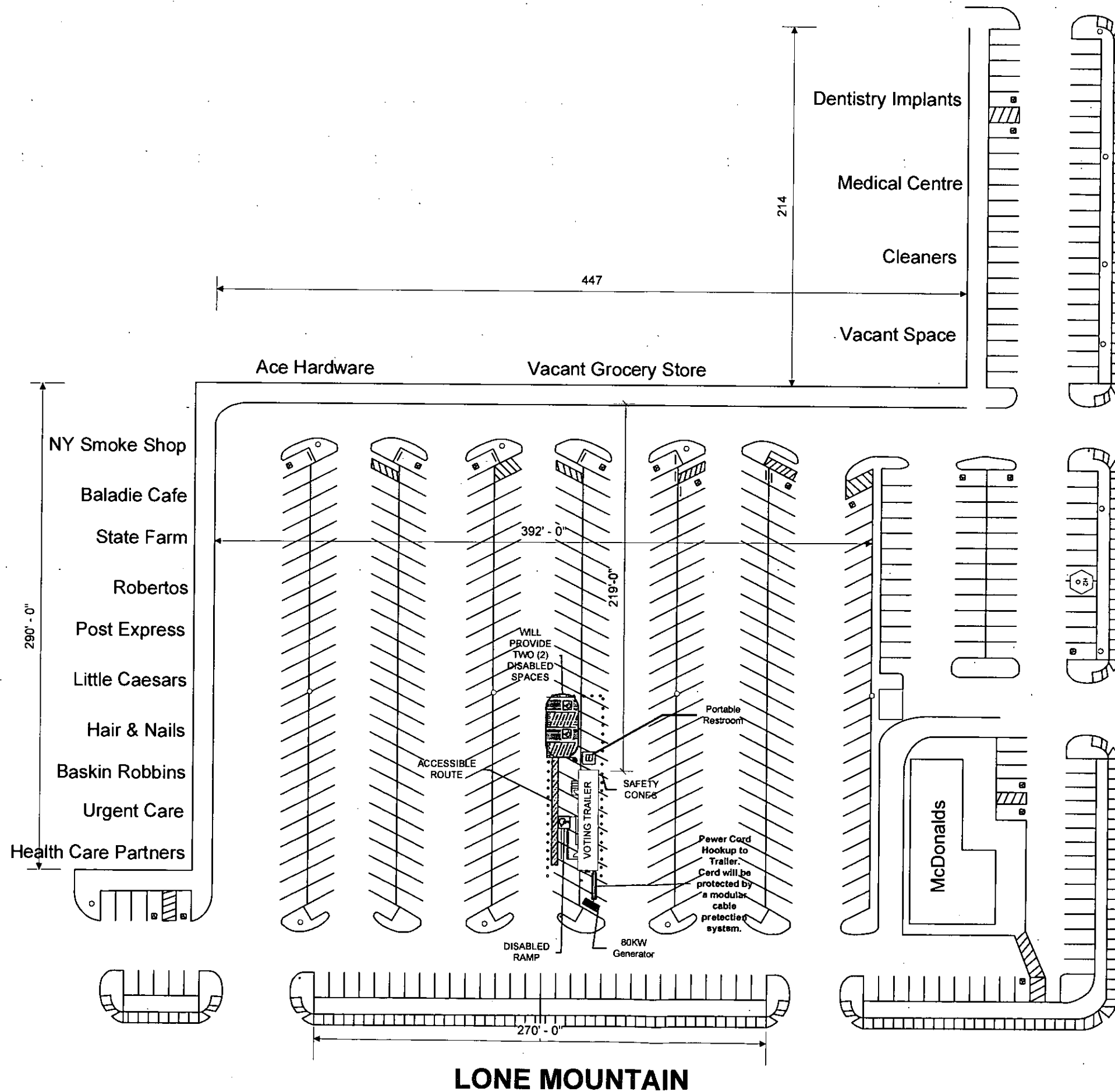
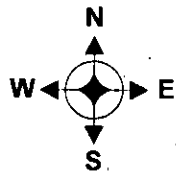

DECATUR

LONE MOUNTAIN

RECEIVED
AUG 15 2012

2012 ELECTION CYCLE - EARLY VOTING TRAILER – FLOOR PLAN –
4854 LONE MOUNTAIN ROAD



SCALE:
3/16" = 1' 0"

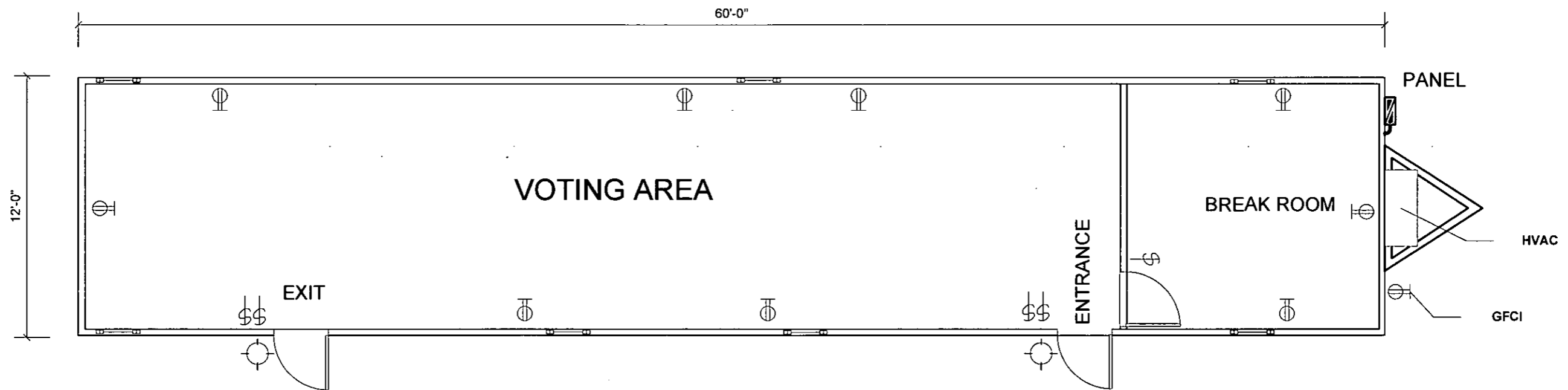

RECEIVED
AUG 15 2012



General

DEPARTMENT OF PLANNING

APPLICATION / PETITION FORM

Application/Petition For: Temporary Construction Trailer
Project Address (Location) Lone Mountain Plaza - 4854 W. Lone Mtn. Rd., LV, NV 89130
Project Name Clark County Early Voting Proposed Use Voting - General Election
Assessor's Parcel #(s) 125-36-818-001 Ward # 6
General Plan: existing X proposed Zoning: existing X proposed
Commercial Square Footage 720448 Ft. Floor Area Ratio
Gross Acres Lots/Units Density
Additional Information County government activity - CCED Voting

PROPERTY OWNER Burns Family LLC Contact Anthony Lomeo (Prop. mgr)
Address 1800 E. Warm Springs Rd #120 Phone: 499-7312 Fax: 736-7671
City LV State NV Zip 89119
E-mail Address Anthony.Lomeo@LVCambridge.com

APPLICANT Clark County Election Dept. Contact Joe Gloria
Address 965 Trade Dr., Ste A-F Phone: 455-7822 Fax: 455-7828
City N. Las Vegas State NV Zip 89030
E-mail Address jpg@clarkcountynv.gov

REPRESENTATIVE Contact
Address Phone: Fax:
City State Zip
E-mail Address

Property Owner Signature* Anthony Lomeo / CG
* An authorized agent may sign in lieu of the property owner for Final Maps, Tentative Maps, and Parcel Maps.
Print Name Anthony Lomeo / Prop mgr.
Subscribed and sworn before me
This 23 day of March, 2012
Mary C. Jones
Notary Public in and for said County and State CLARK & NEVADA

FOR DEPARTMENT USE ONLY
Case # TCP-46454
Meeting Date: N/A
Total Fee: 100.00
Date Received: 01/15/2012
Received By: Mlex

*The application will not be deemed complete until the submitted materials have been reviewed by the Department of Planning for consistency with applicable sections of the Zoning Ordinance.





Election Department

965 Trade Dr • Ste A • North Las Vegas NV 89030
Voter Registration (702) 455-8683 • Fax (702) 455-2793

Harvard L. Lomax, Registrar of Voters

Donna L. Cardinelli, Assistant Registrar of Voters



July 16, 2012

City of LV Building & Safety Dept.
333 N. Rancho Drive
Las Vegas, NV 89106

RE: Temporary Commercial Permit
4854 W. Lone Mtn. Road, LV, NV 89130

To Whom It May Concern,

I represent the Clark County Election Department in its request for a temporary commercial permit for our voting trailer located in the Lone Mountain Plaza Shopping Center. We intend to setup a 64' x 12' trailer in the parking lot to accommodate voters for the upcoming Presidential Election. Our hours of operation will be from 8am to 7pm, Monday through Sunday.

This site will provide voters in the Northern portion of the Las Vegas valley a location to vote early in the 2012 General Election. If we are granted this permit we intend to setup our trailer from September 24, 2012 through November 2, 2012.

If you have any questions regarding the intended use of this permit, please feel free to call me at 455-7822 or 249-2288.

Sincerely,

Joe Gloria
Sr. Election Operations Supervisor
Clark County Election Department
e-mail: jpg@clarkcountynv.gov

RECEIVED

AUG 15 2012

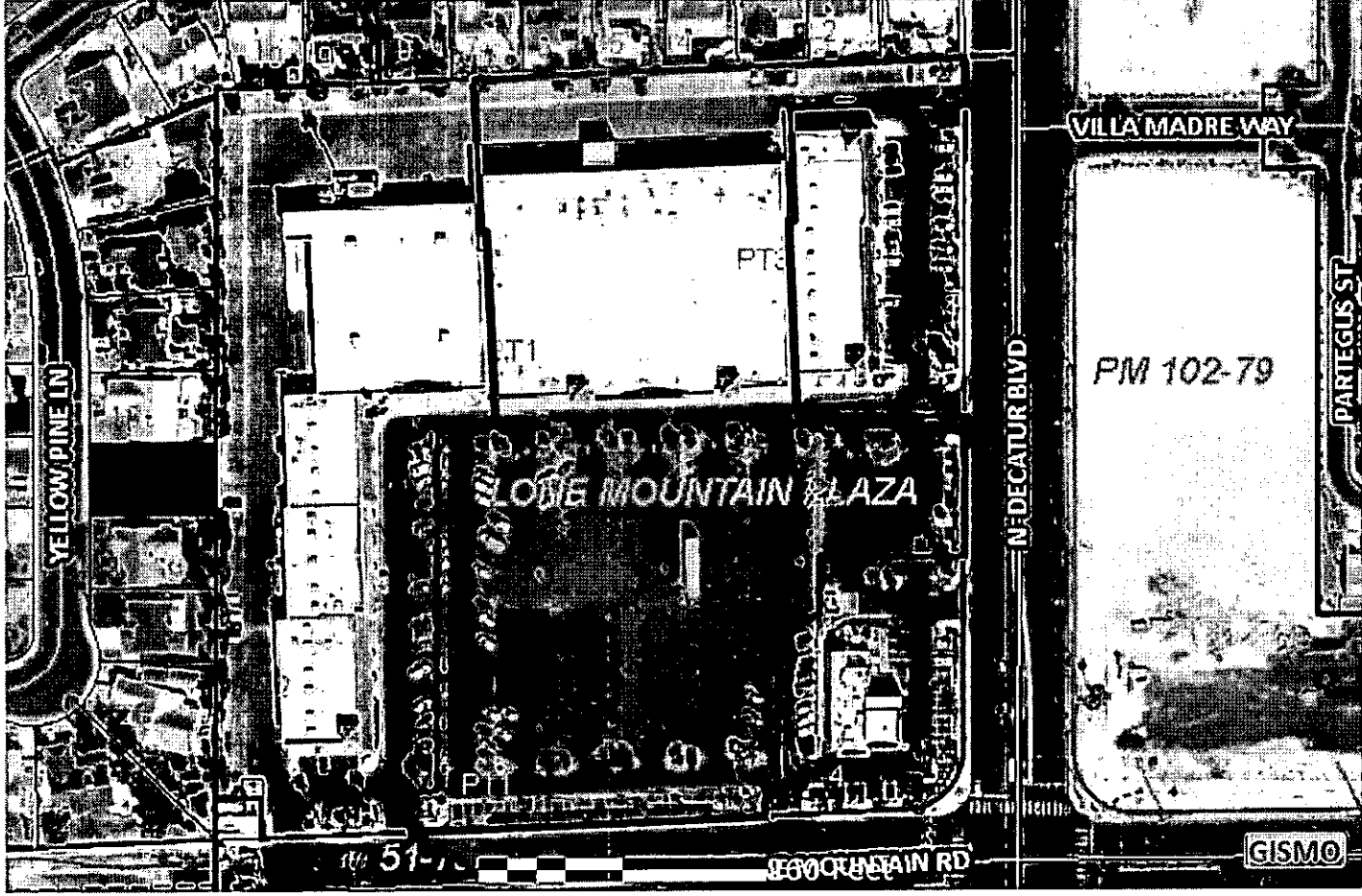

RECEIVED
AUG 15 2012



RECEIVED
AUG 15 2012

LVAC EARLY VOTING - PUMP THE VOTE!

MILITARY HIGHWAY
602-234-1300

FO
1952

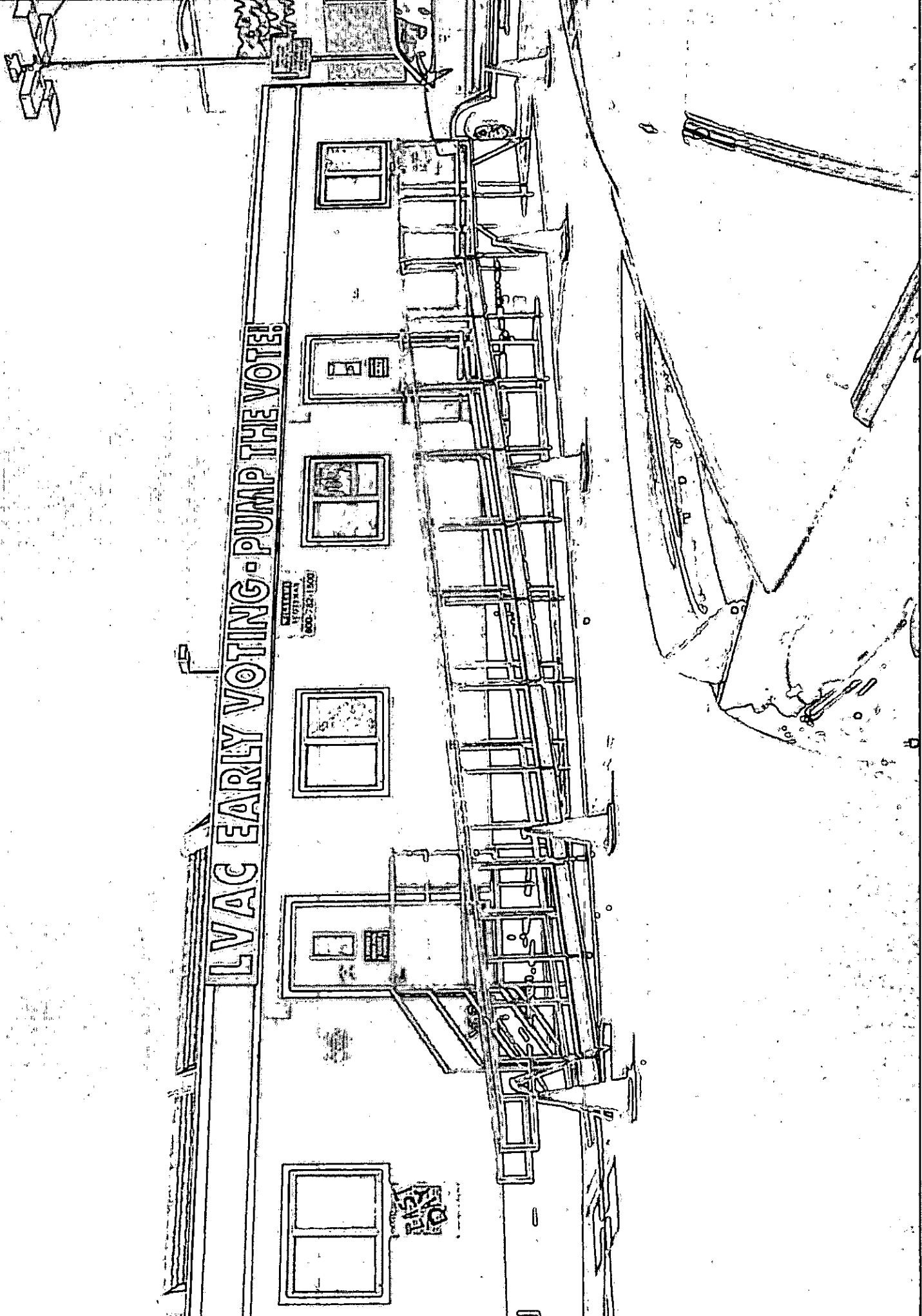

LVAC EARLY VOTING - PUMP THE VOTE!

UNIVERSITY
REGISTRATION
800-732-1500

10/2

RE

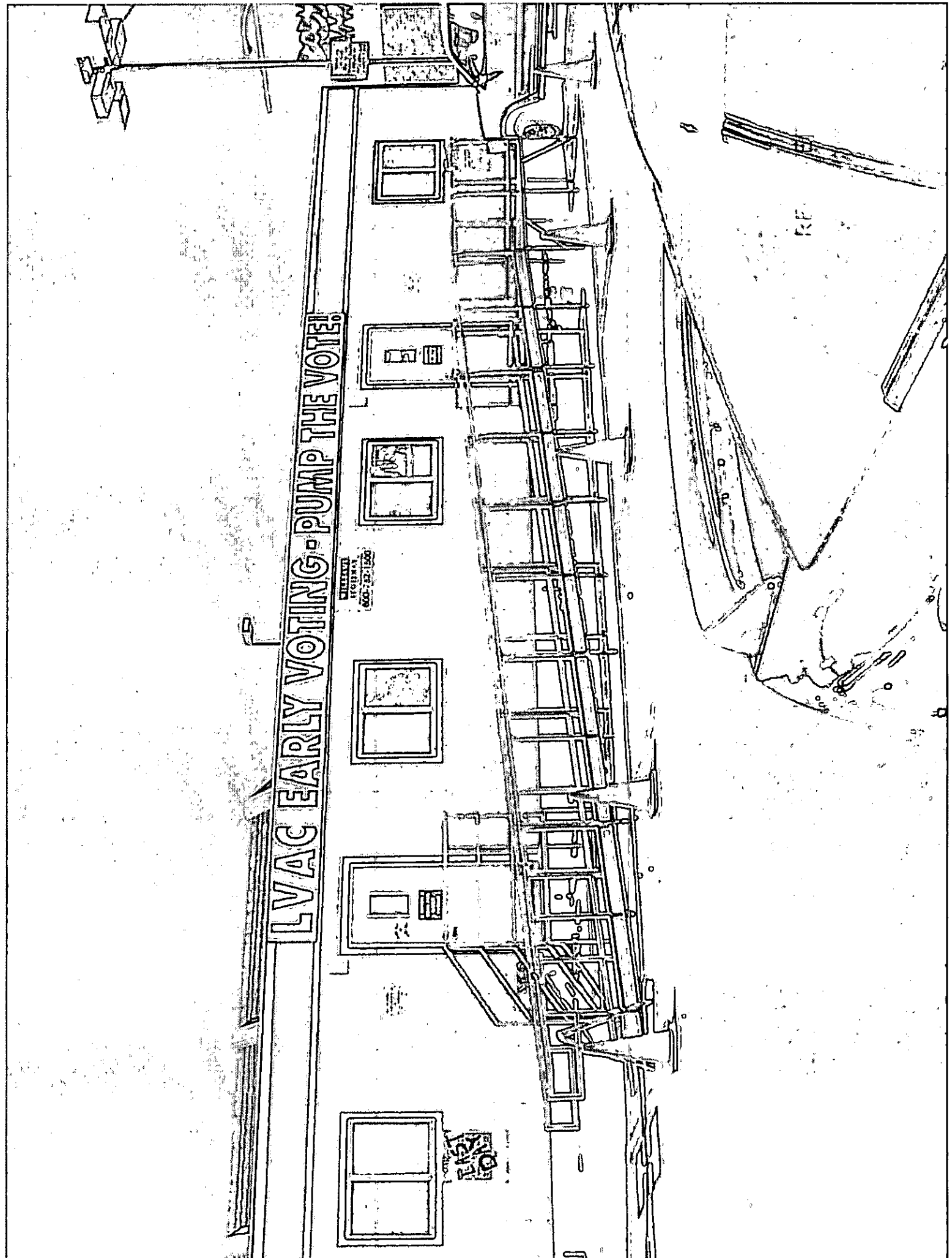



TEMPORARY COMMERCIAL PERMIT

TEMPORARY USE

TCP-46454

Valid September 24, 2012 To November 02, 2012

1. BUSINESS HOURS SHALL BE FROM 8 AM TO 7 PM.
2. THIS PERMIT IS NOT A BUSINESS LICENSE.
3. THIS PERMIT IS NOT A SUBSTITUTE FOR ANY REQUIRED STATE OR LOCAL BUSINESS LICENSE OR FOR ANY REQUIRED CHARITABLE SOLICITATION PERMIT.
4. This use shall not create a nuisance to nearby properties as a result of factors such as excessive illumination, glare, noise, vibration, smoke, dust, dirt, odors, gases or heat.
5. The use shall conform to the submitted plot plan date stamped 8-15-12.
6. No combustible materials shall be located within 50 feet of any structure on, or adjacent to this site.
7. No building or structure of any type shall be erected closer than 25 feet from any property line.
8. The applicant shall display a copy of this Temporary Commercial Permit during the hours of operation.
9. Sanitation facilities must be provided in accordance with the Clark County Health District and Republic Services of Southern Nevada.
10. The applicant shall provide private security officers as required by the Las Vegas Metropolitan Police Department.
11. Any signage for this temporary commercial use must be approved and permitted by the Planning and Development Department.
12. All applicable City code requirements shall be satisfied.
13. The applicant shall be responsible for leaving the site free of debris, litter or any other evidence of occupancy upon completion or removal of the use.

PLANNING SUPERVISOR SIGNATURE

DATE

PLANNING MANAGER SIGNATURE

DATE

THIS PERMIT SHALL BE POSTED IN A CONSPICUOUS PLACE



TEMPORARY COMMERCIAL PERMIT

TEMPORARY USE

TCP-46454

Valid September 24, 2012 To November 02, 2012

Description of Event: TCP-45051 - Temporary Commercial Permit for a voting trailer located in the Lon Mountain Plaza Shopping Center. The 64'x12' trailer will be located in the parking lot and intended to accommodate voters for the upcoming Presidential Primary Election. Hours of operation will be 8 am through 7pm Monday through Sunday. The trailer will be in operation from September 24, 2012 through November 2, 2012.

Applicant: Clark County Election Dept
965 Trade Drive
Suites A-f
North Las Vegas, NV 89030
(702)455-7822 x

Parcel(s): 125-36-818-001
Ward(s): WARD 6 (STEVEN D. ROSS)

THIS PERMIT IS APPROVED PURSUANT TO SECTION 19.18.100 OF THE LAS VEGAS MUNICIPAL CODE, SUBJECT TO THE FOLLOWING CONDITIONS:

See page 2 for conditions

THIS TEMPORARY COMMERCIAL PERMIT IS NOT VALID UNTIL THE FOLLOWING DEPARTMENT APPROVALS / PERMITS / LICENSES HAVE BEEN OBTAINED:

FIRE _____ (Initials)

BUSINESS SERVICES _____ (Initials)

SEWER _____ (Initials)

TRAFFIC _____ (Initials)

THIS PERMIT SHALL BE POSTED IN A CONSPICUOUS PLACE