

This map is for assessment use only and does NOT represent a survey.  
 No liability is assumed for the accuracy of the data delineated herein.  
 Information on roads and other non-assessed parcels may be obtained from the Road Document Listing in the Assessor's Office.

This map is compiled from official records, including surveys and deeds, but only contains the information required for assessment. See the recorded documents for more detailed legal information.

USE THIS SCALE (FEET) WHEN MAP REDUCED FROM 11X17 ORIGINAL

0 100 200 400 600 800

**ASSESSOR'S PARCELS - CLARK CO., NV.**  
 Michele W. Shafe - Assessor

BOOK T20S R61E SEC. 29 MAP N 2 SW 4 139-29-3

CLARK COUNTY NEVADA

PARCEL BOUNDARY CONDOMINIUM UNIT 001 ROAD PARCEL NUMBER  
 SUB BOUNDARY AIR SPACE PCL 001 PARCEL NUMBER  
 PM/LD BOUNDARY RIGHT OF WAY PCL 1.00 ACREAGE  
 ROAD EASEMENT SUB-SURFACE PCL 202 PARCEL SUB/SEQ NUMBER  
 MATCH / LEADER LINE HISTORIC LOT LINE PB 24-45 PLAT RECORDING NUMBER  
 HISTORIC SUB BOUNDARY 5 BLOCK NUMBER  
 HISTORIC PM/LD BOUNDARY 5 LOT NUMBER  
 SECTION LINE GL5 GOV. LOT NUMBER

126	125	124	123
137	138	139	140
164	163	162	161
175	176	177	178

6	5	4	3	2	1
7	8	9	10	11	12
13	14	15	16	17	18
19	20	21	22	23	24
25	26	27	28	29	30
31	32	33	34	35	36

8	4	8	4
5	1	5	1
6	2	6	2
7	3	7	3
8	4	8	4
5	1	5	1

Scale: 1" = 200' Rev: 02/09/2011

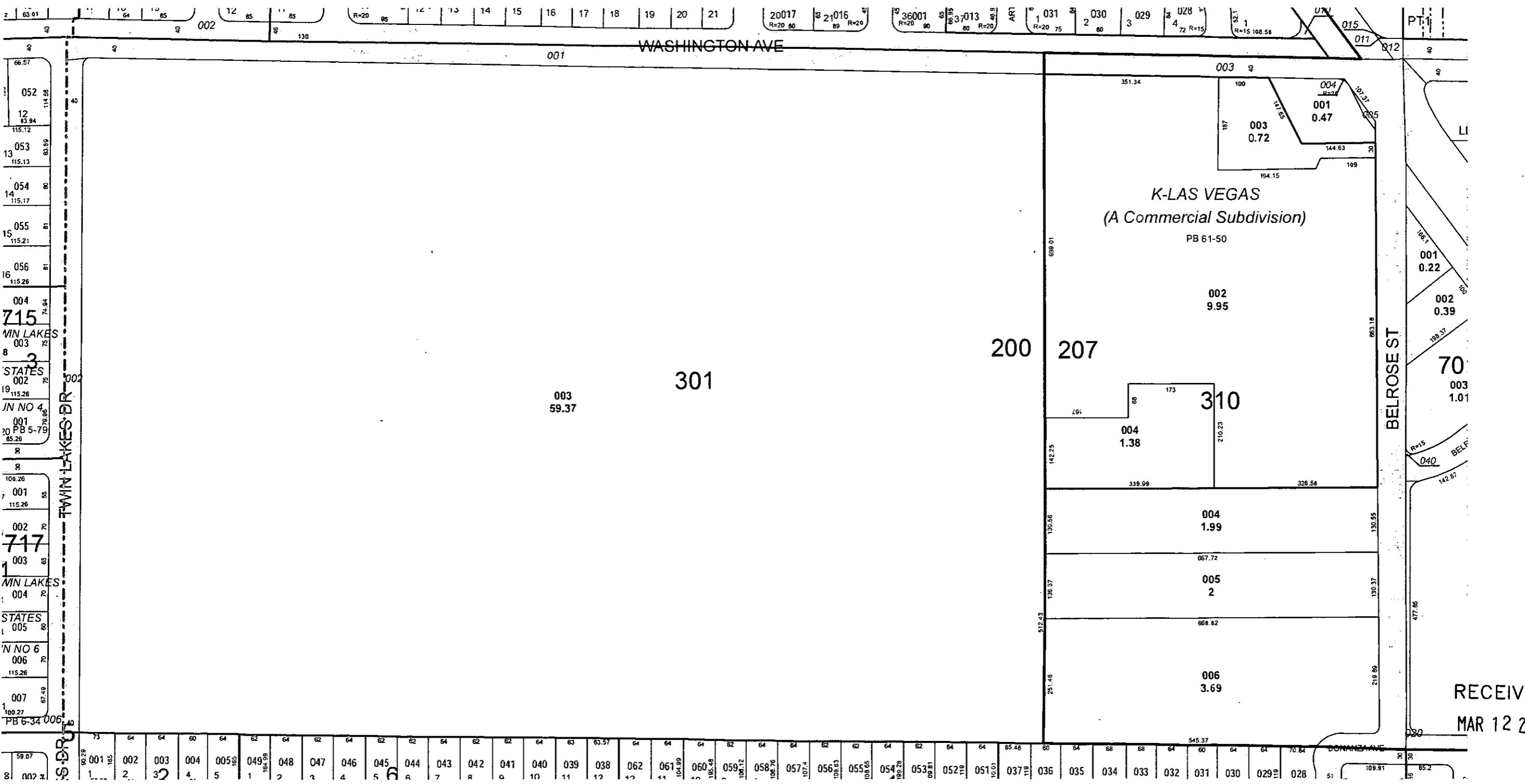

RECEIVED  
 MAR 12 2012

TAX DIST 207,200



Washington

Street

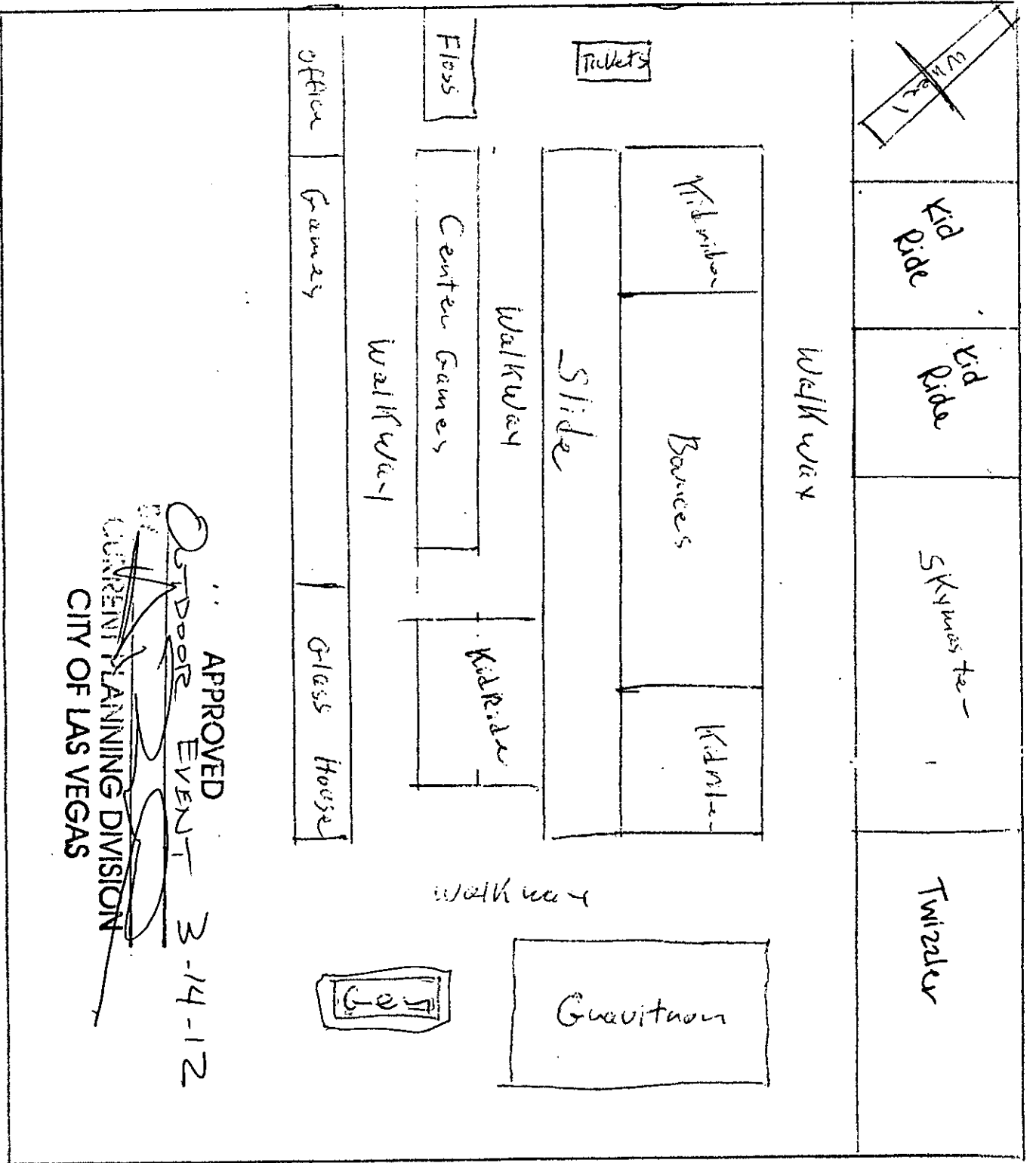

APPROVED  
 OUTDOOR EVENT 3-14-12  
 CONCURRENT PLANNING DIVISION  
 CITY OF LAS VEGAS

floor drawing

Not to Scale

RECEIVED  
MAR 12 2012

# Washington

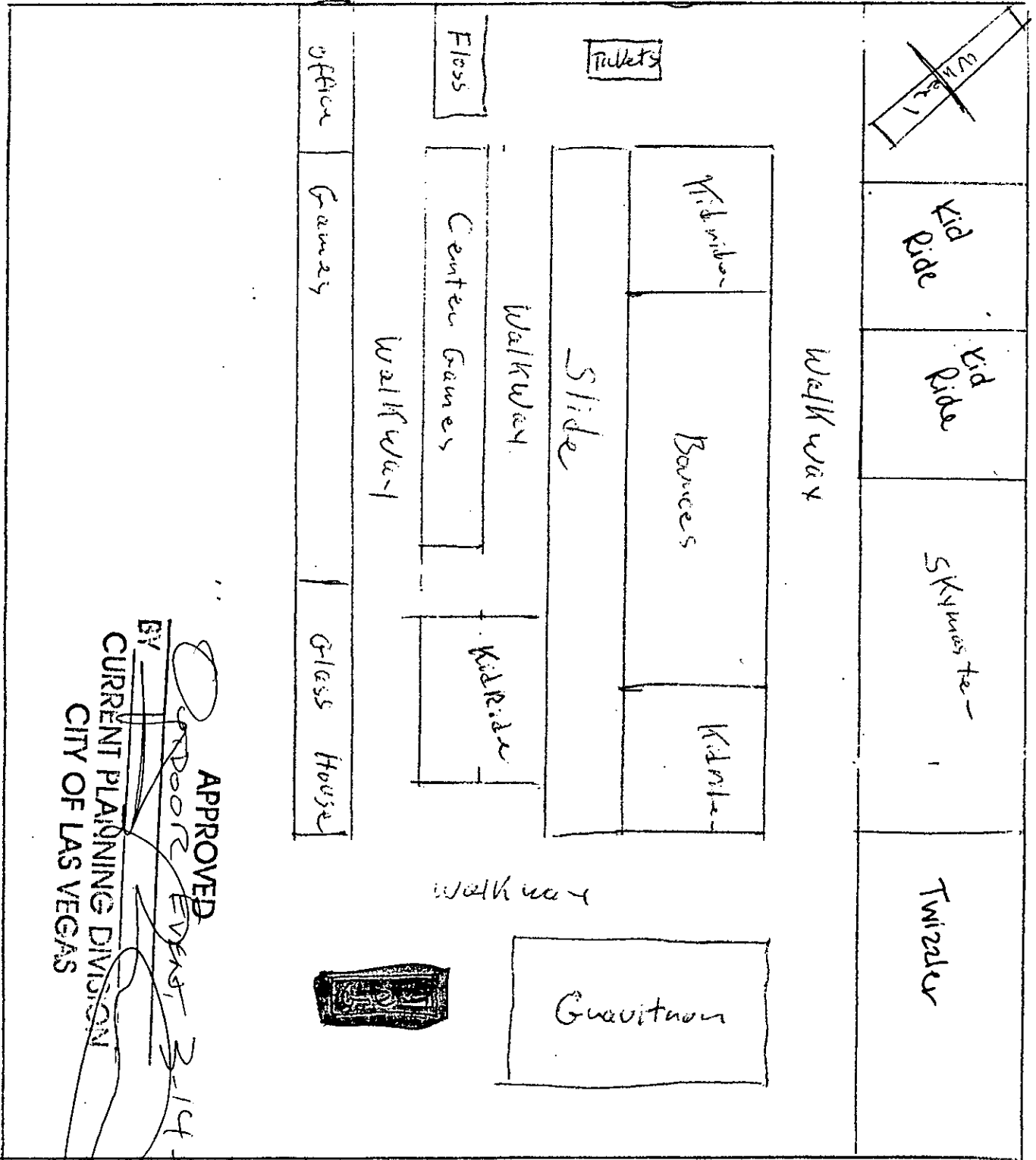

Street

APPROVED  
 BY  BOOR EYER, 3-14-11  
 CURRENT PLANNING DIVISION  
 CITY OF LAS VEGAS

floor plans

Not to Scale

RECEIVED  
 MAR 12 2012



DEPARTMENT OF PLANNING

APPLICATION / PETITION FORM

Application/Petition For: Paradise Amusements  
 Project Address (Location): 2901 W Washington Ave  
 Project Name: Paradise Amusements Carnival Proposed Use: carnival  
 Assessor's Parcel #(s): 139-29-310-002 Ward #: \_\_\_\_\_  
 General Plan: existing \_\_\_\_\_ proposed \_\_\_\_\_ Zoning: existing \_\_\_\_\_ proposed \_\_\_\_\_  
 Commercial Square Footage: 300 x 200 Floor Area Ratio: \_\_\_\_\_  
 Gross Acres: \_\_\_\_\_ Lots/Units: \_\_\_\_\_ Density: \_\_\_\_\_  
 Additional Information: carnival March 23-25, March 30 - April 1, 2012  
inclusive dates March 23 - April 1, 2012

PROPERTY OWNER: BJ Rancho Investments Contact: John  
 Address: 2901 W Washington Ave Phone: (313) 717 Fax: \_\_\_\_\_  
 City: Las Vegas State: NV Zip: 89107  
 E-mail Address: \_\_\_\_\_

APPLICANT: Paradise Amusements Contact: Sherry McKay  
 Address: PO Box 1149 Phone: 660-6829 Fax: 651-1958  
 City: Coeur d'Alene State: ID Zip: 83816  
 E-mail Address: paradiseamusements@gmail.com

REPRESENTATIVE: Sherry McKay Contact: same  
 Address: PO Box 1149 Phone: 660-6829 Fax: 651-1958  
 City: Coeur d'Alene State: ID Zip: 83816  
 E-mail Address: same

Property Owner Signature\* [Signature]  
 \* An authorized agent may sign in lieu of the property owner for Final Maps, Tentative Maps, and Parcel Maps.  
 Print Name: SUSAN CHOI  
 Subscribed and sworn before me  
 This 9<sup>th</sup> day of March, 2012  
[Signature]

FOR DEPARTMENT USE ONLY  
 Case # TCP-44828  
 Meeting Date: \_\_\_\_\_  
 Total Fee: \$ 100.00  
 Date Received:\* 3/12/12  
 Received By: [Signature]

Notary Public in and for said County and State of Nevada  
 THOMAS B. BRISTOW  
 Commission # 1820784  
 Notary Public - California  
 Los Angeles County  
 My Comm. Expires Oct 30, 2012

\*The application will not be deemed complete until the submitted materials have been reviewed by the Department of Planning for consistency with applicable sections of the Zoning Ordinance.  
 @:\depot\Application Packet\Application Form.pdf

FROM: RANCHO DISCOUNT FIELD  
 RECEIVED  
 MAR 12 2012

**BJ RANCHO INVESTMENT, INC.**

Business Entity Information			
Status:	Active	File Date:	9/2/1997
Type:	Domestic Corporation	Entity Number:	C18606-1997
Qualifying State:	NV	List of Officers Due:	9/30/2012
Managed By:		Expiration Date:	
NV Business ID:	NV19971254900	Business License Exp:	9/30/2012

Registered Agent Information			
Name:	JAMES YU	Address 1:	2560 MONTESSOURI ST.
Address 2:	#208	City:	LAS VEGAS
State:	NV	Zip Code:	89117
Phone:		Fax:	
Mailing Address 1:		Mailing Address 2:	
Mailing City:		Mailing State:	
Mailing Zip Code:			
Agent Type:	Noncommercial Registered Agent		

Financial Information			
No Par Share Count:	0	Capital Amount:	\$ 10,000.00
Par Share Count:	10,000.00	Par Share Value:	\$ 1.00

Officers		<input type="checkbox"/> Include Inactive Officers	
President - SUSAN OK CHOI			
Address 1:	937 VIA RINCON	Address 2:	
City:	PALOS VERDES PENINSULA	State:	CA
Zip Code:	90274	Country:	
Status:	Active	Email:	
Secretary - SUSAN OK CHOI			
Address 1:	937 VIA RINCON	Address 2:	
City:	PALOS VERDES PENINSULA	State:	CA
Zip Code:	90274	Country:	
Status:	Active	Email:	
Treasurer - SUSAN OK CHOI			
Address 1:	937 VIA RINCON	Address 2:	
City:	PALOS VERDES PENINSULA	State:	CA
Zip Code:	90274	Country:	
Status:	Active	Email:	
Director - SUSAN OK CHOI			
Address 1:	937 VIA RINCON	Address 2:	
City:	PALOS VERDES PENINSULA	State:	CA
Zip Code:	90274	Country:	
Status:	Active	Email:	

Actions\Amendments		RECEIVED
Action Type:	Articles of Incorporation	MAR 12 2012





# PARADISE AMUSEMENTS

P.O. BOX 1149 Cour d'Alene, ID 83816  
Ph: (800) 699-7433 Mobile: (208) 660-6829

## PARADISE AMUSEMENTS

Paradise Amusements is **geared more towards the family**, rather than the teenage market. This will attract the right demographics to the venue. The rides are clean, state-of-the-art carnival rides and are consistently checked by all appropriate governing agencies.

Paradise Amusements is involved in numerous state and county fairs. Again, this is a first-rate, quality show. Load in will be Tuesday as set-up requires a minimum two days for safety reasons, opening day will be on Thursday or Friday:

<b>Hours:</b>	<b>Weekdays</b>	<b>5:00 PM – 11:00PM</b>
	<b>Saturday</b>	<b>2:00 PM – 11:00 PM</b>
	<b>Sunday</b>	<b>2:00 PM– 11:00 PM</b>

A combination of approximately ten to twelve kiddie and major rides will occupy the lot, along with approximately six games. Three small bunkhouses accompany the show. The carnival arranges itself so that minimal, if any, impact on traffic flow or parking in or around event area results. Anticipated attendance is approximately 300 people a day. Revenues are generally up at stores in strip centers when the carnival is in their parking lot!

The carnival is fully self-contained, powered by a **Caterpillar 350 KW generator**. **All ground wires are matted**. The carnival takes up approximately 200 feet by 200 feet. The carnival provides porta-potties and these are serviced on an as needed basis. **The carnival is secured by its own in-house security 24 hours a day, seven days a week**. A source of water will need to be accessible for carnival for general clean - up purposes.

Paradise Amusements provides an insurance certificate naming the venue, all other interested entities and the city as additionally insured. Additionally, Paradise Amusements will secure its own operating permits from appropriate governing agencies. Paradise Amusements will return the site to its original condition upon departure. .

**Paradise Amusements would like to conduct a carnival at the Rancho Swapmeet, 2901 W Washington from March 22 – March 24 and March 30 – April 1 2012.** I can be reached at (310) 309-0343 if you have any questions or concerns. Please visit the website at [www.paradiseamusements.com](http://www.paradiseamusements.com).

Alexis Kaiser  
Booking Agent  
Paradise Amusements

RECEIVED  
MAR 12 2012

## **GENERAL PLAN ADDENDUM**

1. The proposed use is compatible with existing land used on the same property and on surrounding properties. This is to say that the demographics of shopping center will be the same as the carnival and will actually help generate traffic thereby increasing business. The carnival will not interfere with current business(s) in surrounding area.
2. The subject site is physically suitable for type and intensity of the use being provided. This is a small carnival and will have little or no impact on property. No holes will be drilled and no permanent change to property will be made.
3. There will be adequate public access to site and adequate provision for onsite parking.
4. The application is not a continuation of consecutive applications or otherwise an attempt circumvent the general plan of the property.



# TEMPORARY COMMERCIAL PERMIT

## AMUSEMENT SYSTEMS

TCP-44828

Valid March 22, 2012 To April 01, 2012

**Description of Event:** A combination of approximately 10-12 kiddie and major rides will occupy the lot, along with 6 games. Attendance is 300 people per day. Paradise Amusements would like to conduct a carnival from March 22-24th and March 30-April 1, 2012. Weekday hours 5pm-11pm, Saturday 2pm - 11pm and; Sunday 2pm-11pm

**Applicant:** Paradise Amusements  
Po Box 1149  
Couer D'alene, ID 83816  
(208)660-6829 x

**Parcel(s):** 139-29-310-002  
**Ward(s):** WARD 5 (RICKI Y. BARLOW)

**THIS PERMIT IS APPROVED PURSUANT TO SECTION 19.18.100 OF THE LAS VEGAS MUNICIPAL CODE, SUBJECT TO THE FOLLOWING CONDITIONS:**

See page 2 for conditions

**THIS TEMPORARY COMMERCIAL PERMIT IS NOT VALID UNTIL THE FOLLOWING DEPARTMENT APPROVALS / PERMITS / LICENSES HAVE BEEN OBTAINED:**

FIRE \_\_\_\_\_ (Initials)

BUSINESS SERVICES \_\_\_\_\_ (Initials)

SEWER \_\_\_\_\_ (Initials)

TRAFFIC \_\_\_\_\_ (Initials)

**THIS PERMIT SHALL BE POSTED IN A CONSPICUOUS PLACE**



# TEMPORARY COMMERCIAL PERMIT

## AMUSEMENT SYSTEMS

TCP-44828

Valid March 22, 2012 To April 01, 2012

1. BUSINESS HOURS SHALL BE FROM 2pm TO 11pm
2. THIS PERMIT IS NOT A BUSINESS LICENSE.
3. THIS PERMIT IS NOT A SUBSTITUTE FOR ANY REQUIRED STATE OR LOCAL BUSINESS LICENSE OR FOR ANY REQUIRED CHARITABLE SOLICITATION PERMIT.
4. This use shall not create a nuisance to nearby properties as a result of factors such as excessive illumination, glare, noise, vibration, smoke, dust, dirt, odors, gases or heat.
5. The use shall conform to the submitted plot plan date stamped 3-14-12.
6. No combustible materials shall be located within 50 feet of any structure on, or adjacent to this site.
7. No building or structure of any type shall be erected closer than 25 feet from any property line.
8. The applicant shall display a copy of this Temporary Commercial Permit during the hours of operation.
9. Sanitation facilities must be provided in accordance with the Clark County Health District and Republic Services of Southern Nevada.
10. The applicant shall provide private security officers as required by the Las Vegas Metropolitan Police Department.
11. Any signage for this temporary commercial use must be approved and permitted by the Planning and Development Department.
12. All applicable City code requirements shall be satisfied.
13. The applicant shall be responsible for leaving the site free of debris, litter or any other evidence of occupancy upon completion or removal of the use.

3-14-12

PLANNING SUPERVISOR SIGNATURE

DATE

PLANNING MANAGER SIGNATURE

DATE

**THIS PERMIT SHALL BE POSTED IN A CONSPICUOUS PLACE**