

This map is for assessment use only and does NOT represent a survey.

No liability is assumed for the accuracy of the data delineated herein. Information on roads and other non-assessed parcels may be obtained from the Road Document Listing in the Assessor's Office.

This map is compiled from official records, including surveys and deeds, but only contains the information required for assessment. See the recorded documents for more detailed legal information.

USE THIS SCALE (FEET) WHEN MAP REDUCED FROM 11X17 ORIGINAL

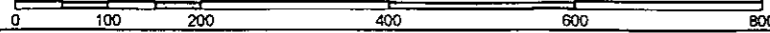

NOTES

MAP LEGEND

- PARCEL BOUNDARY
- SUB BOUNDARY
- PM/LD BOUNDARY
- ROAD EASEMENT
- MATCH / LEADER LINE
- HISTORIC LOT LINE
- HISTORIC SUB BOUNDARY
- HISTORIC PM/LD BOUNDARY
- SECTION LINE
- CONDOMINIUM UNIT
- AIR SPACE PCL
- RIGHT OF WAY PCL
- SUB-SURFACE PCL
- 001 ROAD PARCEL NUMBER
- 001 PARCEL NUMBER
- 1.00 ACREAGE
- 202 PARCEL SUB/SEQ NUMBER
- PB 24-45 PLAT RECORDING NUMBER
- 5 BLOCK NUMBER
- 5 LOT NUMBER
- GL5 GOV. LOT NUMBER

ASSESSOR'S PARCELS - CLARK CO., NV. Michele W. Shafe - Assessor

BOOK T20S R61E

SEC. 29

MAP N 2 SE 4

139-29-7

126	125	124	123
137	138	139	148
154	163	162	161
176	176	177	178

6	5	4	3	2	1
7	8	9	10	11	12
13	14	15	16	17	18
19	20	21	22	23	24
25	26	27	28	29	30
31	32	33	34	35	36

8	4	8	4
5	1	5	1
6	2	6	2
7	3	7	3
8	4	8	4
5	1	5	1

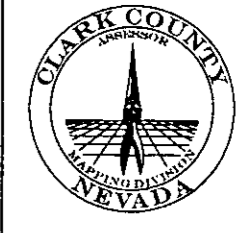

Scale: 1" = 200' Rev: 02/09/2011

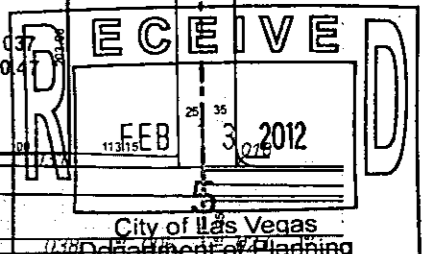
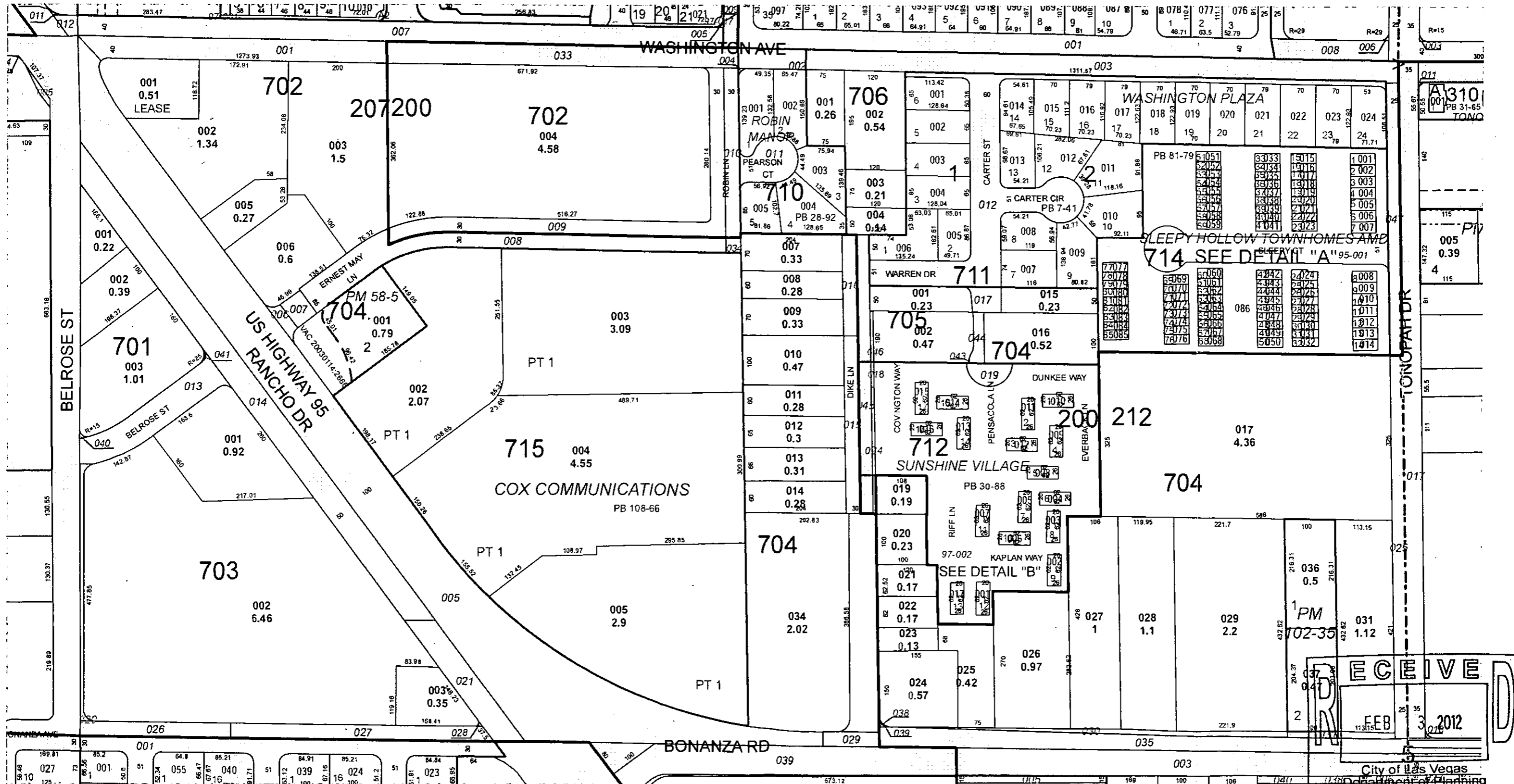

TAX DIST 212,207,200



DEPARTMENT OF PLANNING

APPLICATION / PETITION FORM

Application/Petition For: Vending Valentine's day items
Project Address (Location) 8401/844 Rancho LV, NV 89106
Project Name Valentine's Day vendor Proposed Use Vending Stand
Assessor's Parcel #(s) 139-29-702-002 Ward #
General Plan: existing proposed Zoning: existing proposed
Commercial Square Footage Floor Area Ratio
Gross Acres 1.34 Lots/Units Density
Additional Information Vacant Lot

PROPERTY OWNER 840/844 RANCHO LLC Contact
Address 1125 Cashman Dr. Phone: Fax:
City Las Vegas State NV Zip 89102
E-mail Address

APPLICANT Teresita Regina Carmak Contact
Address 1001 Essex West Phone: 247-6836 Fax:
City Las Vegas State NV Zip 89107
E-mail Address LV132.play@yahoo.com

REPRESENTATIVE Contact
Address SAME as Phone: Fax:
City Above State Zip
E-mail Address

Property Owner Signature* [Signature]
* An authorized agent may sign in lieu of the property owner for Final Maps, Tentative Maps, and Parcel Maps.
Print Name JOHNNY J. PAPPAS JR
Subscribed and sworn before me
This 10th day of FEBRUARY, 2012.
Sharon Yamane

Notary Public in and for said County and State SHARON L. YAMANE
NOTARY PUBLIC
STATE OF NEVADA
My Commission Expires 03-29-13
Certificate No: 99-35503-1

Revised 10/27/08

FOR DEPARTMENT USE ONLY

Case # 44597
TCP-44597a
Meeting Date: N/A
Total Fee: \$100
Date Received:* 2/13/12
Received By: [Signature]

RECEIVED
FEB 13 2012
City of Las Vegas
Department of Planning

*The application will not be deemed complete until the submitted materials have been reviewed by the Department of Planning for consistency with applicable sections of the Zoning Ordinance.
File in Application Packet Application Form.pdf

We are setting up tables and chairs (folding) to sell Valentine's items. Stuffed animals and silk flower arrangements. We will set up 3 folding tables with tarps underneath, along with 3 folding chairs. We are scheduled to work from 3p.m. - 8pm on the ^{February} 13th. Then on Valentine's Day we are scheduled to work 8AM to 8pm. On Feb 15th 6AM - 11AM for the night shift work who forgot Valentine's Day.

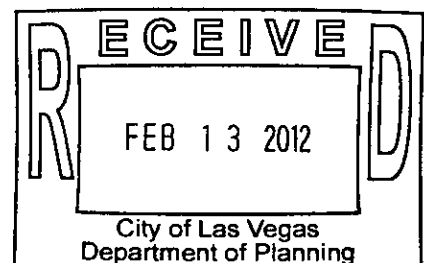

This is a lease and waiver of liability for leasing the property for consideration of \$1.00, the undersigned tenant agrees that he/she has leased the vacant land at 840 South Rancho Las Vegas, Nevada 89106 from 02-10-2012 to 02-15-2012 for the sole purpose to sale Valentine's Day items. The undersigned has seen and examined the vacant lot at 840 South Rancho Las Vegas, Nevada 89106 and found it in good condition and shall relinquish said property to landlord 02-16-2012 in the same condition. If tenant fails to abide by this contract the 840/844 S Rancho LLC shall rescind the use of the property. **840/844 S Rancho LLC., Johnny Pappas and affiliates** are not responsible for accidents, claims, demands, losses, costs, expenses, obligations, liabilities, damages, recoveries and/or deficiencies, including interest, penalties that may occur, or suffer which arise, result from or relate to the lease of the vacant lot at 840 South Rancho Las Vegas, Nevada 89106 by tenant, any guest of tenant, or to any other persons using vacant lot at 840 South Rancho Las Vegas, Nevada 89106 or to any claim by any other persons injured on account of vacant lot 840 South Rancho Las Vegas, Nevada 89106 in the possession of the tenant caused directly or indirectly in the use of the tenant.

Landlord

Tenant

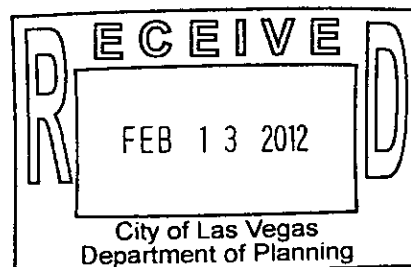

840/844 RANCHO, LLC

Business Entity Information			
Status:	Active	File Date:	9/08/2009
Type:	Domestic Limited-Liability Company	Entity Number:	E0481772009-5
Qualifying State:	NV	List of Officers Due:	9/30/2012
Managed By:	Managers	Expiration Date:	
NV Business ID:	NV20091100578	Business License Exp:	9/30/2012

Additional Information	
Central Index Key:	

Registered Agent Information			
Name:	SHIRLEY A. DERKE, ESQ.	Address 1:	415 S SIXTH ST STE 200K
Address 2:		City:	LAS VEGAS
State:	NV	Zip Code:	89101
Phone:		Fax:	
Mailing Address 1:		Mailing Address 2:	
Mailing City:		Mailing State:	NV
Mailing Zip Code:			
Agent Type:	Commercial Registered Agent		
Status:	Active		

Financial Information			
No Par Share Count:	0	Capital Amount:	\$ 0
No stock records found for this company			

Officers				<input type="checkbox"/> Include Inactive Officers
Manager - HARRY J PAPPAS				
Address 1:	P. O. BOX 28668	Address 2:		
City:	LAS VEGAS	State:	NV	
Zip Code:	89126	Country:		
Status:	Active	Email:		
Manager - JOHN J PAPPAS				
Address 1:	1125 CASHMAN DRIVE	Address 2:		
City:	LAS VEGAS	State:	NV	
Zip Code:	89102	Country:		
Status:	Active	Email:		

Actions\Amendments			
Action Type:	Articles of Organization	# of Pages:	1
Document Number:	20090668719-28	Effective Date:	
File Date:	9/08/2009		
(No notes for this action)			
Action Type:	Initial List		

RECEIVED

FEB 13 2012

City of Las Vegas
Department of Planning

Document Number:	20090714053-61	# of Pages:	1
File Date:	9/30/2009	Effective Date:	
(No notes for this action)			
Action Type:	Annual List		
Document Number:	20100648785-31	# of Pages:	1
File Date:	8/30/2010	Effective Date:	
(No notes for this action)			
Action Type:	Annual List		
Document Number:	20110622083-25	# of Pages:	1
File Date:	8/25/2011	Effective Date:	
(No notes for this action)			

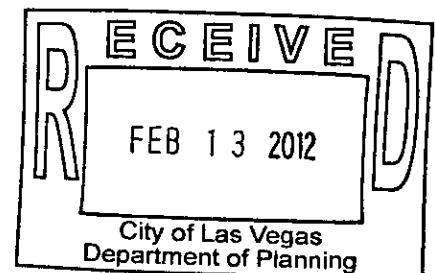



OPENWEB

Submit Quick Search

(Parcel/Address Search/Owner)

- Search
- Display Options
- Tools
- Points of Interest
- Resources

Introduction

The commission district boundaries have been updated in OpenWeb.

A new aerial imagery dataset is available on OpenWeb that covers most of the county. It was flown in 2010 and is 1 meter resolution. In Display Options in the flight dropdown list select NAIP 2010.

You now have the ability to right click on the map and print directly from OpenWeb

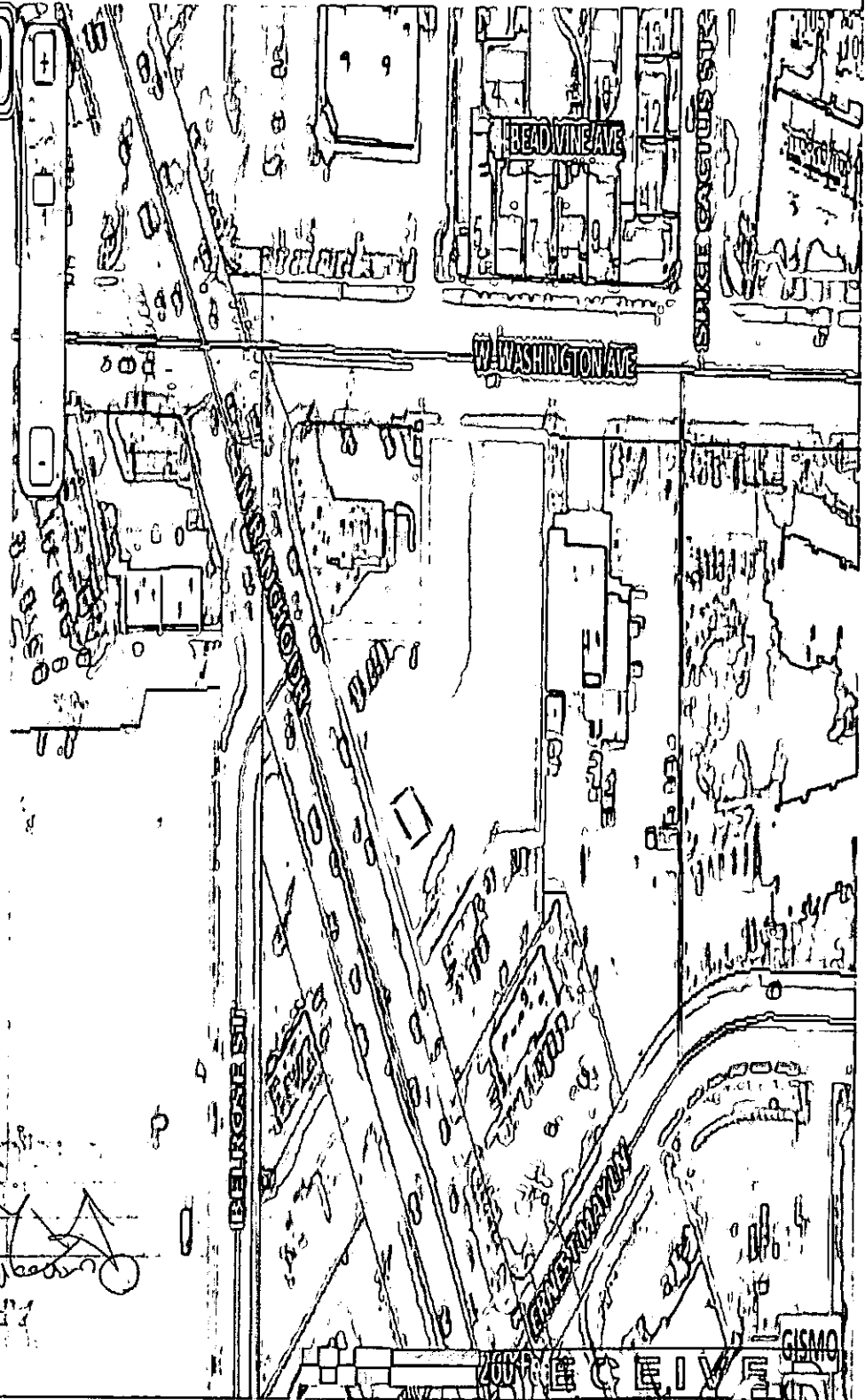

PLANNING DIVISION
CITY OF LAS VEGAS

APPROVED
2/13/12

RECEIVED

FEB 13 2012

2/13/2012

City of Las Vegas
Department of Planning



TEMPORARY COMMERCIAL PERMIT

VALENTINES DAY FLOWERS

TCP-44597

Valid February 13, 2012 To February 15, 2012

Description of Event: TCP-44597 - Temporary Commercial Permit for Valentine's Day Sales at 840 N. Ranch Drive. The sales will take place February 13th, 2012 through February 15th, 2012. The hours of operation on the 13th will be 3pm - 8pm, on the 14th 8am - 8pm, and on the 15th 6am - 11am. The items to be sold will be stuffed animals and silk flowers. There will be three folding tables to be used.

Applicant: Teresita Regina Carmark
1001 Essex West
Las Vegas, NV 89107
(702)247-6836 x

Parcel(s): 139-29-702-002
Ward(s): WARD 5 (RICKI Y. BARLOW)

THIS PERMIT IS APPROVED PURSUANT TO SECTION 19.18.100 OF THE LAS VEGAS MUNICIPAL CODE, SUBJECT TO THE FOLLOWING CONDITIONS:

See page 2 for conditions

THIS TEMPORARY COMMERCIAL PERMIT IS NOT VALID UNTIL THE FOLLOWING DEPARTMENT APPROVALS / PERMITS / LICENSES HAVE BEEN OBTAINED:

FIRE _____ (Initials)

BUSINESS SERVICES _____ (Initials)

SEWER _____ (Initials)

TRAFFIC _____ (Initials)

THIS PERMIT SHALL BE POSTED IN A CONSPICUOUS PLACE



TEMPORARY COMMERCIAL PERMIT

VALENTINES DAY FLOWERS

TCP-44597

Valid February 13, 2012 To February 15, 2012

1. BUSINESS HOURS SHALL BE FROM 6am TO 8pm.
2. THIS PERMIT IS NOT A BUSINESS LICENSE.
3. THIS PERMIT IS NOT A SUBSTITUTE FOR ANY REQUIRED STATE OR LOCAL BUSINESS LICENSE OR FOR ANY REQUIRED CHARITABLE SOLICITATION PERMIT.
4. This use shall not create a nuisance to nearby properties as a result of factors such as excessive illumination, glare, noise, vibration, smoke, dust, dirt, odors, gases or heat.
5. The use shall conform to the submitted plot plan date stamped 2-13-12.
6. No combustible materials shall be located within 50 feet of any structure on, or adjacent to this site.
7. No building or structure of any type shall be erected closer than 25 feet from any property line.
8. The applicant shall display a copy of this Temporary Commercial Permit during the hours of operation.
9. Sanitation facilities must be provided in accordance with the Clark County Health District and Republic Services of Southern Nevada.
10. The applicant shall provide private security officers as required by the Las Vegas Metropolitan Police Department.
11. Any signage for this temporary commercial use must be approved and permitted by the Planning and Development Department.
12. All applicable City code requirements shall be satisfied.
13. The applicant shall be responsible for leaving the site free of debris, litter or any other evidence of occupancy upon completion or removal of the use.

2-13-12

PLANNING SUPERVISOR SIGNATURE

DATE

PLANNING MANAGER SIGNATURE

DATE

THIS PERMIT SHALL BE POSTED IN A CONSPICUOUS PLACE