



LAS VEGAS CITY COUNCIL

OSCAR B. GOODMAN
MAYOR

GARY REESE
MAYOR PRO TEM

STEVE WOLFSON

LOIS TARKANIAN

STEVEN D. ROSS

RICKI Y. BARLOW

STAVROS S. ANTHONY

ELIZABETH N. FRETWELL
CITY MANAGER

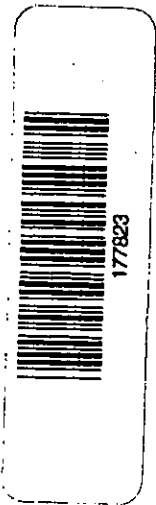

May 20, 2010

Mr. Barry Becker
Fremont West, LLC
50 South Jones Boulevard
Las Vegas, Nevada 89107

RE: SUP-37618 -- SPECIAL USE PERMIT
CITY COUNCIL MEETING OF MAY 19, 2010

Dear Mr. Becker:

The City Council at a regular meeting held May 19, 2010, APPROVED the request for a Special Use Permit TO ADD A JEWELRY STORE, CLASS III USE TO AN EXISTING 2,000 SQUARE-FOOT AUTO TITLE LOAN ESTABLISHMENT at 6378 West Lake Mead Boulevard (APN 138-23-601-003), C-1 (Limited Commercial) Zone. The Notice of Final Action was filed with the Las Vegas City Clerk on May 20, 2010. This approval is subject to:

Planning and Development

1. Conformance to all Minimum Requirements under LVMC Title 19.04.010 for a Jewelry Store, Class III use.
2. This approval shall be void one year from the date of final approval, unless a business license has been issued to conduct the activity, or upon approval of a final inspection. An Extension of Time may be filed for consideration by the City of Las Vegas.
3. All City Code requirements and design standards of all City departments must be satisfied, except as modified herein.

Sincerely,

Angela Crolli
Deputy City Clerk II for
Beverly K. Bridges, MMC, City Clerk

cc: Mr. Jim Marchesi
Check City
2640. Crimson Canyon
Las Vegas, Nevada 89128

CITY OF LAS VEGAS
400 STEWART AVENUE
LAS VEGAS, NEVADA 89101

VOICE 702.229.6011

TTY 702.386.9108

www.lasvegasnevada.gov

FM-0044-08-09

PLANNING & DEVELOPMENT



DEVELOPMENT SERVICES CENTER

731 S. Fourth Street
Los Vegas, NV 89101

Voice: 702-229-6301
Fax: 702-474-0352
TTY: 702-386-9108

www.lasvegasnevada.gov

April 23, 2010

Mr. Barry Becker
Fremont West, LLC
50 South Jones Boulevard
Las Vegas, Nevada 89107

**RE: SUP-37618 - SPECIAL USE PERMIT
PLANNING COMMISSION MEETING OF APRIL 22, 2010**

Dear Mr. Becker:

Your request for a Special Use Permit TO ADD A JEWELRY STORE, CLASS III USE TO AN EXISTING 2,000 SQUARE-FOOT AUTO TITLE LOAN ESTABLISHMENT at 6378 West Lake Mead Boulevard (APN 138-23-601-003), C-1 (Limited Commercial) Zone, Ward 5 (Barlow), was considered by the Planning Commission on April 22, 2010.

The Planning Commission voted to recommend **APPROVAL** of your request, subject to the following:

Planning and Development

1. Conformance to all Minimum Requirements under LVMC Title 19.04.010 for a Jewelry Store, Class III use.
2. This approval shall be void one year from the date of final approval, unless a business license has been issued to conduct the activity, or upon approval of a final inspection. An Extension of Time may be filed for consideration by the City of Las Vegas.
3. All City Code requirements and design standards of all City departments must be satisfied, except as modified herein.

Mayor
Oscar B. Goodman

City Council
Gary Reese
(Mayor Pro Tem)
Steve Wolfson
Lois Torkanian
Steven D. Ross
Ricki Y. Barlow
Stavros S. Anthony
City Manager
Elizabeth N. Fretwell



Mr. Barry Becker
SUP-37618 - Page Two
April 23, 2010

This item will be considered by the City Council on May 19, 2010, at 1:00 P.M. in the Council Chambers of City Hall, 400 Stewart Avenue, Las Vegas, Nevada. ***The Council requires that you or your representative be present at this meeting.*** If you or your representative chooses not to attend, the City Council may act in your absence without your input.

Sincerely,

A handwritten signature in black ink, appearing to read 'Steve Gebeke', with a long horizontal line extending to the right.

Steve Gebeke
Planning Supervisor
Case Planning Division

SG:clb

cc: Mr. Jim Marchesi
Check City
2640 Crimson Canyon
Las Vegas, Nevada 89128

From: unknown Page: 2/9 Date: 4/21/2010 10:28:48 AM

CITY OF LAS VEGAS	
ONE MOTION / ONE VOTE	
	Planning and Development Department
	Case Planning Division
	731 South Fourth Street
	Las Vegas, Nevada 89101
(702) 229-6301 Phone (702) 385-7268 Fax	

SUBJECT: SUP-37618 - APPLICANT: CHECK CITY - OWNER: FREMONT WEST, LLC

The above item has been placed on the One Motion/One Vote portion of the Planning Commission Agenda for the **APRIL 22, 2010** Planning Commission meeting. All of these items will be placed at the beginning of the agenda. The Chairman of the Planning Commission will open them at the same time.

Enclosed please find the proposed conditions of approval. If you agree to these conditions, please sign this form and fax it to **Carman Burney at (702) 385-7268**. If there is no one present at the Planning Commission meeting who wants to discuss this item, you will not be called to the podium to discuss the case. However, you must be present in case any Planning Commissioner or member of the public wants to discuss the item. If you have any questions, please contact my office at (702) 229-6301.

Please sign and date that you have read and agree to the conditions and return to our office by 5:00PM APRIL 21, 2010.

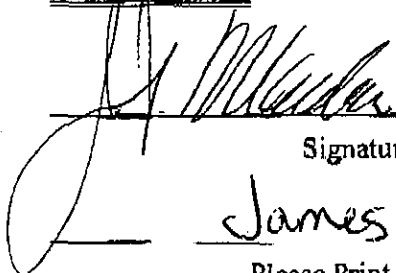

 Signature

 Date

James Marchesi
 Please Print Name

Check City
 Company Name

Sincerely,

Steve Gebeke
Planning Supervisor
Case Planning Division

RECEIVED

APR 21 2010

PLANNING & DEVELOPMENT



DEVELOPMENT SERVICES CENTER

731 S. Fourth Street
Las Vegas, NV 89101

Voice: 702-229-6301
Fax: 702-474-0352
TTY: 702-386-9108

www.lasvegasnevada.gov

April 9, 2010

Mr. Barry Becker
Fremont West, LLC
50 South Jones Boulevard
Las Vegas, Nevada 89107

**RE: SUP-37618 - SPECIAL USE PERMIT
PLANNING COMMISSION MEETING OF APRIL 22, 2010**

Dear Mr. Becker:

Please be advised the City of Las Vegas Planning Commission at its regular meeting on *April 22, 2010* as referred to above, will consider your request. This meeting will be held at 6:00 P. M. at the Council Chambers of City Hall, 400 Stewart Avenue, Las Vegas, Nevada.

A copy of staff's recommendations, any conditions related to your application and the *final agenda* will be available on-line on *Friday, April 16, 2010* at www.lasvegasnevada.gov. If you do not have access to the Internet and would prefer receiving hard copies of the documentation, please call the Case Planning Division at (702) 229-6301 or come into the Development Services Center at 731 South Fourth Street to request your copies.

The Planning Commission requires that you or your representative be present at this meeting.

Sincerely,

Steve Gebeke
Planning Supervisor
Case Planning Division

SG:clb

cc: Mr. Jim Marchesi
Check City
2640 Crimson Canyon
Las Vegas, Nevada 89128

Mayor
Oscar B. Goodman

City Council
Gary Reese
(Mayor Pro Tem)
Steve Wolfson
Lais Tarkanian
Steven D. Rass
Ricki Y. Barlow
Stavros S. Anthany

City Manager
Elizabeth N. Fretwell



Memorandum

City of Las Vegas
Department of Public Works
Development Coordination

To: Department of Planning and Development
From: Bart Anderson, Manager, Development Coordination, Department of Public Works *BA*
CC: Nancy Almanzan, Right-of-Way; Wayne Dowdey, Land Development; O. C. White, Traffic Engineering; Alan Riekki, Survey (FM, PM, & A's only)
Date: March 22, 2010
Re: **SUP-37618** Check City 6378 W. Lake Mead Blvd.
Request for a Special Use Permit for a jewelry store, class III to an existing auto title loan and financial institution, specified

COMMENTS:

We have no comment on the Request for a Special Use Permit application to add a jewelry store, class III use to an existing auto title loan and financial institution, specified located at 6378 West Lake Mead Boulevard.

CITY OF LAS VEGAS

DEVELOPMENT REVIEW COMMENT FORM



Planning and Development Department
Current Planning Division
731 South Fourth Street
Las Vegas, Nevada 89101
(702) 229-6301 phone (702) 385-7268 fax

SUP-37618 - SPECIAL USE PERMIT - PUBLIC HEARING - APPLICANT: CHECK CITY - OWNER:
FREMONT WEST, LLC - Request for a Special Use Permit TO ADD A JEWELRY STORE, CLASS III USE
TO AN EXISTING 1,800 SQUARE-FOOT AUTO TITLE LOAN AND FINANCIAL INSTITUTION, SPECIFIED
at 6378 West Lake Mead Boulevard (APN 138-23-601-003), C-1 (Limited Commercial) Zone, Ward 5 (Barlow)

PLANNING COMMISSION: APRIL 22, 2010

PLANNING SUPERVISOR: STEVE GEBEKE



PUBLIC HEARING

CITY COUNCIL: IF APPROVED: MAY 19, 2010

IF DENIED: P.C. FINAL ACTION (Unless appealed within 10 days)

Comments Due: MARCH 23, 2010

Comments not returned by the due date will not be incorporated into the staff report for this case. Comments
may be submitted either on this sheet and routed via interoffice mail, U.S. mail, fax, or e-mailed to Carman
Burney (cburney@lasvegasnevada.gov), the Agenda Tech responsible for this case. If you desire to meet with
the case planner you may schedule an appointment by calling (702) 229-6301.

LIST COMMENTS BELOW: LUMPED INTERGOVERNMENTAL SERVICES

THE PROPOSED PROJECT WILL HAVE A MINIMAL IMPACT
ON POLICE SERVICES. IF THE APPLICANT IS GRANTED
THE REQUEST, LAS VEGAS METROPOLITAN POLICE REQUESTS
THE APPLICANT STRICTLY ADHERES TO LAS VEGAS
MUNICIPAL CODE 6.74.



CITY OF LAS VEGAS SIGN POSTING AFFIDAVIT



CASE NUMBER: SUP-37618

MEETING DATE: 04/22/10 PC

Sign Pro does hereby certify that a notice as required by Chapter 19.18.010(D) of the Zoning Code, was visibly posted for a period of not less than ten (10) calendar days prior to the first scheduled hearing.

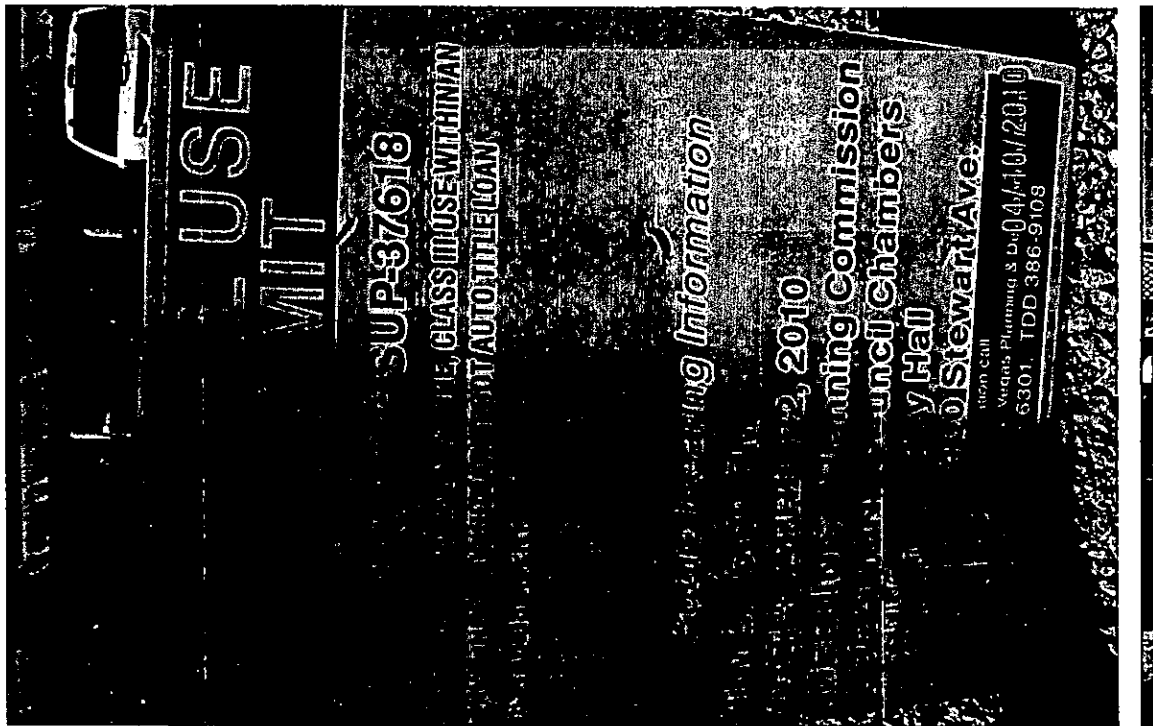

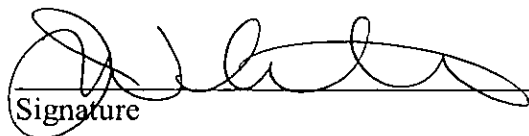
Signature

4-10-10
Date

This affidavit must be returned to the Planning and Development Department, Case Planning Division, at 731 South 4th Street during regular business hours three (3) business days prior to the subject application being heard by the Planning Commission or City Council.

Application Information

SUP-37618 - SPECIAL USE PERMIT - PUBLIC HEARING - APPLICANT: CHECK CITY - OWNER: FREMONT WEST, LLC - Request for a Special Use Permit TO ADD A JEWELRY STORE, CLASS III USE TO AN EXISTING 2,000 SQUARE-FOOT AUTO TITLE LOAN ESTABLISHMENT at 6378 West Lake Mead Boulevard (APN 138-23-601-003), C-1 (Limited Commercial) Zone, Ward 5 (Barlow)

Application Location

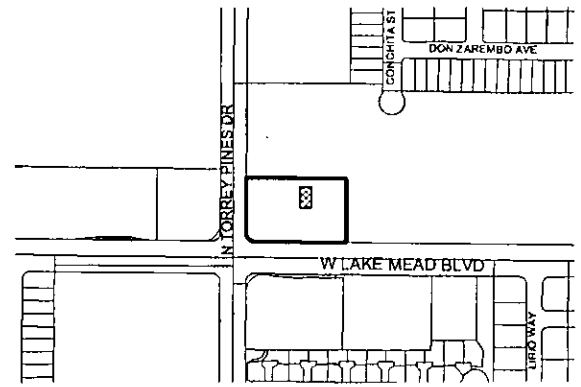

The proposed project may not pertain to the entire highlighted project site.

Public Hearing Information

Meeting: Planning Commission
Date: April 22, 2010
Time: 6:00 P.M.
Location: City Council Chambers
400 Stewart Avenue
Las Vegas, Nevada

Any and all interested persons may appear before the City Planning Commission either in person or by representative and object to or express approval of this request; or may, prior to this meeting, file a written objection thereto or approval thereof with the Planning and Development Department, Development Services Center, 731 South Fourth Street, Las Vegas, Nevada 89101. Final Action on General Plan Amendments and Rezonings will be determined by the City Council. Other public hearing items may be deemed Final Action by the Planning Commission or forwarded to the City Council. The date of the City Council meeting, if applicable, will be announced at the Planning Commission meeting after the discussion of the item. You may not receive an additional notice for the City Council meeting. For further information, please call (702) 229-6301 (TDD 386-9108) <http://www.lasvegasnevada.gov>.

Application Information

SUP-37618 - SPECIAL USE PERMIT - PUBLIC HEARING - APPLICANT: CHECK CITY - OWNER: FREMONT WEST, LLC - Request for a Special Use Permit TO ADD A JEWELRY STORE, CLASS III USE TO AN EXISTING 2,000 SQUARE-FOOT AUTO TITLE LOAN ESTABLISHMENT at 6378 West Lake Mead Boulevard (APN 138-23-601-003), C-1 (Limited Commercial) Zone, Ward 5 (Barlow)

Application Location

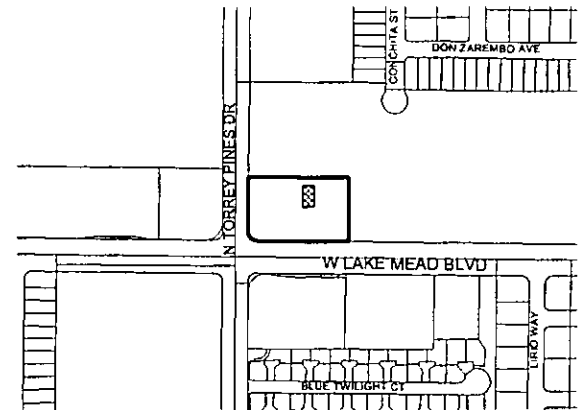

The proposed project may not pertain to the entire highlighted project site.

Public Hearing Information

Meeting: Planning Commission
Date: April 22, 2010
Time: 6:00 P.M.
Location: City Council Chambers
400 Stewart Avenue
Las Vegas, Nevada

Any and all interested persons may appear before the City Planning Commission either in person or by representative and object to or express approval of this request; or may, prior to this meeting, file a written objection thereto or approval thereof with the Planning and Development Department, Development Services Center, 731 South Fourth Street, Las Vegas, Nevada 89101. Final Action on General Plan Amendments and Rezonings will be determined by the City Council. Other public hearing items may be deemed Final Action by the Planning Commission or forwarded to the City Council. The date of the City Council meeting, if applicable, will be announced at the Planning Commission meeting after the discussion of the item. You may not receive an additional notice for the City Council meeting. For further information, please call (702) 229-6301 (TDD 386-9108) <http://www.lasvegasnevada.gov>.

City of Las Vegas
Planning & Development Department
Development Services Center
731 S. Fourth Street
Las Vegas, Nevada 89101-2986

Return Service Requested
Official Notice of Public Hearing

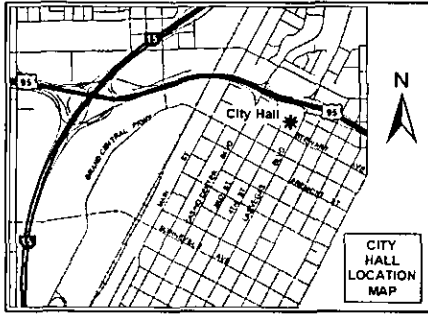

If you wish to file your protest or support on this request, check the appropriate box below and return this card in an envelope with postage to the Planning & Development Department at the address listed above or fax this side of this card to (702) 385-7268. If you would like to contact your Council Representative, please call (702) 229-6405.

I SUPPORT
this Request

I OPPOSE
this Request

Please use available blank space on card for your comments.

SUP-37618

Planning Commission Meeting of 4/22/2010

City of Las Vegas
Planning & Development Department
Development Services Center
731 S. Fourth Street
Las Vegas, Nevada 89101-2986

Return Service Requested
Official Notice of Public Hearing

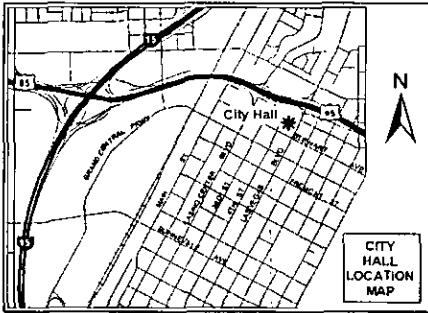

If you wish to file your protest or support on this request, check the appropriate box below and return this card in an envelope with postage to the Planning & Development Department at the address listed above or fax this side of this card to (702) 385-7268. If you would like to contact your Council Representative, please call (702) 229-6405.

I SUPPORT
this Request

I OPPOSE
this Request

Please use available blank space on card for your comments.

SUP-37618

Planning Commission Meeting of 4/22/2010

City of Las Vegas - Planning and Development Department.

Development Notification

PC Meeting: April 22, 2010

The following neighborhood associations are located within approximately one(1) mile of this development application and have been notified of this case by the Planning and Development Department:

SUP-37618

Alondra HOA

Bavington Court HOA

Charleston Heights 44-E Townhouse Owners
Association

Desert Park HOA

Paul Culley NA

Rock Creek Manor HOA

Rosewood HOA

Sierra Oeste NA

Smoke Ranch Maintenance District

Sterling Springs HOA

Tanglewood HOA

Vegas Drive HOA

Westchester Manor HOA

Westcliff-Tenaya NCG

CITY OF LAS VEGAS
INTER-OFFICE MEMORANDUM
REQUEST FOR COMMENT

FROM: PLANNING AND DEVELOPMENT

SUP-37618

HAND DELIVERED

*DEVELOPMENT COORDINATION (DPW)	GARY REID	DSC
FIRE ENGINEERING	OZZIE MIRKHAH	DSC
*FLOOD CONTROL (DPW)	RAUL CRUZ	DSC
*LAND DEVELOPMENT (DPW)	DAVID GUERRA	DSC
PERMITS/ INSPECTIONS	ROD CLARK	DSC
*RIGHT-OF-WAY (DPW)	MARY WULFF	DSC
*SANITARY SEWERS (DPW)	JOE PEÑA	DSC
*TRAFFIC ENGINEERING	RICK SCHROEDER	DSC

SENT VIA COURIER/ INTER-OFFICE MAIL/ OR US MAIL

<CCSD>	LINDA PERRI	4212 EUCALYPTUS ANNEX
METRO	BRIAN O'CALLAGHAN	7 th FLOOR CITY HALL
OFFICE OF BUSINESS DEVELOPMENT	TOM BURKART	2 nd FLOOR CITY HALL EXPANSION
NEIGHBORHOOD SERVICES	ANNE KILPONEN	2 nd FLOOR CITY HALL
*TEFO (DPW)	REBECCA WHITLOCK	3104 BONANZA ROAD
*SID (DPW)	PATRICK MURPHY	420 N. FOURTH STREET
*SURVEY (DPW)	ALAN RIEKKI	WEST YARD

*** ONLY THOSE INDICATED WITH A STAR ARE TO BE ROUTED TO GARY REID, SR. ENG. ASSOC. ALL OTHER DIVISIONS PLEASE ROUTE YOUR COMMENTS DIRECTLY TO THE PLANNING AND DEVELOPMENT DEPARTMENT < US MAIL DELIVERY >**

CITY OF LAS VEGAS

DEVELOPMENT REVIEW COMMENT FORM



Planning and Development Department
Current Planning Division
731 South Fourth Street
Las Vegas, Nevada 89101
(702) 229-6301 phone (702) 385-7268 fax

SUP-37618 - SPECIAL USE PERMIT - PUBLIC HEARING - APPLICANT: CHECK CITY - OWNER:
FREMONT WEST, LLC - Request for a Special Use Permit TO ADD A JEWELRY STORE, CLASS III USE
TO AN EXISTING 1,800 SQUARE-FOOT AUTO TITLE LOAN AND FINANCIAL INSTITUTION, SPECIFIED
at 6378 West Lake Mead Boulevard (APN 138-23-601-003), C-1 (Limited Commercial) Zone, Ward 5 (Barlow)

PLANNING COMMISSION: APRIL 22, 2010

PLANNING SUPERVISOR: STEVE GEBEKE



PUBLIC HEARING

CITY COUNCIL: IF APPROVED: MAY 19, 2010

IF DENIED: P.C. FINAL ACTION (Unless appealed within 10 days)

Comments Due: MARCH 23, 2010

Comments not returned by the due date will not be incorporated into the staff report for this case. Comments may be submitted either on this sheet and routed via interoffice mail, U.S. mail, fax, or e-mailed to **Carman Burney** (cburney@lasvegasnevada.gov), the Agenda Tech responsible for this case. If you desire to meet with the case planner you may schedule an appointment by calling (702) 229-6301.

LIST COMMENTS BELOW:



CITY OF LAS VEGAS
Planning & Development Department
SUBMITTAL CHECKLIST

Pre-Application Conference

Item Required

YES NO

APPLICATION PACKET

<input checked="" type="checkbox"/>	<input type="checkbox"/>	Application signed and notarized by <i>all</i> property owners or authorized agent(s)
<input checked="" type="checkbox"/>	<input type="checkbox"/>	Grant deed and legal description
<input checked="" type="checkbox"/>	<input type="checkbox"/>	<i>Detailed</i> justification letter
<input checked="" type="checkbox"/>	<input type="checkbox"/>	Correct fee(s): \$ 500.00 (Application) + \$ 500.00 (Notification) + \$ 30.00 (Recordation) = \$ 1030.00 Total
<input checked="" type="checkbox"/>	<input type="checkbox"/>	Statement of Financial Interest (SOFI) signed and notarized by <i>all</i> property owners or authorized agent(s)
<input checked="" type="checkbox"/>	<input type="checkbox"/>	Assessor's Parcel Map
<input checked="" type="checkbox"/>	<input type="checkbox"/>	Development Impact Notice and Assessment (DINA)
<input checked="" type="checkbox"/>	<input type="checkbox"/>	Project of Regional Significance (PRS)
<input checked="" type="checkbox"/>	<input type="checkbox"/>	Color & Materials Board per Site Development Plan Review Submittal Requirements
<input checked="" type="checkbox"/>	<input type="checkbox"/>	Copy of Business Licenses: (Owner: <input type="checkbox"/> Applicant: <input type="checkbox"/> Representative: <input checked="" type="checkbox"/>)

NOTES:
 Visit the CLV website for blank application, SOFI & DINA forms @ <http://www.lasvegasnevada.gov/>
 (Follow - "I Want To..." -> "Apply for -> Planning Applications")

SITE PLAN

<input checked="" type="checkbox"/>	<input type="checkbox"/>	11" x 17" min. to 24" x 36" max. page size	Folded Plans:	19
<input checked="" type="checkbox"/>	<input type="checkbox"/>	North arrow, scale, and vicinity map	Colored, Rolled Plans:	1
<input checked="" type="checkbox"/>	<input type="checkbox"/>	<i>All</i> property lines and present dimensions labeled	Reduced Copy (8-1/2x11 BW):	1
<input checked="" type="checkbox"/>	<input type="checkbox"/>	<i>All</i> building setbacks labeled	NOTES:	
<input checked="" type="checkbox"/>	<input type="checkbox"/>	<i>All</i> adjacent existing land uses and street names labeled		
<input checked="" type="checkbox"/>	<input type="checkbox"/>	<i>All</i> points of ingress and egress shown		
<input checked="" type="checkbox"/>	<input type="checkbox"/>	ADA accessibility requirements shown/labeled		
<input checked="" type="checkbox"/>	<input type="checkbox"/>	Parking standard(s) utilized: 1 space per 175 gfa		
<input checked="" type="checkbox"/>	<input type="checkbox"/>	Parking space count and typical dimensions labeled # regular + [30% or less of total] # compact + # handicap = Total		
<input checked="" type="checkbox"/>	<input type="checkbox"/>	<i>All</i> free-standing sign locations shown and heights and sizes noted		

LANDSCAPE PLAN

<input type="checkbox"/>	<input checked="" type="checkbox"/>	11" x 17" min. to 24" x 36" max. page size	Folded Plans:	0
<input type="checkbox"/>	<input checked="" type="checkbox"/>	North arrow, scale, and vicinity map	Colored, Rolled Plans:	0
<input type="checkbox"/>	<input checked="" type="checkbox"/>	<i>All</i> property lines and present dimensions labeled	Reduced Copy (8-1/2x11 BW):	0
<input type="checkbox"/>	<input checked="" type="checkbox"/>	<i>All</i> required perimeter landscape planters shown	NOTES:	
<input type="checkbox"/>	<input checked="" type="checkbox"/>	<i>All</i> required parking lot fingers/islands shown		
<input type="checkbox"/>	<input checked="" type="checkbox"/>	Quantity, size, species/variety of <i>all</i> trees, shrubs, and ground cover		

BUILDING ELEVATIONS

<input type="checkbox"/>	<input checked="" type="checkbox"/>	11" x 17" min. to 24" x 36" max. page size	Folded Plans:	0
<input type="checkbox"/>	<input checked="" type="checkbox"/>	Scale and building dimensions labeled	Colored, Rolled Plans:	0
<input type="checkbox"/>	<input checked="" type="checkbox"/>	North, south, east, and west elevations of <i>all</i> buildings	Reduced Copy (8-1/2x11 BW):	0
<input type="checkbox"/>	<input checked="" type="checkbox"/>	<i>All</i> building materials and colors noted	NOTES:	
<input type="checkbox"/>	<input type="checkbox"/>	8" x 10" photo of original color and material board		
<input type="checkbox"/>	<input checked="" type="checkbox"/>	<i>All</i> wall sign locations shown and sizes noted		

FLOOR PLANS

<input checked="" type="checkbox"/>	<input type="checkbox"/>	11" x 17" min. to 24" x 36" max. page size	Folded Plans:	1
<input checked="" type="checkbox"/>	<input type="checkbox"/>	Scale and building dimensions labeled	Colored, Rolled Plans:	1
<input checked="" type="checkbox"/>	<input type="checkbox"/>	<i>All</i> building entrances/exits shown	Reduced Copy (8-1/2x11 BW):	1
<input checked="" type="checkbox"/>	<input type="checkbox"/>	Use of <i>all</i> rooms noted/labeled	NOTES:	
<input checked="" type="checkbox"/>	<input type="checkbox"/>	Maximum Occupancy (per I.B.C.)		
<input checked="" type="checkbox"/>	<input type="checkbox"/>	Seating Capacity (where applicable)		

THIS FORM MUST ACCOMPANY THE APPLICATION SUBMITTAL and is valid for no more than 60 days after the Pre-App date.

Owner / Applicant:	Fremont West Shopping Center/Check City
Representative:	Lucy Stewart
APN:	138-23-601-003
Planner's Signature:	<i>Swanton 2/25/10</i>
Planner:	Romeo Gumarang, Planner I - 229-4604 Steve Swanton, Senior Planner - 229-4714

Application Type:	Special Use Permit
Application Purpose:	Jewelry Store, Class III
Site Location:	6397 West Lake Mead Boulevard
Pre-App. Meeting Date:	02/25/10
Earliest Submittal Deadline:	03/09/2010 no later than 2:00 pm
Earliest PC / CC Meeting Dates:	4/22/10 PC 5/19/10 CC



CITY OF LAS VEGAS

- Meeting**
 Conversation Record
 Telephone

Page: 1 of 1
Date: 02/25/10
Time: 3:00 p.m.

Project Name: Check City 6378 W. Lake Mead

Conversation between CLV P&D Representative: Romeo Gumarang, Planner I (229-4604 Office / 385-7268 Fax / rgumarang@lasvegasnevada.gov), and:

Name	Company/Department	Phone	Fax	Email
1. Romeo Gumarang	Planning & Development	229-4604		
2. Steve Swanton	Planning & Development	229-4714		
3.				
4.				
5.				
6.				
7.	CLV - PW - Dev Co	229-6578	474-7599	
8.	CLV - PW - Traffic	229-6901 / 6880		
9.	CLV - PW - Flood	229-6541	382-8551	
10.	CLV - Building and Safety.	229-6251	382-1731	
11.	CLV - Fire and Rescue	229-0366	229-0124	
12.	CLV - Office of Business Development	229-6551	385-3128	

OR: see Meeting Attendance Sheet

Is this project intended to meet the City of Las Vegas Green Building Rebate Program? YES NO
Please refer to <http://www.lasvegasnevada.gov/sustaininglasvegas> for more information on rebates and incentives.

The following Special Area/Master Plan(s)/Overlay District(s) apply to the project site: N/A

Meeting Notes:

1. Revise the Site plan to indicate the size of the building.
2. Add parking requirements onto the site plan. A Parking Variance maybe required.
3. Revise the justification letter to address the building square footage and parking.
4. Revise the address to 6378 West Lake Mead Boulevard.

RECEIVED

MAR 09 2010

Should this project require a neighborhood meeting or if you choose to have one, please be aware of the following:

In order to use the City to mail the postcard notices for your neighborhood meeting, you must have all information to us no later than 15 days prior to the intended meeting date. Submitting the required information for the neighborhood meeting when making your application submittal is often best. Therefore, if you want the City to mail the notices for your neighborhood meeting, please ensure that we get all required information and that the request is made at least 15 days before you are scheduling the meeting, otherwise you must make other arrangements for getting the notices mailed.

-- Please return a copy of this form with the original Pre-Application Submittal Checklist --

Complete Submittal Packets MUST be received by Planning staff no later than 2:00 PM of the Submittal Deadline Date, no exceptions

4/22/10 P.C.
AV

Report Date 03/10/2010 10:42 AM

Submitted By

Page 1

A/P # 37618 SPECIAL USE PERMIT

Application Information

Stages

	Date / Time	By		Date / Time	By
Processed	03/09/2010 14:29	984387	Temp COO		
Approved			COO issued		
Final			Expires		

Associated Information

Type of Work	# Plans	0	Declared Valuation	0.00
Dept of Commerce	# Plans	0	Calculated Valuation	0.00
Priority	<input checked="" type="checkbox"/> Auto Reviews	Bill Group	Actual Valuation	0.00

Valuation

Description of Work

SUP-37618 - SPECIAL USE PERMIT - PUBLIC HEARING - APPLICANT: CHECK CITY - OWNER: FREMOT WEST, LLC - Request for a Special Use Permit TO ADD A JEWELRY STORE, CLASS III USE TO AN EXISTING 1,800 SQUARE-FOOT AUTO TITLE LOAN AND FINANCIAL INSTITUTION, SPECIFIED at 6378 West Lake Mead Boulevard (APN 138-23-601-003) Zone, Ward 5 (Barlow)

Parent A/P #

Project #	37618	Project/Phase Name	CHECK CITY	Phase #	
Size/Area	0.00	Size Description		Subdivision Code	
Proposed Start		Proposed Stop		% Completed	0.00
% Complete Formula					

Property/Site Information

Parcel 13823601003

Location

Owner/Tenant

Contact ID	AC96998	Name	FREMONT WEST SHOPPING CENTER	Organization	
Mailing Address	50 S JONES BLVD #100	State/Province	NV	Country	<input type="checkbox"/> Foreign
City	LAS VEGAS	Evening Phone		Mobile #	
ZIP/PC	89107-2672				
Day Phone	(702)878-1903 x				
Fax	(702)878-1903				

A/P Linked Addresses

No Addresses are linked to this Application

Linked Addresses

6370 W LAKE MEAD BLVD
LAS VEGAS, 89108-

6374 W LAKE MEAD BLVD
LAS VEGAS, 89108-

6390 W LAKE MEAD BLVD
LAS VEGAS, 89108-

6382 W LAKE MEAD BLVD
LAS VEGAS, 89108-

6386 W LAKE MEAD BLVD
LAS VEGAS, 89108-

Report Date 03/10/2010 10:42 AM

Submitted By

Page 2

Address **Parcel Link** **AP Link**

6378 W LAKE MEAD BLVD
LAS VEGAS, 89108-

A/P Addresses

No Other Addresses are associated to this Application

Linked Parcels

No Parcels are linked to this Application

A/P Linked Parcels

13823601003

Applicants/Contacts

Primary N Capacity OTHER Other REP Contact ID AC915174 Foreign
Effective Expire
Name CHECK CITY
Day Phone (702)258-8888 x Eve Phone Organization
Pager PIN # Position
Fax (702)880-7779 Mobile Profession
E-Mail
Address 2640 CRIMSON CAYON DR
LAS VEGAS, NV 89117
Seasonal Addr
Valid From To
Comments Jim Marchesi

Primary N Capacity OWNER Contact ID AC96998 Foreign
Effective Expire
Name FREMONT WEST SHOPPING CENTER
Day Phone (702)878-1903 x Eve Phone Organization
Pager PIN # Position
Fax (702)878-1903 Mobile Profession
E-Mail
Address 50 S JONES BLVD #100
LAS VEGAS, NV 89107-2672
Seasonal Addr
Valid From To
Comments Barry W Becker

Report Date 03/10/2010 10:42 AM

Submitted By

Page 3

Applicants/Contacts

Primary Y Capacity APPL Contact ID AC915174 Foreign
 Effective Expire
 Name CHECK CITY
 Day Phone (702)258-8888 x Eve Phone Organization
 Pager PIN # Position
 Fax (702)880-7779 Mobile Profession
 E-Mail
 Address 2640 CRIMSON CAYON DR
 LAS VEGAS, NV 89117
 Seasonal Addr
 Valid From To
 Comments Jim Marchesi

Contractors

No Contractors

Review Activities

Review #	Review Type	#	Status	Waived	Issued	Started	Completed	Comp By
381644	DEVCO	1	Incomplete	<input type="checkbox"/>	03/10/2010 10:41			
381645	NEIGH P&S	1	Incomplete	<input type="checkbox"/>	03/10/2010 10:41			
381646	B&S PLAN	1	Incomplete	<input type="checkbox"/>	03/10/2010 10:41			
381647	FLOOD	1	Incomplete	<input type="checkbox"/>	03/10/2010 10:41			
381648	TRAFFIC	1	Incomplete	<input type="checkbox"/>	03/10/2010 10:41			
381649	TEFO	1	Incomplete	<input type="checkbox"/>	03/10/2010 10:41			
381650	SURVEY	1	Incomplete	<input type="checkbox"/>	03/10/2010 10:41			
381651	SID	1	Incomplete	<input type="checkbox"/>	03/10/2010 10:41			
381652	SEWER	1	Incomplete	<input type="checkbox"/>	03/10/2010 10:41			
381653	ROW	1	Incomplete	<input type="checkbox"/>	03/10/2010 10:41			
381654	LAND DEV	1	Incomplete	<input type="checkbox"/>	03/10/2010 10:41			
381655	FIRE ENG	1	Incomplete	<input type="checkbox"/>	03/10/2010 10:41			

Activity Review Details

Detail SUBMITTAL CHECKLIST (SUP)
 Comments
 No Comments

Modified By MREX

Modified Date/Time 03/09/2010 14:22

Report Date 03/10/2010 10:42 AM

Submitted By

Page 4

SUBMITTAL CHECKLIST

Indicate if item is being submitted

- Y Pre-Application Conference Checklist Y Site Plan (19 Foiled Blue Lines, 1 Roiled Colored)
- Y Application/Petition Form Y Floor Plan, if Applicable (1 Foiled, 1 Roiled)
- Y Deed and Legal Description Y Laser Print Site Plan
- Y Justification Letter Y Laser Print Floor Plan
- Y Assessors Parcel Map Y Statement of Financial Interest
- N DiNA (Not Always Required)

Y Business Licensing Requirements Met

N Business License Exempt

Check Conditions Condition	Approval Supervisor Required	Approved By Comments	Approved Date	Applied By	Applied Date	Assigned
----------------------------	------------------------------	----------------------	---------------	------------	--------------	----------

Z-LEGAL				984387	03/09/2010 14:29	
N						

Planning Condition	Description	Effective	Expire	Comments
--------------------	-------------	-----------	--------	----------

There is no planning condition for this project.

SPECIAL USE PERMIT

- N DINA Required? Y Will this go to the City Council? Final City Council letter received
- N Project of Regional Significance? Annotated minutes received
- N Parent Project link required? is there a condition of approval for a Required Review?

Type of Use

JEWELRY STORE, CLASS III

If yes, when does it need to be reviewed?

N Is this an Alcohol related Use?

Staff Recommendation

Meeting Information

Meeting Information Meeting Date	Meeting Type	Meeting Status	YES Votes	ND Votes	ABSTENTIONS
Comments Added By	Add Date	Modified By Modified Date			

04/22/2010	PC	SCHEDULED	0	0	0
MREX	03/09/2010				

Report Date 03/10/2010 10:42 AM

Submitted By

Page 5

Meeting Information				YES Votes	NO Votes	ABSTENTIONS
Meeting Date	Meeting Type	Meeting Status				
Comments	Add Date	Modified By	Modified Date			
Added By						

Template Type A/P #	A/P Type	Status	Stage
---------------------	----------	--------	-------

No children exist for this project

Employee ID	Last	First	MI	Comments
-------------	------	-------	----	----------

No Employee Entries

Log Action	Description	Entered By	Start	Stop	Hours
------------	-------------	------------	-------	------	-------

PAYMNT CO NAME WHO PICKED UP CONTACT# 890381 03/09/2010 15:24 0.00
 LUCY STEWART; LAS CONSULTING; CK#1197; & CHECK CITY - NEVADA; CK#8202; 702-499-6469;



PLANNING & DEVELOPMENT DEPARTMENT

APPLICATION / PETITION FORM

Application/Petition For: SUP for Class III Jewelry
Project Address (Location) 6378-6382 W. Lake Mead, 89108
Project Name Check City Proposed Use Class III Jewelry
Assessor's Parcel #(s) 138-23-601-003 - a portion of Ward #
General Plan: existing NC proposed NC Zoning: existing C-1 proposed C-1
Commercial Square Footage Floor Area Ratio
Gross Acres Lots/Units Density
Additional Information Adding use of gold purchase to existing financial institution

PROPERTY OWNER Fremont West, L.L.C. Contact Barry W. Becker
Address 50 S. Jones #100 Phone: 878-1903 Fax: 878-1903
City Las Vegas State NV Zip 89107
E-mail Address

APPLICANT Check City Contact Jim Marchesi
Address 2640 Crimson Canyon Phone: (702) 258-8888 Fax:
City Las Vegas State NV Zip 89128
E-mail Address jtskee@aol.com

REPRESENTATIVE Check City Contact Jim Marchesi
Address 2640 Crimson Canyon Phone: (702) 258-8888 Fax:
City Las Vegas State NV Zip 89128
E-mail Address

FOR DEPARTMENT USE ONLY

Case # SUP-3768
Meeting Date: 4/22/10
Total Fee: 1030
Date Received: 3/9/10
Received By: MREV

Property Owner Signature* By: [Signature]
Print Name Barry W. Becker

Subscribed and sworn before me
This 17 day of February, 2010
Bunny J. Reiman



*The application will not be deemed complete until the submitted materials have been reviewed by the Planning and Development Department for consistency with applicable sections of the Zoning Ordinance.

*LA Stewart Consulting
2211 Rampart #130
Las Vegas, NV 89124
(702) 499-6469-Cell
(702) 946-0857-fax*

March 23, 2010

Romeo Gumarang, Planner I
City of Las Vegas, Planning & Development
739 South Fourth Street
Las Vegas, NV. 89101

RE: APN 138-23-601-003, 6378 W. Lake Mead (@ Torrey Pines)

Dear Mr. Gumarang:

Please accept this letter as our request for a Special Use Permit to allow the existing Check City Payday & Auto Title Loan store to purchase gold on the premises. Recently there have been several commercials on TV for gold purchase where the customer requests an envelope, places their broken or discarded gold jewelry in the envelope and send it to the company. In turn, the company sends the customer a check for approximately 10-15 cents on the dollar.

Check City would like to do something similar, only with more controls and a better situation for the customer. The customer brings the jewelry to the store and it is weighed and the customer walks away with a check for approximately 60-65 cents on the dollar-5 times more than if they mailed it. Also, the customer has control because they actually hand it over to a person, not a post office. In addition, it is held for 30 days so if the customer changes their mind they can return and get their jewelry back. Also, every purchase is reported to Metro on a daily basis. There is no resale of the jewelry, it is not a loan but a purchase of the jewelry for the gold. It will be an incidental use to the main business and considered just another service for the customer.

Below are the parking calculations for the site:

Parking Required

Convenience Store

RECEIVED
MAR 23 2010

SUP-37618
REVISED

3,060 Square feet /250=13
Mr. Eats Take out Pizza
933 square feet/200=5
67 square feet/50=2
(public area)
Check City, class III
2000 square feet/175=12
Torrey Pines Tavern
4040 total square feet/
2940 public area/50=59
1100 back of house/200=6

Total Required -97 spaces
Total provided- 99 spaces

Please contact me with any questions regarding this matter. Thank you for your consideration in this matter.

Yours truly,

Lucy Stewart
LA Stewart Consulting

RECEIVED
MAR 23 2010

SUP-37618
REVISED

*LA Stewart Consulting
2211 Rampart #130
Las Vegas, NV 89124
(702) 499-6469-Cell
(702) 946-0857-fax*

March 9, 2010

City of Las Vegas, Planning & Development
739 South Fourth Street
Las Vegas, NV. 89101

RE: APN 138-23-601-003, 6382 W. Lake Mead (@ Torrey Pines)

Dear Sir or Madam:

Please accept this letter as our request for a Special Use Permit to allow the existing Check City Payday & Auto Title Loan store to purchase gold on the premises. Recently there have been several commercials on TV for gold purchase where the customer requests an envelope, places their broken or discarded gold jewelry in the envelope and send it to the company. In turn, the company send the customer a check for approximately 10-15 cents on the dollar.

Check City would like to do something similar, only with more controls and a better situation for the customer. The customer brings the jewelry to the store and it is weighed and the customer walks away with a check for approximately 60-65 cents on the dollar-5 times more than if they mailed it. Also, the customer has control because they actually hand it over to a person, not a post office. In addition, it is held for 30 days so if the customer changes their mind they can return and get their jewelry back. Also, every purchase is reported to Metro on a daily basis. There is no resale of the jewelry; it is not a loan but a purchase of the jewelry for the gold. It will be an incidental use to the main business and is considered just another service for the customer.

In addition, there is adequate parking. The parking calculations are as follows:

Parking Required

Convenience Store
3500 Square feet /175=20
Mr. Eats Take out Pizza
1000 square feet/10=10
Check City, class III

RECEIVED

SUP-37618 MAR 09 2010
04/22/10 PC

1800 square feet/175=10
Torrey Pines Tavern
5000 square feet/200=25
200 public area/50=4

Total Required -69 spaces
Total provided- 95

Please contact me with any questions regarding this matter. Thank you for your consideration in this matter.

Yours truly,

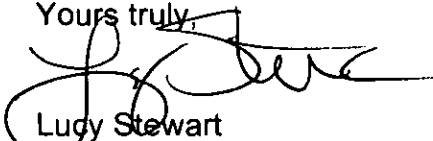

Lucy Stewart
LA Stewart Consulting

RECEIVED

SUP-37618
04/22/10 PC

MAR 09 2010



PLANNING & DEVELOPMENT DEPARTMENT

STATEMENT OF FINANCIAL INTEREST

Case Number: **SUP-37618** APN: 138-23-601-003 — a portion of

Name of Property Owner: Fremont West, L.L.C.

Name of Applicant: Check City

Name of Representative: Check City

To the best of your knowledge, does the Mayor or any member of the City Council or Planning Commission have any financial interest in this or any other property with the property owner, applicant, the property owner or applicant's general or limited partners, or an officer of their corporation or limited liability company?

Yes

No

If yes, please indicate the member of the City Council or Planning Commission who is involved and list the name(s) of the person or persons with whom the City Official holds an interest. Also list the Assessor's Parcel Number if the property in which the interest is held is different from the case parcel.

City Official: _____

Partner(s): _____

APN: _____

Signature of Property Owner: By: [Signature]

Its: manager

Print Name: Barry W. Becker

RECEIVED

MAR 09 2010

Subscribed and sworn before me

This 17 day of February, 2010

[Signature]
Notary Public in and for said County and State



FREMONT WEST, L.L.C.

Business Entity Information			
Status:	Active	File Date:	4/06/2000
Type:	Domestic Limited-Liability Company	Entity Number:	LLC3259-2000
Qualifying State:	NV	List of Officers Due:	4/30/2010
Managed By:	Managers	Expiration Date:	4/06/2500
NV Business ID:	NV20001034049	Business License Exp:	

Registered Agent Information			
Name:	FREMONT WEST, L.L.C.	Address 1:	50 SOUTH JONES BOULEVARD
Address 2:	SUITE 100	City:	LAS VEGAS
State:	NV	Zip Code:	89107
Phone:		Fax:	
Mailing Address 1:		Mailing Address 2:	
Mailing City:		Mailing State:	
Mailing Zip Code:			
Agent Type:	Noncommercial Registered Agent		

Financial Information			
No Par Share Count:	0	Capital Amount:	\$ 0
No stock records found for this company			

Officers				<input type="checkbox"/> Include Inactive Officers
Manager - BARRY W BECKER				
Address 1:	50 S JONES BLVD STE 100 MEMBER	Address 2:		
City:	LAS VEGAS	State:	NV	
Zip Code:	89107	Country:		
Status:	Active	Email:		
Manager - BRUCE F BECKER				
Address 1:	50 S JONES BLVD STE 100 MEMBER	Address 2:		
City:	LAS VEGAS	State:	NV	
Zip Code:	89107	Country:		
Status:	Active	Email:		
Manager - ERNEST A BECKER JR				
Address 1:	50 S JONES BLVD STE 100	Address 2:		
City:	LAS VEGAS	State:	NV	
Zip Code:	89107	Country:		
Status:	Active	Email:		

Actions/Amendments			
Action Type:	Articles of Organization		
Document Number:	LLC3259-2000-001	# of Pages:	7
File Date:	4/06/2000	Effective Date:	
(No notes for this action)			

RECEIVED

MAR 09 2010

Action Type:	Annual List		
Document Number:	LLC3259-2000-005	# of Pages:	1
File Date:	4/03/2001	Effective Date:	
(No notes for this action)			
Action Type:	Annual List		
Document Number:	LLC3259-2000-004	# of Pages:	1
File Date:	4/11/2002	Effective Date:	
(No notes for this action)			
Action Type:	Annual List		
Document Number:	LLC3259-2000-003	# of Pages:	1
File Date:	4/11/2003	Effective Date:	
(No notes for this action)			
Action Type:	Annual List		
Document Number:	LLC3259-2000-002	# of Pages:	1
File Date:	4/20/2004	Effective Date:	
List of Officers for 2004 to 2005			
Action Type:	Annual List		
Document Number:	20050086161-69	# of Pages:	1
File Date:	3/14/2005	Effective Date:	
(No notes for this action)			
Action Type:	Annual List		
Document Number:	20060122036-42	# of Pages:	1
File Date:	2/27/2006	Effective Date:	
(No notes for this action)			
Action Type:	Annual List		
Document Number:	20070192286-57	# of Pages:	1
File Date:	3/19/2007	Effective Date:	
(No notes for this action)			
Action Type:	Annual List		
Document Number:	20080168412-02	# of Pages:	1
File Date:	3/07/2008	Effective Date:	
(No notes for this action)			
Action Type:	Annual List		
Document Number:	20090155209-83	# of Pages:	1
File Date:	2/17/2009	Effective Date:	
09-10			

RECEIVED

MAR 09 2010

GRANT, BARGAIN, SALE DEED

THIS INDENTURE WITNESSETH: That MOHR DEVELOPMENT COMPANY, a Nevada partnership
and ERNEST A. BECKER and BETTY W. BECKER, husband and wife

**FOR A VALUABLE CONSIDERATION, the receipt of which is hereby acknowledged, do hereby Grant, Bargain,
Sell and Convey to** FREMONT WEST SHOPPING CENTER, a Nevada General Partnership

all that real property situated in the _____ County of Clark

State of Nevada, bounded and described as follows:

LEGAL DESCRIPTIONS AS PER RIDER ATTACHED HERETO, MARKED EXHIBIT "A"
AND MADE A PART HEREOF.

Together with all and singular the tenements, hereditaments and appurtenances thereunto belonging or in anywise
appertaining.
Witness their hands this 2nd day of June, 1989

STATE OF NEVADA }
COUNTY OF CLARK } SS.

On June 2, 1989
personally appeared before me, a Notary Public,
Ernest A. Becker, Partner for Mohr
Development Company, and
Ernest A. Becker and Betty W. Becker

MOHR DEVELOPMENT COMPANY
BY: Ernest A. Becker
Ernest A. Becker
Betty W. Becker
Ernest A. Becker
Betty W. Becker

who acknowledged that the y executed the above
instrument.

Signature: [Signature]
(Notary Public)

(Notarial Seal)

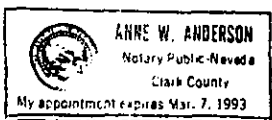

ESCROW NO.) LV 89-90520-GDM
ORDER NO.)
WHEN RECORDED MAIL TO: Fremont West Shopping Center
50 S. Jones Blvd., Las Vegas, NV 89107
RECORDED AT THE REQUEST OF LAND TITLE OF
NEVADA, WITHOUT LIABILITY

RECEIVED
MAR 09 2010

8 9 0 7 EXHIBITS "A"

LEGAL DESCRIPTION

Situate in the County of Clark, State of Nevada, described as follows:

That portion of the Southwest Quarter (SW 1/4) of the Southwest Quarter (SW 1/4) of Section 23, Township 20 South, Range 60 East, M.D.B. & M., described as follows:

Lots One, Two, and Three (1, 2, & 3) as shown by map thereof in File 60 of Parcel Maps, page 97 in the Office of the County Recorder, Clark County, Nevada.

CLARK COUNTY, NEVADA
JOAN L. SWIFT, RECORDER
RECORDED AT REQUEST OF:
LAND TITLE OF NV

07-10-89 08:00 DB1 2
OFFICIAL RECORDS
BOOK: 890710 INST: 00269
FEE: 6.00 RPTT: 1,795.20

RECEIVED

MAR 09 1990

NOTES

This map is for assessment use only and does NOT represent a survey.
 No liability is assumed for the accuracy of the data delineated herein.
 Information on roads and other non-assessed parcels may be obtained
 from the Road Document Listing in the Assessor's Office.

This map is compiled from official records, including surveys and deeds,
 but only contains the information required for assessment. See the
 recorded documents for more detailed legal information.

USE THIS SCALE (FEET) WHEN MAP REDUCED FROM 100% ORIGINAL

ASSESSOR'S PARCELS - CLARK CO., NV.
 M. W. Schofield, Assessor

AVERAGE OR VALUE
35

MAP LEGEND

——	PARCEL BOUNDARY	001	PARCEL NUMBER
——	SUBD BOUNDARY	00	ACREAGE
---	ROAD EASEMENT	202	PARCEL SUB/SE0 NUMBER
---	PW/LD BOUNDARY	21-41	PLAT RECORDING NUMBER
---	NON-PARCEL LOT LINE	5	BLOCK NUMBER
---	MATCH LINE / LEADER LINE	5	LOT NUMBER
---	ROAD ID NUMBER	015	GOV. LOT NUMBER

T20S R60E	23	S 2 NE 4																																																																						
<table border="1"> <tr><th>R59E</th><th>R60E</th><th>R61E</th></tr> <tr><td>126</td><td>125</td><td>124</td></tr> <tr><td>137</td><td>138</td><td>139</td></tr> <tr><td>164</td><td>163</td><td>162</td></tr> </table>	R59E	R60E	R61E	126	125	124	137	138	139	164	163	162	<table border="1"> <tr><th>4</th><th>5</th><th>6</th><th>7</th><th>1</th></tr> <tr><td>4</td><td>5</td><td>6</td><td>7</td><td>1</td></tr> <tr><td>10</td><td>11</td><td>12</td><td>13</td><td>14</td></tr> <tr><td>19</td><td>20</td><td>21</td><td>22</td><td>23</td></tr> <tr><td>28</td><td>29</td><td>30</td><td>31</td><td>32</td></tr> <tr><td>31</td><td>32</td><td>33</td><td>34</td><td>35</td></tr> </table>	4	5	6	7	1	4	5	6	7	1	10	11	12	13	14	19	20	21	22	23	28	29	30	31	32	31	32	33	34	35	<table border="1"> <tr><th>8</th><th>4</th><th>8</th><th>8</th></tr> <tr><td>8</td><td>4</td><td>8</td><td>8</td></tr> <tr><td>5</td><td>1</td><td>5</td><td>1</td></tr> <tr><td>6</td><td>2</td><td>6</td><td>2</td></tr> <tr><td>7</td><td>3</td><td>7</td><td>3</td></tr> <tr><td>8</td><td>4</td><td>8</td><td>4</td></tr> <tr><td>5</td><td>1</td><td>5</td><td>1</td></tr> </table>	8	4	8	8	8	4	8	8	5	1	5	1	6	2	6	2	7	3	7	3	8	4	8	4	5	1	5	1
R59E	R60E	R61E																																																																						
126	125	124																																																																						
137	138	139																																																																						
164	163	162																																																																						
4	5	6	7	1																																																																				
4	5	6	7	1																																																																				
10	11	12	13	14																																																																				
19	20	21	22	23																																																																				
28	29	30	31	32																																																																				
31	32	33	34	35																																																																				
8	4	8	8																																																																					
8	4	8	8																																																																					
5	1	5	1																																																																					
6	2	6	2																																																																					
7	3	7	3																																																																					
8	4	8	4																																																																					
5	1	5	1																																																																					

Scale: 1"=200' Rev: 08/16/05

138-23-6

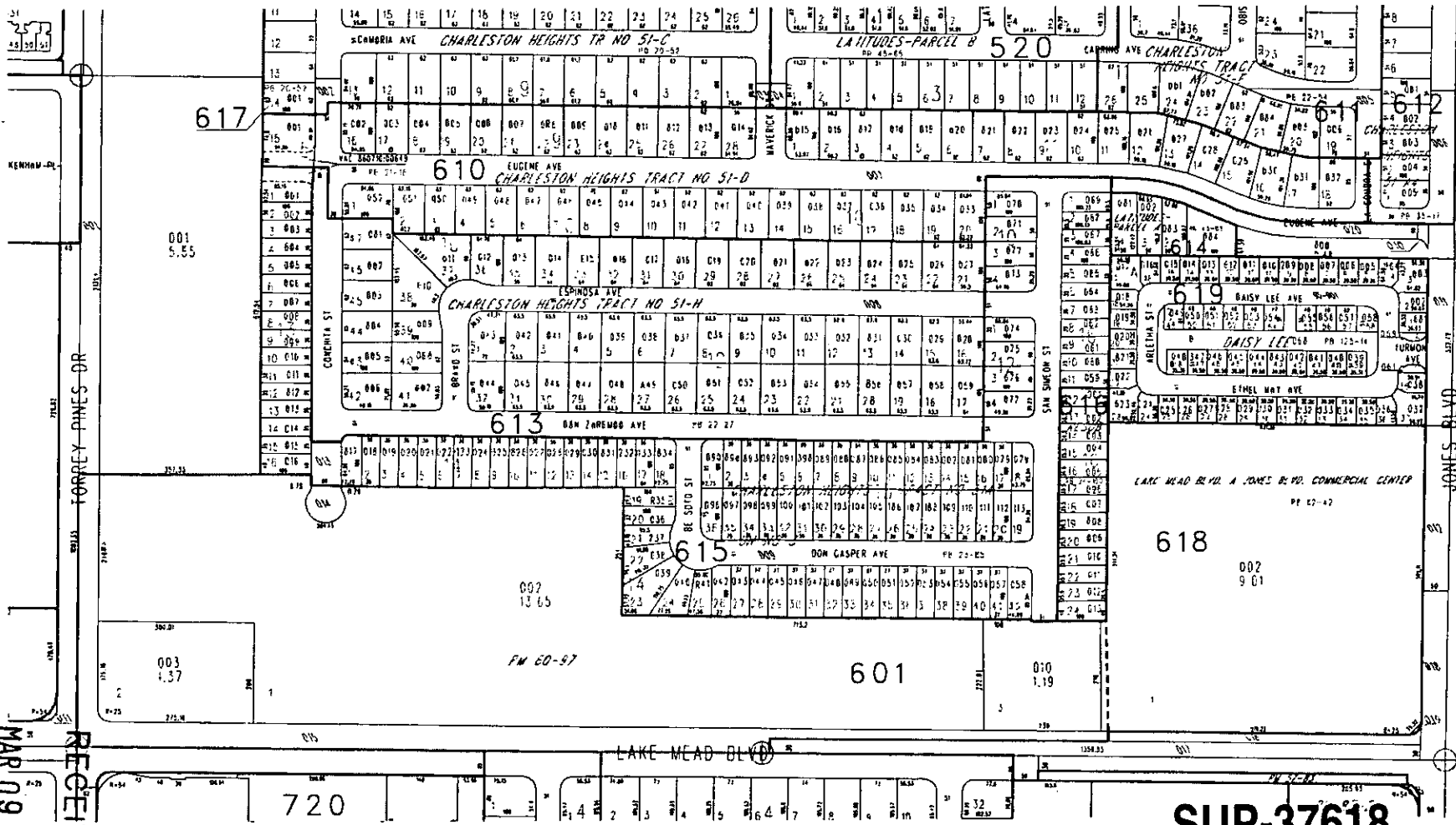

RECEIVED
 MAR 09 2010

SUP-37618
04/22/10 PC

TAX DIST 200

PARCELS 564
LABELS 537

Report of All Selected Parcels

Case Number: SUP-37618

Printed On: Tue: March 23, 2010

<u>Owner</u>	<u>Address</u>	<u>Parcel Number</u>
		13823214000
		13823717000
		13823211000
		13823213000
		13823718000
		13823212000
		13823721046
3 J M L L C	2130 ALEXA BREANNE CT LAS VEGAS NV	13823615012
A & E MANAGEMENT GROUP L L C	%E MYKLETUN 26895 ALISO CREEK #B-738 ALISO VIEJO CA	13823615032
A & E MANAGEMENT GROUP L L C	26895 ALISO CREEK RD #B 738 ALISO VIEJO CA	13823717027
A E TRUST	5886 N BONITA VISTA ST LAS VEGAS NV	13823718018
A E TRUST	5886 N BONITA VISTA ST LAS VEGAS NV	13823710007
A P T INSIDER L L C	9600 CORAL WY LAS VEGAS NV	13823721036
ABARCA ELEAZAR	6355 BLUE TWILIGHT CT LAS VEGAS NV	13823214090
ABATO LYUBOV T	3500 W LAKE MEAD BLVD #123 BLDG B1 LAS VEGAS NV	13823211001
ABEYTA CARLA RENEE	P O BOX 5925 LA QUINTA CA	13823212043
ADAMS CHRISTOPHER J	8042 LEATHER HARNESS CT LAS VEGAS NV	13823615028
AGAR JESSICA	6301 DON ZAREMBO AVE LAS VEGAS NV	13823212039
AKANA ALEXANDER Y S & VANESSA P	175 ULUPA ST KAILUA HI	13823711003
AKARASRIWORN CHLOLADA	19609 BOUMA AVE CERRITOS CA	13823212060
AKOP WARREN	2109 WILLOWBURY #D LAS VEGAS NV	13823721003
ALARCON DEENA	6380 BLUE TWILIGHT CT LAS VEGAS NV	13823713004
ALBERTI PETER D & GLENDA S	6236 LANNING LN LAS VEGAS NV	13823613012
ALEMAN JOSE D	6308 ESPINOSA AVE LAS VEGAS NV	13823213039
ALEXANDER JOE T & VANGIE F	2021 WILLOWBURY DR #C LAS VEGAS NV	13823717022
ALI' MENEHUNE L L C	4535 W SAHARA AVE #200 LAS VEGAS NV	13823212049
ALMENDRA ISMAEL	2110 BAVINGTON DR #A LAS VEGAS NV	13823721010
ALTEZA LORETA	6352 BLUE TWILIGHT CT LAS VEGAS NV	13823712003
ALVAREZ-MEDINA SAUDI Z	6332 LANNING LN LAS VEGAS NV	13823615018
AMEZCUA DANIEL & ISABEL S	6321 DON ZAREMBO AVE LAS VEGAS NV	13823201007
ANDERSON FARLEY L P	%REBEL OIL CO 2200 S HIGHLAND DR LAS VEGAS NV	13823615025
ANDERSON RANDALL & CHARLENE	5255 N CAMPBELL RD LAS VEGAS NV	13823211045
ANDRADE ROBERT N & TAIKO	2120 CHERTSEY DR #A LAS VEGAS NV	

Report of All Selected Parcels**Case Number:** SUP-37618**Printed On:** Tue: March 23, 2010

<u>Owner</u>	<u>Address</u>	<u>Parcel Number</u>
ANDRES RACHAEL	2124 PETERSHAM CT #D LAS VEGAS NV	13823211064
ANGELO ROBERT L	2112 BRAVO ST LAS VEGAS NV	13823613010
ANGULO JUAN	2104 CONCHITA ST LAS VEGAS NV	13823615011
APODACA STEPHEN A	6230 DON GASPAR AVE LAS VEGAS NV	13823615098
ARBOLEDA-BELLOTA L L C	30238 CEDAR OAK LN CASTAIC CA	13823710011
ARNOLD LAWRENCE J	2112 WILLOWBURY DR #C LAS VEGAS NV	13823212015
ARNOLD MARK L & JOLENE J	2116 WILLOWBURY DR #D LAS VEGAS NV	13823212020
ARNOLD PAUL D	2132 PETERSHAM CT #A LAS VEGAS NV	13823211037
ASHBURN JAMES	2331 CAPISTRANO LAS VEGAS NV	13823718005
AVILA JOSE M	4738 W MONTARA CIR LAS VEGAS NV	13823313084
BANK H S B C USA NATL ASSN TRS	7495 NEW HORIZON WY MAIL STOP-NAC #X3902-01F FREDERICK MD	13823214100
BANK U S N A	4801 FREDERICA ST OWENSBORO KY	13823721045
BARKAS MICHEAL SCOTT & JEAN M	6324 LANNING LN LAS VEGAS NV	13823712005
BARNES ROBERT	2136 CHERTSEY #C LAS VEGAS NV	13823211003
BARNETT KARLA J	1945 BOOKBINDER DR LAS VEGAS NV	13823313014
BASHELOR WILLIAM	1 OAK RIDGE LN BOZRAH CT	13823213005
BELL ALLAN M JR	2040 BAVINGTON DR #B LAS VEGAS NV	13823213006
BELLOTA L L C	6245 ILANOS LN #A LAS VEGAS NV	13823710033
BERRY DAVID N & MONICA S	6320 EUGENE AVE LAS VEGAS NV	13823610003
BERTRAM JANEY M & ROBERT G	6340 LANNING LN LAS VEGAS NV	13823712001
BHAIRO PREMCHAN	1951 N JONES BLVD #B207 LAS VEGAS NV	13823211007
BILLS MICHAEL D	3448 N NEDDLES DR PRESCOTT VALLEY AZ	13823718020
BLOSSOM ERLINDA	2108 BAVINGTON DR #A LAS VEGAS NV	13823212053
BONSIGNORI RICHARD S	1900 N TORREY PINES #225 LAS VEGAS NV	13823718019
BORGES ALEXANDER SILVERIA	8027 AVALON ISLAND ST LAS VEGAS NV	13823718008
BOSTIC JANET E LIVING TRUST	1900 N TORREY PINES DR #124 LAS VEGAS NV	13823718014
BOYACK EDWARD & HELEN	10237 SUNSET GARDENS DR LAS VEGAS NV	13823214095
BOYACK EDWARD D & HELEN	10237 SUNSET GARDENS DR LAS VEGAS NV	13823214069
BRADFORD FRANK R & DIANE A	2133 PETERSHAM CT #C LAS VEGAS NV	13823211035
BRAND JUDITH A & CARY J	%WACHOVIA TAX DEPT P D BDX 961242 FORT WORTH TX	13823213028
BRAZIEL ALLEN II	6500 W LAKE MEAD BLVD #117 LAS VEGAS NV	13823214112
BROWN GREGORY W & CARON M	2109 CONCHITA ST LAS VEGAS NV	13823613004

Report of All Selected Parcels**Case Number:** SUP-37618**Printed On:** Tue: March 23, 2010

<u>Owner</u>	<u>Address</u>	<u>Parcel Number</u>
BROWN JANET S LIVING TRUST	6305 EUGENE AVE LAS VEGAS NV	13823610047
BUCHANAN JOE REID & KIM MARIE	6235 DON ZAREMBO AVE LAS VEGAS NV	13823615095
BURNHAM ROBERT W IV	2036 BAVINGTON DR #C LAS VEGAS NV	13823213003
C J L TRUST	10130 ELIZABETH ANN LN LAS VEGAS NV	13823717026
C V S 2990 LAS VEGAS L L C	%CVS PHARMACY INC #2990-01 %STORE ACCOUNTING DEPT 1 CVS DR WOONSOCKET RI	13823720005
CABRERA JOSE & BERTHA	2116 BAVINGTON DR #A LAS VEGAS NV	13823212005
CALEY JOHANNAH E	2028 CONCHITA ST LAS VEGAS NV	13823615015
CAMPOS TEODULO	7337 WELLSFORD AVE WHITTIER CA	13823212065
CANCHOLA-ESPANA HECTOR E	6367 BLUE TWILIGHT CT LAS VEGAS NV	13823721039
CARRILLO BERENICE	3225 ERNEST ST NO LAS VEGAS NV	13823711001
CARSLAKE GRAHAM A & COLIN S	21 TURTLE LAKE DR HALTON HILLS ONTARIO L7J 2W7 CANADA	13823211008
CASS ADRIENNE M	2041 CHERTSEY DR #A LAS VEGAS NV	13823213021
CASSIDY JERRI	2128 PETERSHAM CT #D LAS VEGAS NV	13823211044
CASTRO LUIS M	6500 W LAKE MEAD BLVD #106-A LAS VEGAS NV	13823214079
CATALAN BERNARDO & MARTA	6344 BLUE TWILIGHT CT LAS VEGAS NV	13823721012
CAVA CHRISTINA E	2121 PETERSHAM CT #D LAS VEGAS NV	13823211056
CEBRA ELLA M & MIKE	%H STUDER 311 MARKET ST GENOA IL	13823213036
CHACON SANTIAGO & JESSICA	1932 BOOKBINDER DR LAS VEGAS NV	13823313069
CHAFFEE GUY LEWIS & JANA L	5935 N CAMPBELL RD LAS VEGAS NV	13823212006
CHAN BOB	6500 W LAKE MEAD BLVD #209 BLDG A3 LAS VEGAS NV	13823214088
CHAPMAN LINDA F	2132 PETERSHAM CT #C LAS VEGAS NV	13823211039
CHAR ABRAHAM L H TRUST	308 MAMAKI ST HONOLULU HI	13823313077
CHAVEZ-OLIVARES GEOVANNY E	2136 PETERSHAM CT #A LAS VEGAS NV	13823211013
CHICKERING DAVID W	17 CAMEL POINT LAGUNA BEACH CA	13823214066
CHILES DIANA K	14 CANTERBURY CT #7 BLOOMINGTON IL	13823211025
CHOMES WILLIAM & DOLORES	7848 TURTLE COVE AVE LAS VEGAS NV	13823214076
CHURCH BAPTIST LIBERTY LAS VEGAS	6501 W LAKE MEAD BLVD LAS VEGAS NV	13823302001
CHURCH LIBERTY BAPTIST	6501 W LAKE MEAD LAS VEGAS NV	13823313085
CITY OF LAS VEGAS	400 STEWART LAS VEGAS NV	13823721017
COLLASO ERNESTINE LIVING TRUST	2028 BAVINGTON DR #C LAS VEGAS NV	13823213055
COLVILLE INVESTMENTS L L C	6616 SW 154TH PL BEAVERTON OR	13823213035
COMER KEN E JR & MELINDA S	2021 WILLOWBURY DR #A LAS VEGAS NV	13823213037

Report of All Selected Parcels**Case Number:** SUP-37618**Printed On:** Tue: March 23, 2010

<u>Owner</u>	<u>Address</u>	<u>Parcel Number</u>
COOK DAVID & NANCY M	1610 PROMONTORY RIDGE WY VISTA CA	13823214120
COON TRAVIS R	6992 BLUE TWILIGHT CT LAS VEGAS NV	13823721015
CORDERO RUBY	6359 BLUE TWILIGHT CT LAS VEGAS NV	13823721037
CORDERO VINCE	6315 BLUE TWILIGHT CT LAS VEGAS NV	13823721026
CORONA JOSE LUIS DELTORO	6376 BLUE TWILIGHT CT LAS VEGAS NV	13823721004
CORRAL MARIA E & TOMAS D	5005 MEADOWS LILLY AVE LAS VEGAS NV	13823711028
CORREA RICHARD	2104 BAVINGTON DR #B LAS VEGAS NV	13823212042
COTRIGHT DWAIN R	1900 N TORREY PINES DR #216 LAS VEGAS NV	13823717032
COUCH PATRICIA H	2032 BAVINGTON DR #B LAS VEGAS NV	13823213050
CUTTING DIANA K	2100 BRAVO ST LAS VEGAS NV	13823613007
CUVA ROBERT THOMAS	2101 CONCHITA ST LAS VEGAS NV	13823613006
DALY BRUCE J & MICHAEL V	7421 BUSH GARDEN AVE LAS VEGAS NV	13823212038
D'AMBROSIO NICHOLAS J	7901 BASE CAMP AVE LAS VEGAS NV	13823214106
DAO HIEU V	9307 ROCHELLE AVE LAS VEGAS NV	13823610051
DECASTRO MELODY	6304 BLUE TWILIGHT CT LAS VEGAS NV	13823721022
DESAUTELS ROGER & ROBERTA	58 LEXINGTON CLOSE LACOMBE ALBERTA T4L 2J3 CANADA	13823214074
DEVITTE FRANK J	1900 N TORREY PINES DR #109 LAS VEGAS NV	13823717013
DEVRIES JOY L	34 TAMARRON CLIFFS ST LAS VEGAS NV	13823214094
DEWITT RONALD & KATHLEEN A	1900 N TORREY PINES #102 LAS VEGAS NV	13823717002
DICKEY RONALD & DEIDRE	3648 W 63RD ST LOS ANGELES CA	13823710006
DING GUANGLIAN	6348 BLUE TWILIGHT CT LAS VEGAS NV	13823721011
DININO MARGEL & MARGEL L	1900 N TORREY PINES DR #205 LAS VEGAS NV	13823717015
DIXON FRANKIE L & MARY L LIV TR	11149 S MANHATTAN PL LOS ANGELES CA	13823717029
DOLORFINO CECILIA	2112 BAVINGTOD DR #A LAS VEGAS NV	13823212001
DUARTE EDWIN E	2125 CONCHITA ST LAS VEGAS NV	13823610052
DUNCAN REBA	6500 W LAKE MEAD BLVD #210 LAS VEGAS NV	13823214089
DUOME WALTER T & MARIE	85-05 67 AVE REGO PARK NY	13823212041
ECKERT SCOTT B & K A REV TR	9358 SVL BOX VICTORVILLE CA	13823212057
EDWARDS BRENDA	2041 CHERTSEY DRIVE #D LAS VEGAS NV	13823213024
ELIYAHU IRIT	10284 DUNLEER DR LOS ANGELES CA	13823214082
EQUIVENTURE L L C	P O BOX 60341 BOULDER CITY NV	13823615029
ERBENTRAUT THOMAS R	13911 DEODAR ST SANTA ANA CA	13823214081

Report of All Selected Parcels**Case Number:** SUP-37618**Printed On:** Tue: March 23, 2010

<u>Owner</u>	<u>Address</u>	<u>Parcel Number</u>
ERBER LOUISE A	1900 N TORREY PINES DR #201 LAS VEGAS NV	13823717005
ERICKSON MARILYN K	2041 WILLOWBURY DR #A LAS VEGAS NV	13823213009
ESCOBAR MARIA L	12824 VICTORY BLVD N HOLLYWOOD CA	13823212019
ESPINOZA JUANA A	2108 WILLOWBURY DR LAS VEGAS NV	13823212063
ESPINOZA LORENA	6387 BLUE TWILIGHT CT LAS VEGAS NV	13823721044
EVANS GAIL D	2128 CHERTSEY DR #14D LAS VEGAS NV	13823211032
EWING MARJORIE	1936 BOOKBINDER DR LAS VEGAS NV	13823313070
EYLER EVANGELINE	2124 PETERSHAM CT #C LAS VEGAS NV	13823211063
FAMILY DDLLAR INC	ATTN: TAX DEPT P O BOX 1017 CHARLOTTE NC	13823201003
FEDERAL NATIONAL MORTGAGE ASSN	400 COUNTRYWIDE WY SV-35 SIMI VALLEY CA	13823615035
FEDERAL NATIONAL MDRTGAGE ASSN	135 N LOS ROBLES AVE PASADENA CA	13823718012
FEDERAL NATIONAL MORTGAGE ASSN	135 N LOS ROBLES AVE PASADENA CA	13823214108
FEDERAL NATIONAL MORTGAGE ASSN	400 COUNTRYWIDE WY SV-35 SIMI VALLEY CA	13823313003
FELIZ JEANNE MARIE	2121 PETERSHAM CT #B LAS VEGAS NV	13823211054
FERNANDEZ ANGEL DAVID	5026 N VALADEZ ST LAS VEGAS NV	13823313080
FINNIE MALCOLM	2106 CONCHITA ST LAS VEGAS NV	13823615010
FIORE MAUREEN C	2110 BAVINGTDN DR #C LAS VEGAS NV	13823212051
FIRESTONE KIYA	6311 DON ZAREMBO AVE LAS VEGAS NV	13823615023
FLORES-HERNANDEZ OSMIN G	6311 BLUE TWILIGHT CT LAS VEGAS NV	13823721025
FLOWERS TRACY	2040 WILLOWBURY #AE LAS VEGAS NV	13823213017
FONSECA MARY A	2036 WILLOWBURY DR #C LAS VEGAS NV	13823213015
FONSECA SAMANTHA	6500 W LAKE MEAD BLVD #122 LAS VEGAS NV	13823214065
FORWOOD MONICA	1900 N TORREY PINES DR #111 LAS VEGAS NV	13823717021
FRAGOMENI VINCENT & CHARMAINE	6323 DDN ZAREMBO AVE LAS VEGAS NV	13823615017
FRAUSTO JOSE L	6371 BLUE TWILIGHT CT LAS VEGAS NV	13823721040
FREMDNT WEST SHOPPING CENTER	50 S JONES BLVD #100 LAS VEGAS NV	13823601003
FRERICHS RANDY	#3 5301-21A AVE S E CALGARY AB CANADA T2B2E9	13823717010
FREY PATRICIA B	P O BOX 922 BUFFALD NY	13823717008
FRIEGANG ROBERT H & DIANE G	6500 W LAKE MEAD #125 BLDG #1 LAS VEGAS NV	13823214092
FURTADO TERRI C	2118 CONCHITA ST LAS VEGAS NV	13823615004
GAITHO EPANTUS C	8141 LEGER DR LAS VEGAS NV	13823214110
GAMA GERARDO	6375 BLUE TWILIGHT CT LAS VEGAS NV	13823721041

Report of All Selected Parcels**Case Number:** SUP-37618**Printed On:** Tue: March 23, 2010

<u>Owner</u>	<u>Address</u>	<u>Parcel Number</u>
GAMBOL MICHELLE	6500 W LAKE MEAD #212 LAS VEGAS NV	13823214115
GAON JAIME P JR	1852 N DECATUR BLVD #201 LAS VEGAS NV	13823214093
GARCIA ABEL	1742 WATER CREEK DR NO LAS VEGAS NV	13823212052
GARCIA ALBERTO C & GLAFIRA	6244 DON ZAREMBO AVE LAS VEGAS NV	13823613049
GARCIA FRANCISCO J	6372 BLUE TWILIGHT CT LAS VEGAS NV	13823721005
GARCIA LUIS & RAQUEL	3421 COMMENDATION DR LAS VEGAS NV	13823213014
GARCIA ORLANDO & MARIA ELENA	2601 W IRENE ST PAHRUMP NV	13823313071
GARCIA VICTOR M	2137 PETERSHAM CT #A LAS VEGAS NV	13823211009
GARCIA-GONZALEZ BENJAMIN	2112 WILLOWBURY DR #D LAS VEGAS NV	13823212016
GARG DEVENDRA	5764 CRESCENT LANDING LAS VEGAS NV	13823213058
GATLIN BESSIE M	1900 N TORREY PINES #125 LAS VEGAS NV	13823718015
GAYTON DOROTHY B	13240 N TATUM BLVD #229 PHOENIX AZ	13823213065
GEMMA LEOPOLD J	2113 CONCHITA ST LAS VEGAS NV	13823613003
GERTIE LESLIE R	2020 BAVINGTON DR #B LAS VEGAS NV	13823213046
GILMORE TIMOTHY GEORGE TRUST	1900 N TORREY PINES DR #105 LAS VEGAS NV	13823717009
GIVENS STEPHANIE	2128 CHERTSEY DR #B LAS VEGAS NV	13823211030
GLAZE NIJOLE	1953 ERIN WY GLENDALE CA	13823214117
GLEN CHRISTOPHER R	6500 W LAKE MEAD BLVD #104 BLDG A2 LAS VEGAS NV	13823214073
GOLDENBERG FAMILY TRUST	5936 INDIAN POINTE DR SIMI VALLEY CA	13823214116
GOLIATH INVESTMENTS L L C	%S YANCEY 10300 W CHARLESTON BLVD #13-233 LAS VEGAS NV	13823615027
GONZALEZ GILBERTO & GUILLERMINA	3514 BELL AVE BELL CA	13823713002
GONZALEZ JULIE	2028 WILLOWBURY DR #C LAS VEGAS NV	13823213063
GONZALEZ-PEREZ ALEJANDRA	6309 ESPINOSA AVE LAS VEGAS NV	13823613043
GOODNER GROVER S JR & JANE D	2024 WILLOWBURY DR #A LAS VEGAS NV	13823213029
GRAF TAMI LYNN	2108 BRAVO ST LAS VEGAS NV	13823613009
GREEN MICHELE	P O BOX 25865 HONOLULU HI	13823212056
GUALAZZINI UGO	%M DELACRUZ P O BOX 33053 LAS VEGAS NV	13823214114
GUIRAO DANIEL	6320 BLUE TWILIGHT CT LAS VEGAS NV	13823721018
GULISANO ANNA	P O BOX 570844 LAS VEGAS NV	13823212059
GUTHRIE WALTER K	2141 TWICKENHAM PL #C LAS VEGAS NV	13823211023
GUTIERREZ CIPRIANO	2124 CHERTSEY DR #D LAS VEGAS NV	13823211052
GUZMAN JOHNNY ALLEN & ANDREA K	6313 EUGENE AVE LAS VEGAS NV	13823610049

Report of All Selected Parcels**Case Number:** SUP-37618**Printed On:** Tue: March 23, 2010

<u>Owner</u>	<u>Address</u>	<u>Parcel Number</u>
GUZMAN SERGIO	6234 DON GASPAR AVE LAS VEGAS NV	13823615096
GUZMAN SERGIO	6066 BELCASTRO DR LAS VEGAS NV	13823615040
GUZMAN-BLANCO SANTOS A	6336 LANNING LN LAS VEGAS NV	13823712002
HAKIMI MAHYAR	P O BOX 7262 LAGUNA NIGUEL CA	13823710032
HARENBERG TANYA	2200 LESTER DR NE #370 ALBUQUERQUE NM	13823213047
HARRISON THOMAS H & DENISE R	1984 BOOKBINDER DR LAS VEGAS NV	13823313082
HART DONALD & THERESA	2040 WILLOWBURY DR #C LAS VEGAS NV	13823213019
HAUFF BYRON REVOCABLE TRUST	1900 N TORREY PINES DR #108 LAS VEGAS NV	13823717012
HAVERTY WILLIAM E	6304 ESPINOSA AVE LAS VEGAS NV	13823613013
HEALEY WILLIAM F & EVA M	2041-B CHERTSEY DR LAS VEGAS NV	13823213022
HEALY MICHAEL P & CAROL A	1952 BOOKBINDER DR LAS VEGAS NV	13823313074
HEALY MICHAEL P & CAROL A	1953 BOOKBINDER DR LAS VEGAS NV	13823313012
HEATH EDDIE L	2109 CHERTSEY DR #D LAS VEGAS NV	13823212068
HENRI CORINNE J	914 E ELDORADO LN LAS VEGAS NV	13823211038
HERNANDEZ GUSTAVO	2216 BRADY AVE LAS VEGAS NV	13823711044
HERNANDEZ JUAN & MARIA	6235 DON GASPAR AVE LAS VEGAS NV	13823615041
HERNANDEZ LUZ C	6243 DON ZAREMBO AVE LAS VEGAS NV	13823615033
HERNANDEZ-AGUILA CARLOS A	1949 BOOKBINDER DR LAS VEGAS NV	13823313013
HEYNS JOHN	2141 TWICKENHAM PL #6B LAS VEGAS NV	13823211022
HIGASHI CHELSEA	2120 PETERSHAM CT LAS VEGAS NV	13823211060
HIGHER GROUND L L C	P O BOX 98378 LAS VEGAS NV	13823313007
HILL LORRA D	6233 DON ZAREMBO AVE LAS VEGAS NV	13823615094
HINGTGEN KRISTINE R	7933 DANA MAPLE CT LAS VEGAS NV	13823717031
HINTON LONNIE & DENISE	2024 BAVINGTON DR #B LAS VEGAS NV	13823213042
HO MARGARET	3584 CASA CORONA AVE NO LAS VEGAS NV	13823211048
HODYNO STEPHEN G	2110 CONCHITA ST LAS VEGAS NV	13823615008
HOFFMAN ANDREW P	6309 EUGENE AVE LAS VEGAS NV	13823610048
HOUSTON HOMER LEE & MARY E	1965 BOOKBINDER DR LAS VEGAS NV	13823313009
HSU JUDY M	2953 CLOWN BLUFFS CT LAS VEGAS NV	13823214085
HUPP ERIC L & CAROLE A	207 SHAGBARK DR WESTERVILLE OH	13823212035
HURTT KENNETH L	2121 TWICKENHAM PL #A LAS VEGAS NV	13823211065
ILANOS L L C	6245 ILANOS LN #A LAS VEGAS NV	13823710034

Report of All Selected Parcels**Case Number:** SUP-37618**Printed On:** Tue: March 23, 2010

<u>Owner</u>	<u>Address</u>	<u>Parcel Number</u>
INVESTOR EQUITY HOMES L L C	2020 WILLOWBURY DR #B LAS VEGAS NV	13823213034
IRWIN CHA SUN	2975 BLUEGRASS LN #623 HENDERSON NV	13823711026
IRWIN CHASUN REVOCABLE LIV TR	2975 BLUEGRASS LN #623 HENDERSON NV	13823711027
IZSA ILONA T	6232 DON GASPAR AVE LAS VEGAS NV	13823615097
J A S TRUST	3120 W CAREFREE HWY #-536 PHOENIX AZ	13823212010
JAMES MITCHELL & SABRINA	1900 N TORREY PINES DR #118 LAS VEGAS NV	13823718002
JIMENEZ JUANA	6244 ILANOS LN LAS VEGAS NV	13823710035
JIMENEZ LOUIE	6253 ESPINOSA AVE LAS VEGAS NV	13823613040
JOHNS CASSANDRA A	2136 PETERSHAM CT #C LAS VEGAS NV	13823211015
JOHNSEN MICHAEL A	1900 N TORREY PINES DR #217 LAS VEGAS NV	13823718007
JOHNSON GLENN ETAL	2118 6TH ST N CRANBROOK BC V1C 5E2 CANADA	13823214067
JOHNSON JESSE W	340 E 64TH ST #15K NEW YORK NY	13823214096
JOHNSON JOHNNY E	P O BOX 82063 LAS VEGAS NV	13823211019
JOHNSON ROBERT A & DENISE P	5060 JEAN AVE LAS VEGAS NV	13823717025
JOHNSON THEODORE U & VICKIE E	6500 W LAKE MEAD BLVD #216 LAS VEGAS NV	13823214119
JONES WALTER T	320 CITY CENTER DR ROHNERT PARK CA	13823212023
JOYA JOSE FERNANDO	6500 W LAKE MEAD BLVD #229 LAS VEGAS NV	13823214104
KALILI L L C	8316 FULTON RANCH ST LAS VEGAS NV	13823710001
KALILI L L C	8316 FULTON RANCH ST LAS VEGAS NV	13823710003
KAMBER SIMON	2804 W ESTES CHICAGO IL	13823214109
KAMEENUI HARRY H K REVOCABLE TR	1242 LUNALILO HOME RD HONOLULU HI	13823212058
KAPUSTINA ELENA N	2040 WILLOWBURY DR #D LAS VEGAS NV	13823213020
KELLER LIVING TRUST	7917 COPPER CANYON RD LAS VEGAS NV	13823613047
KHALILZADEGAN JESSICA	1155 E TWAIN AVE #108-84 LAS VEGAS NV	13823711025
KHAN HAROON	3417 ANDREW DR BRYANT AR	13823214098
KIDWILL JOAN B	2133 PETERSHAM CT #B LAS VEGAS NV	13823211034
KILBURG MARY V & JOHN A JR	5916 GLEN EAGLES LN LAS VEGAS NV	13823212044
KILGORE EVA S	16971 CONCORD LN HUNTINGTON BEACH CA	13823213052
KIM SKY M	2114 CONCHITA ST LAS VEGAS NV	13823615006
KING JEFFERY M	2100 WILLOWBURY DR #B LAS VEGAS NV	13823212034
KING SHAWANA	1900 N TORREY PINES DR #219 LAS VEGAS NV	13823718009
KINGDON-CARPENTER LIVING TRUST	25588 PASEO LA VISTA LAGUNA NIGUEL CA	13823211041

Report of All Selected Parcels**Case Number:** SUP-37618**Printed On:** Tue: March 23, 2010

<u>Owner</u>	<u>Address</u>	<u>Parcel Number</u>
KLOS BLAINE	2564 PLAENTINA ST HENDERSON NV	13823212054
KONG CHERYL CHUN REV LIV TR ETAL	2318 KAALA ST HONOLULU HI	13823213044
KORTRAKUL CHAI ETAL	13110 ROSCOE BLVD SUN VALLEY CA	13823212028
KREBS WILLIAM DANIEL & HEIDI ANN	1024 DEER RIVER CIR S E CALGARY AB T2J 621 CANADA	13823717007
KREIDER RICHARD L	P O BOX 170 ANCHOR POINT AK	13823718016
KUNITAKE CHESTER C & JUDITH S	1815 ALA AOLANI ST HONOLULU HI	13823213038
KURASHIMA ROSS S	4924 WHISPERING SPIRNG AVE LAS VEGAS NV	13823717001
L M 2009 TRUST	6500 W LAKE MEAD BLVD #215 LAS VEGAS NV	13823214118
LAMURY LINDA	6312 COPPERFIELD AVE LAS VEGAS NV	13823721006
LARSON GEORGE LOUIS	5142 CANOGA AVE WOODLAND HILLS CA	13823212055
LAS VEGAS VALLEY WATER DISTRICT	3700 W CHARLESTON BLVD LAS VEGAS NV	13823303001
LATHAM STEPHEN	6356 BLUE TWILIGHT CT LAS VEGAS NV	13823721009
LEAL PATRICIA & MARIA	1900 TORREY PINES DR #209 LAS VEGAS NV	13823717019
LEAMMON WESLEY G	6336 BLUE TWILIGHT CT LAS VEGAS NV	13823721014
LEE KUN CHIH	2101 CHERTSEY DR #B LAS VEGAS NV	13823212026
LEON JAIME	1961 BOOKBINDER DR LAS VEGAS NV	13823313010
LEON KEVIN & TARRAH	6360 BLUE TWILIGHT CT LAS VEGAS NV	13823721008
LEPSCIER RICK A & SUSAN A	2137 PETERSHAM CT #C LAS VEGAS NV	13823211011
LEVINE DOLORES E TRUST	2031 WILLOWBURY DR #A LAS VEGAS NV	13823213057
LIN WILLIAM WL	7045 EL PARQUE AVE LAS VEGAS NV	13823710031
LINDSEY MARY F	5900 W 73RD AVE WESTMINSTER CO	13823211010
LIRIOO L L C	%D SANZO 6245 LLANOS LN #A LAS VEGAS NV	13823710009
LIVINGSTON ARTHUR & BECKY A	379 E PLEASANT GROVE RD JACKSON NJ	13823313076
LOEZA MARIA L	P O BOX 27595 LAS VEGAS NV	13823711002
LOGAN FRED R & DELILAH E	11 ANDREW RD AMERICAN CANYON CA	13823214113
LOMBARDO CARMEN F & JENNIE	2128 CHERTSEY DR #14A LAS VEGAS NV	13823211029
LONGORIA ISMAEL & ESPERANZA	6236 DON ZAREMBO AVE LAS VEGAS NV	13823613051
LOPEZ DANIA	5308 DEBUT CT LAS VEGAS NV	13823211067
LOPEZ FERNANDO	2621 WHITEPINE DR HENDERSON NV	13823710010
LOPEZ MARIO A & CYNTHIA A	2805 GLEN AULIN ST LAS VEGAS NV	13823613042
LOPEZ ROGELIO C	2957 CHANNEL BAY LAS VEGAS NV	13823212045
LORENZEN RUSSELL M	4600 E SUNSET RD #286 HENDERSON NV	13823615042

Report of All Selected Parcels**Case Number:** SUP-37618**Printed On:** Tue: March 23, 2010

<u>Owner</u>	<u>Address</u>	<u>Parcel Number</u>
LOSS MARCY S	1361 PYRAMID DR LAS VEGAS NV	13823212002
LOUIE KENNY Y & SOPHIA WONG	6236 ILANOS LN LAS VEGAS NV	13823711029
LOVE WANDA MARIE	6500 W LAKE MEAD BLVD #116 BLDG B2 LAS VEGAS NV	13823214111
LOZANODEPOSADA K C SEP PPTY TR	5522 MOONLIGHT GARDEN ST LAS VEGAS NV	13823613005
LOZOYA QUIRINO & MARIA G	2112 BAVINGTON DR #D LAS VEGAS NV	13823212004
LUCA JOSEPH JR	2104 BRAVO ST LAS VEGAS NV	13823613008
LUCAS OFELIA P & JONATHAN J	6384 BLUE TWILIGHT CT LAS VEGAS NV	13823721002
LUM PAUL	9156 SILVER TROUT ST LAS VEGAS NV	13823615030
LYTLE AYREN L & EMIL	7408 LATTIMORE DR LAS VEGAS NV	13823718006
MABIN EDWARD W & DARLIS	4016 MOUNTAIN TREK LAS VEGAS NV	13823212032
MABRY MICHAEL	6328 LANNING LN LAS VEGAS NV	13823712004
MADRID FATIMA	2024 WILLOWBURY DR #D LAS VEGAS NV	13823213032
MAHAY ANJANA	2100 BAVINGTON DR #D LAS VEGAS NV	13823212048
MAI TRANG HANG	1981 BOOKBINDER DR LAS VEGAS NV	13823313005
MALDONADO-CARRASCO GERARDO H	6307 BLUE TWILIGHT CT LAS VEGAS NV	13823721024
MALIK ANWAR	128 RATLIFF BRANCH RD PIKEVILLE KY	13823721030
MALLORY JACK J & MARY E	6229 DON GASPER AVE LAS VEGAS NV	13823615044
MANALAC CARLOS M JR	7811 PASSETT CT #202 ANNANDALE VA	13823211006
MANCUSO-COTTEN MARY	3172 N RAINBOW BLVD #112 LAS VEGAS NV	13823211017
MANCUSO-COTTEN MARY V	3172 N RAINBOW BLVD LAS VEGAS NV	13823213008
MANDEL PHILLIP D & SHARON H	7104 POWDERHORN CIR LAS VEGAS NV	13823610004
MAQUEDA ISIDRO	6240 DON ZAREMBO LAS VEGAS NV	13823613050
MARQUEZ JPATROCINIO DE SANTIAGO	6300 DON ZAREMBO AVE LAS VEGAS NV	13823613046
MARSHALL BRIGITTE	6301 EUGENE AVE LAS VEGAS NV	13823610046
MARSHALL RENEE	2028 BAVINGTON DR LAS VEGAS NV	13823213053
MARTIN ERNEST D	2041 WILLOWBURY DR #B LAS VEGAS NV	13823213010
MARTIN JONATHAN T	3809 ROSE CANYON DR NO LAS VEGAS NV	13823212025
MARTINEZ LOUIS & MARIA R	7513 MOUNTAIN QUAIL LAS VEGAS NV	13823211031
MARTINEZ LUCAS & ISABEL	1948 BOOKBINDER DR LAS VEGAS NV	13823313073
MARTINEZ RAMON	2024 DE SOTO ST LAS VEGAS NV	13823615036
MARTINEZ RAMON	6317 DON ZAREMBO AVE LAS VEGAS NV	13823615020
MARTINEZ RENE	6364 BLUE TWILIGHT CT LAS VEGAS NV	13823721007

Report of All Selected Parcels**Case Number:** SUP-37618**Printed On:** Tue: March 23, 2010

<u>Owner</u>	<u>Address</u>	<u>Parcel Number</u>
MARWAHA ASHOK K & NEETI	824 S CALLE VENADD ANAHEIM CA	13823212050
MASSEY TERESA DEANN	2028 BAVINGTON DR #D LAS VEGAS NV	13823213056
MATA JESUS A	2631 PETERSHAM CT #B LAS VEGAS NV	13823211014
MATA LEONARD & HOPE M	2121 PETERSHAM CT #C LAS VEGAS NV	13823211055
MAY JEAN REVOCABLE LIVING TRUST	1900 N TORREY PINES DR #221 LAS VEGAS NV	13823718011
MAYJOR WILLIAM G	2120 PETERSHAM CT #C LAS VEGAS NV	13823211059
MAYS MARIA A	1968 BOOKBINDER DR LAS VEGAS NV	13823313078
MCCOY RACHAEL C	1900 N TORREY PINES DR #210 LAS VEGAS NV	13823717020
MCCULLOUGH DENNIS D	6231 DON GASPER AVE LAS VEGAS NV	13823615043
MCDONALD CHRISTA M	6319 BLUE TWILIGHT CT LAS VEGAS NV	13823721027
MCINERNEY DANIEL J	14500 DALLAS PKWY #1171 DALLAS TX	13823213004
MCMURRAY JOHN J	2112 BAVINGTON DR #C LAS VEGAS NV	13823212003
MEDLAND ERNA F	1825 RIDGEFIELD DR LAS VEGAS NV	13823717016
MEINHOLD JUDITH M & ELIZABETH	2020 BAVINGTON DR #D LAS VEGAS NV	13823213048
MEJIA-REYES DIEGO A	6339 BLUE TWILIGHT CT LAS VEGAS NV	13823721032
MELNIK JOSEPH R & BEVERLY J	6300 LANNING LN LAS VEGAS NV	13823713003
MENDOZA BIANCA TERESA	6388 BLUE TWILIGHT CT LAS VEGAS NV	13823721001
MENDOZA VICTORIANO A & LIGAYA A	6248 ESPINOSA AVE LAS VEGAS NV	13823613016
MENJIVAR SANDRA Y	1977 BOOKBINDER DR LAS VEGAS NV	13823313006
MERSEREAU HUGH	202 VAN SCOTT DR BRAMPTON ONTARIO L7A IV8 CANADA	13823718004
METHOT EUGENE W	1900 N TORREY PINES #104 LAS VEGAS NV	13823717004
METZGER EDWARD & CHERYL	10233 CLARK WOOLDRIDGE CT LAS VEGAS NV	13823214086
METZGER EDWARD & CHERYL	10233 CLARK WOOLDRIDGE CT LAS VEGAS NV	13823214121
METZLER DEIKE	2132 CHERTSEY DR #D LAS VEGAS NV	13823211028
MILLAN JORGE	2112 WILLOWBURY DR #A LAS VEGAS NV	13823212013
MILLER HARVEY M FAMILY TRUST	23000 NEWPORT COAST DR NEWPORT COAST CA	13823720007
MILLER LAVERNE	2120 CHERTSEY DR #B LAS VEGAS NV	13823211046
MIRACLE REALTY & INVESTMENTS LLC	%B RAFFI 6399 WILSHIRE BLVD #507 LOS ANGELES CA	13823214080
MISQUEZ-LEE SHERI E	1900 N TORREY PINES DR #214 LAS VEGAS NV	13823717030
MITCHELL DIANA	1956 BOOKBINDER DR LAS VEGAS NV	13823313075
MOORE ALBERT	2104 WILLOWBURY DR #C LAS VEGAS NV	13823212031
MORALES JULIO E	1928 BOOKBINDER DR LAS VEGAS NV	13823313068

Report of All Selected Parcels**Case Number:** SUP-37618**Printed On:** Tue: March 23, 2010

<u>Owner</u>	<u>Address</u>	<u>Parcel Number</u>
MORONEY JOHN D III & CHRISTINE L	6324 EUGENE AVE LAS VEGAS NV	13823610002
MOUANNES VICTOR A	6320 LANNING LN LAS VEGAS NV	13823712006
MURRAY MATTHEW	6335 BLUE TWILIGHT CT LAS VEGAS NV	13823721031
MYINTOO SALLY	6500 W LAKE MEAD BLVD #202 BLDG #A2 LAS VEGAS NV	13823214075
NAGEL JOSEPH A	6363 BLUE TWILIGHT CT LAS VEGAS NV	13823721038
NAMUO ALVIN & WINONA	6500 W LAKE MEAD BLVD #227 LAS VEGAS NV	13823214102
NEAL BILLY WAYNE	6308 DON ZAREMBO AVE LAS VEGAS NV	13823613044
NEWSOM MARJORIE L TRUST	2032-C BAVINGTON DR LAS VEGAS NV	13823213051
NEWSOME KENNARD J	1972 BOOKBINDER DR LAS VEGAS NV	13823313079
NICHOLAS VERNON JOSEPH III	2108 WILLOWBURY DR #D LAS VEGAS NV	13823212064
NIE ZHONG BIN	532 E FAIRMOUNT RD BURBANK CA	13823214068
NIP RUBY C TRUST	810 RICHARDS ST #633 HONOLULU HI	13823213043
NOLAN JOHN C & FRANCESCA C	3750 UNIVERSITY AVE #250 RIVERSIDE CA	13823212040
OASIS PROPERTY MANAGEMENT L L C	%B & A PODLOSKI 584 LACABANA BEACH DR LAS VEGAS NV	13823211026
OBREGON RAYMOND	2117 CONCHITA ST LAS VEGAS NV	13823613002
OBRIEN JAMES F & JANICE M	2104 WILLOWBURY DR #8A LAS VEGAS NV	13823212029
O'GRADY JOEL	2041 CHERTSEY DR #C LAS VEGAS NV	13823213023
OLIVIER DARRYL E	2117 CHERTSEY DR #B LAS VEGAS NV	13823212022
OLSON HOWARD W & MARY L	2020 WILLOWBURY DR #A LAS VEGAS NV	13823213033
ORELLANA WILFREDO	7300 ROAMER PL LAS VEGAS NV	13823711045
OYADOMARI FELICE N & THERESA E	92-300 AKAAWA PL KAPOLEI HI	13823211057
PALACIOS IRINA	6309 DON ZAREMBO AVE LAS VEGAS NV	13823615024
PALISADES 6300 W LAKE MEAD LLC	%S AFSHANI P O BOX 7440 LAS VEGAS NV	13823601002
PALLA VITA CHRISTINE LIVING TR	2041 WILLOWBURY DR #D LAS VEGAS NV	13823213012
PAPPAS STEVEN D & GINA M	10320 TOWER RIDGE AVE LAS VEGAS NV	13823213026
PAPPAS STEVEN D & GINA M	10320 TOWER RIDGE AVE LAS VEGAS NV	13823213041
PAULINA ARMSTRONG G	948 N EL MOLINO PASADENA CA	13823718017
PAYA HOSSEIN	2124 CHERTSEY DR #C LAS VEGAS NV	13823211051
PEARSON CAROL	2109 CHERTSEY DR #C LAS VEGAS NV	13823212067
PELLO MELISSA	2140 PETERSHAM CT #D LAS VEGAS NV	13823211020
PENA ERIK A RAMIREZ	6351 BLUE TWILIGHT CT LAS VEGAS NV	13823721035
PENA ESMELIDA	6340 BLUE TWILIGHT CT LAS VEGAS NV	13823721013

Report of All Selected Parcels**Case Number:** SUP-37618**Printed On:** Tue: March 23, 2010

<u>Owner</u>	<u>Address</u>	<u>Parcel Number</u>
PENNY GAIL C	2100 WILLOWBURY DR #A LAS VEGAS NV	13823212033
PEREZ FABIAN G	6252 ESPINOSA AVE LAS VEGAS NV	13823613015
PERKOWSKI LISA ELLEN REV LIV TR	7747 BEVERLY HILLS DR LAS VEGAS NV	13823718001
PERUCH NATHAN & RACHAEL W	2040 WILLOWBURY DR #B LAS VEGAS NV	13823213018
PETERSEN MARSHA	2036 WILLOWBURY DR #A LAS VEGAS NV	13823213013
PETERSHAM 2133 L L C	10308 CAROLINA HILLS AVE LAS VEGAS NV	13823211036
PHAN THUY T	6132 W LAKE MEAD BLVD LAS VEGAS NV	13823711031
PHILLIPS THERESA S LIVING TRUST	2101 WILLOWBURY DR #A LAS VEGAS NV	13823212037
PINKHAM HEATH & SARAH ETAL	1711 WEISKOPF DR HEATH TX	13823717028
PIONTKO RICHARD	8324 W CHARLESTON #1053 LAS VEGAS NV	13823214087
POWELL JOHN H JR	315 W MARKET ST GERMANTOWN OH	13823211043
PRESTON RICHARD J & LINDA S	1980 BOOKBINOER DR LAS VEGAS NV	13823313081
PRICE KARI	2120 PETERSHAM CT #9-B LAS VEGAS NV	13823211058
PRIME TORREY L L C	%PRIME ADMIN LLC %O JAMES 321 BURNSIOE AVE LOS ANGELES CA	13823601001
PUNSALAN MICHAELA M & DONNIE	6327 BLUE TWILIGHT CT LAS VEGAS NV	13823721029
QIU WEI	2021 CHERTSEY OR BLOG 7 #A LAS VEGAS NV	13823213025
QUEZADA ODILON & CELINA	4552 E 53RD ST MAYWOOD CA	13823710002
QUISAO ALEJANDRO I & EVELYN D	6312 ESPINOSA AVE LAS VEGAS NV	13823613011
R F K HOLDING 4 L L C	3746 TERRACE DR LAS VEGAS NV	13823313083
R F K HOLOING 8 L L C	3746 TERRACE OR LAS VEGAS NV	13823615019
R F K HOLDING 9 L L C	3746 TERRACE OR LAS VEGAS NV	13823613038
R R R HOMES L L C	P O BOX 98378 LAS VEGAS NV	13823711043
RAMIREZ LEUMY	1985 BOOKBINDER DR LAS VEGAS NV	13823313004
RAMIREZ TERESITA	2132 CHERTSEY DR #13C LAS VEGAS NV	13823211027
RAPER BRANDON P	1944 BOOKBINDER DR LAS VEGAS NV	13823313072
RASCO KATHY A	6317 EUGENE AVE LAS VEGAS NV	13823610050
RATCLIFFE WANDA M	1900 N TORREY PINES DR #110 LAS VEGAS NV	13823717014
REA VANCE	6305 DON ZAREMBO AVE LAS VEGAS NV	13823615026
REDMAN REDDRICK	20 BOSWELL CT SACRAMENTO CA	13823313011
RENNIE SHARON L	8609 GRANDBANK OR LAS VEGAS NV	13823721023
RENTERIA-ZAMORA ISRAEL	2116 WILLOWBURY OR #A LAS VEGAS NV	13823212017
RENZETTI MICHAEL P & OONNA M	45 SAMUEL DR NORTH GRAFTON MA	13823212018

Report of All Selected Parcels**Case Number:** SUP-37618**Printed On:** Tue: March 23, 2010

<u>Owner</u>	<u>Address</u>	<u>Parcel Number</u>
RESKA STEPHEN G & JOANNE M	34 RUSSET RD BILLERICA MA	13823212062
REYNOSO RICHARD	4920 YUMA AVE LAS VEGAS NV	13823615009
REZNIK YURI	6500 W LAKE MEAD BLVD #226 LAS VEGAS NV	13823214101
RHODES PAULA R	2040 BAVINGTON DR #C LAS VEGAS NV	13823213007
RICE LLOYD W & MARILYN J	2024 WILLOWBURY DR #C LAS VEGAS NV	13823213031
RICHARDSON 7	%W & K RICHARDSON 309 CANYON CIR LAS VEGAS NV	13823615022
RICHARDSON JUANITA	2132 CONCHITA ST LAS VEGAS NV	13823610001
RICKERT NICOLE	2120 CONCHITA ST LAS VEGAS NV	13823615003
RIDGWAY ROBIN J	5900 W TROPICANA #286 LAS VEGAS NV	13823211062
RIGMAIDEN ANTOINE	2136 PETERSHAM CT LAS VEGAS NV	13823211016
RIOS ROMAN P	15228 MARTHA ST VAN NUYS CA	13823211066
RIQUELME ALVARO	2124 CONCHITA ST LAS VEGAS NV	13823615001
RITCHIE RICHARD CHARLES & LESLEY	7261 201B ST LANGLEY BC CANADA V2Y 3G4	13823213040
ROBERTS ANDRE D	6500 W LAKE MEAD BLVD BLDG A2 #103 LAS VEGAS NV	13823214072
ROBINSON PATRICIA MARIE WALLACE	101 LAFAYETTE AVE #3J BROOKLYN NY	13823212036
ROBLES OCTAVIO & YESENIA	6312 LANNING LN LAS VEGAS NV	13823712008
ROCHA ENRIQUE V	4812 APAWUNA LN LAS VEGAS NV	13823214070
ROCHA MARIA B	2124 CHERTSEY DR #A LAS VEGAS NV	13823211049
RODRIGUEZ JOSE RAFAEL	6312 BLUE TWILIGHT CT LAS VEGAS NV	13823721020
ROGERS EDDIE	94-495 KIILANI ST MILILANI HI	13823213045
ROGERS PAUL A	11400 VISTA PL SE ALBUQUERQUE NM	13823211002
ROSE MARY A	9 JONES PL EDISON NJ	13823211042
ROSE MEREDITH ASSOCIATES L L C	4012 S RAINBOW BLVD #K-610 LAS VEGAS NV	13823711030
ROWLAND REX L L C	3652 S NORWICH PL ROWLAND HEIGHTS CA	13823721021
RUDDY CORRINE M	2117 WILLOWBURY DR #C LAS VEGAS NV	13823212011
RUNYAN CYNTHIA ANN	2140 CHERTSEY DR #A LAS VEGAS NV	13823211005
RUSSO DIANNA	1900 N TORREY PINES DR #207 LAS VEGAS NV	13823717017
RYDER FAMILY TRUST	6304 DON ZAREMBO AVE LAS VEGAS NV	13823613045
S A INVESTMENT L L C	1785 E SAHARA AVE #490700 LAS VEGAS NV	13823721043
SAFAI FEREDDOON & MAHNAZ	12874 VISCAINO RD LOS ALTOS CA	13823711004
SANDERSON FREDA ANN	236 S RAINBOW BLVD #325 LAS VEGAS NV	13823211047
SANGIORGIO FREDERICK & LARRY	51-600 AVEMODA RAMIREZ LA QUINTA CA	13823211004

Report of All Selected Parcels**Case Number:** SUP-37618**Printed On:** Tue: March 23, 2010

<u>Owner</u>	<u>Address</u>	<u>Parcel Number</u>
SAUCEDA ERMA M	2109 CHERTSEY DR #B LAS VEGAS NV	13823212066
SAWYER MARK A & MARILYN	6308 LANNING LN LAS VEGAS NV	13823713001
SCHMIDT ALLEN L	2117 WILLOWBURY DR #D LAS VEGAS NV	13823212012
SCHMIDT STEVEN C	P O BOX 99665 SAN DIEGO CA	13823613001
SCHNIPPEL FAMILY L P ETAL	9960 W CHEYENNE AVE #210 LAS VEGAS NV	13823720008
SCHONBERG LEWIS M & JUDY	1900 N TORREY PINES DR #103 LAS VEGAS NV	13823717003
SCHWAB FLOYD & PEGGY REV FAM TR	2124 CHERTSEY DR #B LAS VEGAS NV	13823211050
SCOTT CHERELLE	P O BOX 570322 LAS VEGAS NV	13823211018
SCOTT DONALD W & ALICE G FAM TR	4624 REBECCA AVE LA CRESCENTA CA	13823613039
SETTLEMYRE RICHARD W	6500 W LAKE MEAD BLVD #119 BLDG A1 LAS VEGAS NV	13823214062
SHADDOCK ELAINE G	2116-D BAVINGTON DR LAS VEGAS NV	13823212008
SHAVER MARVIN D & DARLENE J	1900 N TORREY PINES DR #220 LAS VEGAS NV	13823718010
SHAW JULIE S FAMILY TRUST	2333 FLORISSANT DR LAS VEGAS NV	13823615038
SHEFFIELD HOMEOWNERS ASSOC	%ASSOC COMNTY MGT 4815 W RUSSELL RD #15-0 LAS VEGAS NV	13823721055
SHEFFIELD HOMEOWNERS ASSOC	%ASSOC COMNTY MGT 4815 W RUSSELL RD #15-0 LAS VEGAS NV	13823721057
SHEFFIELD HOMEOWNERS ASSOC	%ASSOC COMNTY MGT 4815 W RUSSELL RD #15-0 LAS VEGAS NV	13823721048
SHEFFIELD HOMEOWNERS ASSOC	%ASSOC COMNTY MGT 4815 W RUSSELL RD #15-0 LAS VEGAS NV	13823721058
SHEFFIELD HOMEOWNERS ASSOC	%ASSOC COMNTY MGT 4815 W RUSSELL RD #15-0 LAS VEGAS NV	13823721050
SHEFFIELD HOMEOWNERS ASSOC	%ASSOC COMNTY MGT 4815 W RUSSELL RD #15-0 LAS VEGAS NV	13823721052
SHEFFIELD HOMEOWNERS ASSOC	%ASSOC COMNTY MGT 4815 W RUSSELL RD #15-0 LAS VEGAS NV	13823721049
SHEFFIELD HOMEOWNERS ASSOC	%ASSOC COMNTY MGT 4815 W RUSSELL RD #15-0 LAS VEGAS NV	13823721053
SHEFFIELD HOMEOWNERS ASSOC	%ASSOC COMNTY MGT 4815 W RUSSELL RD #15-0 LAS VEGAS NV	13823721059
SHEFFIELD HOMEOWNERS ASSOC	%ASSOC COMNTY MGT 4815 W RUSSELL RD #15-0 LAS VEGAS NV	13823721054
SHEFFIELD HOMEOWNERS ASSOC	%ASSOC COMNTY MGT 4815 W RUSSELL RD #15-0 LAS VEGAS NV	13823721056
SHEFFIELD HOMEOWNERS ASSOC	%ASSOC COMNTY MGT 4815 W RUSSELL RD #15-0 LAS VEGAS NV	13823721060
SHEFFIELD HOMEOWNERS ASSOC	%ASSOC COMNTY MGT 4815 W RUSSELL RD #15-0 LAS VEGAS NV	13823721047
SHEFFIELD HOMEOWNERS ASSOC	%ASSOC COMNTY MGT 4815 W RUSSELL RD #15-0 LAS VEGAS NV	13823721051
SHEFFIELD HOMEOWNERS ASSOC	%ASSOC COMNTY MGT 4815 W RUSSELL RD #15-0 LAS VEGAS NV	13823721061
SHERMAN KATHLEEN	1300 NOLA AVE #7A TAHLEQUAH OK	13823717023
SHERWOOD JACQUELINE A	2028 WILLOW DR #B LAS VEGAS NV	13823213062
SHIEH JOHN CHUNG	6500 W LAKE MEAD BLVD #120 LAS VEGAS NV	13823214063
SHOWS RAMONA	2116 CONCHITA ST LAS VEGAS NV	13823615005

Report of All Selected Parcels**Case Number:** SUP-37618**Printed On:** Tue: March 23, 2010

<u>Owner</u>	<u>Address</u>	<u>Parcel Number</u>
SHUPE KATHLEEN L	P O BOX 7208 HILO HI	13823211061
SILVA MARIANN E	2041 WILLOWBURY DR #C LAS VEGAS NV	13823213011
SILVA NIVANILDO SIQUEIRA	2133 PETERSHAM CT #A LAS VEGAS NV	13823211033
SILVERMAN PAUL	6500 W LAKE MEAD BLVD #204 LAS VEGAS NV	13823214077
SILVEYRA ABEL A & ANGELICA	7690 N JONES BLVD LAS VEGAS NV	13823212047
SILVEYRA ABEL A & ANGELICA	7690 N JONES BLVD LAS VEGAS NV	13823213060
SIMLAK HAROLD	2036 BAVINGTON DR #B LAS VEGAS NV	13823213002
SIMPKINS MARY A	2028 WILLOWBURY DR #D LAS VEGAS NV	13823213064
SLOAT CAROL A	6528 MURIETTA AVE VAN NUYS CA	13823214078
SMILEY SANDRA C & KIMBERLY J K	45-175 LILIPUNA RD LOT E KANEOHE HI	13823213059
SMITH HELEN C	2031 CHERTSEY DR #B LAS VEGAS NV	13823213066
SMITH KIMBERLY J	1900 N TORREY PINES DR #107 LAS VEGAS NV	13823717011
SMITH MARIA	2121 TWICKENHAM PL #D LAS VEGAS NV	13823211068
SMITH TIMOTHY & PAULA LARSEN	7811 W WASHBURN RD LAS VEGAS NV	13823717006
SOLEIMAN YASSER F	6301 ESPINOSA AVE LAS VEGAS NV	13823613041
SONIC REAL ESTATE PPTY MGT L L C	4801 STAVAITON AVE LOS ANGELES CA	13823720003
SORIANO ARNEL M & LAURA	6343 BLUE TWILIGHT CT LAS VEGAS NV	13823721033
SPRINGHART HORACIO D	8656 BIG SAGEBRUSH LAS VEGAS NV	13823213030
SQUIRE DEBBIE M	6500 W LAKE MEAD #110 LAS VEGAS NV	13823214083
STATES DIANNE M LIVING TRUST	621 ORDRICH PI LAS VEGAS NV	13823710004
STEEHLER MICHELLE L	1900 N TORREY PINES DR #208 LAS VEGAS NV	13823717018
STEWART SANDRA	6300 ESPINOSA AVE LAS VEGAS NV	13823613014
STINSON HEATH	%K LASSEN 3269 PHEASANT HILLS WY LAUGHLIN NV	13823212046
STORDEUR AUDREY M	2121 PETERSHAM CT #A LAS VEGAS NV	13823211053
SUN YING	1499 HUNTINGTON DR #400 SOUTH PASADONA CA	13823615037
T H DEVELOPMENT INC	1188 BISHOP ST #3203 HONOLULU HI	13823710005
T N T ENTERPRISES NEVADA L L C	%T WANTA 2025 N TORREY PINES LAS VEGAS NV	13823201005
TAAD RODRIGO C & EMILIE	5047 N GREER AVE COVINA CA	13823721028
TADMOR SARAH	2117 CHERTSEY DR #A LAS VEGAS NV	13823212021
TAIRA RICHARD S & BETTY A	1470 LALAMILO ST HONOLULU HI	13823212014
TALAVERA JOSE	7808 MARBLE DOE ST LAS VEGAS NV	13823710037
TALON KRIS CORAZON B	4616 W SAHARA AVE #170 LAS VEGAS NV	13823214071

Report of All Selected Parcels**Case Number:** SUP-37618**Printed On:** Tue: March 23, 2010

<u>Owner</u>	<u>Address</u>	<u>Parcel Number</u>
TAYLOR VALERIE	411 GARDNER ST EL CAJON CA	13823613037
TEAFORD TOM J	2021 CHERTSEY DR #C LAS VEGAS NV	13823213027
TERRACE EIGHTH L L C	%ACE PROPERTY MANAGMENT P O BOX 27377 LAS VEGAS NV	13823615016
THOMAS WILLA	2028 BAVINGTON DR #B LAS VEGAS NV	13823213054
THDMPSON ERMA G	2036 WILLOWBURY DR #D LAS VEGAS NV	13823213016
THOMPSON STEPHEN A	6316 LANNING LN LAS VEGAS NV	13823712007
THOMSON DAVID D & LYN D	9917 BARRIER REEP DR LAS VEGAS NV	13823615031
THORNLEY DANIEL	8733 CREMONA DR LAS VEGAS NV	13823212007
TIGHE JOHN J JR & PATRICK J	340 S 100 W CIRCLEVILLE UT	13823718003
TOM LISA & LESLIE	264 JAMES CT BENICIA CA	13823212024
TORRES GUILLERMO ADRIAN	12185 B ST TRONA CA	13823213068
TORTAROLO FAMILY LIVING TRUST	10416 BENT BROOK PL LAS VEGAS NV	13823211040
TRAN PHUC T	3162 ADAMSWOOD DR SAN JOSE CA	13823711042
TRAXLER SOM P	423 CAMINO DE TEODORO WALNUT CA	13823212027
TREVINO-FAIRBANKS DANA	2030 CONCHITA ST LAS VEGAS NV	13823615014
TROXELL BERNADINE L	2141 TWICKENHAM PL #A LAS VEGAS NV	13823211021
TRUSTEE CLARK COUNTY TREASURER	%JOHNSON VINCENT 1997 BOOKBINDER DR LAS VEGAS NV	13823313001
TRUSTEE CLARK COUNTY TREASURER	%CAPITALIST HOLDING 6241 DON ZAREMBO AVE LAS VEGAS NV	13823615034
UDY NATHAN H & HEATHER M	2108 WILLOWBURY DR #A LAS VEGAS NV	13823212061
ULLOA ALEXIS	1993 BOOKBINDER LAS VEGAS NV	13823313002
URENA ELVA	1900 N TORREY PINES DR #123 LAS VEGAS NV	13823718013
URQUHART JODY	7211 FARRELL RD S E CALGARY ALBERTA T2H0T7 CANADA	13823214107
V & I LAKE MEAD PROMENADE L L C	28632 ROADSIDE DR #285 AGOURA CA	13823201008
VARGAS ANGEL A & DANNY A	1969 BOOKBINDER DR LAS VEGAS NV	13823313008
VASQUEZ ELIAS & ELIZABETH	800 OVERVIEW DR LAS VEGAS NV	13823615002
VILLALPANDO MAILE & CARLOS J	6316 BLUE TWILIGHT CT LAS VEGAS NV	13823721019
WAKLEY ESTHER JEAN	6328 BLUE TWILIGHT CT LAS VEGAS NV	13823721016
WALIA GURPREET SINGH L L C	1968 KNOLLWOOD RD SYOSSET NY	13823710036
WALTERS RENE M TRUST	6239 DON GASPARE AVE LAS VEGAS NV	13823615039
WARD JEAN RUPPERT	2036 BAVINGTON DR #A LAS VEGAS NV	13823213001
WASHBURN MARK F & TERRI L FAM TR	6034 CAPE CLAIRMONT CT NO LAS VEGAS NV	13823721034
WASHINGTON BERTRAL T	P O BOX 750242 LAS VEGAS NV	13823710008

Report of All Selected Parcels**Case Number:** SUP-37618**Printed On:** Tue: March 23, 2010

<u>Owner</u>	<u>Address</u>	<u>Parcel Number</u>
WATERS ZACHARY P	6500 W LAKE MEAD BLVD #205 BLDG #A3 LAS VEGAS NV	13823214084
WELCH SUSAN L	6500 W LAKE MEAD #124 LAS VEGAS NV	13823214091
WEST ROB	6500 W LAKE MEAD BLVD #230 BLDG#B1 LAS VEGAS NV	13823214105
WILHOIT REVOCABLE TRUST	2043 N ROSS ST SANTA ANA CA	13823717024
WILLIAMS DOLORES	2100 CONCHITA ST LAS VEGAS NV	13823615013
WILLIAMS EVE B	%WILLIAMS BONITA 5365 OXBOW ST LAS VEGAS NV	13823212030
WILLIAMS RDNALD J & TERENCE H TR	15 REDWING RD WELLESLEY MA	13823211012
WILLIAMS WILLIAM & MARILYN K	2032 BAVINGTON DR #A LAS VEGAS NV	13823213049
WILSON BRENT	2112 CONCHITA ST LAS VEGAS NV	13823615007
WISE CANDACE	6315 DON ZAREMBO AVE LAS VEGAS NV	13823615021
WOLF JOSEPH M	P O BOX 27793 LAS VEGAS NV	13823211024
WRENN MARY E	2028 WILLDWBURY DR #A LAS VEGAS NV	13823213061
WYLIE MICHELE R	2031 CHETSEY DR #C LAS VEGAS NV	13823213067
YAJNIK SAMIR	3221 BUCHANAN ST #6 SAN FRANCISCO CA	13823214097
YAN ABUNDIO LAHOY-LAHOY	2117 WILLOWBURY DR #A LAS VEGAS NV	13823212009
YAN MIN JUAN	848 N RAINBOW BLVD #828 LAS VEGAS NV	13823214103
YOGI HENRY	P O BOX 507 WAILUKU MAUI HI	13823721042
YOUR MARKET REAL ESTATE L L C	6212 SILVER VEIN ST NO LAS VEGAS NV	13823214099
YOUR MARKET REAL ESTATE L L C	6212 SILVER VEIN ST NO LAS VEGAS NV	13823214064
ZUPANCIC JUDY J	6248 DON ZAREMBO AVE LAS VEGAS NV	13823613048

City of Las Vegas
Planning & Development Department
Development Services Center
731 S. Fourth Street
Las Vegas, Nevada 89101-2986

Return Service Requested
Official Notice of Public Hearing

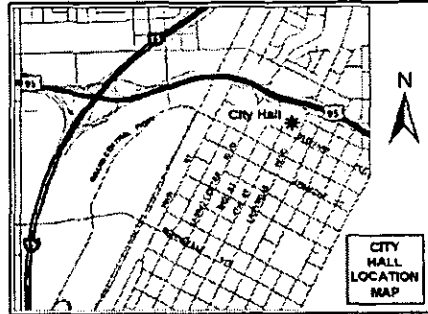

If you wish to file your protest or support on this request, check the appropriate box below and return this card in an envelope with postage to the Planning & Development Department at the address listed above or fax this side of this card to (702) 385-7268. If you would like to contact your Council Representative, please call (702) 229-6405.

I SUPPORT
this Request

I OPPOSE
this Request

Please use available blank space on card for your comments.

SUP-37618

Planning Commission Meeting of 4/22/2010

PRESORTED
FIRST CLASS



02 1M
0004279218 APR 09 2010
MAILED FROM ZIP CODE 89101

\$ 00.414

13823211023
GUTHRIE WALTER K
2141 TWICKENHAM PL #C
LAS VEGAS NV 89108-3461

Case: SUP-37618

APR 13 2010

BAVDE11 0910A



12P

City of Las Vegas
Planning & Development Department
Development Services Center
731 S. Fourth Street
Las Vegas, Nevada 89101-2986

Return Service Requested
Official Notice of Public Hearing

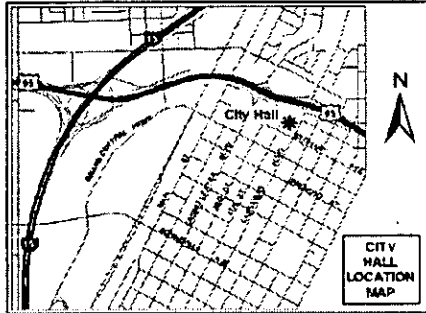

If you wish to file your protest or support on this request, check the appropriate box below and return this card in an envelope with postage to the Planning & Development Department at the address listed above or fax this side of this card to (702) 385-7268. If you would like to contact your Council Representative, please call (702) 229-6405.

I SUPPORT
this Request

I OPPOSE
this Request

Please use available blank space on card for your comments.

SUP-37618

Planning Commission Meeting of 4/22/2010

PRESORTED
FIRST CLASS



UNITED STATES POSTAGE
PITNEY BOWES
02 1M \$ 00.414
0004279218 APR 09 2010
MAILED FROM ZIP CODE 89101

AT LAS VEGAS NV 890 04-10-10

13823214098
KHAN HAROON
3417 ANDREW DR
BRYANT AR 72022-9097

Case: SUP-37618

APR 19 2010

BAVDS I 72022



Submitted after final agenda
Date APR 19
Item 19

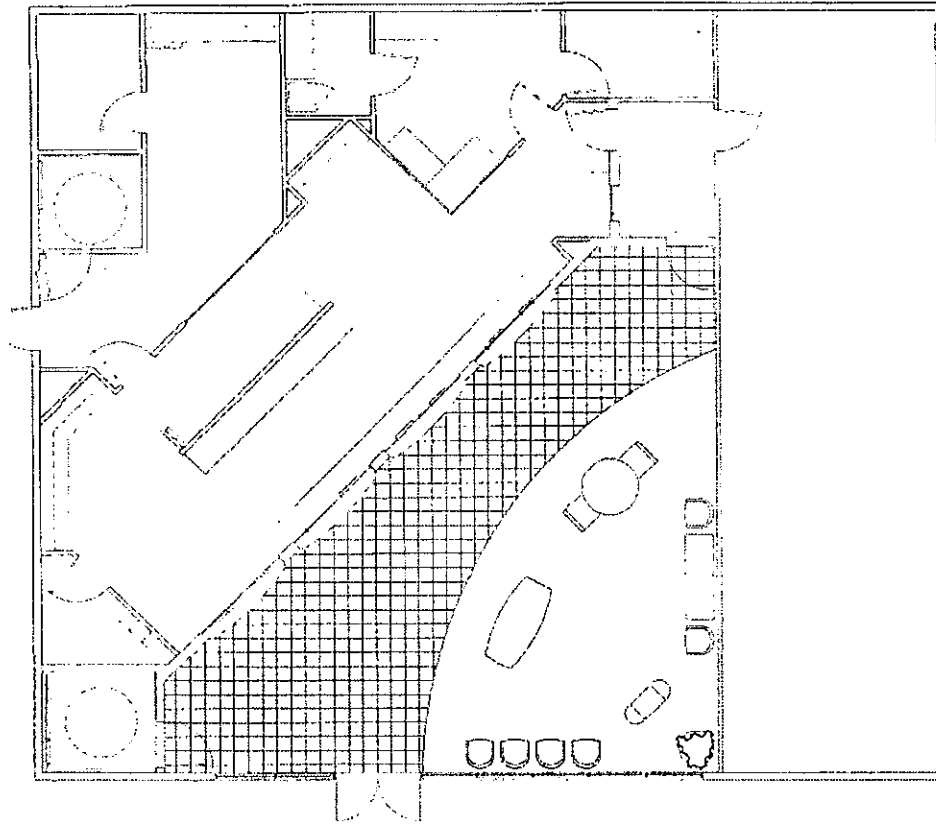

A
N

RECEIVED

MAR 09 2010

SUP-37618
04/22/10 PC

LAKE MEAD

Northeast corner of Lake Mead Boulevard
and Torrey Pines Boulevard

NEC Lake Mead & Torrey Pines

- Parking Required**
- Convenience Store
3,060 Square feet /250=13
 - Mr. Eats Take-out Pizza
933 square feet/200=5
67 square feet/50=2
(public area)
 - Check City, class III
2000 square feet/175=12
 - Torrey Pines Tavern
4040 total square feet/
2940 public area/50=59
1100 back of house/200=6

Total Required -97 spaces
Total provided- 99 spaces

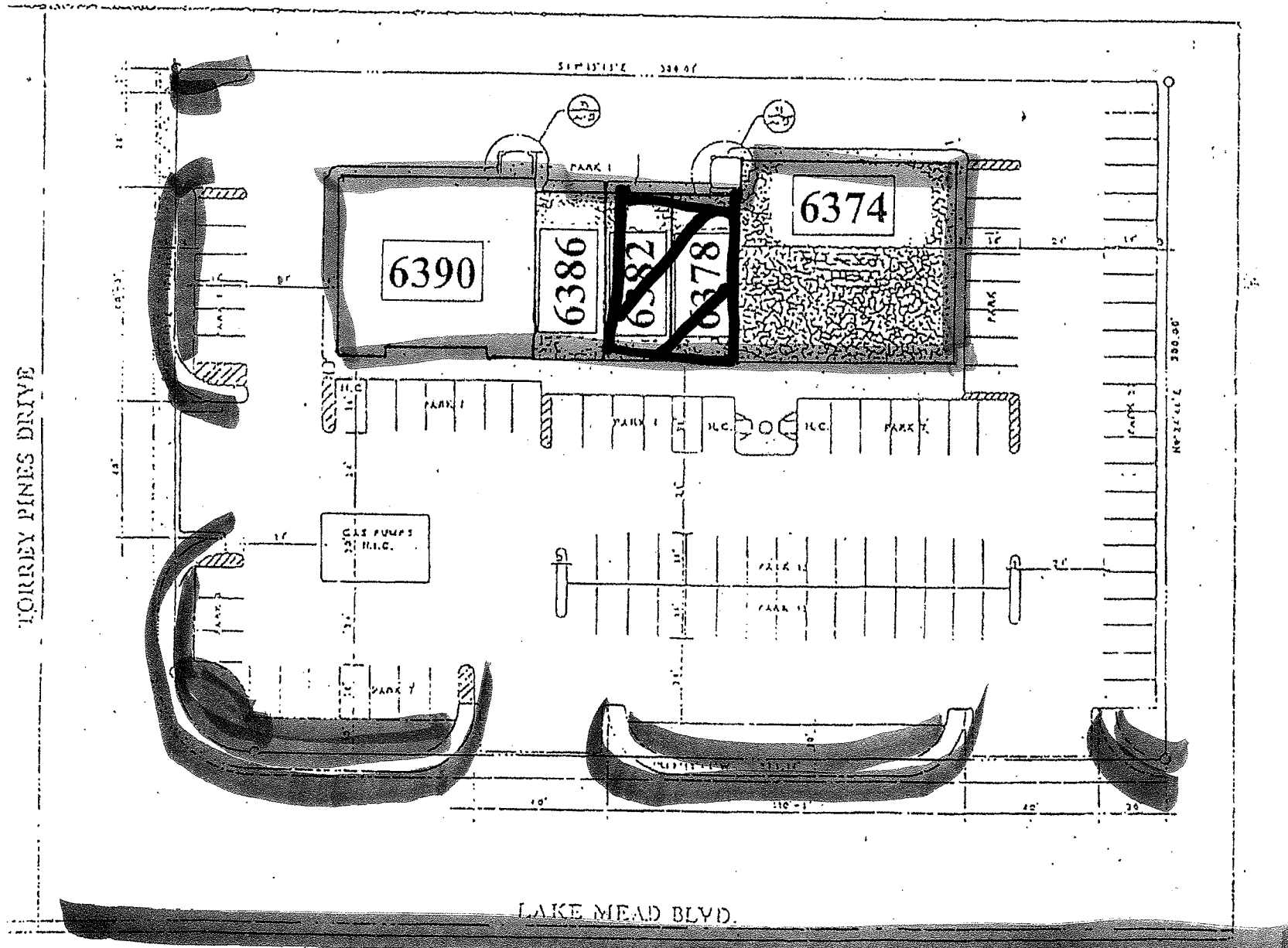

1 site plan

RECEIVED
MAR 23 2010
SUP-37618
REVISED

SUP-37618 REVISED (SITE PLAN) STAMPED 3-23-10