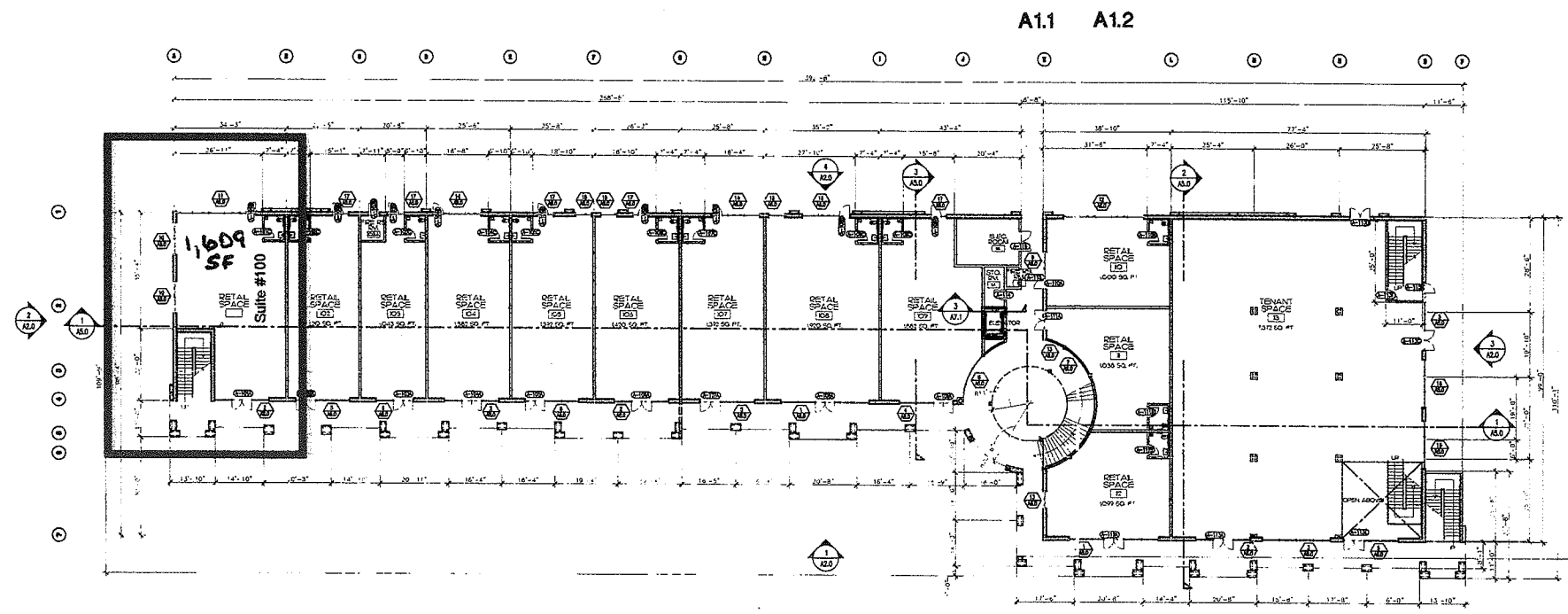
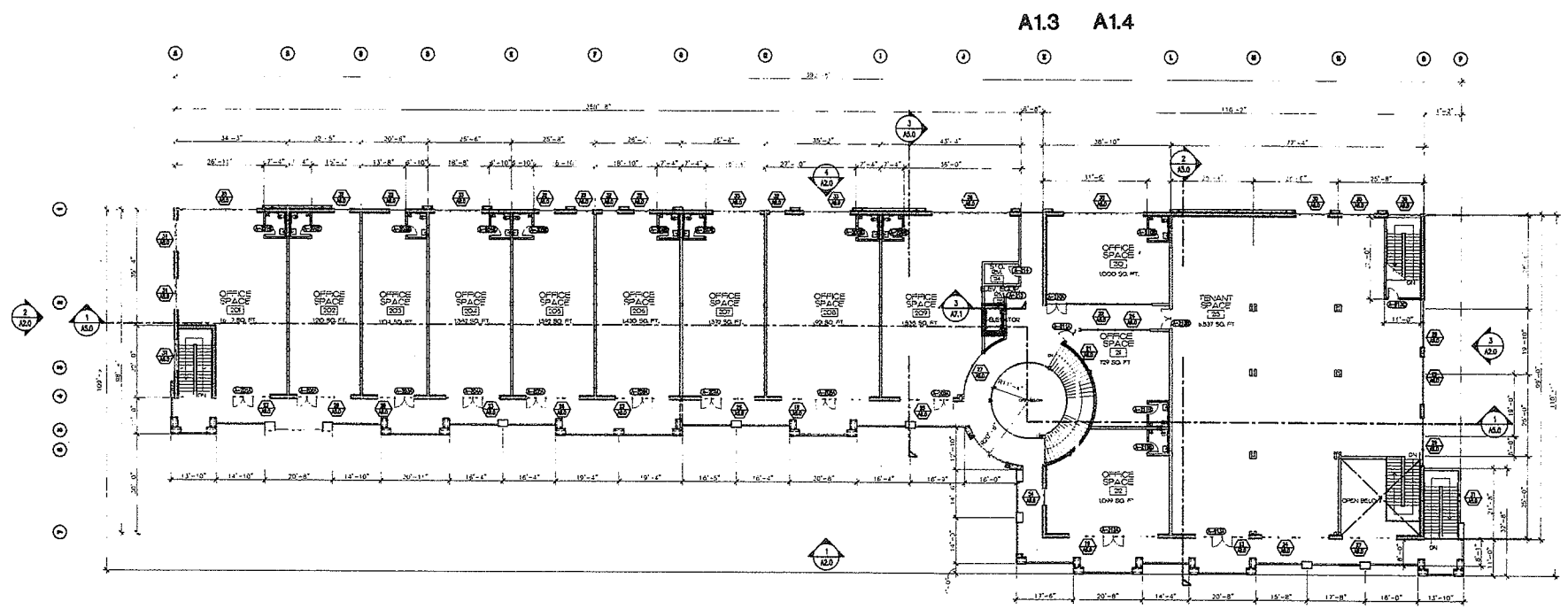

Exhibit A



A1.1 A1.2  
**1 FIRST FLOOR**  
 SCALE: 1/16" = 1'  
 NORTH



A1.3 A1.4  
**2 SECOND FLOOR**  
 SCALE: 1/16" = 1'  
 NORTH

**WALL LEGEND**

- EXTERIOR WALLS: 3/4" O.S.B. SHEATHING ON THE WOOD STUDS @ 16" O.C. WITH 7/8" EXTERIOR JOIST PLATES OF PLYWOOD-BACKED METAL LATH WHEN EXPOSED TO EXTERIOR WEATHER WITH INSULATION BETWEEN STUDS AND 5/8" TYPE 'X' GYP. BD. INSIDE EXPOSED TO INTERIOR. USE 2X6 STUDS AT UNSUPPORTED DOUBLE-HIGHT WALLS.
- CMU MASONRY WALL
- PLUMBING WALL: 2X6 WOOD STUDS @ 16" O.C. W/ 1/2" RIGID INSULATION BETWEEN STUDS & 5/8" INSULATED RESISTANT GYP. BOARD BOTH SIDES.
- DRYING WALLS: 2X6 WOOD STUDS AT 16" O.C. WITH 5/8" TYPE 'X' GYP. BOARD EACH SIDE UNLESS NOTED OTHERWISE.
- 4 HR. FIRE WALL

Approved	
Reviewed	
Drawn	
Checked	
Date	
By	
For	

**WINSTON H. HENDERSON ARCHITECTS**  
 1685 EAST FLAMINGO ROAD STE. #100 LAS VEGAS, NV 89119  
 OFFICE (702) 883-9700 FAX (702) 883-9707

**PATEL OFFICE BUILDING**  
 CRANG ROAD & TENAYA WAY  
 LAS VEGAS, NEVADA

**FIRST FLOOR PLAN**

Date: 06-27-06  
 Job No.: 05-206  
 Designed: W.H.H.  
 Drawn: S.K.  
 Update: 12-13-2006  
 Checked: W.H.H.

Sheet  
**A1.0**

RECEIVED  
 MAR 22 2011

**SUP-41263**

VACANT SC/C-1

Pet Cemetery  
DR/R-E

VACANT L Rezoned  
to Commercial

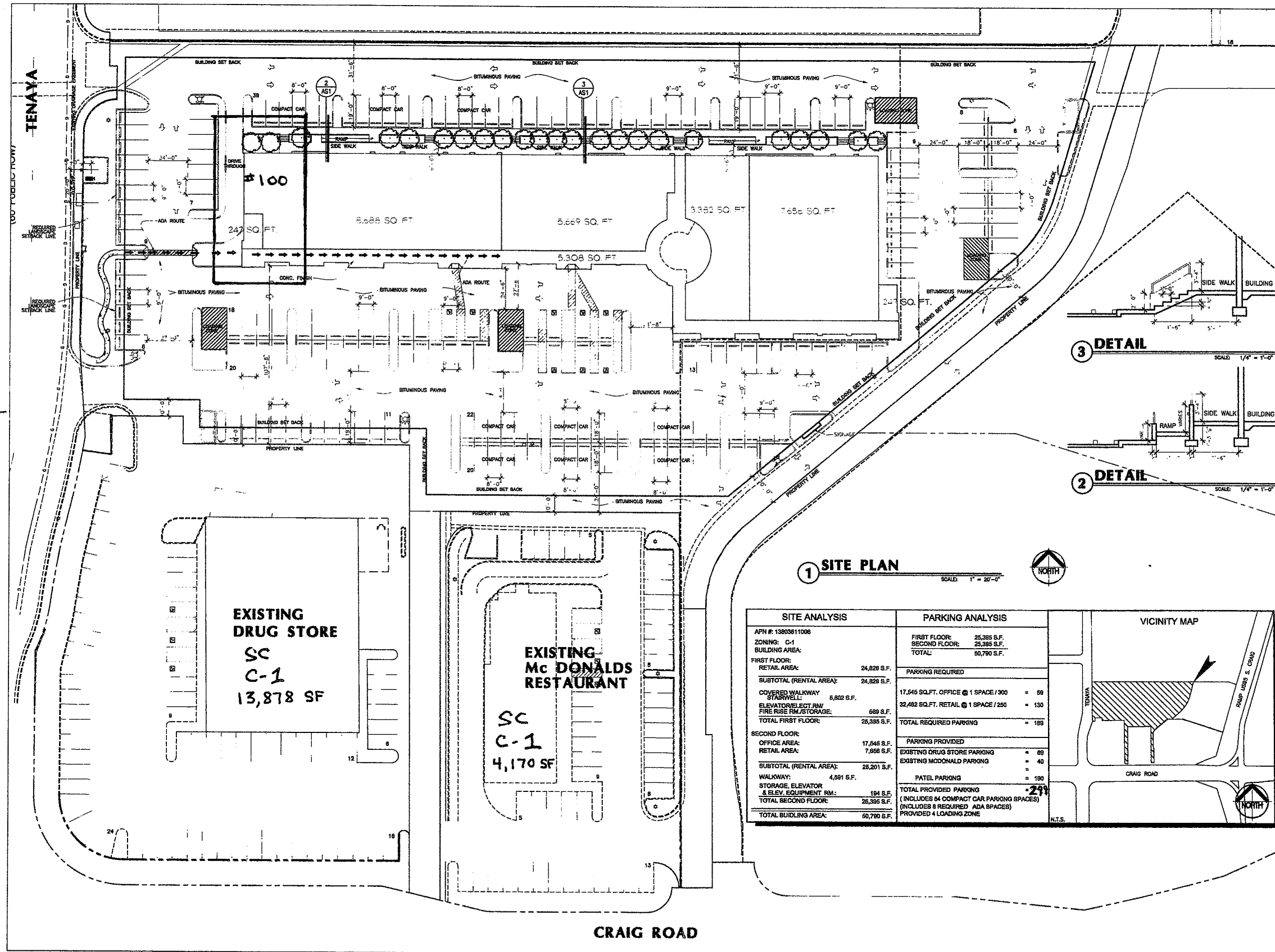

1 SITE PLAN SCALE: 1" = 20'-0"

SITE ANALYSIS		PARKING ANALYSIS		VICINITY MAP	
APN #: 13003611008		FIRST FLOOR: 25,385 S.F.		VICINITY MAP showing the site location relative to Tenaya and Craig Road.	
ZONING: C-1		SECOND FLOOR: 25,395 S.F.			
BUILDING AREA:		TOTAL: 50,780 S.F.			
FIRST FLOOR:		PARKING REQUIRED			
RETAIL AREA:	24,828 S.F.	17,545 SQ.FT. OFFICE @ 1 SPACE / 300 = 59			
SUBTOTAL (RENTAL AREA):	24,828 S.F.	32,482 SQ.FT. RETAIL @ 1 SPACE / 250 = 130			
COVERED WALKWAY	6,802 S.F.	TOTAL REQUIRED PARKING = 189			
ELEVATOR/ELECT. RM./FIRE RISE RM./STORAGE:	689 S.F.	PARKING PROVIDED			
TOTAL FIRST FLOOR:	25,385 S.F.	EXISTING DRUG STORE PARKING = 69			
SECOND FLOOR:		EXISTING MCDONALD PARKING = 40			
OFFICE AREA:	17,545 S.F.	PATEL PARKING = 190			
RETAIL AREA:	7,858 S.F.	TOTAL PROVIDED PARKING = 299			
SUBTOTAL (RENTAL AREA):	25,201 S.F.	(INCLUDES 8 REQUIRED ADA SPACES)			
WALKWAY:	4,681 S.F.	PROVIDED 4 LOADING ZONE			
STORAGE, ELEVATOR & ELEV. EQUIPMENT RM.:	194 S.F.				
TOTAL SECOND FLOOR:	25,395 S.F.				
TOTAL BUILDING AREA:	50,780 S.F.				

3 DETAIL SCALE: 1/4" = 1'-0"

2 DETAIL SCALE: 1/4" = 1'-0"

Winston H. Henderson Architects  
1555 EAST FLAMINGO ROAD STE. 2500 LAS VEGAS, NV 89119  
OFFICE (702) 853-9700 FAX (702) 853-9777

PATEL OFFICE BUILDING  
CRAIG ROAD & TENAYA WAY  
LAS VEGAS, NEVADA

SITE PLAN 4450 N. TENAYA WAY  
November 17, 2010

Date: 09-27-06  
Job No.: 06-038  
Designed: WJH  
Drawn: B.K.  
Updated: 11-18-2006  
Checked: WJH

AS1

VACANT SC/C-1

RECEIVED  
APR 11 2011

SUP-41263  
REVISED

Shopping Center SC C-1

VACANT SC/C-1

Pet Cemetery  
DR/R-E

VACANT L Rezoned  
to Commercial

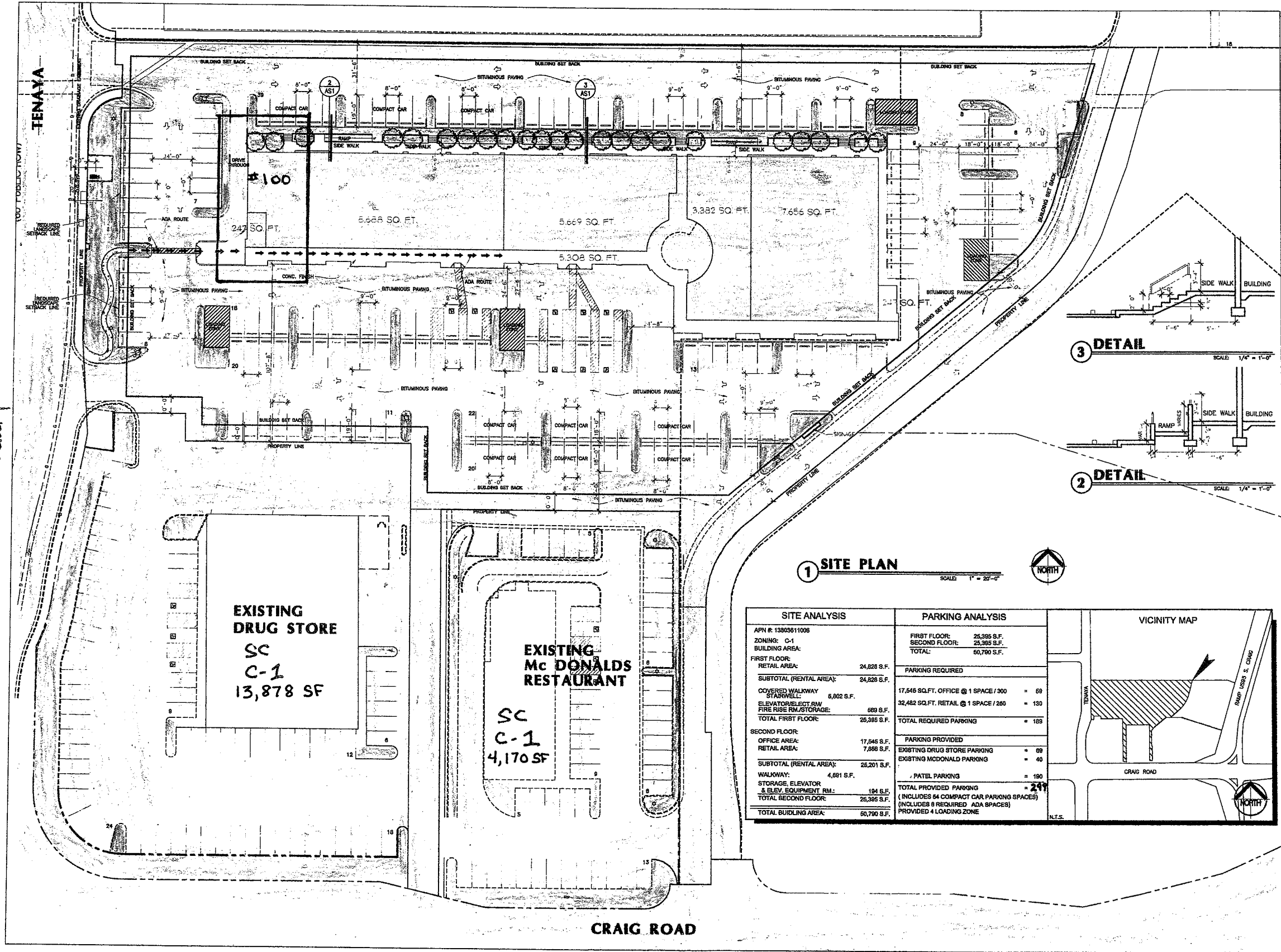

1 SITE PLAN SCALE: 1" = 20'-0"

SITE ANALYSIS	PARKING ANALYSIS	VICINITY MAP
APN #: 13803611008 ZONING: C-1 BUILDING AREA: FIRST FLOOR: RETAIL AREA: 24,828 S.F. SUBTOTAL (RENTAL AREA): 24,828 S.F. COVERED WALKWAY: 5,802 S.F. STAIRWELL: ELEVATOR/ELECT. RM: FIRE RISE RM./STORAGE: 689 S.F. TOTAL FIRST FLOOR: 25,385 S.F. SECOND FLOOR: OFFICE AREA: 17,845 S.F. RETAIL AREA: 7,858 S.F. SUBTOTAL (RENTAL AREA): 25,201 S.F. WALKWAY: 4,681 S.F. STORAGE, ELEVATOR & ELEV. EQUIPMENT RM.: 194 S.F. TOTAL SECOND FLOOR: 25,395 S.F. TOTAL BUILDING AREA: 60,700 S.F.	FIRST FLOOR: 25,385 S.F. SECOND FLOOR: 25,385 S.F. TOTAL: 60,700 S.F. PARKING REQUIRED 17,646 SQ.FT. OFFICE @ 1 SPACE / 300 = 69 32,482 SQ.FT. RETAIL @ 1 SPACE / 250 = 130 TOTAL REQUIRED PARKING = 199 PARKING PROVIDED EXISTING DRUG STORE PARKING = 69 EXISTING MCDONALD PARKING = 40 / PATEL PARKING = 190 TOTAL PROVIDED PARKING = 299 (INCLUDES 84 COMPACT CAR PARKING SPACES) (INCLUDES 8 REQUIRED ADA SPACES) PROVIDED 4 LOADING ZONE	

3 DETAIL SCALE: 1/4" = 1'-0"

2 DETAIL SCALE: 1/4" = 1'-0"

WINSTON H. HENDERSON  
ARCHITECTS  
1655 EAST FLANNING ROAD STE. 200 LAS VEGAS, NV 89119  
OFFICE (702) 862-9700 FAX (702) 862-9707

PATEL OFFICE BUILDING  
CRAIG ROAD & TENAYA WAY  
LAS VEGAS, NEVADA

SITE PLAN 4450 N. TENAYA WAY  
November 17, 2006 - 10:10am '06

Date: 09-27-06  
Job No.: 05-206  
Designed: WJH  
Drawn: BJK  
Updated: 11-18-2006  
Checked: WJH

AS1

VACANT SC/C-1

RECEIVED  
APR 17 2011

SUP-41263  
REVISED

shopping center SC C-1

RECEIVED  
MAR 22 2011

Exhibit A

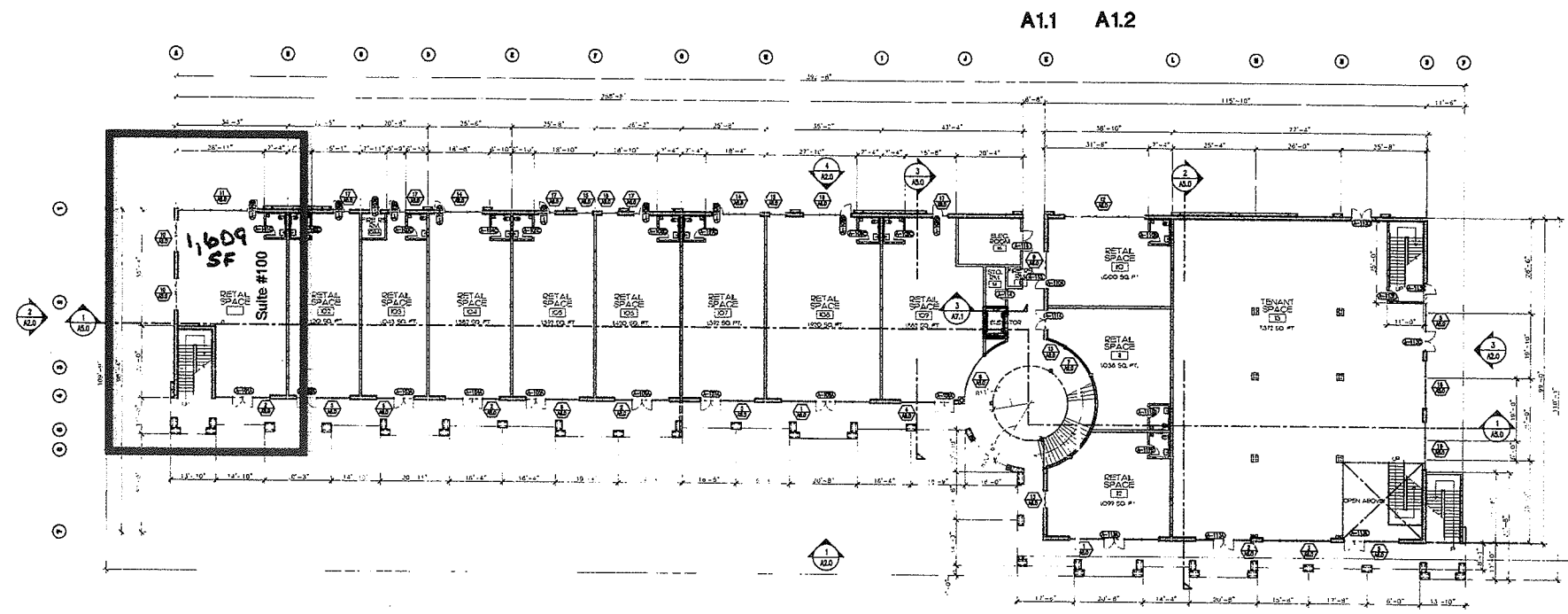

A.1 A.2  
1 FIRST FLOOR  
SCALE 1/8" = 1'

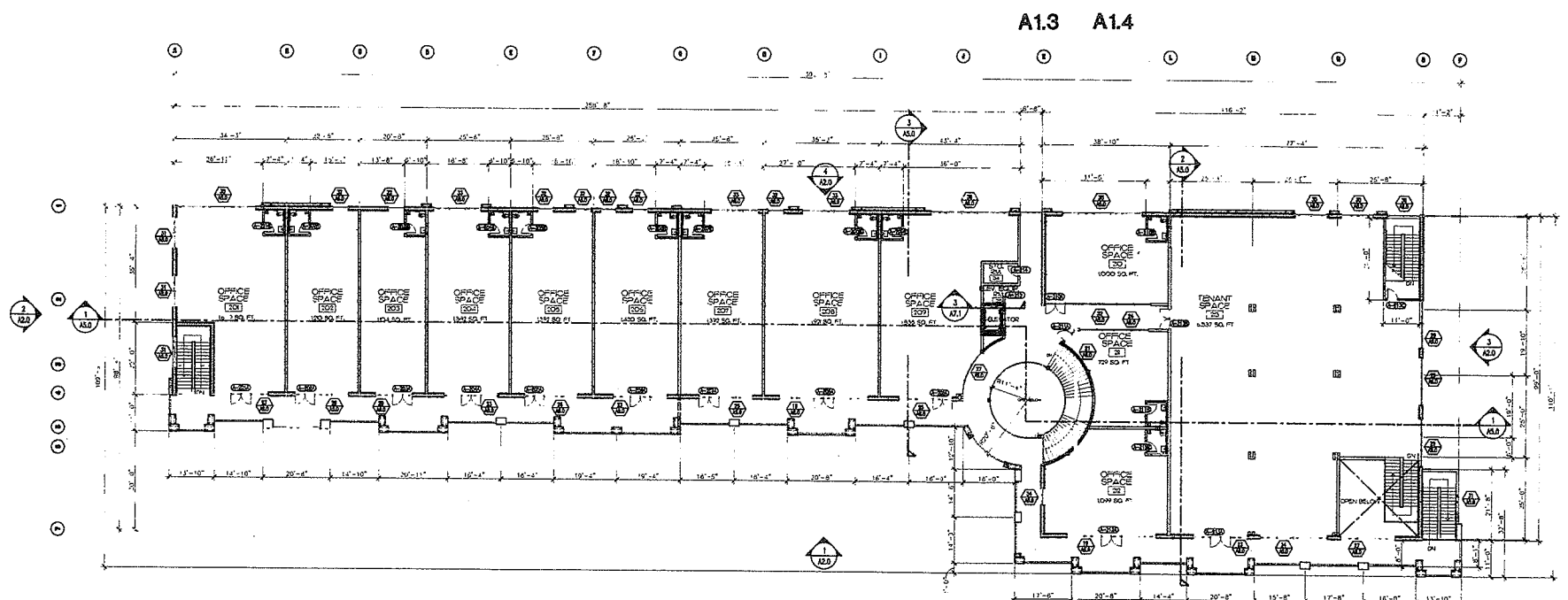

A.3 A.4  
2 SECOND FLOOR  
SCALE 1/8" = 1'

**WALL LEGEND**

- EXTERIOR WALLS: 5/8" O.S.B. SHEATHING ON 2x4 WOOD STUDS @ 16" O.C. WITH 7/8" EXTERIOR CORNER PLATES OF INSULATED METAL LATH WHERE EXPOSED TO EXTERIOR SPACE. 18" RIGID INSULATION BETWEEN STUDS. AND 5/8" TYPE "X" GYP. BD. WHERE EXPOSED TO INTERIOR SPACE. USE 2x6 STUDS AT UNSUPPORTED DOUBLE-HEIGHT WALLS.
- CMU MASONRY WALL
- PLUMBING WALL: 2x6 WOOD STUDS AT 16" O.C. W/ 1/2" R-15 BATT INSULATION BETWEEN STUDS. 5/8" GYP. BOARD EACH SIDE UNLESS NOTED OTHERWISE.
- DEMISING WALLS: 2x4 WOOD STUDS AT 16" O.C. WITH 5/8" TYPE "X" GYP. BOARD EACH SIDE UNLESS NOTED OTHERWISE.
- 4 HR. FIRE WALL

Author	
Checker	
Date	
By	
Drawn	

**WINSTON H. HENDERSON ARCHITECTS**  
 1855 EAST FLAMINGO ROAD STE. 400 LAS VEGAS, NV 89119  
 OFFICE (702) 883-9700 FAX (702) 883-9700

**PATEL OFFICE BUILDING**  
 CHINA ROAD, TERESA WAY  
 LAS VEGAS, NEVADA

**FIRST FLOOR PLAN**  
 Date: 09-27-05  
 Job No.: 05-208  
 Designed: W.H.H.  
 Drawn: B.K.  
 Updated: 12-13-2008  
 Checked: W.H.H.

Sheet  
**A1.0**

RECEIVED  
**SUP-41263** MAR 22 2011  
**05/10/11 PC**

VACANT SC/c-1

Pet Cemetery  
DR/R-E

VACANT L Rezoned  
to Commercial

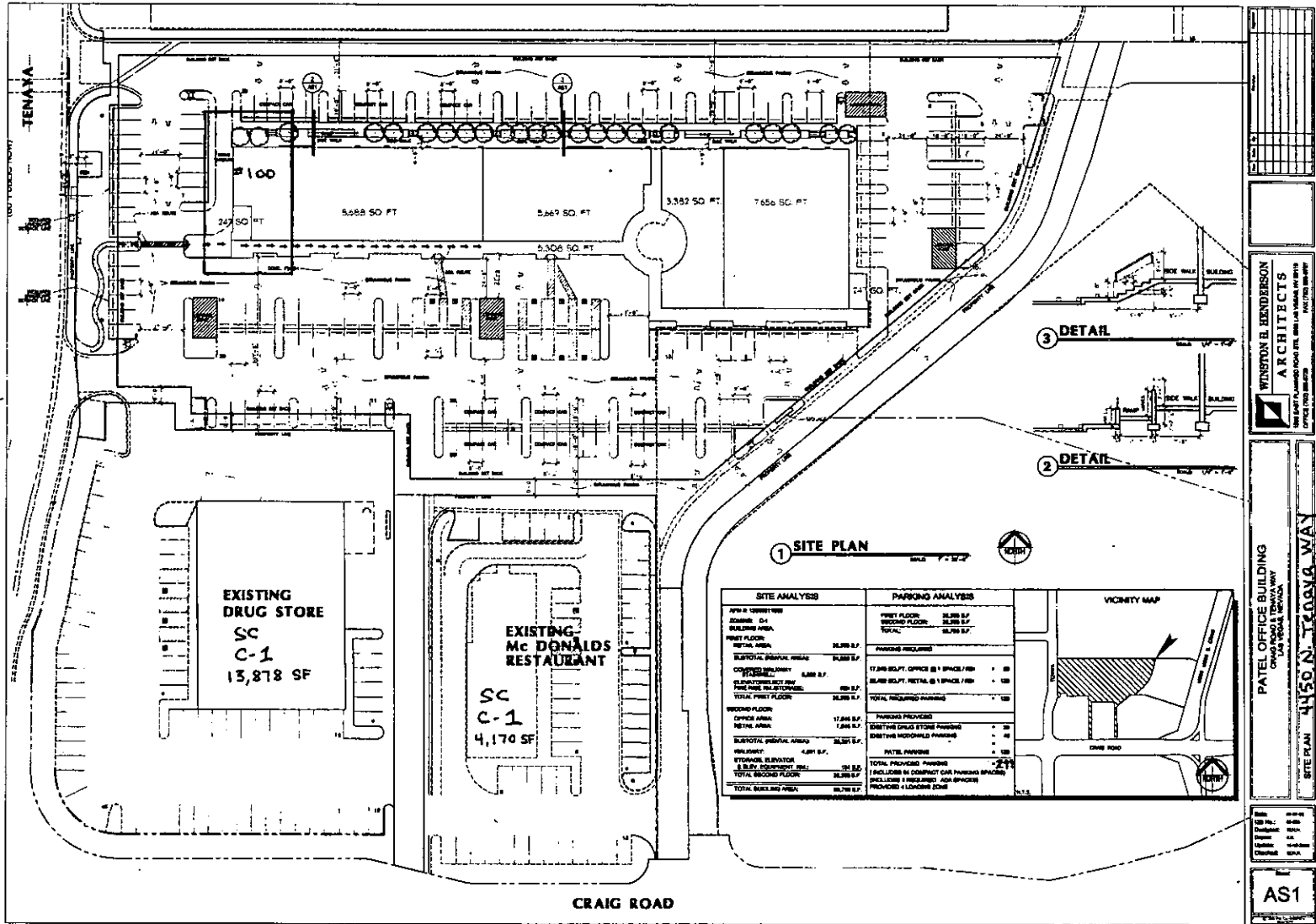

WINSTON B. BENDERSON  
ARCHITECTS  
1000 N. 10TH ST. SUITE 100  
DENVER, CO 80202  
OFFICE: 303.733.8800  
FAX: 303.733.8801

PATEL OFFICE BUILDING  
4150 N. TEALOGA WAY  
DENVER, CO 80202  
SITE PLAN  
AS1

VACANT SC/c-1

shopping center SC c-1

RECEIVED  
APR 11 2011

SUP-41263  
REVISED

Exhibit A

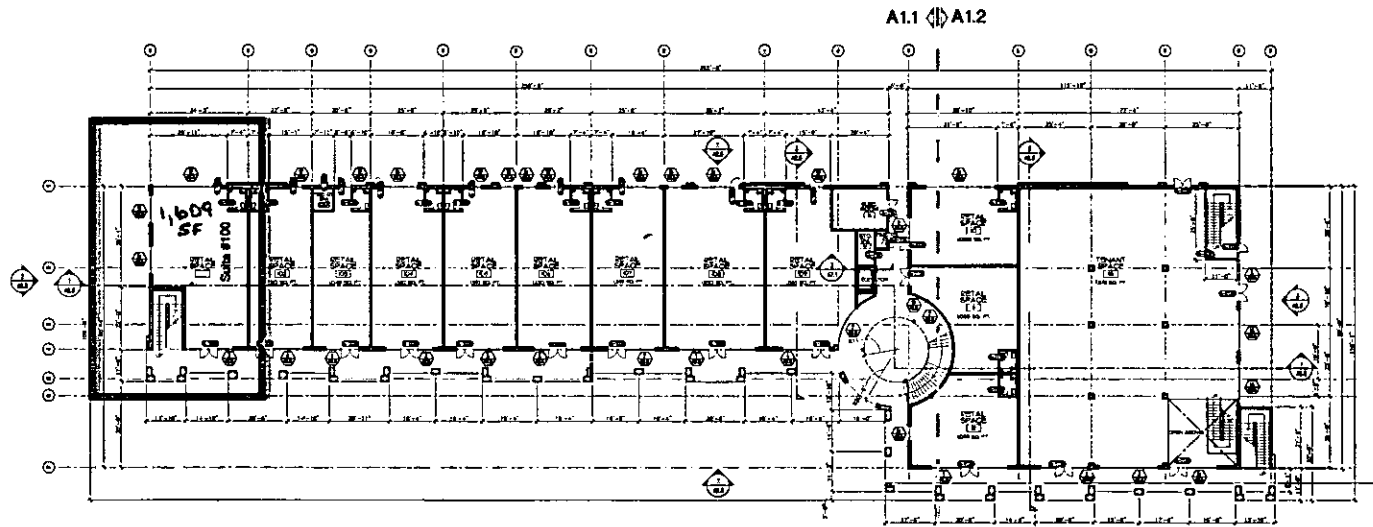

1 FIRST FLOOR

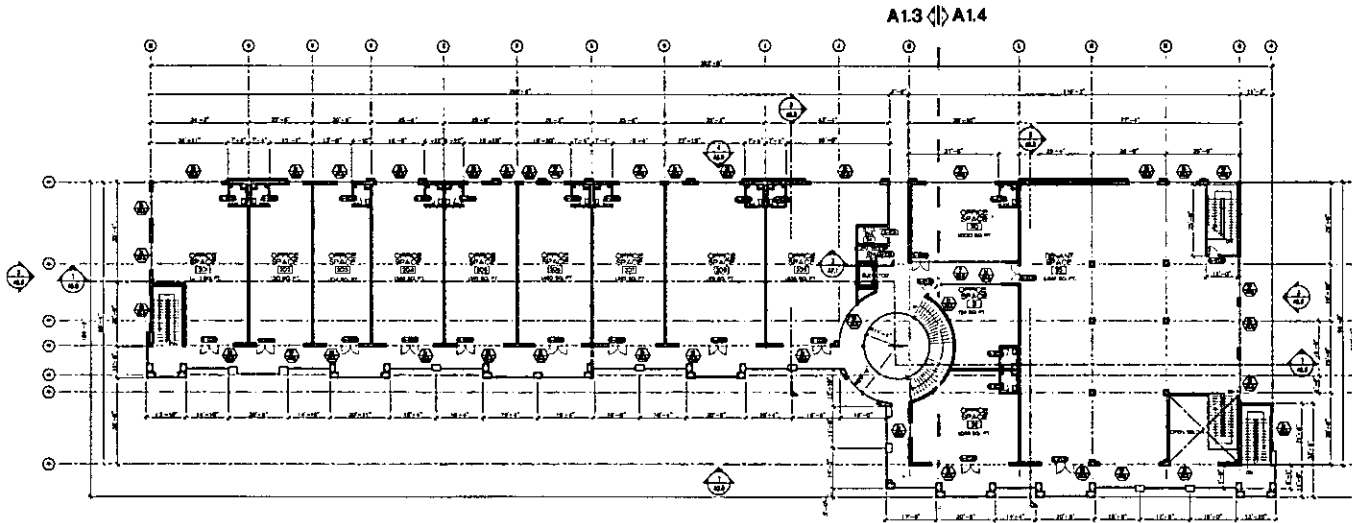

2 SECOND FLOOR

**WALL LEGEND**

[Symbol]	CONCRETE WALL
[Symbol]	CMU WALL
[Symbol]	GLASS WALL
[Symbol]	1/2" GYP. WALL

Rev.	By	Date	Description

**WINSTON H. HENDERSON  
ARCHITECTS**  
 1915 EAST PLANNING ROAD STE. 2000 LAS VEGAS, NV 89115  
 OFFICE (702) 884-9000 FAX (702) 884-9070

**PATEL OFFICE BUILDING**  
 CHANG ROAD & TENAYA WAY  
 LAS VEGAS, NEVADA

FIRST FLOOR PLAN

Date: 02-23-08  
 Job No.: 0808  
 Designer: W.H.H.  
 Checker: S.E.  
 Scale: 1/8" = 1'-0"

Sheet  
**A1.0**

**RECEIVED**  
 MAR 22 2011

**SUP-41263**

City of Las Vegas  
 Department of Planning  
 Development Services Center  
 333 North Rancho Drive, 3<sup>rd</sup> Floor  
 Las Vegas, Nevada 89106

**Return Service Requested  
 Official Notice of Public Hearing**

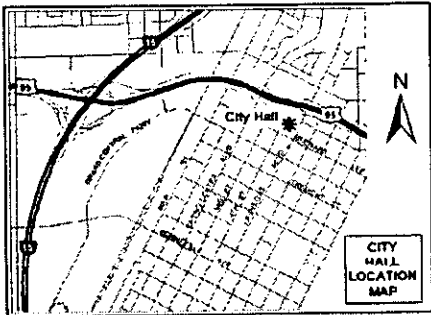

If you wish to file your protest or support on this request, check the appropriate box below and return this card in an envelope with postage to the Department of Planning, Case Planning Division at the address listed above or fax this side of this card to (702) 385-7268. If you would like to contact your Council Representative, please call (702) 229-6405.

I SUPPORT  
 this Request

I OPPOSE  
 this Request

*over*

Please use available blank space on card for your comments.

**SUP-41263**

Planning Commission Meeting of 5/10/2011

65 BRDFN11 89129

**Application Information**

**SUP-41263 - SPECIAL USE PERMIT - PUBLIC HEARING - APPLICANT: NORTHWEST ARMS - OWNER: SHREE GANESHA, INC.** - Request for a Special Use Permit FOR A SECONDHAND DEALER USE (FIREARMS) IN CONJUNCTION WITH A RETAIL ESTABLISHMENT at 4450 North Tenaya Way, Suite #100 (APN 138-03-611-011), C-1 (Limited Commercial) Zone, Ward 4 (Anthony).

*I oppose this as it is too close to a residential area with an Elementary School!*

**Application Location**

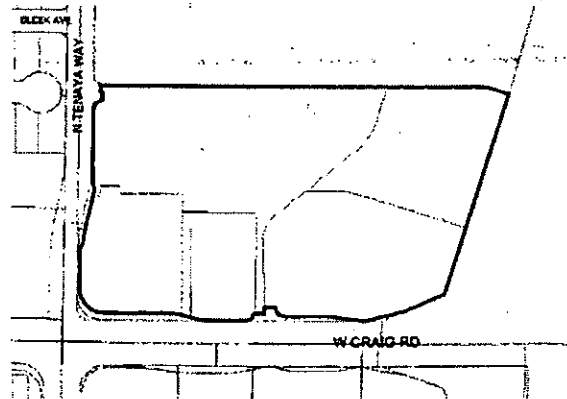

The proposed project may not pertain to the entire highlighted project site.

**Public Hearing Information**

**Meeting:** Planning Commission  
**Date:** May 10, 2011  
**Time:** 6:00 P.M.  
**Location:** City Council Chambers  
 400 Stewart Avenue  
 Las Vegas, Nevada

*33P*

PRESORTED  
 FIRST CLASS



UNITED STATES POSTAGE  
 PERMIT NO. 1000 LAS VEGAS NV  
 \$ 00.414  
 02 1M  
 0004279218 APR 28 2011  
 MAILED FROM ZIP CODE 89101



Case: SUP-41263  
 13803217015  
 SOWERS DENNIS B & LAURA A  
 4421 ORNATE CT  
 LAS VEGAS NV 89129-5986

City of Las Vegas  
Department of Planning  
Development Services Center  
333 North Rancho Drive, 3<sup>rd</sup> Floor  
Las Vegas, Nevada 89106

**Return Service Requested  
Official Notice of Public Hearing**

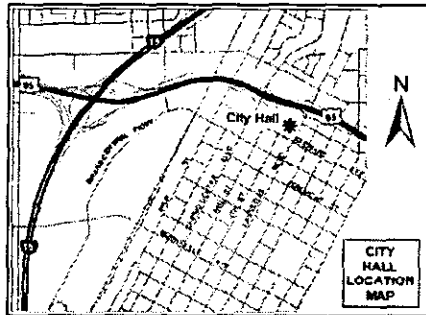

If you wish to file your protest or support on this request, check the appropriate box below and return this card in an envelope with postage to the Department of Planning, Case Planning Division at the address listed above or fax this side of this card to (702) 385-7268. If you would like to contact your Council Representative, please call (702) 229-6405.

I SUPPORT  
this Request

I OPPOSE  
this Request

Please use available blank space on card for your comments.

**SUP-41263**

Planning Commission Meeting of 5/10/2011

PRESORTED  
FIRST CLASS



UNITED STATES POSTAGE  
PINEY BOWLES  
02 1M \$ 00.414  
0004279218 APR 28 2011  
MAILED FROM ZIP CODE 89101

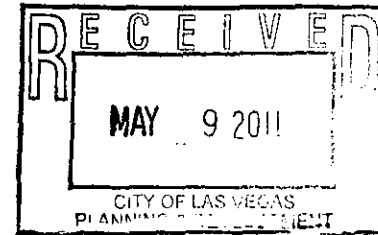

Case: SUP-41263  
13803610017  
WAMMACK KATHLEEN M  
7004 GOLDEN DESERT AVE  
LAS VEGAS NV 89129-7114

ES BRDFM11 65129



123P

City of Las Vegas  
Department of Planning  
Development Services Center  
333 North Rancho Drive, 3<sup>rd</sup> Floor  
Las Vegas, Nevada 89106

**Return Service Requested**  
**Official Notice of Public Hearing**

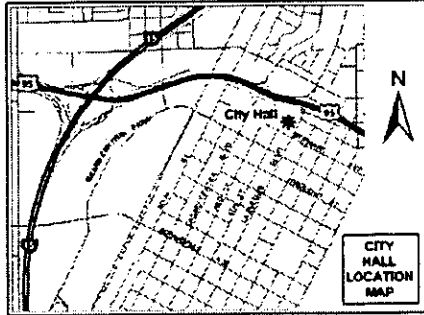

If you wish to file your protest or support on this request, check the appropriate box below and return this card in an envelope with postage to the Department of Planning, Case Planning Division at the address listed above or fax this side of this card to (702) 385-7268. If you would like to contact your Council Representative, please call (702) 229-6405.

I SUPPORT  
this Request

I OPPOSE  
this Request

Please use available blank space on card for your comments.

**SUP-41263**

Planning Commission Meeting of 5/10/2011

PRESORTED  
FIRST CLASS

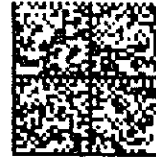

02 1M \$00.414  
0004279218 APR 28 2011  
MAILED FROM ZIP CODE 89101

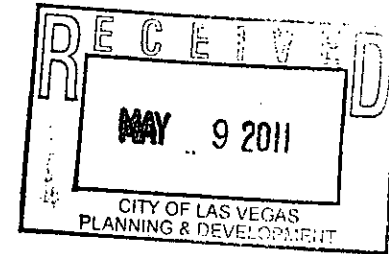

13803215026  
SILVESTRI JOSEPH P  
7301 STANGE AVE  
LAS VEGAS NV 89129-5951

Case: SUP-41263

65 BRDFN11 65129



33A

City of Las Vegas  
Department of Planning  
Development Services Center  
333 North Rancho Drive, 3<sup>rd</sup> Floor  
Las Vegas, Nevada 89106

**Return Service Requested  
Official Notice of Public Hearing**

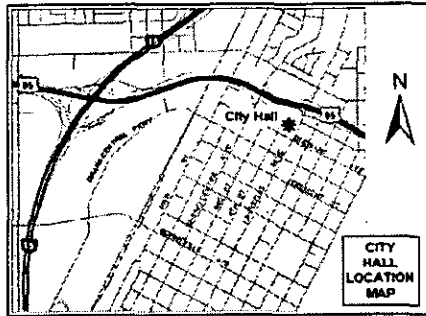

If you wish to file your protest or support on this request, check the appropriate box below and return this card in an envelope with postage to the Department of Planning, Case Planning Division at the address listed above or fax this side of this card to (702) 385-7268. If you would like to contact your Council Representative, please call (702) 229-6405.

I SUPPORT  
this Request

I OPPOSE  
this Request

Please use available blank space on card for your comments.

**SUP-41263**

Planning Commission Meeting of 5/10/2011

PRESORTED  
FIRST CLASS



02 1M  
0004279218  
MAILED FROM ZIP CODE 89101

**\$ 00.414**  
APR 28 2011

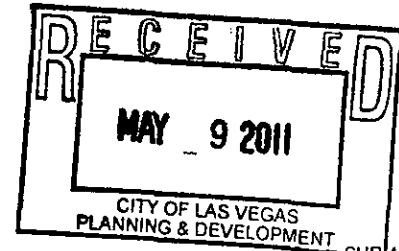

Case: SUP-41263  
13803610024  
MENDEZ MARIA PAZ G  
7025 GOLDEN DESERT AVE  
LAS VEGAS NV 89129-7114

69 BRDFN11 69129



438

City of Las Vegas  
Department of Planning  
Development Services Center  
333 North Rancho Drive, 3<sup>rd</sup> Floor  
Las Vegas, Nevada 89106

**Return Service Requested  
Official Notice of Public Hearing**

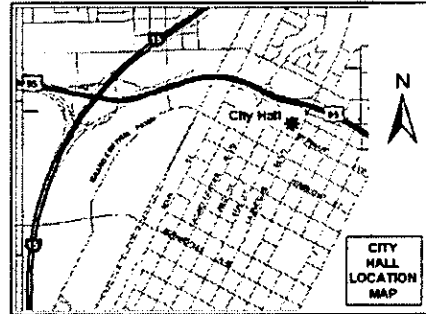

If you wish to file your protest or support on this request, check the appropriate box below and return this card in an envelope with postage to the Department of Planning, Case Planning Division at the address listed above or fax this side of this card to (702) 385-7268. If you would like to contact your Council Representative, please call (702) 229-6405.

I SUPPORT  
this Request

I OPPOSE  
this Request

Please use available blank space on card for your comments.

**SUP-41263**

Planning Commission Meeting of 5/10/2011

PRESORTED  
FIRST CLASS



UNITED STATES POSTAGE  
PITNEY BOWES  
02 1M \$ 00.414  
0004279218 APR 28 2011  
MAILED FROM ZIP CODE 89101



Case: SUP-41263  
13803217024  
NOONAN RICHARD F & LORRAINE A  
4412 ORNATE CT  
LAS VEGAS NV 89129-5986

69 BRDFN11 69129



1338

City of Las Vegas  
Department of Planning  
Development Services Center  
333 North Rancho Drive, 3<sup>rd</sup> Floor  
Las Vegas, Nevada 89106

**Return Service Requested  
Official Notice of Public Hearing**

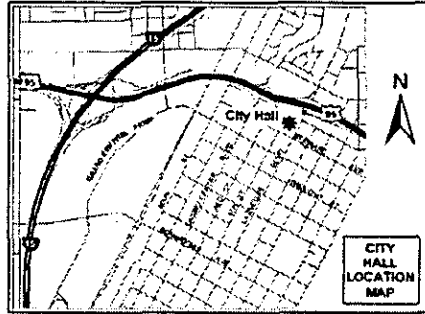

If you wish to file your protest or support on this request, check the appropriate box below and return this card in an envelope with postage to the Department of Planning, Case Planning Division at the address listed above or fax this side of this card to (702) 385-7268. If you would like to contact your Council Representative, please call (702) 229-6405.

I SUPPORT  
this Request

I OPPOSE  
this Request

Please use available blank space on card for your comments.

**SUP-41263**

Planning Commission Meeting of 5/10/2011

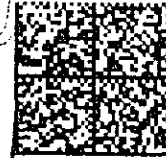

UNITED STATES POSTAGE  
PITNEY BOWES  
02 1M \$ 00.414  
0004279218 APR 28 2011  
MAILED FROM ZIP CODE 89101

*Why would anyone in  
his or her right mind want  
a gun store in a residential  
neighborhood. Absolutely not!*

*Alan A Silverman*

Case: SUP-41263  
13803217027  
SILVERMAN ALAN A & S LIV TR  
7208 SLEEK AVE  
LAS VEGAS NV 89129-5985

65 8907411 89129

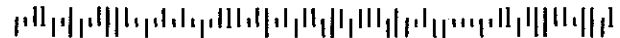

*MS*

City of Las Vegas  
Department of Planning  
Development Services Center  
333 North Rancho Drive, 3<sup>rd</sup> Floor  
Las Vegas, Nevada 89106

**Return Service Requested**  
**Official Notice of Public Hearing**

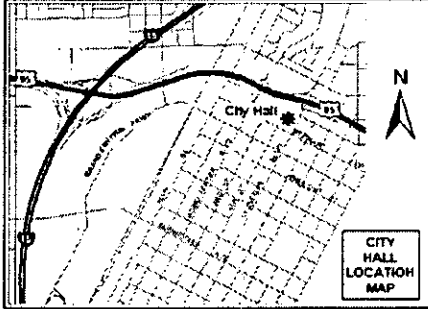

If you wish to file your protest or support on this request, check the appropriate box below and return this card in an envelope with postage to the Department of Planning, Case Planning Division at the address listed above or fax this side of this card to (702) 385-7268. If you would like to contact your Council Representative, please call (702) 229-4405.

I SUPPORT  
this Request

I OPPOSE  
this Request

Please use available blank space on card for your comments.

**SUP-41263**

Planning Commission Meeting of 5/10/2011

69 BRDFN11 89129

PRESORTED  
FIRST CLASS



UNITED STATES POSTAGE  
02 1M \$ 00.414  
0004279218 APR 28 2011  
MAILED FROM ZIP CODE 89101

RECEIVED

MAY 17 2011

13803218016

Case: SUP-41263

~~WHETSTONE KENNETH R~~  
4517 VOGUE ST  
LAS VEGAS NV 89129-5987

PAWLAK, JILL



City of Las Vegas  
Department of Planning  
Development Services Center  
333 North Rancho Drive, 3<sup>rd</sup> Floor  
Las Vegas, Nevada 89106

### Return Service Requested Official Notice of Public Hearing

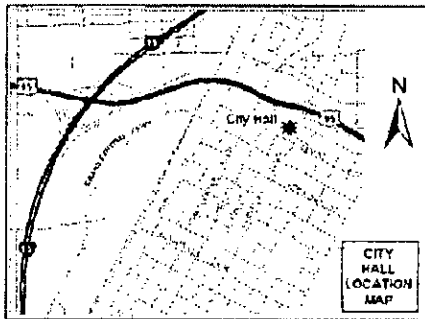

If you wish to file your protest or support on this request, check the appropriate box below and return this card in an envelope with postage to the Department of Planning, Case Planning Division at the address listed above or fax this side of this card to (702) 385-7268. If you would like to contact your Council Representative, please call (702) 229-6405.

I SUPPORT  
this Request

I OPPOSE  
this Request

Please use available blank space on card for your comments.

**SUP-41263**

Planning Commission Meeting of 5/10/2011

13803217033  
HOBBS VIVIAN  
7232 SLEEK AVE  
LAS VEGAS NV 89129-5985

Case: SUP-41263

RECEIVED  
MAY 19 2011



001

City of Las Vegas  
Department of Planning  
Development Services Center  
333 North Rancho Drive, 3<sup>rd</sup> Floor  
Las Vegas, Nevada 89106

**Return Service Requested  
Official Notice of Public Hearing**

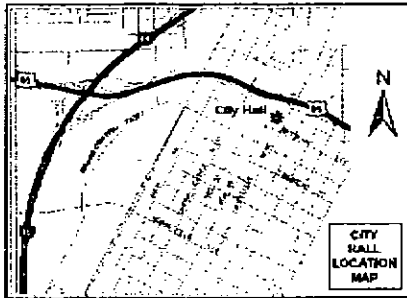

If you wish to file your protest or support on this request, check the appropriate box below and return this card in an envelope with postage to the Department of Planning, Case Planning Division at the address listed above or fax this side of this card to (702) 385-7268. If you would like to contact your Council Representative, please call (702) 229-6405.

I SUPPORT  
this Request

I OPPOSE  
this Request

Please use available blank space on card for your comments.

**SUP-41263**

Planning Commission Meeting of 5/10/2011

0029982406



PRESORTED  
FIRST CLASS

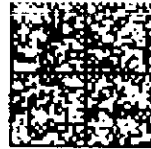

UNITED STATES POSTAGE  
\$ 00.41<sup>4</sup>  
92 1M  
000 4279 212 APR 28 2011  
MAILED FROM ZIP CODE 89101

2011-04-28 11:00 AM LV NV 89

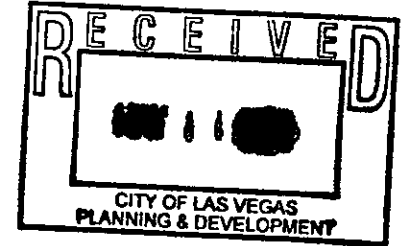

Case: SUP-41263

13803514059  
ALCALDE MARIA DEL CARMEN  
451 BLACKTHORN AVE  
TORONTO ON M6M 3C5  
CANADA 00000-0000

HRC F

05/11/2011 12:29 FAX 4167473217

May. 03 2011 04:43PM P1

FAX NO. : 212 619 5704

FROM : SIRACUSA IIII

City of Las Vegas  
Department of Planning  
Development Services Center  
333 North Rancho Drive, 3<sup>rd</sup> Floor  
Las Vegas, Nevada 89106

**Return Service Requested  
Official Notice of Public Hearing**

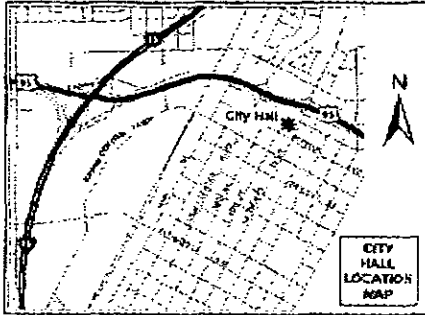

If you wish to file your protest or support on this request, check the appropriate box below and return this card in an envelope with postage to the Department of Planning, Case Planning Division at the address listed above or fax this side of this card to (702) 385-7268. If you would like to contact your Council Representative, please call (702) 229-6405.

I SUPPORT  
this Request

I OPPOSE  
this Request

Please use available blank space on card for your comments.

**SUP-41263**

Planning Commission Meeting of 5/10/2011

102 BRDFN11 10024



33P

PRESORTED  
FIRST CLASS

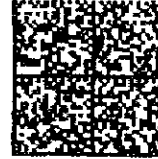

02 1M \$ 00.41<sup>4</sup>  
0004279218 APR 28 2011  
MAILED FROM ZIP CODE 89101



13803313030 Case: SUP-41263  
SIRACUSA RICHARD A  
308 W 82ND ST  
NEW YORK NY 10024-5344

City of Las Vegas  
Department of Planning  
Development Services Center  
333 North Rancho Drive, 3rd Floor  
Las Vegas, Nevada 89106

**Return Service Requested**  
**Official Notice of Public Hearing**

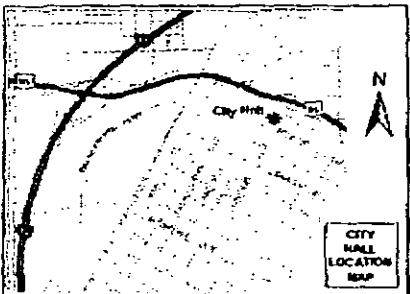

If you wish to file your protest or support on this request, check the appropriate box below and return this card in an envelope with postage to the Department of Planning, Case Planning Division at the address listed above or fax this side of this card to (702) 385-7268. If you would like to contact your Council Representative, please call (702) 229-6405.

I SUPPORT  
this Request

I OPPOSE  
this Request

Please use available blank space on card for your comments.

**SUP-41263**

Planning Commission Meeting of 5/10/2011

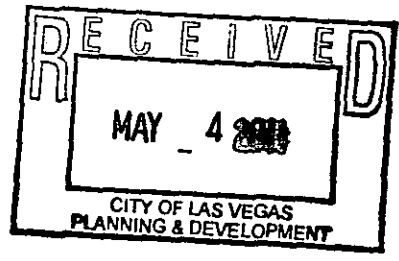

Case: SUP-41263  
13803314017  
DELOSSANTOS LEONOR M  
7318 DOPHINE CREST AVE  
LAS VEGAS NV 89129-0000

5 BRDFN11 85125



338

FROM : SIRACUSA 1111

FAX NO. : 212 619 5704

May. 09 2011 12:37PM P1

City of Las Vegas  
Department of Planning  
Development Services Center  
333 North Rancho Drive, 3<sup>rd</sup> Floor  
Las Vegas, Nevada 89106

**Return Service Requested  
Official Notice of Public Hearing**

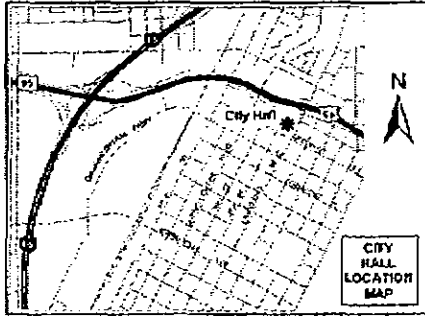

If you wish to file your protest or support on this request, check the appropriate box below and return this card in an envelope with postage to the Department of Planning, Case Planning Division at the address listed above or fax this side of this card to (702) 385-7268. If you would like to contact your Council Representative, please call (702) 229-6405.

I SUPPORT  
this Request

I OPPOSE  
this Request

Please use available blank space on card for your comments.

**SUP-41263**

Planning Commission Meeting of 5/10/2011

PRESORTED  
FIRST CLASS



02 1M \$00.414  
0004279218 APR 28 2011  
MAILED FROM ZIP CODE 89101



13803313101 Case: SUP-41263  
SIRACUSA RICHARD A  
5425 CONNECTICUT N W #318  
WASHINGTON DC 20015-2723

2 BROFN 1 1 20015



1238

City of Las Vegas  
Department of Planning  
Development Services Center  
333 North Rancho Drive, 3<sup>rd</sup> Floor  
Las Vegas, Nevada 89106

**Return Service Requested**  
**Official Notice of Public Hearing**

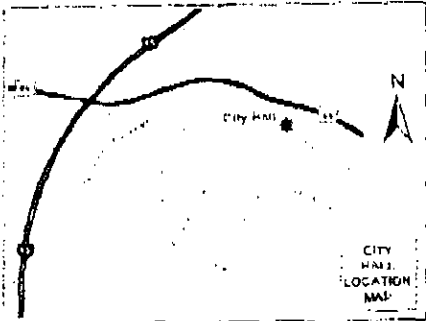

If you wish to file your protest or support on this request, check the appropriate box below and return this card in an envelope with postage to the Department of Planning, Case Planning Division at the address listed above or fax this side of this card to (702) 385-7268. If you would like to contact your Council Representative, please call (702) 279-6405.



I SUPPORT  
this Request



I OPPOSE  
this Request

Please use available blank space on card for your comments.

**SUP-41263**

Planning Commission Meeting of 5/10/2011



13803215033  
BERGER 2003 TRUST  
4404 OLIVE TREE CIR  
LAS VEGAS NV 89129-5949

Case: SUP 41263

338

RECEIVED  
MAY -2 2011

City of Las Vegas  
Department of Planning  
Development Services Center  
333 North Rancho Drive, 3<sup>rd</sup> Floor  
Las Vegas, Nevada 89106

**Return Service Requested**  
**Official Notice of Public Hearing**

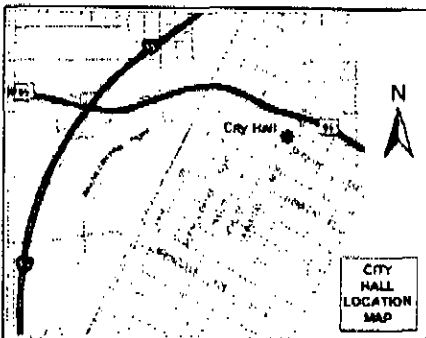

If you wish to file your protest or support on this request, check the appropriate box below and return this card in an envelope with postage to the Department of Planning, Case Planning Division at the address listed above or fax this side of this card to (702) 385-7268. If you would like to contact your Council Representative, please call (702) 229-6405.

I SUPPORT

I OPPOSE

PRESORTED  
FIRST CLASS



UNITED STATES POSTAGE  
\$ 00.414  
MAY 02 2011  
MAILED FROM ZIP CODE 89106

*no firearms up  
here - please do  
not in this area*

*33P*

13803610031 Case: SUP-41283  
DAY PATRICIA L REVOCABLE LIV TR  
7109 GOLDEN DESERT AVE

City of Las Vegas  
Department of Planning  
Development Services Center  
333 North Rancho Drive, 3<sup>rd</sup> Floor  
Las Vegas, Nevada 89106

**Return Service Requested**  
**Official Notice of Public Hearing**

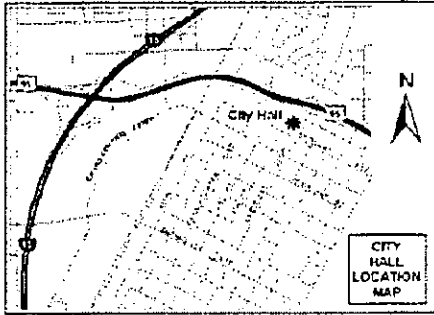

If you wish to file your protest or support on this request, check the appropriate box below and return this card in an envelope with postage to the Department of Planning, Case Planning Division at the address listed above or fax this side of this card to (702) 385-7268. If you would like to contact your Council Representative, please call (702) 229-6405.

I SUPPORT  
this Request

I OPPOSE  
this Request

Please use available blank space on card for your comments.

**SUP-41263**

Planning Commission Meeting of 5/10/2011

*Too close to family  
homes and public  
schools.*

Case: SUP-41263  
13803313007  
HECKER VICTOR & MARILYN S FAM TR  
8593 VERDE PARK AVE  
LAS VEGAS NV 89129-2232

ES 8907411 89129

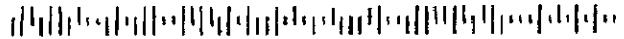

RECEIVED

MAY -2 2011

*33P*

City of Las Vegas  
Department of Planning  
Development Services Center  
333 North Rancho Drive, 3<sup>rd</sup> Floor  
Las Vegas, Nevada 89106

**Return Service Requested**  
**Official Notice of Public Hearing**

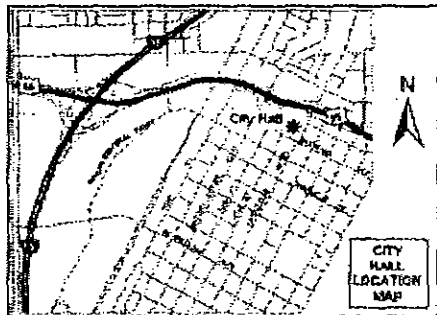

If you wish to file your protest or support on this request, check the appropriate box below and return this card in an envelope with postage to the Department of Planning, Case Planning Division at the address listed above or fax this side of this card to (702) 385-7268. If you would like to contact your Council Representative, please call (702) 229-6405.

I SUPPORT  
this Request

I OPPOSE  
this Request

Please use available blank space on card for your comments.

**SUP-41263**

Planning Commission Meeting of 5/10/2011

PRESORTED  
FIRST CLASS



D 2 1M \$ 00.414  
0004279218 APR 28 2011  
MAILED FROM ZIP CODE 89101



13803610017  
WAMMACK KATHLEEN M  
7004 GOLDEN DESERT AVE  
LAS VEGAS NV 89128-7114

Case: SUP-41263

65 BRDFN11 89128



239

City of Las Vegas  
Department of Planning  
Development Services Center  
333 North Rancho Drive, 3<sup>rd</sup> Floor  
Las Vegas, Nevada 89106

**Return Service Requested  
Official Notice of Public Hearing**

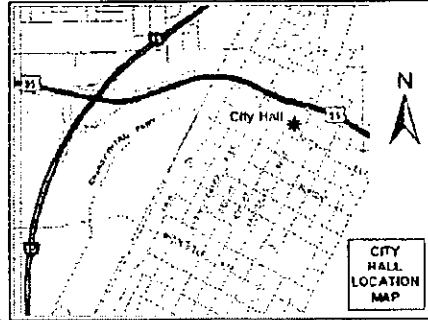

If you wish to file your protest or support on this request, check the appropriate box below and return this card in an envelope with postage to the Department of Planning, Case Planning Division at the address listed above or fax this side of this card to (702) 385-7268. If you would like to contact your Council Representative, please call (702) 229-6405.



I SUPPORT  
this Request



I OPPOSE  
this Request

Please use available blank space on card for your comments.

**SUP-41263**

Planning Commission Meeting of 5/10/2011

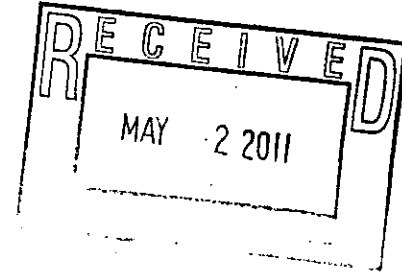

13803610020  
NOVAK JIMMY JOE & BRENDA J  
8148 N HAMMER LN  
LAS VEGAS NV 89149-0000

Case: SUP-41263

5 2011 05149



53A

# City Of Las Vegas Department Of Planning Pre-Application Conference Notes

C  
Y  
C  
L  
E  
  
5

**Project Name: Northwest Arms**

<b>APN(s):</b>	138-03-611-011	<b>Pre-app Date:</b>	03/16/11
<b>Location:</b>	4450 N. Tenaya Way, Suite #100	<b>Meeting Location:</b>	DSC Conference Room 3A - 321
<b>Ward #:</b>	4 - Anthony	<b>Acres:</b>	3.42
		<b>Time:</b>	8:00 a.m.

<b>Ownership Info:</b>	Shree Ganesha, Inc 700 Fremont Street Las Vegas, NV 89101	<b>Last Change of Ownership Date:</b>	10/27/05
	Phone: (702)-	Fax: (702)-	Email:

<b>Applicant Info:</b>	Northwest Arms	Phone: (702)-	Fax: (702)-	Email:
------------------------	----------------	---------------	-------------	--------

<b>Representative Info:</b>	Michelle Gordon	Phone: (702)-556-8003	Fax: (702)-	Email:
-----------------------------	-----------------	-----------------------	-------------	--------

<b>Use:</b>	<b>Existing:</b>	Vacant
	<b>Proposed:</b>	Secondhand Dealer (used firearm sales)

<b>General Plan:</b>	<b>Existing:</b>	SC (Service Commercial)
	<b>Proposed:</b>	No change proposed

<b>Zoning:</b>	<b>Existing:</b>	C-1 (Limited Commercial)
	<b>Proposed:</b>	No change proposed

<b>Special Area, Master Plans, and / or Overlay Districts that Apply:</b>	N/A
	Special Land Use Designation (per plan, if applicable): N/A

**Meeting**     
  **Conversation Record**     
  **Telephone Record**

Between CLV Planning Representative: Romeo Gumarang, Planner I (229-4604 Office / 385-7268 Fax / rgumarang@lasvegasnevada.gov), and:

Name	Company/Department	Phone	Fax	Email
1. Michelle Gordon	Northwest Arms	556-8003		
2.				
3.				
4.				
5.				
6.				
7.				
8. Yorgo Kagafas	CLV - Planning	229-6196	385-7268	gkagafas@lasvegasnevada.gov
9.	CLV - Finance (Business License)	229-6321	383-0769	
10.	CLV - PW - Dev Co	229-6578	474-7599	
11.	CLV - PW - Traffic	229-6901 / 6880		
12.	CLV - PW - Flood	229-6541	382-8551	<div style="border: 2px solid black; padding: 5px; display: inline-block;"> <b>RECEIVED</b>                      MAR 22 2011                 </div>
13.	CLV - Building and Safety	229-6251	382-1731	
14.	CLV - Fire and Rescue	229-0366	229-0124	
15.	CLV - Office of Business Development	229-6551	385-3128	

**OR:**  see Meeting Attendance Sheet

# City of Las Vegas Department of Planning Pre-Application Conference Notes

Is this project intended to promote Sustainability (i.e. use "Green Building" technology)?  YES  NO  
If yes, Please detail how in the justification letter. Refer to <http://www.lasvegasnevada.gov/sustaininglasvegas> for more information on rebates and incentives offered through the City of Las Vegas.

## Meeting Notes:

1. The subject property is located within 60 feet of unincorporated Clark County; therefore, a Project of Regional Significance questionnaire is required upon submittal of the petition for a Special Use Permit for Secondhand Dealer use.
2. Revise the justification letter in a letter format and must be signed by the applicant.
3. Revise Site Plan with labels of surrounding land uses and zoning designations
4. Add the square footage of the <sup>suite for</sup> proposed use, ~~set~~ Either mention on the justification letter or ~~set~~ call out the area of the suite on the Floor Plan.

-- Please return a copy of this form with the original Pre-Application Submittal Checklist --

\*\*Complete Submittal Packets MUST be received by Planning staff no later than 2:00 PM of the Submittal Deadline Date, no exceptions\*\*

15 SEP 2011

# City Of Las Vega Department Of Planning Submittal Checklist (Cont.)

Pre-Application Conference		City Of Las Vega Department Of Planning Submittal Checklist (Cont.)						
Item Required								
YES	NO	APPLICATION PACKET (ALL ITEMS ARE REQUIRED FOR <u>EACH</u> APPLICATION TYPE, unless indicated otherwise)			Fees			
			Appl. Type	Application	Notification	Recordation	Sub-Total	
<input checked="" type="checkbox"/>	<input type="checkbox"/>	Application(s) signed and notarized by property owner(s) or authorized agent(s) for all subject lots	<b>Visit the CLV website</b> For blank application, SOFI & DINA/PRS forms, and justification letter info @ <a href="http://www.lasvegasnevada.gov/">http://www.lasvegasnevada.gov/</a> (Follow - "I Want To ..." -> "Apply for -> Planning Applications")					
<input checked="" type="checkbox"/>	<input type="checkbox"/>	Statement(s) of Financial Interest (SOFI) signed and notarized by property owner(s) or authorized agent(s) for all subject lots						
<input checked="" type="checkbox"/>	<input type="checkbox"/>	<b>Detailed</b> justification letter (the same letter addressing all applications, included with each application)		SUP	\$ 500.00	\$ 500.00	\$ 30.00	\$ 1030.00
<input checked="" type="checkbox"/>	<input type="checkbox"/>	Development Impact Notice and Assessment (DINA) / Project of Regional Significance (PRS) SUP Only			\$	\$	\$	\$
<input checked="" type="checkbox"/>	<input type="checkbox"/>	Grant deed and legal description (from County Assessor; may be available online at: <a href="http://www.accessclarkcounty.com/depts/Assessor/Pages/assessor.aspx">http://www.accessclarkcounty.com/depts/Assessor/Pages/assessor.aspx</a> )			\$	\$	\$	\$
<input checked="" type="checkbox"/>	<input type="checkbox"/>	Meeting notes and checklist signed by city planner (Originals, plus 1 copy for each additional application)		\$	\$	\$	\$	
<input type="checkbox"/>	<input checked="" type="checkbox"/>	Copy of Business License(s) – requested, but submittals will be accepted without		\$	\$	\$	\$	
<input type="checkbox"/>	<input checked="" type="checkbox"/>	If required, cop(ies) of approval letter(s) for		<b>Subtotal:</b>				\$
<input type="checkbox"/>	<input checked="" type="checkbox"/>	Neighborhood Meeting (see General Plan submittal req's for details) – Add neighborhood meeting fee: Applicant only to notify, add \$0; Mailing labels only, add: \$50; Full notification, add: \$500			\$	---	\$	
<input type="checkbox"/>	<input checked="" type="checkbox"/>	Photo Reproduction of the Color & Materials Board (SDR applications only)		<b>Grand Total All Fees:</b>				<b>\$1030.00</b>

**REQUIRED DRAWINGS (INCLUDES TOTAL NUMBER REQUIRED FOR ALL APPLICATION TYPES):**  
 MUST BE 11" X 17" MINIMUM TO 24" X 36" MAXIMUM PAGE SIZE  
 ALL SUBMITTED PLANS AND ELEVATIONS MUST BE LEGIBLE AND DRAWN TO SCALE (UNLESS OTHERWISE INDICATED)

<input checked="" type="checkbox"/>	<input type="checkbox"/>	SITE PLAN	TOTAL REQUIRED FOR ALL APPLICATIONS	
		North arrow, scale, and vicinity map	Folded Plans (5, plus 1 per application): <b>6</b>	
		All property lines and present dimensions labeled	Colored, Rolled Plans: <b>1</b>	
		All building setbacks labeled	Reduced Copy (8-1/2"x11" BW; 1 per application): <b>1</b>	
		All adjacent existing land uses and street names labeled	NOTES:	
		All points of ingress and egress shown		
		ADA accessibility requirements shown/labeled		
		Parking standard(s) utilized:		
		Parking space count and typical dimensions labeled # regular + [30% or less of total] # compact + # handicap = Total		
		All free-standing sign locations shown and heights and sizes noted		
<input checked="" type="checkbox"/>	<input type="checkbox"/>	FLOOR PLANS	TOTAL REQUIRED FOR ALL APPLICATIONS	
		Scale and building dimensions labeled	Folded Plans (1 per application): <b>1</b>	
		North arrow and scale	Rolled Plans: <b>1</b>	
		All building entrances/exits shown	Reduced Copy (8-1/2"x11" BW; 1 per application): <b>1</b>	
		Use of all rooms noted/labeled	NOTES:	
		Maximum Occupancy (per I.B.C.)		
		Seating Capacity (where applicable)		

**THIS FORM MUST ACCOMPANY THE APPLICATION SUBMITTAL and is valid for no more than 60 days after the Pre-App date.**

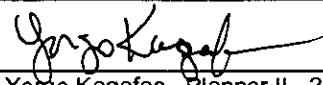
APN(s):	138-03-611-011	Application Purpose:	Special Use Permit
Location:	4450 N Tenaya Way, Suite #100	Application Purpose:	Secondhand Dealer
Ward:	4 - Anthony	Pre-App. Meeting Date:	03/16/11
Planner's Signature:		Submittal Deadline:	03/24/11 - no later than 2:00 pm
Planner:	Yorgo Kagafas, Planner II - 229-6196 Romeo Gumarang, Planner I - 229-4604	Earliest PC / CC Meeting Dates:	05/10/11 PC - 06/15/11 CC (Cycle 5)



**Should this project require a neighborhood meeting or if you choose to have one, please be aware of the following:**  
 In order to use the City to mail the postcard notices for your neighborhood meeting, you must have all information to us no later than 15 days prior to the intended meeting date. Submitting the required information for the neighborhood meeting when making your application submittal is often best. Therefore, if you want the City to mail the notices for your neighborhood meeting, please ensure that we get all required information and that the request is made at least 15 days before you are scheduling the meeting, otherwise you must make other arrangements for getting the notices mailed.

## 2011 PLANNING COMMISSION MEETING SCHEDULE

Generally, the Planning Commission meetings are held on the second Tuesday of each month.

\*Denotes a GPA Cycle

<b>Pre-Application Conference Request Deadline</b>	<b>Application Closing Day</b>	<b>Planning Commission Meeting Date</b>	<b>City Council Meeting Date</b>
November 19, 2010	December 09, 2010	<b>January 25, 2011*</b>	February 16, 2011
December 02, 2010	December 23, 2010	February 08, 2011	March 16, 2011
December 23, 2011	January 20, 2011	March 08, 2011	April 06, 2011
February 03, 2011	February 24, 2011	<b>April 12, 2011*</b>	May 18, 2011
March 03, 2011	March 24, 2011	May 10, 2011	June 15, 2011
April 07, 2011	April 28, 2011	June 14, 2011	July 20, 2011
May 05, 2011	May 26, 2011	<b>July 12, 2011*</b>	August 17, 2011
June 02, 2011	June 23, 2011	August 09, 2011	September 07, 2011
July 07, 2011	July 28, 2011	September 13, 2011	October 19, 2011
August 04, 2011	August 25, 2011	<b>October 11, 2011*</b>	November 16, 2011
September 01, 2011	September 22, 2011	November 08, 2011	December 07, 2011
October 06, 2011	October 27, 2011	December 13, 2011	January 18, 2012
November 03, 2011	November 23, 2011	<b>January 10, 2012*</b>	February 15, 2012
December 08, 2011	December 29, 2011	February 14, 2012	March 07, 2012

**Applications MUST BE submitted by 2:00 P.M. on CLOSING DAYS,  
or by 4:00 P.M. on NON-CLOSING DAYS. Call (702) 229-6301 for additional information**

0 5 2 9 1 1

0 5 2 9 1 1



LAS VEGAS CITY COUNCIL

OSCAR B. GOODMAN  
MAYOR

GARY REESE  
MAYOR PRO TEM

STEVE WOLFSON  
LOIS TARKANIAN  
STEVEN D. ROSS

RICKI Y. BARLOW  
STAVROS S. ANTHONY

ELIZABETH N. FRETWELL  
CITY MANAGER

May 11, 2011

Mr. Raj Patel  
Shree Ganesha, Inc.  
700 Fremont Street  
Las Vegas, Nevada 89101

**RE: SUP-41263 - SPECIAL USE PERMIT  
PLANNING COMMISSION MEETING OF MAY 10, 2011**

Dear Mr. Patel:

Your request for a Special Use Permit FOR A SECONDHAND DEALER USE (FIREARMS) IN CONJUNCTION WITH A RETAIL ESTABLISHMENT at 4450 North Tenaya Way, Suite #100 (APN 138-03-611-011), C-1 (Limited Commercial) Zone, Ward 4 (Anthony), was considered by the Planning Commission on May 10, 2011.

The Planning Commission voted to **APPROVE** your request, subject to the following:

**Planning**

1. Conformance to all Minimum Requirements under LVMC Title 19.04.010 for a Secondhand Dealer use.
2. This approval shall be void two years from the date of final approval, unless exercised pursuant to the provisions of LVMC Title 19.18. An Extension of Time may be filed for consideration by the City of Las Vegas.
3. All City Code requirements and design standards of all City departments must be satisfied, except as modified herein.

CITY OF LAS VEGAS  
DEPARTMENT OF PLANNING  
DEVELOPMENT SERVICES CENTER  
333 NORTH RANCHO DRIVE  
3RD FLOOR  
LAS VEGAS, NEVADA 89106

VOICE 702.229.6301  
FAX 702.474.0352  
TTY 702.386.9108  
[www.lasvegasnevada.gov](http://www.lasvegasnevada.gov)

Mr. Raj Patel  
SUP-41263 - Page Two  
May 11, 2011

This action by the Planning Commission on **May 10, 2011** is final unless a written appeal is filed with the City Clerk within ten days of the date of the Planning Commission's decision as allowed by code or there is a review action filed by the City Council within the same time period. For additional information on appeals or review requests please access <http://www.lasvegasnevada.gov/CheckStatus/DevelopmentApp.htm>, or contact the Department of Planning and Development at 702.229.6301 after **May 23, 2011**. No building permits or business licenses related to these items shall be issued prior to the expiration of the required ten day waiting period, or until any filed appeal is resolved pursuant to LVMC Title 19.18.

Sincerely,



Steve Gebeke, AICP  
Planning Supervisor  
Case Planning Division

SG:clb

cc: Ms. Michelle Gordon  
Kymtec dba Northwest Arms  
50 South Arrowhead Lane, Suite B  
Mesquite, Nevada 89027

Ms. Michelle Gordon  
7893 West Gilmore Avenue  
Las Vegas, Nevada 89129

CC

P/L 398  
366

**Report of All Selected Parcels**

Case Number: SUP-41263

Printed On: Thu: March 31, 2011

<u>Owner</u>	<u>Address</u>	<u>Parcel Number</u>
		13803697001
		13803397009
		13803397011
		13803397021
		13803296003
		13803397016
		13803397018
		13803397017
		13803397022
		13803397008
		13803397020
		13803397003
		13803397013
		13803597002
		13803397010
		13803296002
		13803397015
		13803397019
7001 JUNCTION LAND TRUST	%NV PPTYS LLC P O BOX 7037 RENO NV	13803514052
ADAMCZYK LILLY	7244 PLATINUM PEAK AVE LAS VEGAS NV	13803316008
ALCALDE MARIA DEL CARMEN	451 BLACKTHORN AVE TORONTO ON M6M 3C5 CANADA	13803514059
ALCANTAR LENA A & JEREMY	7309 RIBBON RIDGE AVE LAS VEGAS NV	13803313074
ALI SONYA	5468 CANOPY OAK DR LAS VEGAS NV	13803313089
ALI SYED ASAD & ANITA	5840 SW 130TH TER PINECREST FL	13803313093
ALI SYED M	7724 ALMERIA AVE LAS VEGAS NV	13803313073
ALI SYED SHEHZAD	14403 AUTUMN HILL LN CHINO HILLS CA	13803313024
ALI SYED SHEHZAD	14403 AUTUMN HILL LN CHINO HILLS CA	13803313100
ALLEN KURTIS J & CHARA L	7013 OVERHILL AVE LAS VEGAS NV	13803610003
AMBARTSOUMIAN ARMEN	411 N JACKSON #101 GLENDALE CA	13803315060
AMICO ROBERT S & SHARON L	9372 THUNDER BASIN LAS VEGAS NV	13803315042
AMOREN CARIDAD R	825 CRESTER DR SUISUN CITY CA	13803312010
ANTHONY ALISHA M	7224 NOOK CREST CT LAS VEGAS NV	13803313017

**Report of All Selected Parcels****Case Number:** SUP-41263**Printed On:** Thu: March 31, 2011

<u>Owner</u>	<u>Address</u>	<u>Parcel Number</u>
ARCHLAND PROPERTY I L L C	%MCDONALDS CORP #27-0202 P O BOX 182571 COLUMBUS OH	13803611003
ASBELL RANDY L & DENISE M	4509 VOGUE ST LAS VEGAS NV	13803218018
ASHJIAN SCOTT	4485 N RAINBOW BLVD LAS VEGAS NV	13803602008
B A C HOME LOANS SERVICING L P	400 COUNTRYWIDE WY SV-35 SIMI VALLEY CA	13803218045
B O K INTERNATIONAL INC	54 GUILDFORD CIR MARKHAM ON L3R 0S2 CANADA	13803218028
BAHARI FOUAD	4336 PERFECT DRIFT ST LAS VEGAS NV	13803315032
BAILEY WALTER R & DIANE C	6150 MADRE MESA LAS VEGAS NV	13803313026
BANK NEW YORK MELLON TRS	%RECONTRUST CO 400 COUNTRYWIDE WY SV-35 SIMI VALLEY CA	13803313027
BANK U S NATIONAL ASSN TRS	%SELECT PORTFOLIO SRVCING 3815 S W TEMPLE SALT LAKE CITY UT	13803314010
BAUMANN WALTER & JOSEPHINE	7312 CAMDEN PINE AVE LAS VEGAS NV	13803315063
BECK 1996 TRUST	7121 JUNCTION VILLAGE AVE LAS VEGAS NV	13803514015
BEDSUN DAVID A	4715 N GRAND CANYON LAS VEGAS NV	13803218029
BENSON PATRICK C	1011 HAGGARD DR CLARKSVILLE TN	13803218042
BENSON ROBERT A	4408 OLIVE TREE CIR LAS VEGAS NV	13803215034
BERGER 2003 TRUST	4404 OLIVE TREE CIR LAS VEGAS NV	13803215033
BESTOGUEY RENE P & MARYGRACE	7124 GOLDEN DESERT AVE LAS VEGAS NV	13803610042
BIAFORE FAMILY TRUST	4400 OLIVE TREE CIR LAS VEGAS NV	13803215032
BIDER JOSEPH E & STELLA L	7209 ELITE CT LAS VEGAS NV	13803218025
BISHOP MICHAEL D	7129 GOLDEN DESERT AVE LAS VEGAS NV	13803610036
BISHOP ROBERT L & LISA D	7225 CHIC AVE LAS VEGAS NV	13803218039
BLACK ROSE M	7220 PLATINUM PEAK AVE LAS VEGAS NV	13803316012
BLANCAFLOR ARTHUR & ANAMARIA R	5438 WRENCH CT LAKEWOOD CA	13803315038
BOHN BRENDA & KENNETH	7225 HIGH CASCADE AVE LAS VEGAS NV	13803313022
BORODINSKY STANLEY J	10874 CARBERRY HILL ST LAS VEGAS NV	13803313021
BOYD GARY A & VICKI A	4401 LILAC GLEN DR LAS VEGAS NV	13803215031
BRAM MEIR & XI FENG	7313 DOLPHINE CREST AVE LAS VEGAS NV	13803314013
BRCAK ROBERT E	7124 OVERHILL AVE LAS VEGAS NV	13803514027
BREEZE TRUST	598 PACIFIC COVE DR PORT HUENEME CA	13803514028
BRIONES EDNA V & ILYN V	7253 CAMDEN PINE AVE LAS VEGAS NV	13803315043
BRIONES MARK V & MAGDALENA M	7252 HIGH CASCADE AVE LAS VEGAS NV	13803313094
BROWN DAVID & JOYCE	8525 JAKES PL LAS VEGAS NV	13803516004
BROWN DAVID & JOYCE M	8525 JAKES PL LAS VEGAS NV	13803516002

**Report of All Selected Parcels****Case Number:** SUP-41263**Printed On:** Thu: March 31, 2011

<u>Owner</u>	<u>Address</u>	<u>Parcel Numbe</u>
BROWN FAMILY TRUST	5095 N CHIEFTAIN ST LAS VEGAS NV	13803314014
BROWN HUGH B III & LATOYA L	4413 LILAC GLEN DR LAS VEGAS NV	13803215028
BUDO JAN	7224 ELITE CT LAS VEGAS NV	13803218034
BUHLER RICHARD & DIANNE	18114 96 AVE SURREY B C V4N 4A8 CANADA	13803315045
BULTHUIS MATTHEW & TEAL H	PSC 80 BOX 14128 APO AP	13803316007
BURGOS ANTHONY W	7232 CHIC AVE LAS VEGAS NV	13803218009
BURROUGHS RAYMOND H	7104 GOLDEN DESERT AVE LAS VEGAS NV	13803610047
BURRUS TOBY M REVOCABLE FAM TR	7037 DVERHILL AVE LAS VEGAS NV	13803610009
BURT ADRIAN ALEXANDER & MAVIS R C T-1 L L C	7113 OVERHILL AVE LAS VEGAS NV 4375 POLARIS AVE #4 LAS VEGAS NV	13803515007 13803201009
CABRERA NICHOLAS N	7220 NOCK CREST CT LAS VEGAS NV	13803313018
CAIN THOMAS P	7136 GOLDEN DESERT AVE LAS VEGAS NV	13803610039
CALHOON STEPHANIE A	7240 CAMDEN PINE AVE LAS VEGAS NV	13803315014
CAMACHO DOUGLAS & BRENDA	7324 DOLPHINE CREST AVE LAS VEGAS NV	13803314018
CAMPBELL FAMILY TRUST	6077 BURLESON RANCH RD LAS VEGAS NV	13803215002
CAPTIVA ISLAND TRUST	7224 SLEEK AVE LAS VEGAS NV	13803217031
CARRIAGE CEMETERY SERVICES INC	3040 POST OAK BLVD #300 HOUSTON TX	13803101003
CARRIAGE CEMETERY SERVICES INC	3040 POST OAK BLVD #300 HOUSTON TX	13803501006
CASTILLO ARMANDO & E REV TR	4404 VOGUE ST LAS VEGAS NV	13803217008
CASTRO ARMANDO & CARMEN	7216 ELITE CT LAS VEGAS NV	13803218032
CASTRO OSCAR V & EMILIE MARIE T	7001 GOLDEN DESERT AVE LAS VEGAS NV	13803610019
CEDAR TRUST	3420 CARBURY CT LAS VEGAS NV	13803217018
CENTERS EVERETT FAMILY TRUST	71 STRWFLOWER ST LADERA RANCH CA	13803610037
CHAO FAMILY TRUST	10162 GOLDEN BLUFF LAS VEGAS NV	13803217030
CHAPMAN JOHN C & CARMELITA C	7256 PLATINUM PARK AVE LAS VEGAS NV	13803316005
CHILES ROSS & JILL	4400 ORNATE CT LAS VEGAS NV	13803217021
CHU HOLLY	15291 KNOLLWOOD CIR HUNTINGTON BEACH CA	13803610007
CITIMORTGAGE INC	%REO DEPT %CR TITLE SERV 1000 TECHNOLOGY DR MS-314 O'FALLON MO	13803218010
CITRANGOLA LEANNE	7261 HIGH CASCADE AVE LAS VEGAS NV	13803313088
CLARK JAMES L	103 E MARIPOSA DR REDLANDS CA	13803215030
CLARKE PATRICK	2508 FERNWOOD AVE SAN JOSE CA	13803316002
CLAYTON ROBYN E	7020 GOLDEN DESERT AVE LAS VEGAS NV	13803610013

**Report of All Selected Parcels****Case Number:** SUP-41263**Printed On:** Thu: March 31, 2011

<u>Owner</u>	<u>Address</u>	<u>Parcel Numbe</u>
COBURN DONALD G	7232 ELITE CT LAS VEGAS NV	13803218036
COE ROBERT L	9412 ARTESIAN OAK CT LAS VEGAS NV	13803313098
COITO JOHN & LUCIA B	7200 CHIC AVE LAS VEGAS NV	13803218001
COLLUM JESSE	7228 PLATINUM PEAK LAS VEGAS NV	13803316010
CONDER JENNIFER R	7208 PLATINUM PEAK AVE LAS VEGAS NV	13803316015
COOMBS JASON & KAREN ANN	78A HALL LN GREAT CHISHALL ROYSTON HERTS SG88SH UK	13803313083
CRAIG 95 L L C	%PLATINUM REALTY 9811 W CHARLESTON BLVD #2-630 LAS VEGAS NV	13803701003
CRAIG I-95 L L C	11661 SAN VICENTE BLVD #702 LOS ANGELES CA	13803611008
CRAIG MARKETPLACE L L C	%GREAT AMER CAPITAL 8350 W SAHARA AVE #210 LAS VEGAS NV	13803715005
CRAIG MARKETPLACE L L C	%GREAT AMER CAPITAL 8350 W SAHARA #210 LAS VEGAS NV	13803715007
CRAIG MARKETPLACE L L C	%GREAT AMER CAPITAL 8350 W SAHARA #210 LAS VEGAS NV	13803715006
CRAIG MARKETPLACE PADS L L C	%GREAT AMER CAPITAL 8350 W SAHARA #210 LAS VEGAS NV	13803715002
CRELLY MATTHEW	7253 PLATINUM PEAK AVE LAS VEGAS NV	13803316001
CRIPPS RICHARD L & VERLA P	4529 VOGUE ST LAS VEGAS NV	13803218013
CUEVAS JUDITH C	4417 VOGUE ST LAS VEGAS NV	13803217003
CUEVAS JUDITH C	4412 VOGUE ST LAS VEGAS NV	13803217010
CZELUSNIAK EDITH M	7128 GOLDEN DESERT AVE LAS VEGAS NV	13803610041
DAVID E N D L L C	7821 SEA ROCK RD LAS VEGAS NV	13803315005
DAVIS RONALD W & STACY	7133 OVERHILL AVE LAS VEGAS NV	13803515002
DAY PATRICIA L REVOCABLE LIV TR	7109 GOLDEN DESERT AVE LAS VEGAS NV	13803610031
DEETER JASON R	7228 NOOK CREST CT LAS VEGAS NV	13803313016
DEGRAZIA MELECIA P	7304 CAMDEN PINE AVE LAS VEGAS NV	13803315065
DEGUZMAN MEY MARIE F	10426 LYRIC ARBOR DR LAS VEGAS NV	13803315018
DELOSSANTOS LEONOR M	7318 DOPHINE CREST AVE LAS VEGAS NV	13803314017
DETIE ANGELA R	4401 VOGUE ST LAS VEGAS NV	13803217006
DIONES ROBERT M & REBECCA T	4332 PERFECT DRIFT ST LAS VEGAS NV	13803315033
DISANTE VINCENT C & BETTY M	7012 GOLDEN DESERT AVE LAS VEGAS NV	13803610015
DIZENZO RICHARD & R REV TR	7125 JUNCTION VILLAGE AVE LAS VEGAS NV	13803514014
DORAN DAWN	7316 CAMDEN PINE AVE LAS VEGAS NV	13803315062
DORICK ENTERPRISES INC	7450 W CRAIG RD LAS VEGAS NV	13803201005
DORICK ENTERPRISES INC	7450 W CRAIG RD LAS VEGAS NV	13803201008
DORWIN PAUL A & VIVIAN A	4409 LILAC GLEN DR LAS VEGAS NV	13803215029

**Report of All Selected Parcels****Case Number:** SUP-41263**Printed On:** Thu: March 31, 2011

<u>Owner</u>	<u>Address</u>	<u>Parcel Numbe</u>
DOYLE JAMES N M & CLARA JEAN	7129 OVERHILL AVE LAS VEGAS NV	13803515003
DREYFUS STACY L	7132 GOLDEN DESERT AVE LAS VEGAS NV	13803610040
DUNBAR PETER T	7221 CHIC AVE LAS VEGAS NV	13803218040
DUNLOP-LURA CHARLENE	52437 RANGE RD 220 ARDROSSAN AB T8E 2H7 CANADA	13803315027
DYBATA RUSSELL W	7112 OVERHILL AVE LAS VEGAS NV	13803514024
EDRINGTON FAMILY TRUST	%B GADDY-EDRINGTON P O BOX 1822 FRAZIER PARK CA	13803610014
EDUSADA JULIAN	64 FIRETHORN ST MILPITAS CA	13803516006
ELEAZAR AILENE M	7225 NOOK CREST CT LAS VEGAS NV	13803313014
EMCH ERIC L & JULIE M	7229 NOOK CREST CT LAS VEGAS NV	13803313015
EMERSON JOHN M & CLENIA	7301 BUSH GARDEN AVE LAS VEGAS NV	13803215008
FANNIE MAE	14523 SOUTHWEST MILLIKAN WY #200 BEAVERTON OR	13803515010
FEDERAL HOME LOAN MORTGAGE CORP	5000 PLANO PKWY CARROLLTON TX	13803602001
FEDERAL NATIONAL MORTGAGE ASSN	400 COUNTRYWIDE WY SV-35 SIMI VALLEY CA	13803215010
FEDERAL NATIONAL MORTGAGE ASSN	400 COUNTRYWIDE WY SV-35 SIMI VALLEY CA	13803315047
FEDERAL NATIONAL MORTGAGE ASSN	%CHASE HOME FIN LLC 10790 RANCHO BERNARDO DR SAN DIEGO CA	13803602007
FEDERAL NATIONAL MORTGAGE ASSN	%NATIONSTAR MTGE LLC 350 HIGHLAND DR LEWISVILLE TX	13803218024
FESTEKJIAN NOUBAR & ALICE	18512 DYLAN ST NORTHRIDGE CA	13803315002
FESTEKJIAN RAFFI N & KAREN T	5863 CAPE HORN DR AGOURA HILLS CA	13803315001
FIORE MICHAEL E & BRIDGET E	4352 PERFECT DRIFT ST LAS VEGAS NV	13803315028
FLINSPACH MICHAEL	7137 OVERHILL AVE LAS VEGAS NV	13803515001
FLORES GILBERT & BERTHA ALICIA	2596 BINARY STARS HENDERSON NV	13803218008
FRANCO MANUEL C	7209 CHIC AVE LAS VEGAS NV	13803218043
FREDETTE MARIE A	7204 PLATINUM PEAK AVE LAS VEGAS NV	13803316016
FREEMAN FRANK	7005 OVERHILL AVE LAS VEGAS NV	13803610002
FREEMAN TRICIA ROSE REVOCABLE TR	4316 PERFECT DRIFT ST LAS VEGAS NV	13803313002
FREY JILL M	7501 THORNBUCK PL LAS VEGAS NV	13803610043
GALLAGHER CHARLES T & CONSTANCE	4400 VOGUE ST LAS VEGAS NV	13803217007
GALLUZZO GIUSEPPE	7204 SLEEK AVE LAS VEGAS NV	13803217026
GARCIA CARMEN M	7300 CAMDEN PINE AVE LAS VEGAS NV	13803315066
GARCIA DIMBER L & KIMBERLY	2720 W SAN MIGUEL AVE NO LAS VEGAS NV	13803516003
GARCIA GREGORY	5860 GUSHING SPRING AVE LAS VEGAS NV	13803514061
GARRISON VIRGINIA L	7208 CHIC AVE LAS VEGAS NV	13803218003

**Report of All Selected Parcels****Case Number:** SUP-41263**Printed On:** Thu: March 31, 2011

<u>Owner</u>	<u>Address</u>	<u>Parcel Numbe</u>
GHORI FARID	3123 THOMAS PAINE DR MISSOURI CITY TX	13803313096
GIANG NGUYEN FAMILY TRUST	%D NGUYEN 19686 LEXIE CIR HUNTINGTON BEACH CA	13803516007
GILBERT DAVID	7105 GOLDEN DESERT AVE LAS VEGAS NV	13803610030
GILMORE MICHELLE J	7411 CEDAR RAE AVE LAS VEGAS NV	13803514029
GODOY NYMPHA S	2811 HIDDEN VALLEY CT SPRING VALLEY CA	13803315051
GOESBECK JAMES P	7101 JUNCTION VILLAGE AVE LAS VEGAS NV	13803514020
GOLDENBERG MICHAEL ETAL	1515 HARTFORD TERR ALPHARETTA GA	13803313029
GRIFFIN MILTON E & LYNNE J	7240 CHIC AVE LAS VEGAS NV	13803218011
GUO QIN	2 SOVENTE IRVINE CA	13803315025
GUTIERREZ ADRIANA L	7125 OVERHILL AVE LAS VEGAS NV	13803515004
GUZMAN FERNANDO & MARSHA R	1461 COVELO CT LAS VEGAS NV	13803217001
H D L REAL ESTATE L L C	7925 RAVEN AVE LAS VEGAS NV	13803218022
HAGEMEIER DAVID	7113 GOLDEN DESERT AVE LAS VEGAS NV	13803610032
HAM FORICE	7224 PLATINUM PEAK AVE LAS VEGAS NV	13803316011
HAND RICHARD L & LOIS M	4316 LEON AVE LAS VEGAS NV	13803215007
HANSEN RANDALL L & TAMMY JO	7121 OVERHILL AVE LAS VEGAS NV	13803515005
HANSEN TAMMY JO	7121 OVERHILL AVE LAS VEGAS NV	13803515008
HARDING JENNY	7217 NOOK CREST CT LAS VEGAS NV	13803313012
HARDY HUGH JR & YOUNG	4408 ORNATE CT LAS VEGAS NV	13803217023
HARRISON LAURA L	7221 CAMDEN PINE AVE LAS VEGAS NV	13803315035
HAUSER JOHN & CONNIE	7229 HIGH CASCADE AVE LAS VEGAS NV	13803313023
HAYNES ANNE K	8760 AUTUMN WREATH LAS VEGAS NV	13803314012
HEALEY CLAIRE T	7241 EARLY PIONEER AVE LAS VEGAS NV	13803315011
HEATH KIMNGOC	7029 GOLDEN DESERT AVE LAS VEGAS NV	13803610025
HECKER VICTOR & MARILYN S FAM TR	8593 VERDE PARK AVE LAS VEGAS NV	13803313007
HELVITZ JOHN J & LAURA L	7261 PLATINUM PEAK AVE LAS VEGAS NV	13803316003
HENRY WINIFRED	4312 PERFECT DRIFT ST LAS VEGAS NV	13803313003
HERMAN JEREMY E	7809 SNOWDEN LN #101 LAS VEGAS NV	13803313092
HERMAN JEREMY E	7257 HIGH CASCADE AVE LAS VEGAS NV	13803313087
HOBBS VIVIAN	7232 SLEEK AVE LAS VEGAS NV	13803217033
HOFFMAN DAVID J	7136 OVERHILL AVE LAS VEGAS NV	13803514030
HONG YE	10647 RIVA DE FIORE AVE LAS VEGAS NV	13803315061

**Report of All Selected Parcels****Case Number:** SUP-41263**Printed On:** Thu: March 31, 2011

<u>Owner</u>	<u>Address</u>	<u>Parcel Number</u>
HOSHIBATA JASON P	4256 PERFECT DRIFT ST LAS VEGAS NV	13803313010
HUERTA IRMA	7005 JUNCTION VILLAGE ST LAS VEGAS NV	13803514053
HUERTA KIMBERLY & STEPHANIE	7233 ELITE CT LAS VEGAS NV	13803218019
HUGHES DALLAS	7013 GOLDEN DESERT LAS VEGAS NV	13803610021
HUT LARRY W	7105 OVERHILL AVE LAS VEGAS NV	13803515009
HYBARGER MEGAN	7221 NOOK CREST CT LAS VEGAS NV	13803313013
IBE JOSEPH & MARTHA E	7225 CAMDEN PINE AVE LAS VEGAS NV	13803315036
INFANTE ANGELO	328 EMERLAD VISTA WY LAS VEGAS NV	13803313006
J K LIVING TRUST	8791 ABBEY RIDGE AVE LAS VEGAS NV	13803313008
JACK JANE R	7116 GOLDEN DESERT AVE LAS VEGAS NV	13803610044
JILES CLARICE E	7113 JUNCTION VILLAGE AVE LAS VEGAS NV	13803514017
JIMENEZ MARIA T	4252 PERFECT DRIFT ST LAS VEGAS NV	13803313011
JIMISON JOTIE L & BRIAN D	350 E TAYLOR ST #1207 SAN JOSE CA	13803315008
JOHNSON ROBERT A	7228 DRY LAKE CT LAS VEGAS NV	13803315024
JONES CARSON	2550 E DESERT INN #191 LAS VEGAS NV	13803218041
JORDAN MARCUM T & MICAH J	4417 LILAC GLEN DR LAS VEGAS NV	13803215027
KAGAN MARK	7300 HIGH CASCADE AVE LAS VEGAS NV	13803313091
KALMANSOHN MARK	2910 NEILSON WY #312 SANTA MONICA CA	13803217029
KAMO TED T JR & PEPSI C	216 POCONO RANCH AVE NO LAS VEGAS NV	13803610038
KAUFFMANN STEVEN M & LYNN	411 WALNUT ST #7522 GREEN COVE SPRINGS FL	13803217005
KAVLI FRED	%K BAUMAN 1801 SOLAR DR #250 OXNARD CA	13803601003
KEALOHA FERN	7216 DIAMOND HOPE CT LAS VEGAS NV	13803311001
KEHL FAMILY TRUST	4597 N BALSAM ST LAS VEGAS NV	13803602003
KEISER KEITH FREDERICK & BETH E	7037 GOLDEN DESERT AVE LAS VEGAS NV	13803610027
KELDER ELIZABETH A	459 BROADWAY COSTA MESA CA	13803514011
KILLINSWORTH NANCY	7001 OVERHILL AVE LAS VEGAS NV	13803610001
KING MELISSA J & KEVIN P	7325 DOLPHINE CREST AVE LAS VEGAS NV	13803314011
KING STERLING O & ALICE M REV TR	4433 ORNATE CT LAS VEGAS NV	13803217012
KINNE DONNA GAYLE REV LIV TR	7000 OVERHILL AVE LAS VEGAS NV	13803516010
KOSBIE JAMES L & ELAINE	7184 SAINT LUCIA LAS VEGAS NV	13803313005
KRUM DEBORAH L & KENNETH R JR	7013 JUNCTION VILLAGE AVE LAS VEGAS NV	13803514055
KUKIC ADNAN	7260 PLATINUM PEAK AVE LAS VEGAS NV	13803316004

**Report of All Selected Parcels****Case Number:** SUP-41263**Printed On:** Thu: March 31, 2011

<u>Owner</u>	<u>Address</u>	<u>Parcel Number</u>
LABOY PEDRO	%E LABOY 7000 GOLDEN DESERT AVE LAS VEGAS NV	13803610018
LABRO BAUTISTA & SENICA	7316 RIBBON RIDGE AVE LAS VEGAS NV	13803313071
LABRUM AARON L & JENNIFER FAM TR	7216 CAMDEN PINE AVE LAS VEGAS NV	13803315019
LACY DANNY L & JEANNET	3760 BROADMEAD ST LAS VEGAS NV	13803218017
LAMERA MYRNA C & BENINGO A	20203 DICKSON CT WALNUT CA	13803311003
LANG FLORENCE	4412 LILAC GLEN DR LAS VEGAS NV	13803215004
LAPORTA GREGORY P	7260 EARLY PIONEER AVE LAS VEGAS NV	13803315004
LEE DENISE	P O BOX 2743 CARSON CITY NV	13803514056
LIANG EVA I	9811 E CELTIC DR SCOTTSDALE AZ	13803313086
LIBERTY RALPH G & LINDA M	3713 MISTY FALLS ST LAS VEGAS NV	13803514013
LILLEHAUG RAY C	7229 ELITE CT LAS VEGAS NV	13803218020
LINE SHAWN L	7133 JUNCTION VILLAGE AVE LAS VEGAS NV	13803514012
LLOYD STEVEN JR	4344 PERFECT DRIFT ST LAS VEGAS NV	13803315030
LOSITO RUSSELL M	712 N CHICAGO AVE SO MILWAUKEE WI	13803313004
LUNA-ARELLANO JOSE F	7028 GOLDEN DESERT AVE LAS VEGAS NV	13803610011
LYONS JOHN P	7020 WHITFORD ST LAS VEGAS NV	13803316013
M K T HOLDINGS L L C	4504 SAN JUAN AVE NO LAS VEGAS NV	13803516008
MACARAEG LENA & LAUREANO	2271 GARNET DR VALLEJO CA	13803313034
MAHMUDI MANAGEMENT L L C	%B MAHMUDI 8227 68TH AVE KEMOSHA WI	13803315016
MAHMUDI MANAGEMENT L L C	%B MAHMUDI 8227 68TH AVE KENOSHA WI	13803313028
MARKOTIC-KREZO ANTONIJA	3532 NATURAL VIEW ST LAS VEGAS NV	13803315021
MARTIN ANNE E & HENRY D	7201 ELITE CT LAS VEGAS NV	13803218027
MARTIN DAVID	%FREEDOM MTGE CORP P O BOX 8001 FISHERS IN	13803215003
MATCHKO JASON	7244 CAMDEN PINE AVE LAS VEGAS NV	13803315013
MCCOURT LUKAS & CARLY	7308 CAMDEN PINE AVE LAS VEGAS NV	13803315064
MEADOWS CARMELLO G & PHYLLIS J	7313 BUSH GARDEN AVE LAS VEGAS NV	13803215011
MEMMOTT BRIAN J & HOLLY J	7205 CHIC AVE LAS VEGAS NV	13803218044
MENDEZ ENRIQUE	7229 CHIC AVE LAS VEGAS NV	13803218038
MENDEZ MARIA PAZ G	7025 GOLDEN DESERT AVE LAS VEGAS NV	13803610024
MEYER KENNETH W & WANDA G	7309 CAMDEN PINE AVE LAS VEGAS NV	13803315048
MILES ARNOLD G & GUADALUPE	4533 VOGUE ST LAS VEGAS NV	13803218012
MILLIGAN BRANDON L & LEANNA W	7224 CHIC AVE LAS VEGAS NV	13803218007

**Report of All Selected Parcels****Case Number:** SUP-41263**Printed On:** Thu: March 31, 2011

<u>Owner</u>	<u>Address</u>	<u>Parcel Numbe</u>
MILLONADO MARC A & MAUREEN J	18931 ARMINTA ST RESEDA CA	13803313009
MINI-MASTERS INC	3800 HOWARD HUGHES PKWY 17TH FL LAS VEGAS NV	13803602011
MINI-MASTERS INC	3800 HOWARD HUGHES PKWY 17TH FL LAS VEGAS NV	13803602015
MOHLMAN SCOTT & CATHY REV LIV TR	7524 CATHEDRAL CANYON CT LAS VEGAS NV	13803217022
MONTY JEFFREY A & CAROLYN L	7200 SLEEK AVE LAS VEGAS NV	13803217025
MOODY KENNETH & TRINA	7021 JUNCTION VILLAGE AVE LAS VEGAS NV	13803514057
MORRIS FAMILY TRUST	4445 N CAMPBELL RD LAS VEGAS NV	13803217009
MOSES JEFFERY & DELFINA	P O BOX 14762 IRVINE CA	13803314020
MOURADIAN ARA	7025 OVERHILL AVE LAS VEGAS NV	13803610006
MULLIGAN 1996 TRUST	7041 GOLDEN DESERT AVE LAS VEGAS NV	13803610028
MULLINS GLEN M	7112 GOLDEN DESERT AVE LAS VEGAS NV	13803610045
MURILLO LUIS F	4413 ORNATE CT LAS VEGAS NV	13803217017
MUSANTE JANICE BENNINGTON	8124 MOONSTONE CIR LAS VEGAS NV	13803313102
NAPOLI FRANK DEFINED BENEFIT PL	11532 CAPANNA ROSSO PL LAS VEGAS NV	13803514058
NARINYAN ANZHELA	587 SOUTH ST #14 GLENDALE CA	13803313031
NARODITSKY IGOR ETAL	3239 SHELTER CREEK LN SAN BRUNO CA	13803313033
NICE PROPERTIES L L C	92 CORPDRATE PARK #C-803 IRVINE CA	13803315029
NICE PROPERTIES L L C	92 CORPORATE PARK #C-803 IRVINE CA	13803313099
NOONAN RICHARD F & LORRAINE A	4412 ORNATE CT LAS VEGAS NV	13803217024
NOVAK JIMMY JOE & BRENDA J	8148 N HAMMER LN LAS VEGAS NV	13803610020
ODLE CHRISTOPHER W	7256 DAILY HOPE AVE LAS VEGAS NV	13803313084
OSBURN DAVID L & CYNTHIA N	7521 ENCHANTED HILLS CT LAS VEGAS NV	13803514023
OUIMET SHARON E	7217 DRY LAKE CT LAS VEGAS NV	13803315020
P I J M L L C	7626 PALLON AVE LAS VEGAS NV	13803313095
PATAI DONALD	4424 LILAC GLEN DR LAS VEGAS NV	13803215001
PATTERSON TYRONE	4429 ORNATE CT LAS VEGAS NV	13803217013
PAVLIK JAMES J & BERNADETTE A	7628 BRAINARD CT MENTOR OH	13803315034
PERAZA FRANCISCO ETAL	4416 VOGUE ST LAS VEGAS NV	13803217011
PEREZ REYNALDO S	7237 HIGH CASCADE AVE LAS VEGAS NV	13803313025
PERRY OSNAT	7821 SEA ROCK RD LAS VEGAS NV	13803313097
PETERS BRIAN E	7205 ELITE CT LAS VEGAS NV	13803218026
PETERSON TODD A	7117 OVERHILL AVE LAS VEGAS NV	13803515006

**Report of All Selected Parcels****Case Number:** SUP-41263**Printed On:** Thu: March 31, 2011

<u>Owner</u>	<u>Address</u>	<u>Parcel Number</u>
PHILLIPS LINDA C	4340 PERFECT DRIFT ST LAS VEGAS NV	13803315031
PHILLIPS RICHARD L	13605 WILKIE AVE GARDENA CA	13803610010
POTTER RAYMOND M & PATRICIA L	4595 BALSAM ST LAS VEGAS NV	13803602005
PRUST KAREN J	7228 ELITE CT LAS VEGAS NV	13803218035
PUNZALAN MARITAL LIVING TRUST	7312 DOLPHINE CREST AVE LAS VEGAS NV	13803314016
QUINTEROS MARIO RONALDO	P O BOX 33225 LAS VEGAS NV	13803313001
R B L B INC	8912 SPANISH RIDGE #200 LAS VEGAS NV	13803315012
RAMPTON DALE	7036 OVERHILL AVE LAS VEGAS NV	13803516001
REBEL OIL COMPANY INC	%J CASON 2200 S HIGHLAND DR LAS VEGAS NV	13803701019
REDWINE STEPHANIE L	7116 OVERHILL AVE LAS VEGAS NV	13803514025
REISS WALTER H III & KATHLEEN M	4413 VOGUE ST LAS VEGAS NV	13803217004
REYES VICTOR & JORGE	7020 OVERHILL AVE LAS VEGAS NV	13803516005
RHOADES ERMIE M	7021 OVERHILL AVE LAS VEGAS NV	13803610005
ROBARTS-GARZA REBECCA	4404 LILAC GLEN DR LAS VEGAS NV	13803215006
ROBOLLEDO ROGELIO	4401 OMATE CT LAS VEGAS NV	13803217020
ROE HOWARD P & KAY	7017 GOLDEN DESERT AVE LAS VEGAS NV	13803610022
ROJO MICHAEL A & ROBYN D	7212 SLEEK AVE LAS VEGAS NV	13803217028
ROSS KENNEY S & MARYANN	453 PIXIE LN THE VILLAGES FL	13803218021
ROSS STEVEN K	25870 WESTVIEW WY HAYWARD CA	13803314019
S C P 2002D-2 L L C	%CVS PHARMACY INC #2929-01 %STORE ACCOUNTING DEPT 1 CVS DR WOONSOCKET RI	13803611007
SAHAKIAN EDWARD J & RENEE A	4405 ORNATE CT LAS VEGAS NV	13803217019
SALADO CELIA	7117 GOLDEN DESERT AVE LAS VEGAS NV	13803610033
SANDERS ANTHONY	7220 ELITE CT LAS VEGAS NV	13803218033
SANDOVAL MICHAEL A & FRANCHESKA	7208 ELITE CT LAS VEGAS NV	13803218030
SANFORD SUSAN	7229 CAMDEN PINE AVE LAS VEGAS NV	13803315037
SANTANA LUIS A	7033 OVERHILL AVE LAS VEGAS NV	13803610008
SAVAGE CHERRI A	7237 CHIC AVE LAS VEGAS NV	13803218037
SAVICIC KRISTINA	7313 CAMDEN PINE AVE LAS VEGAS NV	13803315049
SCHMIT RONALD J	4460 N CHIEFTAIN ST LAS VEGAS NV	13803610026
SCHOOL BOARD OF TRUSTEES	2832 E FLAMINGO LAS VEGAS NV	13803201001
SCHURLEY ERIC & MELISSA A	7252 PLATINUM PEAK AVE LAS VEGAS NV	13803316006
SCHWAB ANDREW W	7252 DAILY HOPE AVE LAS VEGAS NV	13803313085

**Report of All Selected Parcels****Case Number:** SUP-41263**Printed On:** Thu: March 31, 2011

<u>Owner</u>	<u>Address</u>	<u>Parcel Number</u>
SCHWARTZ LENORE M REV LIV TR	7305 STANGE AVE LAS VEGAS NV	13803215025
SCOTT CHAD	7245 NOVA RIDGE CT LAS VEGAS NV	13803313035
SELL JACK G	7104 OVERHILL AVE LAS VEGAS NV	13803514022
SENEVI-RATHNER SUNIL	4525 VOGUE ST LAS VEGAS NV	13803218014
SHIELDS WILLIE L	7212 ELITE CT LAS VEGAS NV	13803218031
SHILL FRANK R & RONDA L	820 SAN BRUNO AVE HENDERSON NV	13803602006
SHREE GANESHA INC	700 FREMONT ST LAS VEGAS NV	13803611011
SHREE GANESHA INC	700 FREMONT ST LAS VEGAS NV	13803611009
SHREE GANESHA INC	700 FREMONT ST LAS VEGAS NV	13803611010
SHREVE JANELLE R	7228 SLEEK AVE LAS VEGAS NV	13803217032
SIDDIQI SAJID M & SAIMA	4771 BOWSER CT DALLAS TX	13803313090
SIECKMAN TAMARA	2707 HARMON RD SILVER SPRING MD	13803514016
SILVERMAN ALAN A & S LIV TR	7208 SLEEK AVE LAS VEGAS NV	13803217027
SILVESTRI JOSEPH P	7301 STANGE AVE LAS VEGAS NV	13803215026
SIRACUSA RICHARD A	308 W 82ND ST NEW YORK NY	13803313030
SIRACUSA RICHARD A	5425 CONNECTICUT N W #318 WASHINGTON DC	13803313101
SMIRK WILLIAM & CAROL REV LIV TR	7100 GOLDEN DESERT AVE LAS VEGAS NV	13803610048
SMITH ADAM & MELISSA	7301 CAMDEN PINE AVE LAS VEGAS NV	13803315046
SOMMA MICHAEL W & KATHERINE D	7121 GOLDEN DESERT AVE LAS VEGAS NV	13803610034
SORRELLS JEAN E	7300 DAILY HOPE AVE LAS VEGAS NV	13803313082
SOUTHWEST HOLDING COMPANY L L C	%GREAT AMER CAPITAL 8350 W SAHARA #210 LAS VEGAS NV	13803715003
SOWERS DENNIS B & LAURA A	4421 ORNATE CT LAS VEGAS NV	13803217015
SPAHR GUINEA C & CHRISTOPHER E	8250 N GRAND CANYON DR #1141 LAS VEGAS NV	13803315022
SPENCE RALPH III	7217 ELITE CT LAS VEGAS NV	13803218023
STANCATO AL	7004 OVERHILL AVE LAS VEGAS NV	13803516009
STANOWSKI MARIA	7109 JUNCTION VILLAGE AVE LAS VEGAS NV	13803514018
STAVROS SOPHIA	7237 CAMDEN PINE AVE LAS VEGAS NV	13803315039
STRETCH ROBERT M	7125 GOLDEN DESERT AVE LAS VEGAS NV	13803610035
STROKA LORRAINE S	7008 GOLDEN DESERT LAS VEGAS NV	13803610016
SUITER WAYNE & MARIA	1531 GRAND TETON CT CHULA VISTA CA	13803315003
SULLIVAN DENNIS E JR	7100 OVERHILL AVE LAS VEGAS NV	13803514021
SUMMERLIN HOLDINGS LTD	235-15TH ST 3RD FLR BELLEVUE CENTRE WEST VANCOUVER BC V7T 2X1 CANADA	13803315017

**Report of All Selected Parcels****Case Number:** SUP-41263**Printed On:** Thu: March 31, 2011

<u>Owner</u>	<u>Address</u>	<u>Parcel Number</u>
SUSZEK KRZYSZTOF	7228 DIAMOND HOPE CT LAS VEGAS NV	13803311004
SZALAY TRICIA	7009 JUNCTION VILLAGE AVE LAS VEGAS NV	13803514054
TALBOTT FRANKLIN E & DORALENE	7204 CHIC AVE LAS VEGAS NV	13803218002
TANAKA LESTER & B COLLEEN R	7033 JUNCTION VILLAGE AVE LAS VEGAS NV	13803514060
TANAKA LESTER & B COLLEEN ROWLEY	7033 JUNCTION VILLAGE AVE LAS VEGAS NV	13803610046
TASHJIAN SAM & REGINA LIVING TR TAXPAYER	8001 RYANS REEF LN LAS VEGAS NV LAS VEGAS NV	13803313019 13803215009
TAXPAYER	LAS VEGAS NV	13803315015
TAXPAYER	LAS VEGAS NV	13803215005
TAXPAYER	LAS VEGAS NV	13803316009
TERRIBLE HERBST INC	5195 LAS VEGAS BLVD S LAS VEGAS NV	13803611005
THORNHILL GROUP	7821 SEA ROCK RD LAS VEGAS NV	13803315041
THORNHILL GROUP INC	7821 SEA ROCK RD LAS VEGAS NV	13803315050
THORNHILL PROPERTIES 1 L L C	7821 SEA ROCK RD LAS VEGAS NV	13803315010
THORPE NICK	3605 E SKY HARBOR DR COEUR D ARLENE ID	13803315006
TIOTUYCO ALEXANDER V & CATHERINE	P O BOX 5818 VALLEJO CA	13803313103
TIOTUYCO V R & CATHERINE O	7217 HIGH CASCADE AVE LAS VEGAS NV	13803313020
TOMKO EDWARD	4980 NELLIS OASIS LN #1019 LAS VEGAS NV	13803315007
TROMBLEE DAVID J JR	7216 CHIC AVE LAS VEGAS NV	13803218005
TSUDA CAROLINE M	7312 RIBBON RIDGE AVE LAS VEGAS NV	13803313072
TURONIE JOSEPH SCOTT LIVING TR	3813 ASPEN COVE ST LAS VEGAS NV	13803316014
UMALI NANETTE	4356 PERFECT DRIFT ST LAS VEGAS NV	13803316017
VANALSTYNE GORDON & MAURA	P O BOX 188 LAKEWOOD WA	13803610023
VAUGHN MORRIS LIVING TRUST	7101 GOLDEN DESERT AVE LAS VEGAS NV	13803610029
VEGA ROGER & STEPHANIE	4417 ORNATE CT LAS VEGAS NV	13803217016
VENNER JEREMY & TRACY M	7236 EARLY PIONEER AVE LAS VEGAS NV	13803315009
VEREB JAMES A	4521 VOGUE ST LAS VEGAS NV	13803218015
VERSO ANTOINETTE	7233 NOVA RIDGE CT LAS VEGAS NV	13803313032
VOGUE 4501 L L C	%C CANLAS 26562 BLACK OAK DR VALENCIA CA	13803217002
W I T BRO INC	%WIT BRO ASPHALT 6971 W RED COACH AVE LAS VEGAS NV	13803602002
WALKER JUSTIN & NICHOLE	7220 CHIC AVE LAS VEGAS NV	13803218006
WALKER ROBIN J	7241 CAMDEN PINE AVE LAS VEGAS NV	13803315040

**Report of All Selected Parcels****Case Number:** SUP-41263**Printed On:** Thu: March 31, 2011

<u>Owner</u>	<u>Address</u>	<u>Parcel Number</u>
WALLACE STACIE N	1290 W HORIZON RIDGE PKWY #1816 HENDERSON NV	13803610004
WAMMACK KATHLEEN M	7004 GOLDEN DESERT AVE LAS VEGAS NV	13803610017
WANG CHING CHIEH	7301 DOLPHINE CREST AVE LAS VEGAS NV	13803314015
WASHINGTON PAMELA TRUST	7598 KENWOOD HILLS CT LAS VEGAS NV	13803514019
WASHKO NATALIE	2133 SANTINA AVE LAS VEGAS NV	13803514026
WEDOW & COGER FAMILY REAL EST TR	1030 S DAYTON ST DAVISON MI	13803315026
WETZEL SANTINI FAMILY TRUST	4334 GASPARVILLE ST LAS VEGAS NV	13803312009
WHETSTONE KENNETH R	4517 VOGUE ST LAS VEGAS NV	13803218016
WILLIAMS ASHLEE L & MARGO L	549 IVY SPRING ST LAS VEGAS NV	13803311002
WILLIAMS MONTE COREY & MELISSA K	7212 CHIC AVE LAS VEGAS NV	13803218004
WINTHER MATTHEW	7229 DRY LAKE CT LAS VEGAS NV	13803315023
WISE JULIE MARIE	7024 GOLDEN DESERT AVE LAS VEGAS NV	13803610012
WOODWARD PERRY D & ANN M	4425 ORNATE CT LAS VEGAS NV	13803217014
ZANONI AMANDA	7257 CAMDEN PINE AVE LAS VEGAS NV	13803315044



April 21, 2011

Mr. Raj Patel  
Shree Ganesha, Inc.  
700 Fremont Street  
Las Vegas, Nevada 89101

**RE: SUP-41263 - SPECIAL USE PERMIT  
PLANNING COMMISSION MEETING OF MAY 10, 2011**

Dear Mr. Patel:

Please be advised the City of Las Vegas Planning Commission at its regular meeting on **May 10, 2011** as referred to above, will consider your request. This meeting will be held at 6:00 P.M. at the Council Chambers of City Hall, 400 Stewart Avenue, Las Vegas, Nevada.

A copy of staff's recommendations, any conditions related to your application and the **final agenda** will be available on-line on **Wednesday, May 4, 2011** at [www.lasvegasnevada.gov](http://www.lasvegasnevada.gov). If you do not have access to the Internet and would prefer receiving hard copies of the documentation, please call the Case Planning Division at (702) 229-6301 or come into the Development Services Center at 333 North Rancho Drive, 3<sup>rd</sup> Floor, Las Vegas, Nevada 89106 to request your copies.

The Planning Commission requires that you or your representative be present at this meeting.

Sincerely,

A handwritten signature in black ink, appearing to read "Steve Gebeke", with a long horizontal line extending to the right.

Steve Gebeke, AICP  
Planning Supervisor  
Case Planning Division

SG:clb

cc: Ms. Michelle Gordon  
Kymtec dba Northwest Arms  
50 South Arrowhead Lane, Suite B  
Mesquite, Nevada 89027

Ms. Michelle Gordon  
7893 West Gilmore Avenue  
Las Vegas, Nevada 89129

LAS VEGAS CITY COUNCIL

OSCAR B. GOODMAN  
MAYOR

GARY REESE  
MAYOR PRO TEM

STEVE WOLFSON  
LOIS TARKANIAN  
STEVEN D. ROSS  
RICKI Y. BARLOW  
STAVROS S. ANTHONY

ELIZABETH N. FRETWELL  
CITY MANAGER

CITY OF LAS VEGAS  
DEPARTMENT OF PLANNING  
DEVELOPMENT SERVICES CENTER  
333 NORTH RANCHO DRIVE  
3RD FLOOR  
LAS VEGAS, NEVADA 89106

VOICE 702.229.6301  
FAX 702.474.0352  
TTY 702.386.9108  
[www.lasvegasnevada.gov](http://www.lasvegasnevada.gov)



# CITY OF LAS VEGAS SIGN POSTING AFFIDAVIT



CASE NUMBER: SUP-41263

MEETING DATE: 05/10/11 PC

1 of 2

Sign Pro does hereby certify that a notice as required by Chapter 19.18.010(D) of the Zoning Code, was visibly posted for a period of not less than ten (10) calendar days prior to the first scheduled hearing.

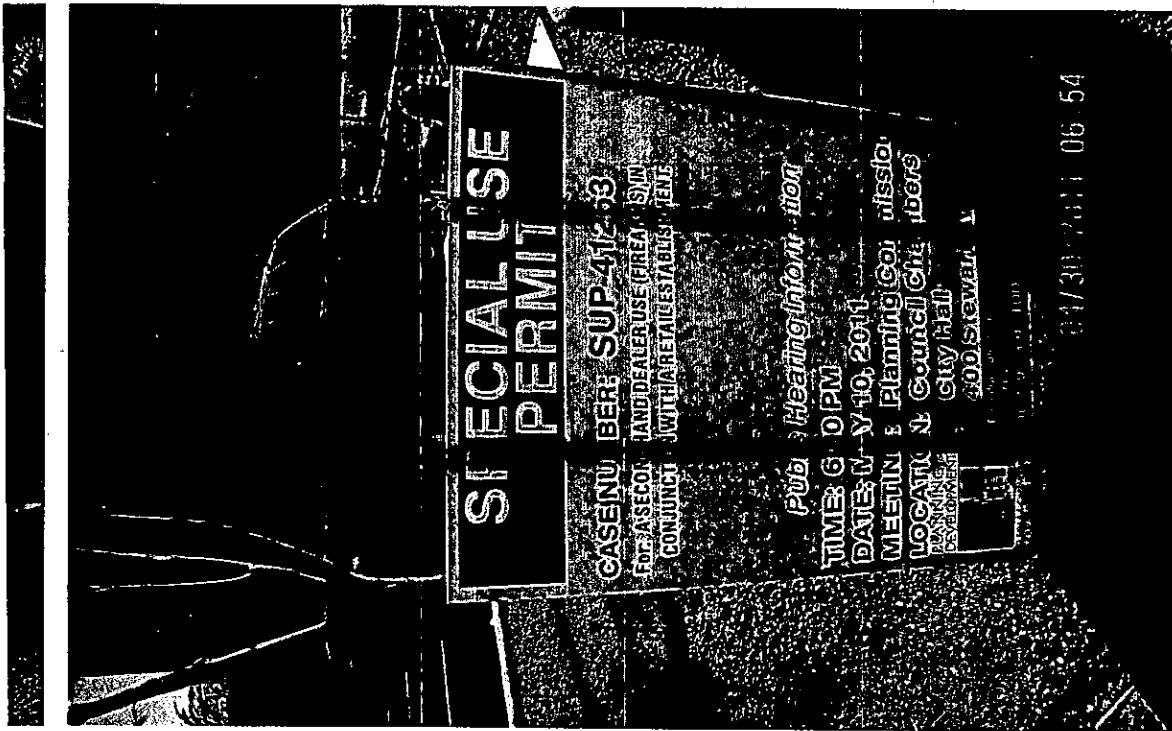

[Signature]  
Signature

4-30-11  
Date

This affidavit must be returned to the Department of Planning, Case Planning Division, at 333 North Rancho Drive, 3<sup>rd</sup> Floor during regular business hours three (3) business days prior to the subject application being heard by the Planning Commission or City Council.



CASE #

MEET

Sign Pr  
Code, wa  
schedulec

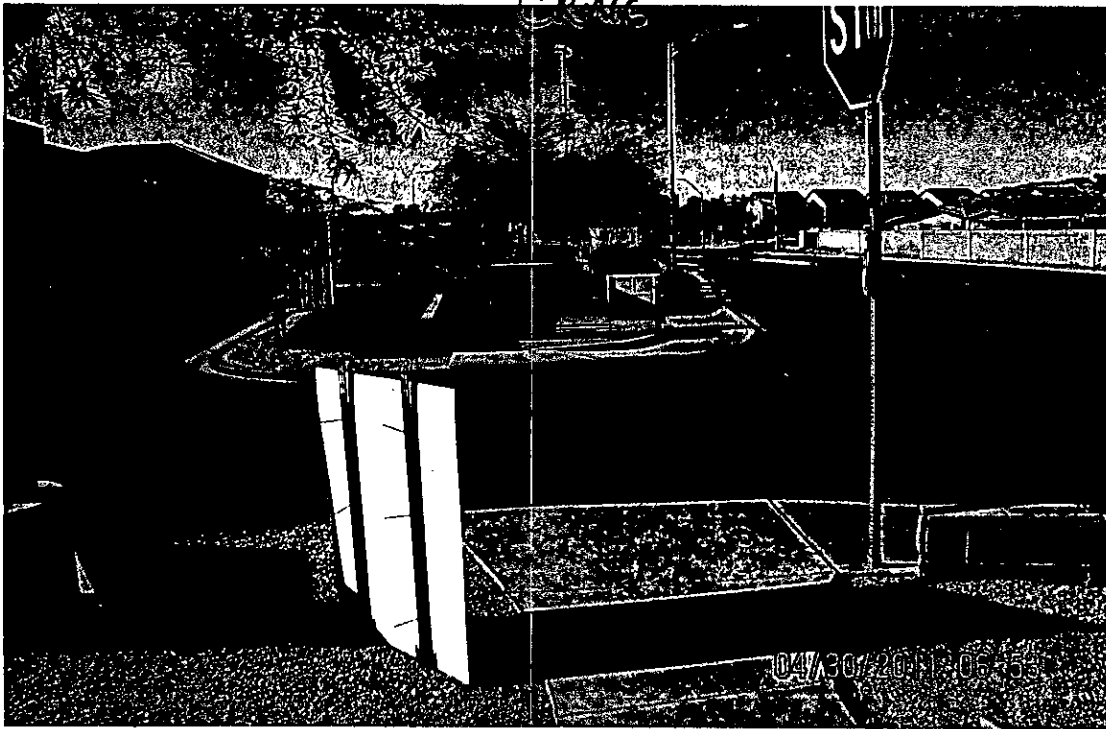

*[Handwritten Signature]*  
Signature

4-30-11  
Date

This affidavit must be returned to the Department of Planning, Case Planning Division, at 333 North Rancho Drive, 3<sup>rd</sup> Floor during regular business hours three (3) business days prior to the subject application being heard by the Planning Commission or City Council.



# CITY OF LAS VEGAS SIGN POSTING AFFIDAVIT



**CASE NUMBER:** SUP-41263

**MEETING DATE:** 05/10/11 PC

242

**Sign Pro** does hereby certify that a notice as required by Chapter 19.18.010(D) of the Zoning Code, was visibly posted for a period of not less than ten (10) calendar days prior to the first scheduled hearing.

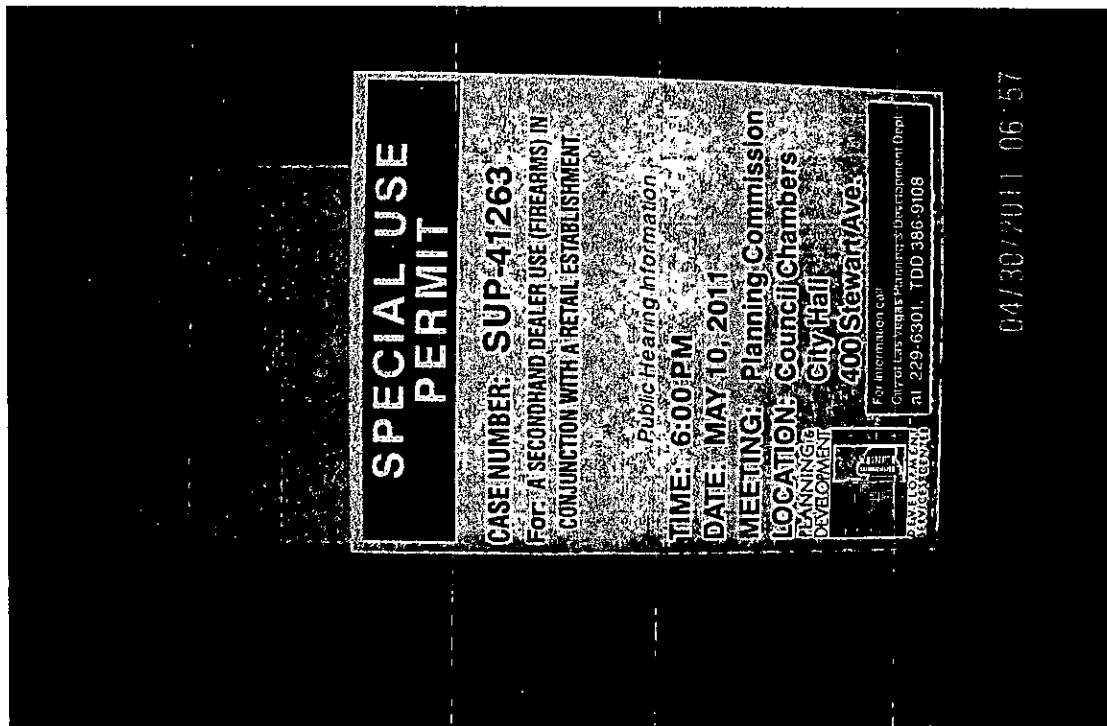

[Signature]  
Signature

4-30-11  
Date

This affidavit must be returned to the Department of Planning, Case Planning Division, at 333 North Rancho Drive, 3<sup>rd</sup> Floor during regular business hours three (3) business days prior to the subject application being heard by the Planning Commission or City Council.



1  
S  
C  
S

242  
Zoning  
re first



[Signature]  
Signature

4-30-11  
Date

This affidavit must be returned to the Department of Planning, Case Planning Division, at 333 North Rancho Drive, 3<sup>rd</sup> Floor during regular business hours three (3) business days prior to the subject application being heard by the Planning Commission or City Council.

## Application Information

**SUP-41263 - SPECIAL USE PERMIT - PUBLIC HEARING - APPLICANT: NORTHWEST ARMS - OWNER: SHREE GANESHA, INC.** - Request for a Special Use Permit FOR A SECONDHAND DEALER USE (FIREARMS) IN CONJUNCTION WITH A RETAIL ESTABLISHMENT at 4450 North Tenaya Way, Suite #100 (APN 138-03-611-011), C-1 (Limited Commercial) Zone, Ward 4 (Anthony).

## Application Location

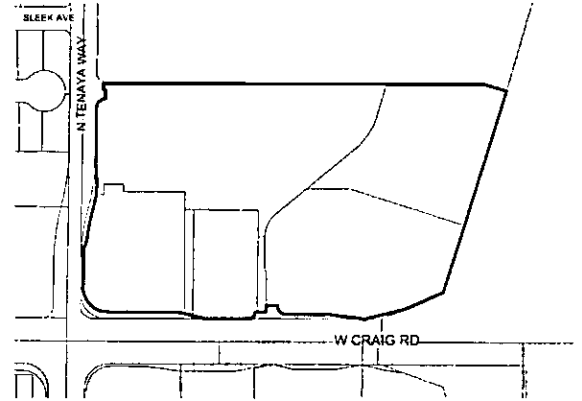

The proposed project may not pertain to the entire highlighted project site.

## Public Hearing Information

**Meeting:** Planning Commission  
**Date:** *May 10, 2011*  
**Time:** 6:00 P.M.  
**Location:** City Council Chambers  
400 Stewart Avenue  
Las Vegas, Nevada

Any and all interested persons may appear before the City Planning Commission either in person or by representative and object to or express approval of this request; or may, prior to this meeting, file a written objection thereto or approval thereof with the Department of Planning, Case Planning Division, Development Services Center, 333 North Rancho Drive, 3<sup>rd</sup> Floor, Las Vegas, Nevada 89106. Final Action on General Plan Amendments and Rezoning will be determined by the City Council. Other public hearing items may be deemed Final Action by the Planning Commission or forwarded to the City Council. The date of the City Council meeting, if applicable, will be announced at the Planning Commission meeting after the discussion of the item. For further information, including the full staff report, please call (702) 229-6301 (TDD 386-9108) or go to <http://www.lasvegasnevada.gov>.

## Application Information

**SUP-41263 - SPECIAL USE PERMIT - PUBLIC HEARING - APPLICANT: NORTHWEST ARMS - OWNER: SHREE GANESHA, INC.** - Request for a Special Use Permit FOR A SECONDHAND DEALER USE (FIREARMS) IN CONJUNCTION WITH A RETAIL ESTABLISHMENT at 4450 North Tenaya Way, Suite #100 (APN 138-03-611-011), C-1 (Limited Commercial) Zone, Ward 4 (Anthony).

## Application Location

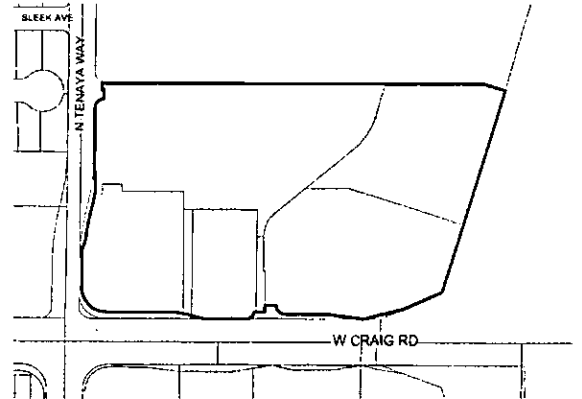

The proposed project may not pertain to the entire highlighted project site.

## Public Hearing Information

**Meeting:** Planning Commission  
**Date:** *May 10, 2011*  
**Time:** 6:00 P.M.  
**Location:** City Council Chambers  
400 Stewart Avenue  
Las Vegas, Nevada

Any and all interested persons may appear before the City Planning Commission either in person or by representative and object to or express approval of this request; or may, prior to this meeting, file a written objection thereto or approval thereof with the Department of Planning, Case Planning Division, Development Services Center, 333 North Rancho Drive, 3<sup>rd</sup> Floor, Las Vegas, Nevada 89106. Final Action on General Plan Amendments and Rezoning will be determined by the City Council. Other public hearing items may be deemed Final Action by the Planning Commission or forwarded to the City Council. The date of the City Council meeting, if applicable, will be announced at the Planning Commission meeting after the discussion of the item. For further information, including the full staff report, please call (702) 229-6301 (TDD 386-9108) or go to <http://www.lasvegasnevada.gov>.

City of Las Vegas  
Department of Planning  
Development Services Center  
333 North Rancho Drive, 3<sup>rd</sup> Floor  
Las Vegas, Nevada 89106

**Return Service Requested  
Official Notice of Public Hearing**

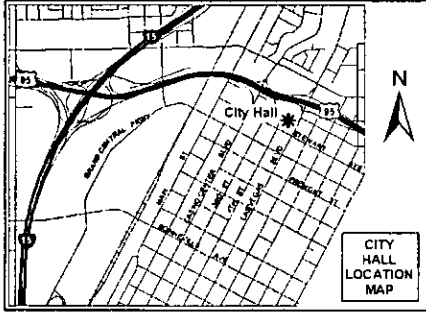

If you wish to file your protest or support on this request, check the appropriate box below and return this card in an envelope with postage to the Department of Planning, Case Planning Division at the address listed above or fax this side of this card to (702) 385-7268. If you would like to contact your Council Representative, please call (702) 229-6405.

I SUPPORT  
this Request

I OPPOSE  
this Request

Please use available blank space on card for your comments.

**SUP-41263**

Planning Commission Meeting of 5/10/2011

City of Las Vegas  
Department of Planning  
Development Services Center  
333 North Rancho Drive, 3<sup>rd</sup> Floor  
Las Vegas, Nevada 89106

**Return Service Requested  
Official Notice of Public Hearing**

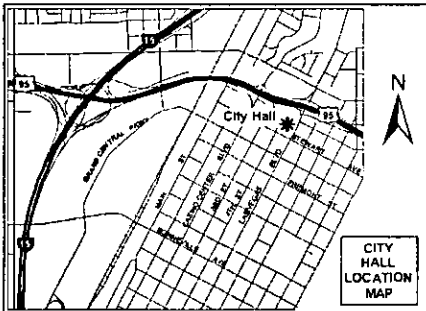

If you wish to file your protest or support on this request, check the appropriate box below and return this card in an envelope with postage to the Department of Planning, Case Planning Division at the address listed above or fax this side of this card to (702) 385-7268. If you would like to contact your Council Representative, please call (702) 229-6405.

I SUPPORT  
this Request

I OPPOSE  
this Request

Please use available blank space on card for your comments.

**SUP-41263**

Planning Commission Meeting of 5/10/2011

# Memorandum

City of Las Vegas  
Department of Public Works  
Development Coordination

**To:** Department of Planning and Development  
**From:** Bart Anderson, Manager, Development Coordination, Department of Public Works *RAA*  
**CC:** Nancy Almanzan, Right-of-Way; Dennis Moyer, Land Development; O. C. White, Traffic Engineering; Alan Riekki, Survey (FM, PM, & A's only)  
**Date:** April 7, 2011  
**Re:** **SUP-41263** Northwest Arms 4450 N. Tenaya Way, Ste. #100  
Request for a Special Use Permit for a secondhand dealer use (firearms)

---

## **COMMENTS:**

We have no comment on the Request for a Special Use Permit application to allow a secondhand dealer use (firearms) at 4450 North Tenaya Way, Suite #100.

## **Development Notification**

PC Meeting: May 10, 2011

---

**The following neighborhood associations are located within approximately one(1) mile of this development application and have been notified of this case by the Planning Department:**

---

**SUP-41263**

Deerbrooke HOA

Desert Greens HOA

Lone Mountain Village HOA

Mountain Gate HOA

Mountain Shadows HOA

Northwest Area Residents Association NCG

Northwest Citizens Board NA

Rancho Santa Fe HOA

Rosewood Estates

Sandpiper Golf Villas HOA

Sunhampton HOA

Sunset Estates Property HOA

Turning Point Community Association

Woodcrest HOA

**CITY OF LAS VEGAS**  
**INTER-OFFICE MEMORANDUM**  
**REQUEST FOR COMMENT**

**FROM:** DEPARTMENT OF PLANNING

**SUP-41263**

**HAND DELIVERED**

*DEVELOPMENT COORDINATION (DPW)	ROGER BAILEY	DSC - 7 <sup>th</sup> Floor
FIRE ENGINEERING	KEN MILLER	DSC - 5 <sup>th</sup> Floor
*FLOOD CONTROL (DPW)	ALBERT SUNG	DSC - 8 <sup>th</sup> Floor
*LAND DEVELOPMENT (DPW)	DAVID GUERRA	DSC - 2 <sup>nd</sup> Floor
PERMITS/ INSPECTIONS	ROD CLARK	DSC - 1 <sup>st</sup> Floor
*RIGHT-OF-WAY (DPW)	MARY WULFF	DSC - 8 <sup>th</sup> Floor
*SANITARY SEWERS (DPW)	JOE PEÑA	DSC - 7 <sup>th</sup> Floor
*SURVEY (DPW)	ALAN RIEKKI	DSC - 8 <sup>th</sup> Floor
*TEFO (DPW)	REBECCA WHITLOCK	DSC - 9 <sup>th</sup> Floor
*TRAFFIC ENGINEERING	RICK SCHROEDER	DSC - 8 <sup>th</sup> Floor

**ROUTED ELECTRONICALLY**

<CCSD>	LINDA PERRI	4190 McLeod Drive, 2 <sup>nd</sup> Floor
METRO	BRIAN O'CALLAGHAN	7 <sup>th</sup> FLOOR CITY HALL
OFFICE OF BUSINESS DEVELOPMENT	TOM BURKART	2 <sup>nd</sup> FLOOR CITY HALL EXPANSION
NEIGHBORHOOD SERVICES	ANNE KILPONEN	2 <sup>nd</sup> FLOOR CITY HALL
*SID (DPW)	PATRICK MURPHY	4 <sup>th</sup> FLOOR CITY HALL

**\* ONLY THOSE INDICATED WITH A STAR ARE TO BE ROUTED TO ROGER BAILEY, SR. ENG. ASSOC. ALL OTHER DIVISIONS PLEASE ROUTE YOUR COMMENTS DIRECTLY TO THE PLANNING AND DEVELOPMENT DEPARTMENT < US MAIL DELIVERY >**

SUP  
03/22/2011

**CITY OF LAS VEGAS**

**DEVELOPMENT REVIEW COMMENT FORM**



**Department of Planning**  
**Case Planning Division**  
**333 North Rancho Drive, 3<sup>rd</sup> Floor**  
**Las Vegas, Nevada 89106**  
**(702) 229-6301 phone (702) 385-7268 fax**

**SUP-41263 - SPECIAL USE PERMIT - PUBLIC HEARING - APPLICANT: NORTHWEST ARMS - OWNER: SHREE GANESHA, INC. - Request for a Special Use Permit FOR A SECONDHAND DEALER USE (FIREARMS) at 4450 North Tenaya Way, Suite #100 (APN 138-03-611-011), C-1 (Limited Commercial) Zone, Ward 4 (Anthony).**

**PLANNING COMMISSION: *MAY 10, 2011***  
**CITY COUNCIL: *JUNE 15, 2011***

**PLANNING SUPERVISOR: *STEVE GEBEKE***



***PUBLIC HEARING***

**Comments Due: *APRIL 7, 2011***

*Comments not returned by the due date will not be incorporated into the staff report for this case. Comments may be submitted either on this sheet and routed via interoffice mail, U.S. mail, fax, or e-mailed to Carman Burney (cburney@lasvegasnevada.gov), the Agenda Tech responsible for this case. If you desire to meet with the case planner you may schedule an appointment by calling (702) 229-6301.*

**LIST COMMENTS BELOW:**

5/10/11 PC



Report Date 03/22/2011 05:15 PM

Submitted By

Page 1

A/P # 41263 SPECIAL USE PERMIT

Application Information

Stages

	Date / Time	By	Date / Time	By
Processed	03/22/2011 14:21	983510	Temp COO	
Approved			COO issued	
Final			Expires	

Associated Information

Type of Work	# Plans	0
Dept of Commerce	# Plans	0
Priority	<input checked="" type="checkbox"/> Auto Reviews	Bill Group

Valuation

Declared Valuation	0.00
Calculated Valuation	0.00
Actual Valuation	0.00

Description of Work

SUP-41263 - SPECIAL USE PERMIT - PUBLIC HEARING - APPLICANT: NORTHWEST ARMS - OWNER: SHREE GANESHA, INC - Request for a Special Use Permit FOR A SECONDHAND DEALER USE at 4450 North Tenaya Way, Suite #100 (APN 138-03-611-011), C-1 (Limited Commercial) Zone, Ward 4 (Anthony).

Parent A/P #

Project # 41263 Project/Phase Name NORTHWEST ARMS SECONDHAND DEAL Phase #  
 Size/Area 3.42 ACRE Size Description Subdivision Code  
 Proposed Start Proposed Stop % Completed 0.00  
 % Complete Formula

Property/Site Information

Parcel 13803611011

Location

Owner/Tenant

Contact ID AC1103766 Name SHREE GANESHA INC  
 Mailing Address 700 FREMONT ST Organization  
 City LAS VEGAS State/Province NV  
 ZIP/PC 89101-5616 Country  Foreign  
 Day Phone Evening Phone  
 Fax Mobile #

A/P Linked Addresses

No Addresses are linked to this Application

Linked Addresses

- 4450 N TENAYA WAY  
LAS VEGAS, 89129-
- 4450 N TENAYA WAY 110  
LAS VEGAS, 89129-
- 4450 N TENAYA WAY 155  
LAS VEGAS, 89129-
- 4450 N TENAYA WAY 255  
LAS VEGAS, 89129-
- 4450 N TENAYA WAY 115  
LAS VEGAS, 89129-

Report Date 03/22/2011 05:15 PM

Submitted By

Page 2

**Address**

**Parcel Link**

**AP Link**

4450 N TENAYA WAY 245  
LAS VEGAS, 89129-

4450 N TENAYA WAY 205  
LAS VEGAS, 89129-

4450 N TENAYA WAY 225  
LAS VEGAS, 89129-

4450 N TENAYA WAY 130  
LAS VEGAS, 89129-

4450 N TENAYA WAY 250  
LAS VEGAS, 89129-

4450 N TENAYA WAY 240  
LAS VEGAS, 89129-

4450 N TENAYA WAY 135  
LAS VEGAS, 89129-

4450 N TENAYA WAY 150  
LAS VEGAS, 89129-

4450 N TENAYA WAY 215  
LAS VEGAS, 89129-

4430 N TENAYA WAY  
LAS VEGAS, 89129-

**AP Addresses**

No Other Addresses are associated to this Application

**Linked Parcels**

No Parcels are linked to this Application

**AP Linked Parcels**

13803611011

**Applicants/Contacts**

Report Date 03/22/2011 05:15 PM

Submitted By

Page 3

**Applicants/Contacts**

Primary N Capacity OWNER Contact ID AC1103766  Foreign  
Effective Expire  
Name SHREE GANESHA INC  
Day Phone Eve Phone Organization  
Pager PIN # Position  
Fax Mobile Profession  
E-Mail  
Address 700 FREMONT ST  
LAS VEGAS, NV 89101-5616  
Seasonal Addr

Valid From To  
Comments No Comments  
CONTACT ADDITIONAL

WORKCARD: Work Card # 0  
Expiration Date

**CONTACT REQUIREMENTS**

License# Percent Owned Waiver Health Card Director Letter Original Transcripts  
Orientation/Attended

There are no items in this list

Primary N Capacity APPL Contact ID AC1880985  Foreign  
Effective Expire  
Name KYMTEC DBA NDRTHWEST ARMS  
Day Phone Eve Phone Organization  
Pager PIN # Position  
Fax Mobile Profession  
E-Mail  
Address 50 S. ARROWHEAD LANE  
SUITE B  
MESQUITE, NV 89129  
Seasonal Addr

Valid From To  
Comments MICHELLE GORDON 467-5363



Report Date 03/22/2011 05:15 PM

Submitted By

Page 5

**Contractors**

No Contractors

**Item Description**

**Item Status**

Check Fees	Fees Successful
NOTIFICATION & ADVERTISING FEE (\$500.00)	Paid
PROCESSING FEE (\$500.00)	Paid
RECORDING OF NOTICE OF ZONING ACTION (\$30.00)	Paid
Check Inspections	Inspections Successful
Check Reviews	Reviews Failed
435728 B&S PLAN #1 (BUILDING&SAFETY PLAN REVIEW)	Incomplete
435726 DEVCO #1 (DEVELOPMENT COORDINATION)	Incomplete
435737 FIRE ENG #1 (FIRE PROTECTION ENGINEERING)	Incomplete
435729 FLOOD #1 (FLOOD CONTROL)	Incomplete
435736 LAND DEV #1 (LAND DEVELOPMENT)	Incomplete
435727 NEIGH P&S #1 (NEIGHBORHOOD PLAN & SUPPORT)	Incomplete
435735 ROW #1 (RIGHT-OF-WAY)	Incomplete
435734 SEWER #1 (COLLECTION SYSTEMS PLANNING)	Incomplete
435733 SID #1 (SPECIAL IMPROVEMENT DISTRICT)	Incomplete
435732 SURVEY #1 (SURVEY)	Incomplete
435731 TEFO #1 (TRAFFIC ENG FIELD OPERATIONS)	Incomplete
435730 TRAFFIC #1 (TRAFFIC ENGINEERING)	Incomplete
Check Conditions	Conditions Successful
Z-LEGAL (LEGAL DONE?)	No affect on stage
Check Alert Conditions	Alert Conditions Failed
(SIGNPRO-MEMO SENT TO POST DT)	
(SIGNPRO-SIGN POSTED DATE)	
(PY-ENTER THE # OF LABELS)	
(ASSIGN CASE TO A PLANNER)	
(AT-COMplete DRT PROCESS)	
(PY-NOTIFICATION MAP DATE)	
(AT-ROUTE PLANS FOR REVIEW)	
(AT-SEND PUB HEARING NOTICE)	
(AT-SEND TO REVIEW JOURNAL)	
(PY-SIZE OF NOTIFICATION AREA)	
(STAFF RECOMMENDATION)	
Check Licenses	Not Checked
Check Children Status	Children Successful
Check Open Cases	0

Fees	Status	Paid Date	Amount
NOTIFICATION & ADVERTISING FEE	P	03/22/2011 15:18	500.00
RECORDING OF NOTICE OF ZONING ACTION	P	03/22/2011 15:18	30.00
PROCESSING FEE	P	03/22/2011 15:18	500.00
<b>Total Unpaid</b>		0.00	<b>Total Paid</b> 1030.00

Review/Activities	Review #	Review Type	#	Status	Waived	Issued	Started	Completed	Comp By
Comments	435726	DEVCO	1	Incomplete	<input type="checkbox"/>		03/22/2011 17:15		

Report Date 03/22/2011 05:15 PM

Submitted By

Page 6

Review Activities Review # Comments	Review Type	#	Status	Waived	Issued	Started	Completed	Comp By
435727	NEIGH P&S	1	Incomplete	<input type="checkbox"/>	03/22/2011 17:15			
435728	B&S PLAN	1	Incomplete	<input type="checkbox"/>	03/22/2011 17:15			
435729	FLOOD	1	Incomplete	<input type="checkbox"/>	03/22/2011 17:15			
435730	TRAFFIC	1	Incomplete	<input type="checkbox"/>	03/22/2011 17:15			
435731	TEFO	1	Incomplete	<input type="checkbox"/>	03/22/2011 17:15			
435732	SURVEY	1	Incomplete	<input type="checkbox"/>	03/22/2011 17:15			
435733	SID	1	Incomplete	<input type="checkbox"/>	03/22/2011 17:15			
435734	SEWER	1	Incomplete	<input type="checkbox"/>	03/22/2011 17:15			
435735	ROW	1	Incomplete	<input type="checkbox"/>	03/22/2011 17:15			
435736	LAND DEV	1	Incomplete	<input type="checkbox"/>	03/22/2011 17:15			
435737	FIRE ENG	1	Incomplete	<input type="checkbox"/>	03/22/2011 17:15			

**Activity Review Details**

Detail SUBMITTAL CHECKLIST (SUP) Modified By BSTICKA Modified Date/Time 03/22/2011 14:18  
 Comments  
 No Comments

**SUBMITTAL CHECKLIST**

Indicate if item is being submitted

- Y Pre-Application Conference Checkiist Y Site Plan (6 Foiled Blue Lines, 1 Rolled Colored)
- Y Application/Petition Form Y Floor Pian, If Applicabie (1 Folded, 1 Rolled)
- Y Deed and Legal Description Y Laser Print Site Pian
- Y Justification Letter Y Laser Print Floor Pian
- Y DINA (Not Always Required) Y Statement of Financial interest

- Y Business Licensing Requirements Met
- N Business License Exempt

Check Conditions Condition Supervisor Required	Approval	Approved By Comments	Approved Date	Applied By	Applied Date	Assigned
--	----------	-------------------------	---------------	------------	--------------	----------

Z-LEGAL 980608 03/22/2011 17:15  
 N

Report Date 03/22/2011 05:15 PM

Submitted By

Page 7

Check Conditions	Approval	Approved By	Approved Date	Applied By	Applied Date	Assigned
Condition	Supervisor Required	Comments				

Planning Condition	Description	Effective	Expire	Comments
--------------------	-------------	-----------	--------	----------

There is no planning condition for this project.

**SPECIAL USE PERMIT**

Y DINA Required? Y Will this go to the City Council? Hearing Type  
 Public or Admin? PUBLIC

Y Project of Regional Significance?

N Parent Project link required? Is there a condition of approval for a Required Review?  
 If yes, when does it need to be reviewed?

Type of Use  
 SECONDHAND DEALER

N Is this an Alcohol related Use? Staff Recommendation Entitlement Exercised?

**Meeting Information**

Meeting Information	Meeting Date	Meeting Type	Meeting Status	YES Votes	NO Votes	ABSTENTIONS
Comments Added By	Add Date	Modified By	Modified Date			
	05/10/2011	PC	SCHEDULED	0	0	0
BSTICKA	03/22/2011					

Template Type	A/P #	A/P Type	Status	Stage
---------------	-------	----------	--------	-------

No children exist for this project

Employee ID	Last	First	MI	Comments
-------------	------	-------	----	----------

No Employee Entries

Log Action	Description	Entered By	Start	Stop	Hours
------------	-------------	------------	-------	------	-------

PAYMNT	CO NAME WHO PICKED UP CONTACT# MICHELLE GORDON; KYMTEC LLC; CK#1006; 702-556-8003;	890381	03/22/2011 15:19		0.00
--------	---	--------	------------------	--	------



**DEPARTMENT OF PLANNING**

**APPLICATION / PETITION FORM**

Application/Petition For: SPECIAL USE PERMIT (SUP)  
 Project Address (Location) 4450 N. TENAYA WAY, SUITE 100, LAS VEGAS, NV 89129  
 Project Name Northwest ARMS Proposed Use Second Hand Dealer (Firearm sales)  
 Assessor's Parcel #(s) 138-03-611-011 Ward # 4  
 General Plan: existing SC proposed N/A Zoning: existing C-1 proposed N/A  
 Commercial Square Footage \_\_\_\_\_ Floor Area Ratio \_\_\_\_\_  
 Gross Acres 3.42 Lots/Units \_\_\_\_\_ Density \_\_\_\_\_  
 Additional Information \_\_\_\_\_

PROPERTY OWNER SHREE GANESHA, INC Contact Raj  
 Address 700 FREMONT ST Phone: \_\_\_\_\_ Fax: \_\_\_\_\_  
 City LAS VEGAS State NV Zip 89101  
 E-mail Address \_\_\_\_\_

APPLICANT Kymtec dba Northwest Arms Contact Michelle Gordon  
 Address 50 So Arrowhead Ln # B Phone: 467-5363 Fax: \_\_\_\_\_  
 City Mesquite State NV Zip 89027  
 E-mail Address tmac@northwestarmslv.com

REPRESENTATIVE Michelle Gordon Contact \_\_\_\_\_  
 Address 7893 W. Gilmore Ave Phone: 556-8003 Fax: \_\_\_\_\_  
 City Las Vegas State NV Zip 89129  
 E-mail Address mg@northwestarmslv.com

Property Owner Signature\* Rajesh Patel  
\*An authorized agent may sign in lieu of the property owner for Final Maps, Tentative Maps, and Parcel Maps.  
 Print Name Rajesh Patel  
 Subscribed and sworn before me  
 This 22 day of MARCH, 20 11.  
[Signature]  
 Notary Public in and for said County and State

**FOR DEPARTMENT USE ONLY**

Case # 5UP-41263  
 Meeting Date: 5/16/11  
 Total Fee: \$1,030  
 Date Accepted: 3/22/11  
 Accepted By: [Signature]

\*The application will not be deemed complete until the submitted materials have been reviewed by the Planning and Development for consistency with applicable sections for the Zoning Ordinance.

f:\depot\Public\Forms\ApplicationPacket\Application Form.doc

Revised 02.14.11



**RECEIVED**  
**MAR 22 2011**



**DEPARTMENT OF PLANNING**

**STATEMENT OF FINANCIAL INTEREST**

Case Number: **SUP-41263** APN: 138-03-611-011

Name of Property Owner: SHREE GANESHA, INC.

Name of Applicant: Kymtec, LLC dba Northwest Arms

Name of Representative: Michelle GORDON

To the best of your knowledge, does the Mayor or any member of the City Council or Planning Commission have any financial interest in this or any other property with the property owner, applicant, the property owner or applicant's general or limited partners, or an officer of their corporation or limited liability company?

Yes

No

If yes, please indicate the member of the City Council or Planning Commission who is involved and list the name(s) of the person or persons with whom the City Official holds an interest. Also list the Assessor's Parcel Number if the property in which the interest is held is different from the case parcel.

City Official: \_\_\_\_\_

Partner(s): \_\_\_\_\_

APN: \_\_\_\_\_

Signature of Property Owner: *Rajesh Patel*  
Print Name: Rajesh Patel

Subscribed and sworn before me

This 22 day of MARCH, 2011

*Lyn Heinicke*  
Notary Public in and for said County and State

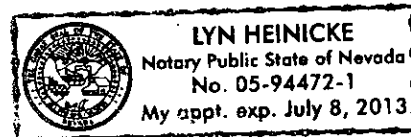

**RECEIVED**  
MAR 22 2011

# NORTHWEST ARMS

50 South Arrowhead Lane, Suite B  
Mesquite, Nevada 89027  
(702) 346-6153

March 20, 2011

CITY OF LAS VEGAS  
DEPARTMENT OF PLANNING  
333 Rancho Drive  
Las Vegas, NV 89101

RE: Special Use Permit  
Secondhand Sales @ 4450 North Tenaya Way, Suite 100, Las Vegas, NV 89129

## Issue -

Kymtec, LLC a Nevada corporation dba Northwest Arms is requesting a Special Use Permit at its Las Vegas location. Northwest Arms has currently signed a lease at 4450 N. Tenaya Way, Suite 100, Las Vegas, Nevada 89129 and submitted applications with the City of Las Vegas Business Licensing for a Sporting Goods (general retail) and a Pistol Permit. Northwest Arms has also requested temporary licenses until the Application process is completed. Northwest Arms intends to sell new firearms, rifles, ammunition and accessories, including but not limited to apparel, scopes, holsters, targets, etc. Northwest Arms also takes firearms in on trade as secondhand sales from previous customers or new customers who want to obtain a different type of firearm. All new and used firearms are called into NHP/NICS for a background check before the customer obtains the firearm.

Licensees play a critical role in protecting America from violent firearms crime through responsible and lawful distribution of firearms and accurate recordkeeping which assists ATF in tracing guns used to commit crimes. By complying with Federal law, licensees prevented the sale of more than 870,000 firearms to prohibited persons from November 1998 through September 2005. An untold number of lives have been saved and countless crimes have been prevented by stopping such transactions from taking place. (*Federal Firearms Regulations Reference Guide 2005*). Currently, there are no full service firearm retailers in the Northwest Las Vegas quadrant.

## Information -

Northwest Arms intends to employ three (3) persons upon opening of the store and will increase the number of employees as demand increases. The hours of operation will be 10:00 AM to 6:00 PM unless otherwise specified at the store. Northwest Arms has an existing similar use owned

RECEIVED  
MAR 22 2011  
SUP-41263

# **NORTHWEST ARMS**

50 South Arrowhead Lane, Suite B  
Mesquite, Nevada 89027  
(702) 346-6153

and operated by Kymtec, LLC a Colorado Corporation at its Mesquite location - 50 South Arrowhead Lane, Suite B, Mesquite, Nevada. Kymtec, LLC a Colorado Corporation has been in business for over seven (7) years at this location.

The required state licenses specific to our use is a Sporting Goods License (general retail for new rifles, ammunition, accessories, etc); a Pistol Permit (retail new firearms; Federal Firearms License (firearms, rifles, Class III); and a Special Use Permit for Secondhand Sales Use (used, trade-in's or estate collections).

## **Findings -**

1. "The proposed land use can be conducted in a manner that is harmonious and compatible with existing surrounding land uses, and with future surrounding land uses as projected by the General Plan."

Northwest Arms is located within a shopping center that can accommodate a variety of uses including retail sales, medical and professional offices, personal services, and restaurants. The addition of a Firearms Retailer within this shopping center is compatible with the existing and future land uses as specified by the SC (Service Commercial) General Plan designation and CC&R's.

2. "The subject site is physically suitable for the type and intensity of land use proposed."

Northwest Arms is located within a shopping center that was designed to accommodate a variety of uses, including retail use, and conforms to both the General Plan and Title 19 land use designations of the site with the approval of a Special Use Permit.

3. "Street or highway facilities providing access to the property are or will be adequate in size to meet the requirements of the proposed use."

The proposed Firearm Retailer is located within a C-1 shopping center that is adequately served by Craig Road, a 100-foot Primary Arterial, and Tenaya Way, a 60-foot Collector Street, as designated by the Master Plan Streets and Highways.

4. "Approval of the Special Use Permit at the site in question will not be inconsistent with or compromise the public health, safety, and welfare or the overall objectives of the General Plan."

The proposed Special Use Permit will not be inconsistent with or compromise the public health, safety or welfare as a secondhand dealer is subject to licensing and inspections by the City of Las Vegas; BATFE, Bureau of Alcohol Tobacco Firearms and Explosives (pursuant to the Federal Firearms Regulations Reference Guide 2005, Gun Control Act, National Firearms Act, Arms Export Control Act); National Instant Criminal Background Check System; and the Las Vegas Metropolitan Police Department.

**RECEIVED**  
MAR 22 2011  
**SUP-41263**

# **NORTHWEST ARMS**

50 South Arrowhead Lane, Suite B  
Mesquite, Nevada 89027  
(702) 346-6153

Northwest Arms is located three (3) miles from the Clark County Shooting Range and will allow customers access to regulated safe shooting. Currently, the Clark County Shooting Range offers a limited supply of ammunition and accessories that Northwest Arms can augment. The proposed site will reduce the length of trips of our customers to other shops in Las Vegas, thus reducing traffic trips and congestion in the core of the city. Opening Northwest Arms in Las Vegas fills vacant commercial property and improves the appearance of the business park and will generate sales tax revenues and additional employment for the city.

Sincerely,

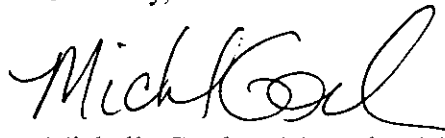

Michelle Gordon, Managing Member  
NORTHWEST ARMS

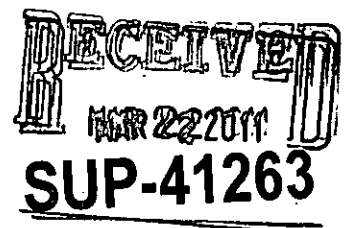

CITY OF LAS VEGAS  
DEPARTMENT OF PLANNING

**ENVIRONMENTAL IMPACT ASSESSMENT**

Pursuant to Las Vegas Municipal Code (LVMC) Section 19.18.010(E) and Ordinance No. 5477 (May 1, 2002), the City of Las Vegas has determined that your project is subject to a Development Impact Notice and Assessment (DINA) and/or meets the criteria for a Project of Regional Significance as established by the Southern Nevada Regional Policy Plan.

**ENVIRONMENTAL FACTORS POTENTIALLY AFFECTED:**

The environmental factors checked below would be potentially affected by this project. The Environmental Impact Assessment forms attached herein must be prepared for each factor\* and submitted for evaluation.

<input checked="" type="checkbox"/>	<b>1</b>	<b>Project Description</b>
<input checked="" type="checkbox"/>	<b>2</b>	<b>Transportation and Traffic</b>
<input checked="" type="checkbox"/>	<b>3</b>	<b>Schools</b>
<input checked="" type="checkbox"/>	<b>4</b>	<b>Emergency Services</b>
<input checked="" type="checkbox"/>	<b>5</b>	<b>Housing</b>
<input checked="" type="checkbox"/>	<b>6</b>	<b>Mass Transit</b>
<input checked="" type="checkbox"/>	<b>7</b>	<b>Open Space and Recreation</b>
<input checked="" type="checkbox"/>	<b>8</b>	<b>Hydrology</b>
<input checked="" type="checkbox"/>	<b>9</b>	<b>Water Quality</b>
<input checked="" type="checkbox"/>	<b>10</b>	<b>Utilities and Service System</b>

\* Bold question numbers denote minimum NRS requirements

**RECEIVED**  
MAR 22 2011

**SUP-41263**

City of Las Vegas  
ENVIRONMENTAL IMPACT ASSESSMENT

**Applicant Information**

The following Environmental Impact Assessment is being submitted for consideration for the proposed project known as KYMTEC, LLC dba NORTHWEST ARMS, located at 4450 NORTH TENAYA WAY, SUITE 100, LAS VEGAS, NV 89129.

This document is being prepared by:

Company Name: KYMTEC, LLC dba NORTHWEST ARMS

Address: 4450 NORTH TENAYA WAY, SUITE 100, LAS VEGAS, NV 89129

Contact Person:

Name: MICHELLE GORDON

Title: MANAGING MEMBER

Telephone: (702) 556-8003

Fax: (702) 346-6153

E-mail: [thegoddess91@yahoo.com](mailto:thegoddess91@yahoo.com) or [mg@northwestarmslv.com](mailto:mg@northwestarmslv.com)

I certify that the statements made by me on this Environmental Impact Assessment represent my best professional judgment and are, to the best of my knowledge, true and complete and correct.

I understand that any misrepresentation or material omission of fact on this document may be considered as constituting grounds for an incomplete application and may uphold processing of the application until complete information is provided.

Signature: 

Date: 3-21-2011

Name: MICHELLE GORDON  
Title: MANAGING MEMBER

RECEIVED  
MAR 22 2011

City of Las Vegas  
ENVIRONMENTAL IMPACT ASSESSMENT

**1 Project Description**

1.a Project title: NORTHWEST ARMS  
1.b Application #:  
1.c Project location: 4450 NORTH TENAYA WAY, SUITE 100, LAS VEGAS, NV 89129

1.d Project sponsor  
Name:  
Address:  
Telephone:

1.e G. P. designation: SC (Service Commercial)

1.f Zoning: C-1

1.g Project description:

Total site acreage: 3.42

i) Residential

Total units: 0

FAR per Lot: 0

Lot Coverage per Lot: 0

ii) Hospitality

Total rooms: 0

Total entertainment: 0

iii) Commercial

Total S.F.: 32,684 Retail

Total FAR: 50,790

Total Lot Coverage:

1.h Briefly describe the project's surrounding land use and setting:

North: VACANT (Building Supply Warehouse) SC / C-1

East: VACANT / (US 95) SC / C-1

South: Shopping Center (CVS & McDonalds) SC / C-1

West: VACANT rezoned from L to Commercial

Pet Cemetery DR (Desert Rural Clark County R-E)

1.i Project narrative (Describe the whole action involved, including but not limited to later phases of the project, and any secondary, support, or off-site features necessary for its implementation:

Narrative: The proposed Retail Sales and Secondhand Sales of firearms is located within a shopping center that can accommodate a variety of uses including, retail sales, medical and professional offices, personal services and restaurants. The addition of a Secondhand Retailer with this shopping center is compatible with the existing and future land uses as specified by the SC (Service Commercial) General Plan designation.

RECEIVED  
MAR 22 2011

## 2 Transportation and Traffic

- 2.a Would the project include adequate emergency access pursuant to LVMC Fire and emergency response requirements?

Explain: YES. The proposed Secondhand Retailer is located within a shopping center that is adequately served by Craig Road, a 100-foot Primary Arterial, and Tenaya Way, a 60-foot Collector Street, for emergency access pursuant to LVMC Fire and emergency response, as designed by the Master Plan Streets and Highways.

- 2.b Would the project provide adequate parking pursuant to LVMC parking requirements?

Explain: YES. Pursuant to the LVMC parking requirements, the parking provided by Shree Ganesha, Inc. would be 553 regular and 12 handicapped for a total of 565 parking spaces and the LVMC parking requirements have a parking ratio of 1:25 and 302 regular and 8 handicapped for a Gross Floor area of 77,465 SF.

- 2.c Would the project potentially increase hazards due to a design feature (e.g., sharp curves, dangerous intersection) or incompatible uses (e.g., commercial heavy equipment)?

Explain: NO. The proposed Secondhand Retailer will not increase hazards as the design features have already been installed or are in place and no commercial heavy equipment will be utilized.

- 2.d Would the site have sufficient access to streets and highways, adequate in width and pavement type to carry the quantity and quality of traffic generated by the proposed project?

Explain: YES. The proposed Secondhand Retailer is located within a shopping center that is adequately served by Craig Road, a 100-foot Primary Arterial, and Tenaya Way, a 60-foot Collector Street, as designed by the Master Plan Streets and Highways.

- 2.e Insert a Table (attach additional sheets if necessary), indicating the number of vehicle trips that the proposal will generate, estimated by applying to the proposal the average trip rates for the peak days and hours established by the Institute of Transportation Engineers (or its successor).

Table: The proposed site will have hours of operation from 10:00 AM to 6:00 PM and will generate an estimated number of vehicle trips of 6-10 per day.

RECEIVED  
MAR 22 2011

City of Las Vegas  
ENVIRONMENTAL IMPACT ASSESSMENT

**3** Schools

3.a What is the total number of proposed residential units?

Conventional units:0

Age-restricted units:0

3.b Based upon the student generation factors utilized by Clark County School District what is the estimated number of pupils generated by the proposal which will be added to the enrollment of each of the following:

Elementary School

School name: N/A

Distance from site:

Number of pupils:

Junior High/Middle School

School name: N/A

Distance from site<sup>2</sup>:

Number of pupils:

High School

School name: N/A

Distance from site<sup>2</sup>:

Number of pupils:

RECEIVED  
MAR 22 2011

*City of Las Vegas*  
ENVIRONMENTAL IMPACT ASSESSMENT

**4 Emergency Services**

4.a Provide the distance from the site of the proposal to the nearest facilities from which firefighting, police and emergency services will be provided, including without limitation, facilities of a local government that are planned but not yet constructed, and facilities that have been included in a local government's plan for capital improvements prepared pursuant to NRS 278.0226.

Fire

Name of the facility: City of Las Vegas  
STATION 9  
4747 N. Rainbow Blvd  
Las Vegas, NV 89108  
Existing/proposed: Existing  
Distance from site: 0.53 miles

Police

Name of the facility: Las Vegas Metropolitan Police Department  
Northwest Command  
9850 W. Cheyenne Avenue  
Las Vegas, NV 89129  
Existing/proposed: Existing  
Distance from site<sup>3</sup>: 4.9 miles

Emergency Services

Name of the facility: Mountain View Hospital  
3100 N. Tenaya Way  
Las Vegas, NV 89129  
Existing/proposed: Existing  
Distance from site<sup>3</sup>: 1.8 miles

4.b Would the project result in increase for emergency services in order to maintain acceptable service ratios, response times or other performance objectives for any of the public services:  
Explain: NO.

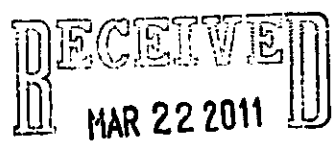

*City of Las Vegas*  
ENVIRONMENTAL IMPACT ASSESSMENT

**5** **Housing**

5.a Would the proposed project conflict with any applicable land use plan, policy, or regulation of an agency with jurisdiction over the project (including, but not limited to the general plan, specific plan, rural preservation area, or zoning ordinance)?

Explain: NO. The proposed site is within a shopping center that was designed to accommodate a variety of uses, including secondhand sales use, and conforms to both the SC - Service Commercial - General Plan and LVMC 6.74 / Title 19 land use designations of the site with the approval of a Special Use Permit.

5.b Would the project displace or eliminate existing housing?

Explain: NO.

5.c What are the project characteristics, in terms of:

Density: 6-10 persons per acre

Height:

Gated community: N/A

Housing Type: N/A

Home ownership: N/A

5.d Provide a brief statement setting forth the anticipated effects of the proposal on housing.

Explain: N/A

RECEIVED  
MAR 22 2011

*City of Las Vegas*  
ENVIRONMENTAL IMPACT ASSESSMENT

**6** **Mass Transit**

6.a Provide the distance from the site of the proposal to the nearest mass transit loading point.

Line number/name: 218 / Cheyenne

Location: W. Gowan and N. Buffalo

Distance from site: 1.57 miles

---

6.b Would the project result in change to the existing mass transit route, creation of a new line, or new loading points?

Explain: NO.

---

6.c Provide a brief statement setting forth the anticipated effects of the proposal on mass transit.

Explain: No known anticipated effects of the proposal on mass transit.

RECEIVED  
MAR 22 2011 Page 8 of 17

*City of Las Vegas*  
ENVIRONMENTAL IMPACT ASSESSMENT

**7** **Open Space and Recreation**

- 7.a Provide the distance from the site of the proposal to the nearest existing or planned (as identified by the City of Las Vegas Master Plan – Parks Element, 2000) recreation area as follows:

Neighborhood Park

Park name: W. Wayne Bunker Family Park

Location: Buffalo and Gowan

Distance from site: 0.8 miles

---

Community Park

Park name: Buckskin Basin

Location: 7350 Buckskin Avenue, Las Vegas, NV 89129

Distance from site<sup>7</sup>: 1.2 miles

---

Regional Park

Park name: Lorenzi Park

Location: W. Washington Avenue, Las Vegas, NV 89107

Distance from site<sup>7</sup>: 6.5 miles

- 
- 7.b Based upon 1990 US Census population table, what would be the total population generated by the proposed project?

Explain: N/A

- 
- 7.c How much public parkland would be included in the proposed project?

Explain: None.

- 
- 7.d Provide a brief statement setting forth the anticipated effects of the proposal on open space and recreation.

Explain: No known anticipated effects of the proposal on open space and recreation.

**RECEIVED**  
**MAR 22 2011**

*City of Las Vegas*  
ENVIRONMENTAL IMPACT ASSESSMENT

**8 Hydrology**

8.a Would the proposed project alter the existing drainage pattern of the site area?

Explain: NO.

8.b What is the quantity of the increase in storm water runoff generated by the proposed project, estimated by using standards hydrologic method?

Explain: N/A

8.c Would the total quantity of water runoff after construction exceed the capacity of existing or planned storm water drainage system?

Explain: N/A

8.d Would the proposed project result in the construction of a new storm water drainage facility or the expansion of existing facilities? Is the storm water facility identified in the Neighborhood, City Wide or the Regional Master Plans?

Explain: NO.

8.e Would the proposed project place housing within a 100-year special flood hazard area as mapped on the Federal Emergency Management Agency (FEMA) Flood Insurance Rate Map (FIRM)?

Explain: N/A

8.f Would the proposed project require drainage mitigation to protect the development from interim flows?

Explain: N/A

8.g Would the proposed project development meet the Clark County Regional Flood Control District – Hydrologic Criteria and Drainage Design Manual requirements for street flow and dry lane criteria for both the existing and the ultimate flow conditions?

Explain: YES. The proposed site is within an existing shopping center that was designed to accommodate a variety of uses and conforms to both the General Plan and Title 19 land use designations of the site with the approval of a Special Use Permit.

**RECEIVED**  
MAR 22 2011

*City of Las Vegas*  
ENVIRONMENTAL IMPACT ASSESSMENT

**9** **Water Quality**

9.a Would water service provided to the proposed project by an existing or planned facility?

Explain: Existing.

9.b Would the proposed project result in the construction of a new water treatment facility or expansion of existing facilities?

Explain: NO.

9.c What is the quantity of water that the project will demand during and after completion of the project, estimated by applying a demand factor established by the provider of water service or an equivalent calculation to the number of units that will be created by and the gross acreage that will be occupied by the project?

Explain: The proposed site is within an existing shopping center that will occupy 1,681 SF and it is not anticipated that the quantity of water will increase.

**RECEIVED**  
**MAR 22 2011**

*City of Las Vegas*  
ENVIRONMENTAL IMPACT ASSESSMENT

**10** Utilities and Service System

10.a Would the proposed project connect to an existing or planned sewer system?

Explain: Existing

10.b What is the quantity of sewage affluent generated by the proposed project, estimated by applying a sewage generation factor established by the provider of sewer service or an equivalent calculation to the number of units or area of indoor floor space that would be created by the project?

Explain: N/A

10.c Would the total quantity of sewage effluent generated by the proposed project exceed the capacity of existing or planned sewer system and wastewater treatment facility?

Explain: NO.

10.d Would the proposed project generate any industrial waste?

Explain: NO.

**RECEIVED**  
**MAR 22 2011**

City of Las Vegas  
ENVIRONMENTAL IMPACT ASSESSMENT

**EXHIBIT 1**

Clark County School District  
April 9, 2002

2001-2001 Valley-wide Student Yields

Grade	Student Yield	
	Single-Family	Multi-Family
K-5	0.245	0.163
6-8	0.123	0.066
9-12	0.137	0.062
P & 13	0.004	0.002

Single-Family units include mobile homes and townhouse.

Multi-Family units include a combination of apartments, plexes, and condominiums.

P & 13: Pre-school and Sunset School.

**RECEIVED**  
**MAR 22 2011**

City of Las Vegas  
ENVIRONMENTAL IMPACT ASSESSMENT

**EXHIBIT 2**

City of Las Vegas  
Master Plan – Parks Element  
March 15, 2000

Existing City Parks  
(Map 1, pp. 11)

Parks Name	Classification			Acres
	N	C	R	
Aloha Shores Park	X			4.03
Angel Park	X			6.11
AnSan Sister City Park	X			7.83
Baker Park	X			6.78
Bob Baskin Park	X			6.18
Bruce Trent Park	X			10.00
Buckskin Basin	X	X		39.17
Charleston Heights Park	X			3.90
Charleston Heights	X			7.12
Chester A. Stupak Park	X			1.23
Children's Mem. Park	X	X		29.82
Coleman Park	X			4.00
Cragin Park	X			3.27
Dexter Park	X			4.70
Doolittle Park	X			15.28
Ed Fountain Park	X	X		29.82
Ethel Pearson Park	X			2.59
Fitzgerald Tot Lot	X			0.70
Freedom Park	X	X	X	68.08
Hadland Park	X			13.64

Parks Name	Classification			Acres
	N	C	R	
Heers Park	X			7.07
Hills Park	X			13.50
Huntridge Circle Park	X			3.14
James Gay III Park	X			7.18
Jaycee Park	X			18.40
Lorenzi Park	X	X	X	59.37
Lubertha Johnson Park	X			1.60
Mary Dutton Park	X			0.20
Mirabelli Park	X			1.41
Pueblo Park(s)	X			5.09
Rafael Rivera Park	X			9.28
Rainbow Family Park	X	X		26.48
Elkhorn/Durango Fields	X	X		
Rotary Park	X			3.34
Stewart Place Park	X			3.45
Wayne Bunker Family Pk	X			13.75
W. Charleston Lions Park	X			4.50
Wildwood Park	X			1.24
Woofter Family Park	X			9.22
Clarence Ray Park	X			0.10

N: Neighborhood Park C: Community Park R: Regional Park



City of Las Vegas  
ENVIRONMENTAL IMPACT ASSESSMENT

**EXHIBIT 3**

City of Las Vegas  
Master Plan – Parks Element  
March 15, 2000

Planned City Parks  
(Map 12, pp. 49)

Parks Name	Classification			Acres
	N	C	R	
Fort Apache/Log Cabin Park	X			TBD
Jones/Iron Mountain Park	X	X	X	TBD
Grand Canyon/Bardley Park	X	X		40.0/34.0
Fort Apache/Elkhorn Park	X			TBD
Elkhorn/Durango Ballfields	X	X		TBD
Deer Springs Park	X	X		110.0/40.0
Deer Springs/Thom Park	X	X		TBD
Regional Sports Park	X	X		60.00
Ann/Cimmaron Park	X			2.50
Cheyenne/Jensen	X	X		20.00
Metro Park	X			17.00
Alexander/Diamond Ridge Park	X			TBD
Cheyenne/Durango Park	X	X	X	5.0/61.5
Northwest Soccer Park	X	X		TBD
Summerlin Sports Park	X			TBD
Pioneer/Silver Ridge Park	X			TBD
AnSan Sister City Park	X			TBD
Buffalo/Oakey Park	X	X		42.5/30.0
Pioneer/O' Bannon Park	X			TBD
Oakey/Redwood Park	X	X		28.00
Heritage Park	X			TBD
Dog Fanciers Park	X			0.5/6.0
Bonanza/Honolulu Park	X			TBD

**RECEIVED**  
**MAR 22 2011**

N: Neighborhood Park C: Community Park R: Regional Park

*City of Las Vegas*  
ENVIRONMENTAL IMPACT ASSESSMENT

RECEIVED  
MAR 22 2011

*City of Las Vegas*  
**ENVIRONMENTAL IMPACT ASSESSMENT**

**EXHIBIT 4**

US Census Bureau  
 1990

Persons per Units by Units in Structure by Owner and Renter Occupied  
 (City of Las Vegas, US Census Bureau, 1990 STF-1)

<b>Owner Occupied</b>	<b>Persons per Unit</b>
Single Family Detached	2.82
Single Family Attached (Townhouse)	2.14
Condominiums	
2 to 19 units	1.92
20 to 49 units	1.86
50 or more units	1.35
Mobile Home or Trailer	2.05

<b>Renter Occupied</b>	<b>Persons per Unit</b>
Single Family Detached	3.33
Single Family Attached (Townhouse)	2.79
Apartments	
2 to 19 units	2.23
20 to 49 units	1.82
50 or more units	1.76
Mobile Home or Trailer	1.87

**RECEIVED**  
**MAR 22 2011**

20051027-0005653

Fee: \$20.00 RPTT: \$12,367.50  
N/C Fee: \$25.00

10/27/2005 14:59:20  
T20050198036

Requestor:  
NATIONAL TITLE COMPANY

Frances Deane KGP  
Clark County Recorder Pgs: 7

Order No.: 260054-DJ  
APN No.: 138-03-611-006 *PORTION*  
R.P.T.T.: 12,367.50  
WHEN RECORDED MAIL TO:  
SHREE GANESHA INC  
700 FREMONT STREET  
LAS VEGAS, NV 89101

72 11

RETURN TAX STMTS. TO:  
SAME

9

### GRANT, BARGAIN & SALE DEED

**THIS INDENTURE WITNESSETH:** That CRAIG I-95 LLC, A LIMITED LIABILITY COMPANY

in consideration of \$10.00, the receipt of which is hereby acknowledged, do/does hereby Grant, Bargain, Sell and Convey to SHREE GANESHA, INC., A NEVADA CORPORATION

all that real property situated in the County of Clark, State of Nevada, bounded and described as follows:

That portion of the Southwest Quarter (SW1/4) of the Northeast Quarter (NE1/4) of Section 3, Township 20 South, Range 60 East, M.D.M., more particularly described as follows:

Commencing at the East Quarter (E1/4) Corner of said Section 3;

Thence along the South line of the said Northeast Quarter (NE1/4), said line also being the centerline of Craig Road, North 89°32'53" West 1897.88 feet to the Point of Intersection of said South line and the West Right-of-Way line of US Highway 95 as Recorded in Book 869, Document Number 828092, Clark County Recorders;

Thence along said Right-of-Way line, North 17°37'54" East 117.08 feet to the most Easterly Southeast Corner of Lot One (1) as shown on the certain Map in Book 77, Page 38 of Plats, Clark County Official Records;

Thence continuing along the Westerly Right-of-Way line of Highway 95, North 17°37'54" East a distance of 467.20 feet to the Northeast Corner of said Lot One (1);

Thence along the North line of said Lot One (1) North 72°20'36" West a distance of 50.00 feet;

Thence along said North line of Lot One (1) North 89°32'53" West a distance of 219.18 feet to the True Point of Beginning;

Thence continuing along said North line of Lot One (1) North 89°32'53" West a distance of 626.30 feet;

RECEIVED  
MAR 22 2011

Thence South 00°27'07" West a distance of 15.20 feet;

Thence South 89°32'53" East a distance of 4.49 feet;

Thence South 00°27'07" West, a distance of 20.00 feet to the beginning of a non-tangent curve concave Southeasterly having a radius of 20.00 feet;

Thence Southwesterly along the said curve 31.28 feet through a central angle of 89°36'41" to the East Right-of-Way line of Tenaya Way;

Thence South 00°50'26" West along the East Right-of-Way line of Tenaya Way a distance of 98.33 feet to the beginning of a tangent curve concave Westerly having a radius of 530.00 feet;

Thence Southerly along the said curve 27.27 feet through a central angle of 2°56'53";

Thence South 03°08'59" East a distance of 57.64 feet to the beginning of a non-tangent curve concave Westerly having a radius of 540.00 feet;

Thence Southerly along the said curve 8.70 feet through a central angle of 00°55'22" to the most westerly Northwest corner of Lot Four (4) of Record of Survey as shown on the certain map in the File 115 Page 33 of Surveys, Clark County Official Records;

Thence South 82°41'57" East a distance of 17.05 feet;

Thence North 01°06'36" West a distance of 23.16 feet;

Thence South 89°32'49" East a distance of 43.90 feet;

Thence South 00°27'06" West a distance of 16.73 feet;

Thence South 89°32'22" East a distance of 135.87 feet;

Thence South 00°27'07" West a distance of 39.85 feet

Thence South 89°32'53" East a distance of 161.85 feet;

Thence South 00°27'07" West a distance of 57.89 feet;

Thence South 89°32'53" East a distance of 16.16 feet to the beginning of a tangent curve concave Southeasterly having a radius of 65.00 feet;

Thence Northeasterly along the said curve 57.02 feet through a central angle of 50°15'44"

COPY

Thence North 50°42'49" East a distance of 235.70 feet to the beginning of a tangent curve concave Northwesterly having a radius of 180.26 feet;

Thence Northeasterly along the said curve 71.93 feet through a central angle of 22°51'47";

Thence North 16°49'39" East a distance of 82.99 feet to the True Point of Beginning.

Said Parcel contains 3.42 acres, more or less.

Also known as Lot Five (5) of that Record of Survey in File 151, Page 74 Official Records, Clark County, Nevada.

**SUBJECT TO:** 1. Taxes for the fiscal year.  
2. Rights of way, reservations, restrictions, easements and conditions of record.

Together with all and singular the tenements, hereditaments and appurtenances thereunto belonging or in anywise appertaining.

Witness my/our hand(s) this 21<sup>st</sup> day of October, 2005.

CRAIG I-95 LLC

By: Bruce Galloway  
BRUCE GALLOWAY, MANAGER

By: \_\_\_\_\_  
RICHARD ENGEL, MANAGER

SIGNED IN COUNTERPARTS

COPY

STATE OF ~~NEVADA~~ <sup>WASHINGTON</sup>  
COUNTY OF CLARK } SS  
~~CLATSOP~~ <sup>KITSAP</sup>

This instrument was acknowledged before me on 10-21-05  
by: Bruce C. Galloway

[Signature]  
Notary Public in and for said County and State

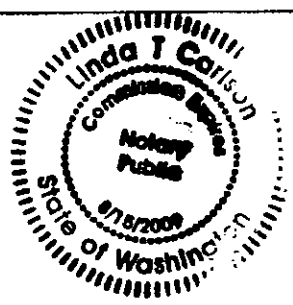

Thence North 50°42'49" East a distance of 235.70 feet to the beginning of a tangent curve concave Northwesterly having a radius of 180.26 feet;

Thence Northeasterly along the said curve 71.93 feet through a central angle of 22°51'47";

Thence North 16°49'39" East a distance of 82.99 feet to the True Point of Beginning.

Said Parcel contains 3.42 acres, more or less.

Also known as Lot Five (5) of that Record of Survey in File 151, Page 74 Official Records, Clark County, Nevada.

**SUBJECT TO:** 1. Taxes for the fiscal year.  
2. Rights of way, reservations, restrictions, easements and conditions of record.

Together with all and singular the tenements, hereditaments and appurtenances thereunto belonging or in anywise appertaining.

Witness my/our hand(s) this 21 day of October, 2005.

CRAIG I-95 LLC

By: \_\_\_\_\_  
BRUCE GALLOWAY, MANAGER

By: [Signature]  
RICHARD ENGEL, MANAGER

SIGNED IN COUNTERPARTS

DUPLICATE COPY

STATE OF NEVADA }  
COUNTY OF CLARK } SS

This instrument was acknowledged before me on Oct. 21, 2005  
by: Richard Engel

[Signature]  
Notary Public in and for said County and State



**STATE OF NEVADA  
DECLARATION OF VALUE**

1. Assessors Parcel Number(s)

- a) 138-03-611-006 PORTION
- b) \_\_\_\_\_
- c) \_\_\_\_\_
- d) 9

2. Type of Property:

- a)  Vacant Land
- b)  Single Fam. Res.
- c)  Condo/Twnhse
- d)  2-4 Plex
- e)  Apt. Bldg
- f)  Comm'l/Ind'l
- g)  Agricultural
- h)  Mobile Home
- Other:

FOR RECORDER'S OPTIONAL USE ONLY	
Book: _____	Page: _____
Date of Recording: _____	
Notes: _____	

3. Total Value/Sales Price of Property	\$	<u>2,425,000.00</u>
Deed in Lieu of Foreclosure Only (value of property)		<u>0</u>
Transfer Tax Value	\$	<u>2,425,000.00</u>
Real Property Transfer Tax Due	\$	<u>12,367.50</u>

4. IF EXEMPTION CLAIMED:

- a. Transfer Tax Exempt per NRS 375.090 Section \_\_\_\_\_
- b. Explain Reason for Exemption: \_\_\_\_\_

5. Partial Interest: Percentage being Transferred: 50%

The undersigned declares and acknowledges, under penalty of perjury, pursuant to NRS 375.060 and NRS 375.110, that the information provided is correct to the best of their information and belief, and can be supported by documentation if called upon to substantiate the information provided herein. Furthermore, the parties agree that disallowance of any claimed exemption or other determination of additional tax due, may result in a penalty of 10% of the tax due plus interest at 1% per month. Pursuant to NRS 375.030, the Buyer and Seller shall be jointly and severally liable for any additional amount owed.

Signature: \_\_\_\_\_ Capacity: \_\_\_\_\_

Signature: [Signature] Capacity: Grantor

**SELLER (GRANTOR) INFORMATION (REQUIRED)**

Print Name: CRAIG I-95 LLC  
 Address: 9440 Santa Monica  
 City: Beverly Hills  
 State: CA  
 Zip: 90210  
 Telephone: \_\_\_\_\_

**BUYER (GRANTEE) INFORMATION (REQUIRED)**

Print Name: Shree Ganesha, Inc  
 Address: 700 E. Fremont St  
 City: LAS VEGAS NV  
 State: NV  
 Zip: 89101  
 Telephone: 702-255-7643

**COMPANY/PERSON REQUESTING RECORDING (required if not seller or buyer)**

Print Name: NATIONAL TITLE CO. Escrow #: 260054-DJ  
 Address: 7251 W. LAKE MEAD STE 350  
 City: Las Vegas State: NV Zip: 89128

**AN ADDITIONAL RECORDING FEE OF \$1.00 WILL APPLY FOR EACH DECLARATION OF VALUE FORM PRESENTED TO CLARK COUNTY, EFFECTIVE JUNE 1, 2004.**

5653

**STATE OF NEVADA  
DECLARATION OF VALUE**

**1. Assessors Parcel Number(s)**

- a) 138-03-611-006 PORTION
- b) \_\_\_\_\_
- c) \_\_\_\_\_
- d) \_\_\_\_\_

**2. Type of Property:**

- a)  Vacant Land
- b)  Single Fam. Res.
- c)  Condo/Twnhse
- d)  2-4 Plex
- e)  Apt. Bldg
- f)  Comm'l/Ind'l
- g)  Agricultural
- h)  Mobile Home
- Other: \_\_\_\_\_

FOR RECORDER'S OPTIONAL USE ONLY	
Book: _____	Page: _____
Date of Recording: _____	
Notes: _____	

- 3. Total Value/Sales Price of Property** \$ \_\_\_\_\_ 2,425,000.00
- Deed in Lieu of Foreclosure Only (value of property)** \$ \_\_\_\_\_ 0
- Transfer Tax Value** \$ \_\_\_\_\_ 2,425,000.00
- Real Property Transfer Tax Due** \$ \_\_\_\_\_ 12,367.50

**4. IF EXEMPTION CLAIMED:**

- a. Transfer Tax Exempt per NRS 375.090 Section \_\_\_\_\_
- b. Explain Reason for Exemption: \_\_\_\_\_

**5. Partial Interest: Percentage being Transferred: %** 0%

The undersigned declares and acknowledges, under penalty of perjury, pursuant to NRS 375.060 and NRS 375.110, that the information provided is correct to the best of their information and belief, and can be supported by documentation if called upon to substantiate the information provided herein. Furthermore, the parties agree that disallowance of any claimed exemption or other determination of additional tax due may result in a penalty of 10% of the tax due plus interest at 1% per month. Pursuant to NRS 375.010, the Buyer and Seller shall be jointly and severally liable for any additional amount owed.

Signature: [Signature] Capacity: Grantor

Signature: \_\_\_\_\_ Capacity: \_\_\_\_\_

**SELLER (GRANTOR) INFORMATION (REQUIRED)**

Print Name: CRAIG I-95 LLC

Address: 4440 Santa Monica Blvd

City: Beverly Hills

State: CA

Zip: 90210

Telephone: \_\_\_\_\_

**BUYER (GRANTEE) INFORMATION (REQUIRED)**

Print Name: Shree Ganesha, Inc

Address: 700 E. Fremont St.

City: Las Vegas

State: NV

Zip: 89101

Telephone: \_\_\_\_\_

**COMPANY/PERSON REQUESTING RECORDING (required if not seller or buyer)**

Print Name: NATIONAL TITLE CO. Escrow #: 260054-DJ

Address: 7251 W. LAKE MEAD STE 350

City: Las Vegas State: NV Zip: 89128

**AN ADDITIONAL RECORDING FEE OF \$1.00 WILL APPLY FOR EACH DECLARATION OF VALUE FORM PRESENTED TO CLARK COUNTY, EFFECTIVE JUNE 1, 2004.**

5653

**STATE OF NEVADA  
DECLARATION OF VALUE**

1. Assessors Parcel Number(s)

- a) 138-03-611-006 PORTION
- b) \_\_\_\_\_
- c) \_\_\_\_\_
- d) \_\_\_\_\_

2. Type of Property:

- a)  Vacant Land
- b)  Single Fam. Res.
- c)  Condo/Twnhse
- d)  2-4 Plex
- e)  Apt. Bldg
- f)  Comm'v/Ind'l
- g)  Agricultural
- h)  Mobile Home
- Other: \_\_\_\_\_

FOR RECORDER'S OPTIONAL USE ONLY	
Book: _____	Page: _____
Date of Recording: _____	
Notes: _____	

3. Total Value/Sales Price of Property \$ 2,425,000.00  
 Deed in Lieu of Foreclosure Only (value of property) \_\_\_\_\_  
 Transfer Tax Value \$ 2,425,000.00  
 Real Property Transfer Tax Due \$ 12,367.50

4. IF EXEMPTION CLAIMED:

- a. Transfer Tax Exempt per NRS 375.090 Section \_\_\_\_\_
- b. Explain Reason for Exemption: \_\_\_\_\_

5. Partial Interest: Percentage being Transferred: 20%

The undersigned declares and acknowledges, under penalty of perjury, pursuant to NRS 375.060 and NRS 375.110, that the information provided is correct to the best of their information and belief, and can be supported by documentation if called upon to substantiate the information provided herein. Furthermore, the parties agree that disallowance of any claimed exemption or other determination of additional tax due, may result in a penalty of 10% of the tax due plus interest at 1% per month. Pursuant to NRS 375.030, the Buyer and Seller shall be jointly and severally liable for any additional amount owed.

Signature: [Signature] Capacity: Member - Seller  
 Signature: \_\_\_\_\_ Capacity: \_\_\_\_\_

**SELLER (GRANTOR) INFORMATION (REQUIRED)**

Print Name: CRAIG I-95 LLC  
 Address: 9440 Santa Monica Blvd #706  
 City: Beverly Hills  
 State: CA  
 Zip: 90210  
 Telephone: ~~310-200-3100~~ 310-275-9831

**BUYER (GRANTEE) INFORMATION (REQUIRED)**

Print Name: Shree Ganesha, Inc  
 Address: 700 E. Fremont St.  
 City: Las Vegas  
 State: NV  
 Zip: 89101  
 Telephone: \_\_\_\_\_

**COMPANY/PERSON REQUESTING RECORDING (required if not seller or buyer)**

Print Name: NATIONAL TITLE CO. Escrow #: 260054-DJ  
 Address: 7251 W. LAKE MEAD STE 350  
 City: Las Vegas State: NV Zip: 89128

**AN ADDITIONAL RECORDING FEE OF \$1.00 WILL APPLY FOR EACH DECLARATION OF VALUE FORM PRESENTED TO CLARK COUNTY, EFFECTIVE JUNE 1, 2004.**

5653

**SHREE GANESHA, INC.**

<b>Business Entity Information</b>			
Status:	Active	File Date:	10/07/1998
Type:	Domestic Corporation	Entity Number:	C23608-1998
Qualifying State:	NV	List of Officers Due:	10/31/2011
Managed By:		Expiration Date:	
NV Business ID:	NV19981349886	Business License Exp:	10/31/2011

<b>Registered Agent Information</b>			
Name:	RAJESH K. PATEL	Address 1:	1500 CHAMBOLLE CT
Address 2:		City:	LAS VEGAS
State:	NV	Zip Code:	89144
Phone:		Fax:	
Mailing Address 1:		Mailing Address 2:	
Mailing City:		Mailing State:	
Mailing Zip Code:			
Agent Type:	Noncommercial Registered Agent		

<b>Financial Information</b>			
No Par Share Count:	25,000.00	Capital Amount:	\$ 0
<b>No stock records found for this company</b>			

<b>Officers</b>				<input type="checkbox"/> Include Inactive Officers
<b>Secretary - KAMALESH K PATEL</b>				
Address 1:	1500 CHAMBOLLE CT	Address 2:		
City:	LAS VEGAS	State:	NV	
Zip Code:	89144	Country:		
Status:	Active	Email:		
<b>Director - KAMALESH K PATEL</b>				
Address 1:	1500 CHAMBOLLE CT	Address 2:		
City:	LAS VEGAS	State:	NV	
Zip Code:	89144	Country:		
Status:	Active	Email:		
<b>President - KANAIYALAL N PATEL</b>				
Address 1:	1500 CHAMBOLLE CT.	Address 2:		
City:	LAS VEGAS	State:	NV	
Zip Code:	89144	Country:		
Status:	Active	Email:		
<b>Treasurer - RAJESH K PATEL</b>				
Address 1:	1500 CHAMBOLLE CT	Address 2:		
City:	LAS VEGAS	State:	NV	
Zip Code:	89144	Country:		
Status:	Active	Email:		

<b>Actions\Amendments</b>	
Action Type:	Articles of Incorporation

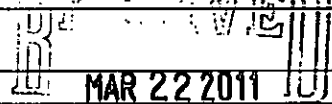

MAR 22 2011