

**NOTES**

This map is for assessment use only and does NOT represent a survey. No liability is assumed for the accuracy of the data delineated herein. Information on roads and other non-assessed parcels may be obtained from the Road Document Listing in the Assessor's Office.

This map is compiled from official records, including surveys and deeds, but only contains the information required for assessment. See the recorded documents for more detailed legal information.

USE THIS SCALE (FEET) WHEN MAP REDUCED FROM 11x17 ORIGINAL

8 50 100 200 400 600

**MAP LEGEND**

- PARCEL BOUNDARY 551
- SUBD BOUNDARY 1.55
- ROAD EASEMENT 202
- PW/LD BOUNDARY PB 23-45
- NON-PARCEL LOT LINE 5
- MATCH LINE / LEADER LINE 5
- ROAD ID NUMBER 001
- PARCEL NUMBER ACREAGE 551
- PARCEL SUB/SEC NUMBER PLAT RECORDING NUMBER 202
- BLOCK NUMBER 5
- LOT NUMBER 5
- GOV. LOT NUMBER 015

**ASSessor's PARCELS - CLARK CO., NV.**  
M. W. Schofield, Assessor

T20S R60E 32 S 2 SE 4 138-32-8

R59E	R60E	R61E
126	125	124
137	138	139
164	163	162

4	3	4	3	7	1
2	8	9	10	11	12
16	17	18	13	14	15
19	28	21	22	23	29
30	29	28	27	25	25
31	37	33	34	35	34

Scale: 1"=200' Rev: 06/29/05

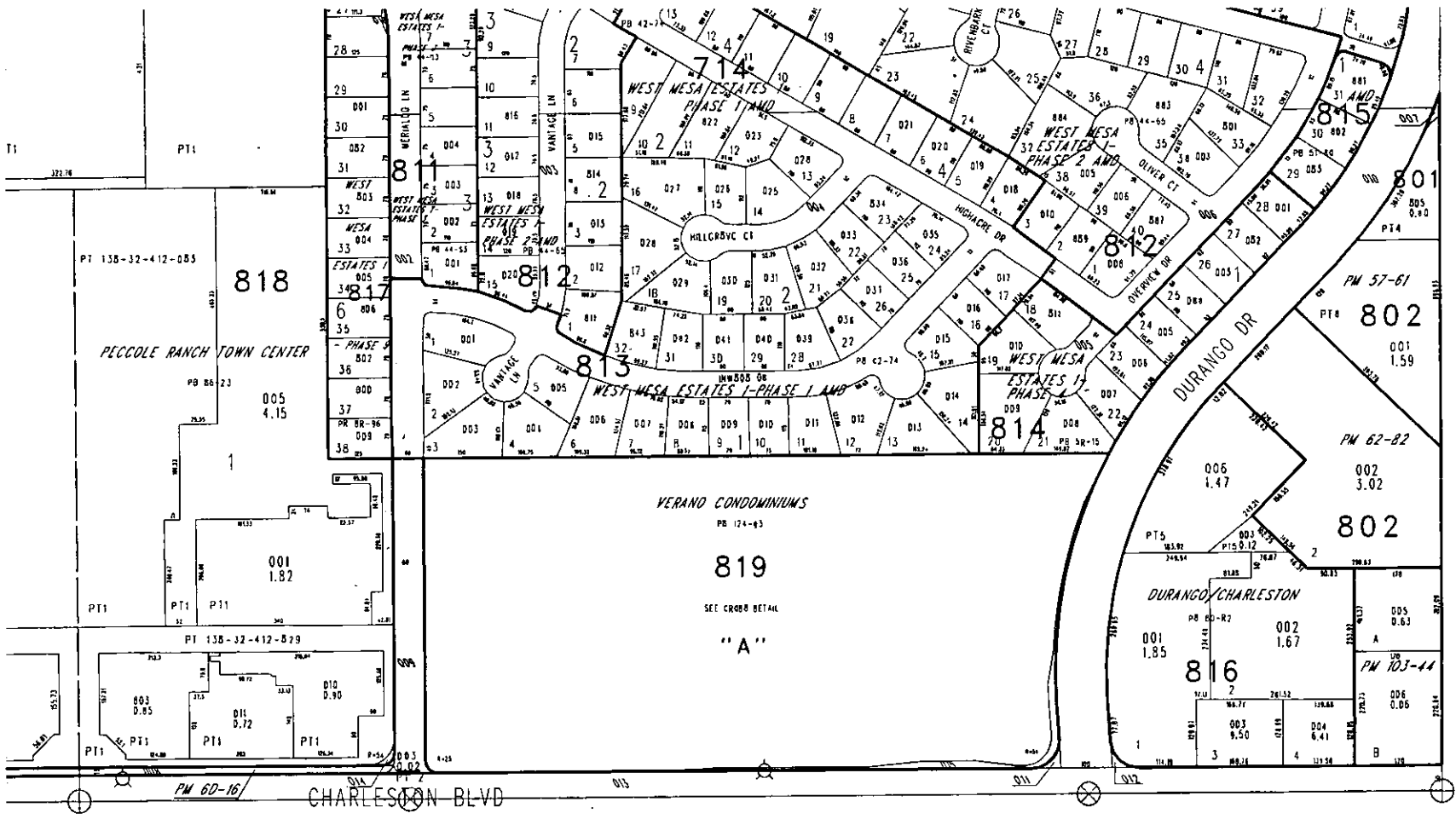

930202

00909

SURVEY  
FILE 65 AGE 50

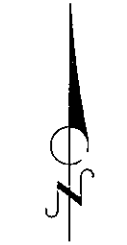
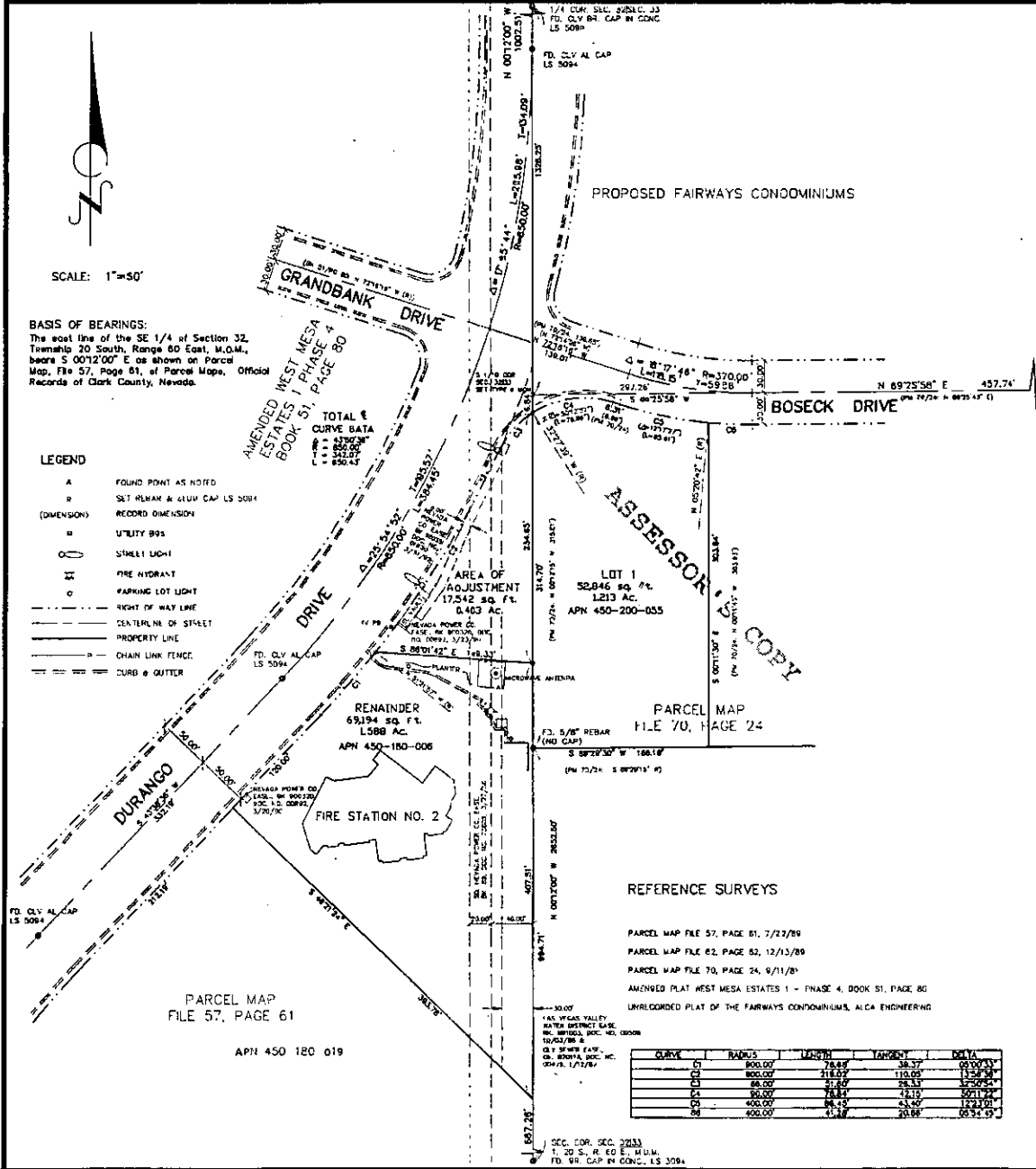

SCALE: 1"=50'

**BASIS OF BEARINGS:**  
The east line of the SE 1/4 of Section 32, Township 20 South, Range 60 East, M.D.M., bears S 00°12'00" E as shown on Parcel Map, File 57, Page 61, of Parcel Maps, Official Records of Clark County, Nevada.

- LEGEND**
- A FOUND POINT AS NOTED
  - SET IRON & CUM CAP LS 5084
  - (DIMENSION) REDDED DIMENSION
  - UTILITY BNS
  - STREET LIGHT
  - FIRE HYDRANT
  - PARKING LOT LIGHT
  - RIGHT OF WAY LINE
  - CENTERLINE OF STREET
  - PROPERTY LINE
  - CHAIN LINK FENCE
  - CURB & GUTTER

**REFERENCE SURVEYS**

- PARCEL MAP FILE 57, PAGE 61, 7/23/89
- PARCEL MAP FILE 62, PAGE 62, 12/13/89
- PARCEL MAP FILE 70, PAGE 24, 9/11/87
- AMENDED PLAT WEST MESA ESTATES 1 - PHASE 4, BOOK 51, PAGE 80
- UNRECORDED PLAT OF THE FAIRWAYS CONDOMINIUMS, ALCA ENGINEERING

CURVE	RADIUS	LENGTH	TANGENT	DATA
C1	800.00'	218.22'	38.27'	02°00'00"
C2	800.00'	218.22'	110.00'	02°00'00"
C3	800.00'	218.22'	28.33'	12°00'00"
C4	800.00'	218.22'	28.33'	02°00'00"
C5	400.00'	109.11'	28.33'	02°00'00"
C6	400.00'	109.11'	28.33'	02°00'00"

**OWNER'S CERTIFICATE**

THE CITY OF LAS VEGAS, NEVADA, by and through its Mayor and City Council, do hereby certify that being the owners of the lands as shown hereon, have caused a Boundary Line Adjustment Survey to be performed as indicated hereon and that we have examined and approved this plat and content to and authorize the recording of same. Further, we agree to prepare and execute the required documents creating any and all easements as shown hereon and to execute all required documentation abridging any existing easements affecting the lands shown pursuant to the provisions of NRS 278.010 through 278.030, inclusive, based on the error of adjustment on exempt.

THE CITY OF LAS VEGAS, NEVADA  
*Jan Lavery Jones*  
 JAN LAVERTY JONES, MAYOR  
*Kathleen M. Tigue*  
 KATHLEEN M. TIGUE, CITY CLERK

**NOTARY ACKNOWLEDGEMENT**

STATE OF NEVADA  
 COUNTY OF CLARK  
 On this 24 day of APRIL, 1992, Jan Lavery Jones and Kathleen M. Tigue personally appeared before me, a Notary Public, and acknowledged to me that they executed the above instrument.

*Joanna C. Barriello*  
 JOANNA C. BARRIELLO, NOTARY PUBLIC IN AND FOR SAID STATE

STATE OF NEVADA  
 COUNTY OF CLARK

On this 04 day of October, 1992, *Joanna C. Barriello* appeared before me, a Notary Public, and acknowledged to me that she executed the above instrument.

*Joanna C. Barriello*  
 JOANNA C. BARRIELLO, NOTARY PUBLIC IN AND FOR SAID STATE

**SURVEYOR'S CERTIFICATE**

I, Rich M. Lunick, a Professional Land Surveyor registered in the State of Nevada, do hereby certify that this map is a true and accurate representation of a survey made by me or under my direct supervision of the boundaries of the parcels as shown hereon of the parcel of the City of Las Vegas, Nevada, and that the survey was completed on March 21, 1992, in conformance with the provisions of NRS 278.010 through 278.030, inclusive, and NRS 625.010 through 625.580, inclusive, as indicated. This survey is not a subdivision.

RICH M. LUNICK, PLS  
 Nevada Certificate No. 5084

**APPROVAL**

This map has been approved for the purpose of Boundary Line Adjustment in accordance with the provisions of NRS 278.010 through 278.030, inclusive, this 27th day of APRIL, 1992.

*Norman R. Stenderfer*  
 Norman R. Stenderfer, Director  
 Department of Community Planning & Development

NOTE: ANY SUBSEQUENT CHANGES TO THIS MAP SHOULD BE EXAMINED AND MAY BE DETERMINED BY REFERENCE TO THE COUNTY RECORDER'S CUMULATIVE MAP INDEX (NVS 278.020)

<b>RECORD OF SURVEY</b> <b>BOUNDARY LINE ADJUSTMENT</b> CITY OF LAS VEGAS TO SCHNIPPEL TRUST POR OF PARCEL 4 OF PM FILE 57, PAGE 61 IN THE SE 1/4 SE 1/4 SEC. 32, T20S, R60E, M0M CITY OF LAS VEGAS, NEVADA		FILE NO. <u>00909</u> FILED AT THE REQUEST OF THE CITY OF LAS VEGAS DATE <u>02-02-93</u> AT <u>12:11</u> FILE <u>065</u> PAGE <u>0050</u>
DRAWN BY: <u>mm</u> CHECKED BY: <u>WUNKE</u> DATE: <u>MARCH 1992</u>	OFFICIAL RECORDS BOOK NO. <u>12249</u> CLARK COUNTY, NEVADA, RECORDS JOHN L. SMYTH, RECORDER FEE <u>10.00</u> DEPUTY <u>5.00</u>	

REZONING Parcel: 138-32-802-001

ZON - 40496

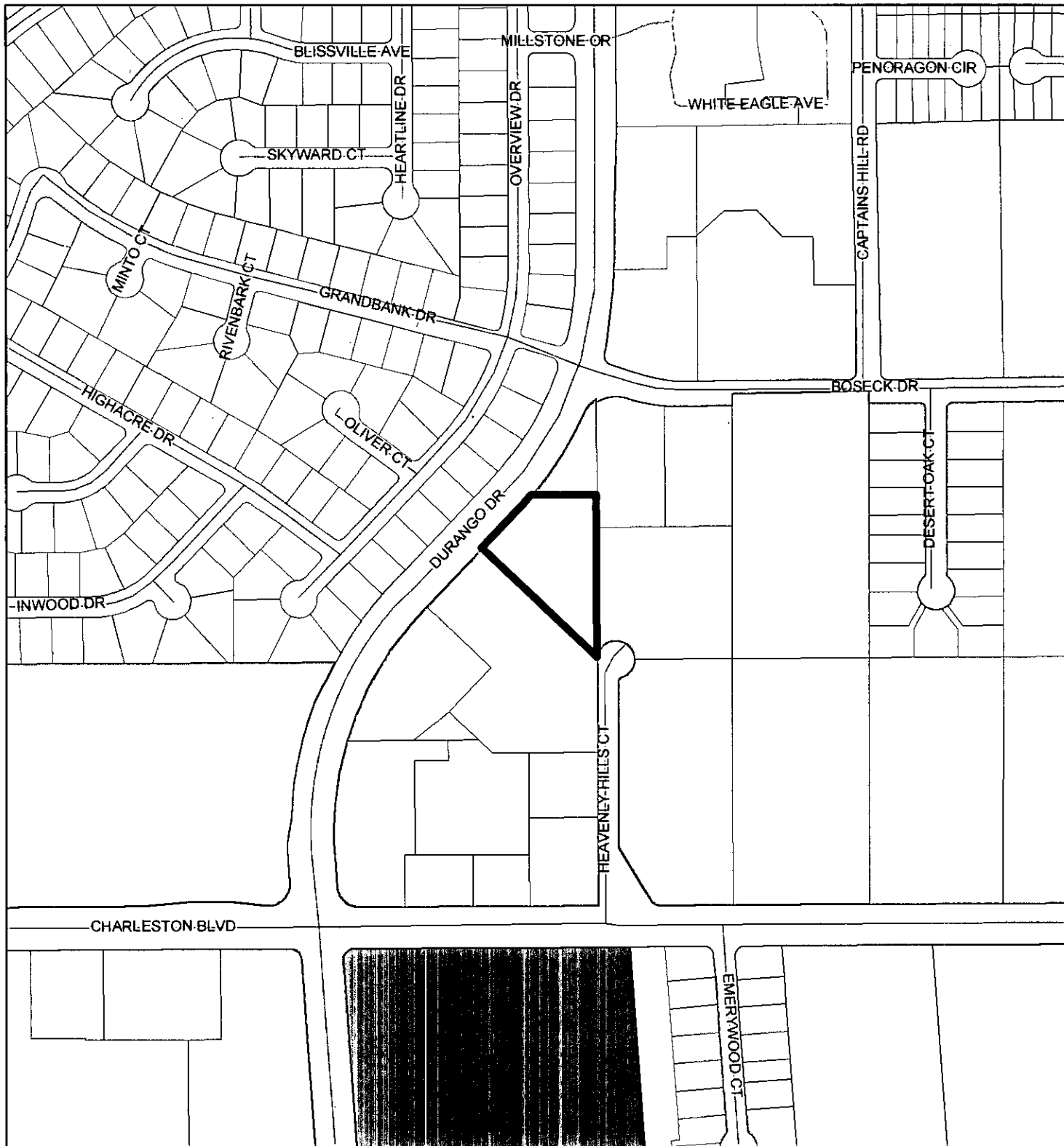

**ZONING**

C-V	R-MH	R-3	O	C-2
C-PB	R-CL	R-4	C-D	C-M
P-C	R-2	R-5	C-1	M
U	R-D	R-MHP	PD	Subject Parcel
R-A	R-PD	P-R	T-D	City Limits
R-E	R-1	N-S	TC	ROI Zoning

FROM C-1 TO C-V



GIS maps are normally produced only to meet the needs of the City. Due to continuous development activity this map is for reference only. Geographic Information System Planning & Development Dept. 702-229-6301



Printed: December 17, 2010

City of Las Vegas  
Planning & Development Department  
Development Services Center  
333 North Rancho Drive, 3<sup>rd</sup> Floor  
Las Vegas, Nevada 89107

**Return Service Requested  
Official Notice of Public Hearing**

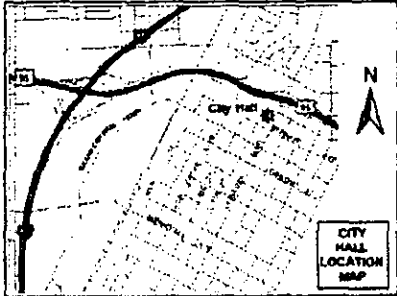

If you wish to file your protest or support on this request, check the appropriate box below and return this card in an envelope with postage to the Planning & Development Department at the address listed above or fax this side of this card to (702) 385-7268. If you would like to contact your Council Representative, please call (702) 229-6405.



I SUPPORT  
this Request



I OPPOSE  
this Request

Please use available blank space on card for your comments.

**ZON-40496**

Planning Commission Meeting of 2/8/2011

PRESORTED  
FIRST CLASS



UNITED STATES POSTAGE  
02 1M  
0004279218  
\$ 00.41<sup>4</sup>  
JAN 27 2011  
MAILED FROM ZIP CODE 89101

Case: ZON-40496  
13832713013  
JACKSON NANCY E  
3905 BRANCHWOOD DR  
NO LAS VEGAS NV 89032-0192

48 KRDFN11 89032



RECEIVED

JAN 31 2011

8A

**APPLICATION PACKET**

<input checked="" type="checkbox"/>	<input type="checkbox"/>	Signed and notarized by <i>all</i> property owners or authorized agent(s)	<b>NOTES:</b> Visit the City's website for blank application, SOFI, and DINA forms @ <a href="http://www.lasvegasnevada.gov/">http://www.lasvegasnevada.gov/</a> (Follow - "I Want To..." --> "Apply for -> Planning Applications")
<input checked="" type="checkbox"/>	<input type="checkbox"/>	Grant deed and legal description	
<input checked="" type="checkbox"/>	<input type="checkbox"/>	<i>Detailed</i> justification letter	
<input checked="" type="checkbox"/>	<input type="checkbox"/>	Reduced 8.5" x 11" copy of <i>all</i> plans and elevations	
<input checked="" type="checkbox"/>	<input type="checkbox"/>	Full size, rolled, color copy of <i>all</i> plans and elevations	
<input checked="" type="checkbox"/>	<input type="checkbox"/>	Correct fee(s): \$ 700.00 + \$ 500.00 + \$ - = \$ 1,200.00 Total	
<input checked="" type="checkbox"/>	<input type="checkbox"/>	Statement of Financial Interest (SOFI)	
<input checked="" type="checkbox"/>	<input type="checkbox"/>	Assessor's Parcel Map	
<input type="checkbox"/>	<input checked="" type="checkbox"/>	Development Impact Notice and Assessment (DINA)	
<input type="checkbox"/>	<input checked="" type="checkbox"/>	Project of Regional Significance	
<input type="checkbox"/>	<input checked="" type="checkbox"/>	Color & Materials Board per Site Development Plan Review Submittal Requirements	City initiated application.

**SITE PLAN**

<input checked="" type="checkbox"/>	<input type="checkbox"/>	11" x 17" min. to 24" x 36" max. page size	Folded Plans: <u>6</u>
<input checked="" type="checkbox"/>	<input type="checkbox"/>	North arrow, scale, and vicinity map	Colored, Rolled Plans: <u>1</u>
<input checked="" type="checkbox"/>	<input type="checkbox"/>	<i>All</i> property lines and present dimensions labeled	<b>NOTES:</b> Location map to be submitted.
<input type="checkbox"/>	<input checked="" type="checkbox"/>	<i>All</i> building setbacks labeled	
<input checked="" type="checkbox"/>	<input type="checkbox"/>	<i>All</i> adjacent existing land uses and street names labeled	
<input type="checkbox"/>	<input checked="" type="checkbox"/>	<i>All</i> points of ingress and egress shown	
<input type="checkbox"/>	<input checked="" type="checkbox"/>	ADA accessibility requirements shown/labeled	
<input type="checkbox"/>	<input checked="" type="checkbox"/>	Parking standard(s) utilized:	
<input type="checkbox"/>	<input checked="" type="checkbox"/>	Parking space count and typical dimensions labeled	
<input type="checkbox"/>	<input checked="" type="checkbox"/>	#regular + #compact + #handicap = Total	
<input type="checkbox"/>	<input checked="" type="checkbox"/>	<i>All</i> free-standing sign locations shown and heights and sizes noted	

**LANDSCAPE PLAN**

<input type="checkbox"/>	<input checked="" type="checkbox"/>	11" x 17" min. to 24" x 36" max. page size	Folded Plans: <u>0</u>
<input type="checkbox"/>	<input checked="" type="checkbox"/>	North arrow, scale, and vicinity map	Colored, Rolled Plans: <u>0</u>
<input type="checkbox"/>	<input checked="" type="checkbox"/>	<i>All</i> property lines and present dimensions labeled	<b>NOTES:</b>
<input type="checkbox"/>	<input checked="" type="checkbox"/>	<i>All</i> required perimeter landscape planters shown	
<input type="checkbox"/>	<input checked="" type="checkbox"/>	<i>All</i> required parking lot fingers/islands shown	
<input type="checkbox"/>	<input checked="" type="checkbox"/>	Quantity, size, species/variety of <i>all</i> trees, shrubs, and ground cover	

**BUILDING ELEVATIONS**

<input type="checkbox"/>	<input checked="" type="checkbox"/>	11" x 17" min. to 24" x 36" max. page size	Folded Plans: <u>0</u>
<input type="checkbox"/>	<input checked="" type="checkbox"/>	Scale and building dimensions labeled	Colored, Rolled Plans: <u>0</u>
<input type="checkbox"/>	<input checked="" type="checkbox"/>	North, south, east, and west elevations of <i>all</i> buildings	<b>NOTES:</b>
<input type="checkbox"/>	<input checked="" type="checkbox"/>	<i>All</i> building materials and colors noted	
<input type="checkbox"/>	<input checked="" type="checkbox"/>	8" x 10" photo of original color and material board	
<input type="checkbox"/>	<input checked="" type="checkbox"/>	<i>All</i> wall sign locations shown and sizes noted	

**FLOOR PLANS**

<input type="checkbox"/>	<input checked="" type="checkbox"/>	11" x 17" min. to 24" x 36" max. page size	Folded Plans: <u>0</u>
<input type="checkbox"/>	<input checked="" type="checkbox"/>	Scale and building dimensions labeled	Rolled Plans: <u>0</u>
<input type="checkbox"/>	<input checked="" type="checkbox"/>	<i>All</i> building entrances/exits shown	<b>NOTES:</b>
<input type="checkbox"/>	<input checked="" type="checkbox"/>	Use of <i>all</i> rooms noted/labeled	
<input type="checkbox"/>	<input checked="" type="checkbox"/>	Maximum Occupancy (per I.B.C.)	
<input type="checkbox"/>	<input checked="" type="checkbox"/>	Seating Capacity (where applicable)	

THIS FORM MUST ACCOMPANY THE APPLICATION SUBMITTAL and is valid for no more than 60 days after the Pre-App date.

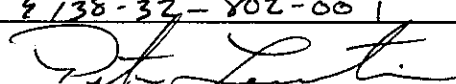
Applicant: City of Las Vegas Company: APN: 8138-32-802-001 Planner's Signature:  Planner: Peter Lowenstein	Application Type: Rezoning Application Purpose: Change zoning district from C-1 to C-V Location: Pre-App. Meeting Date: Thursday, December 16, 2010 Earliest Submittal Deadline: Thursday, December 23, 2010 Earliest PC Meeting Date: Tuesday, February 08, 2011
---	--



March 17, 2011

Mr. Peter Lowenstein  
City of Las Vegas  
Department of Planning  
333 North Rancho Drive, 3<sup>rd</sup> Floor  
Las Vegas, Nevada 89106

RE: ZON-40496 - REZONING  
CITY COUNCIL MEETING OF MARCH 16, 2011

Dear Mr. Lowenstein:

The City Council at a regular meeting held March 16, 2011, APPROVED the request for a Rezoning FROM: C-1 (LIMITED COMMERCIAL) TO: C-V (CIVIC) on 1.59 acres at 900 South Durango Drive (APN 138-32-802-001). The Notice of Final Action was filed with the Las Vegas City Clerk on March 17, 2011.

Sincerely,

  
Gabriela Portillo-Brenner  
Deputy City Clerk II for  
Beverly K. Bridges, MMC, City Clerk

LAS VEGAS CITY COUNCIL

OSCAR B. GOODMAN  
MAYOR

GARY REESE  
MAYOR PRO TEM

STEVE WOLFSON  
LOIS TARKANIAN

STEVEN D. ROSS  
RICKI Y. BARLOW

STAVROS S. ANTHONY

ELIZABETH N. FRETWELL  
CITY MANAGER

CITY OF LAS VEGAS  
400 STEWART AVENUE  
LAS VEGAS, NEVADA 89101

VOICE 702.229.6011  
TTY 702.386.9108  
[www.lasvegasnevada.gov](http://www.lasvegasnevada.gov)

FM-0044-08-09

# PLANNING & DEVELOPMENT



DEVELOPMENT SERVICES CENTER

731 S. Fourth Street  
Las Vegas, NV 89101

Voice: 702-229-6301  
Fax: 702-474-0352  
TTY: 702-386-9108

[www.lasvegasnevada.gov](http://www.lasvegasnevada.gov)

February 9, 2011

Mr. Peter Lowenstein  
City of Las Vegas  
Department of Planning  
333 North Rancho Drive, 3<sup>rd</sup> Floor  
Las Vegas, Nevada 89106

**RE: ZON-40496 - REZONING  
PLANNING COMMISSION MEETING OF FEBRUARY 8, 2011**

Dear Mr. Lowenstein:

Your request for a Rezoning FROM: C-1 (LIMITED COMMERCIAL) TO: C-V (CIVIC) on 1.59 acres at 900 South Durango Drive (APN 138-32-802-001), Ward 2 (Wolfson), was considered by the Planning Commission on February 8, 2011.

The Planning Commission voted to recommend **APPROVAL** of your request.

This item will be considered by the City Council on **March 16, 2011**, at 1:00 P.M. in the Council Chambers of City Hall, 400 Stewart Avenue, Las Vegas, Nevada. **The Council requires that you or your representative be present at this meeting.** If you or your representative chooses not to attend, the City Council may act in your absence without your input.

Sincerely,

Steve Gebeke, AICP  
Planning Supervisor  
Case Planning Division

SG:clb

Mayor:  
Oscar B. Goodman  
  
City Council  
Gary Reese  
(Mayor Pro Tem)  
Steve Wolfson  
Lais Torkanian  
Steven D. Rass  
Ricki Y. Barlow  
Stavros S. Anthony  
  
City Manager  
Elizabeth N. Fretwell





January 19, 2011

Mr. Peter Lowenstein  
City of Las Vegas  
Planning and Development Department  
731 South Fourth Street, 2nd Floor  
Las Vegas, Nevada 89101

**RE: ZON-40496 - REZONING  
PLANNING COMMISSION MEETING OF FEBRUARY 8, 2011**

Dear Mr. Lowenstein:

Please be advised the City of Las Vegas Planning Commission at its regular meeting on **February 8, 2011** as referred to above, will consider your request. This meeting will be held at 6:00 P. M. at the Council Chambers of City Hall, 400 Stewart Avenue, Las Vegas, Nevada.

A copy of staff's recommendations, any conditions related to your application and the **final agenda** will available on-line on **Wednesday, January 26, 2011** at [www.lasvegasnevada.gov](http://www.lasvegasnevada.gov). If you do not have access to the Internet and would prefer receiving hard copies of the documentation, please call the Case Planning Division at (702) 229-6301 or come into the Development Services Center at 333 North Rancho Drive to request your copies.

The Planning Commission requires that you or your representative be present at this meeting.

Sincerely,

A handwritten signature in black ink, appearing to read "Steve Gebeke", with a long horizontal line extending to the right.

Steve Gebeke, AICP  
Planning Supervisor  
Case Planning Division

SG:clb

LAS VEGAS CITY COUNCIL

OSCAR B. GOODMAN  
MAYOR

GARY REESE  
MAYOR PRO TEM

STEVE WOLFSON

LOIS TARKANIAN

STEVEN D. ROSS

RICKI Y. BARLOW

STAVROS S. ANTHONY

ELIZABETH N. FRETWELL  
CITY MANAGER

CITY OF LAS VEGAS  
400 STEWART AVENUE  
LAS VEGAS, NEVADA 89101

VOICE 702.229.6011  
TTY 702.386.9108  
[www.lasvegasnevada.gov](http://www.lasvegasnevada.gov)

FM-0044-08-09



# CITY OF LAS VEGAS SIGN POSTING AFFIDAVIT



**CASE NUMBER:** ZON-40496

**MEETING DATE:** 02/08/11 PC

Sign Pro does hereby certify that a notice as required by Chapter 19.18.010(D) of the Zoning Code, was visibly posted for a period of not less than ten (10) calendar days prior to the first scheduled hearing.

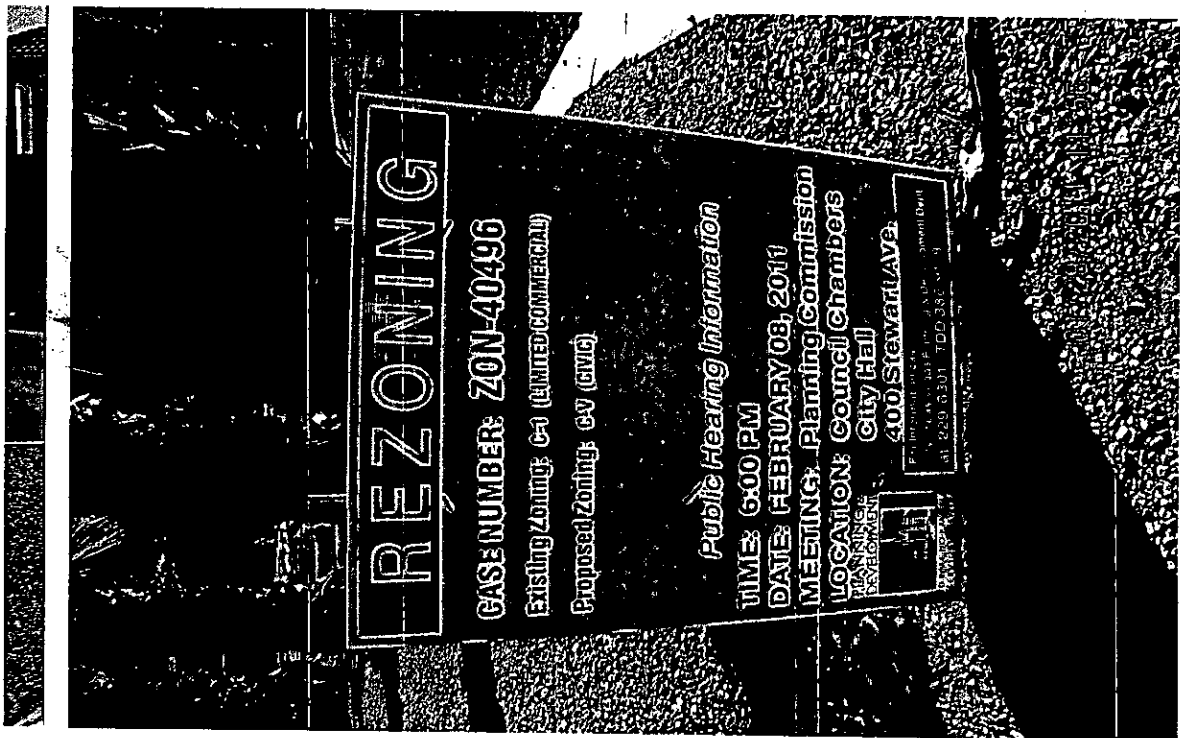

[Signature]  
Signature

1-28-11  
Date

This affidavit must be returned to the Planning and Development Department, Case Planning Division, at 333 North Rancho Drive, 3<sup>rd</sup> Floor during regular business hours three (3) business days prior to the subject application being heard by the Planning Commission or City Council.



**CASE 1**

**MEET**

**Sign Pro**  
Code, wa  
scheduled



  
Signature

1-28-11  
Date

This affidavit must be returned to the Planning and Development Department, Case Planning Division, at 333 North Rancho Drive, 3<sup>rd</sup> Floor during regular business hours three (3) business days prior to the subject application being heard by the Planning Commission or City Council.

## Application Information

**ZON-40496 - REZONING - PUBLIC HEARING - APPLICANT/OWNER: CITY OF LAS VEGAS - Request for a Rezoning FROM: C-1 (LIMITED COMMERCIAL) TO: C-V (CIVIC) on 1.59 acres at 900 South Durango Drive (APN 138-32-802-001), Ward 2 (Wolfson).**

## Application Location

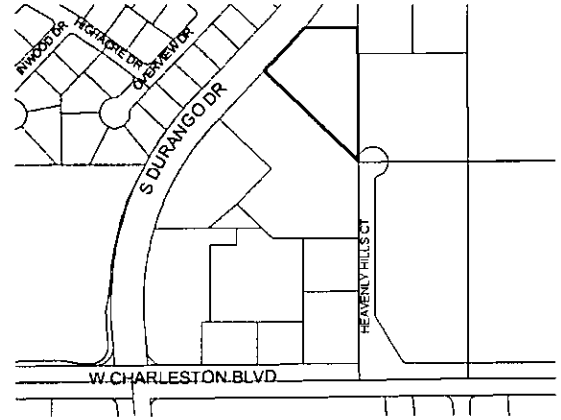

The proposed project may not pertain to the entire highlighted project site.

## Public Hearing Information

**Meeting:** Planning Commission  
**Date:** *February 08, 2011*  
**Time:** 6:00 P.M.  
**Location:** City Council Chambers  
400 Stewart Avenue  
Las Vegas, Nevada

Any and all interested persons may appear before the City Planning Commission either in person or by representative and object to or express approval of this request; or may, prior to this meeting, file a written objection thereto or approval thereof with the Planning and Development Department, Development Services Center, 333 North Rancho Drive, 3<sup>rd</sup> Floor, Las Vegas, Nevada 89107. Final Action on General Plan Amendments and Rezonings will be determined by the City Council. Other public hearing items may be deemed Final Action by the Planning Commission or forwarded to the City Council. The date of the City Council meeting, if applicable, will be announced at the Planning Commission meeting after the discussion of the item. For further information, including the full staff report, please call (702) 229-6301 (TDD 386-9108) or go to <http://www.lasvegasnevada.gov>.

## Application Information

**ZON-40496 - REZONING - PUBLIC HEARING - APPLICANT/OWNER: CITY OF LAS VEGAS - Request for a Rezoning FROM: C-1 (LIMITED COMMERCIAL) TO: C-V (CIVIC) on 1.59 acres at 900 South Durango Drive (APN 138-32-802-001), Ward 2 (Wolfson).**

## Application Location

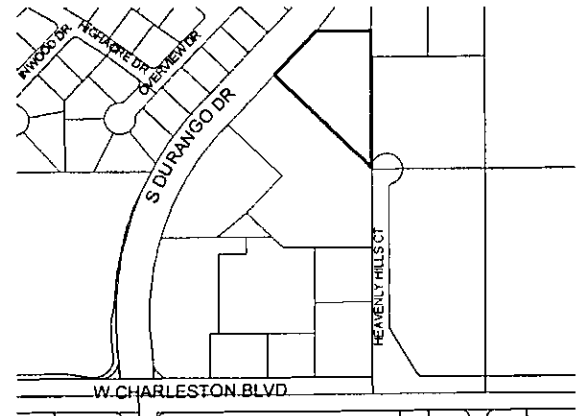

The proposed project may not pertain to the entire highlighted project site.

## Public Hearing Information

**Meeting:** Planning Commission  
**Date:** *February 08, 2011*  
**Time:** 6:00 P.M.  
**Location:** City Council Chambers  
400 Stewart Avenue  
Las Vegas, Nevada

Any and all interested persons may appear before the City Planning Commission either in person or by representative and object to or express approval of this request; or may, prior to this meeting, file a written objection thereto or approval thereof with the Planning and Development Department, Development Services Center, 333 North Rancho Drive, 3<sup>rd</sup> Floor, Las Vegas, Nevada 89107. Final Action on General Plan Amendments and Rezonings will be determined by the City Council. Other public hearing items may be deemed Final Action by the Planning Commission or forwarded to the City Council. The date of the City Council meeting, if applicable, will be announced at the Planning Commission meeting after the discussion of the item. For further information, including the full staff report, please call (702) 229-6301 (TDD 386-9108) or go to <http://www.lasvegasnevada.gov>.

City of Las Vegas  
Planning & Development Department  
Development Services Center  
333 North Rancho Drive, 3<sup>rd</sup> Floor  
Las Vegas, Nevada 89107



**Return Service Requested**  
**Official Notice of Public Hearing**

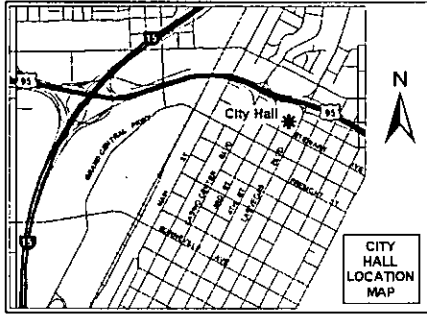

If you wish to file your protest or support on this request, check the appropriate box below and return this card in an envelope with postage to the Planning & Development Department at the address listed above or fax this side of this card to (702) 385-7268. If you would like to contact your Council Representative, please call (702) 229-6405.

I SUPPORT  
this Request

I OPPOSE  
this Request

Please use available blank space on card for your comments.

**ZON-40496**

Planning Commission Meeting of 2/8/2011

City of Las Vegas  
Planning & Development Department  
Development Services Center  
333 North Rancho Drive, 3<sup>rd</sup> Floor  
Las Vegas, Nevada 89107

**Return Service Requested**  
**Official Notice of Public Hearing**

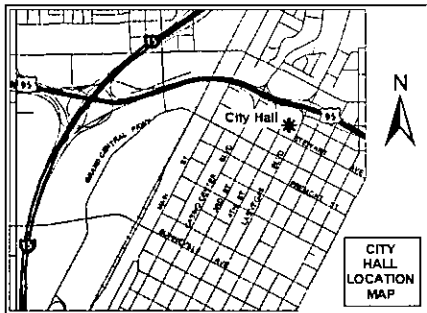

If you wish to file your protest or support on this request, check the appropriate box below and return this card in an envelope with postage to the Planning & Development Department at the address listed above or fax this side of this card to (702) 385-7268. If you would like to contact your Council Representative, please call (702) 229-6405.

I SUPPORT  
this Request

I OPPOSE  
this Request

Please use available blank space on card for your comments.

**ZON-40496**

Planning Commission Meeting of 2/8/2011

## **Development Notification**

PC Meeting: February 8, 2011a

---

**The following neighborhood associations are located within approximately one(1) mile of this development application and have been notified of this case by the Planning and Development Department:**

---

### **ZON-40496**

Angel Park Ranch Architectural Committee

Canyon Gate Master Association

Diamond Springs Estates HOA

Elan HOA

Fairway Pointe HOA

Lakeside Village HOA

Neighborhood Alliance NCG

Pare West Apartment Homes

Peccole Ranch Community Association

Plantea Court HOA

Queensridge Owners Association

Sycamore Estates HOA

Sycamore Square I HOA

Tuscany Hills North HOA

# Memorandum

City of Las Vegas  
Department of Public Works  
Development Coordination

**To:** Department of Planning and Development  
**From:** Bart Anderson, Manager, Development Coordination, Department of Public Works *BA*  
**CC:** Nancy Almanzan, Right-of-Way; Tom Hayes, Land Development; O. C. White, Traffic Engineering; Alan Riecki, Survey (FM, PM, & A's only)  
**Date:** January 11, 2011  
**Re:** **ZON-40496** City of Las Vegas 900 S. Durango Dr.  
Request for a Rezoning from C-1 to C-V

---

## Comments:

We have no comment on the request for a Rezoning from C-1 (LIMITED COMMERCIAL) to: C-V (CIVIC) on 1.59 acres at 900 South Durango Drive (APN 138-32-802-001), Ward 2 (Wolfson).

P/L 909/814

**Report of All Selected Parcels**

Case Number: ZON-40496

Printed On: Tue: January 4, 2011

<u>Owner</u>	<u>Address</u>	<u>Parcel Numbe</u>
		13832819000
		13833317000
		13833324000
		13833320000
		13833412000
		13833419000
1 PARC ONE L L C	5 BRADFORD PL MELVILLE NY	13832819102
1 PARC ONE L L C	5 BRADFORD PL MELVILLE NY	13832819045
1 PARC ONE L L C	5 BRADFORD PL MELVILLE NY	13832819296
1108 HOLDINGS L L C	22 INNISBROOK AVE LAS VEGAS NV	16304118016
277 EAST 10TH STREET ASSOCIATES	%L MARTINAITIS 1725 S RAINBOW #1-191 LAS VEGAS NV	13832819279
621 OVERVIEW L L C	%B BALLARD 629 NEY A TI DR GUNTERSVILLE AL	13832713014
8600 W CHARLESTON BLVD UT 2195	%P & S BARAI 21 TOLMERS RD CUFFLEY EN6 4JF UNITED KINGDOM	13832819393
ABELLERA VIRGINIA & CAESAR	2060 BEGLEY DR CORONA CA	13832819158
ABELLERA VIRGINIA & CAESAR	2060 BEGLEY DR CORONA CA	13832819215
ABELLERRA VIRGINIA & CAESAR	2060 BEGLEY DR CORONA CA	13832819151
ABREGO DANIEL S & MARTHA A	612 HEARTLINE DR LAS VEGAS NV	13832717025
ACE JACK PROPERTY L L C	%V RAJKUMAR 12345 LAKE CITY WY N E #386 SEATTLE WA	13832819346
ADAMS ERIC J	8600 CHARLESTON #2185 LAS VEGAS NV	13832819371
ADELMAN STEVEN A & ERIC A	2734 S BRAUN WY LAKEWOOD CO	13833317013
ADYMY MARGARET M	8452 BOSECK DR LAS VEGAS NV	13833317027
AFSHAR BEHZAD	51 VIA MARBRISA SAN CLEMENTE CA	13833317049
AGAPI ENTERPRISES L L C	321 LAKE WINDEMERE ST LAS VEGAS NV	13832819038
AGAYAN JOHN & MONIKA	16808 LOS ALIMOS ST GRANADA HILLS CA	13832819039
AHUNCAIN PIERRE L	8425 RUNNING DEER AVE #103 LAS VEGAS NV	13833320071
AIKEN PEARL REVOCABLE LIVING TR	509 INDIAN BLUFF ST #102 LAS VEGAS NV	13833320022
AJAMIAN VAHAN	25 THE ESPLANADE #2402 TORONTO ON MJE1W5 CANADA	13832819114
ALBERTO LEANDRO M	2036 SEDONA CREEK CIR LAS VEGAS NV	13832819232
ALBERTSON JOHN C	8600 W CHARLESTON BLVD #1054 LAS VEGAS NV	13832819104
ALCANTARA ALEX M & ERLINDA A	1017 ST RAPHAEL DR BAY POINTE CA	13832819101
ALI WARDA	541 INDIAN BLUFF #202 LAS VEGAS NV	13833320004
ALLEN PROPERTIES II L L C	200 PLEASANT ST HOFFMAN ESTATES IL	13833415017

**Report of All Selected Parcels****Case Number:** ZON-40496**Printed On:** Tue: January 4, 2011

<u>Owner</u>	<u>Address</u>	<u>Parcel Number</u>
ALOISI BERNARD & MARIE	108 FERNDALE BLVD ISLIP NY	13833419018
AMBARTSOUMIAN ALONA	8628 INWOOD OR LAS VEGAS NV	13832813038
ANNSLEY S B FAMILY TRUST	P O BOX 753 RIMROCK AZ	13833317015
APPIGNANESI IVANO	8400 W CHARLESTON BLVD #241 BLDG 10 LAS VEGAS NV	13833419083
ARAI RYUSO	%B YAHIKU 8452 BOSECK DR #236 LAS VEGAS NV	13833324060
ARANETA CHARMAINE RAMOS	175 RUSTY PLANK AVE LAS VEGAS NV	13832819024
ASATRYAN KARINE	1255 SPAZIER AVE GLENDALE CA	13832819067
ASATRYAN KARINE	1255 SPAZIER AVE GLENDALE CA	13832819097
ASATRYAN SARKIS	1255 SPAZIER AVE GLENDALE CA	13832819122
ASATRYAN SARKIS & ANAIT	1255 SPAZIER AVE GLENDALE CA	13832819162
ASH JAMES A	8600 W CHARLESTON BLVD #2194 LAS VEGAS NV	13832819299
ASTON WILBUR G & LOIS H	8452 BOSECK OR #245 LAS VEGAS NV	13833324041
ATHERTON ARTHUR L & PRISCILLA E	808 HILLGROVE CT LAS VEGAS NV	13832813032
ATTERBERRY CYNTHIA	P O BOX 43631 LOS ANGELES CA	13832819009
AYVAZOVA INGA	136 S EVERETT ST #204 GLENDALE CA	13832819205
AZIMI MEHDI	820 S 7TH ST LAS VEGAS NV	13832819263
AZOULAY RACHEL	650 S TOWN CENTER DR LAS VEGAS NV	13832819031
B B VENTURES L L C	2973 RED SPRINGS OR LAS VEGAS NV	13833324036
BABAYAN YERVAND	1246 LINDEN AVE GLENDALE CA	13832819091
BACON SUSAN D & JAMES	900 HEAVENLY HILLS CT #215 LAS VEGAS NV	13833412031
BAGGELAAR WILLIAM C SR & LINDA A	5310 W 132ND ST HOLLYGLEN CA	13833415018
BAKER DAVIO J & SANDRA J	27 SHARON DR BAY POINT CA	13833324009
BANK AMERICA N A	475 CROSSPOINT PKWY GETZVILLE NY	13833317011
BANK NEW YORK MELLON TRS	400 COUNTRYWIDE WY SV-35 SIMI VALLEY CA	13833324049
BANK NEW YORK MELLON TRS	400 COUNTRYWIDE WY SV-35 SIMI VALLEY CA	13832819391
BANK WELLS FARGO N A	4101 WISEMAN BLVD SAN ANTONIO TX	13833320072
BARROSO JOSE & OLIVIA	8620 HIGHACRE OR LAS VEGAS NV	13832813020
BARTU TERRY LEE & TRACIE LYN	8612 SKYWARO CT LAS VEGAS NV	13832717009
BAYER FRANK	8452 BOSECK DR #118 LAS VEGAS NV	13833324067
BEADEL GERALD R	800 OVERVIEW DR LAS VEGAS NV	13832814006
BEAN-SUNPOINTE L L C	1600 S W 4TH AVE #870 PORTLAND OR	13833419027
BEAUDET FAMILY TRUST	P O BOX 370397 LAS VEGAS NV	13833415016

**Report of All Selected Parcels****Case Number:** ZON-40496**Printed On:** Tue: January 4, 2011

<u>Owner</u>	<u>Address</u>	<u>Parcel Number</u>
BEAUDET FAMILY TRUST	P O BOX 370397 LAS VEGAS NV	13833415003
BECK CHRISTOPHER J & LAURA G	8289 TARRAGON DR MECHANICSVILLE VA	13832819144
BELL ORLANDER JR	3540 CRAIN HIGHWAY #361 BOWIE MD	13832819407
BELL WESLEY S	8452 BOSECK DR #255 LAS VEGAS NV ,	13833324022
BENDER DAVID C	9333 OLYMPIA FALLS AVE LAS VEGAS NV	13833317039
BENSONI DAVID J & KATHERINE A	8452 BOSECK DR #243 LAS VEGAS NV	13833324034
BERGSTRAND WENDY A & DONALD V	632 OVERVIEW DR LAS VEGAS NV	13832713009
BERLAND AMANDA	7636 WINTER CT LAS VEGAS NV	13833412023
BERNAL PEDRO & HEIDI	134 W CHARLESTON BLVD #134 LAS VEGAS NV	13833419064
BERRIOS JOSE B & OLIMPIA M	2107 JAYMIE WY LAS VEGAS NV	13832819157
BESNARD NICOLAS	8400 W CHARLESTON BLVD #140 LAS VEGAS NV	13833419078
BIANCO ANTONIO & MARIA A	900 HEAVENLY HILLS CT #120 LAS VEGAS NV	13833412036
BIEGANSKI WILLIAM & KIM TRUST	709 OVERVIEW DR LAS VEGAS NV	13832812001
BIRGER YEKATERINA	11044 ACAMA ST #208 STUDIO CITY CA	13832819272
BIRK MARCELL A	8324 W CHARLESTON BLVD #2070 LAS VEGAS NV	13832819308
BLACK FAMILY TRUST	8085 PLANTING FIELDS PL LAS VEGAS NV	13833317058
BLACK SALLY A	900 HEAVENLY HILLS CT #210 LAS VEGAS NV	13833412022
BOEZEMAN RICHARD A	8452 BOSECK DR #102 LAS VEGAS NV	13833317025
BOHNEN THOMAS SPECIAL NEEDS TR	%SR GUIDANCE CTR 3651 LINDELL RD #D LAS VEGAS NV	13833317054
BOMALASKI JOHN & PATRICIA	11 CHESTNUT LN WAYNE PA	13832819250
BOMALASKI JOHN & PATRICIA	11 CHESTNUT LN WAYNE PA	13832819192
BONOMO EMANUEL	8600 W CHARLESTON BLVD #1031 LAS VEGAS NV	13832819061
BORGNA REAL ESTATE THREE L L C	10624 S EASTERN AVE #A-124 HENDERSON NV	13832819195
BOROWSKY IKE & MIRIAM	8425 RUNNING DEER AVE #202 LAS VEGAS NV	13833320074
BOURNE PAUL & JULIE	40 KING EIDER LN ALISO VIEJO CA	13832819022
BOUZAGLO YOSS	8742 ROSEWOOD AVE NORTH HOLLYWOOD CA	13832819002
BOUZAGLO YOSS	8742 ROSEWOOD W HOLLYWOOD CA	13832819020
BOWLIN KENNETH R & PATRICIA A	8452 BOSECK DR #254 LAS VEGAS NV	13833324021
BRAUD CLARA A	10588 GARDEN LIGHT DR LAS VEGAS NV	13832819014
BRAVO FRED	10009 QUEBEC AVE S BLOOMINGTON MN	13832819044
BRILLANTES-FERNANDEZ JOANB	4803 N BURNABY DR COVINA CA	13832819155
BRINKLEY JENNIFER R	8600 W CHARLESTON BLVD #2070 LAS VEGAS NV	13832819142

**Report of All Selected Parcels****Case Number:** ZON-40496**Printed On:** Tue: January 4, 2011

<u>Owner</u>	<u>Address</u>	<u>Parcel Number</u>
BROCK BRANTLEY R	8452 BOSECK DR #283 LAS VEGAS NV	13833317046
BROOK DORIS M REVOCABLE TRUST	500 GREY CLOUD #103 LAS VEGAS NV	13833320047
BROSIOUS JOHN P	509 INDIAN BLUFF ST #103 LAS VEGAS NV	13833320023
BROWN FLORENCE O	10481 RIVERSIDE PARK AVE LAS VEGAS NV	13832819134
BROWN LIVING TRUST	17 FARMSTEAO RD COMMACK NY	13832819214
BROWN RAYMOND L & VICKI J	7865 TRAIL BOSS CT LAS VEGAS NV	13833320040
BROWN ROBERT C & MARY LOU	8400 RUNNING DEER AVE #104 LAS VEGAS NV	13833320060
BRUMM KARL	8465 TACKLE BOX CT LAS VEGAS NV	13833324048
BRUNKOW JUDY E & WARD G	1319 W CANTERBURY ST HOBBS NM	13832819037
BRUSH LISA A	501 GREY CLOUD ST #101 LAS VEGAS NV	13833320037
BRYANT SPENCER D	8612 GRANOBANK OR LAS VEGAS NV	13832711015
BUCHANAN LESLEY	508 INDIAN PRINCESS DR #102 LAS VEGAS NV	13833320064
BUEME JEFFREY	30 ELY RD OEPEW NY	13833320068
BUENO VICTORIA B TRUST	10910 DENSMORE AVE GRANADA HILLS CA	13832819177
BULOCHNIK ASYA INTERVIVOS TR	1734 N FULLER AVE #304 LOS ANGELES CA	13833324029
BURGESS OWEN L & ARLENE E	8417 RUNNING DEER AVE #103 LAS VEGAS NV	13833320079
BUTERA SAMUEL JR	8417 RUNNING DEER AVE #104 LAS VEGAS NV	13833320080
BYORICK LINDA & RITA	805 HILLGROVE CT LAS VEGAS NV	13832813025
C M R TRUST	8632 HIGHACRE DR LAS VEGAS NV	13832714005
CAORIN LIVING TRUST	8550 W CHARLESTON BLVD #102-408 LAS VEGAS NV	13832814003
CAIN LIVING TRUST	8617 INWOOD DR LAS VEGAS NV	13832813017
CALAHAN VIRGINIA R TRUST	713 OVERVIEW DR LAS VEGAS NV	13832812002
CALDERON CAROLINE & JOSE	8452 BOSECK OR LAS VEGAS NV	13833324001
CALEDO PROPERTIES L L C	3100 S OURANGO #106 LAS VEGAS NV	13833412032
CALLEJA PAUL	8452 BOSECK DR #273 LAS VEGAS NV	13833317059
CAMDEN USA INC	%CAMDEN PPTY TRUST %B BANEY 3 GREENWAY PLAZA #1300 HOUSTON TX	13833401004
CAMDEN USA INC	%CAMDEN PPTY TRUST %B BANEY 3 GREENWAY PLAZA #1300 HOUSTON TX	13833401013
CAMERON CYNTHIA D	5575 W TECO AVE LAS VEGAS NV	13832819300
CAMPAN ALIN	280 SOGGY RUFF WY LAS VEGAS NV	13832819397
CAMPER ZOE AMANDA	FLAT 509 417 WICK LANE LONDON UK E32JJ ENGLAND	13832819336
CANADA BEVERLY OIANE	8020 W SAHARA AVE #100 LAS VEGAS NV	13833320019
CANALES GLADYS J	900 HEAVENLY HILLS CT #103 LAS VEGAS NV	13833412003

**Report of All Selected Parcels****Case Number:** ZON-40496**Printed On:** Tue: January 4, 2011

<u>Owner</u>	<u>Address</u>	<u>Parcel Number</u>
CANALES PATRICK P	8600 W CHARLESTON BLVD #2014 LAS VEGAS NV	13832819085
CAPARAS LARA	9030 W SAHARA #181 LAS VEGAS NV	13832819227
CAPRICORN TRUST	11407 CEDAR LOG CT LAS VEGAS NV	13832819280
CARDELLA ANTHDNY & MARIANNA	814 HARBOR RD FORKED RIVER NJ	13833320026
CARRAUTERS RICKEY	800 HILLGROVE CT LAS VEGAS NV	13832813034
CASABELLA ALBERT	5903 GLENFINNAN AVE AZUSA CA	13832819357
CASEY MICHAEL E	8600 W CHARLESTON BLVD #2169 LAS VEGAS NV	13832819339
CELIS CECILIA V	708 OVERVIEW DR LAS VEGAS NV	13832815003
CERVANTES HENRY P S & MA V L	2209 FORDHAM DR SANTA CLARA CA	13832819303
CHAKRAVARTHY SUMANT	4237 NERISSA CIR FREMONT CA	13832819109
CHALAMISH MALKA	8600 W CHARLESTON BLVD #1165 LAS VEGAS NV	13832819327
CHAN CHAN WAN	4126 SARILEE AVE ROSEMEAD CA	13833419051
CHAN CHAN WAN	4126 SARILEE AVE ROSEMEAD CA	13833419066
CHAN CHAN WAN	4126 SARILEE AVE ROSEMEAD CA	13833419045
CHAN CHAN WAN & SUE OY	4126 SARILEE AVE ROSEMEAD CA	13833419070
CHANEY JAMES & CHIARINA FAM TR	8633 INWOOD DR LAS VEGAS NV	13832813013
CHANG WINSTON K C & PATRICIA W	3502 HEROIC DR RANCHO PALOS VERDES CA	13832819267
CHATHAM LIVING TRUST	8452 BOSECK DR #155 LAS VEGAS NV	13833324020
CHEN BILLIE	8600 W CHARLESTON #2136 LAS VEGAS NV	13832819274
CHEN NELLIE	9744 CALLITA ST ARCADIA CA	13833419024
CHENG RUEY HAN & YU HWA	13715 LUCAS LN CERRITOS CA	13832819355
CHENG XIAO WILLIAM	10845 LA ALBERCA AVE SAN DIEGO CA	13833320030
CHING FREDERICK & ANN MARIE	98-656 PAPALEARII PL AIEA HI	13832819100
CHISM FAMILY REVOCABLE LIV TR	7725 FRUIT DOVE ST NO LAS VEGAS NV	13832819259
CHISM MAXINE A SEMI-REV LIV TR	7725 FRUIT DOVE ST NO LAS VEGAS NV	13832819320
CHO KWONG & ELIZABETH	3831 CORNELL DR OCEANSIDE CA	13832819316
CHOPRA UPENDER F	20855 RINALDI ST CHATSWORTH CA	13833320062
CHULLANANDANA SOITONG & C	6 JEROME CT BELLEVILLE NJ	13832819168
CIRIA-CRUZ ZOILO S JR & NORMITA	290 GRISSOM ST HERCULES CA	13832819361
CITY OF LAS VEGAS FIRE DEPT	400 E STEWART LAS VEGAS NV	13832802001
CIVELLO JOSEPH G	1501 OWLS PERCH PL SANTA ROSA CA	13833419039
CLINKSCALES ROBERT L	8452 BOSECK DR #288 LAS VEGAS NV	13833317042

**Report of All Selected Parcels****Case Number:** ZON-40496**Printed On:** Tue: January 4, 2011

<u>Owner</u>	<u>Address</u>	<u>Parcel Number</u>
COCKRELL MICHELSON FAM TR ETAL	%3651 INDIAN CREEK CT PLACERVILLE CA	16304101003
COLEMAN CHARLES H & CHRIS HOLLY	8452 BOSECK DR #107 LAS VEGAS NV	13833317020
COLEMAN LAWRENCE	8636 INWOOD DR LAS VEGAS NV	13832813040
COLEMAN ROBERT D & KRISTI H	3654 GERRI BAY LN LAS VEGAS NV	13832713012
CDLIN RICHARD & BRENDA	1722 HAVEMEYER LN REDONDO BEACH CA	13832819124
COMPUTER CNSLTNG GRP INC RTMT TR	1881 W ALEXANDER #1111 NO LAS VEGAS NV	13832819312
CONKLIN JAMES & DIANE D	533 INDIAN BLUFF #203 LAS VEGAS NV	13833320011
CONSTABLE DANIEL	8600 W CHARLESTON BLVD #1032 LAS VEGAS NV	13832819062
COOPER TED INVESTMENTS L P	6420 HILL VIEW AVE LAS VEGAS NV	13832819271
COPPOLA BENJAMIN JR	176 MATILDA DR MANAHAWKIN NJ	13832711013
CDRNELL RICHARD	129 W LAKE MEAD PKWY #8 HENDERSON NV	13832819069
CRUZ AMY M	8600 W CHARLESTON BLVD #1099 LAS VEGAS NV	13832819197
CUA FAMILY TRUST	180 MELISSA CIR DALY CITY CA	13832819292
CURTIS FAMILY INVESTMENTS I LLC	P O BOX 4689 MODESTO CA	13832819278
D & C INC	8500 W CHARLESTON BLVD LAS VEGAS NV	13832802005
D & C INC	8500 W CHARLESTON BLVD LAS VEGAS NV	13832802006
D K K C HDLDINGS SERIES I L L C	% D CHEVAL 401 GRAND AUGUSTA LN LAS VEGAS NV	13833324055
DAEISADEGHI MOHAMMAD R	50-41-202ST BAYSIDE NEW YORK NY	13832819286
DALTON LINDA JO	8400 W CHARLESTON BLVD #216 LAS VEGAS NV	13833419032
DANNENBRINK DAVID & TRACY	3445 MONTERO RD CAMERON PARK CA	13832819375
D'ANTONIO ANGELINA REV LIV TR	3825 E CAMELBACK RD #245 PHOENIX AZ	13833324059
DARCONTE CARLA L & GAIL	9120 BLAZING FIRE CT LAS VEGAS NV	13833324063
DARCONTE EUGENE	9120 BLAZING FIRE CT LAS VEGAS NV	13833324045
DARCONTE EUGENE & GAIL	9120 BLAZING FIRE CT LAS VEGAS NV	13833324023
DARCONTE EUGENE J & GYTHA M	90 WARD AVE STATEN ISLAND NY	13833324030
DARCONTE JOHN	8452 BOSECK DR #224 LAS VEGAS NV	13833317006
DARYANANI JACK	3879 IVYHILL AVE LAS VEGAS NV	13832819220
DAUGHENBAUGH ORA D FAMILY TRUST	520 W 2ND ST FLORA IL	13833415019
DAVID DANY	422 E 72ND ST #14C NEW YORK NY	13832819019
DAVIES RUSSELL & JOY TRUST	7904 ROXBURGH CASTLE AVE LAS VEGAS NV	13833415006
D'COSTA BERTRAM & TERESA	8452 BOSECK DR #269 LAS VEGAS NV	13833317035
D'CRUZ FUSAKO	517 OCEANFRONT WALK #16 VENICE CA	13832819112

**Report of All Selected Parcels****Case Number:** ZON-40496**Printed On:** Tue: January 4, 2011

<u>Owner</u>	<u>Address</u>	<u>Parcel Number</u>
D'CRUZ FUSAKO	517 OCEANFRONT WALK #16 VENICE CA	13832819118
DEAN STEVEN M ETAL	3095 SPRUCEWOOD LN ESCONDIDO CA	13832819186
DECKER CONSTANCE T	900 HEAVENLY HILLS CT #109 LAS VEGAS NV	13833412017
DELGADO EDGARDO H & VICTORIA F	9524 QUAKERTOWN AVE CHATSWORTH CA	13832819147
DEMOOR JACKIE L	401 PARK RD OJAI CA	13832819018
DENISON GREG	2808 W DEER PATH TRL JANESVILLE WI	13833419031
DIBROG JOHN J & LAUREL A	8452 BDSECK DR #135 LAS VEGAS NV	13833324056
DICKERSON MARY	10205 NIGHTOWL CREEK PL LAS VEGAS NV	13833320043
DIEP ELOISE M & SON T	2520 MUIRFIELD GILRDY CA	13832819247
DIGRANDI LAURIE	8452 BOSECK DR #261 HENDERSON NV	13833324011
DIMICCO CHRISTOPHER M	8600 W CHARLESTON BLVD #1157 LAS VEGAS NV	13832819311
DIXON LISA D	6391 RANCHO MISSION RD #4 SAN DIEGO CA	13833324012
DOGFACE L L C	656 ROSE BLVD BALDWIN NY	13832819350
DOLAN RUSSELL E & MICHIKO N	8621 INWOOD DR LAS VEGAS NV	13832813016
DROZD FRANK & PAMELA ANN	7801 DANA POINT CT LAS VEGAS NV	13833320020
DRUNGLE LYDIA K D B REV LIV TR	8408 RUNNING DEER AVE #102 LAS VEGAS NV	13833320052
DUNFEE LAND COMPANY L P	5790 W MEADOWBROOK LOOP COEUR D'ALENE ID	13832819119
DUPONT FAMILY TRUST	10509 BACK PLAINS DR LAS VEGAS NV	13832713003
DURANGO COMMONS LTD L L C	851 S RAMPART BLVD #220 LAS VEGAS NV	13832816001
DURANGO COMMONS LTD L L C	851 S RAMPART BLVD #150 LAS VEGAS NV	13832816003
DURANGO COMMONS LTD L L C	851 S RAMPART BLVD #150 LAS VEGAS NV	13832816002
DURANGO MINI STORAGE INC	11920 SOUTHERN HIGHLANDS PKWY #301 LAS VEGAS NV	13832802002
DURANGO MINI STORAGE INC	11920 SOUTHERN HIGHLANDS PKWY SUITE 301 LAS VEGAS NV	13833401028
EBY JOANIE O	8452 BOSECK DR #258 LAS VEGAS NV	13833324015
ELBAZ ORI	SHLOMO DOGA 35 JERUSALEM 93758 ISRAEL	13832819194
ELIAS FLOYD E & CHRISTINA L	3450 SAWTELLE BLVD #152 LOS ANGELES CA	13832819210
ELIZONDO RAMIRO	4500 JOSEPH CARY LAS VEGAS NV	13833317024
ELK POINT PROPERTIES L L C	24 FIFTH AVE #1701 NEW YORK NY	13832819266
EMANUEL CONCEPCION	29834 CALLE SAN MARTIN MENIFEE CA	13832819080
EMERY VILLA L L C	8960 WREN CIR FOUNTAIN VALLEY CA	16304118002
ENDICOTT MARCUM	6348 INGIN LAS GOAL AVE LAS VEGAS NV	13832819289
ENGILMAN STEPHEN & SONIA FAM TR	2019 S CANFIELD AVE LOS ANGELES CA	13833324037

**Report of All Selected Parcels****Case Number:** ZON-40496**Printed On:** Tue: January 4, 2011

<u>Owner</u>	<u>Address</u>	<u>Parcel Number</u>
ERAZ US L L C	P O BOX 320122 SAN FRANCISCO CA	13832819373
ESTEP FAMILY TRUST	P O BOX 2416 CAPISTRANO BEACH CA	13833317032
EVENS DONALD S JR	8550 W CHARLESTON #102-394 LAS VEGAS NV	13833415013
EVERGREEN INTL HOLDINGS L L C	%A CHIU 8113 TIARA COVE CIR LAS VEGAS NV	13832819239
EWANIUK CHRIS	8600 W CHARLESTON BLVD #2162 LAS VEGAS NV	13832819324
EWANIUK DEBORA	8815 SAIL BAY LAS VEGAS NV	13832819322
EXECUTIVE INVESTMENTS INC	5405 FREMANTLE LN CALABASAS CA	13832819321
FALGIONE MARIA D	1851 N GREEN VALLEY PKWY HENDERSON NV	13832819368
FANNIE MAE	475 CROSSPOINT PKWY GETZVILLE NY	13833419040
FANNIE MAE	800 BROOKSEDGE BLVD WESTERVILLE OH	13832819334
FANNIE MAE	%LENDER BUSINESS PROCESS SERV 14523 SW MILLIKAN WAY #200 BEAVERTON OR	13833419029
FARLEY TRACY	8624 HIGHACRE DR LAS VEGAS NV	13832813021
FASO JOSEPH R & PATRICIA A	822 ARQUILLA GLENWOOD IL	13833320036
FAZIO MICHAEL	900 HEAVENLY HILLS CT #220 LAS VEGAS NV	13833412040
FEDERAL HOME LOAN MORTGAGE CORP	5000 PLANO PKWY CARROLLTON TX	13833419022
FEDERAL HOME LOAN MORTGAGE CORP	%AMTRUST BANK %BKR DEPT OH 98-0210 1111 CHESTER AVE #200 CLEVELAND OH	13832819135
FEDERAL HOME LOAN MORTGAGE CORP	3476 STATEVIEW BLVD FORT MILL SC	13832819073
FEDERAL HOME LOAN MORTGAGE CORP	5000 PLANO PKWY CARROLLTON TX	13833419011
FEDERAL NATIONAL MORTGAGE ASSN	%AURORA LOAN SERV LLC 10350 PARK MEADOWS DR LITTLETON CO	13832819363
FEDERAL NATIONAL MORTGAGE ASSN	1000 TECHNOLOGY DR MS 314 O FALLON MO	13832819074
FELICIANO REYNALDO & AURORA	8600 W CHARLESTON BLVD #2023 LAS VEGAS NV	13832819047
FENNER MICHAEL WAYNE	700 RIVENBARK CT LAS VEGAS NV	13832712023
FIERRO CHERI & MICHAEL	%D MAGON 8600 W CHARLESTON BLVD #2109 LAS VEGAS NV	13832819219
FIRST INVESTORS CHOICE L L C	8530 W SAHARA AVE #110 LAS VEGAS NV	13832819264
FIRST INVESTORS CHOICE L L C	8530 W SAHARA AVE #110 LAS VEGAS NV	13832819075
FIRST INVESTORS CHOICE L L C	8530 W SAHARA AVE #110 LAS VEGAS NV	13832819089
FIRST INVESTORS CHOICE L L C	8530 W SAHARA AVE #110 LAS VEGAS NV	13832819076
FIRST INVESTORS CHOICE L L C	8530 W SAHARA AVE #110 LAS VEGAS NV	13832819081
FLAHERTY PHYLLIS J	604 HEARTLINE DR LAS VEGAS NV	13832717027
FLEMING JAMES & OLIVIA JT REV TR	7260 BIRKLAND CT LAS VEGAS NV	13833324008
FLETCHER ELIZABETH	2000 GRAND ISLAND CT LAS VEGAS NV	13832819103
FONSECA SILVIA	10110 REFLECTION BROOK AVE LAS VEGAS NV	13832819249

**Report of All Selected Parcels****Case Number:** ZON-40496**Printed On:** Tue: January 4, 2011

<u>Owner</u>	<u>Address</u>	<u>Parcel Number</u>
FORLANO LESLIE	1124 OLD COURSE LN MOUNT PLEASANT SC	13832819008
FRANK & SONS	%F CLEARY 6299 SUNDANCE BRIGHTON MI	13833320084
FRANK DEBRA J & WILLIAM E	81 N 200 W CEDAR CITY UT	13832819187
FRANKLIN CALEB D & CHERISH L	608 HEARTLINE DR LAS VEGAS NV	13832717026
FRIEDL RICHARD C	6333 MEADOWSWEET AVE NW CANTON OH	13832819351
FRIZZLE JAMES	517 INDIAN BLUFF ST #101 LAS VEGAS NV	13833320013
FULLER JOHNNY L & VIVIAN G	8452 BOSECK DR #106 LAS VEGAS NV	13833317019
FULTZ RANDY & DESIREE	700 MINTO CT LAS VEGAS NV	13832712017
G D I L L C	10340 HEALE GARDEN CT LAS VEGAS NV	13832819035
GAFENEY HERB	613 OVERVIEW DR LAS VEGAS NV	13832713016
GAMMELL 2002 TRUST	8452 BOSECK DR #235 LAS VEGAS NV	13833324058
GANS RAYMDND LIVING TRUST	8116 TOWER BRIDGE AVE LAS VEGAS NV	13833324027
GARCIA DAVID R	3147 SURF SPRAY ST LAS VEGAS NV	13832819405
GARCIA SALVADOR G	9749 GENTLE SPIRIT DR LAS VEGAS NV	13833320082
GASPARINE JOLENE A	8452 BOSECK DR #130 LAS VEGAS NV	13833324043
GASPARINE MARY & MIKE	8452 BOSECK DR #274 LAS VEGAS NV	13833317057
GAY JOELENA W	8600 W CHARLESTON BLVD #2156 LAS VEGAS NV	13832819314
GELVAN SAAR	412 WINERY RIDGE ST LAS VEGAS NV	13832819174
GENG SUYAN	209-5683 HAMPTON PLACE VANCOUVER BC V6T 2H3 CANADA	13832819057
GENTILE MICHELLE A	121 EMERALD FOREST ST #201 LAS VEGAS NV	13832819225
GHANIMIAN ZAVEN	8600 W CHARLESTON BLVD #1085 LAS VEGAS NV	13832819169
HAZARIAN PAREN & HAGOP	5748 HAZELTINE AVE #6 VAN NUYS CA	13832819236
GINN FAMILY TRUST	%J GINN 600 LAIRD ST PICAYUNE MS	13832712026
GIOVA-RAINEY ANNE	P O BOX 435 ODESSA DE	13832819132
GLAVIN MICHAEL	5814 NE 180 ST KENMORE WA	13832819140
GLAZER MICHELE & ITSCHAK	4377 LA BARCA DR TARZANA CA	13833317048
GLOBAL INVESTMENTS ALPHA L L C	%O HAGAY 8600 W CHARLESTON BLVD #1021 LAS VEGAS NV	13832819048
GLOBAL INVESTMENTS ALPHA L L C	%D HAGAY 8600 W CHARLESTON BLVD #1021 LAS VEGAS NV	13832819063
GLOBAL INVESTMENTS ALPHA L L C	%O HAGAY 8600 W CHARLESTON BLVD #1021 LAS VEGAS NV	13832819068
GLOBAL INVESTMENTS ALPHA L L C	%O HAGAY 8600 W CHARLESTON BLVD #1021 LAS VEGAS NV	13832819329
GLOBAL INVESTMENTS ALPHA L L C	%O HAGAY 8600 W CHARLESTON BLVD #1021 LAS VEGAS NV	13832819096
GLOBAL INVESTMENTS ALPHA L L C	%O HAGAY 8600 W CHARLESTON BLVD #1021 LAS VEGAS NV	13832819301

**Report of All Selected Parcels****Case Number:** ZON-40496**Printed On:** Tue: January 4, 2011

<u>Owner</u>	<u>Address</u>	<u>Parcel Number</u>
GLOBAL INVESTMENTS ALPHA L L C	%O HAGAY 8600 W CHARLESTON BLVD #1021 LAS VEGAS NV	13832819182
GLOBAL INVESTMENTS ALPHA L L C	%O HAGAY 8600 W CHARLESTON BLVD #1021 LAS VEGAS NV	13832819095
GOCHAN ALFREDO	8600 W CHARLESTON BLVD #1203 LAS VEGAS NV	13832819365
GOCHAN ALFREDO R	8600 W CHARLESTON BLVD #1203 LAS VEGAS NV	13832819401
GODINICH ROBERT ANTHONY	501 GREY CLOUD ST #204 LAS VEGAS NV	13833320044
GOLDEN PEACH PROPERTY GROUP LLC	12345 LAKE CITY WY NE #386 SEATTLE WA	13832819139
GOLDER BRADLEY R & BETH	1915 208TH ST SW LYNNWOOD WA	13832819117
GOLDSTEIN BARRY J	533 INDIAN BLUFF ST #103 LAS VEGAS NV	13833320007
GONZALES ROBERT M	501 GREY CLOUD ST #102 LAS VEGAS NV	13833320038
GOOCH EMERY G JR	8400 W CHARLESTON BLVD #214 LAS VEGAS NV	13833419030
GOODSELL GORDON E & DEBBIE	716 OVERVIEW DR LAS VEGAS NV	13832814002
GORBERT STEVEN J	8452 BOSECK AVE #247 LAS VEGAS NV	13833324040
GORUNOV TATIANA	8600 W CHARLESTON BLVD #2036 LAS VEGAS NV	13832819072
GOSSAGE & REED L L C	%SHAWN CHRISTOPHER LTD 2625 N GREEN VALLEY PKWY #290 HENDERSON NV	13833412019
GOTTLIEB SUN T LIVING TRUST	8600 W CHARLESTON BLVD #1065 LAS VEGAS NV	13832819125
GOULD ALAN	8452 BOSECK DR #228 LAS VEGAS NV	13833324066
GRANDBANK TRUST	%NEEDHAM LAW FRIM 3216 W CHARLESTON BLVD LAS VEGAS NV	13832712024
GRAPEL PAUL	508 INDIAN PRINCESS DR #201 LAS VEGAS NV	13833320067
GRAY BILL & DENA	6953 PEACE PIPE CT RENO NV	13833412021
GRAYBLAS FE E & ERNESTO F	901 BOURBON ST #4 PAHRUMP NV	13832819383
GREEN MICHAEL L	8408 RUNNING DEER AVE #201 LAS VEGAS NV	13833320055
GREGORKA ROBERT	141 MONTCLAIR DR HENDERSON NV	13832819370
GRUMMER HUBERT A & YVONNE D	P S C 471 BOX 840 FPO AE	13833324047
GUADIZ STEVEN U	2461 WAGNER ST #8 PASADENA CA	13833419005
GUARINO PATRICK M & LINDA L	9216 WORSLEY PARK PL LAS VEGAS NV	13832717024
GUILLOT THOMAS A & JUNE	10499 WINDAM HILL RD GLEN ALLEN VA	13832819347
GUILLOT THOMAS ALLEN & JUNE	10499 WINDAM HILL RD GLEN ALLEN VA	13832819164
GUINThER HAROLD & ANNE	11 MIN ST BLANDON PA	13832819123
GUNN GARRETT & KAREN	1 KURRAWA AVE MERMAID WATERS QLD 4218 AUSTRALIA	13832819340
GUTIERREZ EUGENE JR & CHRISTINE	119 MNAPLE CIR ELIZABETH PA	13832819171
GUZMAN MARTHA F	5828 SACRAMENTO AVE ALTA LOMA CA	13833324019
HAFFEY LINDA E	509 INDIAN BLUFF ST #204 LAS VEGAS NV	13833320028

**Report of All Selected Parcels****Case Number:** ZON-40496**Printed On:** Tue: January 4, 2011

<u>Owner</u>	<u>Address</u>	<u>Parcel Number</u>
HAGAY OFIR & TSURIT	11630 EVERGREEN CREEK LAS VEGAS NV	13832819041
HAGAY OFIR & TSURIT	8600 W CHARLESTON BLVD #1021 LAS VEGAS NV	13832819042
HAKIMI TRUST	10364 EASTBOURNE AVE LOS ANGELES CA	13832819337
HALL GARY & DONNA TRUST	812 HILLGROVE CT LAS VEGAS NV	13832813031
HALL RONALD C & DIANA G FAM TR	704 RIVENBARK CT LAS VEGAS NV	13832712022
HALLMEYER VANDA R	9030 W SAHARA AVE P M B 510 LAS VEGAS NV	13833317009
HAMILTON SCOTT B JR	3091 BRETON DR LAS VEGAS NV	13833320078
HAMPTON ROBERT A & JOYCE D	6008 MOORHAVEN DR LOUISVILLE KY	13833324017
HAREL INVESTMENTS L L C	1820 E WARMSPRINGS RD #100 LAS VEGAS NV	13832819090
HARRIS CHRISTOPHER B & IRENE	8600 W CHARLESTON BLVD #1191 LAS VEGAS NV	13832819377
HARRIS DALE L & DEBORAH L	801 HILLGROVE CT LAS VEGAS NV	13832813024
HARRIS MICHAEL D	4740 KILLINGTON ST LAS VEGAS NV	13832819298
HARTFORD KITTY M	7421 N LEAD AVE FRESNO CA	13832819200
HARTZELL ALLEN L REV LIV TR	8452 BOSECK DR #162 LAS VEGAS NV	13833324007
HAVLIK FAMILY L P	%M HAVLIK 1620 STANFORD AVE REDONDO BEACH CA	16304118004
HAWN HEATHER	9524 WALKING SPIRIT CT LAS VEGAS NV	13832819023
HENRETTY CHRIS & BEVERLY	1601 LOMA DR HERMOSA BEACH CA	13833317012
HERR MANINDER & AMANPREET	9469 THATCHED SUNLIGHT CT LAS VEGAS NV	13832819199
HIBLER DENNIS R & JEANNE A	8765 KILLIANS GREENS DR LAS VEGAS NV	13833419017
HIRAHARA RONALD YOSHIMITSU TRUST	%LEARNING CARE GROUP %ACCTS PAYABLE 21333 HAGGERTY RD #300 NOVI MI	13833401002
HIRSH JASON	325 S BEACHWOOD BURBANK CA	13833320017
HLADY THOMAS K & JOYCE D	621 HEARTLINE DR LAS VEGAS NV	13832717021
HOFFMAN SAMUEL F	369B THIRD ST #56108 SAN RAFAEL CA	13832819222
HOLLOWAY TIMOTHY R	8452 BOSECK DR #278 LAS VEGAS NV	13833317051
HOLSAPFEL-BAXTER FAMILY TRUST	3870 MONACA AVE YOUNGSTOWN OH	13833412010
HOLTON KILER	P O DRAWER 70639 ALBANY GA	13833412001
HOROWITZ DAVID A	1333 14TH ST #1 SANTA MONICA CA	13833419089
HOUGEN PATTY J	8400 RUNNING DEER AVE #102 LAS VEGAS NV	13833320058
HOWARD AARON J	P O BOX 1298 LINCOLN NH	13832819269
HOWARD AARON J	P O BOX 1298 LINCOLN NH	13832819180
HSIUNG JENNIFER & MARILYN	264 CORAL ROSE IRVINE CA	13833419068
HUANG KIMBALL Y	3428 PRAIRIE MEADOW ST LAS VEGAS NV	13832819304

**Report of All Selected Parcels****Case Number:** ZON-40496**Printed On:** Tue: January 4, 2011

<u>Owner</u>	<u>Address</u>	<u>Parcel Number</u>
HUBER HENRY J III & PATRICIA M	3808 LAKE OSBORNE DR LAKE WORTH FL	13832819066
HUBER HENRY J III & PATRICIA M	3808 LAKE OSBORNE DR LAKE WORTH FL	13832819086
HUBER HENRY J III & PATRICIA M	3808 LAKE OSBORNE DR LAKE WORTH FL	13832819170
HUMPHRIES JOANNE	8600 W CHARLESTON BLVD #1048 LAS VEGAS NV	13832819092
HUNT DENNIS & FAYE	4615 WESTON WOODS WY WHITE BEAR TOWNSHIP MN	13833324038
HUNT DENNIS W & FAY I	4615 WESTON WOODS WY WHITE BEAR TOWNSHIP MN	13833324031
HURST SPENCER	9409 DREW CT LAS VEGAS NV	13832819262
HUTCHINS JOHN	8600 W CHARLESTON BLVD #1132 LAS VEGAS NV	13832819260
IMPERIAL INVESTMENT PTNRS L L C	142 N MILIPITAS BLVD #217 MILPITAS CA	13833419085
INDIAN WHEAT PATTERSON IRR TR	7404 WHEAT GRASS CT LAS VEGAS NV	13833320005
INSERRA DIANNA J TRUST	8616 HIGHACRE DR LAS VEGAS NV	13832813019
IRELAND-ASHLEY GILBERT & LAURIE	19229 SONOMA HWY #258 SONOMA CA	13832819276
ISHIHARA GLENN REVOCABLE TRUST	1150 N BUFFALO DR #2107 LAS VEGAS NV	13832819228
JACARUSO FAMILY TRUST	8491 GREEN MESA CT LAS VEGAS NV	13833415014
JACKSON LILLIE	4459 DON MIGUEL DR LOS ANGELES CA	13833324014
JACKSON NANCY E	3905 BRANCHWOOD DR NO LAS VEGAS NV	13832713013
JACOBS DONALD & ANNE	8600 W CHARLESTON BLVD #2187 LAS VEGAS NV	13832819379
JAMES JOSEPH RAJKUMAR	12345 LAKE CITY WY NE #386 SEATTLE WA	13832819394
JAMES JOSEPH RAJKUMER	10124 LEXINGTON PINES AVE LAS VEGAS NV	13832819372
JAMIESON FAMILY TRUST	6052 DUNHAM HILLS WY LAS VEGAS NV	13832819203
JEFFS ANDREW W & DEENA N CHAPIN	2693 RIVERSIDE DR COSTA MESA CA	13832819126
JELKE CONSTANCE J	8637 INWOOD DR LAS VEGAS NV	13832813012
JENSEN TAMMY KAY	509 INDIAN BLUFF ST #203 LAS VEGAS NV	13833320027
JOHNSON GARY L	8600 W CHARLESTON BLVD #2120 LAS VEGAS NV	13832819242
JOHNSON JOSHUA L	8524 W GILMORE AVE LAS VEGAS NV	13833412004
JOHNSON PATRICIA L	312 HARBOR GULF CT NO LAS VEGAS NV	13832819352
JOHNSON-MARCOTT FAMILY TRUST	101 MILL VALLEY CIR N SACRAMENTO CA	13833320015
JOINER JAMIE HARDY	8452 BOSECK DR #265 LAS VEGAS NV	13833324005
JONES ETHEL M	1708 WEST BLVD LOS ANGELES CA	13832819211
JOSEPH KAREN D	8452 BOSECK DR #167 LAS VEGAS NV	13833324002
JOURNO TAL JOSEPH	LIVNE #3 KATZRIN 12900 ISRAEL	13832819284
JUDGMENTS INC	930 S 4TH ST #100 LAS VEGAS NV	13832819145

**Report of All Selected Parcels****Case Number:** ZON-40496**Printed On:** Tue: January 4, 2011

<u>Owner</u>	<u>Address</u>	<u>Parcel Numbe</u>
KADER MARTHA	7521 LINTWHITE ST NO LAS VEGAS NV	13832819358
KAISER BARBARA ANN REVOCABLE TR	13311 COGSWELL ST ROMULUS MI	13833412012
KAMARA SHLOMO & GALILA	1922 MIDVALE AVE LOS ANGELES CA	13832819319
KAMARA SHLOMO & GALILA	1922 MIDVALE AVE LOS ANGELES CA	13832819348
KANE ELIZABETH L	8400 W CHARLESTON BLVD #211 BLDG #3 LAS VEGAS NV	13833419023
KARAGEUZIAN FAMILY TRUST	10815 LURLINE AVE CHATSWORTH CA	13832819330
KARAS JAMES G	8452 BOSECK DR #179 LAS VEGAS NV	13833317050
KARKENNY PATRICIA R	900 HEAVENLY HILLS CT #219 LAS VEGAS NV	13833412039
KATO WILLIAM L & KAREN M	243 ANAPALAU ST HONOLULU HI	13833324039
KAWASAKI NORI & THOMAS	500 GREY CLOUD ST #201 LAS VEGAS NV	13833320049
KEARNS TROY J	9436 W LAKE MEAD BLVD #15 LAS VEGAS NV	13832819246
KELLEHER MICHAEL T	8400 W CHARLESTON #104 BLD 1 LAS VEGAS NV	13833419004
KELLON DALE B & ALICIA D	16327 MAGENTA TERRACE CHINO HILLS CA	13832819098
KELLON SUZANNE	16327 MAGENTA TERR CHINO HILLS CA	13833324028
KELLY RONALD R & DONNA K	705 RIVENBARK CT LAS VEGAS NV	13832712019
KENNEDY ROBERT	8600 W CHARLESTON BLVD #2006 LAS VEGAS NV	13832819012
KERR SHANNON	13311 COGSWELL ST ROMULUS MI	13833412018
KESHAVA BALAJI & SHANTHI	18201 SANDRINGHAM CT NORTHRIDGE CA	13832819150
KETTENIS ALBERT-JAN & HEATHER A	5425 MURIETTA AVE SHERMAN OAKS CA	13833320014
KHACHATRYAN ARTUR	8600 W CHARLESTON BLVD #1034 LAS VEGAS NV	13832819064
KHUU TERRY	76 ANTIQUE GARDEN ST LAS VEGAS NV	13832819253
KIM JARED & NYON HEE	2206 CYPRESS ST COVINA CA	13833320083
KING GLADYS	2339 ARBOR LAKE CT HENDERSON NV	13833317036
KIRKORIAN CHRIS	402 PALEGOLD ST HENDERSON NV	13832819021
KLEIN ROSS & JANINE	21602 TREESHADE LN LAKE FOREST CA	13833317033
KLEIN ROSS & JANINE	21602 TREESHADE LN LAKE FOREST CA	13833317004
KLINE SHARON I	1046 PALACE ST AURORA IL	13832819152
KODAK FAMILY TRUST	3578 PIONEER RD MEDFORD OR	13833415010
KOENIG THOMAS P & KRIS M	1 DANFORTH RD MERRIMACK NJ	13832819387
KOLIVAS JOHN & DEANNA	P O BOX 89368 HONOLULU HI	13832819212
KOLIVAS JOHN & DEANNA KOLIVAS	P O BOX 89368 HONOLULU HI	13832819395
KOSAKA KAZUHIRO	7289 GRADY CIR CASTLE ROCK CO	13833320008

**Report of All Selected Parcels****Case Number:** ZON-40496**Printed On:** Tue: January 4, 2011

<u>Owner</u>	<u>Address</u>	<u>Parcel Numbe</u>
KOSUTH LIVING TRUST	7921 MARBELLA CIR LAS VEGAS NV	13832815002
KRBASHYAN MARGARET	8600 W CHARLESTON BLVD #2183 LAS VEGAS NV	13832819369
KU ANNE	21117 VALLEY VIEW DR WALNUT CA	13832819254
KU BEVERLY R	576 LOCKHAVEN DR RIVER VALE NJ	13832819153
L D L L C SERIES VII	5795 S LAMB LAS VEGAS NV	13832816004
LACHER MILTON J & DORIS E REV TR	8616 GRANDBANK DR LAS VEGAS NV	13832711014
LAKEOTES CHARLOTTE	8600 W CHARLESTON BLVD #2051 LAS VEGAS NV	13832819105
LANDUCCI LORI BETH	2081 SHERATON DR SANTA CLARA CA	13832819345
LANDUCCI LORI BETH	2081 SHERATON DR SANTA CLARA CA	13832819027
LANE MARVIN P & SUE L	712 OVERVIEW DR LAS VEGAS NV	13832814001
LANIER JO ANN	8452 BOSECK DR #170 LAS VEGAS NV	13833317031
LAPICTO JONE L	15477 TIMBERIDGE LN CHINO HILLS CA	13832819033
LAROCK GERARD & ALICE REV LIV TR	8452 BOSECK DR #282 LAS VEGAS NV	13833317045
LAU STANLEY HO WING	P O BOX 4552 HONOLULU HI	13832819136
LEE BING B	8452 BOSECK DR #240 LAS VEGAS NV	13833324054
LEE DAVID	7575 VEGAS DR #150 LAS VEGAS NV	13832819110
LEE DAVID & MARY KU	140 BLUE RIDGE DR CRANBERRY TWP PA	13832819244
LEE JULIE TSUGIE FUJISHIGE	1553 ALA LANI ST HONOLULU HI	13832819166
LEE MARGARET L & ROGER Y	20563 PESARO WAY NORTHRIDGE CA	13832819376
LEE VI TRUST	8605 OLIVER CT LAS VEGAS NV	13832812006
LEIVA MARIA E	8621 SKYWARD CT LAS VEGAS NV	13832717019
LEONTOS CAROLYN J REV TR AGMT	628 OVERVIEW DR LAS VEGAS NV	13832713008
LEUNG DENNIS	2360 HUNTINGTON DR #300 SAN MARINO CA	13832819163
LEVELLAND LIMITED L L C	P O BOX 320122 SAN FRANCISCO CA	13832819384
LEVELLAND LIMITED L L C	P O BOX 320122 SAN FRANCISCO CA	13832819015
LEVELLAND LIMITED L L C	P O BOX 320122 SAN FRANCISCO CA	13832819049
LEVY CHRISTOPHE	%L PILLOM P O BOX 401613 LAS VEGAS NV	13833320034
LEWIS JOANNA D	508 INDIAN PRINCESS DR #101 LAS VEGAS NV	13833320063
LIM FRANCISCO B	29906 MULEDEER LN CASTAIC CA	13832819189
LIM MARIA CORDELIA	177 107TH ST NE #1108 BELLEVUE WA	13832819179
LIM RICHARD & KATHERINE TRUST	939 S FEDORA ST LOS ANGELES CA	13833415001
LINDEMANN PATRICK W & SHARON I	700 OVERVIEW DR LAS VEGAS NV	13832815001

**Report of All Selected Parcels****Case Number:** ZON-40496**Printed On:** Tue: January 4, 2011

<u>Owner</u>	<u>Address</u>	<u>Parcel Numbe</u>
LINDNER GREGORY S	900 HEAVENLY HILLS CT #207 LAS VEGAS NV	13833412015
LINGUARD TRENT & MEGAN	8600 W CHARLESTON BLVD #1163 LAS VEGAS NV	13832819325
LINZI NICOLA	6224 W COUGAR AVE LAS VEGAS NV	13833412011
LITTLE PATRICIA M & DELL	3011 BRADFORD HILL AVE NO LAS VEGAS NV	13832819051
LOCATELLI PETER A	7237 RICHMOND HEIGHTS DR LAS VEGAS NV	13832813036
LONGO RAYMOND F & LYNN SH	8632 GRANDBANK DR LAS VEGAS NV	13832711010
LORD JOSEPH A & TAMMY K LIV TR	609 OVERVIEW DR LAS VEGAS NV	13832713017
LORMER THAD D	8400 RUNNING DEER AVE #103 LAS VEGAS NV	13833320059
LOUBONBEL RICH P L L C	6743 LONGMONT AVE SAN GABRIEL CA	13833419071
LOUBONBEL RICH P L L C	9108 LAS TUNAS DR TEMPLE CITY CA	13833419072
LUCERO LIBERATO & SEGUNDINA	8600 W CHARLESTON BLVD #1067 LAS VEGAS NV	13832819133
LUCY'S SEAMSTRESS L L C	8600 W CHARLESTON BLVD #2078 LAS VEGAS NV	13832819156
LUJAN JOHN	690 CASTLE ROCK RO #1 WOODLAKE CA	13833324016
LUTES WILLIAM B & JOAN C	8452 BOSECK DR #127 LAS VEGAS NV	13833324062
LYTHGOE KEVIN	%M SINGER LTD 4475 S PECOS RD LAS VEGAS NV	13833419021
M J W INVESTMENTS L L C	702 S BERETANIA HONOLULU HI	13832819004
M J W INVESTMENTS L L C	2557 TANTALUS DR HONOLULU HI	13832819001
MA WEI CHEN	9816 GILESPIE #110 LAS VEGAS NV	13832819364
MACFARLAND THOMAS J	268 BUSH ST #3624 SAN FRANCISCO CA	13833320066
MAOERAZO ENTERPRISES L L C	23 PERENNIAL BORDER LAS VEGAS NV	13832819297
MAESTRO CALVIN J & FELINITA O	10652 SAPPHIRE VISTA AVE LAS VEGAS NV	13832819374
MAGEL LAWRENCE W JR REVOCABLE TR	4724 PONY EXPRESS ST NO LAS VEGAS NV	13832713006
MAHSEREJIAN SHANT	6633 BIANCA AVE VAN NUYS CA	13832819216
MAHSEREJIAN SHANT	6633 BLANCA AVE LAKE BALBOA CA	13832819359
MAJEWSKI WILLIAM R	8452 BOSECK DR #111 LAS VEGAS NV	13833317014
MAK JAYNRY W	2043 LAWTON ST SAN FRANCISCO CA	13832819113
MAK JAYNRY W	2043 LAWTON ST SAN FRANCISCO CA	13832819161
MALKA NAAMA	6337 BABCOCK AVE NORTH HOLLYWOOD CA	13832819209
MALKA SHLOMO MAILIK & RACHEL M	6337 BABCOCK AVE NORTH HOLLYWOOD CA	13832819390
MANDEL LANCE W	8600 W CHARLESTON BLVD #1152 LAS VEGAS NV	13832819302
MANDELLO MICHAEL DON & JULIE K	1636 ARBORETUM WY BURLINGTON MA	13832819207
MANELL KENNETH M	1526 MALCOLM AVE LOS ANGELES CA	13832819275

**Report of All Selected Parcels****Case Number:** ZON-40496**Printed On:** Tue: January 4, 2011

<u>Owner</u>	<u>Address</u>	<u>Parcel Number</u>
MANGAN NICHOLAS T JR & J LUANN	616 OVERVIEW DR LAS VEGAS NV	13832713005
MANNING LIVING TRUST	8629 INWOOD DR LAS VEGAS NV	13832813014
MANTILLA MIGUEL E & IRMA	512 AMPERE LN LAS VEGAS NV	13833412024
MARCHIONNE GIULIO T & FRANCES	8608 OLIVER CT LAS VEGAS NV	13833317002
MARCHIONNE TULLIO J & JANE M	8608 OLIVER CT LAS VEGAS NV	13832812003
MARHOFFER DOUG & AMY	7947 FARRALONE AVE CANOGA PARK CA	13832819252
MARINO ALEXANDRA	P O BOX 139 MARYKNOLL NY	13832819287
MARKETATIONS L L C	1816 WINCANTON DR LAS VEGAS NV	13832819175
MARTELLO ANTONE C & MARY L	403 TRUE HICKORY DR ROCHESTER NY	13833412030
MARTINEZ ANDRES	8600 W CHARLESTON BLVD #2069 LAS VEGAS NV	13832819141
MARTINEZ JAFRIUS	14691 VINCENNES ST PANORAMA CITY CA	13833419002
MARTINEZ JAIME & MARIA	804 HILLGROVE CT LAS VEGAS NV	13832813033
MASHHOOD SHAHRZAD & FIROOZ	8605 CANYON VIEW DR LAS VEGAS NV	13832819184
MATUSZAK ANA MARIA	900 HEAVENLY HILLS CT #115 LAS VEGAS NV	13833412027
MAUZY MATTHEW	8600 W CHARLESTON BLVD #1007 LAS VEGAS NV	13832819013
MAYES SHEILA M	11237 HAAS AVE LOS ANGELES CA	13833317053
MCAFFEE ALISA	900 HEAVENLY HILLS CT #118 LAS VEGAS NV	13833412034
MCCAMANT ROBERT R & LINDA CO-TRS	8612 OLIVER CT LAS VEGAS NV	13832712030
MCCARTHY RUSSELL III & PATRICIA	8600 W CHARLESTON BLVD #1076 LAS VEGAS NV	13832819148
MCCOY MATTHEW D B	14805 SE 179TH ST #18M RENTON WA	13833324057
MCDONALD NORVEL	1137 N CENTRAL AVE #1704 GLENDALE CA	13832819028
MCDONALD RUFUS L & PATRICIA E	%S MCDONALD 8452 BOSECK DR #285 LAS VEGAS NV	13833317041
MCEWAN JULIE ANNE	501 GREY CLOUD ST LAS VEGAS NV	13833320042
MCGEE FAMILY TRUST	809 OVERVIEW DR LAS VEGAS NV	13832814009
MCGILL FAMILY LIVING TRUST	14716 DUNTON DR WHITTIER CA	13833324042
MCGONEGAL RALPH JR	205 S SANDSTONE RD JACKSON MI	13832819273
MCGRAIN AMIE S	8600 W CHARLESTON BLVD #2098 LAS VEGAS NV	13832819196
MCGUIRE DANIEL G	8452 BOSECK DR #287 LAS VEGAS NV	13833317040
MCGUIRE FAMILY LIVING TRUST	1005 S HIGHRIDGE CT ANAHEIM CA	13833320048
MCGUIRE JAMES F LIVING TRUST	8600 W CHARLESTON BLVD #1136 LAS VEGAS NV	13832819268
MCHUGH DANIEL	8452 BOSECK DR #231 LAS VEGAS NV	13833324046
MCPMAHON FAMILY TRUST	6416 TINA LN LAS VEGAS NV	13832819385

**Report of All Selected Parcels****Case Number:** ZON-40496**Printed On:** Tue: January 4, 2011

<u>Owner</u>	<u>Address</u>	<u>Parcel Number</u>
MCPHERRIN I L L C	%C YU 1912 S MCPHERRIN AVE MONTEREY PARK CA	13832819353
MCPHERRIN II L L C	%C YU 1912 S MCPHERRIN AVE MONTEREY PARK CA	13832819131
MELANSON MICHAEL J	158 DEERFIELD TERRACE S E CALGARY AB T2H 6V3 CANADA	13832819094
MELTZER PAULINE	8408 RUNNING DEER AVE #103 LAS VEGAS NV	13833320053
MENON VENU G LIVING TRUST	7901 BAYMEADOWS CIR EAST #328 JACKSONVILLE FL	13833324052
MERIWETHER GARRETT & GALYNA	8601 TITLEIST CIR LAS VEGAS NV	13832819173
METSPAKYAN SARKIS	18520 ENTRADA CT NORTHRIOGE CA	13832819406
MEYER ANNIE	400 VIDAL DR SAN FRANCISCO CA	13832819305
MEZIKIAN PIRAP A	1835 N KENMORE AVE #5 LOS ANGELES CA	13832819354
MICHALAK PETER	3478 MIRROR LAKE CIR SARATOGA SPRINGS UT	13832819331
MIDANY DROR	10611 CAPESTHORNE WY LAS VEGAS NV	13832819233
MIKAMI FAMILY TRUST	604 OVERVIEW DR LAS VEGAS NV	13832713002
MIKHAYLOVA TAMARA	900 HEAVENLY HILLS CT #203 LAS VEGAS NV	13833412007
MIKLE RICKEY & SHIRLEY ETAL	163 MARTIN RD PLAIN DEALING LA	13832819235
MIKULA MICHAEL JOHN	8624 INWOOD DR LAS VEGAS NV	13832813037
MILLER CHERYL L LIVING TRUST	8609 OLIVER CT LAS VEGAS NV	13832812005
MILLER MEGHAN C	8452 BOSECK DR #187 LAS VEGAS NV	13833317038
MINWEGEN FAMILY TRUST	8613 OLIVER CT LAS VEGAS NV	13832812004
MITCHELL MONROE & LILLIAN	9316 QUEEN CHARLOTTE DR LAS VEGAS NV	13832819043
MIYAMURA HOWARD	6254 JOAQUIN MURIETA AVE #E NEWARK CA	13833320041
MIZUFUKA GEORGE A	%G MIZUFUKA 541 INOIAN BLUFF ST #102 LAS VEGAS NV	13833320002
MOLINA SANDRA & LARRY	2061 SCHAFFHAUSEN ST MANTECA CA	13832819178
MONFARED SARA KAZEMEYNI	7894 PRIZE DR LAS VEGAS NV	13833412033
MONROY ANTONIO R JR & ROWENA R	8600 W CHARLESTON BLVD #1175 LAS VEGAS NV	13832819349
MONTAG WAYNE R & BAMBI A	1904 SHIFTING WINDS ST LAS VEGAS NV	13833317056
MONTEBON NICANDRO S JR	25560 BURNS PL STEVENSON RANCH CA	13832819204
MONTEIRO CHRISTINA	1833 WARRENVILLE ST LAS VEGAS NV	13833317030
MONTGOMERY PAMELA B	8452 BOSECK DR #267 LAS VEGAS NV	13833324004
MOOOY NORA S REVOCABLE LIVING TR	500 GREY CLOUD ST #202 LAS VEGAS NV	13833320050
MOONWATER ENTERPRISES L L C	%O HAGAY 8600 W CHARLESTON BLVO #1021 LAS VEGAS NV	13832819065
MOORE MATTHEW P	8600 W CHARLESTON BLVD #2049 LAS VEGAS NV	13832819099
MORADIAN EDWIN	11629 ROYAL DERWENT LAS VEGAS NV	13833412016

**Report of All Selected Parcels****Case Number:** ZON-40496**Printed On:** Tue: January 4, 2011

<u>Owner</u>	<u>Address</u>	<u>Parcel Number</u>
MORGAN EDDIE JR & EDITH S	8408 RUNNIGN DEER AVE #101 LAS VEGAS NV	13833320051
MORRISON META R FAMILY TRUST	160 W FOOTHILL PKWY #105-138 CORONA CA	13832814010
MOSHE GAVRIEL BEN	10611 CAPESTRONE WY LAS VEGAS NV	13832819381
MUCKLER ANDREW D	541 INOIAN BLUFF ST #101 LAS VEGAS NV	13833320001
MUELLER SHIRLEY A DECLARATION TR	3432 VOLTAIRE LN ST CHARLES IL	13833324053
MURANAKA SANA E	2785 S BASCOM AVE #50 CAMPBELL CA	13833419014
MUZIKAR KAREN L	920 OESERT OAK CT LAS VEGAS NV	13833415011
NABAT DANIEL	1572 KELTON AVE LOS ANGELES CA	13832819070
NABAT OANIEL	1572 KELTON AVE LOS ANGELES CA	13832819328
NABAT OANIEL & SHAHROKH	1572 KELTON AVE LOS ANGELES CA	13832819335
NABAT SHAHROKH & FARIMA	1572 KELTON AVE LOS ANGELES CA	13832819332
NABAT SHAHROKH & FARIMA	1572 KELTON AVE LOS ANGELES CA	13832819341
NAGLE SUZANNE M	8924 WINDSOR LOCKS AVE LAS VEGAS NV	13832819107
NAKATA KUMIKO	8601 OLIVER CT LAS VEGAS NV	13832812007
NAMVARI FAMILY TRUST	928 ALTAVILLE CT LAS VEGAS NV	13832819295
NANKIL REVOCABLE LIVING TRUST	6519 ROUND MOUNTAIN RD BAKERSFIELDO CA	13832819318
NASSIE JACK W & REBECCA L	857 SOUTHSORE DR CHULA VISTA CA	13832819003
NEHME RULLA	8 SKYVIEW DR LINCOLN RI	13832819046
NEIMAN ELYSE	273 SIXTH ST #2 BROOKLYN NY	13832819201
NELSON BRANDT & KAREN	617 HEARTLINE DR LAS VEGAS NV	13832717020
NELSON PATRICIA	320 ONYX CREST ST LAS VEGAS NV	13832819344
NELSON PATRICIA	320 ONYX CREST LAS VEGAS NV	13832819053
NELSON PATRICIA & MARVIN FAM TR	320 ONYX CREST ST LAS VEGAS NV	13832819054
NEVADA POWER COMPANY	%LAND SERV STA #9 P O BOX 98910 LAS VEGAS NV	16304101001
NGUYEN PHUNG H	8625 INWOOD DR LAS VEGAS NV	13832813015
NICHOLSON NICK	316 ONYX CREST ST LAS VEGAS NV	13832819342
NICOLAI ANDREA	8600 W CHARLESTON BLVO #1074 LAS VEGAS NV	13832819146
NIKOLAYCHUK ALEXANDER	2568 COLT RD RANCHO PALOS VEROES CA	13832819313
NIX L DEE & ELAINE VERA REV TR	P O BOX 571 FLETCHER OK	13833317026
NORMAN REVOCABLE TRUST	11703 HILLCROFT HOUSTON TX	13833419042
NUNEZ YOLANDA	8452 BOSECK DR #220 LAS VEGAS NV	13833324072
OAK LTD	%GRETHER 27174 ORTEGA HWY SAN JUAN CAPISTRANO CA	13833415015

**Report of All Selected Parcels****Case Number:** ZDN-40496**Printed On:** Tue: January 4, 2011

<u>Owner</u>	<u>Address</u>	<u>Parcel Number</u>
O'BRIEN FAMILY TRUST	8600 HIGHACRE DR LAS VEGAS NV	13832812008
OCON LOURDES	8425 RUNNING DEER AVE #101 LAS VEGAS NV	13833320069
ODOM EARL C	8452 BOSECK DR #209 LAS VEGAS NV	13833317017
OLIVER GREGORY A & JEANNINE A	9164 W DODACRE BLVD N INDIANAPOLIS IN	13832819310
ORION STAR TRUST	8550 W DESERT INN #102-119 LAS VEGAS NV	13833412014
ORME CHRISTIAN M & LINDSAY	533 INDIAN BLUFF ST #201 LAS VEGAS NV	13833320009
ORR BRETT W	1717 EGRET LN SOUTHLAKE TX	13832819399
OSTROW EDWIN J & J R REV LIV TR	2844 CARMEL RIDGE DR LAS VEGAS NV	16304118003
PAI AJIT	4455 EDISON LAKE PKWY MISHAWAKA IN	13832819283
PAIGE JILL	8617 GRANDBANK DR LAS VEGAS NV	13832712025
PALIOтта JOHN S	7351 BACHELORS BUTTON DR LAS VEGAS NV	13832819188
PALLAS CHRIS GEORGE	1821 NE 42ND ST FORT LAUDERDALE FL	13832819306
PANTHER LOUIS	8600 W CHARLESTON BLVD #1057 LAS VEGAS NV	13832819111
PARK SANG TAE & KEUM SDON	3925 SAN ESTEBAN AVE NO LAS VEGAS NV	13832819290
PARKE DARRELL	8612 HIGHACRE DR LAS VEGAS NV	13832813018
PARRY JOHN ANDREW II & LINDA L	8600 W CHARLESTON BLVD #2119 LAS VEGAS NV	13832819241
PARTRIDGE L DIANNE	8452 BOSECK DR #150 LAS VEGAS NV	13833324025
PASCUA ANTONIO G & MARIETTA M	26629 OAK TERRACE PL VALENCIA CA	13832819234
PASCUAL ISMAEL	633 OVERVIEW DR LAS VEGAS NV	13832713011
PASRICHA RAJMIT	3261 BISHOP PINE CT LAS VEGAS NV	13833320076
PATRIS MICHAEL & MARIA	805 N OLIVE AVE ALHAMBRA CA	13833419019
PAULUSSAN EVA & GEORG	10701 WOODLORE PL LAS VEGAS NV	13832819167
PAVEY CARTER IV	9225 W CHARLESTON #1193 LAS VEGAS NV	13833419056
PAVFAM PROPERTIES	%PAVONE 7337 MISSION HILL DR LAS VEGAS NV	13832819245
PAZ ZACHARY & FRANCES	198 ANI ST KAHULUI MAUI HI	13833324013
PECK DANIEL N	8600 W CHARLESTON BLVD #1149 LAS VEGAS NV	13832819293
PECK JOHN H & NANCY 1993 LIV TR	10401 W CHARLESTON B-314 LAS VEGAS NV	13832711012
PEDE JOAN C	1600 BELLUNO CT LAS VEGAS NV	13833412002
PEERA JAMES	8600 W CHARLESTON BLVD #1097 LAS VEGAS NV	13832819191
PENINSULA SERVICES INC	4700 SANTA LUC ST PAHRUMP NV	13833320046
PENNINGTON MICHAEL K & MARION R	5838 EL PALOMINO RIVERSIDE CA	13833317003
PENINSULA SERVICES INC	4700 SANTA LUC ST PAHRUMP NV	13833320075

**Report of All Selected Parcels****Case Number:** ZON-40496**Printed On:** Tue: January 4, 2011

<u>Owner</u>	<u>Address</u>	<u>Parcel Number</u>
PENSICO TRUST COMPANY	P O BOX 26903 SAN FRANCISCO CA	13833419069
PERDICHIZZI FELICE & FRANCES	2725 HOPE FOREST DR LAS VEGAS NV	13833320025
PERDICHIZZI JESSICA D	2121 CROOKED PINE DR LAS VEGAS NV	13833324024
PEREIRA CLAIRE FAMILY TRUST	8432 RUNNING DEER AVE #201 LAS VEGAS NV	13833320033
PERIERA RIGOBERTO A	8400 RUNNING DEER AVE #201 LAS VEGAS NV	13833320061
PERNELL FAMILY TRUST	3019 LAKE HILL DR ORANGE CA	16304118001
PERO SHANNON	4616 W SAHARA AVE #153 LAS VEGAS NV	13832819238
PERO SHANNON	4616 W SAHARA AVE #153 LAS VEGAS NV	13832819198
PERO SHANNON N	4616 W SAHARA AVE #153 LAS VEGAS NV	13832819138
PERONNARD FLORENCE	533 INDIAN BLUFF ST #202 LAS VEGAS NV	13833320010
PETERMAN FAMILY TRUST	8601 GRANDBANK DR LAS VEGAS NV	13832712029
PETERSON RYAN & KIMBERLY	2827 MIDDLE EARTH ST LAS VEGAS NV	13832819309
PFIMMER GARY E & BARBARA E	6582 MAGELLAN WY LAS VEGAS NV	13832812010
PHARAR JESSICA S	8452 BOSECK DR #271 LAS VEGAS NV	13833317034
PHOENIX L V REALTY PARTNERS LLC	7310 SMOKE RANCH RD #S LAS VEGAS NV	13832819130
PHOENIX LV REALTY PARTNERS L L C	7310 SMOKE RANCH RD #S LAS VEGAS NV	13832819005
PIAROVA LUCIA REVOCABLE LIV TR	8416 PACIFIC FOUNTAIN AVE LAS VEGAS NV	13833317021
PIETRANTON ROBERT & L REV LIV TR	8452 BOSECK DR #183 LAS VEGAS NV	13833317044
PINHAS TAMIR & LAURIE	25879 CHALMERS PL CALABASAS CA	13833320024
PIZZUTO FRANK R	8600 W CHARLESTON #6-2028 LAS VEGAS NV	13832819058
PLAMBECK BRIAN & KOLETTE	724 OVERVIEW DR LAS VEGAS NV	13832814004
POIRIER ERMA G REVOCABLE TRUST	612 OVERVIEW DR LAS VEGAS NV	13832713004
POLL DAVID S & PENNY J	8629 SKYWARD CT LAS VEGAS NV	13832717017
POLLOCK SCOTT	8600 W CHARLESTON BLVD #2014 LAS VEGAS NV	13832819030
POPE VICTOR H JR & ETSUKO F	277 WHISPER KNOLL CIRCLE #B ANCHORAGE AK	13833320065
POPLIN CHRISTOPHER K	300 N ISABEL ST #9 GLENDALE CA	13833419038
PORRAS CARLOS	3275 ALI BABA LN #511 LAS VEGAS NV	13832819143
PORTER STANSBY A & SELENA	10671 RIVA DE FIORE LAS VEGAS NV	13832819237
POSADAS ARACELI L	3600 BAYWOOD CIRCLE ANTIOCH CA	13832819356
PRADERA ANA CORNEJO	8600 CHARLESTON BLVD #2039 LAS VEGAS NV	13832819079
PRADIA VINCENT P	908 AUDELIA RD #200-140 RICHARDSON TX	13832819055
PREM DEFERRED TRUST	5640 W POST RD LAS VEGAS NV	13832819224

**Report of All Selected Parcels****Case Number:** ZON-40496**Printed On:** Tue: January 4, 2011

<u>Owner</u>	<u>Address</u>	<u>Parcel Numbe</u>
PRUSSIN JOSEPH	32-12 ROSALIE ST FAIR LAWN NJ	13833320032
PSARAKI GEORGETTE I	8600 W CHARLESTON #1020 LAS VEGAS NV	13832819036
PUNO DEXTER & KATHRINA	5716 VANTAGE AVE VALLEY VILLAGE CA	13832819159
PURPLE SWEATER TRUST	9101 W SAHARA #105-206 LAS VEGAS NV	13833419081
QUINN TERESA R	8233 ABERCROMBE WY LAS VEGAS NV	13832819231
QUINTERO GISELLE	2256 NEW YORK DR ALTADENA CA	13832819257
R A Z INVESTMENT L L C	%O HAGAY 8600 W CHARLESTON BLVD #1021 LAS VEGAS NV	13832819360
R A Z INVESTMENTS L L C	8600 W CHARLESTON #1021 LAS VEGAS NV	13832819221
RACICOT MICHAEL	6225 #1 BAY CLUB DR FT LAUDERDALE FL	13832819025
RADOVAN ANTONIO & LILIA	8452 BOSECK DR #219 LAS VEGAS NV	13833324070
RALPH JOAN L	8432 RUNNING DEER AVE #101 LAS VEGAS NV	13833320029
RAPALO EDGARDO	720 BRICK DR HENDERSON NV	13832819115
RAPALO EDGARDO	720 BRICK DR HENDERSON NV	13832819403
RAPP RANDALL R & VIVIAN A	11702 STEPHANIE LN GARDEN GROVE CA	13833419052
RASKANSKY ALLISON & IDEL	8600 W CHARLESTON #1042 LAS VEGAS NV	13832819082
RASKANSKY ALLISON & IDEL	2932 SETTING SUN ST LAS VEGAS NV	13832819285
RAZ INVESTMENTS L L C	%O HAGAY 8600 W CHARLESTON BLVD #1021 LAS VEGAS NV	13832819029
RED TWELVE L L C	848 N RAINBOW BLVD #2660 LAS VEGAS NV	13833419049
REDHILLS S G VENTURES L L C	%V CHALTIEL 7501 TRINITY PEAK #210 LAS VEGAS NV	13832819050
REDHILLS S G VENTURES L L C	%V CHALTIEL 7501 TRINITY PEAK #210 LAS VEGAS NV	13832819176
REDHILLS S G VENTURES L L C	%V CHALTIEL 7501 TRINITY PEAK #210 LAS VEGAS NV	13832819084
REDHILLS S G VENTURES L L C	%V CHALTIEL 7501 TRINITY PEAK #210 LAS VEGAS NV	13832819240
REDHILLS S G VENTURES L L C	%V CHALTIEL 7501 TRINITY PEAK #210 LAS VEGAS NV	13832819323
REDHILLS S G VENTURES L L C	%V CHALTIEL 7501 TRINITY PEAK #210 LAS VEGAS NV	13832819088
REDHILLS S G VENTURES L L C	%V CHALTIEL 7501 TRINITY PEAK #210 LAS VEGAS NV	13832819202
REDHILLS S G VENTURES L L C	%V CHALTIEL 7501 TRINITY PEAK #210 LAS VEGAS NV	13832819060
REED VIOLETA REVOCABLE TRUST	%V REED P O BOX 71345 LAS VEGAS NV	13833324051
REN PEIYUAN	8063 SAPPHIRE COVE AVE LAS VEGAS NV	13832819270
RENAUD FAMILY TRUST	8400 W CHARLESTON BLVD #142 LAS VEGAS NV	13833419080
RENNE RALPH & DEBY ANN	5384 DEEP SHADOW CT LAS VEGAS NV	13832819366
RENNIE SHARON L	8609 GRANDBANK DR LAS VEGAS NV	13832712027
RENZI SHELLEY ANNE	7588 EDGERTON DR LAS VEGAS NV	13833324071

**Report of All Selected Parcels****Case Number:** ZON-40496**Printed On:** Tue: January 4, 2011

<u>Owner</u>	<u>Address</u>	<u>Parcel Numbe</u>
RESTEY PAUL & JANET	31 INTERNATIONAL LN GRAND ISLAND NY	13833317007
REYNOSO JOE M & LARAYNE V FAM TR	P O BOX 895 SANTA ANA CA	13832814007
RHODES KATHLEEN	8600 W CHARLESTON #1109 LAS VEGAS NV	13832819213
RICCIARDI RIK REVOCABLE TRUST	1720 CHARLES LAM CT LAS VEGAS NV	16304118018
RICHARDSON DORA FAMILY BYPASS TR	10428 MISSION LN SUN CITY AZ	13833317047
RIGGIO BIONE D	8452 BOSECK DR #207 LAS VEGAS NV	13833317022
RITTATORE JORGE & ROSA M	12350 BACA AVE CHINO CA	13832819251
RIVAS JOSE ARMANDO	900 HEAVENLY HILLS CT #213 LAS VEGAS NV	13833412029
RIVENBARK L L C	224 S TOWER DR #B BEVERLY HILLS CA	13832712018
ROBERT GERALD & JEANNETTE	21015 N STONEGATE DR SUN CITY WEST AZ	13833320081
ROBERTS DANIEL & YOLANDA	1110 134TH ST CT S TACOMA WA	13833419091
ROBINSON CHRISTOPHER L	8600 W CHARLESTON BLVD #1028 LAS VEGAS NV	13832819052
ROCKWELL PERRY & CASSANDRA	1508 PACIFIC TERRACE DR LAS VEGAS NV	13832813011
RODRIGUEZ ALEX	783 FAXON AVE SAN FRANCISCO CA	13832819229
RODRIGUEZ CECILIA R & JOSELITO A	1440 PLUMA ST UPLAND CA	13832819190
RODRIGUEZ DICK HANSEN	1245 HENDERSON AVE #J SUNNYVALE CA	13832819392
ROSE TIMOTHY A & CAROL R	8452 BOSECK DR #143 LAS VEGAS NV	13833324032
ROSENBERG TEMMA A TRUST	9105 SANDY SHORES DR LAS VEGAS NV	13833320039
ROSTAMIAN SOHRAB	2153 QUARTZ CLIFF ST #106 LAS VEGAS NV	13832819396
ROTEN DAMIAN	8600 W CHARLESTON #2056 LAS VEGAS NV	13832819116
ROTEN DAMIAN	8600 W CHARLESTON BLVD #2190 LAS VEGAS NV	13832819382
ROUMBOS MELINA & PARASKEUAS	226 PEACOCK LN MONTEBELLO CA	13832819120
ROUMBOS PARASKEVAS & MELINA	8600 W CHARLESTON BLVD #2052 LAS VEGAS NV	13832819106
ROVERA JOE JOHN	10959 LAS FLORES DR ELMONTE CA	13833412026
RUSHFIELD MORTON & SALLY	8452 BOSECK DR #126 LAS VEGAS NV	13833324061
RUTZ DANNY J	708 RIVERBARK CT LAS VEGAS NV	13832712021
SAADA GUY & MICHELLE	7501 TRINITY PEAK #210 LAS VEGAS NV	13832819288
SAHER PROPERTIES L L C	%R SAENZ 281 ANDOVER RIDGE CT HENDERSON NV	13833415004
SALO JAMES D & IRMA JO	620 HEARTLINE DR LAS VEGAS NV	13832717023
SALTZMAN ALLEN & SHARONA	6036 AGAPANTHUS PL WOODLAND HILLS CA	13832819127
SAMPLE RONALD L	605 OVERVIEW DR LAS VEGAS NV	13832713018
SAND JOAN ANITA & JACK	8452 BOSECK DR #174 LAS VEGAS NV	13833317055

**Report of All Selected Parcels****Case Number:** ZON-40496**Printed On:** Tue: January 4, 2011

<u>Owner</u>	<u>Address</u>	<u>Parcel Numbe</u>
SANDEJAS LYDIA F	2413 GREENDALE DR SOUTH SAN FRANCISCO CA	13832819172
SANTAMARINA ODALYS M	8600 W CHARLESTON BLVD #2043 LAS VEGAS NV	13832819087
SANTORO FAMILY REVOCABLE LIV TR	11441 ALLERTON PARK DR #214 LAS VEGAS NV	13833317005
SAPIN WILSON S	8600 W CHARLESTON BLVD #1202 LAS VEGAS NV	13832819400
SASAKI RUTH M	1118 E 165TH ST SOUTH HOLLAND IL	13833324033
SAVAGE PAMELA FAMILY TRUST	8452 BOSECK DR #211 LAS VEGAS NV	13833317016
SAVARONA L L C	33 TALL RUFF DR LAS VEGAS NV	13832819307
SAVOV MIHAIL A	900 HEAVENLY HILLS CT #202 LAS VEGAS NV	13833412006
SCANZERA CAROLE K	8452 BOSECK DR #268 LAS VEGAS NV	13833324006
SCHEINER MARK	9103 ALTA DR #1203 LAS VEGAS NV	13833412025
SCHMIDT STACIE A	8600 W CHARLESTON #28-1147 LAS VEGAS NV	13832819291
SCHNEIDER ELAINE	P O BOX 35541 LAS VEGAS NV	13833412028
SCHOEN JANIS A	70 WEBSTER AVE PORT WASHINGTON NY	13832819160
SCHOOL BOARD OF TRUSTEES	2832 E FLAMINGO RD LAS VEGAS NV	13833301008
SCHROEDER RICHARD F	8452 BOSECK DR #276 LAS VEGAS NV	13833317060
SCHULZ PAMELA A	11379 W FREMONT AVE LITTLETON CO	13833320056
SCHWARTZ NANCY L	8600 W CHARLESTON BLVD #1164 LAS VEGAS NV	13832819326
SCHWARTZ RONNIE	1800 W CHARLESTON BLVD #1139 LAS VEGAS NV	13832819277
SEARS ROBERT A	8425 RUNNING DEER AVE #201 LAS VEGAS NV	13833320073
SEIFERT RICHARD J & LOUISE	215 W SUNSET LOMBARD IL	13833320021
SEPS FAMILY TRUST	P O BOX 23212 SAN JOSE CA	13833419055
SEYMOUR HEATHER M	533 INDIAN BLUFF ST #204 LAS VEGAS NV	13833320012
SHAFFER DAVID S	8632 INWOOD DR LAS VEGAS NV	13832813039
SHAH PARINDU	515 KILBURN CT CONCORD CA	13833320054
SHANKAR SAVITRI	2312 ELLIOT ST SAN MATEO CA	13832819137
SHARLEY DIANE	15702 BRASSIE CT ORLAND PARK IL	13833320018
SHCHIGLIK FAMILY TRUST	5401 ZELZAH AVE #112 ENCINO CA	13832819185
SHEPARD M LIV TR	8452 BOSECK DR #122 LAS VEGAS NV	13833317001
SHINHAN E & C AMERICA INC	%J YU 2560 MONTESSOURI ST #208 LAS VEGAS NV	13832816006
SHINHAN E & C AMERICA INC	%J YU 2560 MONTESSOURI ST #208 LAS VEGAS NV	13832816007
SHUBBUCK FAMILY TRUST	8628 GRANDBANK DR LAS VEGAS NV	13832711011
SHULTZ RYAN C & LORRI A	428 MYRTLE AVE GLENDORA CA	13832819378

**Report of All Selected Parcels****Case Number:** ZON-40496**Printed On:** Tue: January 4, 2011

<u>Owner</u>	<u>Address</u>	<u>Parcel Numbe</u>
SIDHOM SAMIR	900 HEAVENLY HILLS CT LAS VEGAS NV	13833412013
SIGFORD ADRIENNE	8600 W CHARLESTON BLVD #1144 LAS VEGAS NV	13832819282
SILVA SYLVESTER	712 MACCABE AVE LAS VEGAS NV	13833412038
SIMHA L L C	%R BAZAK 9101 W SAHARA AVE #105-K24 LAS VEGAS NV	13832819016
SIROPAT LIVING TRUST	11431 DONA DOROTEA STUDIO CITY CA	13833324044
SKOWRONSKI DENNIS & G LIV REV TR	5979 PORTO ALEGRE DR SAN JOSE CA	13832819315
SLADEK JULIA ETAL	1155 N LA CIENEGA DR WEST HOLLYWOOD CA	13832819333
SMITH PAUL GARY & TONI Z	1956 SUMMER PALM PL #102 LAS VEGAS NV	13833320003
SNOODGRASS JAMES D & RENEE	3232 FEATHERING CT NO LAS VEGAS NV	13833320057
SNOOK NOHEMY	720 BRICK DR HENDERSON NV	13832819243
SOLANA VILLAGE L L C	6268 SPRING MOUNTAIN RD #100A LAS VEGAS NV	13833419087
SOLANA VILLAGE L L C	6268 SPRING MOUNTAIN RD #100A LAS VEGAS NV	13833419088
SOLANA VILLAGE L L C	6268 SPRING MOUNTAIN RD #100A LAS VEGAS NV	13833419025
SOLANA VILLAGE L L C	6268 SPRING MOUNTAIN RD #100A LAS VEGAS NV	13833419026
SOLANA VILLAGE L L C	6268 SPRING MOUNTAIN RD #100A LAS VEGAS NV	13833419028
SOLANA VILLAGE L L C	6268 SPRING MOUNTAIN RD #100A LAS VEGAS NV	13833419033
SOLANA VILLAGE L L C	6268 SPRING MOUNTAIN RD #100A LAS VEGAS NV	13833419073
SOLANA VILLAGE L L C	6268 SPRING MOUNTAIN RD #100A LAS VEGAS NV	13833419074
SOLANA VILLAGE L L C	6268 SPRING MOUNTAIN RD #100A LAS VEGAS NV	13833419092
SOLANA VILLAGE L L C	6268 SPRING MOUNTAIN RD #100A LAS VEGAS NV	13833419035
SOLANA VILLAGE L L C	6268 SPRING MOUNTAIN RD #100A LAS VEGAS NV	13833419036
SOLANA VILLAGE L L C	6268 SPRING MOUNTAIN RD #100A LAS VEGAS NV	13833419041
SOLANA VILLAGE L L C	6268 SPRING MOUNTAIN RD #100A LAS VEGAS NV	13833419054
SOLANA VILLAGE L L C	6268 SPRING MOUNTAIN RD #100A LAS VEGAS NV	13833419043
SOLANA VILLAGE L L C	6268 SPRING MOUNTAIN RD #100A LAS VEGAS NV	13833419034
SOLANA VILLAGE L L C	6268 SPRING MOUNTAIN RD #100A LAS VEGAS NV	13833419007
SOLANA VILLAGE L L C	6268 SPRING MOUNTAIN RD #100A LAS VEGAS NV	13833419076
SOLANA VILLAGE L L C	6268 SPRING MOUNTAIN RD #100A LAS VEGAS NV	13833419053
SOLANA VILLAGE L L C	6268 SPRING MOUNTAIN RD #100A LAS VEGAS NV	13833419001
SOLANA VILLAGE L L C	6268 SPRING MOUNTAIN RD #100A LAS VEGAS NV	13833419084
SOLANA VILLAGE L L C	6268 SPRING MOUNTAIN RD #100A LAS VEGAS NV	13833419003
SOLANA VILLAGE L L C	6268 SPRING MOUNTAIN RD #100A LAS VEGAS NV	13833419048

**Report of All Selected Parcels****Case Number:** ZON-40496**Printed On:** Tue: January 4, 2011

<u>Owner</u>	<u>Address</u>	<u>Parcel Numbe</u>
SOLANA VILLAGE L L C	6268 SPRING MOUNTAIN RD #100A LAS VEGAS NV	13833419077
SOLANA VILLAGE L L C	6268 SPRING MOUNTAIN RD #100A LAS VEGAS NV	13833419060
SOLANA VILLAGE L L C	6268 SPRING MOUNTAIN RD #100A LAS VEGAS NV	13833419016
SOLANA VILLAGE L L C	6268 SPRING MOUNTAIN RD #100A LAS VEGAS NV	13833419061
SOLANA VILLAGE L L C	6268 SPRING MOUNTAIN RD #100A LAS VEGAS NV	13833419020
SOLANA VILLAGE L L C	6268 SPRING MOUNTAIN RD #100A LAS VEGAS NV	13833419008
SOLANA VILLAGE L L C	6268 SPRING MOUNTAIN RD #100A LAS VEGAS NV	13833419009
SOLANA VILLAGE L L C	6268 SPRING MOUNTAIN RD #100A LAS VEGAS NV	13833419010
SOLANA VILLAGE L L C	6268 SPRING MOUNTAIN RD #100A LAS VEGAS NV	13833419065
SOLANA VILLAGE L L C	6268 SPRING MOUNTAIN RD #100A LAS VEGAS NV	13833419044
SOLANA VILLAGE L L C	6268 SPRING MOUNTAIN RD #100A LAS VEGAS NV	13833419012
SOLANA VILLAGE L L C	6268 SPRING MOUNTAIN RD #100A LAS VEGAS NV	13833419059
SOLANA VILLAGE L L C	6268 SPRING MOUNTAIN RD #100A LAS VEGAS NV	13833419046
SOLANA VILLAGE L L C	6268 SPRING MOUNTAIN RD #100A LAS VEGAS NV	13833419006
SOLANA VILLAGE L L C	6268 SPRING MOUNTAIN RD #100A LAS VEGAS NV	13833419062
SOLANA VILLAGE L L C	6268 SPRING MOUNTAIN RD #100A LAS VEGAS NV	13833419047
SOLANA VILLAGE L L C	6268 SPRING MOUNTAIN RD #100A LAS VEGAS NV	13833419057
SOLOMON KENNETH N	P O BOX 1149 FORT COLLINS CO	13832819281
SOLOMON MICHELE L SELF-DIR TR	773 BOXWOOD LN BUFFALO GROVE IL	13832819398
SOLOMON SHERRIE	8452 BOSECK DR LAS VEGAS NV	13833317008
SOLOMON STACEY JAY 1995 TRUST	2333 CHATFIELD DR LAS VEGAS NV	13833324050
SOTO MICHAEL	4514 S NELLIS BLVD LAS VEGAS NV	13833324018
SOUTH WIND VENTURES L L C	%J RODRIGUES 8600 W CHARLESTON BLVD #1021 LAS VEGAS NV	13832819389
SOUTH WIND VENTURES L L C	%J RODRIGUES 8600 W CHARLESTON BLVD #1021 LAS VEGAS NV	13832819217
SPERBECK DON K & C J REV TR	8448 ILLUSIONARY MAGIC CIR LAS VEGAS NV	13832819149
STAMARIA SIEGRIED I & MARICEL	8600 W CHARLESTON #1159 LAS VEGAS NV	13832819317
STANLEY LYLE J	8600 W CHARLESTON BLVD #2002 LAS VEGAS NV	13832819011
STANLEY MORGAN ABS CAPITAL I TR	400 COUNTRYWIDE WY SV-35 SIMI VALLEY CA	13833324035
STASIUK HENRY & MARY E FAMILY TR	801 OVERVIEW DR LAS VEGAS NV	13832814011
STEEN JOHN E & MARK J	8600 W CHARLESTON BLVD #2054 LAS VEGAS NV	13832819108
STEWART DONALD D	624 OVERVIEW DR LAS VEGAS NV	13832713007
STIGLER MICHAEL S	624 HEARTLINE DR LAS VEGAS NV	13832717022

**Report of All Selected Parcels****Case Number:** ZON-40496**Printed On:** Tue: January 4, 2011

<u>Owner</u>	<u>Address</u>	<u>Parcel Numbe</u>
SUBRAMANIAN VISWANATHAN	6521 DAKOTA RIDGE DR EL PASO TX	13832819230
SUDA STANLEY H & ELAINE S	17128 SPINNING AVE TORRANCE CA	13833419013
SUMMERWOOD OWNERS ASSN INC	%OAKWOOD MGT CO 8501 W CHARLESTON BLVD LAS VEGAS NV	13833415005
SURANOWITZ MARTIN & SHIRLEE M	709 RIVENBARK CT LAS VEGAS NV	13832712020
T H P INVESTMENT L L C	518 W GLENDON WY SAN GABRIEL CA	13832819218
TABOR LINDA M	617 OVERVIEW DR LAS VEGAS NV	13832713015
TAIT LOUISE RITA TRUST	8616 INWOOD DR LAS VEGAS NV	13832813035
TAIWO ADERINOLA & MOJISOLA	517 INDIAN BLUFF ST #104 LAS VEGAS NV	13833320016
TAKAHATA MARK N	8600 W CHARLESTON #1133 LAS VEGAS NV	13832819265
TAKASHIMA MIKI LIVING TRUST	704 MINTO CT LAS VEGAS NV	13832712016
TANNOUS GEORGE	2948 BRIARWOOD DR W MOUNT PROSPECT IL	13833317018
TATUM VINCENT E	8600 W CHARLESTON BLVD #2204 LAS VEGAS NV	13832819408
TERRAIN INVESTMENTS L L C	251 ARBOUR GARDEN AVE LAS VEGAS NV	13833419050
TEXAS VEGAS INVESTMENTS L L C	500 N RAINBOW BLVD #300A LAS VEGAS NV	13832819181
THOMPSON GERALDINE TRUST	8616 SKYWARD CT LAS VEGAS NV	13832717010
TICKNOR PRUDENCE	8400 W CHARLESTON BLVD #233-8 LAS VEGAS NV	13833419067
TILICONE ALBERTO	10 EAGLE RUN IRVINE CA	13832819071
TINO ED	8400 W CHARLESTON BLVD #133 LAS VEGAS NV	13833419063
TOFIGHI SHAROKH STEPHEN 2004 TR	949 GRANGER FARM WY LAS VEGAS NV	13832819261
TONG JONATHAN S	761 STEWART AVE DALY CITY CA	13833419015
TOOLE DAVID M	810 ANITA AVE BELMONT CA	13833419058
TORO ONE L L C	2620 SIERRA SECO AVE #102 LAS VEGAS NV	13832819193
TORTOLINI FREDERICK	8452 BOSECK DR #215 LAS VEGAS NV	13833317010
TRAISMAN STEVEN LIVING TRUST	%LANDRY & ASSOC 7235 BERMUDA RD #A LAS VEGAS NV	13833401001
TRAISMAN STEVEN LIVING TRUST	%LANDRY & ASSOC 7235 BERMUDA RD #A LAS VEGAS NV	13832801005
TRAM XUAN	728 OVERVIEW DR LAS VEGAS NV	13832814005
TRAN DUC	8215 PARTING CLOUDS CT LAS VEGAS NV	13833324065
TSUNEYOSHI KURT	4946 POOLA ST HONOLULU HI	13832819083
TURNER EVELYN J	8452 BOSECK DR #263 LAS VEGAS NV	13833324010
TURNER PAUL G & MARJORIE H	8628 HIGHACRE DR LAS VEGAS NV	13832714006
UENO PAMELA S	8600 W CHARLESTON BLVD #1116 LAS VEGAS NV	13832819226
ULANDAY LILIA REVOCABLE LIV TR	500 GREY CLOUD ST #101 LAS VEGAS NV	13833320045

**Report of All Selected Parcels****Case Number:** ZON-40496**Printed On:** Tue: January 4, 2011

<u>Owner</u>	<u>Address</u>	<u>Parcel Number</u>
USA CHARLESTON LV SELF SGE L L C	%US COMMERCIAL 111 CORPORATE DR #120 LADERA RANCH CA	16304118019
VALLE EMMA	8600 W CHARLESTON BLVD #2128 LAS VEGAS NV	13832819256
VANNOY TRICIA E	8600 W CHARLESTON BLVD #2081 LAS VEGAS NV	13832819165
VARGHESE ANITHA	9000 VANTAGE POINT DR #216 DALLAS TX	13832819006
VEGA SUYAPA L	514 N SUNSET AVE AZUSA CA	13832819032
VEGAS IT TECHS INC	P O BOX 35006 LAS VEGAS NV	13832819007
VELASQUEZ PATTY & GARY	8608 GRANDBANK DR LAS VEGAS NV	13832711016
VELAYO DANTE P M D PENISON PL TR	1096 STEIN LN LEWISBURG PA	13833415008
VELAYO DANTE P M D PENSION PL TR	1096 STEIN LN LEWISBURG PA	13833415007
VELAYO DANTE P M D PFT SHR PL TR	1096 STEIN LN LEWISBURG PA	13833415009
VERGE GREGOIRE M & AGATHE M	2820 N COMMERCE ST NO LAS VEGAS NV	13832819040
VICENCIA GARY M	18007 CLARKDALE AVE ARTESIA CA	13833324069
VICK FAMILY TRUST	8452 BOSECK DR #186 LAS VEGAS NV	13833317037
VILLA ROLANDO & ADRIENE	1236 E BROADWAY #9 GLENDALE CA	13832819388
VINCENT CHARLES WILLIAMS	8605 GRANDBANK DR LAS VEGAS NV	13832712028
VIRGA NICOLE	1275 SONATINA DR HENDERSON NV	13833419037
WADLEY OLADIPO & BEVERLEY	1577 CHANDLER ST OAKLAND CA	13832819294
WAGNER BERTRAM	36 ALYSSUM AVE HUNTINGTON NY	13832819010
WAKISAKA KAZUYO	27461 FIELDPATH WY LAGUNA NIGUEL CA	13832819402
WAKISAKA KAZUYO	27461 FIELDPATH WY LAGUNA NIGUEL CA	13833412037
WAKISAKI KAZUYO	27461 FIELDPATH WY LAGUNA NIGUEL CA	13832819258
WALLACE JANICE ROSE LIVING TRUST	8600 W CHARLESTON BLVD #2063 LAS VEGAS NV	13832819129
WALTERS CHRISTINE R REV LIV TR	5064 DODGE RIDGE AVE LAS VEGAS NV	13833320077
WALTERS EVELYN G	16108 18TH PL NORTH PLYMOUTH MN	13832819206
WANG XIAOMIN	2106 GUNNISON PL HENDERSON NV	13833419075
WARD JOANN	2986 THUNDER LAKE CIR LAFAYETTE CO	13832819183
WARD PATRICK & CHERYL	5437 ROYAL VISTA LN LAS VEGAS NV	13832819078
WARD PATRICK T & CHERYL L	5437 ROYAL VISTA LAND LAS VEGAS NV	13832819077
WATERS STEPHEN	8600 W CHARLESTON BLVD #1049 LAS VEGAS NV	13832819093
WATKINS MORRIS & REBECCA	15 HASTINGS RIDGE NY	13832819121
WEATHERS BENNIE & DESSIE R	900 HEAVENLY HILLS CT #201 LAS VEGAS NV	13833412005
WEBBER JOEL L JR	4648 BELLFLOWER BLVD LAKE WOOD CA	13832711017

**Report of All Selected Parcels****Case Number:** ZON-40496**Printed On:** Tue: January 4, 2011

<u>Owner</u>	<u>Address</u>	<u>Parcel Number</u>
WEITZ JEROME H	2725 MISSION ST SAN FRANCISCO CA	13833317029
WELLS CHARLES E	8425 RUNNING DEER AVE #102 LAS VEGAS NV	13833320070
WEN WARREN & SHARON MINHAI LI	360 LA PRENDA MILLBRAE CA	13833320006
WETHERINGTON CHARLES E & BELINDA	2548 ALKALI CREEK RD BILLINGS MT	13832819338
WETMORE OONN & LORI	620 S WILLIAMETTE NEWBERG OR	13833412009
WHEATON DONALO	900 HEAVENLY HILLS CT #112 LAS VEGAS NV	13833412020
WHELAN RICHARD JOSEPH & SUSAN	P O BOX 371315 LAS VEGAS NV	13832717018
WHITE KENNETH F	1077 W BROAOSTONE CT WASHINGTON UT	13833419086
WHITE KENNETH F	P O BOX 3059 MESQUITE NV	13833419090
WHITE ROSE PROPERTIES L L C	6450 ALOEA AVE LAKE BALBOA CA	13832819223
WHITMORE LEIF J	8600 W CHARLESTON #2-2007 LAS VEGAS NV	13832819017
WICKLIFFE PATRICIA A	808 OVERVIEW OR LAS VEGAS NV	13832814008
WIEKAMP LESTER K	6640 ETIWANDA AVE RANCHO CUCAMONGA CA	16304118017
WIERENGA STEVEN W	36 GLEN GARRY WY HILLSBOROUGH CA	13833324068
WILLIAMS EARL O	8452 BOSECK DR #203 LAS VEGAS NV	13833317028
WILSON FAMILY TRUST 1999	8604 HIGHACRE DR LAS VEGAS NV	13832812009
WILSON JANET V	900 HEAVENLY HILLS CT #204 LAS VEGAS NV	13833412008
WINBACK TRUST	2955 FRANKLIN ST LA CRESCENTA CA	13832819154
WISE PILAR	8452 BOSECK DR #227 LAS VEGAS NV	13833324064
WOLFE STEVEN & LESLIE 2006 TRUST	P O BOX 2333 REDONOO BEACH CA	13833415012
WOLFFIS BRIAN C & VICTORIA L	164 DERWENT PL LAS VEGAS NV	13833317052
WONG LORENZO L & ROSY L	4047 CHESHIRE OR CYPRESS CA	13833324026
WULFSBERG FAMILY TRUST	%C WULFSBERG 2109 DIAMOND PEAK CT LAS VEGAS NV	13833412035
XU XIU X	8452 BOSECK DR #182 LAS VEGAS NV	13833317043
XUE JIE	45913 VIA LA COLORAOA TEMECULA CA	13832819208
YANO RIKA	224 W 18TH ST #4B NEW YORK NY	13832819255
YARON PROPERTIES L L C	412 WINERY RIDGE ST LAS VEGAS NV	13832819367
YARON PROPERTIES L L C	412 WINERY RIDGE ST LAS VEGAS NV	13832819059
YAROSLAVSKIY MICHAIL	11759 CASA GRANDE DR ST LOUIS MO	13833320031
YEE NORMAN SED WING LIVING TRUST	9957 BISCAVNE LN LAS VEGAS NV	13833415002
YELADIM L L C	%S BAZAK 9101 W SAHARA AVE #105-K24 LAS VEGAS NV	13832819026
YEN MARIANNE	8838 CHATLAKE DR WEST HILLS CA	13833324003

**Report of All Selected Parcels****Case Number:** ZON-40496**Printed On:** Tue: January 4, 2011

<u>Owner</u>	<u>Address</u>	<u>Parcel Numbe</u>
YEUNG CHEUK YAN & KWAI KUEN	240 ORTEGA ST SAN FRANCISCO CA	13832819248
YU BRENDA S	1120 N HEAVENLY VALLEY CIR WALNUT CA	13832819380
YU CHENG	260 SHARON RD ARCADIA CA	13832819404
YU SI M	8600 W CHARLESTON #2026 LAS VEGAS NV	13832819056
YUAN YUAN	9625 PHOENICIAN AVE LAS VEGAS NV	13832819362
ZADEH ALI E & ABDOLREZA E	1293 MORADA PL ALTADENA CA	13832819386
ZAMBERG PAUL & BONNIE	2636 GOLFSIDE DR LAS VEGAS NV	13833317023
ZDYBER PAULINA	680 S 9TH AVE YUMA AZ	13833419079
ZHANG XIU ZHEN	1656 JULIA WY RIVERSIDE CA	13832819128
ZHONG GANG	8600 CHARLESTON #1018 LAS VEGAS NV	13832819034
ZIMMER TRACIE A & NEAL A	8432 RUNNING DEER AVE #203 LAS VEGAS NV	13833320035
ZIMMERMAN HARLAND	7872 REGENCY PARK LAS VEGAS NV	13833419082
ZUNINO FRANCES A	8600 W CHARLESTON BLVD #1173 LAS VEGAS NV	13832819343

**CITY OF LAS VEGAS**  
**INTER-OFFICE MEMORANDUM**  
**REQUEST FOR COMMENT**

**FROM: PLANNING AND DEVELOPMENT**

**ZON-40496**

**HAND DELIVERED**

*DEVELOPMENT COORDINATION (DPW)	ROGER BAILEY	DSC
FIRE ENGINEERING	OZZIE MIRKHAH	DSC
*FLOOD CONTROL (DPW)	ALBERT SUNG	DSC
*LAND DEVELOPMENT (DPW)	DAVID GUERRA	DSC
PERMITS/ INSPECTIONS	ROD CLARK	DSC
*RIGHT-OF-WAY (DPW)	MARY WULFF	DSC
*SANITARY SEWERS (DPW)	JOE PEÑA	DSC
*TRAFFIC ENGINEERING	RICK SCHRODER	DSC

**ROUTED ELECTRONICALLY**

CCSD	LINDA PERRI	4190 McLeod Drive, 2 <sup>nd</sup> Floor
METRO	BRIAN O'CALLAGHAN	7 <sup>th</sup> FLOOR CITY HALL
OFFICE OF BUSINESS DEVELOPMENT	TOM BURKART	2 <sup>nd</sup> FLOOR CITY HALL EXPANSION
NEIGHBORHOOD SERVICES	ANNE KILPONEN	2 <sup>nd</sup> FLOOR CITY HALL
*TEFO (DPW)	REBECCA WHITLOCK	2900 RONEMUS
*SID (DPW)	PATRICK MURPHY	420 N. FOURTH STREET
*SURVEY (DPW)	ALAN RIEKKI	WEST YARD

**\* ONLY THOSE INDICATED WITH A STAR ARE TO BE ROUTED TO ROGER BAILEY, SR. ENG. ASSOC. ALL OTHER DIVISIONS PLEASE ROUTE YOUR COMMENTS DIRECTLY TO THE PLANNING AND DEVELOPMENT DEPARTMENT < US MAIL DELIVERY >**

**CITY OF LAS VEGAS**

**DEVELOPMENT REVIEW COMMENT FORM**



**Planning and Development Department**  
**Current Planning Division**  
**731 South Fourth Street**  
**Las Vegas, Nevada 89101**  
**(702) 229-6301 phone (702) 385-7268 fax**

**ZON-40496 - REZONING - PUBLIC HEARING - APPLICANT/OWNER: CITY OF LAS VEGAS** - Request for a Rezoning FROM: C-1 (LIMITED COMMERCIAL) TO: C-V (CIVIC) on 1.59 acres at 900 South Durango Drive (APN 138-32-802-001), Ward 2 (Wolfson).

PLANNING COMMISSION: **FEBRUARY 8, 2011**

CITY COUNCIL: **MARCH 16, 2011**

PLANNING SUPERVISOR: **STEVE GEBEKE**



**PUBLIC HEARING**

Comments Due: **JANUARY 6, 2011**

Comments not returned by the due date will not be incorporated into the staff report for this case. Comments may be submitted either on this sheet and routed via interoffice mail, U.S. mail, fax, or e-mailed to **Carman Burney** ([cburney@lasvegasnevada.gov](mailto:cburney@lasvegasnevada.gov)), the Agenda Tech responsible for this case. If you desire to meet with the case planner you may schedule an appointment by calling (702) 229-6301.

**LIST COMMENTS BELOW:**

---

Report Date 12/16/2010 03:43 PM

Submitted By

Page 1

A/P # 40496 REZONING

Application Information

Stages

	Date / Time	By	Date / Time	By
Processed	12/16/2010 10:49	982721	Temp COO	
Approved			COO Issued	
Final			Expires	

Associated Information

Type of Work	# Plans	0	Declared Valuation	0.00
Dept of Commerce	# Plans	0	Calculated Valuation	0.00
Priority	<input checked="" type="checkbox"/> Auto Reviews	Bill Group	Actual Valuation	0.00

Description of Work

ZON-40496 - REZONING - PUBLIC HEARING - APPLICANT/OWNER: CITY OF LAS VEGAS - Request for a Rezoning FROM: C-1 (LIMITED COMMERCIAL) TO: C-V (CIVIC) on 1.59 acres at 900 South Durango Drive (APN 138-32-802-001), Ward 2 (Wolfson).

Parent A/P #

Project # 40496 Project/Phase Name FIRE DEPARTMENT #2 Phase #  
Size/Area 1.59 ACRE Size Description Subdivision Code  
Proposed Start Proposed Stop % Completed 0.00  
% Complete Formula

Property/Site Information

Parcel 13832802001

Location

Owner/Tenant

Contact ID AC1301731 Name CITY OF LAS VEGAS Organization  
Mailing Address 400 E STEWART AVE State/Province NV  
City LAS VEGAS Country  Foreign  
ZIP/PC 89101-2913 Evening Phone  
Day Phone Mobile #  
Fax

A/P Linked Addresses

No Addresses are linked to this Application

Linked Addresses

900 S DURANGO DR  
LAS VEGAS, 89145-

A/P Addresses

No Other Addresses are associated to this Application

Linked Parcels

No Parcels are linked to this Application

A/P Linked Parcels

13832802001

Report Date 12/16/2010 03:43 PM

Submitted By

Page 2

**Applicants/Contacts**

Primary N Capacity OWNER Contact ID AC1301731  Foreign  
Effective Expire  
Name CITY OF LAS VEGAS  
Day Phone Eve Phone Organization  
Pager PIN # Position  
Fax Mobile Profession  
E-Mail  
Address 400 E STEWART AVE  
LAS VEGAS, NV 89101-2913  
Seasonal Addr  
Valid From To  
Comments No Comments

Primary Y. Capacity APPL Contact ID 981106  Foreign  
Effective Expire  
Name CITY OF LAS VEGAS  
Day Phone (702)229-6301 x Eve Phone Organization % PLANNING AND DEVELOPMENT  
Pager PIN # Position  
Fax (702)385-7268 Mobile Profession  
E-Mail  
Address 731 S. 4TH STREET  
LAS VEGAS, NV 89101  
Seasonal Addr  
Valid From To  
Comments Contact Flinn Fagg, AICP or Peter Lowenstein, AICP

**Contractors**

No Contractors

Project# AP Type Status Stage Relation

No children exist for this project

Planning Condition Description Effective Expire Comments

There is no planning condition for this project.

**REZONING**

N DINA Required? N PRS N Parent required? Zoning Information

Final City Council letter received

Annotated minutes recieved

Is there a condition of approval for a Required Review?

If yes, when does it need to be reviewed?

ROI Expired

Staff Recommendation

Meeting Information

Report Date 12/16/2010 03:43 PM

Submitted By

Page 3

Zoning Information

<u>Acres</u>	<u>Existing</u>	<u>Existing ROI</u>	<u>Proposed</u>	<u>Approved</u>	<u>ROI?</u>	<u>ROI Exp Date</u>	<u>Ordinance Adopted</u>
<u>Ordinance #</u>	<u>Added By</u>	<u>Modified By</u>	<u>Comments</u>	<u>Comments</u>			

1.59	C-1						
	PLOWENSTEIN						

Meeting Information

<u>Meeting Date</u>	<u>Meeting Type</u>	<u>Meeting Status</u>	<u>YES Votes</u>	<u>NO Votes</u>	<u>ABSTENTIONS</u>
<u>Comments</u>	<u>Add Date</u>	<u>Modified By</u>			
<u>Added By</u>	<u>Modified Date</u>				

02/08/2011	PC	SCHEDULED	0	0	0
PLOWENSTEIN	12/16/2010				

Template Type AP# AP Type Status Stage

No children exist for this project

Employee  
Employee ID Last First M Comments

No Employee Entries

Log  
Action Description Entered By Start Stop Hours

FEE	FEE	982721	12/16/2010 10:49		0.00
	CITY INITIATED APPLICATION				



**PLANNING & DEVELOPMENT DEPARTMENT**

**APPLICATION / PETITION FORM**

Application/Petition For: Rezoning

Project Address (Location) 900 S Durango Drive

Project Name CLV Fire Station Proposed Use No change

Assessor's Parcel #(s) 138-32-802-001 Ward # 2

General Plan: existing PF proposed N/A Zoning: existing C-1 proposed C-V

Commercial Square Footage N/A Floor Area Ratio N/A

Gross Acres 1.59 Lots/Units N/A Density N/A

Additional Information Rezoning from C-1 (Limited Commercial) to C-V (Civic)

**PROPERTY OWNER** City of Las Vegas Contact Elinn Fagg, AICP

Address 731 S 4th Street Phone: (702) 229-6301 Fax: (702) 385-7268

City Las Vegas State NV Zip 89101

E-mail Address \_\_\_\_\_

**APPLICANT** City of Las Vegas Contact Elinn Fagg, AICP

Address 731 S 4th Street Phone: (702) 229-6301 Fax: (702) 385-7268

City Las Vegas State NV Zip 89101

E-mail Address \_\_\_\_\_

**REPRESENTATIVE** \_\_\_\_\_ Contact \_\_\_\_\_

Address \_\_\_\_\_ Phone: \_\_\_\_\_ Fax: \_\_\_\_\_

City \_\_\_\_\_ State \_\_\_\_\_ Zip \_\_\_\_\_

E-mail Address \_\_\_\_\_

Property Owner Signature\* [Signature]

\* An authorized agent may sign in lieu of the property owner for Final Maps, Tentative Maps, and Parcel Maps.  
 Print Name Elinn Fagg, AICP

Subscribed and sworn before me  
 This 16<sup>th</sup> day of DECEMBER, 20 10

[Signature]

Notary Public in and for said County and State

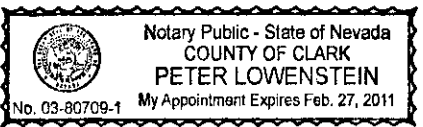

Revised 10/27/08

**FOR DEPARTMENT USE ONLY**

Case #	<u>ZON-40496</u>
Meeting Date:	<u>2/8/11</u>
Total Fee:	<u>\$1,200.00</u>
Date Received:*	<u>12/16/10</u>
Received By:	<u>[Signature]</u>

\*The application will not be deemed complete until the submitted materials have been reviewed by the Planning and Development Department for consistency with applicable sections of the Zoning Ordinance.



**PLANNING & DEVELOPMENT DEPARTMENT**

**STATEMENT OF FINANCIAL INTEREST**

Case Number: **ZON-40496** APN: 138-32-802-001

Name of Property Owner: City of Las Vegas

Name of Applicant: City of Las Vegas, % Flinn Fagg, AICP

Name of Representative: \_\_\_\_\_

To the best of your knowledge, does the Mayor or any member of the City Council or Planning Commission have any financial interest in this or any other property with the property owner, applicant, the property owner or applicant's general or limited partners, or an officer of their corporation or limited liability company?

Yes

No

If yes, please indicate the member of the City Council or Planning Commission who is involved and list the name(s) of the person or persons with whom the City Official holds an interest. Also list the Assessor's Parcel Number if the property in which the interest is held is different from the case parcel.

City Official: \_\_\_\_\_

Partner(s): \_\_\_\_\_

APN: \_\_\_\_\_

Signature of Property Owner: *Flinn Fagg*

Print Name: Flinn Fagg, AICP

Subscribed and sworn before me

This 16<sup>th</sup> day of December, 20 10

*[Signature]*

Notary Public in and for said County and State



# PLANNING & DEVELOPMENT



DEVELOPMENT SERVICES CENTER

731 S. Fourth Street  
Las Vegas, NV 89101

Voice: 702-229-6301  
Fax: 702-474-0352  
TTY: 702-386-9108

[www.lasvegasnevada.gov](http://www.lasvegasnevada.gov)

December 16, 2010

Mr. Steve Gebeke  
Planning and Development Department  
731 S 4<sup>th</sup> Street  
Las Vegas, NV 89101

**RE: ZON-40496**  
**Assessor's Parcel Number 138-32-802-001**

Dear Mr. Gebeke:

In regard to the subject parcel, staff has determined that the existing General Plan designation and zoning classification are inconsistent with possible future development. In order to resolve this inconsistency and ensure that future development is compatible with existing development, staff is proposing to change the zoning district of the subject parcel to C-V (Civic). Please call me at 229-4693 with any questions.

Sincerely,

Peter Lowenstein, AICP  
Planning Supervisor  
Planning & Development Department

Mayor  
Oscar B. Goodman

City Council  
Gary Reese  
(Mayor Pro Tem)  
Steve Wolfson  
Lais Tarkanian  
Steven D. Ross  
Ricki Y. Barlow  
Stavros S. Anthony

City Manager  
Elizabeth N. Fretwell



**ZON-40496**

ORIGINAL (2)

Alta IRS #2

# GRANT DEED

THIS INSTRUMENT WITNESSETH: That WILLIAM PECCOLE, as Trustee of the PECCOLE 1982

TRUST dated February 15, 1982

for and in consideration of \$1.00 and other good and valuable considerations, the receipt of which is hereby acknowledged, do hereby Grant, Bargain and Convey to the CITY OF LAS VEGAS, a Municipal Corporation of the County of Clark, State of Nevada, and to its agents forever, all of \_\_\_\_\_ right, title and interest

in and to all that real property situate in the City of Las Vegas County of Clark, State of Nevada, bounded and described as follows:

That portion of the East Half (E 1/2) of the Southeast Quarter (SE 1/4) of Section 32, T. 20 S., R. 60 E., City of Las Vegas, Clark County, Nevada, described as follows:

COMMENCING at the Southeast Corner (SE Cor.) of said East Half (E 1/2) of the Southeast Quarter (SE 1/4); thence N.00°12'00"W., along the East line thereof, 667.26 feet to the TRUE POINT OF BEGINNING; thence N.46°21'24"W., 393.78 feet; thence S143°38'36"E., 120.00 feet to a point of tangency with a curve concave Northwesterly and having a radius of 900.00 feet; thence Northeasterly along said curve, through a central angle of 24°39'19", an arc distance of 387.28 feet to a point, a radial line to said point bears S.71°00'43"E., said point being on the East line of the aforementioned Southeast Quarter (SE 1/4); thence S100°12'00"E., along said East line, 686.93 feet to the TRUE POINT OF BEGINNING.

Containing 2.004 acres, (het) more or less.

Parcel 450-180-002

Together with all and singular the tenements, hereditaments and appurtenances thereto belonging or in anywise appertaining.

Witness my hand and seal this 1st day of December, 1986.

William Peccole  
WILLIAM PECCOLE

STATE OF NEVADA

COUNTY OF CLARK

On 1st December 1, 1986

personally appeared before me, a Notary Public

WILLIAM PECCOLE

who acknowledged that he executed the above

Instrument

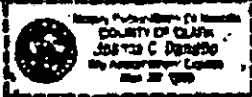

SEAL

James C. Daniels  
Notary Public in and for said County and State

WILL BE RECORDED MAIL TO:

City Clerk - City Hall  
400 East Stewart Avenue  
Las Vegas, Nevada 89101

SPACE BELOW FOR RECORDER'S USE ONLY

ZON-36091  
11/05/09 PC

ORIGINAL

RESOLUTION of ACCEPTANCE OF GRANT DEED

On motion of Councilman Lurie, and carried unanimously, the following Resolution is adopted, and order made:

BE IT RESOLVED, this 3rd day of December, 1986, by the City Council of the City of Las Vegas, County of Clark, State of Nevada, that the Grant Deed

dated the 1st day of December, 1986, executed by WILLIAM PECCOLE, as Trustee of the PECCOLE 1982 TRUST dated February 15, 1982. (Parcel # 450-180-002

to the City of Las Vegas, County of Clark, State of Nevada, and that the real property described therein be, and is hereby accepted, for the purpose of Real Property Acquisition; and

BE IT FURTHER RESOLVED, that a copy of this Resolution be attached to said Grant Deed and that the same be recorded in the Office of the County Recorder of the County of Clark, State of Nevada, and this resolution to be filed in the records of this Board.

STATE OF NEVADA }
COUNTY OF CLARK }

I, CAROL ANN HAWLEY, City Clerk, of the City of Las Vegas, County of Clark, State of Nevada, hereby certifying the foregoing to be a full, true and correct copy of the Resolution accepting the Grant Deed attached hereto duly adopted at a regular meeting of the City Council held on the 3rd day of December, 1986.

IN WITNESS WHEREOF, I have hereto set my hand and affixed my official seal this 3rd day of December, 1986.

Carol Ann Hawley
CAROL ANN HAWLEY
Clerk of the City of Las Vegas

By Deputy

FOR: Real Property Acquisition

WHEN RECORDED, MAIL TO:
City Clerk-City Hall
400 East Stewart Avenue
Las Vegas, Nevada 89101



CLARK COUNTY NEVADA
JOAN G. SWIFT, RECORDER
RECORDED AT REQUEST OF

CITY OF LAS VEGAS
Dec 8 2 05 PM '86

ALL DEPUTY
OFFICIAL RECORDS
BOOK 00694

861208

Handwritten initials