

**REZONING Parcel: 125-25-201-006
ZON - 40051**



ZONING

	U		R-MH		PD		Subject Parcel
	R-A		R-CI		T-D		City Limits
	R-F		R-2		TC		ROI Zoning
	R-D		R-3		C-2		
	C-PB		R-4		C-D		
	P-C		R-1		C-1		
			R-5		M		

FROM U(PF) TO C-V



City maps are continually updated and only the most current version of the City of Houston Official Code, Ordinance, and City Map are for reference only. For the most current information, please contact the Planning & Development Dept. 713-251-6303



REZONING Parcel: 125-25-201-006

ZON - 40051

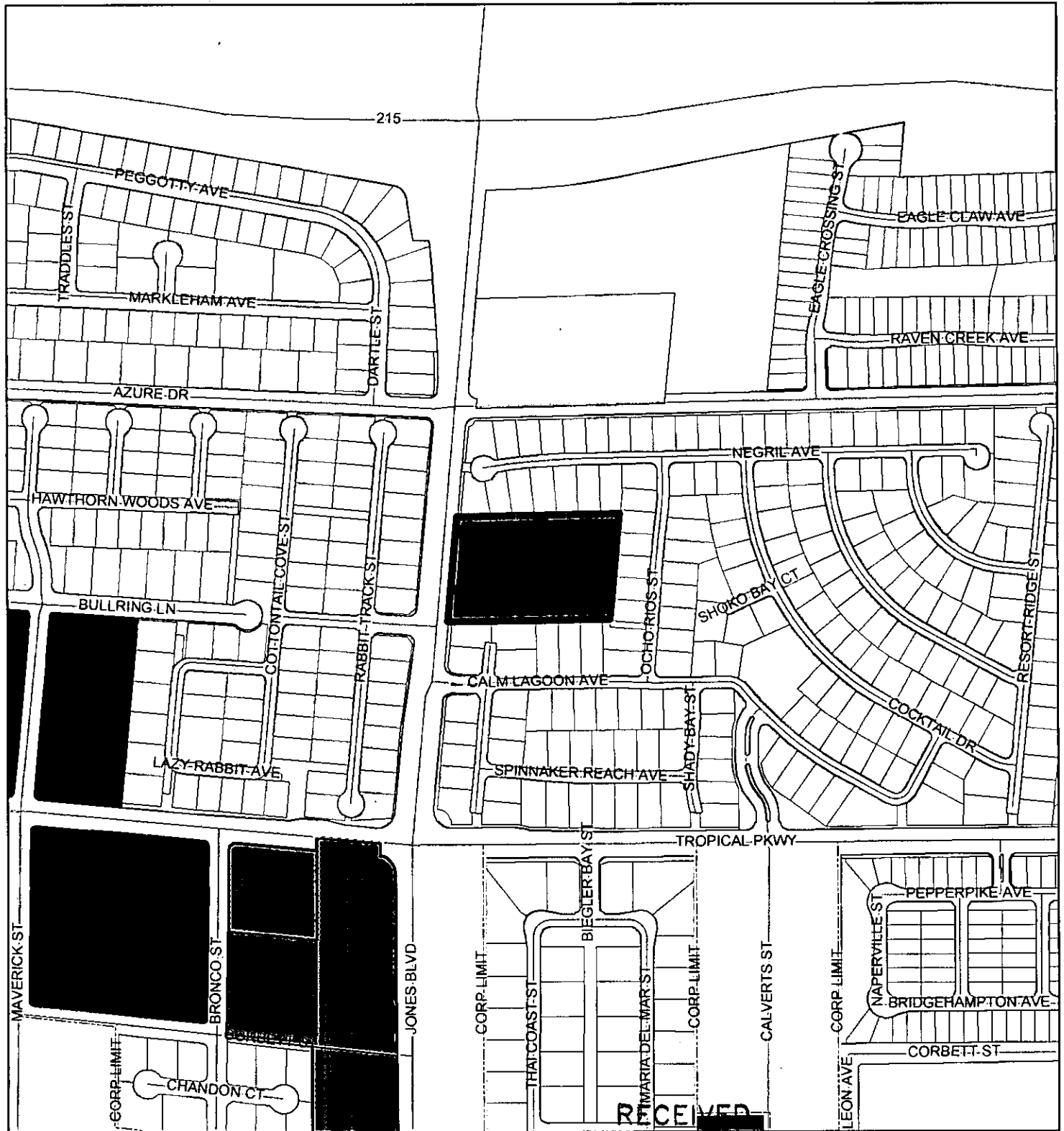

ZONING

C-V	R-MH	R-3	O
C-PB	R-CL	R-4	C-D
P-C	R-2	R-5	C-1
U	R-D	R-MHP	PD
R-A	R-PD	P-R	T-D
R-E	R-1	N-S	TC

C-2	Subject Parcel
C-M	City Limits
M	ROI Zoning

OCT 27 2010 FROM U(PF) TO C-V



GIS maps are normally produced only to meet the needs of the City. Due to continuous development activity this map is for reference only. Geographic Information System Planning & Development Dept. 702-229-6301



Printed: October 26, 2010

City of Las Vegas
Planning & Development Department
Development Services Center
731 S. Fourth Street
Las Vegas, Nevada 89101-2986

Return Service Requested
Official Notice of Public Hearing

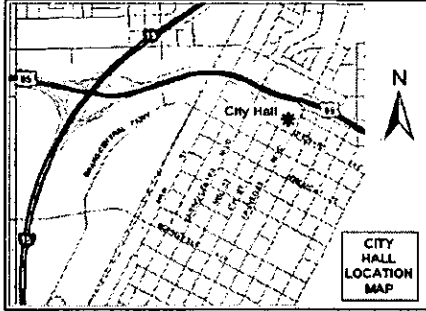

If you wish to file your protest or support on this request, check the appropriate box below and return this card in an envelope with postage to the Planning & Development Department at the address listed above or fax this side of this card to (702) 385-7268. If you would like to contact your Council Representative, please call (702) 229-6405.

I SUPPORT
this Request

I OPPOSE
this Request

Please use available blank space on card for your comments.

ZON-40051

Planning Commission Meeting of 12/16/2010

PRESORTED
FIRST CLASS



UNITED STATES POSTAGE
02 1M
6004279218
MAILED FROM ZIP CODE 89101
\$ 00.41⁴
DEC 03 2010

RECEIVED
DEC 16 2010

12525211033
CAMPBELL MICHAEL L & M DIANE
5713 CALM LAGOON AVE
LAS VEGAS NV 89130-7076

Case: ZON-40051

12525211033



City of Las Vegas
Planning & Development Department
Development Services Center
731 S. Fourth Street
Las Vegas, Nevada 89101-2986

Return Service Requested
Official Notice of Public Hearing

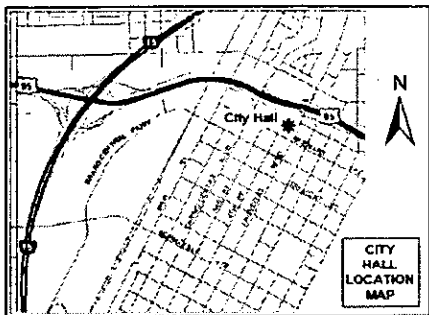

If you wish to file your protest or support on this request, check the appropriate box below and return this card in an envelope with postage to the Planning & Development Department at the address listed above or fax this side of this card to (702) 385-7268. If you would like to contact your Council Representative, please call (702) 229-6405.

I SUPPORT
this Request

I OPPOSE
this Request

Please use available blank space on card for your comments.

ZON-40051

Planning Commission Meeting of 12/16/2010

PRESORTED
FIRST CLASS



UNITED STATES POSTAGE
02 1M \$ 00.414
0004279218 DEC 03 2010
MAILED FROM ZIP CODE 89101

RECEIVED
DEC 08 2010

12525213035
JONES FAMILY TRUST
6121 OCHO RIOS ST
LAS VEGAS NV 89130-7217

Case: ZON-40051

6A

City of Las Vegas
Planning & Development Department
Development Services Center
731 S. Fourth Street
Las Vegas, Nevada 89101-2986

Return Service Requested
Official Notice of Public Hearing

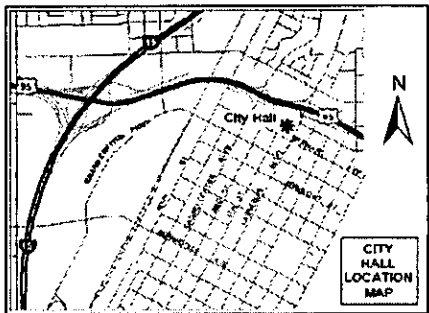

If you wish to file your protest or support on this request, check the appropriate box below and return this card in an envelope with postage to the Planning & Development Department at the address listed above or fax this side of this card to (702) 385-7268. If you would like to contact your Council Representative, please call (702) 229-6405.

I SUPPORT
this Request

I OPPOSE
this Request

Please use available blank space on card for your comments.

ZON-40051

Planning Commission Meeting of 12/16/2010

PRESORTED
FIRST CLASS



UNITED STATES POSTAGE
02 1M \$ 00.414
0004279218 DEC 03 2010
MAILED FROM ZIP CODE 89101

12525215024
BRADY HORACE E JR & ANTOINETTE J
6116 PORT OF DREAMS DR
LAS VEGAS NV 89130-7094

Case: ZON-40051

6A

JAN 05 11 05 10



City of Las Vegas
Planning & Development Department
Development Services Center
731 S. Fourth Street
Las Vegas, Nevada 89101-2986

Return Service Requested
Official Notice of Public Hearing

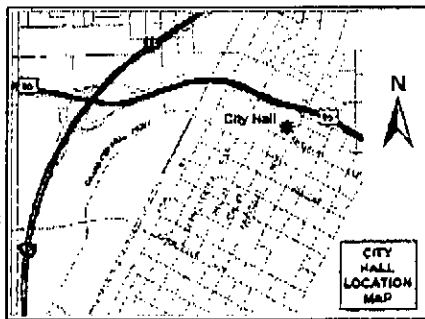

If you wish to file your protest or support on this request, check the appropriate box below and return this card in an envelope with postage to the Planning & Development Department at the address listed above or fax this side of this card to (702) 385-7268. If you would like to contact your Council Representative, please call (702) 229-6405.

I SUPPORT
this Request

I OPPOSE
this Request

Please use available blank space on card for your comments.

ZON-40051

Planning Commission Meeting of 12/16/2010

PRESORTED
FIRST CLASS



UNITED STATES POSTAGE
02 1M \$ 00.41⁴
0004279218 DEC 03 2010
MAILED FROM ZIP CODE 89101

RECEIVED
DEC 17 2010

12526810063 Case: ZON-40051
GRIMMETT JARROD A & SHANNAN M
6020 RABBIT TRACK ST
LAS VEGAS NV 89130-1351

JAN 05 11 89130



City of Las Vegas
Planning & Development Department
Development Services Center
731 S. Fourth Street
Las Vegas, Nevada 89101-2986

Return Service Requested
Official Notice of Public Hearing

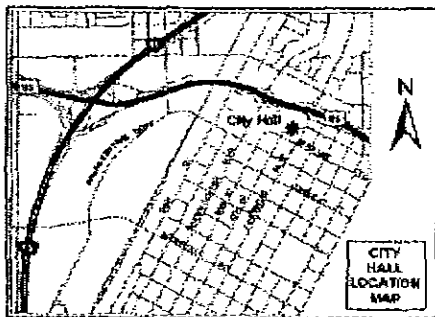

If you wish to file your protest or support on this request, check the appropriate box below and return this card in an envelope with postage to the Planning & Development Department at the address listed above or fax this side of this card to (702) 385-7268. If you would like to contact your Council Representative, please call (702) 229-6405.

I SUPPORT
this Request

I OPPOSE
this Request

Please use available blank space on card for your comments.

ZON-40051

Planning Commission Meeting of 12/16/2010

RESORTED
FIRST CLASS



UNITED STATES POSTAGE
02 1M \$ 00.414
9004279216 DEC 03 2010
MAILED FROM ZIP CODE 89101

RECEIVED
DEC 13 2010

Case: ZON-40051
12525213027
BUFF RANDY S JR & HEATHER M
5808 CALM LAGOON AVE
LAS VEGAS NV 89130-7219

09/02/11 09:13:00



69

FROM : S&L MODLER

PHONE NO. : 702 363 7423

Dec. 15 2010 01:38PM P1

City of Las Vegas
Planning & Development Department
Development Services Center
731 S. Fourth Street
Las Vegas, Nevada 89101-2986

**Return Service Requested
Official Notice of Public Hearing**

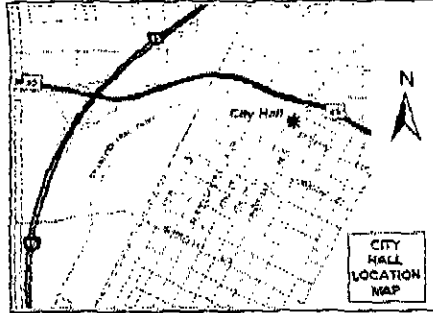

If you wish to file your protest or support on this request, check the appropriate box below and return this card in an envelope with postage to the Planning & Development Department at the address listed above or fax this side of this card to (702) 385-7268. If you would like to contact your Council Representative, please call (702) 229-6405.



I SUPPORT
this Request



I OPPOSE
this Request

Please use available blank space on card for your comments.

ZON-40051

Planning Commission Meeting of 12/16/2010

PRESORTED
FIRST CLASS

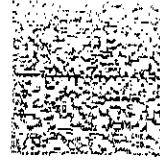

\$ 00.414

DEC 15 2010
MAILED FROM ZIP CODE 89101

RECEIVED
DEC 15 2010

12525215041
MODLER STEPHEN R & LILY C
6121 PORT OF DREAMS DR
LAS VEGAS NV 89130-7094

Case: ZON-40051

12525215041



6A

Planning & Development Department
APPLICATION SUBMITTAL CHECKLIST

Additional Notes

Conference		Item Required	Additional Notes
YES	NO		
APPLICATION			
<input checked="" type="checkbox"/>	<input type="checkbox"/>	Signed and notarized by <i>all</i> property owners or authorized agent(s)	
<input checked="" type="checkbox"/>	<input type="checkbox"/>	Grant deed and legal description	
<input checked="" type="checkbox"/>	<input type="checkbox"/>	<i>Detailed</i> justification letter	
<input checked="" type="checkbox"/>	<input type="checkbox"/>	Reduced 8.5" x 11" copy of <i>all</i> plans and elevations	
<input checked="" type="checkbox"/>	<input type="checkbox"/>	Full size, rolled, color copy of <i>all</i> plans and elevations	
<input checked="" type="checkbox"/>	<input type="checkbox"/>	Correct fee(s): \$ <u>700</u> \$ <u>500</u> \$ <u>-</u> Total = \$ <u>1,200</u>	
<input checked="" type="checkbox"/>	<input type="checkbox"/>	Assessor Parcel Map	
<input checked="" type="checkbox"/>	<input type="checkbox"/>	Statement of Financial Interest	
<input type="checkbox"/>	<input checked="" type="checkbox"/>	Development Impact Notice and Assessment (DINA)	
<input type="checkbox"/>	<input checked="" type="checkbox"/>	Project of Regional Significance	
<input type="checkbox"/>	<input checked="" type="checkbox"/>	Copy of Business Licenses (Owner, Applicant, Representative)	
SITE PLAN		Folded Plans: <u>6</u>	Rolled/Colored Plans: <u>1</u>
<input checked="" type="checkbox"/>	<input type="checkbox"/>	11" x 17" min. to 24" x 36" max. page size	
<input checked="" type="checkbox"/>	<input type="checkbox"/>	North arrow, scale, and vicinity map	
<input checked="" type="checkbox"/>	<input type="checkbox"/>	<i>All</i> property lines and present dimensions labeled	
<input type="checkbox"/>	<input checked="" type="checkbox"/>	<i>All</i> building setbacks labeled	
<input checked="" type="checkbox"/>	<input type="checkbox"/>	<i>All</i> adjacent existing land uses and street names labeled	
<input type="checkbox"/>	<input checked="" type="checkbox"/>	<i>All</i> points of ingress and egress shown	
<input type="checkbox"/>	<input checked="" type="checkbox"/>	ADA accessibility requirements shown/labeled	
<input type="checkbox"/>	<input checked="" type="checkbox"/>	Parking standard(s) utilized: _____	
<input type="checkbox"/>	<input checked="" type="checkbox"/>	Parking space count and typical dimensions labeled #regular #compact #handicap Total	
<input type="checkbox"/>	<input checked="" type="checkbox"/>	<i>All</i> free-standing sign locations shown and heights and sizes noted	
LANDSCAPE PLAN		Folded Plans:	Rolled/Colored Plans:
<input type="checkbox"/>	<input checked="" type="checkbox"/>	11" x 17" min. to 24" x 36" max. page size	
<input type="checkbox"/>	<input checked="" type="checkbox"/>	North arrow, scale, and vicinity map	
<input type="checkbox"/>	<input checked="" type="checkbox"/>	<i>All</i> property lines and present dimensions labeled	
<input type="checkbox"/>	<input checked="" type="checkbox"/>	<i>All</i> required perimeter landscape planters shown	
<input type="checkbox"/>	<input checked="" type="checkbox"/>	<i>All</i> required parking lot fingers/islands shown	
<input type="checkbox"/>	<input checked="" type="checkbox"/>	Quantity, size, species/variety of <i>all</i> trees, shrubs, and ground cover	
BUILDING ELEVATIONS		Folded Plans:	Rolled/Colored Plans:
<input type="checkbox"/>	<input checked="" type="checkbox"/>	11" x 17" min. to 24" x 36" max. page size	
<input type="checkbox"/>	<input checked="" type="checkbox"/>	Scale and building dimensions labeled	
<input type="checkbox"/>	<input checked="" type="checkbox"/>	North, south, east, and west elevations of <i>all</i> buildings	
<input type="checkbox"/>	<input checked="" type="checkbox"/>	<i>All</i> building materials and colors noted	
<input type="checkbox"/>	<input checked="" type="checkbox"/>	8" x 10" photo of original color and material board	
<input type="checkbox"/>	<input checked="" type="checkbox"/>	<i>All</i> wall sign locations shown and sizes noted	
FLOOR PLANS		Folded Plans:	Rolled Plans:
<input type="checkbox"/>	<input checked="" type="checkbox"/>	11" x 17" min. to 24" x 36" max. page size	
<input type="checkbox"/>	<input checked="" type="checkbox"/>	Scale and building dimensions labeled	
<input type="checkbox"/>	<input checked="" type="checkbox"/>	<i>All</i> building entrances/exits shown	
<input type="checkbox"/>	<input checked="" type="checkbox"/>	Use of <i>all</i> rooms noted/labeled	

THIS FORM MUST ACCOMPANY THE APPLICATION SUBMITTAL and is valid for no more than 60 days after the Pre-App date.

Applicant: CITY OF LAS VEGAS Application Type: REZONING [U(PF) TO C-V]
 APN: 125-25-201-006 Location: 6120 N. JONES BLVD
 Planner: [Signature] Pre-App Meeting Date: 10/18/10 Earliest PC Date: 12/16/10



January 20, 2011

LAS VEGAS CITY COUNCIL

OSCAR B. GOODMAN
MAYOR

GARY REESE
MAYOR PRO TEM

STEVE WOLFSON

LOIS TARKANIAN

STEVEN D. ROSS

RICKI Y. BARLOW

STAVROS S. ANTHONY

ELIZABETH N. FRETWELL
CITY MANAGER

Mr. Tom Dombrowski
Nevada Power Company
PO Box 98910
Las Vegas, Nevada 89193

RE: ZON-40051 - REZONING
CITY COUNCIL MEETING OF JANUARY 19, 2011

Dear Mr. Dombrowski:

The City Council at a regular meeting held January 19, 2011, APPROVED the request for a Rezoning FROM: U (UNDEVELOPED) [PF (PUBLIC FACILITIES) GENERAL PLAN DESIGNATION] TO: C-V (CIVIC) on 3.85 acres at 6120 North Jones Boulevard (APN 125-25-201-006). The Notice of Final Action was filed with the Las Vegas City Clerk on January 20, 2011.

Sincerely,

A handwritten signature in cursive script, appearing to read "Lean Coleman".

Lean Coleman
Deputy City Clerk II for
Beverly K. Bridges, MMC, City Clerk

cc: Mr. Peter Lowenstein
City of Las Vegas
731 South Fourth Street, 2nd Floor
Las Vegas, Nevada 89101

CITY OF LAS VEGAS
400 STEWART AVENUE
LAS VEGAS, NEVADA 89101

VOICE 702.229.6011
TTY 702.386.9108
www.lasvegasnevada.gov

FM-0044-08-09

PLANNING & DEVELOPMENT

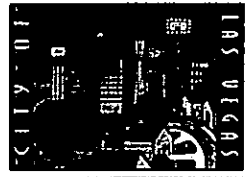

DEVELOPMENT SERVICES CENTER

731 S. Fourth Street
Las Vegas, NV 89101

Voice: 702-229-6301
Fax: 702-474-0352
TTY: 702-386-9108

www.lasvegasnevada.gov

December 17, 2010

Mr. Tom Dombrowski
Nevada Power Company
PO Box 98910
Las Vegas, Nevada 89193

**RE: ZON-40051 - REZONING
PLANNING COMMISSION MEETING OF DECEMBER 16, 2010**

Dear Mr. Dombrowski:

Your request for a Rezoning FROM: U (UNDEVELOPED) [PF (PUBLIC FACILITIES) GENERAL PLAN DESIGNATION] TO: C-V (CIVIC) on 3.85 acres at 6120 North Jones Boulevard (APN 125-25-201-006), Ward 6 (Ross), was considered by the Planning Commission on December 16, 2010.

The Planning Commission voted to recommend **APPROVAL** of your request.

This item will be considered by the City Council on January 19, 2011, at 1:00 P.M. in the Council Chambers of City Hall, 400 Stewart Avenue, Las Vegas, Nevada. **The Council requires that you or your representative be present at this meeting.** If you or your representative chooses not to attend, the City Council may act in your absence without your input.

Sincerely,

Steve Gebeke, AICP
Planning Supervisor
Case Planning Division

SG:clb

cc: Mr. Peter Lowenstein
City of Las Vegas
731 South Fourth Street, 2nd Floor
Las Vegas, Nevada 89101

Mayor
Oscar B. Goodman
City Council
Gary Reese
(Mayor Pro Tem)
Steve Wolfson
Lois Tarkanian
Steven D. Ross
Ricki Y. Barlow
Stavros S. Anthony
City Manager
Elizabeth N. Fretwell



CITY OF LAS VEGAS

ONE MOTION/ONE VOTE



Planning and Development Department
Case Planning Division
731 South Fourth Street
Las Vegas, Nevada 89101
(702) 229-6301 Phone (702) 385-7268 Fax

SUBJECT: ZON-40051 - APPLICANT: CITY OF LAS VEGAS - OWNER: NEVADA POWER COMPANY

The above item has been placed on the One Motion/One Vote portion of the Planning Commission Agenda for the **DECEMBER 16, 2010** Planning Commission meeting. All of these items will be placed at the beginning of the agenda. The Chairman of the Planning Commission will open them at the same time.

Enclosed please find the proposed conditions of approval. If you agree to these conditions, please sign this form and fax it to **Carman Burney at (702) 385-7268**. If there is no one present at the Planning Commission meeting who wants to discuss this item, you will not be called to the podium to discuss the case. However, you must be present in case any Planning Commissioner or member of the public wants to discuss the item. If you have any questions, please contact my office at (702) 229-6301.

Please sign and date that you have read and agree to the conditions and return to our office by 5:00PM **DECEMBER 15, 2010**.

 <hr style="border: 0; border-top: 1px solid black;"/> <p style="text-align: center;">Signature</p>	<p style="font-size: 2em; margin: 0;">12/10/10</p> <hr style="border: 0; border-top: 1px solid black;"/> <p style="text-align: center;">Date</p>
<p style="font-size: 1.5em; margin: 0;">THOMAS DOMBROWSKI</p> <hr style="border: 0; border-top: 1px solid black;"/> <p style="text-align: center;">Please Print Name</p>	
<p style="font-size: 1.5em; margin: 0;">NV ENERGY</p> <hr style="border: 0; border-top: 1px solid black;"/> <p style="text-align: center;">Company Name</p>	

Sincerely,

Steve Gebeke, AICP
 Planning Supervisor
 Case Planning Division

RECEIVED
 DEC 10 2010

CC

P/L 353/316

Report of All Selected Parcels

Case Number: ZON-40051

Printed On: Mon: November 8, 2010

<u>Owner</u>	<u>Address</u>	<u>Parcel Number</u>
		12525297015
		12526697001
		12525297018
		12526697003
		12525297006
		12525297016
		12525197006
		12525397012
		12525397015
		12525297019
		12525297017
		12526597002
		12526697006
		12526697004
		12526697002
		12525397011
		12526697007
		12525297014
		12525297021
		12525197007
		12525297013
		12525197005
		12526697010
		12525397014
		12525397013
		12525297005
		12525297008
		12526697009
		12526697005
		12525297020
		12526597001
		12525297007

Report of All Selected Parcels**Case Number:** ZON-40051**Printed On:** Mon: November 8, 2010

<u>Owner</u>	<u>Address</u>	<u>Parcel Number</u>
6221 EAGLE CROSSING L L C	%AVALON REALTY & OAKTREE MGMT 500 ROSE ST LAS VEGAS NV	12525112039
AADLAND LARRY & SANDRA	6133 MARKLEHAM AVE LAS VEGAS NV	12526510039
ADAMS STEPHEN W & BARBARA	5921 NEGRIL AVE LAS VEGAS NV	12525214007
ADAMS THELONIOUS T	6229 HAWTHORN WOODS AVE LAS VEGAS NV	12526611058
AGGIERI ALBERT J & DIANE M	6029 PORT OF DREAMS DR LAS VEGAS NV	12525215033
ALAMO JEFFERY S & DELRA	6124 COCKTAIL DR LAS VEGAS NV	12525214024
ALLEN ROBERT P & JANEY L	5920 NEGRIL AVE LAS VEGAS NV	12525214010
ALSUP TREVER & KELLY	6128 COTTONTAIL COVE ST LAS VEGAS NV	12526610022
AMADOR RACHELLE F	6020 COTTONTAIL COVE ST LAS VEGAS NV	12526610047
AMATO ANTHONY G	6000 SHADY BAY ST LAS VEGAS NV	12525213006
ANDERSON MICHAEL G	6125 RABBIT TRACK ST LAS VEGAS NV	12526610012
ARCENAS LOUIE	6021 COTTONTAIL COVE ST LAS VEGAS NV	12526610070
ARIZA MAURICIO	9070 TIERRA SANTA AVE LAS VEGAS NV	12525111018
ARROYO CHRISTOPHER & TERESITA	6025 RABBIT TRACK ST LAS VEGAS NV	12526610055
ARSAGA PETER & MELISSA J	5900 NEGRIL AVE LAS VEGAS NV	12525214015
AUGUSTINE LAWRENCE L	6112 PORT OF DREAMS DR LAS VEGAS NV	12525215025
AXEL JESSE	9040 LOGGERS MILLS AVE LAS VEGAS NV	12525213025
B A C HOME LOANS SERVICING L P	400 COUNTRYWIDE WY SV-35 SIMI VALLEY CA	12526610031
B A C HOME LOANS SERVICING L P	400 COUNTRYWIDE WY SV-35 SIMI VALLEY CA	12526611048
BAGWELL KENNETH & DEANNA	5716 NEGRIL AVE LAS VEGAS NV	12525215001
BANK WELLS FARGO N A	4101 WISEMAN BLVD SAN ANTONIO TX	12525111019
BANTUM JOSEPH M & B L REV LIV TR	5909 NEGRIL AVE LAS VEGAS NV	12525214004
BANUELOS GILBERTO & LAURA	6220 DARTLE ST LAS VEGAS NV	12526510006
BARCLAY RANDALL O & EVA J	6120 OCHO RIOS ST LAS VEGAS NV	12525213036
BECK GEORGE P & PATRICIA A	5805 SHOKO BAY CT LAS VEGAS NV	12525214041
BELLON PETER J	6124 COTTENTAIL COVE ST LAS VEGAS NV	12526610021
BERG MARCIA	6113 COCKTAIL DR LAS VEGAS NV	12525214044
BLASKO OANIEL A & OEBRA L	6128 ARWELLS CORNER CT LAS VEGAS NV	12526611046
BOBADILLA JOSE & MARIA	6032 COTTONTAIL COVE ST LAS VEGAS NV	12526610050
BOUCHER NANCY J INHERITANCE TR	6125 COCKTAIL OR LAS VEGAS NV	12525214046
BOUCHER NANCY J SEPARATE PPTY TR	6125 COCKTAIL OR LAS VEGAS NV	12525214047
BRADY HORACE E JR & ANTOINETTE J	6116 PORT OF DREAMS DR LAS VEGAS NV	12525215024

Report of All Selected Parcels**Case Number:** ZON-40051**Printed On:** Mon: November 8, 2010

<u>Owner</u>	<u>Address</u>	<u>Parcel Number</u>
BRICENO LANA M	6024 RABBIT TRACK ST LAS VEGAS NV	12526610064
BUFF RANDY S JR & HEATHER M	5908 CALM LAGOON AVE LAS VEGAS NV	12525213027
BUTLER RONALD C & MICHELLE A	6025 COCKTAIL DR LAS VEGAS NV	12525214035
BUZZE THOMAS L & LORI A	135 SEVEN SPRINGS LOOP STATESVILLE NC	12525215020
BUZZIN ADRIANO & DEBRA A	5709 RAVEN CREEK AVE LAS VEGAS NV	12525111003
CAMERON DEBORAH I LIVING TRUST	6112 COCKTAIL DR LAS VEGAS NV	12525214027
CAMPBELL LESTER MACK & PATRICIA	6132 ARWELLS CORNER CT LAS VEGAS NV	12526611045
CAMPBELL MICHAEL L & M DIANE	5713 CALM LAGOON AVE LAS VEGAS NV	12525211033
CANTY MARY	6008 RABBIT TRACK ST LAS VEGAS NV	12526610060
CARNABY ROBYN C & RONALD J	6028 COCKTAIL DR LAS VEGAS NV	12525214033
CARR LIVING TRUST	6017 COTTONTAIL COVE ST LAS VEGAS NV	12526610069
CHANG WILLIAM M & FLORENCE L	466 36TH AVE SAN FRANCISCO CA	12526610013
CHENOWETH R & E LTD FAM PTNRSHIP	9811 W CHARLESTON BLVD #2-365 LAS VEGAS NV	12526610014
CHRISTENSEN JAMES R & CYNTHIA L	6008 SHADY BAY ST LAS VEGAS NV	12525213004
CHRISTIAN MICHELLE S & TERRY R	6016 BUNGALOW BAY ST LAS VEGAS NV	12525213054
CHURCH LUTHERAN LAMB GOD	6220 N JONES BLVD LAS VEGAS NV	12525101032
CISSELL NEVIL SHANE	5832 FARNSWORTH POND AVE LAS VEGAS NV	12525313026
COFFMAN IRVING MATTHEW & SUSAN H	6032 COCKTAIL DR LAS VEGAS NV	12525214032
COLFIN W L H LAND ACQUISITIONS	%K TRAENKLE 2450 BROADWAY 6TH FLR SANTA MONICA CA	12526704002
COLFIN W L H LAND ACQUISITIONS	%K TRAENKLE 2450 BROADWAY 6TH FLR SANTA MONICA CA	12526704001
COMSTOCK RYAN P & ELIZABETH J	6029 COCKTAIL DR LAS VEGAS NV	12525214036
CONDARCO RUDY JR	6128 RABBIT TRACK ST HENDERSON NV	12526610006
CONNOR FAMILY REVOCABLE LIV TR	4317 W LAKE MEAD BLVD LAS VEGAS NV	12526610059
COOK GLENDA R	5700 CALM LAGOON AVE LAS VEGAS NV	12525211041
COOPER FAMILY TRUST	5904 SPINNAKER REACH AVE LAS VEGAS NV	12525213059
COOPER RAYMOND R & VICTORIA L	6124 PORT OF DREAMS DR LAS VEGAS NV	12525215023
COPPERFIELD HOMEOWNERS ASSN	%US HOME CORP %S MACKALL 3016 W CHARLESTON #200 LAS VEGAS NV	12526511047
COPPERFIELD HOMEOWNERS ASSOC	%U S HOME CORPORATION 3016 W CHARLESTON BLVD #200 LAS VEGAS NV	12526510037
CORDNER MARK R	5800 FARNSWORTH POND AVE LAS VEGAS NV	12525313002
CORDOVA JOSEPH MICHAEL III	6029 RABBIT TRACK ST LAS VEGAS NV	12526610054
CORNBLETH HOWARD	6016 SHADY BAY ST LAS VEGAS NV	12525213002
COUMOU FRANK JOHAN & LUCINDA L	5901 SPINNAKER REACH AVE LAS VEGAS NV	12525213009

Report of All Selected Parcels**Case Number:** ZON-40051**Printed On:** Mon: November 8, 2010

<u>Owner</u>	<u>Address</u>	<u>Parcel Numbe</u>
COUNTY OF CLARK(PUBLIC WORKS)	500 S GRAND CENTRAL PKWY LAS VEGAS NV	12526501006
CROSS TERRY L & MARGRET K	5724 NEGRIL AVE LAS VEGAS NV	12525214021
CUSHLER LOUIS R	8000 SPRING MOUNTAIN RD #2159 LAS VEGAS NV	12525213029
CYRUS EDWARD T & SHARON D	5708 CALM LAGOON AVE LAS VEGAS NV	12525211039
D L J MORTGAGE CAPITAL INC	%SELECT PORTFOLIO SRVCING INC 3815 S W TEMPLE SALT LAKE CITY UT	12526510034
DALKE WANDA & GREGORY	6125 MARKLEHAM AVE LAS VEGAS NV	12526510041
DAMIAN FAMILY LIVING TRUST	665 TURQUOISE DR HERCULES CA	12526610018
DAVIS CARL F & MIRIAM R	6120 W AZURE DR LAS VEGAS NV	12526510046
DEMARIA RALPH & MERCEDES	5824 FARNSWORTH POND AVE LAS VEGAS NV	12525313027
DEMPSEY CONNIE & JDHN	5900 SPINNAKER REACH AVE LAS VEGAS NV	12525213060
DENTON JANET MELSON & MICHAEL L	10234 GARDEN STATE DR LAS VEGAS NV	12525213031
DLOUHY JOHN & MARIA	5901 NEGRIL AVE LAS VEGAS NV	12525214002
DOOM DAMIAN & CARRIE	6204 DARTLE ST LAS VEGAS NV	12526510002
DORAME GILBERT & ESTELLA REV TR	6036 COCKTAIL DR LAS VEGAS NV	12525214031
DUNN JAMES A & BARBARA J	5705 NEGRIL AVE LAS VEGAS NV	12525215021
EAGLE CROSSING COMMUNITY ASSN	630 TRADE CENTER DR #100 LAS VEGAS NV	12525111020
EASTERLING FORD M	5816 NEGRIL AVE LAS VEGAS NV	12525214016
EASTMOND FAMILY TRUST	6021 COCKTAIL DR LAS VEGAS NV	12525211042
EDISON MARK L & DONNA	6100 COCKTAIL DR LAS VEGAS NV	12525214030
ELWELL TOMAS L & GLORIOSA S	10389 PILOT MOUNTAIN CT LAS VEGAS NV	12526611096
EMERY TIMOTHY A & MARY E	5917 THAI COAST ST LAS VEGAS NV	12525313025
EPPS KRISTA	613 E LAMADRE WY LAS VEGAS NV	12526610066
ESTRADA ADRIAN A & CHONG C	6150 W AZURE DR LAS VEGAS NV	12526511001
FEDERAL NATIONAL MORTGAGE ASSN	1000 TECHNOLOGY DR MS 314 O'FALLON MO	12526510035
FEDERAL NATIONAL MORTGAGE ASSN	400 COUNTRYWIDE WY SV-35 SIMI VALLEY CA	12526610067
FIERSTEIN RANDALL K & CATHY A	5609 NEGRIL AVE LAS VEGAS NV	12525215012
FIFIELD STEWART D	6004 BUNGALOW BAY ST LAS VEGAS NV	12525213014
FORD DUANE K & JENNIFER S	6128 COCKTAIL DR LAS VEGAS NV	12525214023
FORNOF JOHN & JUDY	2304 SCOTTWOOD AVE TOLEDO OH	12525214014
FOSTER LILA I	6133 RUM RUNNER DR LAS VEGAS NV	12525215018
FRANK STACY	2885 RED ARROW DR LAS VEGAS NV	12525211040
FREMONT INVESTMENT & LOAN	3110 E GUASTI RD #500 ONTARIO CA	12526610033

Report of All Selected Parcels**Case Number:** ZON-40051**Printed On:** Mon: November 8, 2010

<u>Owner</u>	<u>Address</u>	<u>Parcel Number</u>
FRENCH CHERRI L	6100 PORT OF DREAMS DR LAS VEGAS NV	12525215027
FRIEDMAN BEAU	6013 ROLLING MEADOW ST LAS VEGAS NV	12526610039
FRISCH JACOLE L	5809 CALM LAGOON AVE LAS VEGAS NV	12525213046
GALANG HERMINIA C	P O BOX 28707 LAS VEGAS NV	12526610046
GALLEGOS FILIBERTO & GUADALUPE	6201 DARTLE ST LAS VEGAS NV	12526510045
GARCIA DAVID & JO ANNE L	6237 EAGLE CROSSING ST LAS VEGAS NV	12525112035
GARCIA ISAURO T & LELA	6109 OCHO RIOS ST LAS VEGAS NV	12525213032
GARCIA ORLANDO & JUDY C	6020 BUNGALOW BAY ST LAS VEGAS NV	12525213053
GARFIELD WILLIAM & PAMELA FAM TR	6017 RABBIT TRACK ST LAS VEGAS NV	12526610057
GARGARITANO HERMELINA T	39 EXCELSIOR AVE SAN FRANCISCO CA	12526610036
GAUDET FAMILY TRUST	5809 NEGRIL AVE LAS VEGAS NV	12525214050
GERACE SUSAN J REVOCABLE TRUST	6113 OCHO RIOS ST LAS VEGAS NV	12525213033
GIBBERT MICHAEL J & ELLANA B	6116 OCHO RIOS ST LAS VEGAS NV	12525213037
GIBBS DARREN & NICOLE	6129 RABBIT TRACK ST LAS VEGAS NV	12526610011
GILFOR NANCY L & RICHARD E TRUST	9353 FRESH SPRING DR LAS VEGAS NV	12526610015
GILSON GREGORY J & AMY L	5808 FARNSWORTH POND AVE LAS VEGAS NV	12525313001
GIOVI MARTIN M & PATRICIA	6113 PORT OF DREAMS DR LAS VEGAS NV	12525215039
GONZALEZ RECAREDO & HELEN	6028 COTTONTAIL COVE ST LAS VEGAS NV	12526610049
GORDON AARON J & DIANE M	6101 OCHO RIOS ST LAS VEGAS NV	12525213030
GORDON FAY LOUIS	1058 N ASH AVE RIALTO CA	12526610035
GREEN DANIEL L & KRISTINA M	%CUMORAH CREDIT UNION P O BOX 70060 LAS VEGAS NV	12526510009
GRIMMETT JARROD A & SHANNAN M	6020 RABBIT TRACK ST LAS VEGAS NV	12526610063
HALL MICHAEL D & VIRGINIA	6001 BUNGALOW BAY ST LAS VEGAS NV	12525213016
HALLGREN RICK	6020 ROLLING MEADOW LAS VEGAS NV	12526610073
HANLON EILEEN P	6104 OCHO RIOS ST LAS VEGAS NV	12525213040
HANSON JAY M & KATHRYN	6137 COTTONTAIL COVE ST LAS VEGAS NV	12526610025
HARVEY JODIE E	6124 RABBIT TRACK ST LAS VEGAS NV	12526610005
HAYNES DARYL N	5720 CALM LAGOON AVE LAS VEGAS NV	12525211036
HEATHCOCK MICHAEL & BRETT	6017 BUNGALOW BAY ST LAS VEGAS NV	12525213020
HEIMLICH BRUCE	26175 PIERCE RD LOS GATOS CA	12526611054
HENDERSON SEAN E	6132 MOLLY MALONE CT LAS VEGAS NV	12526611053
HILL JOHN H & MARSHA LEA L	5801 NEGRIL AVE LAS VEGAS NV	12525214048

Report of All Selected Parcels**Case Number:** ZON-40051**Printed On:** Mon: November 8, 2010

<u>Owner</u>	<u>Address</u>	<u>Parcel Numbe</u>
HILLIARD LEWIS H & MARILYN J	5809 SHOKO BAY CT LAS VEGAS NV	12525214042
HODGES FREDERICK M & DIANA	6005 BUNGALOW BAY ST LAS VEGAS NV	12525213017
HOFFMAN BRIAN S & DAISYLYNN F	6033 CDCKTAIL DR LAS VEGAS NV	12525214037
HOFMANN JOSEPH D & EVA V	6041 COCKTAIL DR LAS VEGAS NV	12525214039
HOPE FAMILY TRUST	6125 PORT OF DREAMS DR LAS VEGAS NV	12525215042
HOSKING NORMAN D	6141 MARKLEHAM LAS VEGAS NV	12526511022
HUGGINS JAMES H	6225 EAGLE CROSSING ST LAS VEGAS NV	12525112038
HUGHES DOUG E JR & JENNIFER	6016 RABBIT TRACK ST LAS VEGAS NV	12526610062
HUGHES GREGORY J	6036 PORT OF DREAMS DR LAS VEGAS NV	12525215028
HUMPHREY GERALD LIVING TRUST	6129 PORT OF DREAMS DR LAS VEGAS NV	12525215043
HUNTER JONATHAN T & RACHEL	6133 RABBIT TRACK ST LAS VEGAS NV	12526610010
HYT COLBY	6108 RABBIT TRACK ST LAS VEGAS NV	12526610001
IVEY PHILLIP D	9811 W CHARLESTON BLVD #852 LAS VEGAS NV	12525112042
JOHNSON BALISA & KENNETH C	6112 OCHO RIOS ST LAS VEGAS NV	12525213038
JOHNSON MAURICE A & LATONYA D	5804 NEGRIL AVE LAS VEGAS NV	12525214019
JOHNSON WILLIAM ALBERT	5801 SHOKO BAY CT LAS VEGAS NV	12525214040
JOHNSTON MARLYS S TRUST	5812 ELPHIN CT NO LAS VEGAS NV	12525112043
JONES CARL O & MARIA D	6108 PORT OF DREAMS DR LAS VEGAS NV	12525215026
JONES FAMILY TRUST	6121 OCHO RIOS ST LAS VEGAS NV	12525213035
JORDAN FAMILY LIVING TRUST	6217 DARTLE ST LAS VEGAS NV	12526510036
JOSEPH DONNA A	5724 RAVEN CREEK AVE LAS VEGAS NV	12525112002
JOSHI BHANUPRASAD M & P B LIV TR	6013 COTTONTAIL COVE ST LAS VEGAS NV	12526610068
JOSHI JYOTI A	6025 COTTONTAIL COVE ST LAS VEGAS NV	12526610071
JOSHI SANGITA K	6021 RABBIT TRACK ST LAS VEGAS NV	12526610056
JUNG MARLENE	5996 CALVERTS ST LAS VEGAS NV	12525310037
K I C FUNDING L L C	%J KAVIANI 7656 BOCA RATON DR LAS VEGAS NV	12526510038
KAMLOT ARTHUR & LORETTA	5813 SPINNAKER REACH AVE LAS VEGAS NV	12525213008
KANAN COMPANY L L C	P O BOX 750522 LAS VEGAS NV	12525213044
KASIEWICZ EDWARD F TRUST	5341 SUPAI DR LAS VEGAS NV	12525215038
KIETA PING HAN	21215 FIBRE CT WALNUT CA	12526610043
KIM MYUNG B & YUCHA S	6216 TURTLE RUN AVE LAS VEGAS NV	12526610034
KLOSS KEVIN D & HEIDI E	5913 SPINNAKER REACH AVE LAS VEGAS NV	12525213012

Report of All Selected Parcels**Case Number:** ZON-40051**Printed On:** Mon: November 8, 2010

<u>Owner</u>	<u>Address</u>	<u>Parcel Number</u>
KOCH RONALD & JUDY EILEEN	P O BOX 2402 LETHBRIDGE AB T1J 4K8 CANADA	12525214009
KORICA STEVEN & LINDA	6120 COCKTAIL DR LAS VEGAS NV	12525214025
KYLES ANDREW L	6120 RABBIT TRACK ST LAS VEGAS NV	12526610004
LAPOINTE STANLEY III & CARRIE	5809 SPINNAKERREACH AVE LAS VEGAS NV	12525213007
LAR-MAR TRUST	6133 COTTONTAIL COVE ST LAS VEGAS NV	12526610026
LASIC KAY & PETER	6109 RABBIT TRACK ST LAS VEGAS NV	12526610016
LEE KENNETH O	5924 MARIA DEL MAR ST LAS VEGAS NV	12525313003
LEE LARRY E & PATRICIA	6125 COTTONTAIL COVE ST LAS VEGAS NV	12526610028
LEE MICHAEL T & SANDRA K	8297 GARNET CANYON LN LAS VEGAS NV	12526611059
LOFTSGAARDEN LAURA	3852 OAK HILL AVE LOS ANGELES CA	12525213056
LOPEZ RICHARD JR	23620 ROAD 180 LINDSAY CA	12525215007
LORELLI ERNEST J & CHRISTINE M	5812 SPINNAKER REACH AVE LAS VEGAS NV	12525213061
LOY MARK D & KIRA C	5917 CALM LAGOON AVE LAS VEGAS NV	12525213052
M A G LIVING TRUST	%M GLOVINSKY ETAL 5990 N JONES BLVD LAS VEGAS NV	12525310001
MAAS JAMES & PAULA	5701 CALM LAGOON AVE LAS VEGAS NV	12525211031
MACDONALD BEVERLY A REV LIV TR	6128 RUM RUNNER DR LAS VEGAS NV	12525215013
MACTAL REYNALDO L & CORAZON A	6012 RABBIT TRACK ST LAS VEGAS NV	12526610061
MAES HERMAN	4021 W CAREY AVE NO LAS VEGAS NV	12526510043
MAHAR PATRICK & JOANNE	6117 PORT OF DREAMS DR LAS VEGAS NV	12525215040
MANN PAMELA S TRUST	5812 NEGRIL AVE LAS VEGAS NV	12525214017
MARESH SILVIU & COSETTE	5022 VISTA LOMA WY LAS VEGAS NV	12525213028
MARINO FAMILY TRUST	6112 RABBIT TRACK ST LAS VEGAS NV	12526610002
MARON RICHARD H & SHARON P	953 DARLENE CT UPLAND CA	12525214005
MARSHALL ROBERT & ANN TRUST	26582 ESPALTER DR MISSION VIEJO CA	12526510044
MARTIN ERIC A	6024 BUNGALOW BAY ST LAS VEGAS NV	12525213024
MARTIN MICHAEL A	5705 RAVEN CREEK AVE LAS VEGAS NV	12525111004
MATTIA CHERYL REVOCABLE TR 2001	5916 NEGRIL AVE LAS VEGAS NV	12525214011
MAYES BOBBY LYNN	6021 ROLLING MEADOW ST LAS VEGAS NV	12526610037
MAZZOLA PAUL J & SHIRLEY ANN	6020 SHADY BAY ST LAS VEGAS NV	12525213001
MCCAMISH KEVIN R & DONNA M	6116 COTTONTAIL COVE ST LAS VEGAS NV	12526610019
MCDERMOTT FAMILY TRUST	5709 NEGRIL AVE LAS VEGAS NV	12525215022
MCGRIFF ERNEST & ANN E	6217 EAGLE CROSSING ST LAS VEGAS NV	12525112040

Report of All Selected Parcels**Case Number:** ZON-40051**Printed On:** Mon: November 8, 2010

<u>Owner</u>	<u>Address</u>	<u>Parcel Number</u>
MCHARGUE LARRY & STEPHANIE	6129 COTTONTAIL COVE ST LAS VEGAS NV	12526610027
MCMAHAN JAMES I & CLAUDETTE D	5808 NEGRIL AVE LAS VEGAS NV	12525214018
MCTEAR KEVIN A	5925 NEGRIL AVE LAS VEGAS NV	12525214008
MEEKER JEFFREY L	6025 BUNGALOW BAY ST LAS VEGAS NV	12525213021
MEHN DENNIS LEE	6037 RABBIT TRACK ST LAS VEGAS NV	12526610052
MEROLA MARIO & SHARON	6201 EAGLE CROSSING ST LAS VEGAS NV	12525112044
MILLER FAMILY REVOCABLE LIV TR	5813 CALM LAGOON AVE LAS VEGAS NV	12525213047
MITCHELL WARREN N	5800 CALM LAGOON AVE LAS VEGAS NV	12525213045
MODLER STEPHEN R & LILY C	6121 PORT OF DREAMS DR LAS VEGAS NV	12525215041
MOFFETT MICHAEL K & TERI R	5700 NEGRIL AVE LAS VEGAS NV	12525215005
MONATO JOHNEIL B	6201 LAZY RABBIT AVE LAS VEGAS NV	12526610045
MOORE JAMES H & DIANNA L	5717 RAVEN CREEK AVE LAS VEGAS NV	12525111001
MOORE TRACY & KELLEEN	5909 CALM LAGOON AVE LAS VEGAS NV	12525213050
MOORMAN DENISE REVOCABLE LIV TR	5912 CALM LAGOON AVE LAS VEGAS NV	12525213026
MORA JOSE	6024 ROLLING MEAOOWS ST LAS VEGAS NV	12526610072
MORENO RAYMUNDO S & HELEN PASTOR	6137 RABBIT TRACK ST LAS VEGAS NV	12526610009
MORGAN MIKE	6869 EAGLE WING CIR SPARKS NV	12526610029
MYK LISA M & JODY J	5912 NEGRIL AVE LAS VEGAS NV	12525214012
NELSON DENISE D	6213 LAZY RABBIT AVE LAS VEGAS NV	12526610042
NELSON HOWARD D & SUSAN L	6208 TURTLE RUN AVE LAS VEGAS NV	12526610032
NEVADA POWER COMPANY	%LAND SERV STA #9 P O BOX 98910 LAS VEGAS NV	12525201006
NIEDERLE PETER & ANNA	16125 SE 156TH ST RENTON WA	12526610003
NORRIS BRIAN & CAROLYN	6136 COTTONTAIL COVE ST LAS VEGAS NV	12526610024
NOWAK FAMILY TRUST	6032 PORT OF DREAMS DR LAS VEGAS NV	12525215029
NOYES LINO A S & GARY L	6137 RUM RUNNER OR LAS VEGAS NV	12525215019
OGIER CHARLES E JR & NANCY K	6004 SHADY BAY ST LAS VEGAS NV	12525213005
OHASHI OANI & CHERYL	14418 SE 256TH PL KENT WA	12526610065
OLDRIDGE JARROD	5712 CALM LAGOON AVE LAS VEGAS NV	12525211038
OLESEN ERIK F LIVING TRUST	6012 SHADY BAY ST LAS VEGAS NV	12525213003
O'NEIL FRANK E	6028 OCHO RIOS ST LAS VEGAS NV	12525213018
O'NEIL FRANK E & JOANN R	6028 OCHO RIOS ST LAS VEGAS NV	12525213042
ONISHI CHRIS N	6116 COCKTAIL OR LAS VEGAS NV	12525214026

Report of All Selected Parcels**Case Number:** ZON-40051**Printed On:** Mon: November 8, 2010

<u>Owner</u>	<u>Address</u>	<u>Parcel Number</u>
ONO	5804 VEGAS DR LAS VEGAS NV	12525310002
O'REILLY TRACY & MICHAEL	5901 CALM LAGOON AVE LAS VEGAS NV	12525213048
OSBORN HERBERT D & PATRICIA L	6101 PORT OF DREAMS DR LAS VEGAS NV	12525215036
PALAGI MARTIN J & ELIZABETH J	5800 NEGRIL AVE LAS VEGAS NV	12525214020
PAQUETTE HAROLD R & CHARLENE M	6000 BUNGALOW BAY ST LAS VEGAS NV	12525213015
PARADISE FALLS HOMEOWNERS ASSN	%NICKLIN PPTY MGMT 375 N STEPHANIE ST #911-B HENDERSON NV	12525211053
PARRA JOSE A	6225 HAWTHORN WODDS AVE LAS VEGAS NV	12526611057
PATTERSON JOHN D JR & KAYO	1655 KANUNU ST #601 HONOLULU HI	12525214034
PEARCE JEFFREY M & MIRANDA A	6117 COTTONTAIL COVE LAS VEGAS NV	12526610030
PEREZ RAQUEL	6129 MARKLEHAM AVE LAS VEGAS NV	12526510040
PERRY RODNEY E	6837 W CHARLESTON BLVD LAS VEGAS NV	12526610051
PHILLIPS KEITH ALAN & TAMARA L	6200 DARTLE ST LAS VEGAS NV	12526510001
PISTONE TED R & LINDA L	6124 MOLLY MALONE LAS VEGAS NV	12526611055
PLANA CORALYNN L & MAR C	6129 MOLLY MALONE CT LAS VEGAS NV	12526611051
POLANCO NOE A	6125 PEGGOTTY AVE LAS VEGAS NV	12526510033
POMO HECTOR & APRIEL	6013 RABBIT TRACK ST LAS VEGAS NV	12526610058
PRESENT MARJORIE	6029 BUNGALOW BAY ST LAS VEGAS NV	12525213022
QUINTERO-OSUNA SERGIO R	6108 COTTONTAIL COVE ST LAS VEGAS NV	12526610017
RAMO AMER	6237 HAWTHORN WOODS AVE LAS VEGAS NV	12526611060
RAST JAMES E	6205 LAZY RABBIT AVE LAS VEGAS NV	12526610044
REED ROBERT E & SHARON	5905 NEGRIL AVE LAS VEGAS NV	12525214003
REESE JOHN MICHAEL & THERESA L	6140 W AZURE DR LAS VEGAS NV	12526510048
REINSTADTLER DIANE	6104 COCKTAIL DR LAS VEGAS NV	12525214029
REMEY ANDREW & ANN	5905 CALM LAGOON AVE LAS VEGAS NV	12525213049
RIMBEY RODNEY W & LAURA C	5909 SPINNAKER REACH AVE LAS VEGAS NV	12525213011
ROBB RICKY & CATHY	6028 BUNGALOW BAY ST LAS VEGAS NV	12525213023
ROBERTSON CHARLES T & JANET Y	6160 W AZURE DR LAS VEGAS NV	12526511002
ROBINSON HENK	6228 DARTLE ST LAS VEGAS NV	12526510008
ROCKING HORSE TRUST	11571 BOLLINGER LN LAS VEGAS NV	12526610053
RODRIGUEZ HIPOLITO B & ANGELINA	6145 MARKLEHAM LAS VEGAS NV	12526511021
ROLL FAMILY TRUST	6037 PORT OF DREAMS DR LAS VEGAS NV	12525215035
ROLL P & L FAMILY TRUST	6033 PORT OF DREAMS DR LAS VEGAS NV	12525215034

Report of All Selected Parcels**Case Number:** ZON-40051**Printed On:** Mon: November 8, 2010

<u>Owner</u>	<u>Address</u>	<u>Parcel Number</u>
ROMERO JOSE & NORMA	6129 OCHO RIOS ST LAS VEGAS NV	12525214001
ROMERO LLOYD V & BETTY L	5808 SPINNAKER REACH AVE LAS VEGAS NV	12525213062
ROSEN KEITH & SHARON A	6012 BUNGALOW BAY LAS VEGAS NV	12525213055
ROWE ROBERT A & RHONDA R	6120 COTTONTAIL COVE ST LAS VEGAS NV	12526610020
ROY WARREN	6132 RABBIT TRACK ST LAS VEGAS NV	12526610007
ROYAL VELVET 8 L L C	6121 RESORT RIDGE ST LAS VEGAS NV	12525112037
RUFF DANIEL W & SHARON R	5713 RAVEN CREEK AVE LAS VEGAS NV	12525111002
RUTKOWSKI SCOTT & JENNIFER	6121 MOLLY MALONE CT LAS VEGAS NV	12526611049
RYAN SHAWN K & ELIZABETH J	5720 NEGRIL AVE LAS VEGAS NV	12525214022
SANCHEZ ROBERTO	6213 EAGLE CROSSING ST LAS VEGAS NV	12525112041
SATTLER TIMOTHY G	5712 NEGRIL AVE LAS VEGAS NV	12525215002
SCARPATI TAMMY & RALPH V	6133 MOLLY MALONE LAS VEGAS NV	12526611052
SCHULE ROBERT A & JUNE M REV TR	6129 RUM RUNNER DR LAS VEGAS NV	12525215017
SECRETARY HOUSING URBAN DEVELOP	%MICHAELSON CONNOR & BOUL INC 4400 WILL ROGERS PKWY #300 OKLAHOMA CITY OK	12526610048
SENER JOSEPH W & THELMA G	6108 COCKTAIL DR LAS VEGAS NV	12525214028
SHABO BASIM	823 OGDEN AVE LAS VEGAS NV	12526510007
SHARON MICHAEL R	6467 FOSCO CT LAS VEGAS NV	12526510032
SHENO ROBERT	6124 ARWELLS CORNER CT LAS VEGAS NV	12526611047
SHENO YOUASH & SHAMIRAN FAM TR	6236 BULLRING LN LAS VEGAS NV	12526611095
SHINTON DENNIS	6117 OCHO RIOS ST LAS VEGAS NV	12525213034
SHOEMAKER 2000 REVOCABLE LIV TR	6024 OCHO RIOS ST LAS VEGAS NV	12525213043
SIMS RANDALL A & KELLIE J	6013 BUNGALOW BAY ST LAS VEGAS NV	12525213019
SMALLING NATALIE M	3350 N DURANGO DR #2062 LAS VEGAS NV	12525111017
SMITH KEVIN & THERESA	6108 OCHO RIOS ST LAS VEGAS NV	12525213039
SNOW FAMILY TRUST	6217 BAYHAVEN CT LAS VEGAS NV	12525310026
SPURLIN TONY & LIZETTE	5716 CALM LAGOON AVE LAS VEGAS NV	12525211037
STAFFORD CARMEN & ARTHUR	5917 NEGRIL AVE LAS VEGAS NV	12525214006
STERNER GARY L & SUZETTE A	5805 NEGRIL AVE LAS VEGAS NV	12525214049
STOLL MATTHEW & JENNIFER	6136 RABBIT TRACK ST LAS VEGAS NV	12526610008
STOLZ DENNIS B & HELEN	5908 NEGRIL AVE LAS VEGAS NV	12525214013
STOUT ROBIN L & RANDY L	5708 NEGRIL AVE LAS VEGAS NV	12525215003
STREHLOW AUDREY M LIVING TRUST	5913 CALM LAGOON AVE LAS VEGAS NV	12525213051

Report of All Selected Parcels**Case Number:** ZON-40051**Printed On:** Mon: November 8, 2010

<u>Owner</u>	<u>Address</u>	<u>Parcel Numbe</u>
STREHLOW MCCALL & SCOT	6121 MARKELHAM AVE LAS VEGAS NV	12526510042
STRINGHAM CANDICE JENNIFER	5721 RAVEN CREEK AVE LAS VEGAS NV	12525112001
SZEWCZYK MICHAEL T. & KAREN B	5917 SPINNAKER REACH AVE LAS VEGAS NV	12525213013
TANZA JOHN M JR	6212 DARTLE ST LAS VEGAS NV	12526510004
TAXPAYER	LAS VEGAS NV	12525213058
TAXPAYER	LAS VEGAS NV	12525213010
TAXPAYER	LAS VEGAS NV	12525211035
TAXPAYER	LAS VEGAS NV	12525213057
TAYLOR RONNIE T & ADVERGUS	5704 NEGRIL AVE LAS VEGAS NV	12525215004
TINDER KEVIN C & ISELA S	6242 BULLRING LN LAS VEGAS NV	12526611094
TOBIAS RICHARD & LORNA	6117 COCKTAIL DR LAS VEGAS NV	12525214045
TORRES SERGIO A & EFIGENIA A	6125 MOLLY MALONE CT LAS VEGAS NV	12526611050
TOWNSEND RICHARD A & LORI A	BOX 877726 WASILLA AK	12525112036
TURNER JAMES E & RUBY W	6037 COCKTAIL DR LAS VEGAS NV	12525214038
TURTLE CREEK ESTS HOWNERS ASSN	%COLONIAL PROPERTY MGMT 3068 E SUNSET RD #14 LAS VEGAS NV	12526610074
USA POSTAL SERVICE	%DENVER FACILITIES SERV CTR 8055 E TUFTS AVE #400 DENVER CO	12525101012
VAIZ RICHARD A & CONNIE L	5717 CALM LAGOON AVE LAS VEGAS NV	12525211034
VENDRA HERCULES & HAFIDA	6208 DARTLE ST LAS VEGAS NV	12526510003
WALDEN CHARLES C & MILDRED R	6125 RUM RUNNER DR LAS VEGAS NV	12525215016
WARD JOHN SCOTT	6216 DARTLE ST LAS VEGAS NV	12526510005
WASHINGTON MARCIA C	6241 BULLRING LN LAS VEGAS NV	12526604003
WATSON ZENOBIA & JULIETTE	6120 MOLLY MALONE CT LAS VEGAS NV	12526611056
WAYT JEFFREY L & LISA D	6217 LAZY RABBIT AVE LAS VEGAS NV	12526610041
WEGER CHARLES P & RHONDA L	6130 W AZURE DR LAS VEGAS NV	12526510047
WHITE JOSEPH D & CAROLLEE ANN	6100 OCHO RIOS ST LAS VEGAS NV	12525213041
WILBANKS JEFFERY W	5709 CALM LAGOON AVE LAS VEGAS NV	12525211032
WILLIAMS CHARLES F & JANICE	6132 COTTONTAIL COVE ST LAS VEGAS NV	12526610023
WILLIAMS LLOYD C & LINDA R	6241 HAWTHORN WOODS AVE LAS VEGAS NV	12526611061
WILLIAMSON PATRICIA SEP PPTY TR	6224 BULLRING LN LAS VEGAS NV	12526611097
WILSON BATTRELL ALLEN & JULIE A	5612 NEGRIL AVE LAS VEGAS NV	12525215006
WRIGHT REGAN M	5808 SHOKO BAY CT LAS VEGAS NV	12525214043
YOUNG STEVEN B & ROWENA M	6017 ROLLING MEADOW ST LAS VEGAS NV	12526610038

Report of All Selected Parcels

Case Number: ZON-40051

Printed On: Mon: November 8, 2010

Owner

ZIEL GREGORY J & ANGELA J

Address

6105 PORT OF DREAMS DR LAS VEGAS NV

Parcel Numbe

12525215037

PLANNING & DEVELOPMENT



DEVELOPMENT SERVICES CENTER

731 S. Fourth Street
Las Vegas, NV 89101

Voice: 702-229-6301
Fax: 702-474-0352
TTY: 702-386-9108

www.lasvegasnevada.gov

December 3, 2010

Mr. Tom Dombrowski
Nevada Power Company
PO Box 98910
Las Vegas, Nevada 89193

**RE: ZON-40051 - REZONING
PLANNING COMMISSION MEETING OF DECEMBER 16, 2010**

Dear Mr. Dombrowski:

Please be advised the City of Las Vegas Planning Commission at its regular meeting on **December 16, 2010** as referred to above, will consider your request. This meeting will be held at 6:00 P. M. at the Council Chambers of City Hall, 400 Stewart Avenue, Las Vegas, Nevada.

A copy of staff's recommendations, any conditions related to your application and the **final agenda** will available on-line on **Friday, December 10, 2010** at www.lasvegasnevada.gov. If you do not have access to the Internet and would prefer receiving hard copies of the documentation, please call the Case Planning Division at (702) 229-6301 or come into the Development Services Center at 731 South Fourth Street to request your copies.

The Planning Commission requires that you or your representative be present at this meeting.

Sincerely,

Steve Gebeke, AICP
Planning Supervisor
Case Planning Division

SG:clb

cc: Mr. Peter Lowenstein
City of Las Vegas
731 South Fourth Street, 2nd Floor
Las Vegas, Nevada 89101

Mayor
Oscar B. Goodman

City Council
Gary Reese
(Mayor Pro Tem)
Steve Wolfson
Lois Tarkenton
Steven D. Ross
Ricki Y. Barlow
Stavros S. Anthony
City Manager
Elizobeth N. Fretwell





CITY OF LAS VEGAS SIGN POSTING AFFIDAVIT



CASE NUMBER: ZON-40051

MEETING DATE: 12/16/10 PC

Sign Pro does hereby certify that a notice as required by Chapter 19.18.010(D) of the Zoning Code, was visibly posted for a period of not less than ten (10) calendar days prior to the first scheduled hearing.



[Signature]
Signature

12-04-10
Date

This affidavit must be returned to the Planning and Development Department, Case Planning Division, at 731 South 4th Street during regular business hours three (3) business days prior to the subject application being heard by the Planning Commission or City Council.



CASE

MEET

Sign Pj
Code, w
schedule

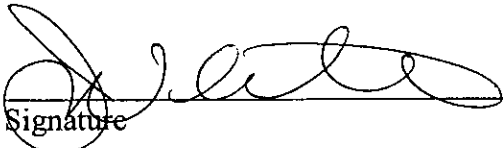

Signature

12-04-10
Date

This affidavit must be returned to the Planning and Development Department, Case Planning Division, at 731 South 4th Street during regular business hours three (3) business days prior to the subject application being heard by the Planning Commission or City Council.

Application Information

ZON-40051 - REZONING - PUBLIC HEARING - APPLICANT: CITY OF LAS VEGAS - OWNER: NEVADA POWER COMPANY - Request for a Rezoning FROM: U (UNDEVELOPED) [PF (PUBLIC FACILITIES) GENERAL PLAN DESIGNATION] TO: C-V (CIVIC) on 3.85 acres at 6120 North Jones Boulevard (APN 125-25-201-006), Ward 6 (Ross).

Application Location

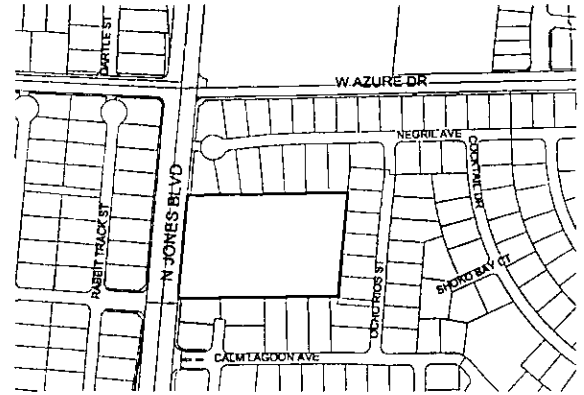

The proposed project may not pertain to the entire highlighted project site.

Public Hearing Information

Meeting: Planning Commission
Date: *December 16, 2010*
Time: 6:00 P.M.
Location: City Council Chambers
400 Stewart Avenue
Las Vegas, Nevada

Any and all interested persons may appear before the City Planning Commission either in person or by representative and object to or express approval of this request; or may, prior to this meeting, file a written objection thereto or approval thereof with the Planning and Development Department, Development Services Center, 731 South Fourth Street, Las Vegas, Nevada 89101. Final Action on General Plan Amendments and Rezonings will be determined by the City Council. Other public hearing items may be deemed Final Action by the Planning Commission or forwarded to the City Council. The date of the City Council meeting, if applicable, will be announced at the Planning Commission meeting after the discussion of the item. For further information, including the full staff report, please call (702) 229-6301 (TDD 386-9108) or go to <http://www.lasvegasnevada.gov>.

Application Information

ZON-40051 - REZONING - PUBLIC HEARING - APPLICANT: CITY OF LAS VEGAS - OWNER: NEVADA POWER COMPANY - Request for a Rezoning FROM: U (UNDEVELOPED) [PF (PUBLIC FACILITIES) GENERAL PLAN DESIGNATION] TO: C-V (CIVIC) on 3.85 acres at 6120 North Jones Boulevard (APN 125-25-201-006), Ward 6 (Ross).

Application Location

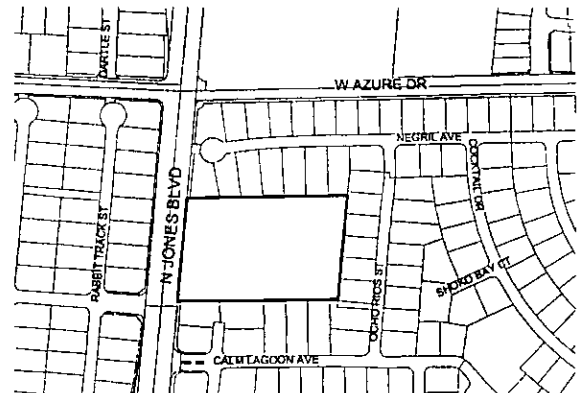

The proposed project may not pertain to the entire highlighted project site.

Public Hearing Information

Meeting: Planning Commission
Date: *December 16, 2010*
Time: 6:00 P.M.
Location: City Council Chambers
400 Stewart Avenue
Las Vegas, Nevada

Any and all interested persons may appear before the City Planning Commission either in person or by representative and object to or express approval of this request; or may, prior to this meeting, file a written objection thereto or approval thereof with the Planning and Development Department, Development Services Center, 731 South Fourth Street, Las Vegas, Nevada 89101. Final Action on General Plan Amendments and Rezonings will be determined by the City Council. Other public hearing items may be deemed Final Action by the Planning Commission or forwarded to the City Council. The date of the City Council meeting, if applicable, will be announced at the Planning Commission meeting after the discussion of the item. For further information, including the full staff report, please call (702) 229-6301 (TDD 386-9108) or go to <http://www.lasvegasnevada.gov>.

City of Las Vegas
Planning & Development Department
Development Services Center
731 S. Fourth Street
Las Vegas, Nevada 89101-2986

Return Service Requested
Official Notice of Public Hearing

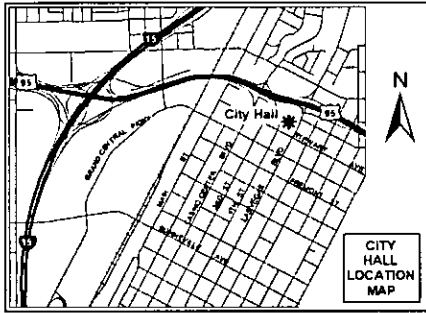

If you wish to file your protest or support on this request, check the appropriate box below and return this card in an envelope with postage to the Planning & Development Department at the address listed above or fax this side of this card to (702) 385-7268. If you would like to contact your Council Representative, please call (702) 229-6405.

I SUPPORT
this Request

I OPPOSE
this Request

Please use available blank space on card for your comments.

ZON-40051

Planning Commission Meeting of 12/16/2010

City of Las Vegas
Planning & Development Department
Development Services Center
731 S. Fourth Street
Las Vegas, Nevada 89101-2986

Return Service Requested
Official Notice of Public Hearing

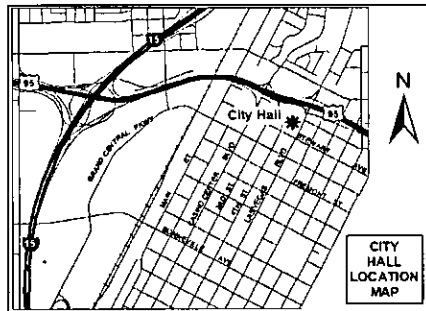

If you wish to file your protest or support on this request, check the appropriate box below and return this card in an envelope with postage to the Planning & Development Department at the address listed above or fax this side of this card to (702) 385-7268. If you would like to contact your Council Representative, please call (702) 229-6405.

I SUPPORT
this Request

I OPPOSE
this Request

Please use available blank space on card for your comments.

ZON-40051

Planning Commission Meeting of 12/16/2010

Memorandum

City of Las Vegas
Department of Public Works
Development Coordination

To: Department of Planning and Development
From: Bart Anderson, Manager, Development Coordination, Department of Public Works *BA*
CC: Nancy Almanzan, Right-of-Way; Tom Hayes, Land Development; O. C. White, Traffic Engineering; Alan Riecki, Survey (FM, PM, & A's only)
Date: November 15, 2010
Re: **ZON-40051** City of Las Vegas 6120 N. Jones Blvd.
Request for Rezoning from U to C-V on 3.85 acres

COMMENTS:

We have no comment on the Request for a Rezoning From: U (Undeveloped) [PF (Public Facilities) General Plan Designation] TO: C-V (Civic) on 3.85 acres at 6120 North Jones Boulevard.

Development Notification

PC Meeting: December 16, 2010

The following neighborhood associations are located within approximately one(1) mile of this development application and have been notified of this case by the Planning and Development Department:

ZON-40051

Ambiance Estates HOA

Carson Ranch East HOA

Copper Crest HOA

Copperfield HOA

Country Lane Estates NA

Eagle Canyon HOA

Eagle Creek Community HOA

Eagle Creek Heights Community Association

Eagle Crossing Community Association

Los Prados Community Association

Meister Park North HOA

Northgate HOA

Paradise Falls HOA

Romano Ridge HOA

Summer Ridge HOA

The Springs HOA

Timber Creek HOA

Tropical Meadows HOA

**CITY OF LAS VEGAS
INTER-OFFICE MEMORANDUM
REQUEST FOR COMMENT**

FROM: PLANNING AND DEVELOPMENT

ZON-40051

HAND DELIVERED

*DEVELOPMENT COORDINATION (DPW)	ROGER BAILEY	DSC
FIRE ENGINEERING	OZZIE MIRKHAH	DSC
*FLOOD CONTROL (DPW)	ALBERT SUNG	DSC
*LAND DEVELOPMENT (DPW)	DAVID GUERRA	DSC
PERMITS/ INSPECTIONS	ROD CLARK	DSC
*RIGHT-OF-WAY (DPW)	MARY WULFF	DSC
*SANITARY SEWERS (DPW)	JOE PEÑA	DSC
*TRAFFIC ENGINEERING	RICK SCHRODER	DSC

SENT VIA COURIER/INTER-OFFICE MAIL/ OR US MAIL

CCSD	LINDA PERRI	4190 McLeod Drive, 2 nd Floor
METRO	BRIAN O'CALLAGHAN	7 th FLOOR CITY HALL
OFFICE OF BUSINESS DEVELOPMENT	TOM BURKART	2 nd FLOOR CITY HALL EXPANSION
NEIGHBORHOOD SERVICES	ANNE KILPONEN	2 nd FLOOR CITY HALL
*TEFO (DPW)	REBECCA WHITLOCK	2900 RONEMUS
*SID (DPW)	PATRICK MURPHY	420 N. FOURTH STREET
*SURVEY (DPW)	ALAN RIEKKI	WEST YARD

*** ONLY THOSE INDICATED WITH A STAR ARE TO BE ROUTED TO ROGER BAILEY, SR. ENG. ASSOC. ALL OTHER DIVISIONS PLEASE ROUTE YOUR COMMENTS DIRECTLY TO THE PLANNING AND DEVELOPMENT DEPARTMENT < US MAIL DELIVERY >**

CITY OF LAS VEGAS

DEVELOPMENT REVIEW COMMENT FORM



*Planning and Development Department
Current Planning Division
731 South Fourth Street
Las Vegas, Nevada 89101
(702) 229-6301 phone (702) 385-7268 fax*

ZON-40051 - REZONING - PUBLIC HEARING - APPLICANT: CITY OF LAS VEGAS - OWNER: NEVADA POWER COMPANY - Request for a Rezoning FROM: U (UNDEVELOPED) [PF (PUBLIC FACILITIES) GENERAL PLAN DESIGNATION] TO: C-V (CIVIC) on 3.85 acres at 6120 North Jones Boulevard (APN 125-25-201-006), Ward 6 (Ross).

PLANNING COMMISSION: *DECEMBER 16, 2010*
CITY COUNCIL: *JANUARY 19, 2011*

PLANNING SUPERVISOR: *STEVE GEBEKE*



PUBLIC HEARING

Comments Due: *NOVEMBER 17, 2010*

*Comments not returned by the due date will not be incorporated into the staff report for this case. Comments may be submitted either on this sheet and routed via interoffice mail, U.S. mail, fax, or e-mailed to **Carman Burney** (cburney@lasvegasnevada.gov), the Agenda Tech responsible for this case. If you desire to meet with the case planner you may schedule an appointment by calling (702) 229-6301.*

LIST COMMENTS BELOW:

Report Date 10/27/2010 11:13 AM

Submitted By

Page 1

A/P # 40052 REZONING

Application Information

Stages

	Date / Time	By		Date / Time	By
Processed	10/25/2010 12:32	982721	Temp COD		
Approved			COO Issued		
Final			Expires		

Associated Information

Type of Work	# Plans	0	Valuation	Declared Valuation	0.00
Dept of Commerce	# Plans	0	Calculated Valuation		0.00
Priority	<input checked="" type="checkbox"/> Auto Reviews	Bill Group	Actual Valuation		0.00

Description of Work

ZON-40052 - REZONING - PUBLIC HEARING - APPLICANT: CITY OF LAS VEGAS - OWNER: NEVADA POWER COMPANY - Request for a Rezoning FROM: R-E (RESIDENCE ESTATES) TO: C-V (CIVIC) on 2.02 acres on the East alignment of Rainbow Boulevard, approximately 100 feet North of Delphinium Avenue (APN 138-02-401-001), Ward 6 (Ross).

Parent A/P #

Project #	40052	Project/Phase Name	NV ENERGY POWER SUBSTATION - R	Phase #	
Size/Area	2.02 ACRE	Size Description		Subdivision Code	
Proposed Start		Proposed Stop		% Completed	0.00
% Complete Formula					

Property/Site Information

Parcel 13802401001

Location

Owner/Tenant

Contact ID	AC475351	Name	NEVADA POWER COMPANY	Organization	% LAND SERV STA #9
Mailing Address	P O BOX 98910	City	LAS VEGAS	State/Province	NV
ZIP/PC	89193-8910	Day Phone	(702)227-2421 x	Country	<input type="checkbox"/> Foreign
Fax	(702)402-5064	Evening Phone		Mobile #	

A/P Linked Addresses

No Addresses are linked to this Application

Linked Addresses

No Addresses are linked to this Application

A/P Addresses

No Other Addresses are associated to this Application

Linked Parcels

No Parcels are linked to this Application

A/P Linked Parcels

13802401001

Report Date 10/27/2010 11:13 AM

Submitted By

Page 3

REZONING

N DINA Required? N PRS N Parent required? Zoning Information

Final City Council letter received

Annotated minutes recieved

Is there a condition of approval for a Required Review?

If yes, when does it need to be reviewed?

ROI Expired

Staff Recommendation

Meeting Information

<u>Zoning Information</u>	<u>Acres</u>	<u>Existing</u>	<u>Existing ROI</u>	<u>Proposed</u>	<u>Approved</u>	<u>ROI?</u>	<u>ROI Exp Date</u>	<u>Ordinance Adopted</u>
<u>Ordinance #</u>		<u>Added By</u>	<u>Modified By</u>	<u>Comments</u>				

2.02	R-E			C-V				
PLOWENSTEIN								

<u>Meeting Information</u>	<u>Meeting Date</u>	<u>Meeting Type</u>	<u>Meeting Status</u>	<u>YES Votes</u>	<u>NO Votes</u>	<u>ABSTENTIONS</u>
<u>Comments</u>	<u>Added By</u>	<u>Add Date</u>	<u>Modified By</u>	<u>Modified Date</u>		

12/16/2010	PC		SCHEDULED			
PLOWENSTEIN	10/25/2010			0	0	0

<u>Template Type</u>	<u>A/P #</u>	<u>A/P Type</u>	<u>Status</u>	<u>Stage</u>
----------------------	--------------	-----------------	---------------	--------------

No children exist for this project

<u>Employee</u>	<u>Employee ID</u>	<u>Last</u>	<u>First</u>	<u>MI</u>	<u>Comments</u>
-----------------	--------------------	-------------	--------------	-----------	-----------------

No Employee Entries

<u>Log</u>	<u>Action</u>	<u>Description</u>	<u>Entered By</u>	<u>Start</u>	<u>Stop</u>	<u>Hours</u>
<u>Comments</u>						

No Log Entries



PLANNING & DEVELOPMENT DEPARTMENT

APPLICATION / PETITION FORM

Application/Petition For: Rezoning

Project Address (Location) 6120 N Jones Boulevard

Project Name NV Energy Substation Proposed Use Electric Utility Sub

Assessor's Parcel #(s) 125-25-201-006 Ward # 6 (Ross)

General Plan: existing PF proposed N/A Zoning: existing U(PF) proposed C-V

Commercial Square Footage N/A Floor Area Ratio N/A

Gross Acres 3.85 Lots/Units 1 Density N/A

Additional Information To amend the zoning district from U(PF) to C-V for an existing NV Energy Electric Utility Substation.

PROPERTY OWNER Nevada Power Company Contact Tom Dombrowski

Address PO Box 98910 Phone: _____ Fax: _____

City Las Vegas State NV Zip 89193

E-mail Address _____

APPLICANT City of Las Vegas Contact Peter Lowenstein

Address 731 S 4th Street Phone: (702) 229-6301 Fax: (702) 385-7268

City Las Vegas State NV Zip 89101

E-mail Address _____

REPRESENTATIVE _____ Contact _____

Address _____ Phone: _____ Fax: _____

City _____ State _____ Zip _____

E-mail Address _____

Property Owner Signature* *Peter Lowenstein*

* An authorized agent may sign in lieu of the property owner for Final Maps, Tentative Maps, and Parcel Maps.

Print Name Peter Lowenstein

Subscribed and sworn before me

This 25th day of October, 2010

(Signature)

Notary Public in and for said County and State

FOR DEPARTMENT USE ONLY

Case #	<u>ZON-40051</u>
Meeting Date:	<u>12/16/10</u>
Total Fee:	<u>\$1,200.</u> 25
Date Received:*	<u>10/25/10</u>
Received By:	<u><i>(Signature)</i></u>

*The application will not be deemed complete until the submitted materials have been reviewed by the Planning and Development Department for consistency with applicable sections of the Zoning Ordinance.

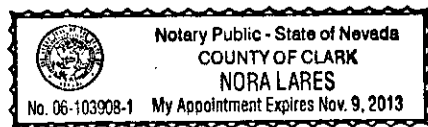



PLANNING & DEVELOPMENT DEPARTMENT

STATEMENT OF FINANCIAL INTEREST

Case Number: **ZON-40051** APN: 125-25-201-006

Name of Property Owner: Nevada Power Company

Name of Applicant: City of Las Vegas

Name of Representative: _____

To the best of your knowledge, does the Mayor or any member of the City Council or Planning Commission have any financial interest in this or any other property with the property owner, applicant, the property owner or applicant's general or limited partners, or an officer of their corporation or limited liability company?

Yes

No

If yes, please indicate the member of the City Council or Planning Commission who is involved and list the name(s) of the person or persons with whom the City Official holds an interest. Also list the Assessor's Parcel Number if the property in which the interest is held is different from the case parcel.

City Official: _____

Partner(s): _____

APN: _____

Signature of Property Owner: *Peter Lowenstein*

Print Name: Peter Lowenstein

RECEIVED
OCT 27 2010

Subscribed and sworn before me

This 25th day of October, 2010
Nora Lares
Notary Public in and for said County and State

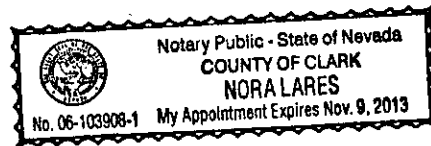

PLANNING & DEVELOPMENT



DEVELOPMENT SERVICES CENTER

731 S. Fourth Street
Las Vegas, NV 89101

Voice: 702-229-6301
Fax: 702-474-0352
TTY: 702-386-9108

www.lasvegasnevada.gov

October 25, 2010

Steve Gebeke
Planning & Development Department
731 S 4th Street
Las Vegas, NV 89101

**RE: Application ZON-40051
Assessor's Parcel Number 125-25-201-001**

Dear Mr. Gebeke:

In regard to this parcel, staff has determined that the existing General Plan designation and zoning classification are inconsistent with possible future development. In order to resolve this inconsistency and ensure that future development is compatible with existing development, staff is proposing to change the zoning district of the site to C-V (Civic). Please call me at 229-4693 with any questions.

Sincerely,

Peter Lowenstein, AICP
Planning Supervisor
Planning & Development Department

PL:nl

Mayor
Oscar B. Goodman

City Council
Gory Reese

(Mayor Pro Tem)

Steve Wolfson

Lois Tarkanian

Steven D. Ross

Ricki Y. Barlow

Stavros S. Anthony

City Manager

Elizabeth N. Fretwell

RECEIVED

OCT 27 2010



07101-001-06-09

ZON-40051

960819.00376

Escrow Number: 794322 TACtac

WHEN RECORDED, MAIL TO:
Nevada Power Company, a Nevada Corporation
P.O. BOX 230
Las Vegas NV 89151

RPTT: \$850.00
APNR: 125-25-201-002

GRANT, BARGAIN and SALE DEED

FOR A VALUABLE CONSIDERATION, receipt of which is hereby acknowledged.

Robert Allen Zolla, a married man as his sole and separate property as to an undivided 1/3
Thomas James Zolla an unmarried man as to an undivided 1/3 interest interest
and William John Zolla an unmarried man as to an undivided 1/3 interest

do(es) hereby GRANT, BARGAIN, and SELL to

Nevada Power Company, a Nevada Corporation

the real property situate in the County of Clark, State of Nevada, described as follows:

See exhibit "A" attached hereto for complete legal description and by reference made a part hereof.

Subject to:

1. All general and special taxes for the fiscal year 1995-1996 if any, and fiscal year 1996-1997.
2. Covenants, Conditions, Restrictions, Reservations, Rights, Rights of Way and Easements now of record.

TOGETHER with all tenements, hereditaments and appurtenances, including easements and water rights, if any, thereto belonging or appertaining, and any reversions, remainders, rents, issues or profits thereof.

[Signature] 7/19/96
Robert Allen Zolla Date

[Signature] 7/19/96
Thomas James Zolla Date

[Signature] 7/19/96
William John Zolla Date

STATE OF NEVADA *Nevada*
COUNTY OF CLARK *San Des*

This instrument was acknowledged before me on July 19 1996 by Robert Allen Zolla, Thomas James Zolla and William John Zolla

[Signature]
Notary Public
My commission expires: 9-10-98

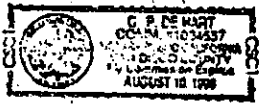

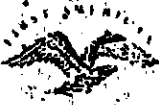

LV-794322-TAC

DESCRIPTION

ALL THAT REAL PROPERTY SITUATED IN THE COUNTY OF CLARK, STATE OF NEVADA, BOUNDED AND DESCRIBED AS FOLLOWS:

THE SOUTH HALF (S 1/2) OF THE NORTH HALF (N 1/2) OF THE SOUTHWEST QUARTER (SW 1/4) OF THE NORTHWEST QUARTER (NW 1/4) OF SECTION 25, TOWNSHIP 19 SOUTH, RANGE 60 EAST, M.D.B. & M.

EXCEPTING THEREFROM THE WESTERLY FIFTY (50) FEET AND SOUTHERLY FIFTEEN (15) FEET AND EASTERLY FIFTEEN (15) FEET THEREOF, TO BE USED AS A PUBLIC ROAD AND FOR UTILITIES.

FURTHER DESCRIBED AS LOT THREE HUNDRED SEVEN (307) AS SHOWN IN THAT CERTAIN RECORD OF SURVEY RECORDED OCTOBER 18, 1989 IN BOOK 891018 AS DOCUMENT NO. 00517 IN FILE 52 OF SURVEYS, PAGE 70.

.....

SKE

CLARK COUNTY, NEVADA
JUDITH A. VANDEVER, RECORDER
RECORDED AT REQUEST OF:

BOOK _____ OFFICIAL RECORDS
FEE _____ INST. _____
RPTD _____

NOTES

This map is for assessment use only and does NOT represent a survey. No liability is assumed for the accuracy of the data delineated herein. Information on roads and other non-assessed parcels may be obtained from the Real Book Listing in the Assessor's Office.

This map is compiled from official records, including surveys and deeds, but only contains the information required for assessment. See the recorded documents for more detailed legal information.

USE THIS SCALE (FEET) WHEN MAP REDUCED FROM THIS ORIGINAL

ASSessor's PARCELS - CLARK CO., NV.
M. W. Schofield, Assessor

AVERAGE AREA VALUE 35

MAP LEGEND

- PARCEL BOUNDARY 881 1.88
- SUBD BOUNDARY 202
- ROAD EASEMENT
- PW/LD BOUNDARY
- NON-PARCEL LOT LINE
- WATCH LINE / LEADER LINE 5
- ROAD ID NUMBER 615

PARCEL NUMBER ACREAGE
202
 PARCEL SUB/SED NUMBER
 PLAT RECORDING NUMBER
5
 BLOCK NUMBER
 LOT NUMBER
 GOV. LOT NUMBER

T19S R60E

R59E	R60E	R61E
99	100	101
126	125	124
137	138	139

25

6	5	4	3	2	1
7	8	9	10	11	12
13	14	15	16	17	18
19	20	21	22	23	24
25	26	27	28	29	30
31	32	33	34	35	36

S 2 NW 4

4	8	4
5	1	5
6	2	6
7	3	7
8	4	8
5	1	5

125-25-2

Scale: 1"=200' Rev: 04/17/01

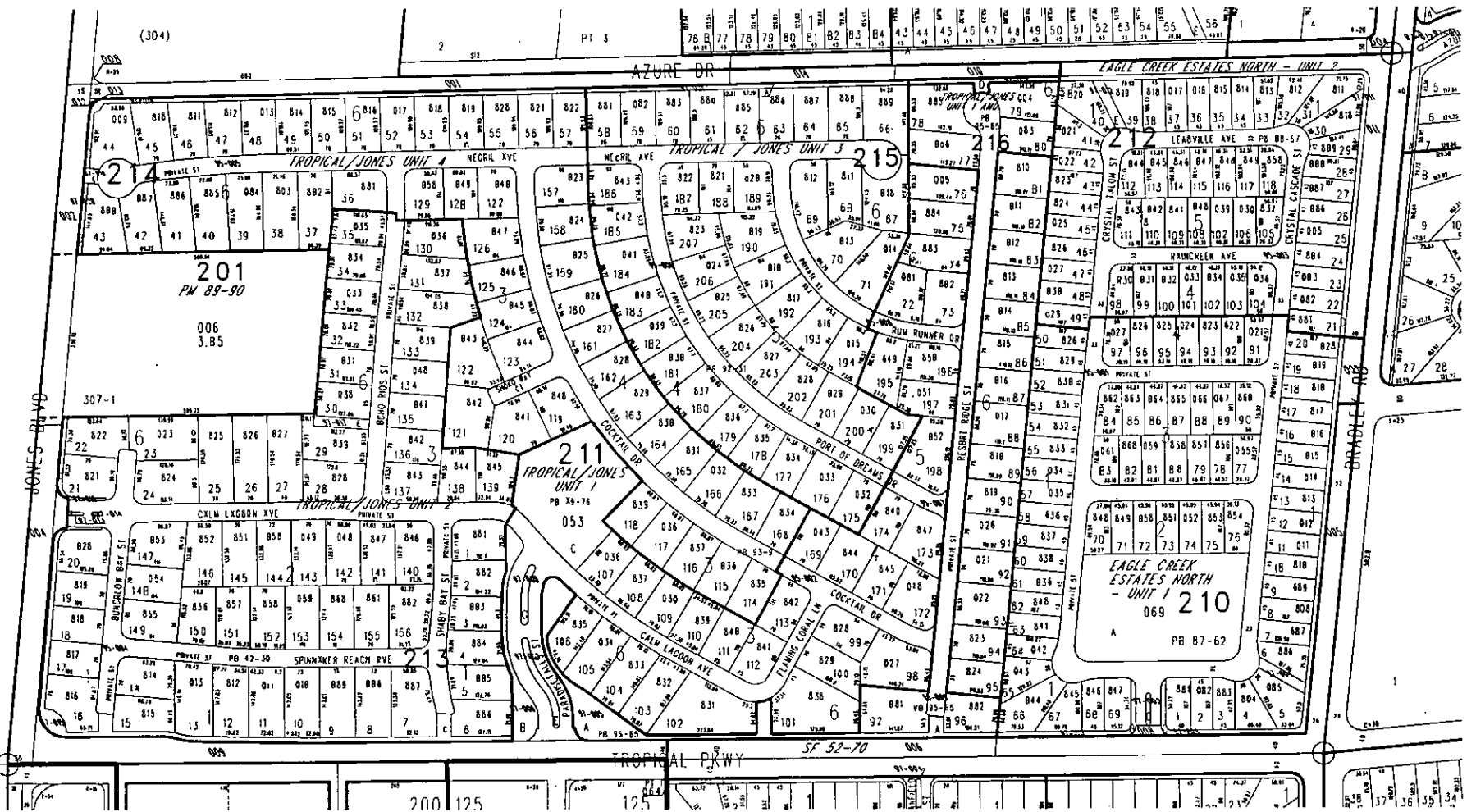
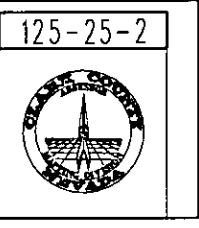

TAX DIST 200