

# Plans (Approved Site Plan)

---



Separator Sheet

---

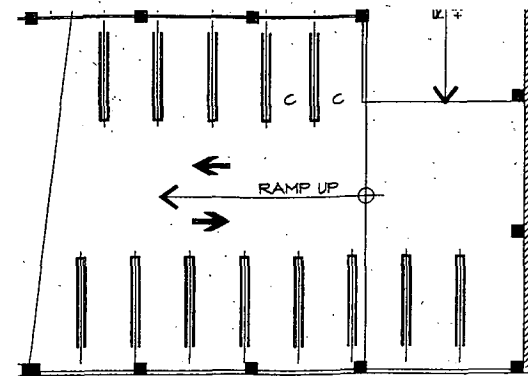

SECTION 1022.6 PROTECTION OF EXTERIOR WALL OPENINGS.  
 TABLE 1018.1  
 OCCUPANT LOAD OF 1-100 = 2 EXITS  
 S-2 = 200 / A.3 =  
 SECTION 1007.3 STAIRWAYS.  
 EXCEPTION #5  
 SECTION 1007.4 ELEVATORS.  
 EXCEPTION #1

APPROVED  
 TSP-18535  
 BY [Signature] 12.5.06  
 CURRENT PLANNING DIVISION  
 CITY OF LAS VEGAS

TYPICAL LEVEL  
 SCALE: 1/16" = 1'-0"



OPEN AREA CALCULATIONS

NORTH ELEVATION

N/A

SOUTH ELEVATION

LEVEL	OPEN AREA	TIER AREA	% OPEN (PROVIDED)	% OPEN (REQ'D)
GROUND	N/A (A-3)			
2ND	836.0	1360.00 =	60.57%	20%
3RD - 7TH	722.00	1260.00 =	57.30%	20%
ROOF	N/A			

LEVEL	TIER PERIMETER	OPENING LENGTH	% OPEN (PROVIDED)	% OPEN (REQ'D)
GROUND	N/A (A-3)			
2ND	120'-0"	114'-0" =	95.0%	40%
3RD - 7TH	120'-0"	114'-0" =	95.0%	40%
ROOF	N/A			

EAST ELEVATION

N/A

WEST ELEVATION

LEVEL	OPEN AREA	TIER AREA	% OPEN (PROVIDED)	% OPEN (REQ'D)
GROUND	N/A (A-3)			
2ND	655.66	1989.50 =	32.96%	20%
3RD - 7TH	565.66	1816.50 =	31.14%	20%
ROOF	N/A			

LEVEL	TIER PERIMETER	OPENING LENGTH	% OPEN (PROVIDED)	% OPEN (REQ'D)
GROUND	N/A (A-3)			
2ND	173'-0"	90'-0" =	52.02%	40%
3RD - 7TH	173'-0"	90'-0" =	52.02%	40%
ROOF	N/A			

TOTAL SPACES  
 N/A  
 73 SPACES  
 64 SPACES  
 64 SPACES  
 64 SPACES  
 64 SPACES  
 65 SPACES  
 34 SPACES  
 428 SPACES

LEVEL

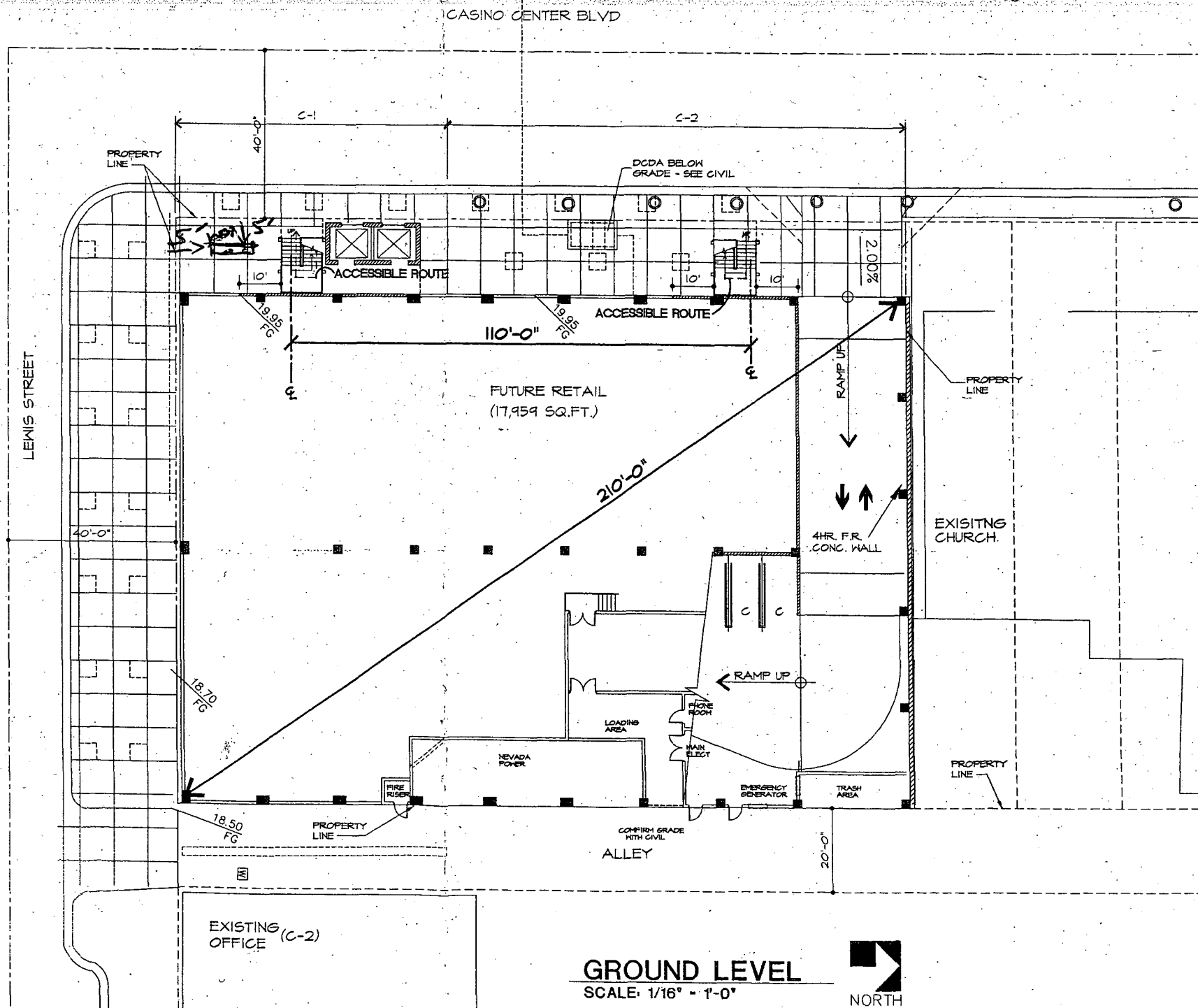

LEWIS STREET PARKING STRUCTURE  
 FOR  
 LEWIS CENTER PARKING, L.L.C.  
 LAS VEGAS, NEVADA

All designs, arrangements and plans indicated or presented by this drawing as instruments of service, are owned by and the property of KRACOR, INC. The plans and/or specifications shall be restricted to the original site for which they were prepared and publication thereof is expressly limited to such use. Reproduction, publication or re-use by any method in whole or in part, is prohibited. None of such designs, arrangements or plans shall be used by or disclosed to any person, firm, agency or corporation without the written permission of KRACOR, INC. Visual contact with these plans and specifications shall constitute prima facie evidence of acceptance of these restrictions.

CODE ANALYSIS

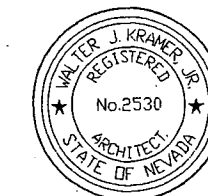

PROJECT NO. 02-118.01  
 DATE 3/21/2003  
 DRAWN BY RL  
 CHECKED BY  
 REVISED DATE  
 4/17/03 - CITY CORRECTIONS  
 4/15/05 - OWNER REVISIONS  
 6/7/05 - REDESIGN  
 8/15/05 - REDESIGN

9-1-05 FOR CONSTRUCTION

# Plans (PMT)

---



Separator Sheet

---

APPROVED  
 752-18535  
 BY [Signature]  
 12.5.06  
 CURRENT PLANNING DIVISION  
 CITY OF LAS VEGAS



6' HAG

**WESTERN**  
**SIGN & FLAG**  
 A WESTERN OUTDOOR COMPANY  
 CONTRACTORS LICENSE #: 0019631

SCALE: 1/2"=1'	OPTION:
DATE: 10/05/06	REVISION DATE:
ARTIST: CA <input type="checkbox"/> TKB <input checked="" type="checkbox"/>	REP: BEN

DETAIL:  
 8'x 12' S/F DURAPLY  
 PAINT BACK OF SIGN

# Action Letter

---



# Separator Sheet

---



# TEMPORARY SIGN PERMIT

## TSP-18535

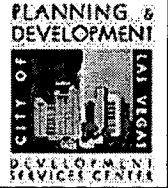

**Description of Sign(s):** 8'X12'Lewis center parking garage grand opening temporary sign from 12-12-06 to 2-11-07.

**Applicant:** Lewis Center Parking L L C  
851 S Rampart Blvd #125  
Las Vegas, NV 89145-4899  
(702)939-0990 x

**Parcel(s):** 139-34-201-020

**Ward(s):** Ward 3 (Reese)

**Type of Signs:**

- Pennants
- Balloons
- Streamers
- Searchlights
- Portable
- Other

**THIS PERMIT IS APPROVED PURSUANT TO TITLE 19.14.090A OF THE LAS VEGAS MUNICIPAL CODE, SUBJECT TO THE FOLLOWING CONDITIONS:**

- 1) THE TEMPORARY SIGN PERMIT SHALL BE VALID FOR ~~60~~ DAYS FROM DECEMBER 12, 2006 TO FEBRUARY 11, 2007.
- 2) ALL TEMPORARY SIGNS SHALL BE SET BACK FROM ANY STREET INTERSECTION OR DRIVEWAY OR OTHERWISE LOCATED IN ORDER TO NOT CREATE A SIGHT RESTRICTION.
- 3) ALL TEMPORARY SIGNAGE SHALL BE SO LOCATED AS TO NOT CREATE A NUISANCE TO NEARBY PROPERTIES AS A RESULT OF FACTORS SUCH AS EXCESSIVE ILLUMINATION, GLARE, OR NOISE.
- 4) ALL TEMPORARY SIGNAGE SHALL CONFORM TO THE SUBMITTED SITE PLAN.
- 5) THE APPLICANT SHALL DISPLAY A COPY OF THIS TEMPORARY SIGN PERMIT DURING NORMAL BUSINESS HOURS.
- 6) ALL TEMPORARY IMPROVEMENTS MADE TO THIS SITE AND THE ABUTTING STREETS SHALL BE REMOVED UPON EXPIRATION OF THE PERMIT.
- 7) ALL APPLICABLE CITY CODE REQUIREMENTS SHALL BE SATISFIED.
- 8) THE APPLICANT SHALL BE RESPONSIBLE FOR LEAVING THE SITE FREE OF DEBRIS, LITTER, OR ANY OTHER EVIDENCE OF THE SIGNAGE UPON EXPIRATION OF THE PERMIT.
- 9) NO SIGNS SHALL BE LOCATED IN THE PUBLIC RIGHT-OF-WAY.

# Application

---



Separator Sheet

---



ATTN RON

**PLANNING & DEVELOPMENT DEPARTMENT**

**RECEIVED**

NOV 22 2006

**APPLICATION / PETITION FORM**

Application/Petition For: ON SITE SIGN (Temp)  
 Project Address (Location) 321 S. Casino Center Blvd.  
 Project Name LEWIS CENTER PARKING, LLC. Proposed Use \_\_\_\_\_  
 Assessor's Parcel #(s) 139-34-201-020 Ward # \_\_\_\_\_  
 General Plan: existing \_\_\_\_\_ proposed X Zoning: existing \_\_\_\_\_ proposed \_\_\_\_\_  
 Commercial Square Footage \_\_\_\_\_ Floor Area Ratio \_\_\_\_\_  
 Gross Acres 0.56 Lots/Units \_\_\_\_\_ Density \_\_\_\_\_  
 Additional Information \_\_\_\_\_

**PROPERTY OWNER** Lewis Center Parking LLC Contact Ron Bures  
 Address 8910 W. Tropicana Ste. 3 Phone: 938-0990 Fax: 838-4531  
 City Las Vegas State NV. Zip 89147

**APPLICANT** Lewis Center Parking LLC Contact Ron Bures  
 Address 8910 W. Tropicana Ste. 3 Phone: 938-0990 Fax: 838-4531  
 City Las Vegas State NV. Zip 89147

**REPRESENTATIVE** Ron Bures Contact Ron Bures  
 Address 8910 W Tropicana Ste. 3. Phone: 938-0990 Fax: 838-4531  
 City Las Vegas State NV. Zip 89147

Property Owner Signature\* Ron Bures  
 \* An authorized agent may sign in lieu of the property owner for Final Maps, Tentative Maps, and Parcel Maps.  
 Print Name Ron BURES

Subscribed and sworn before me  
 This 27<sup>th</sup> day of November, 2007

[Signature]  
 Notary Public in and for said County and State

 **CHERYL A. MOORE**  
 Notary Public State of Nevada  
 No. 97-4544-1  
 My appt. exp. Nov. 17, 2009

**FOR DEPARTMENT USE ONLY**

Case #	<u>TSP-18535</u>
Meeting Date:	_____
Total Fee:	<u>100</u>
Date Received:*	<u>12-5-06</u>
Received By:	<u>[Signature]</u>

\*The application will not be deemed complete until the submitted materials have been reviewed by the Planning and Development Department for consistency with applicable sections of the Zoning Ordinance.

# Justification Letter

---



JUSTIFICATION LETTER

Separator Sheet

---

 <p><b>WESTERN</b> <b>SIGN &amp; FLAG</b> A WESTERN OUTDOOR COMPANY</p>	<table border="1"><tr><td data-bbox="812 331 1112 405"><p>3060 Business Lane Las Vegas, Nevada 89103</p></td><td data-bbox="1112 331 1339 405"><p>TEL: 702-798-6030 FAX: 702-798-8314</p></td></tr></table>	<p>3060 Business Lane Las Vegas, Nevada 89103</p>	<p>TEL: 702-798-6030 FAX: 702-798-8314</p>
<p>3060 Business Lane Las Vegas, Nevada 89103</p>	<p>TEL: 702-798-6030 FAX: 702-798-8314</p>		

Attention: Dan 474-0352

Grand Opening of Parking Garage

Advertising For 60 Days

Lewis Center Parking Garage on Corner of Lewis / Casino Center

Sign To Be Up Between December 12, 2006 – February 12, 2007

Temporary Sign for Grand Opening

Deed

---



Separator Sheet

---

## LEWIS CENTER PARKING LLC

Business Entity Information			
Status:	Active on 9/20/2006	File Date:	8/19/2002
Type:	Domestic Limited-Liability Company	Corp Number:	LLC10056-2002
Qualifying State:	NV	List of Officers Due:	8/31/2007
Managed By:	Managers	Expiration Date:	8/19/2502

Resident Agent Information			
Name:	RONALD BURES	Address 1:	8910 W TROPICANA AVE STE #3
Address 2:		City:	LAS VEGAS
State:	NV	Zip Code:	89147
Phone:		Fax:	
Email:		Mailing Address 1:	
Mailing Address 2:		Mailing City:	
Mailing State:		Mailing Zip Code:	

Financial Information			
No Par Share Count:	0	Capital Amount:	\$ 0
<b>No stock records found for this company</b>			

Officers				<input checked="" type="checkbox"/> Include Inactive Officers
<b>Manager - RONALD BURES</b>				
Address 1:	8910 W. TROPICANA AVE, SUITE 3	Address 2:		
City:	LAS VEGAS	State:	NV	
Zip Code:	89147	Country:		
Status:	Historical	Email:		
<b>Manager - RONALD BURES</b>				
Address 1:	8910 W. TROPICANA AVE, SUITE 3	Address 2:		
City:	LAS VEGAS	State:	NV	
Zip Code:	89147	Country:		
Status:	Active	Email:		
<b>Manager - MAHLON BROWN FAMILY TRUST</b>				
Address 1:	601 EAST CHARLESTON BLVD.	Address 2:		
City:	LAS VEGAS	State:	NV	
Zip Code:	89104	Country:		
Status:	Historical	Email:		
<b>Manager - MAHLON BROWN FAMILY TRUST</b>				
Address 1:	601 EAST CHARLESTON BLVD.	Address 2:		
City:	LAS VEGAS	State:	NV	
Zip Code:	89104	Country:		
Status:	Active	Email:		

Actions\Amendments			
Action Type:	Articles of Organization		
Document Number:	LLC10056-2002-001	# of Pages:	1
File Date:	08/19/2002	Effective Date:	
(No Notes for this action)			

<b>Action Type:</b>	Resident Agent Change		
<b>Document Number:</b>	LLC10056-2002-004	<b># of Pages:</b>	1
<b>File Date:</b>	09/09/2003	<b>Effective Date:</b>	
RONALD J. DAY SUITE A			
4175 CAMERON LAS VEGAS NV 89103 DAR			
<b>Action Type:</b>	Annual List		
<b>Document Number:</b>	LLC10056-2002-007	<b># of Pages:</b>	1
<b>File Date:</b>	09/26/2003	<b>Effective Date:</b>	
(No Notes for this action)			
<b>Action Type:</b>	Resident Agent Address Change		
<b>Document Number:</b>	LLC10056-2002-005	<b># of Pages:</b>	1
<b>File Date:</b>	01/08/2004	<b>Effective Date:</b>	
LOREN A. PIEL, ESQ. SUITE A DMM			
4175 CAMERON STREET LAS VEGAS NV 89103 DMM			
LOREN A. PIEL, ESQ. DMM			
P.O. BOX 36592 LAS VEGAS NV 891336592 DMM			
<b>Action Type:</b>	Annual List		
<b>Document Number:</b>	LLC10056-2002-002	<b># of Pages:</b>	1
<b>File Date:</b>	08/23/2004	<b>Effective Date:</b>	
List of Officers for 2004 to 2005			
<b>Action Type:</b>	Amended List		
<b>Document Number:</b>	LLC10056-2002-003	<b># of Pages:</b>	1
<b>File Date:</b>	12/17/2004	<b>Effective Date:</b>	
(No Notes for this action)			
<b>Action Type:</b>	Amendment		
<b>Document Number:</b>	LLC10056-2002-006	<b># of Pages:</b>	1
<b>File Date:</b>	12/30/2004	<b>Effective Date:</b>	
CERTIFICATE OF AMENDMENT TO ARTICLES OF ORGANIZATION FILED AMENDING MANAGERS.			
(1) PG. PXE			
<b>Action Type:</b>	Annual List		
<b>Document Number:</b>	20050600969-47	<b># of Pages:</b>	1
<b>File Date:</b>	12/07/2005	<b>Effective Date:</b>	
(No Notes for this action)			
<b>Action Type:</b>	Annual List		
<b>Document Number:</b>	20060603595-06	<b># of Pages:</b>	1
<b>File Date:</b>	09/20/2006	<b>Effective Date:</b>	
(No Notes for this action)			
<b>Action Type:</b>	Resident Agent Change		
<b>Document Number:</b>	20060663619-59	<b># of Pages:</b>	1
<b>File Date:</b>	10/13/2006	<b>Effective Date:</b>	
(No Notes for this action)			