



60

OWNER - SHAR GARDNER  
100 E. CHURCH ST.  
SALT LAKE CITY, UT 84103  
PHONE - 531-1111

SCALE - 1" = 10 FEET

LOTS 25, 26, 27  
BLONE ST  
BUILT UP DOWN THE SIDE STREET

8 1/2' width of south property line  
54' distance from plot to building

Center of Edna Street

18'

curb line  
12' deep  
set 2' into property line

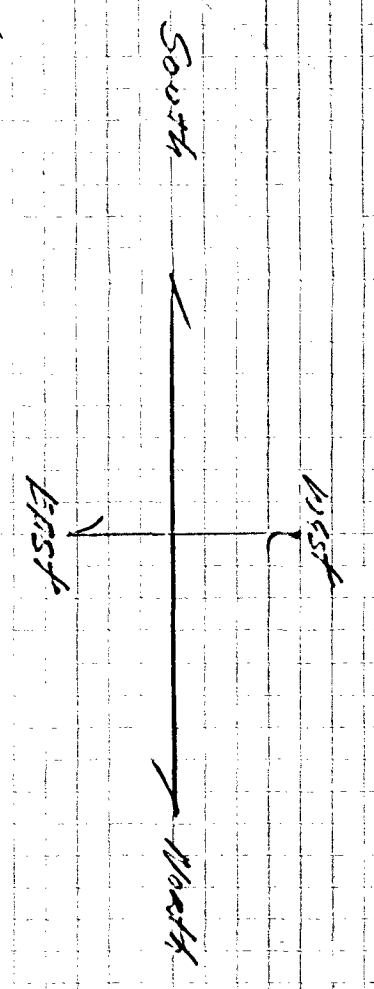

181' property line  
181' property line

Building - 20' x 120' - 12' high  
Access on south, north & east walls

TRUCK PARKING & SERVICE AREA  
N. SIDE OF STREET

PARKING SPACE  
5' x 20'

Building set back 20' from  
lot property line  
Also set back 100' from  
south street

South Street

30'

Center of 25th Street

existing  
50' alley

20' width of street

