

LAS VEGAS TOWNSITE
ADDITION
SECTION 34
PACIFIC RR RIGHT OF WAY

Z-53

PACIFIC FRUIT EXPRESS
LOADING PLANT

SHELL OIL COMPANY

RICHFIELD OIL CO.



LAND USE
STUDY
11-6-61
For Z-53-61
Nov. 28, 1961 Denied P.C.
Dec. 13, 1961 Denied C.C.

SHEET NO. 69

SHEET NO. 69

Z-53

KYS LAS VEGAS TOWNSITE
IN ADDITION
TO THE ADDITION
TO THE PACIFIC RR RIGHT OF WAY

PACIFIC RAILROAD EXPRESS
LOCOMOTIVE PLANT

SALE SUPPLY
RIGHTFIELD OIL CO.

SHELL OIL COMPANY

S 88° 42' 12" W CENTER SEC. 34

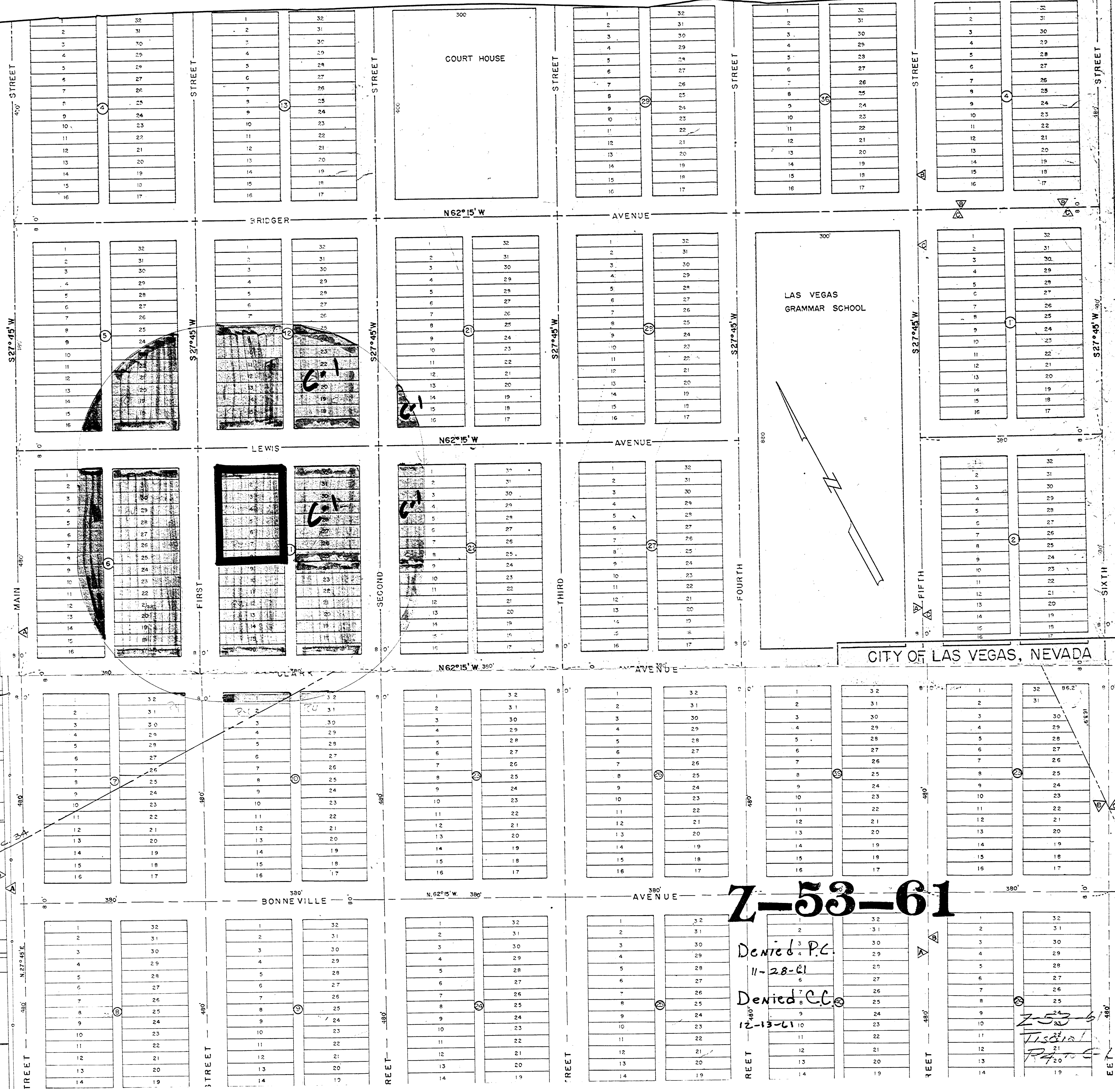

CITY OF LAS VEGAS, NEVADA

Z-53-61

Denied P.C.
11-28-61

Denied C.C.
12-13-61

Z-53-61
T. S. ...
P. ...

SHEET NO. 69