

**Planning & Development Department
Scanning Cover Sheet**

Case No A-5-63

APN N/A

Location Smoke Ranch Rd & Jones

Applicant Anna Mohr

Subject

Proposal for Annexation



A-5-63

ORDINANCE NO. 1032

AN ORDINANCE ANNEXING TO, AND MAKING A PART OF THE CITY OF LAS VEGAS CERTAIN SPECIFICALLY DESCRIBED TERRITORY ADJOINING AND CONTIGUOUS TO THE CORPORATE LIMITS OF THE CITY OF LAS VEGAS; DECLARING SAID TERRITORY AND INHABITANTS TO BE ANNEXED THERETO AND SUBJECT TO ALL LAWS AND ORDINANCES, ORDERING A PLAT SHOWING SAID TERRITORY TO BE RECORDED IN THE OFFICE OF THE COUNTY RECORDER OF THE COUNTY OF CLARK, STATE OF NEVADA, AND PROVIDING OTHER MATTERS PROPERLY RELATED THERETO.

THE BOARD OF COMMISSIONERS OF THE CITY OF LAS VEGAS DOES ORDAIN AS FOLLOWS:

SECTION 1. Pursuant to a Petition duly presented to the Board of Commissioners of the City of Las Vegas, signed by a majority of the freeholders in the area containing the hereinafter described parcel of real property requesting the Board of Commissioners of the City of Las Vegas to annex to and make a part of the City of Las Vegas, the hereinafter described parcel of real property, the exterior boundaries of the City of Las Vegas are hereby extended to annex to, and include therein, the following described parcel of said property, to wit:

S½ of the SW¼ of Section 13, Township 20 South, Range 60 East, M.D.B.&M.

Together with the tenements, property; and inhabitants within said parcel of real property is hereby declared to be a part of the City of Las Vegas.

SECTION 2. Said parcel of real property, together with the tenements and inhabitants thereof, shall be subject to all of the laws applicable to the City of Las Vegas.

SECTION 3. The City Engineer of the City of Las Vegas is hereby instructed to prepare plats of said territory described in Section 1 of this ordinance and to file the same for record in the office of the County Recorder of Clark County, Nevada.

APPROVED:

ORAN K. GRAGSON, Mayor

ATTEST:

SIGRID DODGSON, Acting City Clerk

The above and foregoing ordinance was first proposed and read by title to the Board of Commissioners on the 6th day of February, 1963, and referred to the following committee composed of Commissioners _____ and _____ for recommendation; thereafter the said committee reported favorably on said ordinance on the ____ day of _____, 1963, which was a _____ meeting of said Board; that at said regular meeting the proposed ordinance was read by title to the Board of Commissioners as first introduced and adopted by the following vote:

VOTING "AYE": Commissioners _____

VOTING "NAY": _____ ABSENT: _____

APPROVED:

ATTEST:

ORAN K. GRAGSON, Mayor

SIGRID DODGSON, Acting City Clerk

ACCEPTANCE OF NOTICE:

We, the undersigned Mayor, Commissioners, City Manager, Assistant City Manager, and City Attorney of the City of Las Vegas do hereby admit due service of the foregoing Notice of Special Meeting:

/s/ Oran K. Gragson
/s/ E. W. Fountain
/s/ Harry Levy

/s/ Reed Whipple
/s/ Verlyn L. Fletcher
/s/ Sidney R. Whitmore

MINUTES

Las Vegas, Nevada
February 6, 1963

A Special Meeting of the Board of Commissioners of the City of Las Vegas, held this 6th day of February, 1963, was called to order by His Honor, Mayor Oran K. Gragson, at the hour of 7:00 p.m. with the following members present:

Mayor	Oran K. Gragson
Commissioner	Reed Whipple
Commissioner	E. W. Fountain
Commissioner	Harry C. Levy

ABSENT (EXCUSED)

Commissioner Philip M. Mirabelli

STAFF PRESENT:

City Manager	Verlyn L. Fletcher
Director of Planning	Donald J. Saylor
Acting City Clerk	Sigrid Dodgson

ORDINANCE NO. 1032
ANNEXATION
A-5-63

Referred to
Committee

ANNEXATION (A-5-63) - PETITION OF ANNA MOHR for annexation of property generally located on Smoke Ranch Road, between Jones Boulevard and Michael Way, legally described as follows:

The South Half (S-1/2) of the Southwest Quarter (SW-1/4) of Section 13, Township 20 South, Range 60 East, MDB&M.

The Director of Planning, Mr. Donald J. Saylor, stated that this is a petition for annexation of an 80-acre one owner parcel, on which development will be started in the very near future, and the Planning Commission recommended approval.

An Ordinance entitled: "AN ORDINANCE ANNEXING TO, AND MAKING A PART OF THE CITY OF LAS VEGAS CERTAIN SPECIFICALLY DESCRIBED TERRITORY ADJOINING AND CONTIGUOUS TO THE CORPORATE LIMITS OF THE CITY OF LAS VEGAS; DECLARING SAID TERRITORY AND INHABITANTS TO BE ANNEXED THERETO AND SUBJECT TO ALL LAWS AND ORDINANCES, ORDERING A PLAT SHOWING SAID TERRITORY TO BE RECORDED IN THE OFFICE OF THE COUNTY RECORDER OF THE COUNTY OF CLARK, STATE OF NEVADA, AND PROVIDING OTHER MATTERS PROPERLY RELATED THERETO." was read by title by the City Attorney, who stated that this proposed Ordinance No. 1032 should be referred to a Committee.

M I N U T E S
SPECIAL MEETING
CITY PLANNING COMMISSION
February 5, 1963

A Special Meeting of the City Planning Commission was called to order at 10:30 AM by Acting Chairman Longley, Sr. in the Planning Director's Office, City Hall, Las Vegas, Nevada.

PRESENT: Messrs. Longley, Sr., Mirabelli, Johnston and Uehling.

ABSENT: Chairman Cahlan, Vice-Chairman Tiberti, Messrs. Gilday, Empey and City Manager Fletcher.

STAFF PRESENT: Director of Planning Don J. Saylor and Planning Analyst Harold Foster.

NEW BUSINESS:

1. A-5-63
Approved

Petition of ANNA MOHR for the annexation of property legally described as the S 1/2 of the SW 1/4 of Section 13, T20S, R60E, MDB&M and generally located on the northwest corner of Smoke Ranch Road and Michael Way. Mr. Saylor gave the staff report pointing out the location, and stated staff recommended approval. After discussion, Mr. Johnston moved that the petition of ANNA MOHR for the annexation of property generally located on the northwest corner of Smoke Ranch Road and Michael Way be approved. Mr. Mirabelli seconded the motion and the vote was unanimous.

2. A-6-63
Approved

Petition of JACK I. MADDALENA and BILL ACHURRA for the annexation of property legally described as the N 1/2 of the SE 1/4 of the SE 1/4 of the NE 1/4 of the NW 1/4 of the SE 1/4 of Section 19, T20S, R61E, MDB&M and generally located on the west side of Tonopah Hwy between Spring Road and College Avenue. (Save and excepting therefrom an easement to the public for street and road purposes over and along the west 30 feet of the above described property, further save and excepting therefrom an easement for utilities over and along the east 5 feet of the above described property). Mr. Saylor gave the staff report pointing out the location, stating staff recommended approval. After discussion, Mr. Johnston moved that the petition of JACK I. MADDALENA and BILL ACHURRA for the annexation of property generally located on the west side of Tonopah Hwy between Spring Road and College Avenue be approved. Mr. Mirabelli seconded the motion and the vote was unanimous.

3. CONTINENTAL
PARK NO. 2
County Referral
Final Map
Approved

Mr. Saylor presented the County referred final map of CONTINENTAL PARK NO. 2 pointing out the location. Staff recommended approval. After discussion, Mr. Johnston moved that the County referred final map of CONTINENTAL PARK NO. 2 be approved. Mr. Uehling seconded the motion and the vote was unanimous.

4. BRAMCREST
ESTATES
County Referral
Tentative Map
Approved

Mr. Saylor presented the County referred tentative map of BRAMCREST ESTATES, stating staff recommends approval. After discussion, Mr. Johnston moved that the County referred tentative map of BRAMCREST ESTATES be approved. Mr. Uehling seconded the motion and the vote was unanimous.

Date:

Honorable Mayor and Board of City Commissioners
City Hall
Las Vegas, Nevada

Gentlemen:

(I, We) the undersigned, (freeholder, freeholders) of the following
legally described property do hereby petition for annexation to the
City of Las Vegas, Nevada:

S $\frac{1}{2}$ SW $\frac{1}{4}$ Sect. 13, T20S, R60E

NW corner of Smoke Ranch Road and Michael Way.

Anna Mohr
Signature

Anna Mohr

Address

516 Las Vegas Blvd. So.
1321 East Oakey (residence)

Harry Mohr - agent

Attention: Mr. Saylor

Re:

Date:

Honorable Mayor and Board of City Commissioners
City Hall
Las Vegas, Nevada

Gentlemen:

(I, We) the undersigned, (freeholder, freeholders) of the following
legally described property do hereby petition for annexation to the
City of Las Vegas, Nevada:

Signature

Address

Attention: Mr. Saylor

Re:

February 4, 1963

City Clerk

Planning Department

Original Annexation Petition

Attached herewith is the original petition for annexation of Anna Mohr.

DON J. SAYLOR By Harold Foster
Director of Planning

DJS:eb
attachment

13

JONES

SHELIA AVE.
HILLCREST
MADRE MESA
ALFRED

DR.
MANOR
DR.

A-5-63

BEVVIE
JEAN

DECATUR

Smoke

Ranch

CITY LIMITS

MICHAEL

AUBURN
REITER
CURTIS
EUGENE

AVE.
AVE.
PARK
AVE.

MANOR

13

JONES

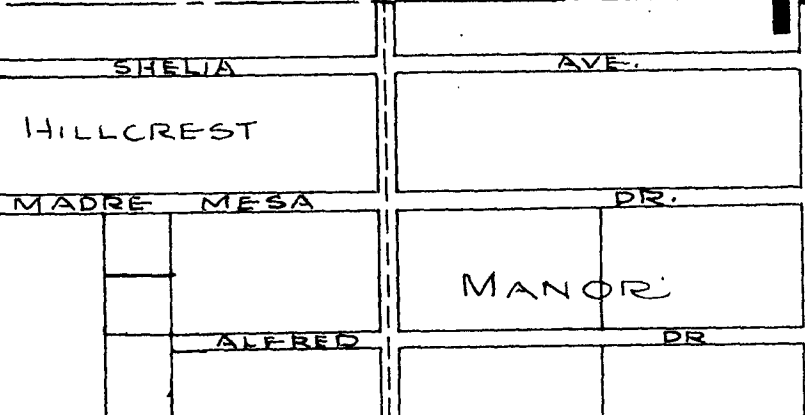

A-5-63

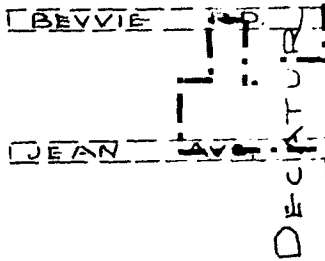

Smoke Ranch

CITY LIMITS

Smoke Ranch

MICHAEL

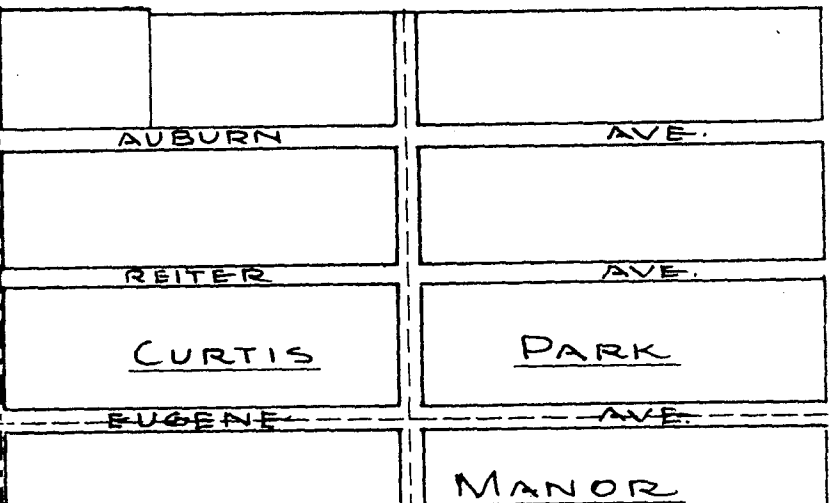

13

JONES

SHELIA AVE.

HILLCREST

MADRE MESA DR.

MANOR

ALFRED DR.

A-5-63

BEVVIE DR.

JEAN AVE.

DECATUR

Smoke Ranch

CITY LIMITS

MICHAEL

AUBURN AVE.

REITER AVE.

CURTIS PARK

EUGENE AVE.

MANOR

A-5-63

CITY LIMITS

WYANDOT

WYANDOT

WYANDOT

WYANDOT

WYANDOT

WYANDOT

WYANDOT

WYANDOT

WYANDOT

WYANDOT

WYANDOT

WYANDOT

WYANDOT

WYANDOT

WYANDOT

WYANDOT

WYANDOT

WYANDOT

WYANDOT

WYANDOT

WYANDOT

WYANDOT

WYANDOT

WYANDOT

14

13

WYANDOT