

Planning & Development Department
Scanning Cover Sheet

Case No A-3-84

APN N/A

Location DECATUR BLVD BTWN AUBORN & REITER AVE

Applicant George & Anna Essayian

Subject

Proposal for Annexation



ANNEXATION NUMBER

A-3-84A

1. Clerk for Date Stamping
2. Log in - make up file - White label (A# - Applicant - G.L.)
3. Prepare Name, Address & Annexation # for Foster's Secretary
4. Post Item Under Proper Planning Commission Meeting in Foster's Secretary's Office
5. Send Letter to Clark County Zoning for present zoning.
- 1-27-84 6. Request Comments from ^{ENR:} Public Services (~~Doug Peterson~~), Fire Services, Metro and Electric Division (George Ferris)
- 1-27-84 7. Request Public Services check survey map for accuracy and form, and provide legal metes and bounds description.
8. Planning Commission Hearing
9. When okay received by Public Services, send memo to City Attorney requesting ordinance preparation including:
 - a. Date of 1st Reading
 - b. Effective Date
 - c. General location
 - d. Present and conforming zoning
 - e. Acreage
 - f. Reminder Annexation must be heard prior to Reading
 - g. Provision in ordinance for Master Plan of Streets & Highways
 Along with five (5) copies of the survey map to be attached to Ordinance
10. Send letter to applicant stating when first ordinance reading
11. Memo to Public Services requesting recordation.
12. Send Memo to Public Services with certified copy of Annexation Ordinance CC: License, Fire, Building and Engineering (see sample)
13. Send letter to Mabel Snyder with same information prior to effective date
14. Send copy of Ordinance and Recorded Plat to Nevada Tax Commission by certified mail after effective date of annexation
15. Send letter to County with effective date
16. Send letter & copy of Ordinance to Applicant with effective date
17. Send copy of ordinance to Ernie Hutchison, Election Department
18. Send memo to Joel Harris, Permit Desk, advising annexation is effective (include location map).

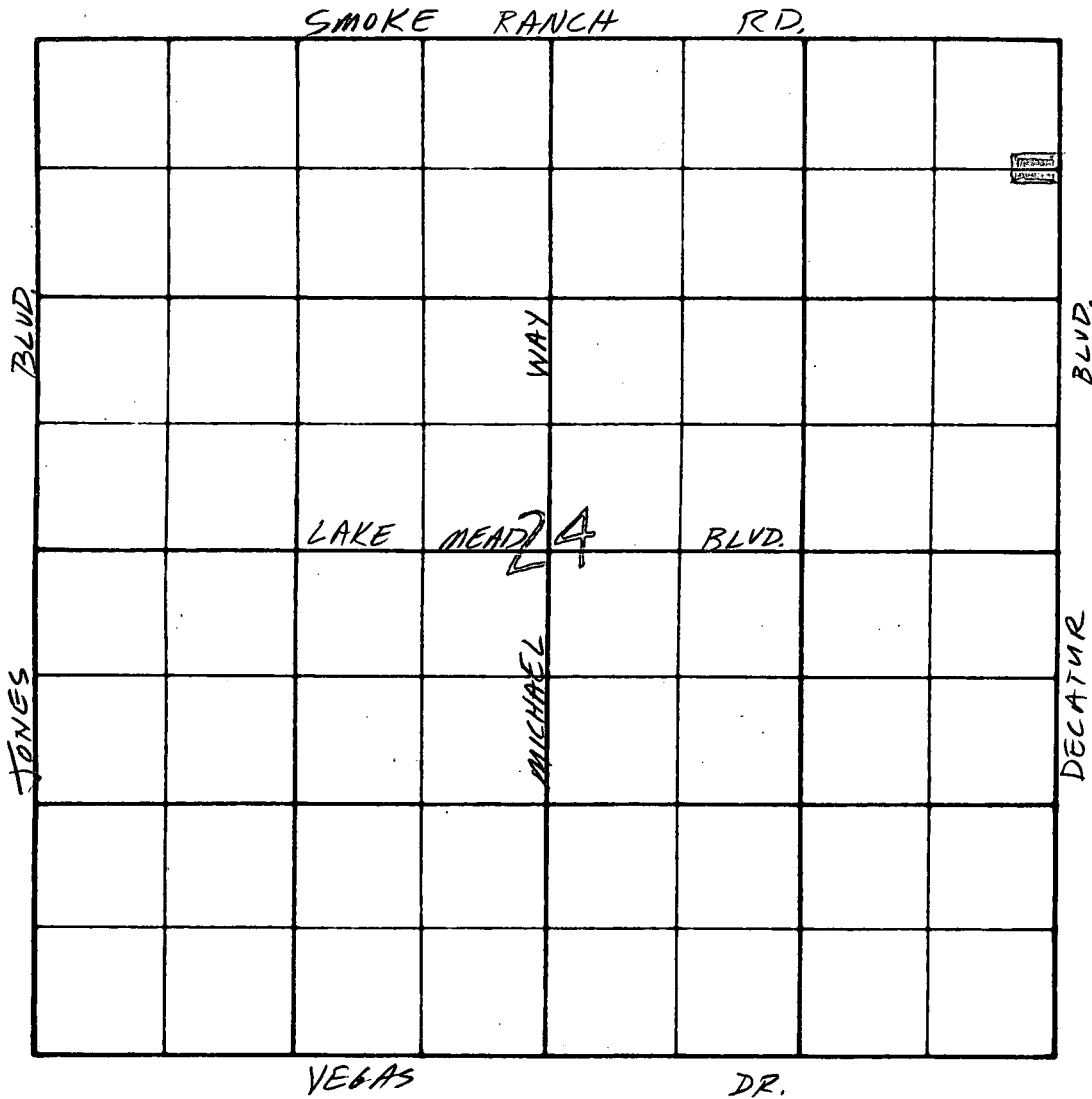

APPROVED _____ 198__
 EFFECTIVE DATE _____ 198__

SECTION 24
 RANGE 60 E.
 TOWNSHIP 20 S.

ORD. _____

A-3-84

NET - 0.55 AC.
 GROSS - 0.73

9. A-3-84(A)

APPROVED

Petition of Annexation submitted by GEORGE AND ANNA ESSAYIAN to annex property generally located on the west side of Decatur Boulevard between Auburn Avenue and Reiter Avenue, containing approximately 1/2 acre.

MR. NULL stated the County zoning on this parcel is R-E and the City equivalent would be N-U. Staff would recommend approval.

GEORGE ESSAYIAN, 9020 W. Washburn Road, appeared and represented the application.

MR. GUTHRIE made a Motion for APPROVAL of A-3-84(A).

Voting was as follows:

"AYES" Chairman Mack, Mrs. Tracy, Mr. Kennedy,
Mr. Bugbee, Mrs. Coleman, Mr. Guthrie

"NOES" None

"EXCUSED" Mr. Johnston

Motion for APPROVAL carried unanimously.

10. A-4-84(A)

APPROVED

Petition of Annexation submitted by GEORGE AND ANNA ESSAYIAN to annex property generally located on the west side of Decatur Boulevard between Sawyer Avenue and Lake Mead Boulevard, containing approximately 1/2 acre.

MR. NULL stated this parcel has County C-2 zoning and C-1 would be the City equivalent. Staff would recommend approval.

GEORGE ESSAYIAN, 9020 W. Washburn Road, appeared and represented the application.

MR. GUTHRIE made a Motion for APPROVAL of A-4-84(A).

Voting was as follows:

"AYES" Chairman Mack, Mrs. Tracy, Mr. Kennedy,
Mr. Bugbee, Mrs. Coleman, Mr. Guthrie

"NOES" None

"EXCUSED" Mr. Johnston

Motion for APPROVAL carried unanimously.

11. A-5-84(A)

APPROVED

Petition of Annexation submitted by STEVEN S. MILLER, INC. to annex property generally located on the southwest corner of Vegas Drive and Tenaya Way, containing approximately 15.05 acres.

MR. NULL stated this parcel has County R-E zoning and the City equivalent would be N-U. Staff would recommend approval.

CHARLEY JOHNSON, VTN-Nevada, 2800 West Sahara Avenue, appeared and represented the applicant.

MRS. TRACY made a Motion for APPROVAL of A-5-84(A).

Voting was as follows:

"AYES" Chairman Mack, Mrs. Tracy, Mr. Kennedy,
Mr. Bugbee, Mrs. Coleman, Mr. Guthrie

"NOES" None

"EXCUSED" Mr. Johnston

Motion for APPROVAL carried unanimously.

INTER-OFFICE MEMORANDUM

May 2, 1984

TO: FIRE SERVICES, JIM LONG & PAULA LEMKE
BUSINESS ACTIVITY
PERMIT DESK, JOEL HARRIS
RIGHT-OF-WAY
BUILDING AND SAFETY

FROM: *Howard A. Null*
HOWARD A. NULL
CHIEF, PLANNING DIVISION
DEPARTMENT OF COMMUNITY PLANNING
AND DEVELOPMENT

SUBJECT:

ANNEXATION: A-3-84(A)
GEORGE AND ANNA ESSAYIAN

COPIES TO:

ZONING DIVISION
CENTRAL TELEPHONE CO., CARMAN RHODA
CENTEL, DENNIS DOULDER

Please be advised that a parcel of land containing approximately one-half acre, generally located on the west side of Decatur Boulevard between Auburn Avenue and Reiter Avenue, has been annexed to the City of Las Vegas, effective April 27, 1984.

A location map and a copy of the Annexation Ordinance #3107 are attached for your reference.

HAN:jcd

Attachments:

1. Annex. Ord.
2. Location Map

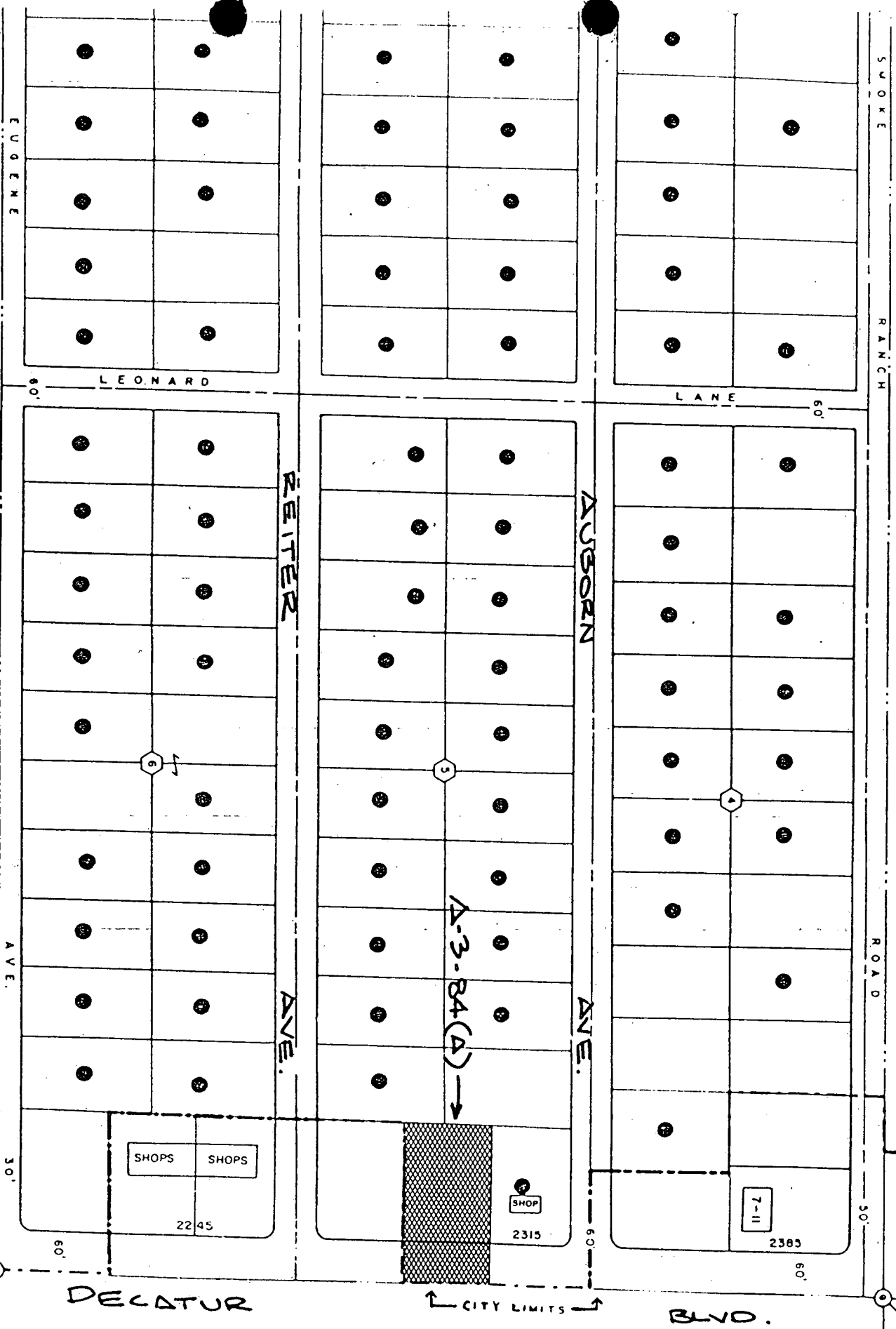

7

A-3-84(A)

1310
2419

MAYOR BILL BRIARE
COUNCILMEN
RON LURIE
PAUL J. CHRISTENSEN
AL LEVY
BOB NOLEN
CITY ATTORNEY
GEORGE F. OGILVIE
CITY MANAGER
ASHLEY HALL

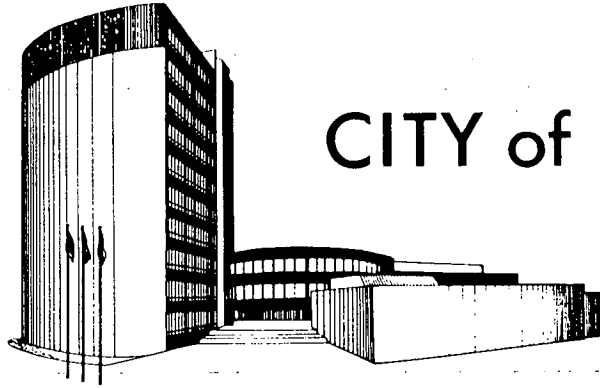

CITY of LAS VEGAS

February 13, 1984

George and Anna Essayian
9020 W. Washburn Road
Las Vegas, Nevada 89129

RE: A-3-84(A)

Dear Mr. and Mrs. Essayian:

Your petition to annex property generally located on the west side of Decatur Boulevard between Auburn Avenue and Reiter Avenue, containing approximately 1/2 acre, was considered by the City Planning Commission on February 9, 1984.

The Commission voted to refer this item with a recommendation of APPROVAL.

After further review, this annexation will be forwarded to the City Council for final action. You will receive notification of this meeting.

Sincerely,

DEPARTMENT OF COMMUNITY PLANNING
AND DEVELOPMENT
HAROLD P. FOSTER, DIRECTOR

HOWARD A. NULL
Chief of Planning

HPF:HAN:cme
cc: City Clerk



1 Bill No. 84-12

2 ORDINANCE NO. 3107

3
4 AN ORDINANCE EXTENDING THE CORPORATE LIMITS OF THE CITY OF LAS
5 VEGAS, NEVADA, TO INCLUDE WITHIN, ANNEX TO AND MAKE A PART OF
6 SAID CITY CERTAIN SPECIFICALLY DESCRIBED TERRITORY ADJOINING AND
7 CONTIGUOUS TO THE CORPORATE LIMITS OF SAID CITY; DECLARING SAID
8 TERRITORY AND THE INHABITANTS THEREOF TO BE ANNEXED TO SAID CITY
9 AND SUBJECT TO ALL DEBTS, LAWS, ORDINANCES AND REGULATIONS IN
10 FORCE IN SAID CITY; ORDERING A MAP OR PLAT OF SAID DESCRIBED
11 TERRITORY TO BE RECORDED IN THE OFFICE OF THE COUNTY RECORDER OF
12 THE COUNTY OF CLARK, STATE OF NEVADA; AND TO PROVIDE FOR OTHER
13 MATTERS PROPERLY RELATING THERETO; AND TO REPEAL ALL ORDINANCES
14 AND PARTS OF ORDINANCES IN CONFLICT HEREWITH.
15 (Annexation A-3-84(A))

11 Sponsored by
12 COUNCILMAN RON LURIE

Summary: Annexes property described
generally as located on the west
side of Decatur Boulevard between
Auborn Avenue and Reiter Avenue

14 THE CITY COUNCIL OF THE CITY OF LAS VEGAS, NEVADA,
15 DOES HEREBY ORDAIN AS FOLLOWS:

16 SECTION 1: The corporate limits of the City of Las
17 Vegas, Nevada, are hereby extended to include, annex to, and make
18 a part of the City of Las Vegas, Nevada, the following described
19 real property, to-wit:

20 That portion of CURTIS PARK MANOR UNIT NO. 2
21 as shown by map thereof on file in Book 5 of
22 Plats, Page 24, in the Office of the County
Recorder of Clark County, Nevada, described
as follows:

23 COMMENCING at the Southeast corner of said
24 CURTIS PARK MANOR UNIT NO. 2; thence along
25 the East line of said CURTIS PARK MANOR UNIT
26 NO. 2, North 01°10'48" East a distance of
27 600.15 feet to the intersection with the
28 Easterly prolongation of the South line of
29 Lot 22, Block 5 of said CURTIS PARK MANOR
UNIT NO. 2, said intersection being the
TRUE POINT OF BEGINNING; thence continuing
along said East line of CURTIS PARK MANOR
UNIT NO. 2, North 01°10'48" East a distance
of 128.12 feet to the Easterly prolongation
of the North line of said Lot 22; thence along
the said Easterly prolongation and said North
line of Lot 22, North 88°42'08" West a
distance of 248.47 feet to the West line of
said Lot 22; thence along said West line
of Lot 22, South 01°10'48" West a distance
of 128.12 feet to the South line of said

CERTIFIED AS A TRUE COPY

Carol Ann Hawley
CAROL ANN HAWLEY
CITY CLERK
CITY OF LAS VEGAS, NEVADA
4-23-84 (5 pages)

1 Lot 22; thence along the South line of said
2 Lot 22 and the Easterly prolongation of said
3 South line, South 88°42'08" East a distance
4 of 248.47 feet to the TRUE POINT OF BEGINNING .

5 SECTION 2: That said City Council has determined and
6 does hereby determine, that said described territory meets the
7 requirements provided by law for annexation to the City of Las
8 Vegas for the following reasons:

- 9 A. The area to be annexed was contiguous to the
10 City's boundaries at the time the annexation pro-
11 ceedings were instituted;
- 12 B. More than one-eighth (1/8) of the aggregate
13 external boundaries of the area are contiguous to the
14 City of Las Vegas;
- 15 C. The territory proposed to be annexed is not
16 included within the boundaries of another incor-
17 porated city or within the boundaries of any unin-
18 corporated town as those boundaries existed as of
19 July 1, 1983;
- 20 D. The City of Las Vegas is eligible to annex the
21 area described in this report since the landowners
22 have signed a petition requesting annexation to
23 the City, said petition constituting one hundred
24 percent (100%) of the owners of record of individual
25 lots or parcels of land within the annexation area.

26 SECTION 3: The City of Las Vegas will provide police
27 protection through the Las Vegas Metropolitan Police Department,
28 fire protection, street maintenance, and library services
29 immediately upon annexation. Garbage collection by the company
30 franchised by the City will also be provided immediately. The
31 City sanitary sewer system will serve the proposed annexation
32 area. Any connection to or extension of this sewer line to serve
the annexation area shall be at the expense of the landowners.
A-3-84(A)

1 Other services, such as participation in the City's recreational
2 programs, special educational classes and programs, public works
3 planning, building inspections, and other City Hall services
4 will also be available immediately. Utilities such as gas,
5 electricity, telephone, and water are provided by private utility
6 companies and other services to the area will not be affected by
7 annexation. Street paving, curbs and gutters, sidewalks and
8 street lights which are not in place at the time of annexation
9 will be installed in the presently developed areas upon the
10 request of the property owners and at their expense by means
11 of special assessment districts. Such improvements will be
12 extended into the undeveloped areas as development takes place
13 and the need therefor arises, and will be located according to
14 the needs of the area at that time. Such installations will
15 also be made at the expense of the property owners, either by
16 means of special assessment districts or as prerequisites to the
17 approval of subdivision plats or the issuance of building permits,
18 re-zonings, zone variances or special use permits.

19 SECTION 4: The annexation of said described territory
20 shall become effective on the 27th day of April, 1984, and on such
21 date the City of Las Vegas will have the funds appropriated in
22 sufficient amount to finance the extension into said described
23 territory of police protection, fire protection, street mainten-
24 ance, street sweeping, and street lighting maintenance.

25 SECTION 5: Said described territory, together with the
26 inhabitants and property thereof, shall, from and after the
27 27th day of April, 1984, be subject to all debts, laws, ordinances
28 and regulations in force in the City of Las Vegas and shall be
29 entitled to the same privileges and benefits as other parts of
30 said City, and shall be subject to municipal taxes levied by
31 the City of Las Vegas, Nevada.

32 SECTION 6: The City Engineer of the City of Las Vegas,
A-3-84(A)

1 The above and foregoing ordinance was first proposed and read by
2 title to the City Council on the 21st day of March,
3 1984, and referred to the following committee composed of
4 Councilmen Lurie and Nolen
5 for recommendation; thereafter the said committee reported
6 favorably on said ordinance on the 18th day of April,
7 1984, which was a regular meeting of said Council;
8 that at said regular meeting, the proposed ordinance
9 was read by title to the City Council as first introduced and
10 adopted by the following vote:

11
12 VOTING "AYE" Councilmen: Christensen, Levy, Lurie, Nolen and Mayor Briare
13 VOTING "NAY" Councilmen: NONE
14 ABSENT: NONE



15 APPROVED:
16
17 By William H. Briare
18 WILLIAM H. BRIARE, Mayor

19 ATTEST:
20
21 Carol Ann Hawley
22 Carol Ann Hawley, City Clerk

23
24
25
26
27
28
29 CLERK COURT NEVADA
30 JOAN L. SWIFT, RECORDER
31 RECORDED AT REQUEST OF

32 APR 25 9 15 AM '84

A-3-84 (A)

FEE _____ DEPUTY _____
OFFICIAL RECORDS
BOOK _____ INSTRUMENT _____

1910 1869850

MAYOR BILL BRIARE
COUNCILMEN
RON LURIE
PAUL J. CHRISTENSEN
AL LEVY
BOB NOLEN

CITY ATTORNEY
GEORGE F. OGILVIE

CITY MANAGER
RUSSELL W. DORN

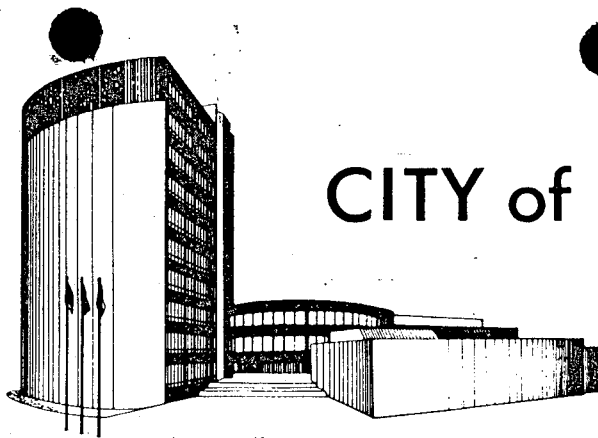

CITY of LAS VEGAS

May 2, 1984

CERTIFIED MAIL

Nevada State Tax Commission
State of Nevada
Carson City, Nevada 89701

RE: A-3-84(A) - Annexation

Gentlemen:

In compliance with Nevada Revised Statutes 268.600, a certified copy of an annexation ordinance for A-3-84(A) and recorded survey map are referred to your office.

The annexation area consists of approximately one-half acre of land, generally located on the west side of Decatur Boulevard between Auburn Avenue and Reiter Avenue.

If there are any questions regarding this annexation, please advise.

Sincerely,

DEPARTMENT OF COMMUNITY PLANNING
AND DEVELOPMENT

HAROLD P. FOSTER, DIRECTOR

HPF:jcd

Attachments:

1. Annex. Ord.
2. Survey Map

cc: City Clerk
Director of Finance



MAYOR BILL BRIARE
COUNCILMEN
RON LURIE
PAUL J. CHRISTENSEN
AL LEVY
BOB NOLEN
CITY ATTORNEY
GEORGE F. OGILVIE
CITY MANAGER
RUSSELL W. DORN

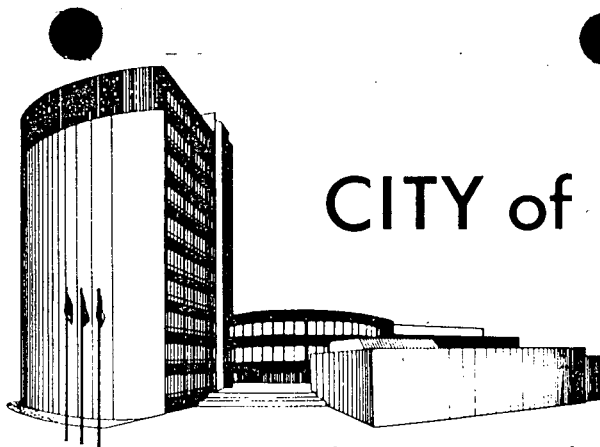

CITY of LAS VEGAS

May 2, 1984

Mr. Chuck Neiry
Clark County Elections Department
400 Las Vegas Boulevard South
Las Vegas, Nevada 89101

RE: Annexation - A-3-84(A)

Dear Mr. Neiry:

Please be advised that a parcel of land containing approximately one-half acre, generally located on the west side of Decatur Boulevard between Auburn Avenue and Reiter Avenue, has been annexed to the City of Las Vegas, effective April 27, 1984.

A location map, a copy of the Annexation Ordinance #3107, and a copy of the survey map are attached for your reference.

Sincerely,

DEPARTMENT OF COMMUNITY PLANNING
AND DEVELOPMENT
HAROLD P. FOSTER, DIRECTOR

HOWARD A. NULL
Chief of Planning

HPF:HAN:jcd

Attachments:

1. Location Map
2. Annex. Ord.
3. Survey Map



MAYOR BILL BRIARE
COUNCILMEN
RON LURIE
PAUL J. CHRISTENSEN
AL LEVY
BOB NOLEN
CITY ATTORNEY
GEORGE F. OGILVIE
CITY MANAGER
RUSSELL W. DORN

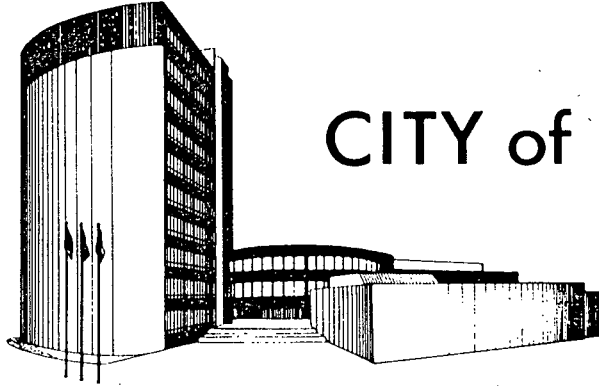

CITY of LAS VEGAS

May 2, 1984

Mrs. Mabel Snyder
Clark County Tax Assessor's Office
Clark County Courthouse
Las Vegas, Nevada 89101

RE: A-3-84(A) - Annexation

Dear Mrs. Snyder:

Please be advised that a parcel of land containing approximately one-half acre, generally located on the west side of Decatur Boulevard between Auburn Avenue and Reiter Avenue, has been annexed to the City of Las Vegas, effective April 27, 1984.

A location map and a copy of the Annexation Ordinance #3107 are attached for your reference.

Sincerely,

DEPARTMENT OF COMMUNITY PLANNING
AND DEVELOPMENT
HAROLD P. FOSTER, DIRECTOR

A handwritten signature in black ink, appearing to read "Howard A. Null". The signature is fluid and cursive, written over a light background.

HOWARD A. NULL
Chief of Planning

HPF:HAN:jcd

Attachments:

1. Location Map
2. Annex. Ord.



MAYOR BILL BRIARE
COUNCILMEN
RON LURIE
PAUL J. CHRISTENSEN
AL LEVY
BOB NOLEN
CITY ATTORNEY
GEORGE F. OGILVIE
CITY MANAGER
RUSSELL W. DORN



CITY of LAS VEGAS

May 2, 1984

George and Anna Essayian
9020 W. Washburn Road
Las Vegas, Nevada

RE: A-3-84(A)

Dear Mr. and Mrs. Essayian:

Please be advised that your petition to annex a parcel of land containing approximately one-half acre, generally located on the west side of Decatur Boulevard between Auburn Avenue and Reiter Avenue, has been annexed to the City of Las Vegas, effective April 27, 1984.

The Annexation Ordinance #3107 is attached for your reference.

Sincerely,

DEPARTMENT OF COMMUNITY PLANNING
AND DEVELOPMENT
HAROLD P. FOSTER, DIRECTOR

HOWARD A. NULL
Chief of Planning

HPF:HAN:jcd

Attachment
Annex. Ord.



MAYOR BILL BRIARE
COUNCILMEN
RON LURIE
PAUL J. CHRISTENSEN
AL LEVY
BOB NOLEN
CITY ATTORNEY
GEORGE F. OGILVIE
CITY MANAGER
RUSSELL W. DORN



CITY of LAS VEGAS

May 2, 1984

Susan French
Clark County Comprehensive Planning
Bridger Building, 7th Floor
225 Bridger Avenue
Las Vegas, Nevada 89155

RE: Annexation - A-3-84(A)

Dear Ms. French:

Please be advised that a parcel of land containing approximately one-half acre, generally located on the west side of Decatur Boulevard between Auburn Avenue and Reiter Avenue, has been annexed to the City of Las Vegas, effective April 27, 1984.

A location map and a copy of the Annexation Ordinance #3107 are attached for your reference.

Sincerely,

DEPARTMENT OF COMMUNITY PLANNING
AND DEVELOPMENT
HAROLD P. FOSTER, DIRECTOR

HOWARD A. NULL
Chief of Planning

HPF:HAN:jcd

Attachments:

1. Location Map
2. Annex. Ord.

cc: Clark County Public Works
Right-of-Way Division
Clark County Business
License Bureau



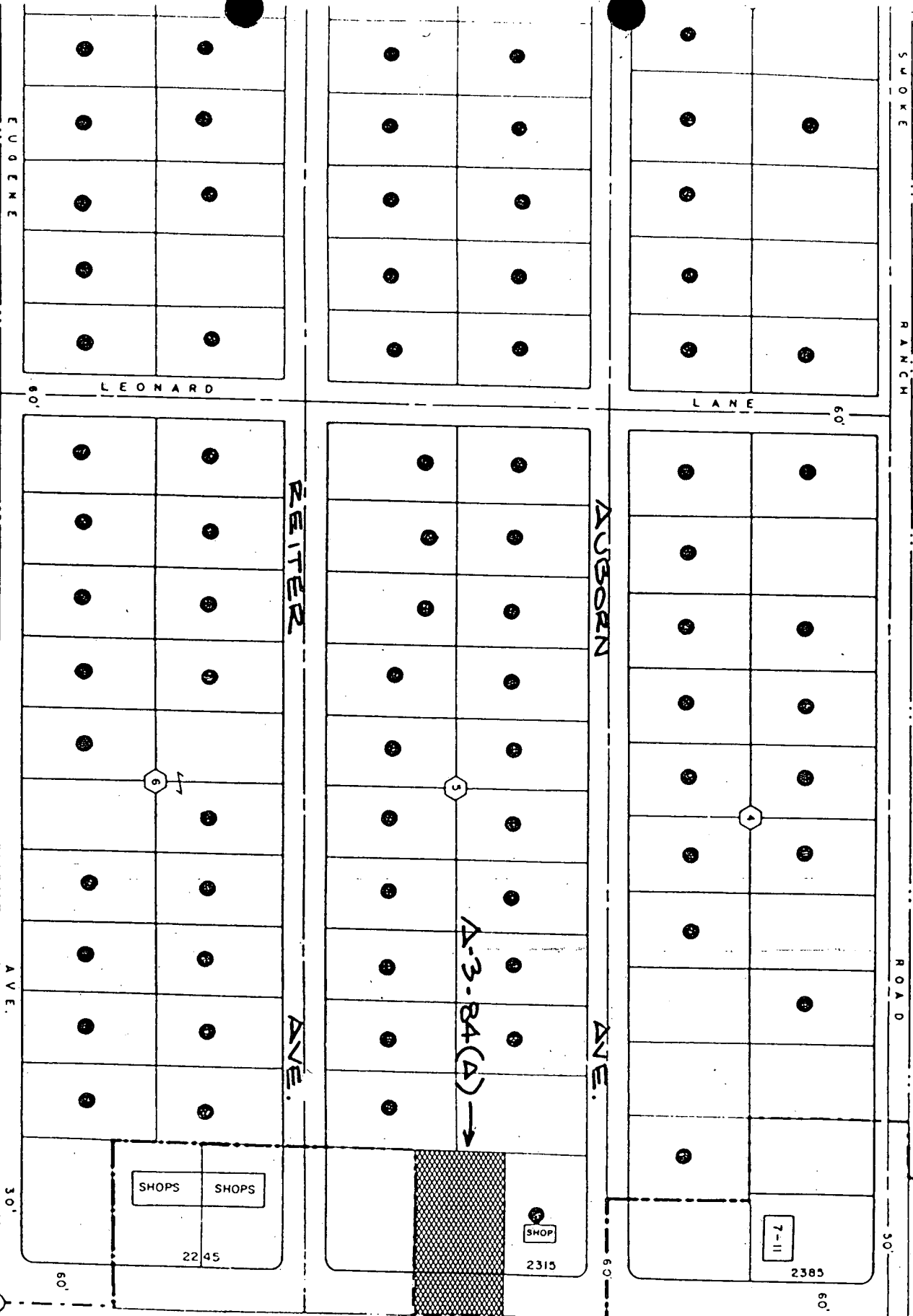

A-3-84(A)

110
2419

1 Bill No. 84-12

2 ORDINANCE NO. 3107

3
4 AN ORDINANCE EXTENDING THE CORPORATE LIMITS OF THE CITY OF LAS
5 VEGAS, NEVADA, TO INCLUDE WITHIN, ANNEX TO AND MAKE A PART OF
6 SAID CITY CERTAIN SPECIFICALLY DESCRIBED TERRITORY ADJOINING AND
7 CONTIGUOUS TO THE CORPORATE LIMITS OF SAID CITY; DECLARING SAID
8 TERRITORY AND THE INHABITANTS THEREOF TO BE ANNEXED TO SAID CITY
9 AND SUBJECT TO ALL DEBTS, LAWS, ORDINANCES AND REGULATIONS IN
10 FORCE IN SAID CITY; ORDERING A MAP OR PLAT OF SAID DESCRIBED
11 TERRITORY TO BE RECORDED IN THE OFFICE OF THE COUNTY RECORDER OF
12 THE COUNTY OF CLARK, STATE OF NEVADA; AND TO PROVIDE FOR OTHER
13 MATTERS PROPERLY RELATING THERETO; AND TO REPEAL ALL ORDINANCES
14 AND PARTS OF ORDINANCES IN CONFLICT HEREWITH.
15 (Annexation A-3-84(A))

11 Sponsored by
12 COUNCILMAN RON LURIE

Summary: Annexes property described
generally as located on the west
side of Decatur Boulevard between
Auborn Avenue and Reiter Avenue

14 THE CITY COUNCIL OF THE CITY OF LAS VEGAS, NEVADA,
15 DOES HEREBY ORDAIN AS FOLLOWS:

16 SECTION 1: The corporate limits of the City of Las
17 Vegas, Nevada, are hereby extended to include, annex to, and make
18 a part of the City of Las Vegas, Nevada, the following described
19 real property, to-wit:

20 That portion of CURTIS PARK MANOR UNIT NO. 2
21 as shown by map thereof on file in Book 5 of
22 Plats, Page 24, in the Office of the County
Recorder of Clark County, Nevada, described
as follows:

23 COMMENCING at the Southeast corner of said
24 CURTIS PARK MANOR UNIT NO. 2; thence along
the East line of said CURTIS PARK MANOR UNIT
25 NO. 2, North 01°10'48" East a distance of
600.15 feet to the intersection with the
26 Easterly prolongation of the South line of
Lot 22, Block 5 of said CURTIS PARK MANOR
UNIT NO. 2, said intersection being the
27 TRUE POINT OF BEGINNING; thence continuing
along said East line of CURTIS PARK MANOR
28 UNIT NO. 2, North 01°10'48" East a distance
of 128.12 feet to the Easterly prolongation
29 of the North line of said Lot 22; thence along
the said Easterly prolongation and said North
30 line of Lot 22, North 88°42'08" West a
distance of 248.47 feet to the West line of
31 said Lot 22; thence along said West line
of Lot 22, South 01°10'48" West a distance
32 of 128.12 feet to the South line of said

CERTIFIED AS A TRUE COPY

Carol A. Hawley
CAROL ANN HAWLEY
CITY CLERK
CITY OF LAS VEGAS, NEVADA
4-23-84 (5 pages)

1 Lot 22; thence along the South line of said
2 Lot 22 and the Easterly prolongation of said
3 South line, South 88°42'08" East a distance
4 of 248.47 feet to the TRUE POINT OF BEGINNING .

5 SECTION 2: That said City Council has determined and
6 does hereby determine, that said described territory meets the
7 requirements provided by law for annexation to the City of Las
8 Vegas for the following reasons:

9 A. The area to be annexed was contiguous to the
10 City's boundaries at the time the annexation pro-
11 ceedings were instituted;

12 B. More than one-eighth (1/8) of the aggregate
13 external boundaries of the area are contiguous to the
14 City of Las Vegas;

15 C. The territory proposed to be annexed is not
16 included within the boundaries of another incor-
17 porated city or within the boundaries of any unin-
18 corporated town as those boundaries existed as of
19 July 1, 1983;

20 D. The City of Las Vegas is eligible to annex the
21 area described in this report since the landowners
22 have signed a petition requesting annexation to
23 the City, said petition constituting one hundred
24 percent (100%) of the owners of record of individual
25 lots or parcels of land within the annexation area.

26 SECTION 3: The City of Las Vegas will provide police
27 protection through the Las Vegas Metropolitan Police Department,
28 fire protection, street maintenance, and library services
29 immediately upon annexation. Garbage collection by the company
30 franchised by the City will also be provided immediately. The
31 City sanitary sewer system will serve the proposed annexation
32 area. Any connection to or extension of this sewer line to serve
the annexation area shall be at the expense of the landowners.

A-3-84(A)

1 Other services, such as participation in the City's recreational
2 programs, special educational classes and programs, public works
3 planning, building inspections, and other City Hall services
4 will also be available immediately. Utilities such as gas,
5 electricity, telephone, and water are provided by private utility
6 companies and other services to the area will not be affected by
7 annexation. Street paving, curbs and gutters, sidewalks and
8 street lights which are not in place at the time of annexation
9 will be installed in the presently developed areas upon the
10 request of the property owners and at their expense by means
11 of special assessment districts. Such improvements will be
12 extended into the undeveloped areas as development takes place
13 and the need therefor arises, and will be located according to
14 the needs of the area at that time. Such installations will
15 also be made at the expense of the property owners, either by
16 means of special assessment districts or as prerequisites to the
17 approval of subdivision plats or the issuance of building permits,
18 re-zonings, zone variances or special use permits.

19 SECTION 4: The annexation of said described territory
20 shall become effective on the 27th day of April, 1984, and on such
21 date the City of Las Vegas will have the funds appropriated in
22 sufficient amount to finance the extension into said described
23 territory of police protection, fire protection, street mainten-
24 ance, street sweeping, and street lighting maintenance.

25 SECTION 5: Said described territory, together with the
26 inhabitants and property thereof, shall, from and after the
27 27th day of April, 1984, be subject to all debts, laws, ordinances
28 and regulations in force in the City of Las Vegas and shall be
29 entitled to the same privileges and benefits as other parts of
30 said City, and shall be subject to municipal taxes levied by
31 the City of Las Vegas, Nevada.

32 SECTION 6: The City Engineer of the City of Las Vegas,
A-3-84(A)

1 Nevada, is hereby instructed to cause to be prepared an accurate
2 map or plat of said described territory and to record the same,
3 together with a certified copy of this ordinance in the office of
4 the County Recorder of Clark County, Nevada, which said recording
5 shall be done prior to the 27th day of April, 1984.

6 SECTION 7: If any section, subsection, subdivision,
7 paragraph, sentence, clause or phrase in this Chapter or any
8 part thereof, is for any reason held to be unconstitutional, or
9 invalid or ineffective by any court of competent jurisdiction,
10 such decision shall not affect the validity or effectiveness of
11 the remaining portions of this Chapter or any part thereof. The
12 City Council of the City of Las Vegas hereby declares that it
13 would have passed each section, subsection, subdivision, para-
14 graph, sentence, clause or phrase thereof irrespective of the
15 fact that any one or more sections, subsections, subdivisions,
16 paragraphs, sentences, clauses or phrases be declared unconstitu-
17 tional, invalid or ineffective.

18 SECTION 8: All ordinances or parts of ordinances,
19 sections, subsections, phrases, sentences, clauses or paragraphs
20 contained in the Municipal Code of the City of Las Vegas, Nevada,
21 1983 Edition, in conflict herewith are hereby repealed.

22 PASSED, ADOPTED and APPROVED this 18th day of
23 April, 1984.

24 APPROVED:

25
26 By William H. Briare
27 WILLIAM H. BRIARE, Mayor



28 ATTEST:

29
30 Carol Ann Hawley
31 Carol Ann Hawley, City Clerk

32 A-3-84(A)

1 The above and foregoing ordinance was first proposed and read by
2 title to the City Council on the 21st day of March,
3 1984, and referred to the following committee composed of
4 Councilmen Lurie and Nolen
5 for recommendation; thereafter the said committee reported
6 favorably on said ordinance on the 18th day of April,
7 1984, which was a regular meeting of said Council;
8 that at said regular meeting, the proposed ordinance
9 was read by title to the City Council as first introduced and
10 adopted by the following vote:

11
12 VOTING "AYE" Councilmen: Christensen, Levy, Lurie, Nolen and Mayor Briare
13 VOTING "NAY" Councilmen: NONE
14 ABSENT: NONE



15 APPROVED:
16
17 By William H. Briare
18 WILLIAM H. BRIARE, Mayor

19 ATTEST:
20
21 Carol Ann Hawley
22 Carol Ann Hawley, City Clerk

CLARK COUNTY, NEVADA
JOAN L. SWIFT, RECORDER
RECORDED & INDEXED

APR 25 9 15 AM '84

FEE _____ DEPUTY _____
OFFICIAL RECORDS
BOOK _____ INSTRUMENT _____

A-3-84(A)

1910 1869850

AGENDA DOCUMENTATION

Date: March 14, 1984

TO: The City Council

FROM:

Val Steed
Deputy City Attorney

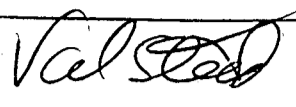

SUBJECT: Bill No. 84-12
Annexation No. A-3-84(A)

PURPOSE/BACKGROUND

The proposed ordinance annexes certain real property located on the west side of Decatur Boulevard between Auburn Avenue and Reiter Avenue. The annexation process has now been completed in accordance with the NRS and the final date of annexation (April 27, 1984) is set by this ordinance.

The following is pertinent information:

Annexation No.:	A-3-84(A)
Property Located:	On the west side of Decatur Boulevard between Auburn Avenue and Reiter Avenue
Petitioned By:	George and Anna Essayian 9020 West Washburn Road Las Vegas, Nevada
Acreage:	Approximately one-half acre
Zoned:	R-E (County classification) N-U (City equivalent)

FISCAL IMPACT

RECOMMENDATIONS

This Bill should be submitted to a Recommending Committee for review, hearing and recommendation to the City Council for final action.

Agenda Item

VIII-C

2 ORDINANCE NO. _____

3
4 AN ORDINANCE EXTENDING THE CORPORATE LIMITS OF THE CITY OF LAS
5 VEGAS, NEVADA, TO INCLUDE WITHIN, ANNEX TO AND MAKE A PART OF
6 SAID CITY CERTAIN SPECIFICALLY DESCRIBED TERRITORY ADJOINING AND
7 CONTIGUOUS TO THE CORPORATE LIMITS OF SAID CITY; DECLARING SAID
8 TERRITORY AND THE INHABITANTS THEREOF TO BE ANNEXED TO SAID CITY
9 AND SUBJECT TO ALL DEBTS, LAWS, ORDINANCES AND REGULATIONS IN
10 FORCE IN SAID CITY; ORDERING A MAP OR PLAT OF SAID DESCRIBED
11 TERRITORY TO BE RECORDED IN THE OFFICE OF THE COUNTY RECORDER OF
12 THE COUNTY OF CLARK, STATE OF NEVADA; AND TO PROVIDE FOR OTHER
13 MATTERS PROPERLY RELATING THERETO; AND TO REPEAL ALL ORDINANCES
14 AND PARTS OF ORDINANCES IN CONFLICT HEREWITH.
15 (Annexation A-3-84(A))

11 Sponsored by
12 COUNCILMAN RON LURIE

Summary: Annexes property described
generally as located on the west
side of Decatur Boulevard between
Auborn Avenue and Reiter Avenue

14 THE CITY COUNCIL OF THE CITY OF LAS VEGAS, NEVADA,
15 DOES HEREBY ORDAIN AS FOLLOWS:

16 SECTION 1: The corporate limits of the City of Las
17 Vegas, Nevada, are hereby extended to include, annex to, and make
18 a part of the City of Las Vegas, Nevada, the following described
19 real property, to-wit:

20 That portion of CURTIS PARK MANOR UNIT NO. 2
21 as shown by map thereof on file in Book 5 of
22 Plats, Page 24, in the Office of the County
Recorder of Clark County, Nevada, described
as follows:

23 COMMENCING at the Southeast corner of said
24 CURTIS PARK MANOR UNIT NO. 2; thence along
25 the East line of said CURTIS PARK MANOR UNIT
26 NO. 2, North 01°10'48" East a distance of
27 600.15 feet to the intersection with the
28 Easterly prolongation of the South line of
29 Lot 22, Block 5 of said CURTIS PARK MANOR
30 UNIT NO. 2, said intersection being the
31 TRUE POINT OF BEGINNING; thence continuing
32 along said East line of CURTIS PARK MANOR
UNIT NO. 2, North 01°10'48" East a distance
of 128.12 feet to the Easterly prolongation
of the North line of said Lot 22; thence along
the said Easterly prolongation and said North
line of Lot 22, North 88°42'08" West a
distance of 248.47 feet to the West line of
said Lot 22; thence along said West line
of Lot 22, South 01°10'48" West a distance
of 128.12 feet to the South line of said

1
2
3
4
5
6
7
8
9
10
11
12
13
14
15
16
17
18
19
20
21
22
23
24
25
26
27
28
29
30
31
32

Lot 22; thence along the South line of said Lot 22 and the Easterly prolongation of said South line, South 88°42'08" East a distance of 248.47 feet to the TRUE POINT OF BEGINNING.

SECTION 2: That said City Council has determined and does hereby determine, that said described territory meets the requirements provided by law for annexation to the City of Las Vegas for the following reasons:

- A. The area to be annexed was contiguous to the City's boundaries at the time the annexation proceedings were instituted;
- B. More than one-eighth (1/8) of the aggregate external boundaries of the area are contiguous to the City of Las Vegas;
- C. The territory proposed to be annexed is not included within the boundaries of another incorporated city or within the boundaries of any unincorporated town as those boundaries existed as of July 1, 1983;
- D. The City of Las Vegas is eligible to annex the area described in this report since the landowners have signed a petition requesting annexation to the City, said petition constituting one hundred percent (100%) of the owners of record of individual lots or parcels of land within the annexation area.

SECTION 3: The City of Las Vegas will provide police protection through the Las Vegas Metropolitan Police Department, fire protection, street maintenance, and library services immediately upon annexation. Garbage collection by the company franchised by the City will also be provided immediately. The City sanitary sewer system will serve the proposed annexation area. Any connection to or extension of this sewer line to serve the annexation area shall be at the expense of the landowners.

A-3-84(A)

1 Other services, such as participation in the City's recreational
2 programs, special educational classes and programs, public works
3 planning, building inspections, and other City Hall services
4 will also be available immediately. Utilities such as gas,
5 electricity, telephone, and water are provided by private utility
6 companies and other services to the area will not be affected by
7 annexation. Street paving, curbs and gutters, sidewalks and
8 street lights which are not in place at the time of annexation
9 will be installed in the presently developed areas upon the
10 request of the property owners and at their expense by means
11 of special assessment districts. Such improvements will be
12 extended into the undeveloped areas as development takes place
13 and the need therefor arises, and will be located according to
14 the needs of the area at that time. Such installations will
15 also be made at the expense of the property owners, either by
16 means of special assessment districts or as prerequisites to the
17 approval of subdivision plats or the issuance of building permits,
18 re-zonings, zone variances or special use permits.

19 SECTION 4: The annexation of said described territory
20 shall become effective on the 27th day of April, 1984, and on such
21 date the City of Las Vegas will have the funds appropriated in
22 sufficient amount to finance the extension into said described
23 territory of police protection, fire protection, street mainten-
24 ance, street sweeping, and street lighting maintenance.

25 SECTION 5: Said described territory, together with the
26 inhabitants and property thereof, shall, from and after the
27 27th day of April, 1984, be subject to all debts, laws, ordinances
28 and regulations in force in the City of Las Vegas and shall be
29 entitled to the same privileges and benefits as other parts of
30 said City, and shall be subject to municipal taxes levied by
31 the City of Las Vegas, Nevada.

32 SECTION 6: The City Engineer of the City of Las Vegas,
A-3-84(A)

1 Nevada, is hereby instructed to cause to be prepared an accurate
2 map or plat of said described territory and to record the same,
3 together with a certified copy of this ordinance in the office of
4 the County Recorder of Clark County, Nevada, which said recording
5 shall be done prior to the 27th day of April, 1984.

6 SECTION 7: If any section, subsection, subdivision,
7 paragraph, sentence, clause or phrase in this Chapter or any
8 part thereof, is for any reason held to be unconstitutional, or
9 invalid or ineffective by any court of competent jurisdiction,
10 such decision shall not affect the validity or effectiveness of
11 the remaining portions of this Chapter or any part thereof. The
12 City Council of the City of Las Vegas hereby declares that it
13 would have passed each section, subsection, subdivision, para-
14 graph, sentence, clause or phrase thereof irrespective of the
15 fact that any one or more sections, subsections, subdivisions,
16 paragraphs, sentences, clauses or phrases be declared unconstitu-
17 tional, invalid or ineffective.

18 SECTION 8: All ordinances or parts of ordinances,
19 sections, subsections, phrases, sentences, clauses or paragraphs
20 contained in the Municipal Code of the City of Las Vegas, Nevada,
21 1983 Edition, in conflict herewith are hereby repealed.

22 PASSED, ADOPTED and APPROVED this _____ day of
23 _____, 1984.

24 APPROVED:

25
26 By _____
WILLIAM H. BRIARE, Mayor

27
28 ATTEST:

29
30 _____
Carol Ann Hawley, City Clerk

31
32 A-3-84(A)

1 The above and foregoing ordinance was first proposed and read by
2 title to the City Council on the ____ day of _____,
3 1984, and referred to the following committee composed of
4 Councilmen _____ and _____
5 for recommendation; thereafter the said committee reported
6 favorably on said ordinance on the ____ day of _____,
7 1984, which was a _____ meeting of said Council;
8 that at said _____ meeting, the proposed ordinance
9 was read by title to the City Council as first introduced and
10 adopted by the following vote:

11
12 VOTING "AYE" Councilmen: _____
13 VOTING "NAY" Councilmen: _____
14 ABSENT: _____

15 APPROVED:

16
17 By _____
18 WILLIAM H. BRIARE, Mayor

19 ATTEST:
20
21 _____
22 Carol Ann Hawley, City Clerk

23
24
25
26
27
28
29
30
31
32

A-3-84 (A)

INTER-OFFICE MEMORANDUM

Date

APRIL 24, 1984

<p>TO:</p> <p>DEPARTMENT OF ENGINEERING SERVICES RIGHT-OF-WAY DIVISION</p>	<p>FROM:</p> <p><i>Howard A. Null</i> HOWARD A. NULL, CHIEF OF PLANNING DIVISION DEPT. OF COMMUNITY PLANNING & DEVELOPMENT</p>
<p>SUBJECT:</p> <p>RECORDATION: A-3-84(A)</p>	<p>COPIES TO:</p>

The above Annexation MUST BE RECORDED BEFORE APRIL 26, 1984 .

Please return a Recorded Copy for our file.

Thank you.

HAN:hb
Attach.

INTER-OFFICE MEMORANDUM

Date

February 29, 1984

TO:

CITY ATTORNEY'S OFFICE

FROM:

Howard A. Null
HOWARD A. NULL, CHIEF OF PLANNING,
DEPARTMENT OF COMMUNITY PLANNING
AND DEVELOPMENT

SUBJECT:

ANNEXATION - A-3-84(A)
GEORGE AND ANNA ESSAYIAN

COPIES TO:

Please begin preparation of the annexation ordinance to have an effective day of April 27, 1984 for the subject annexation. This annexation is under the alternate annexation provisions provided for by Senate Bill 427.

The annexation area is generally located on the west side of Decatur Boulevard between Auburn Avenue and Reiter Avenue containing approximately one-half acre of land. The land is presently vacant with the County Zoning of R-E, which is comparable to the City's N-U Zone.

Please send us a copy of the Ordinance when it is completed. It is requested that the first reading of this Ordinance be scheduled for March 21, 1984 and the second reading for the April 18, 1984 City Council meetings.

HAN:cme
Attachments

CITY OF LAS VEGAS
ORDINANCE REQUEST MEMORANDUM

February 29, 1984

DATE

TO: CITY MANAGER	FROM: HAROLD P. FOSTER, DIRECTOR DEPARTMENT OF COMMUNITY PLANNING AND DEVELOPMENT
SUBJECT OF ORDINANCE: Annexation A-3-84(A)	APPROVED TO FORWARD: CITY MANAGER
SPONSOR:	DATE:
DATE:	DATE TO CITY ATTORNEY: _____ DATE TO SUBMITTING DEPT: _____

To comply with N.R.S. step requirements



Department of
Comprehensive Planning

Zoning Division

JOHN VORNAND
ZONING ADMINISTRATOR

GREG BORGEL
COORDINATOR

PUBLIC SERVICES BUILDING
401 SOUTH FOURTH STREET
LAS VEGAS, NEVADA 89101
(702) 386-4314

February 14, 1984

Mr. Howard A. Null
Chief of Planning Division
Community Planning & Development
City of Las Vegas
400 E. Stewart
Las Vegas, NV 89101

RE: ~~A~~-3(A); A-4(A); A-5(A)

Dear Mr. Null:

The above annexation areas are zoned as follows:

A-3(A) - RE (Rural Estates Residential)
A-4(A) - C-2 (General Commercial)
A-5(A) - RE (Rural Estates Residential)

At this time there are no pending applications.

Sincerely,

A handwritten signature in cursive script that reads 'Joyce Avery'.

JOYCE AVERY
Zoning Specialist

/dl

COMMISSIONERS

Thalia M. Dondero, Chairman • Jack R. Petitti, Vice-Chairman
Manuel J. Cortez, Karen Hayes, R.J. "Dick" Ronzone, Woodrow Wilson, Bruce L. Woodbury
Bruce W. Spaulding, County Manager • Joseph C. Denny, Assistant County Manager

TO: COMMUNITY PLANNING & DEVELOPMENT

FROM: FIRE PREVENTION BUREAU

SUBJECT: A-3-84(A)

- 1. No Objections.
- 2. Fire hydrant(s) to be installed when water is available to area.
- 3. Fire hydrant to be installed within 300 feet of the building or existing hydrant.
- 4. Fire hydrants to be installed in accordance with current fire code adopting ordinance.
- 5. Fire flow requirements to be determined when final construction plans are submitted.
- 6. Hydrants are to be installed and charged with water before construction begins.
- 7. Must meet requirements of Uniform Fire Code.
- 8. Dead end fire lanes not to exceed 150'.
- 9. Cul-de-sacs not to exceed 400'. Minimum turning radius of 45' 6".
- 10. Crash gate(s) shall be approved by the Fire Department prior to installation.
- 11. If private streets are to be named, names are to be checked by Alarm Office to eliminate duplication.

OTHER: _____



R. Joseph
FIRE PREVENTION OFFICER

INTER-OFFICE MEMORANDUM

Date

February 27, 1984

TO: Community Planning & Development	FROM: Engineering Services
SUBJECT: George & Anna Essayian A-3-84(A)	COPIES TO: C. D. Peterson Right-of-Way Right-of-Way Design

Attached is the requested legal description for the subject Annexation.



C. D. PETERSON, R.L.S.

CDP:bc
Attchmt.

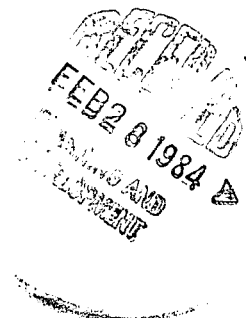

CITY OF LAS VEGAS
DEPARTMENT OF PUBLIC SERVICES
RIGHT OF WAY DESIGN SECTION
LEGAL DESCRIPTION

Tax Parcel No. _____

Document No. _____

Vesting A 3-84(A)

Section _____

Street/Subdivision _____

Requested cdp Written bb Checked mwb Proofread mwb+bb
2/23/84 23 Feb 84

That portion of CURTIS PARK MANOR UNIT NO. 2 as shown by map thereof on file in Book 5 of Plats, Page 24, in the Office of the County Recorder of Clark County, Nevada, described as follows:

COMMENCING at the Southeast corner of said CURTIS PARK MANOR UNIT NO. 2; thence along the East line of said CURTIS PARK MANOR UNIT NO. 2, North 01°10'48" East a distance of 600.15 feet to the intersection with the Easterly prolongation of the South line of Lot 22, Block 5 of said CURTIS PARK MANOR UNIT NO. 2, said intersection being the TRUE POINT OF BEGINNING; thence continuing along said East line of CURTIS PARK MANOR UNIT NO. 2, North 01°10'48" East a distance of 128.12 feet to the Easterly prolongation of the North line of said Lot 22; thence along the said Easterly prolongation and said North line of Lot 22, North 88°42'08" West a distance of 248.47 feet to the West line of said Lot 22; thence along said West line of Lot 22, South 01°10'48" West a distance of 128.12 feet to the South line of said Lot 22; thence along the South line of said Lot 22 and the Easterly prolongation of said South line, South 88°42'08" East a distance of 248.47 feet to the TRUE POINT OF BEGINNING.

RECEIVED
FEB 29 1924
U.S. DEPARTMENT OF AGRICULTURE
WASHINGTON, D.C.

INTER-OFFICE MEMORANDUM

February 2, 1984

TO:

Community Planning & Development

FROM:

Engineering Services

SUBJECT:

George and Anna Essayian
A-3-84

COPIES TO:

Right-of-Way
Traffic Engineering
C. D. Peterson
Permits

Your memorandum dated January 27, 1984 requested comments from this Department as soon as possible concerning the petition of George and Anna Essayian for the annexation of property generally located on the west side of Decatur Boulevard between Auburn Avenue and Reiter Avenue, containing approximately one-half acre of land into the corporate limits of the City of Las Vegas.

There are ample facilities along Decatur Boulevard to service this property when it is developed. The off-site improvements abutting this property are existing with the exception of sidewalks.



C. D. PETERSON
Land Development & Flood Control

CDP:bc



INTER-OFFICE MEMORANDUM

Date

February 2, 1984

TO:

Community Planning & Development

FROM:

Engineering Services

SUBJECT:

George and Anna Essayian
A-3-84

COPIES TO:

Right-of-Way
Traffic Engineering
C. D. Peterson
Permits

Your memorandum dated January 27, 1984 requested comments from this Department as soon as possible concerning the petition of George and Anna Essayian for the annexation of property generally located on the west side of Decatur Boulevard between Auburn Avenue and Reiter Avenue, containing approximately one-half acre of land into the corporate limits of the City of Las Vegas.

There are ample facilities along Decatur Boulevard to service this property when it is developed. The off-site improvements abutting this property are existing with the exception of sidewalks.



C. D. PETERSON
Land Development & Flood Control

CDP:bc

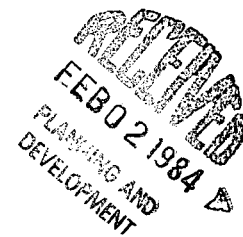

LAS VEGAS METROPOLITAN POLICE DEPARTMENT

MEMORANDUM

Date: 1-31-84

To : HOWARD A. NULL - PLANNING DIVISION

Subject : A - 3 - 84

This Department has no objections as long as this meets the requirements of the City.



O.A. STEELE, LIEUTENANT
TRAFFIC BUREAU

OAS:cp

INTER-OFFICE MEMORANDUM

January 27, 1984

TO:

ENGINEERING SERVICES DEPARTMENT
 FIRE SERVICES (JIM LONG)
 ✓ FIRE SERVICES, ALARM OFFICE (PAULA)
 METROPOLITAN POLICE DEPARTMENT
 GEORGE FERRIS, ELECTRICAL DIVISION

FROM:

HOWARD A. NULL, CHIEF
 PLANNING DIVISION
 DEPARTMENT OF COMMUNITY PLANNING
 AND DEVELOPMENT

SUBJECT:

A-3-84 (A)

GEORGE & ANNA ESSAYIAN

COPIES TO:

Please provide your comments regarding the subject Annexation Petition for property generally located west side of Decatur Blvd. between Auburn Avenue and Reiter Avenue

containing approximately 1/2 acres of land.

In particular, we need to know if sewer and drainage as well as other facilities will be adequate to handle this proposed annexation. This petition for annexation will be heard at the February 9, 1984 Planning Commission meeting, so your comments would be appreciated as soon as possible.

Attached is a map for your reference. Also attached is a copy of the Petition for Annexation.

HAN:jk

attachments: Petition for Annexation
 Location Map

No Comment

*Don Kilbert
 Planning Aide
 1-31-84*



*REC. A.D.
 1-31-84*

INTER-OFFICE MEMORANDUM

Date

January 26, 1984

TO:

DENNES JENSEN, CHIEF OF LAND DEVELOPMENT
AND FLOOD CONTROL DIVISION
DEPT. OF ENGINEERING SERVICES

FROM:

Howard A. Null
HOWARD A. NULL, CHIEF
PLANNING DIVISION
DEPT. OF COMMUNITY PLANNING & DEVELOPMENT

SUBJECT:

A-3-84 (A)
GEORGE & ANNA ESSAYIAN

COPIES TO:

Please check the attached survey map(s) provided by the applicant for accuracy and that it is in proper form for recording.

Please provide a proper legal description for the above referenced annexation.

We would appreciate receiving this data as soon as practical in order to schedule this Annexation for first Ordinance reading.

HAN:hb

Attachs: Survey Maps (2)
Petition for Annexation
Legal Description
Location Map

INTER-OFFICE MEMORANDUM

Date

January 27, 1984

TO:

ENGINEERING SERVICES DEPARTMENT
FIRE SERVICES (JIM LONG)
FIRE SERVICES, ALARM OFFICE (PAULA)
METROPOLITAN POLICE DEPARTMENT
GEORGE FERRIS, ELECTRICAL DIVISION

FROM:

HOWARD A. NULL, CHIEF
PLANNING DIVISION
DEPARTMENT OF COMMUNITY PLANNING
AND DEVELOPMENT

SUBJECT:

A-3-84(A)

GEORGE & ANNA ESSAYIAN

COPIES TO:

Please provide your comments regarding the subject Annexation Petition for property generally located west side of Decatur Blvd. between Auburn Avenue and Reiter Avenue

containing approximately 1/2 acres of land.

In particular, we need to know if sewer and drainage as well as other facilities will be adequate to handle this proposed annexation. This petition for annexation will be heard at the February 9, 1984 Planning Commission meeting, so your comments would be appreciated as soon as possible.

Attached is a map for your reference. Also attached is a copy of the Petition for Annexation.

HAN:jk

attachments: Petition for Annexation
Location Map

C I T Y O F L A S V E G A S

DEPARTMENT OF COMMUNITY PLANNING AND DEVELOPMENT

ANNEXATION TRANSMITTAL

DATE: January 27, 1984

TO: GREG BORGEL, ZONING COORDINATOR
CLARK COUNTY DEPARTMENT OF BUILDING
AND ZONING, ZONING DIVISION
CLARK COUNTY COURTHOUSE ANNEX
400 LAS VEGAS BOULEVARD SOUTH
LAS VEGAS, NEVADA 89101

RE: A-3-84(A)
GEORGE AND ANNA ESSAYIAN

An annexation petition has been submitted to the City of Las Vegas on property generally located west side of Decatur Blvd. between Auburn Avenue and Reiter Avenue, containing approximately 1/2 acres of land.

Please advise me of the present zoning for this property, as well as any resolutions of intent that have been approved giving the zoning case number and date of expiration. I am attaching a copy of the petition containing the legal description and a location map for your reference. I would appreciate receiving this information at your earliest convenience.

Sincerely,
COMMUNITY PLANNING AND DEVELOPMENT
HAROLD P. FOSTER, DIRECTOR

Howard A. Null, Chief
Planning Division

HAN:bjl
attachments: Petition
Legal Description
Location Map

PETITION FOR ANNEXATION

RECEIVED

TO THE HONORABLE WILLIAM H. BRIARE,
MAYOR OF THE CITY OF LAS VEGAS, NEVADA

JAN 27 8 40 AM '84

and

CITY CLERK

BOARD OF COUNCILMEN OF THE CITY OF LAS VEGAS, NEVADA

Linda M. Owens

Gentlemen:

The undersigned, being owners of real property situate within the boundaries of the territory hereinafter described, do hereby petition your honorable Board to annex and include within the corporate limits of the City of Las Vegas, Nevada, pursuant to the provisions of the Nevada Revised Statutes 268.570-268.608 inclusive, the territory being more particularly described as follows: to-wit:

Lot Twenty-two (22), Block 5 (5), CURTIS PARK MANOR NO. 2

NO. OF ACRES TO BE ANNEXED: 1/2

GENERAL LOCATION OF ANNEXATION AREA: West side of Decatur Boulevard
between Auburn Avenue and Reiter Avenue.

Respectfully submitted,

NAME (Print)

SIGNATURE:

GEORGE ESSAYIAN
ANNA ESSAYIAN

George Essayian
Anna Essayian

ADDRESS: 9020 W. Washburn Road
Las Vegas, Nv.

TELEPHONE #: 645-2427

**Additional property owners may sign on an attached sheet.

A copy of the Deed of Ownership is required.

HAN:jk

A-3-84 (A)

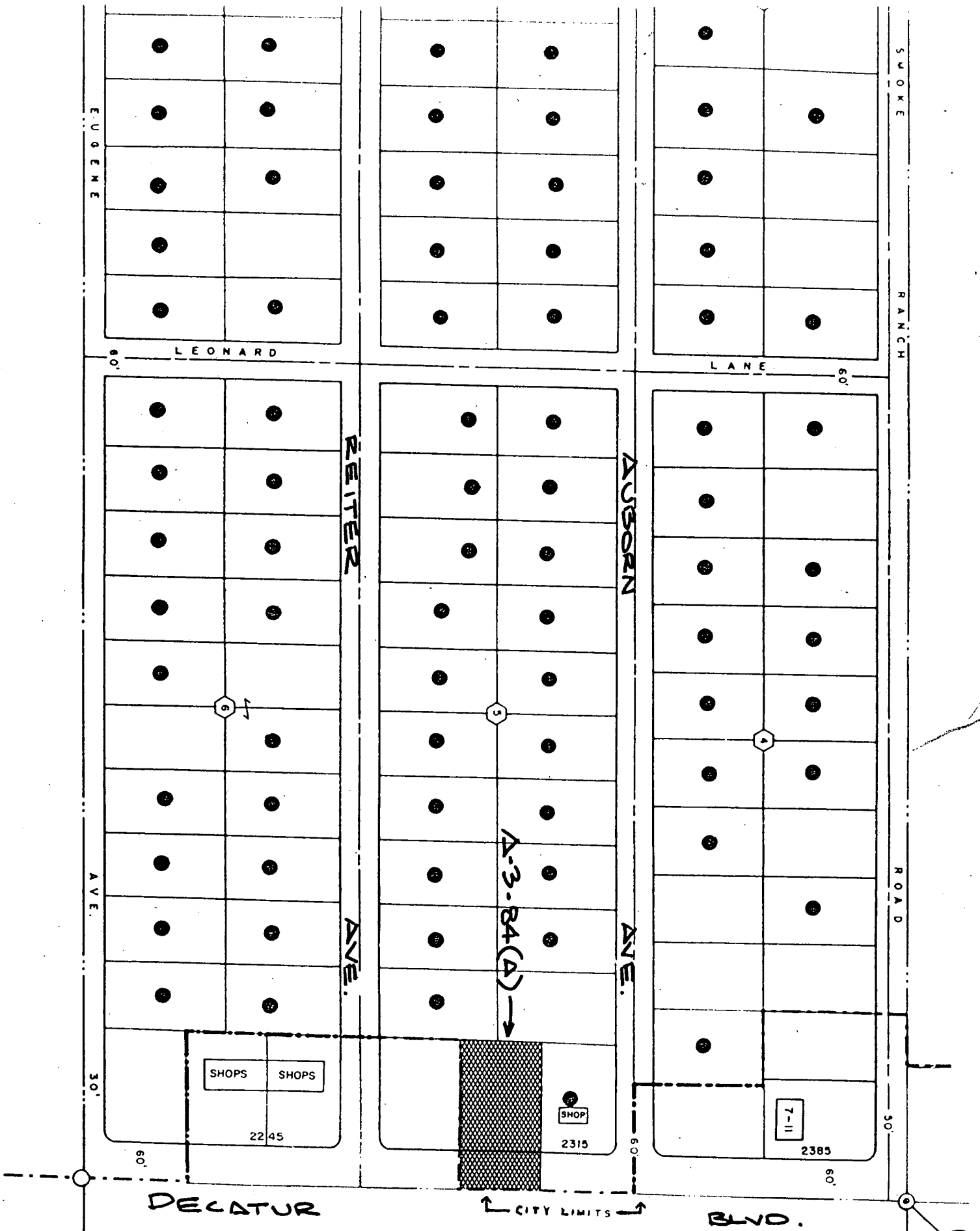

7A

A-3-84(A)

1318
2419

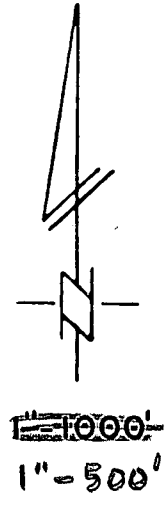
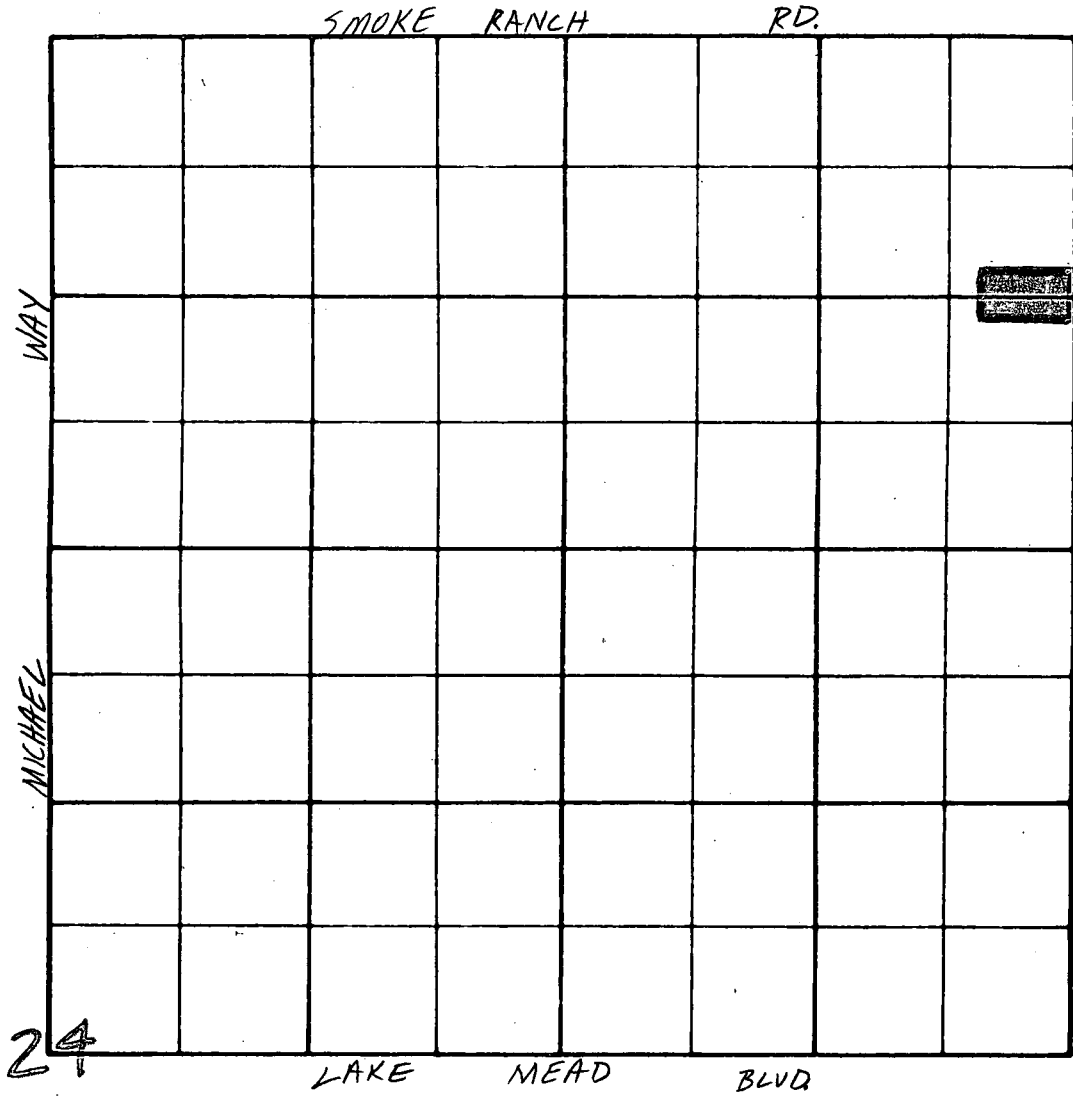

APPROVED _____ 198__
 EFFECTIVE DATE _____ 198__

SECTION 24 (NE 1/4)
 RANGE 60 E.
 TOWNSHIP 20 S.

ORD. _____

A-3-84

NET. 0.55 AC.
 GROSS 0.73