

**Planning & Development Department
Scanning Cover Sheet**

Case No A-0002-88 (A)

APN

Location LORENZI BLVD & PEAK DR

Applicant

EVALYN J EFFINGER

Subject

PROPOSAL FOR ANNEXATION



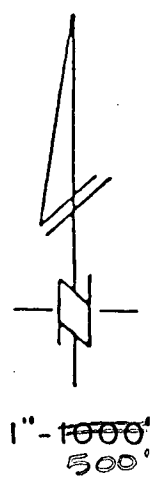
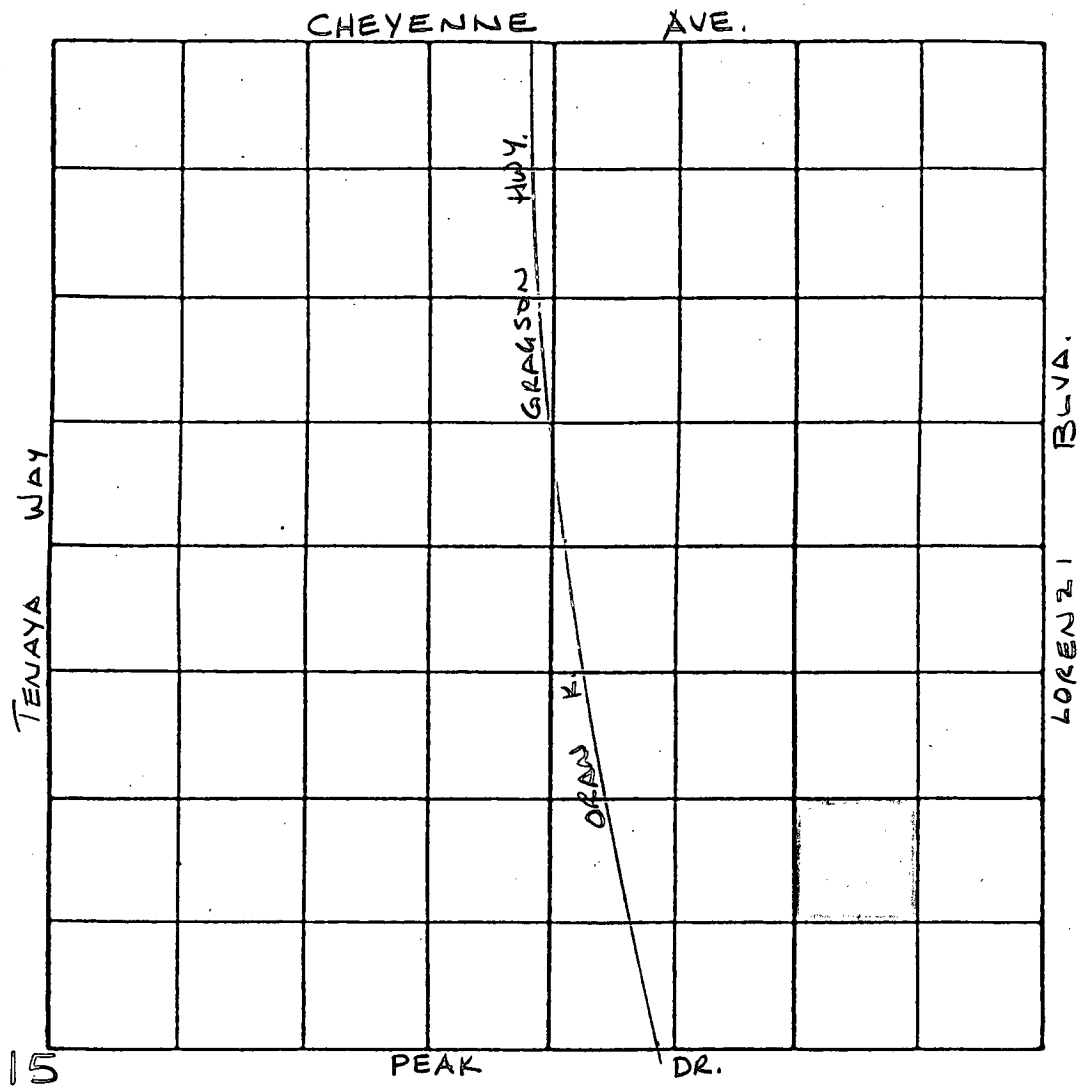

APPROVED _____ 198__
 EFFECTIVE DATE _____ 198__

SECTION 15
 RANGE 60 E.
 TOWNSHIP 20 S.

ORD. 3350

A-2-88

2.606 AC.

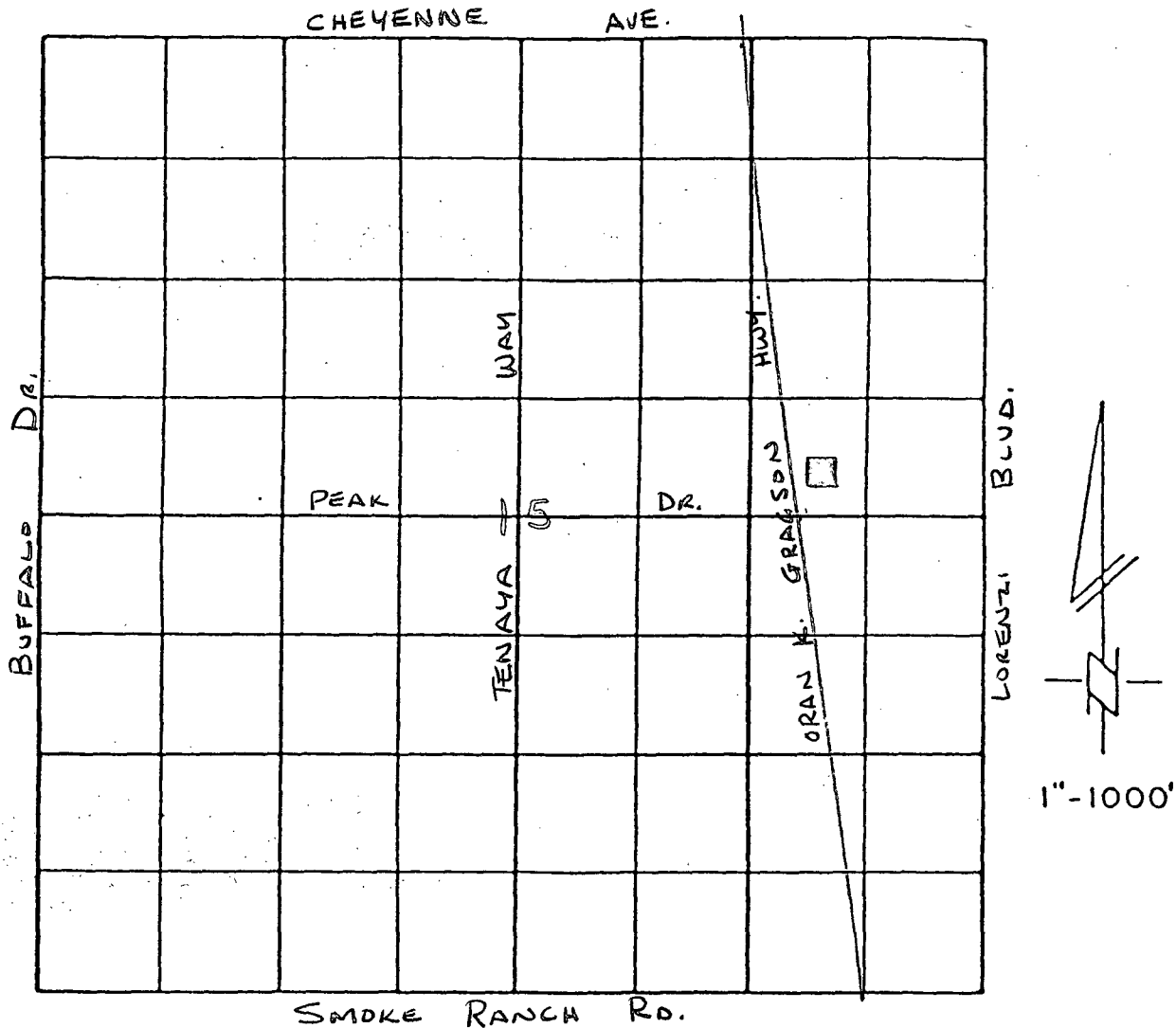

APPROVED _____ 198__
 EFFECTIVE DATE _____ 198__

SECTION 15
 RANGE 60 E.
 TOWNSHIP 20 S.

ORD. 3350

2.606 AC.

A-2-88

MAYOR RON LURIE
COUNCILMEN
BOB NOLEN
W. WAYNE BUNKER
STEVE MILLER
ARNIE ADAMSEN
CITY MANAGER
ASHLEY HALL

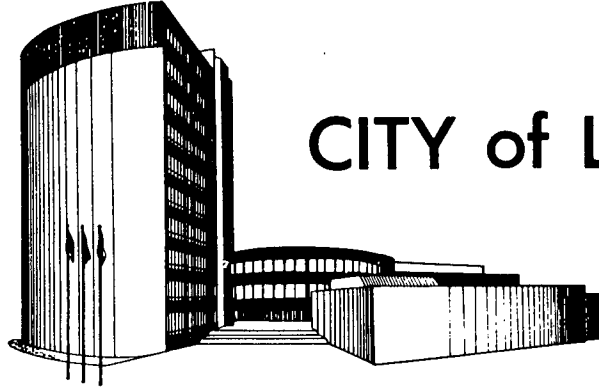

CITY of LAS VEGAS

May 17, 1988

Evalyn J. Effinger
3447 Frontier Avenue
Las Vegas, Nevada 89106

RE: A-2-88(A)

Dear Ms. Effinger:

Please be advised that your parcel of land containing approximately two and one-half (2.5) acres, generally located northwest of Lorenzi Boulevard and Peak Drive, was annexed to the City of Las Vegas effective April 15, 1988.

A copy of Annexation Ordinance #3350 is attached for your reference.

Sincerely,

DEPARTMENT OF COMMUNITY
PLANNING AND DEVELOPMENT
HAROLD P. FOSTER, DIRECTOR

ROBERT S. GENZER
PRINCIPAL PLANNER

HPF:RSG:gm

Attachment:
Annexation Ordinance



MAYOR RON LURIE

COUNCILMEN
BOB NOLEN
W. WAYNE BUNKER
STEVE MILLER
ARNIE ADAMSEN

CITY MANAGER
ASHLEY HALL

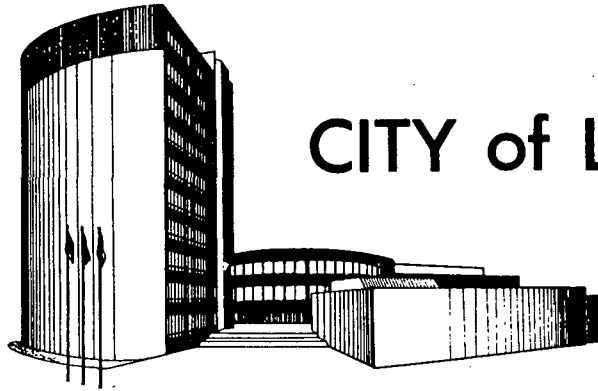

CITY of LAS VEGAS

May 17, 1988

Department of Taxation
Capitol Complex
Carson City, Nevada 89701

RE: Annexation A-2-88(A)

Gentlemen:

In compliance with Nevada Revised Statutes 268.597, a copy of an Annexation Ordinance for A-2-88(A) and recorded accurate map are referred to your office. Please note that the effective date of the Ordinance is April 15, 1988.

The annexation area consists of approximately 2.5 acres, generally located northwest of Lorenzi Boulevard and Peak Drive.

If there are any questions regarding this annexation, please advise.

Sincerely,

DEPARTMENT OF COMMUNITY
PLANNING AND DEVELOPMENT

HAROLD P. FOSTER, DIRECTOR

HPF:gm

Attachments:

1. Annexation Ordinance
2. Accurate Map

cc: City Clerk
Director of Finance
(w/Annexation Ordinance and
Location Map)



INTER-OFFICE MEMORANDUM

May 17, 1988

TO:

BUILDING AND SAFETY
BUSINESS ACTIVITY
FIRE SERVICES: RAY PEEPLES & ANN VILBERT
PUBLIC WORKS: RIGHT-OF-WAY (ED BYRGE)
ELECTRICAL SERVICES (GEORGE FERRIS)
SANITATION DIVISION (TOM MCCAFFREY)
LAND DEVELOPMENT SERVICES (JOEL HARRIS)
STREET DIVISION
TRAFFIC ENGINEERING

FROM:

DEPARTMENT OF COMMUNITY PLANNING
AND DEVELOPMENT
HAROLD P. FOSTER, DIRECTOR

GM
ROBERT S. GENZER
PRINCIPAL PLANNER

SUBJECT:

ANNEXATION A-2-88(A)
EVALYN J. EFFINGER

COPIES TO:

CURRENT PLANNING DIVISION (JOHN HERBERT)
STREETLIGHTING (GENE ROGERS % 2ND FLOOR
- CONSTRUCTION SERVICES)
ENGINEERING PLANNING (JOHN MCNELLIS)

Please be advised that a parcel of land containing approximately 2.5 acres, generally located northwest of Lorenzi Boulevard and Peak Drive, was annexed to the City of Las Vegas effective April 15, 1988.

A location map and copy of Annexation Ordinance #3350 are attached for your reference.

HPF:RSG:gm

Attachment:

1. Location Map
2. Annexation Ordinance

MAYOR RON LURIE

COUNCILMEN
BOB NOLEN
W. WAYNE BUNKER
STEVE MILLER
ARNIE ADAMSEN

CITY MANAGER
ASHLEY HALL

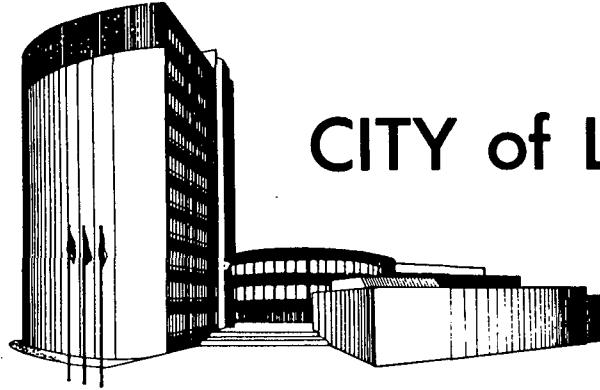

CITY of LAS VEGAS

May 17, 1988

Ms. Barbara Bailey
Clark County Elections Department
400 Las Vegas Boulevard South
Las Vegas, Nevada 89101

RE: Annexation A-2-88(A)

Gentlemen:

Please be advised that a parcel of land containing approximately 2.5 acres, generally located northwest of Lorenzi Boulevard and Peak Drive, was annexed to the City of Las Vegas effective April 15, 1988.

A location map, a copy of the Annexation Ordinance #3350, and a copy of the accurate map are attached for your reference.

Sincerely,

DEPARTMENT OF COMMUNITY
PLANNING AND DEVELOPMENT
HAROLD P. FOSTER, DIRECTOR

ROBERT S. GENZER
PRINCIPAL PLANNER

HPF:RSG:gm

Attachments:

1. Location Map
2. Annexation Ordinance
3. Accurate Map



MAYOR RON LURIE
COUNCILMEN
BOB NOLEN
W. WAYNE BUNKER
STEVE MILLER
ARNIE ADAMSEN
CITY MANAGER
ASHLEY HALL

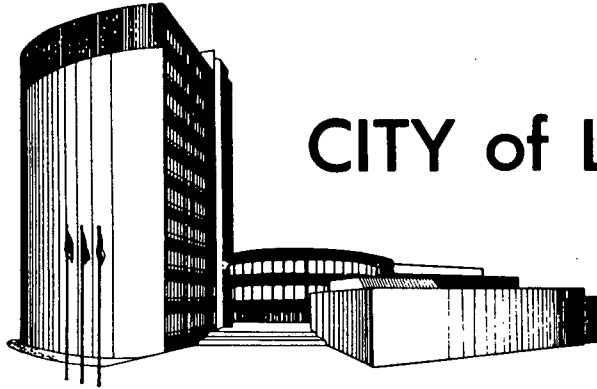

CITY of LAS VEGAS

May 17, 1988

Mrs. Mabel Snyder
Clark County Tax Assessor's Office
Mapping Division
309 South Third Street
Las Vegas, Nevada 89155

RE: Annexation A-2-88(A)

Dear Mrs. Snyder:

Please be advised that a parcel of land containing approximately 2.5 acres, generally located northwest of Lorenzi Boulevard and Peak Drive, was annexed to the City of Las Vegas effective April 15, 1988.

A location map and a copy of Annexation Ordinance #3350 are attached for your reference.

Sincerely,

DEPARTMENT OF COMMUNITY
PLANNING AND DEVELOPMENT
HAROLD P. FOSTER, DIRECTOR

ROBERT S. GENZER
PRINCIPAL PLANNER

HPF:RSG:gm

Attachments:

1. Location Map
2. Annexation Ordinance



MAYOR RON LURIE
COUNCILMEN
BOB NOLEN
W. WAYNE BUNKER
STEVE MILLER
ARNIE ADAMSEN

CITY MANAGER
ASHLEY HALL

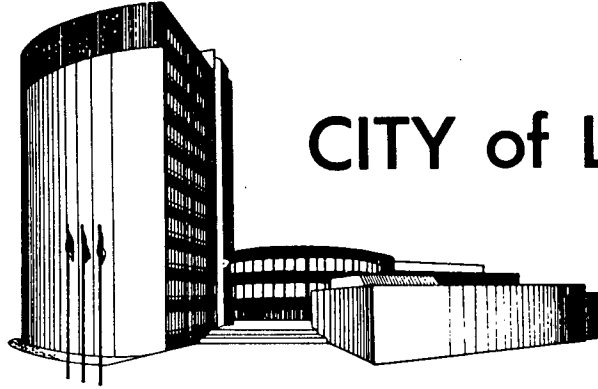

CITY of LAS VEGAS

May 17, 1988

Ms. Susan French Neiry
Clark County Comprehensive Planning
Bridger Building, 7th Floor
225 Bridger Avenue
Las Vegas, Nevada 89155

RE: Annexation A-2-88(A)

Dear Ms. Neiry:

Please be advised that a parcel of land containing approximately 2.5 acres, generally located northwest of Lorenzi Boulevard and Peak Drive, was annexed to the City of Las Vegas effective April 15, 1988.

A location map and a copy of Annexation Ordinance #3350 are attached for your reference.

Sincerely,

DEPARTMENT OF COMMUNITY
PLANNING AND DEVELOPMENT
HAROLD P. FOSTER, DIRECTOR

ROBERT S. GENZER
PRINCIPAL PLANNER

HPF:RSG:gm

Attachments:

1. Location Map
2. Annexation Ordinance

cc: Clark County Public Works
Right-of-Way Division

Clark County Business License Bureau



MAYOR RON LURIE

COUNCILMEN
BOB NOLEN
W. WAYNE BUNKER
STEVE MILLER
ARNIE ADAMSEN

CITY MANAGER
ASHLEY HALL

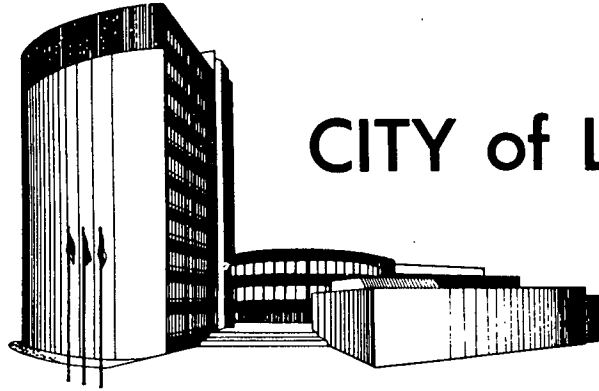

CITY of LAS VEGAS

May 17, 1988

Ms. Shirley Myron
Manager of Office Services
Nevada Power Company
P. O. Box 230
Las Vegas, Nevada 89151

RE: Annexation A-2-88(A)

Dear Ms. Myron:

Please be advised that a parcel of land containing approximately 2.5 acres, generally located northwest of Lorenzi Boulevard and Peak Drive, was annexed to the City of Las Vegas effective April 15, 1988.

A location map and a copy of Annexation Ordinance #3350 are attached for your reference.

Sincerely,

DEPARTMENT OF COMMUNITY
PLANNING AND DEVELOPMENT
HAROLD P. FOSTER, DIRECTOR

ROBERT S. GENZER
PRINCIPAL PLANNER

HPF:RSG:gm

Attachments:

1. Location Map
2. Annexation Ordinance



MAYOR RON LURIE

COUNCILMEN
BOB NOLEN
W. WAYNE BUNKER
STEVE MILLER
ARNIE ADAMSEN

CITY MANAGER
ASHLEY HALL

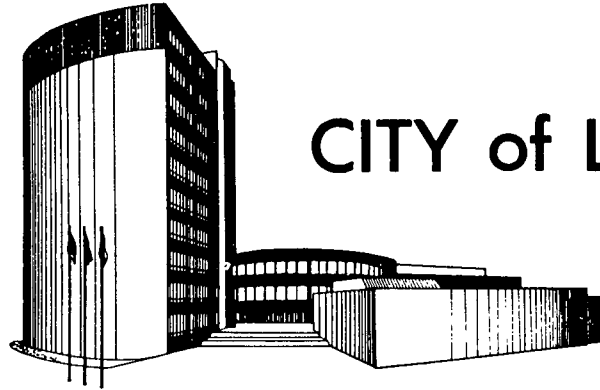

CITY of LAS VEGAS

May 17, 1988

Southwest Gas Corporation
Engr. Mgr., Thunderbird Division
P. O. Box 15015
Las Vegas, Nevada 89114

RE: Annexation A-2-88(A)

Gentlemen:

Please be advised that a parcel of land containing approximately 2.5 acres, generally located northwest of Lorenzi Boulevard and Peak Drive, was annexed to the City of Las Vegas effective April 15, 1988.

A location map and a copy of Annexation Ordinance #3350 are attached for your reference.

Sincerely,

DEPARTMENT OF COMMUNITY
PLANNING AND DEVELOPMENT
HAROLD P. FOSTER, DIRECTOR

ROBERT S. GENZER
PRINCIPAL PLANNER

HPF:RSG:gm

Attachments:

1. Location Map (three copies)
2. Annexation Ordinance



MAYOR RON LURIE

COUNCILMEN
BOB NOLEN
W. WAYNE BUNKER
STEVE MILLER
ARNIE ADAMSEN

CITY MANAGER
ASHLEY HALL

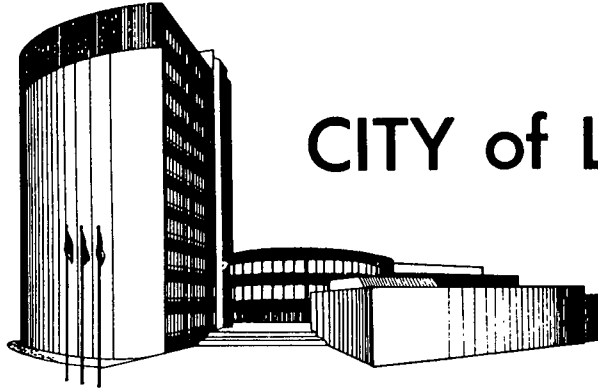

CITY of LAS VEGAS

May 17, 1988

Paul Michalka, OPS Manager
Central Telephone Company
330 South Valley View Boulevard
Las Vegas, Nevada 89152

RE: Annexation A-2-88(A)

Dear Mr. Michalka:

Please be advised that a parcel of land containing approximately 2.5 acres, generally located northwest of Lorenzi Boulevard and Peak Drive, was annexed to the City of Las Vegas effective April 15, 1988.

A location map and a copy of Annexation Ordinance #3350 are attached for your reference.

Sincerely,

DEPARTMENT OF COMMUNITY
PLANNING AND DEVELOPMENT
HAROLD P. FOSTER, DIRECTOR

ROBERT S. GENZER
PRINCIPAL PLANNER

HPF:RSG:gm

Attachments:

1. Location Map
2. Annexation Ordinance

cc: Mr. Dennis Doulder
Centel



INTER-OFFICE MEMORANDUM

Date

April 12, 1988

TO:

RIGHT-OF-WAY ACQUISITION,
DEPARTMENT OF PUBLIC WORKS

FROM:

RS
ROBERT S. GENZER, PRINCIPAL PLANNER
DEPARTMENT OF COMMUNITY PLANNING
AND DEVELOPMENT

SUBJECT:

RECORDATION: A-2-88(A)

COPIES TO:

Subject Annexation MUST BE RECORDED BEFORE 4-15-88.

Please return a Recorded Copy for our files.

Thank you.

RSG:erh

Attachment

1
2
3
4
5
6
7
8
9
10
11
12
13
14
15
16
17
18
19
20
21
22
23
24
25
26
27
28
29
30
31
32

AN ORDINANCE EXTENDING THE CORPORATE LIMITS OF THE CITY OF LAS VEGAS, NEVADA, TO INCLUDE WITHIN, ANNEX TO AND MAKE A PART OF SAID CITY CERTAIN SPECIFICALLY DESCRIBED TERRITORY ADJOINING AND CONTIGUOUS TO THE CORPORATE LIMITS OF SAID CITY; DECLARING SAID TERRITORY AND THE INHABITANTS THEREOF TO BE ANNEXED TO SAID CITY AND SUBJECT TO ALL DEBTS, LAWS, ORDINANCES AND REGULATIONS IN FORCE IN SAID CITY; ORDERING A MAP OR PLAT OF SAID DESCRIBED TERRITORY TO BE RECORDED IN THE OFFICE OF THE COUNTY RECORDER OF THE COUNTY OF CLARK, STATE OF NEVADA; DESIGNATING THE ZONING CLASSIFICATION(S) APPLICABLE TO SAID TERRITORY; PROVIDING FOR OTHER MATTERS PROPERLY RELATING THERETO; AND REPEALING ALL ORDINANCES AND PARTS OF ORDINANCES IN CONFLICT HEREWITH. (Annexation A-2-88(A))

Sponsored by:
Mayor Ron Lurie

Summary: Annexes property described generally as located west of Lorenzi Boulevard and north of Peak Drive

THE CITY COUNCIL OF THE CITY OF LAS VEGAS DOES HEREBY ORDAIN AS FOLLOWS:

SECTION 1: The corporate limits of the City of Las Vegas, Nevada, are hereby extended to include, annex to, and make a part of the City of Las Vegas, Nevada, the following described real property, to-wit:

The Northwest Quarter (NW¹/₄) of the Southeast Quarter (SE¹/₄) of the Southeast Quarter (SE¹/₄) of the Northeast Quarter (NE¹/₄) of Section 15, Township 20 South, Range 60 East, M.D.M., in the County of Clark, State of Nevada

SECTION 2: That said City Council has determined and does hereby determine, that said described territory meets the requirements provided by law for annexation to the City of Las Vegas for the following reasons:

- A. The area to be annexed was contiguous to the City's boundaries at the time the annexation proceedings were instituted;
- B. More than one-eighth (1/8) of the aggregate external boundaries of the area are contiguous to the City of Las Vegas;
- C. The territory proposed to be annexed is not included within the boundaries of another incor-

1 porated city or within the boundaries of any unin-
2 corporated town as those boundaries existed as of
3 July 1, 1983;

4 D. The City of Las Vegas is eligible to annex the area
5 described in this report since the landowners have
6 signed a petition constituting one hundred percent
7 (100%) of the owners of record of individual lots
8 or parcels of land within the annexation area.

9 SECTION 3: The City of Las Vegas will provide police
10 protection through the Las Vegas Metropolitan Police Department,
11 fire protection, street maintenance, and library services imme-
12 diately upon annexation. Garbage collection by the company
13 franchised by the City will also be provided immediately. The
14 City sanitary sewer system will serve the proposed annexation
15 area. Any connection to or extension of this sewer line to serve
16 the annexation area shall be at the expense of the landowners.
17 Other services, such as participation in the City's recreational
18 programs, special education classes and programs, public works
19 planning, building inspections, and other City Hall services will
20 also be available immediately. Utilities such as gas, electri-
21 city, telephone, and water are provided by private utility com-
22 panies and other services to the area will not be affected by
23 annexation. Street paving, curbs and gutters, sidewalks and
24 street lights which are not in place at the time of annexation
25 will be installed in the presently developed areas upon the
26 request of the property owners and at their expense by means of
27 special assessment districts. Such improvements will be extended
28 into the undeveloped areas as development takes place and the
29 need therefor arises, and will be located according to the needs
30 of the area at that time. Such installations will also be made
31 at the expense of the property owners, either by means of special
32 assessment districts or as prerequisites to the approval of sub-

1 division plats or the issuance of building permits, re-zonings,
2 zone variances or special use permits.

3 SECTION 4: The annexation of said described territory
4 shall become effective on the 15th day of April, 1988, and on
5 such date the City of Las Vegas will have the funds appropriated
6 in sufficient amount to finance the extension into said described
7 territory of police protection, fire protection, street main-
8 tenance, street sweeping, and street lighting maintenance.

9 SECTION 5: Said described territory, together with the
10 inhabitants and property thereof, shall, from and after the 15th
11 day of April, 1988, be subject to all debts, laws, ordinances and
12 regulations in force in the City of Las Vegas and shall be
13 entitled to the same privileges and benefits as other parts of
14 said City, and shall be subject to municipal taxes levied by the
15 City of Las Vegas, Nevada.

16 SECTION 6: The City Engineer of the City of Las Vegas,
17 Nevada, is hereby instructed to cause to be prepared an accurate
18 map or plat of said described territory and to record the same,
19 together with a certified copy of this ordinance in the office of
20 the County Recorder of Clark County, Nevada, which said recording
21 shall be done prior to the 15th day of April, 1988.

22 SECTION 7: The said described territory, which hereto-
23 fore has been zoned R-E (County of Clark classification), is
24 hereby classified as N-U (City of Las Vegas classification),
25 which is deemed to be the City equivalent of said County classi-
26 fication.

27 SECTION 8: If any section, subsection, subdivision,
28 paragraph, sentence, clause or phrase in this ordinance or any
29 part thereof, is for any reason held to be unconstitutional, or
30 invalid or ineffective by any court of competent jurisdiction,
31 such decision shall not affect the validity or effectiveness of
32 the remaining portions of this ordinance or any part thereof.

1
2
3
4
5
6
7
8
9
10
11
12
13
14
15
16
17
18
19
20
21
22
23
24
25
26
27
28
29
30
31
32

The City Council of the City of Las Vegas hereby declares that it would have passed each section, subsection, subdivision, paragraph, sentence, clause or phrase thereof irrespective of the fact that any one or more sections, subsections, subdivisions, paragraphs, sentences, clauses or phrases be declared unconstitutional, invalid or ineffective.

PASSED, ADOPTED and APPROVED this 6th day of April, 1988.



APPROVED:

By *Ron Lurie*
RON LURIE, Mayor

ATTEST:

Kathleen M. Tighe
KATHLEEN M. TIGHE, City Clerk

Approved
[Signature]
4-8-88

1 The above and foregoing ordinance was first proposed and read by
2 title to the City Council on the 2nd day of March, 1988,
3 and referred to the following committee composed of _____
4 Mayor Lurie and Councilman Nolen for recommen-
5 dation; thereafter the said committee reported favorably on said
6 ordinance on the 6th day of April, 1988, which was a
7 regular meeting of said Council; that at said
8 regular meeting, the proposed ordinance was read by
9 title to the City Council as first introduced and adopted by the
10 following vote:

11 VOTING "AYE": Councilmen Adamsen, Bunker, Miller, Nolen and Mayor Lurie

12 VOTING "NAY": NONE

13 ABSENT: NONE



APPROVED:

19
20
21
22

By *Ron Lurie*
RON LURIE, Mayor

23
24
25
26
27

ATTEST:

28
29
30
31
32

Kathleen M. Tighe
KATHLEEN M. TIGHE, City Clerk

When recorded mail to:
ROBERT S. GENZER, Principal Planner
Department of Community Planning
and Development
400 East Stewart Avenue
Las Vegas, Nevada 89101

THE NORTHWEST QUARTER OF THE SOUTHEAST QUARTER OF
THE SOUTHEAST QUARTER OF THE NORTHEAST QUARTER OF
SECTION 15, TOWNSHIP 20 SOUTH, RANGE 60 EAST, M. D. M.
CLARK COUNTY, NEVADA

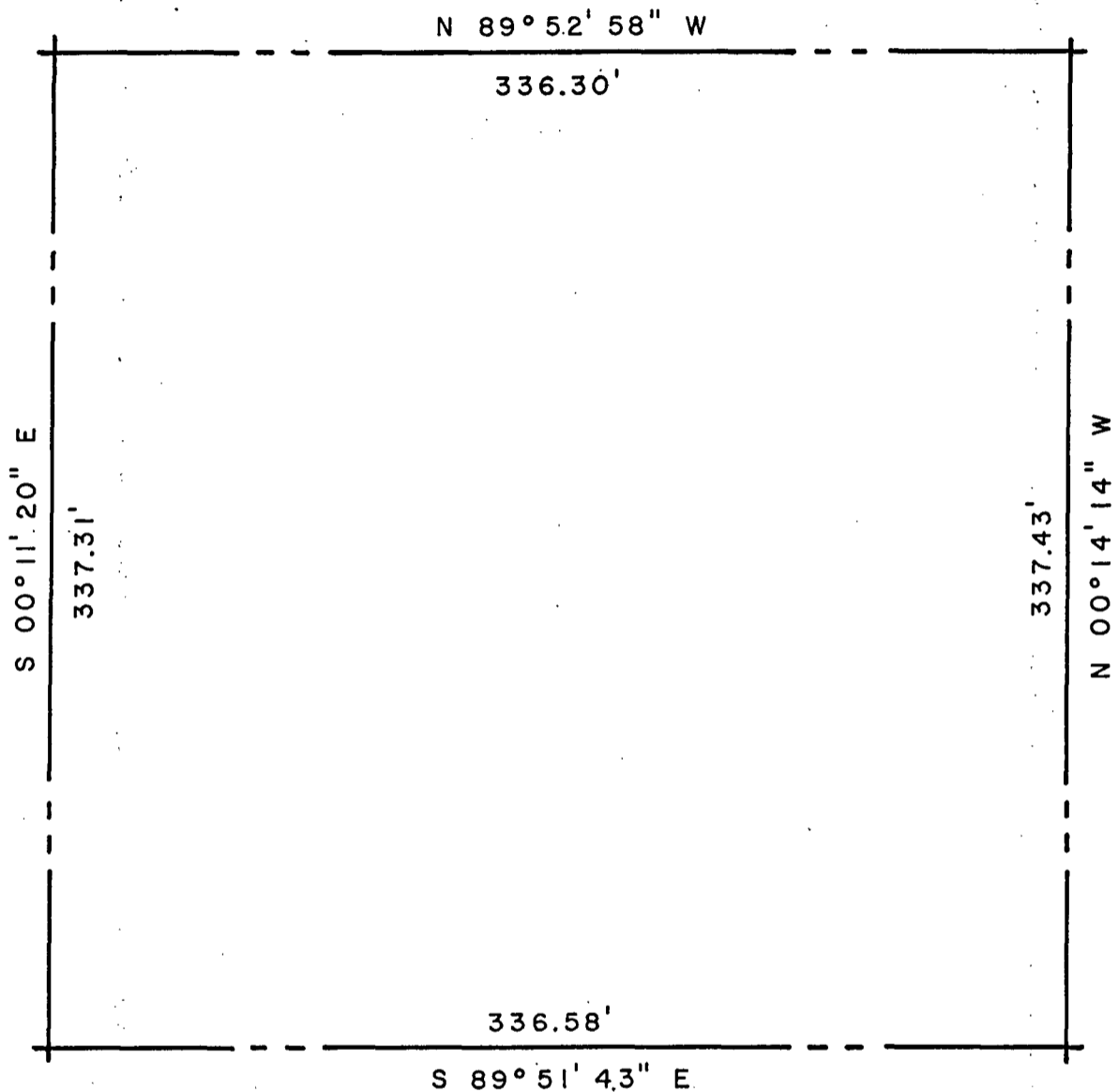

THIS MAP WAS PREPARED FROM EXISTING
INFORMATION AS SHOWN ON THE PARCEL
MAP IN FILE 50 OF PARCEL MAPS, PAGE
41 OF CLARK COUNTY, NEVADA RECORDS.
NO RESPONSIBILITY IS ASSUMED FOR THE
CORRECTNESS OF THE INFORMATION SHOWN
HEREON.

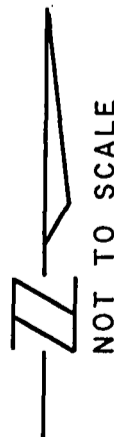

ANNEXED TO THE CITY OF LAS VEGAS
UNDER ORDINANCE No. 3350

FOR USE OF THE
COUNTY RECORDER

**CITY OF LAS VEGAS
DEPARTMENT OF PUBLIC WORKS
RIGHT OF WAY
LEGAL DESCRIPTION**

Tax Parcel No. _____

Document No. _____

Vesting A-2-88 (A)

Section NW 1/4, SE 1/4, SE 1/4, NE 1/4, Sec. 15, T.20S., R.60E., M.D.M.

Street/Subdivision _____

Requested eb Written bb Checked jdW Proofread bb, mwb
2-9-88 2-9-88

The Northwest Quarter (NW 1/4) of the Southeast Quarter (SE 1/4) of the Southeast Quarter (SE 1/4) of the Northeast Quarter (NE 1/4) of Section 15, Township 20 South, Range 60 East, M.D.M., in the County of Clark, State of Nevada.

NOTICE TO PUBLISH

Las Vegas, Nevada

Date: April 6, 1988

TO: LAS VEGAS REVIEW-JOURNAL

FROM: CITY CLERK

SUBJECT: PUBLICATION OF BILL NO. 88-13 ORDINANCE NO. 3350 ANNEXATION
NO.A-2-88(A)

Please publish the attached Legal Notice

ON THE FOLLOWING DATES: Saturday, April 9th, 1988 (one time only)

and send me three copies of the Affidavit of Publication at your earliest convenience. (No later than seven (7) days following final publication.)

CITY CLERK

cc: Finance Department - Accounts Payable
City Attorney - (on Ordinances only)
Community Planning & Development ✓

Bill No. 88-13

Ordinance No. 3350

AN ORDINANCE EXTENDING THE CORPORATE LIMITS OF THE CITY OF LAS VEGAS, NEVADA, TO INCLUDE WITHIN, ANNEX TO AND MAKE A PART OF SAID CITY CERTAIN SPECIFICALLY DESCRIBED TERRITORY ADJOINING AND CONTIGUOUS TO THE CORPORATE LIMITS OF SAID CITY; DECLARING SAID TERRITORY AND THE INHABITANTS THEREOF TO BE ANNEXED TO SAID CITY AND SUBJECT TO ALL DEBTS, LAWS, ORDINANCES AND REGULATIONS IN FORCE IN SAID CITY; ORDERING A MAP OR PLAT OF SAID DESCRIBED TERRITORY TO BE RECORDED IN THE OFFICE OF THE COUNTY RECORDER OF THE COUNTY OF CLARK, STATE OF NEVADA; DESIGNATING THE ZONING CLASSIFICATION(S) APPLICABLE TO SAID TERRITORY; PROVIDING FOR OTHER MATTERS PROPERLY RELATING THERETO; AND REPEALING ALL ORDINANCES AND PARTS OF ORDINANCES IN CONFLICT HEREWITH. (Annexation A-2-88(A))

Sponsored by:
Mayor Ron Lurie

Summary: Annexes property described generally as located west of Lorenzi Boulevard and north of Peak Drive

1
2
3
4
5
6
7
8
9
10
11

The above and foregoing ordinance was first proposed and read by title to the City Council on the 2nd day of March, 1988, and referred to the following committee composed of Mayor Lurie and Councilman Nolen for recommendation; thereafter the said committee reported favorably on said ordinance on the 6th day of April, 1988, which was a regular meeting of said Council; that at said regular meeting, the proposed ordinance was read by title to the City Council as first introduced and adopted by the following vote:

VOTING "AYE" Councilmen: Adamsen, Bunker, Miller, Nolen and Mayor Lurie
VOTING "NAY" Councilmen: NONE
ABSENT: NONE

COPIES OF THE COMPLETE ORDINANCE ARE AVAILABLE FOR PUBLIC INFORMATION IN THE OFFICE OF THE CITY CLERK, 10TH FLOOR, CITY HALL, 400 EAST STEWART AVENUE, LAS VEGAS, NEVADA.

NOTICE TO PUBLISH

Las Vegas, Nevada

Date: March 14, 1988

TO: LAS VEGAS REVIEW-JOURNAL

FROM: CITY CLERK

SUBJECT: PUBLICATION OF BILL NO. 88-13 ANNEXATION NO.A-2-88(A)

Please publish the attached Legal Notice

ON THE FOLLOWING DATES: Thursday, March 17, 1988 (one time only)

and send me three copies of the Affidavit of Publication at your earliest convenience. (No later than seven (7) days following final publication.)

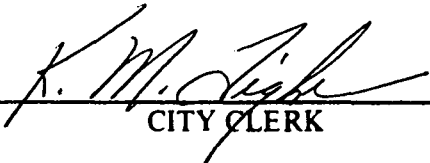
CITY CLERK

cc: Finance Department - Accounts Payable
City Attorney - (on Ordinances only)
Community Planning & Development

Bill No. 88-13

1
2
3
4
5
6
7
8
9
10
11

AN ORDINANCE EXTENDING THE CORPORATE LIMITS OF THE CITY OF LAS VEGAS, NEVADA, TO INCLUDE WITHIN, ANNEX TO AND MAKE A PART OF SAID CITY CERTAIN SPECIFICALLY DESCRIBED TERRITORY ADJOINING AND CONTIGUOUS TO THE CORPORATE LIMITS OF SAID CITY; DECLARING SAID TERRITORY AND THE INHABITANTS THEREOF TO BE ANNEXED TO SAID CITY AND SUBJECT TO ALL DEBTS, LAWS, ORDINANCES AND REGULATIONS IN FORCE IN SAID CITY; ORDERING A MAP OR PLAT OF SAID DESCRIBED TERRITORY TO BE RECORDED IN THE OFFICE OF THE COUNTY RECORDER OF THE COUNTY OF CLARK, STATE OF NEVADA; DESIGNATING THE ZONING CLASSIFICATION(S) APPLICABLE TO SAID TERRITORY; PROVIDING FOR OTHER MATTERS PROPERLY RELATING THERETO; AND REPEALING ALL ORDINANCES AND PARTS OF ORDINANCES IN CONFLICT HEREWITH.
(Annexation A-2-88(A))

Sponsored by:
Mayor Ron Lurie

Summary: Annexes property described generally as located west of Lorenzi Boulevard and north of Peak Drive

At a City Council meeting

March 2, 1988

BILL NO. 88-13 WAS READ BY TITLE AND REFERRED TO RECOMMENDING COMMITTEE:

Mayor Lurie
and Councilman Nolen

COPIES OF THE COMPLETE ORDINANCE ARE AVAILABLE FOR PUBLIC INFORMATION IN THE OFFICE OF THE CITY CLERK, 10TH FLOOR, CITY HALL, 400 EAST STEWART AVENUE, LAS VEGAS, NEVADA.

MAYOR RON LURIE

COUNCILMEN
BOB NOLEN
W. WAYNE BUNKER
STEVE MILLER
ARNIE ADAMSEN

CITY MANAGER
ASHLEY HALL

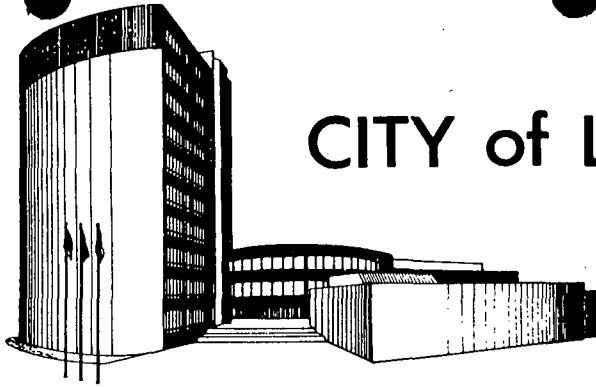

CITY of LAS VEGAS

February 26, 1988

Ms. Evalyn J. Effinger
3447 Frontier Avenue
Las Vegas, Nevada 89106

RE: A-2-88(A) - PETITION OF ANNEXATION

Dear Ms. Effinger:

Your Petition for Annexation of property located northwest of Lorenzi Boulevard and Peak Drive, containing approximately 2.5 acres, was considered by the Planning Commission on February 23, 1988.

The Planning Commission unanimously voted to recommend APPROVAL.

This request will be forwarded to the City Council for consideration of adopting an ordinance to annex this land.

Sincerely,

DEPARTMENT OF COMMUNITY PLANNING
AND DEVELOPMENT

A handwritten signature in black ink, appearing to read "Harold P. Foster". The signature is fluid and cursive.

HAROLD P. FOSTER, DIRECTOR

HPF:erh



PLANNING COMMISSION

COUNCIL CHAMBERS • 400 EAST STEWART AVENUE

PHONE 386-6301

COMMISSION ACTION

ITEM

*2. ANNEXATION - A-2-88(A)

Applicant: EVALYN J. EFFINGER
Application: Petition of Annexation
Location: Northwest of Lorenzi
Boulevard and Peak
Drive
Size: 2.5 Acres

STAFF RECOMMENDATION: APPROVAL.

Babero -
APPROVED
Unanimous
(Coleman and Kennedy excused)

CHAIRMAN JOHNSTON stated this
is a consent item.

INTER-OFFICE MEMORANDUM

Date

February 19, 1988

TO:

Harold Foster, Director
Community Planning

FROM:

George F. Ogilvie
George F. Ogilvie,
City Attorney

SUBJECT:

Annexation A-2-88(A)

COPIES TO:

Val Steed

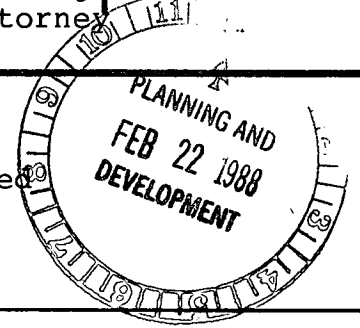

This will acknowledge receipt of your ordinance request memorandum received in this office on February 17, 1988, regarding the above subject. This request has been assigned to Val Steed and he should have it completed no later than February 23, 1988, to be placed on the March 2, 1988 City Council agenda. If the urgency of this matter requires an earlier answer, or if you have any questions, please feel free to contact him.

GFO/ph

CITY OF LAS VEGAS

Date

INTER-OFFICE MEMORANDUM

February 5, 1988

TO:

PUBLIC WORKS (ED BYRGE)
 FIRE SERVICES, ALARM OFFICE (ANN VILBERT)
 METROPOLITAN POLICE DEPT. (TRAFFIC)
 ELECTRICAL SERVICES (GEORGE FERRIS)

FROM: DEPARTMENT OF COMMUNITY PLANNING AND DEVELOPMENT
 HAROLD P. FOSTER, DIRECTOR
 GV ROBERT S. GENZER
 PRINCIPAL PLANNER

SUBJECT:

ANNEXATION - A-2-88(A)

SUBMITTED BY - EVALYN J. EFFINGER

COPIES TO:

KIRK CRANE

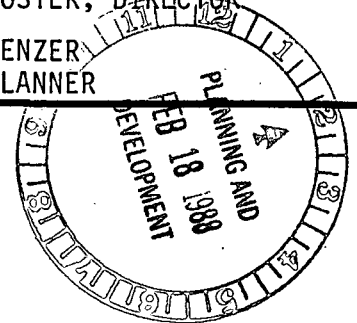

Please provide your comments regarding the subject Annexation Petition for property generally located:

Northwest of Lorenzi Boulevard and Peak Drive

containing approximately 2.5 acres of land.

In particular, we need to know if sewer and drainage, as well as other facilities will be adequate to handle this proposed annexation. This petition for annexation will be heard at the Planning Commission meeting, so your comments would be appreciated as soon as possible.

Attached is a map for your reference.

No Comment

HPF:RSG: erh

Attachments:
 Location Map

Public Works:
 Location Map
 Deed
 Petition

*Ann Vilbert
 Planning Aide
 2-16-88*

INTER-OFFICE MEMORANDUM

Date

February 16, 1988

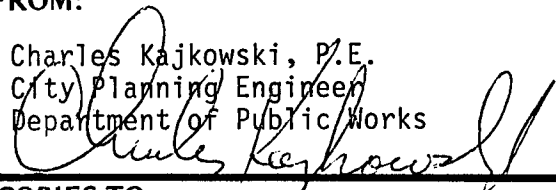
TO: Harold P. Foster, Director Department of Community Planning and Development	FROM: Charles Kajkowski, P.E. City Planning Engineer Department of Public Works 
SUBJECT: COMMENTS RE: A-2-88(A) Evalyn J. Effinger	COPIES TO: John McNellis, Engineering Planning C. E. Gilpin, Land Development Nancy Miller, Right-of-Way Doug Peterson, Suverying (FM, PM & A's only)

1. No objection to the annexation. Off-site improvements, right-of-way dedications and/or drainage studies may be required when development occurs.

NOTE: At present there is no public sewer adjacent to this site.

RECEIVED
 FEB 17 1988
 PLANNING AND
 DEVELOPMENT

MAYOR RON LURIE
COUNCILMEN
BOB NOLEN
W. WAYNE BUNKER
STEVE MILLER
ARNIE ADAMSEN
CITY MANAGER
ASHLEY HALL

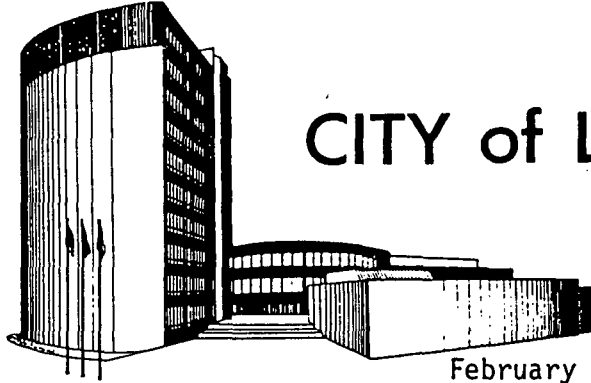

CITY of LAS VEGAS

February 12, 1988

Ms. Evalyn J. Effinger
3447 Frontier Avenue
Las Vegas, Nevada 89106

RE: A-2-88(A) - PETITION OF ANNEXATION

Dear Applicant:

Please be advised your request, as referred to above, will be considered by the City Planning Commission at its regular meeting on February 23, 1988. This meeting will be held at 7:30 P.M. in the Council Chambers of City Hall, 400 East Stewart Avenue, Las Vegas, Nevada.

A copy of Staff's recommendations and any conditions related to your application may be obtained on the day of the meeting from the Department of Community Planning and Development, Second Floor, City Hall, or you may obtain this information by telephone on the day of the meeting by calling 386-6301.

The Planning Commission requires that you or your representative be present at this meeting.

Sincerely,

DEPARTMENT OF COMMUNITY PLANNING
AND DEVELOPMENT

HAROLD P. FOSTER, DIRECTOR

HPF:erh

Enclosure



INTER-OFFICE MEMORANDUM

Date

February 9, 1988

TO:

Community Planning
and Development

FROM:

Public Works
Survey Division

SUBJECT:

Eyalyn J. Effinger
A-2-88 (A)

COPIES TO:

City Engineer
Survey

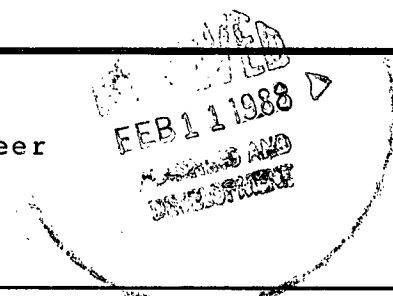

This Division will have no objections to the granting of the subject petition.

A handwritten signature in cursive script, reading "C. D. Peterson", is written above the typed name.

C. D. Peterson, R. L. S.

CDP:rk

LAS VEGAS METROPOLITAN POLICE DEPARTMENT

MEMORANDUM

Date: 02-11-88

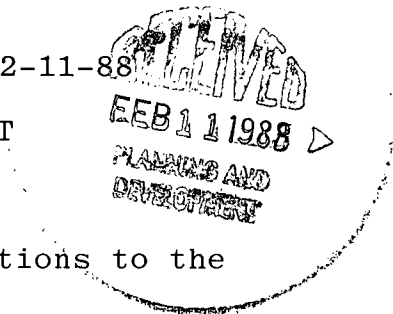

To : ROBERT GENZER - COMMUNITY PLANNING & DEVELOPMENT
Subject : ANNEXATION - A-2-88(A)

Please be advised, this Department has no objections to the above.



RANDY OAKS, LIEUTENANT
SPECIAL OPERATIONS BUREAU
TRAFFIC SECTION

RO:cs



Department of
Comprehensive Planning

Zoning Division

PUBLIC SERVICES BUILDING
401 SOUTH FOURTH STREET
LAS VEGAS, NEVADA 89101
(702) 455-4314

February 11, 1988

Mr. Robert Genzer
Community Planning & Development
City of Las Vegas
400 E. Stewart Avenue
Las Vegas, NV 89101

RE: A-2-88(A)

Dear Mr. Genzer:

This is to verify that the above-referenced annexation area is presently zoned R-E (Rural Estates Residential) District. At this time there are no pending applications for rezoning.

Sincerely,

A handwritten signature in cursive script that reads 'Joyce Avery'.

JOYCE AVERY
Sr. Zoning Specialist

JA/km

CITY OF LAS VEGAS
ORDINANCE REQUEST MEMORANDUM

DATE _____	
TO: CITY MANAGER	FROM: HAROLD P. FOSTER, DIRECTOR DEPARTMENT OF COMMUNITY PLANNING AND DEVELOPMENT
SUBJECT OF ORDINANCE: _____ ANNEXATION - A-2-88(A)	APPROVED TO FORWARD: _____ CITY MANAGER DATE: _____
SPONSOR: _____	DATE TO CITY ATTORNEY: _____
DATE: _____	DATE TO SUBMITTING DEPT: _____

To comply with N.R.S. step requirements for annexation process.

HPF:HAN:jcd

INTER-OFFICE MEMORANDUM

February 11, 1988

TO:

GEORGE OGILVIE
CITY ATTORNEY

FROM:

HAROLD P. FOSTER, DIRECTOR
DEPARTMENT OF COMMUNITY
PLANNING AND DEVELOPMENT

SUBJECT:

ANNEXATION A-2-88(A)
EVALYN J. EFFINGER

COPIES TO:

Please prepare an ordinance with an effective date of April 15, 1988, for the subject annexation. This annexation is under the alternate annexation provision provided for by NRS 268.597.

The annexation area is generally located west of Lorenzi Boulevard and north of Peak Drive, containing approximately 2.5 acres of land. The County zoning is R-E. The City's zoning equivalent would be N-U.

Please send us a copy of the ordinance when it is completed. It is requested that the first reading of this ordinance be scheduled for March 2, 1988 with a final reading on April 6, 1988 City Council meetings.

HPF:RSG:gm

Attachment

INTER-OFFICE MEMORANDUM

February 5, 1988

TO:
 PUBLIC WORKS (ED BYRGE)
 FIRE SERVICES, ALARM OFFICE (ANN VILBERT)
 METROPOLITAN POLICE DEPT. (TRAFFIC)
 ELECTRICAL SERVICES (GEORGE FERRIS)

FROM: DEPARTMENT OF COMMUNITY PLANNING
 AND DEVELOPMENT
 HAROLD P. FOSTER, DIRECTOR
 GV ROBERT S. GENZER
 PRINCIPAL PLANNER

SUBJECT:
 ANNEXATION - A-2-88(A)
 SUBMITTED BY - EVALYN J. EFFINGER

COPIES TO:
 KIRK CRANE

Please provide your comments regarding the subject Annexation Petition for property generally located:

Northwest of Lorenzi Boulevard and Peak Drive

containing approximately 2.5 acres of land.

In particular, we need to know if sewer and drainage, as well as other facilities will be adequate to handle this proposed annexation. This petition for annexation will be heard at the Planning Commission meeting, so your comments would be appreciated as soon as possible.

Attached is a map for your reference.

HPF:RSG: erh

Attachments:
 Location Map

Public Works:
 Location Map
 Deed
 Petition

INTER-OFFICE MEMORANDUM

Date

February 5, 1988

TO: ED BYRGE, DEPT. OF PUBLIC WORKS	FROM: DEPARTMENT OF COMMUNITY PLANNING AND DEVELOPMENT HAROLD P. FOSTER, DIRECTOR <i>GV</i> ROBERT S. GENZER PRINCIPAL PLANNER
SUBJECT: ANNEXATION A-2-88(A) EVALYN J. EFFINGER REQUEST FOR LEGAL DESCRIPTION AND ACCURATE MAP	COPIES TO: C. E. GILPIN

The above-referenced Annexation has been initiated at the request of the City of Las Vegas; therefore, please provide a proper legal description and accurate map.

We would appreciate receiving this data as soon as possible in order to schedule this Annexation for first Ordinance reading.

HPF:RSG:gm

Attachment: Location Map

MAYOR RON LURIE
COUNCILMEN
BOB NOLEN
W. WAYNE BUNKER
STEVE MILLER
ARNIE ADAMSEN
CITY MANAGER
ASHLEY HALL



CITY of LAS VEGAS

February 5, 1988

Susan French Neiry
Clark County Comprehensive Planning
Bridger Building, 7th Floor
225 Bridger Avenue
Las Vegas, Nevada 89155

RE: ANNEXATION A-2-88(A)

Dear Ms. Neiry:

Attached is a location map for a new annexation request, A-2-88(A) submitted by Evalyn P. Effinger.

We are forwarding this for your information only, as per your request.

Sincerely,

DEPARTMENT OF COMMUNITY PLANNING
AND DEVELOPMENT
HAROLD P. FOSTER, DIRECTOR

ROBERT S. GENZER
PRINCIPAL PLANNER

HPF:RSG:gm

Attachment: Location Map



MAYOR RON LURIE
COUNCILMEN
BOB NOLEN
W. WAYNE BUNKER
STEVE MILLER
ARNIE ADAMSEN
CITY MANAGER
ASHLEY HALL

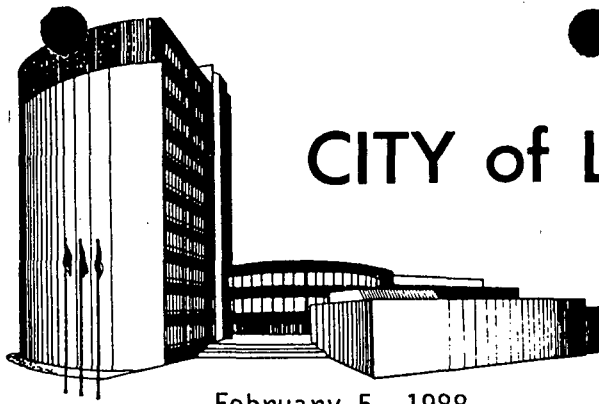

CITY of LAS VEGAS

February 5, 1988

ANNEXATION TRANSMITTAL

Mr. Greg Borgel, Zoning Coordinator
Clark County Department of
Building and Zoning
401 South Fourth Street
Las Vegas, Nevada 89101

RE: ANNEXATION A-2-88(A)

Dear Mr. Borgel:

An annexation request has been submitted to the City of Las Vegas on property generally located

Northwest of Lorenzi Boulevard and Peak Drive

containing approximately 2.5 acres of land.

Please advise us of the present zoning for this property, as well as any resolutions of intent that have been approved, giving the zoning case number and date of expiration.

Attached is a copy of the location map for your reference.

We would appreciate receiving this information at your earliest convenience.

Sincerely,

DEPARTMENT OF COMMUNITY PLANNING
AND DEVELOPMENT
HAROLD P. FOSTER, DIRECTOR

ROBERT S. GENZER
PRINCIPAL PLANNER

HPF:RSG:gm

Attachment: Location Map



PETITION FOR ANNEXATION

TO THE HONORABLE RON LURIE
MAYOR OF THE CITY OF LAS VEGAS, NEVADA

and

BOARD OF COUNCILMEN OF THE CITY OF LAS VEGAS, NEVADA

Gentlemen:

The undersigned, being owners of real property situate within the boundaries of the territory hereinafter described, do hereby petition your honorable Board to annex and include within the corporate limits of the City of Las Vegas, Nevada, pursuant to the provisions of the Nevada Revised Statutes 268.570-268.608 inclusive, the territory being more particularly described as follows: to-wit:

Situate in the County of Clark, State of Nevada, described as follows: That portion of the East Half (E½) of Section 15, Township 20 South, Range 60 East, M.D.B.&M., described as follows:

The southern most out parcel of Parcel 2 (see attached exhibit) of that certain map on file in File 50 of Parcel Maps, Page 41, recorded August 12, 1986 in Book 860812, as Document No. 00463 of Clark County, Nevada records.

Mount Diablo Meridian, Nevada

T. 20 S., R. 60 E.
sec. 15, NW¼SE¼SE¼NE¼

NO. OF ACRES TO BE ANNEXED: 2.5

GENERAL LOCATION OF ANNEXATION AREA: Northwest corner of
Lorenzi and Peak

Respectfully submitted,

NAME (Print)

SIGNATURE:

EVALYN J. EFFINGER

Evalyn J. Effinger

ADDRESS: 3447 Frontier Ave.

TELEPHONE #: 876-1484

Las Vegas, NV 89106

**Additional property owners may sign on an attached sheet.

A copy of the Deed of Ownership is required.

HAN:jk

CITY CLERK

Marcus Miller
FEB 5 12 16 PM '88

A-2-88(A)

RECEIVED

1744

1703191

Form 1860-9
(March 1965)
(formerly 4-1043)

The United States of America

Nev-029859

To all to whom these presents shall come, Greeting:

RPTT EXHIBIT # 2

WHEREAS, Rudolph P. Effinger and Evalyn J. Effinger are entitled to a Land Patent pursuant to the Act of December 23, 1980, 94 Stat. 3381, 43 U.S.C. 17D1; and October 21, 1976, 90 Stat. 2757, 43 U.S.C. 1719, for the following described land:

Mount Diablo Meridian, Nevada

T. 20 S., R. 60 E.
sec. 15, NW~~X~~SE~~X~~SE~~X~~NE~~X~~.

The area described contains 2.5 acres.

NOW KNOW YE, that there is, therefore, granted by the UNITED STATES, unto the above named claimants, the land above described; TO HAVE AND TO HOLD the said land with all the rights, privileges, immunities, and appurtenances, of whatsoever nature, thereunto belonging, unto the said claimants, their heirs, successors and assigns, forever:

EXCEPTING AND RESERVING TO THE UNITED STATES:

1. A right-of-way thereon for ditches and canals constructed by the authority of the United States, Act of August 30, 1890, 26 Stat. 391; 43 U.S.C. 945.

SUBJECT TO:

1. All the oil and gas, sodium and potassium deposits in the lands so patented, and to it, or persons authorized by it, the right to prospect, mine and remove such deposits from the same under applicable law and such regulations as the Secretary of the Interior may prescribe.
2. An easement 30 feet in width along the north and west boundaries for road and public utilities purposes to insure continued ingress and egress to adjacent lands.

3. Those rights granted by oil and gas lease, N-20078, made under Section 29 of the Act of February 25, 1920, 41 Stat. 437 and the Act of March 4, 1933, 47 Stat. 1570. This patent is issued subject to the right of the prior permittee or lessee to use so much of the surface of said land as is required for oil and gas exploration and development operations, without compensation to the patentee for damages resulting from proper oil and gas operations, for the duration of oil and gas lease N-20078, and any authorized extension of that lease. Upon termination or relinquishment of said oil and gas lease, this reservation shall terminate.

IN TESTIMONY WHEREOF, the undersigned authorized officer of the Bureau of Land Management, in accordance with the provisions of the Act of June 17, 1948 (62 Stat. 476), has, in the name of the United States, caused these letters to be made Patent, and the Seal of the Bureau to be hereunto affixed.

GIVEN under my hand, in Reno, Nevada
the EIGHTEENTH day of JANUARY in the year
of our Lord one thousand nine hundred and EIGHTY-THREE
and of the Independence of the United States the two hundred
and SEVENTH.

[SEAL]

300x 1744

1703191

3 1

RETURN TO:

Rudolph P. Anderson
3447 S FRONTIER ST.
1111 Vogel Nevada, 89102

RECEIVED
JOAN L. ...
RECORD ...
Walter D. Hinger
JUN 10 12 AM '83
FEE ...
OFFICIAL RECORDS
POSTAL AUTHORITY

1744 1703191

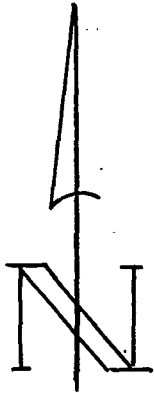

LENATA ST

ORAN K. GRAGSON HIGHWAY

A-2-88(A)

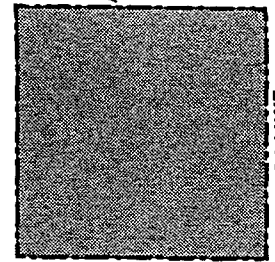

CITY LIMIT

CITY LIMIT

LORENZI BOULEVARD

PEAK DRIVE