

**Planning & Development Department
Scanning Cover Sheet**

Case No A-2-86(A)

APN N/A

Location LAKE MEAD BLVD & RANCHO DR.

Applicant William S. Boyd

Subject

Proposal for Annexation



- **SENDER:** Complete items 1, 2, 3, and 4.
Add your address in the "RETURN TO" space
on reverse.

(CONSULT POSTMASTER FOR FEES)

1. The following service is requested (check one).

Show to whom and date delivered —¢

Show to whom, date, and address of delivery .. —¢

2. **RESTRICTED DELIVERY** —¢

*(The restricted delivery fee is charged in addition to
the return receipt fee.)*

TOTAL \$ _____

3. **ARTICLE ADDRESSED TO:**

Nevada State Tax Commission
State of Nevada
Carson City, Nevada 89701

4. **TYPE OF SERVICE:**

REGISTERED INSURED
 CERTIFIED COD
 EXPRESS MAIL

- ARTICLE NUMBER**

94086

(Always obtain signature of addressee or agent)

I have received the article described above.

SIGNATURE Addressee Authorized agent

5.

DATE OF DELIVERY

2 DEC 1986

POSTMARK

6. **ADDRESSEE'S ADDRESS** (Only if requested)

7. **UNABLE TO DELIVER BECAUSE:**

7a. **EMPLOYEE'S
INITIALS**

UNITED STATES POSTAL SERVICE

OFFICIAL BUSINESS

SENDER INSTRUCTIONS

Print your name, address, and ZIP Code in the space below.

- Complete items 1, 2, 3, and 4 on the reverse.
- Attach to front of article if space permits, otherwise affix to back of article.
- Endorse article "Return Receipt Requested" adjacent to number.

**PENALTY FOR PRIVATE
USE TO AVOID PAYMENT
OF POSTAGE, \$300**



3500 0 1086 P

RECEIVED
POSTAL SERVICE

**RETURN
TO**



Mr. Harold P. Foster, Director

(Name of Sender)

Dept. of Community Planning & Development
400 East Stewart Avenue

(Street or P.O. Box)

Las Vegas, Nevada 89101

(City, State, and ZIP Code)

A-2-86 (A)

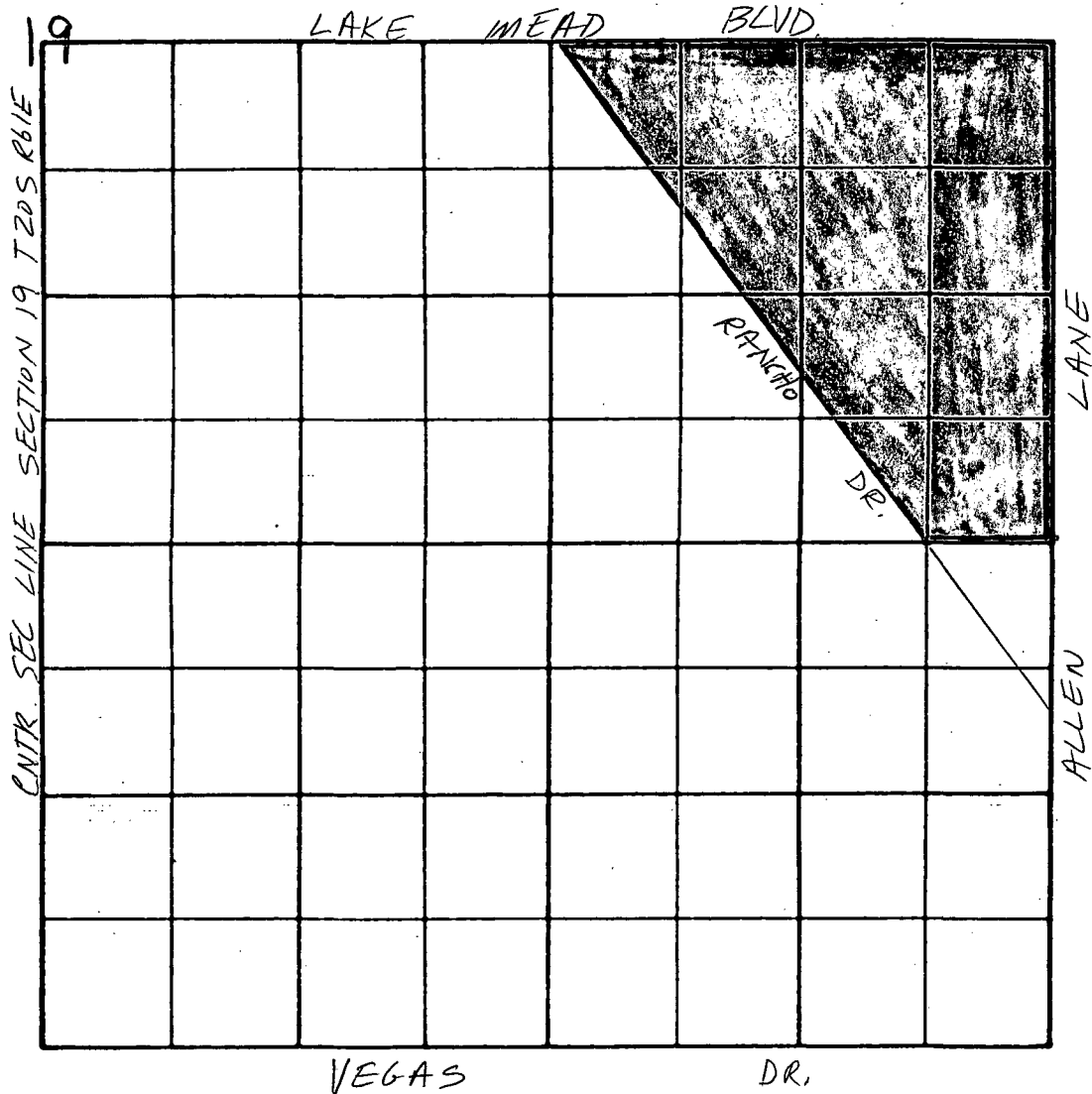

APPROVED _____ 198__
 EFFECTIVE DATE _____ 198__

SECTION 19 (SE 1/4)
 RANGE 61 E.
 TOWNSHIP 20 S.

ORD. _____

A-2-86

NET - 22.06 AC.
 GROSS - 24.06

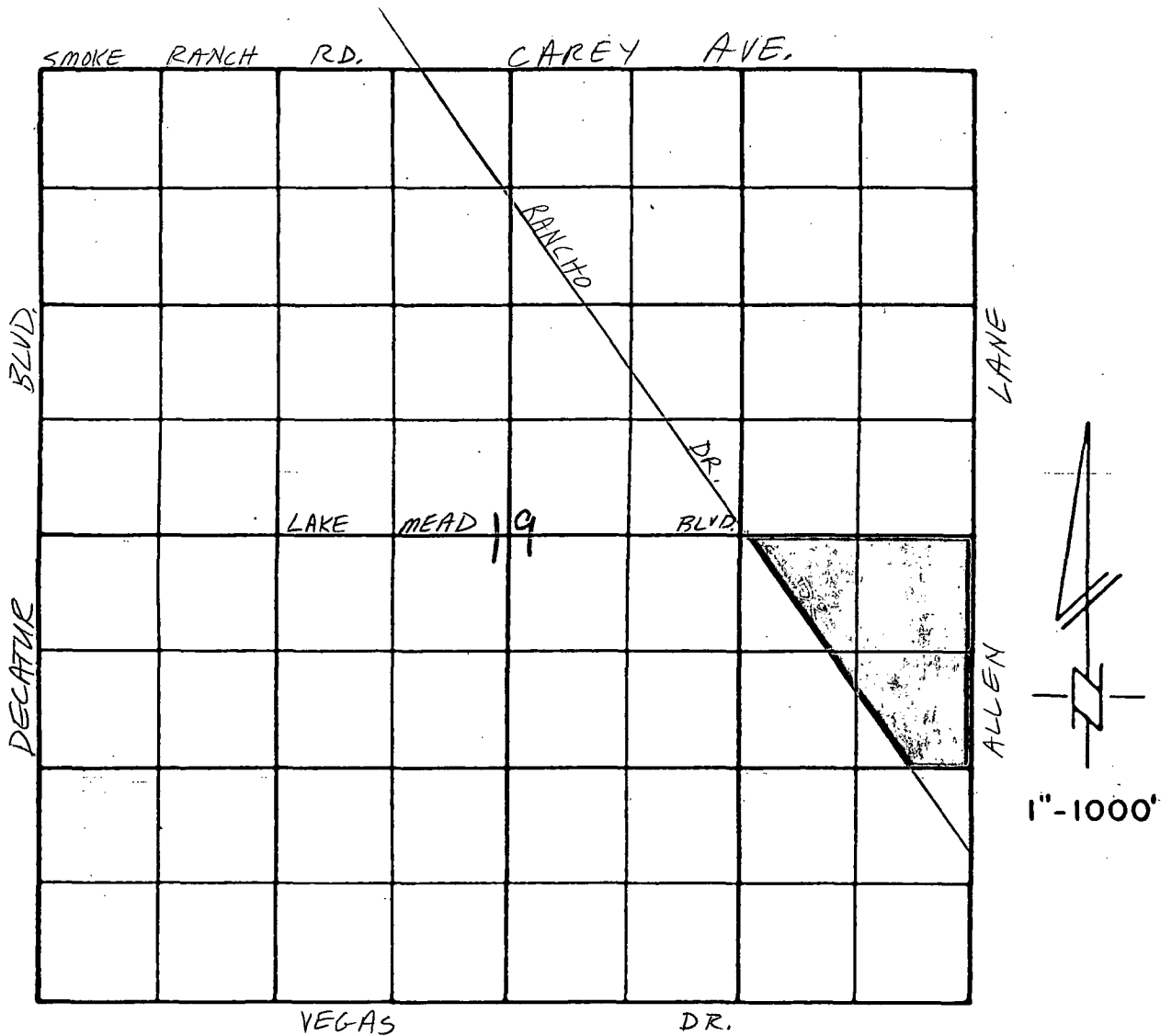

APPROVED _____ 198__
 EFFECTIVE DATE _____ 198__

SECTION 19
 RANGE 61 E.
 TOWNSHIP 20 S.

ORD. _____

A-2-86

NET - 22.06 AC.
 GROSS - 24.06

MAYOR BILL BRIARE

COUNCILMEN
RON LURIE
AL LEVY
BOB NOLEN
W. WAYNE BUNKER

CITY MANAGER
ASHLEY HALL

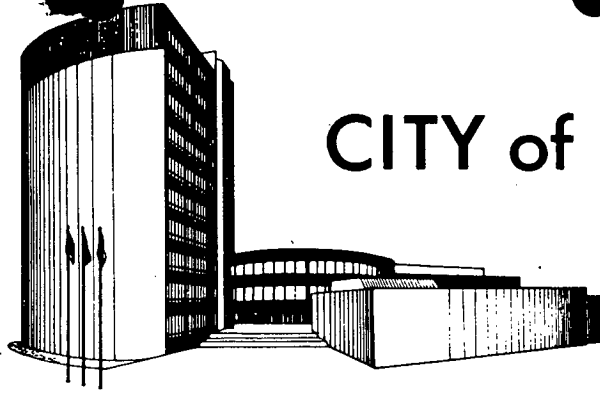

CITY of LAS VEGAS

December 18, 1986

CERTIFIED MAIL

Nevada State Tax Commission
State of Nevada
Carson City, Nevada 89701

RE: Annexation A-2-86(A)

Gentlemen:

In compliance with Nevada Revised Statutes 268.597, a certified copy of an annexation ordinance for A-2-86(A) and recorded survey map are referred to your office.

The annexation area consists of approximately 24.13 acres, generally located on the southeast corner of Lake Mead Boulevard and Rancho Drive.

If there are any questions regarding this annexation, please advise.

Sincerely,

DEPARTMENT OF COMMUNITY
PLANNING AND DEVELOPMENT

HAROLD P. FOSTER, DIRECTOR

HPF:erh

Attachments:

1. Annexation Ordinance
2. Survey Map

cc: City Clerk
Director of Finance
(w/Annex. Ord. & Loc. Map)



MAYOR BILL BRIARE

COUNCILMEN
RON LURIE
AL LEVY
BOB NOLEN
W. WAYNE BUNKER

CITY MANAGER
ASHLEY HALL

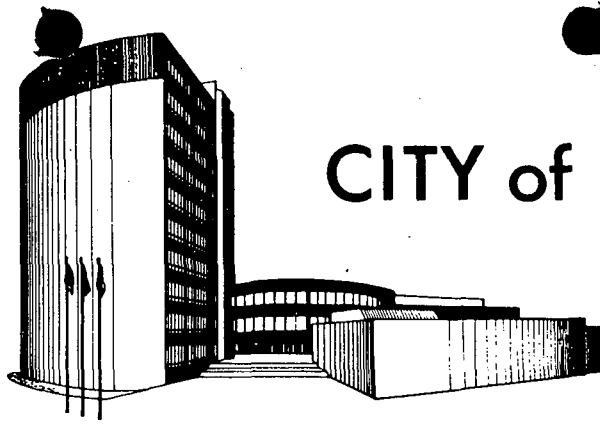

CITY of LAS VEGAS

December 18, 1986

Mr. William S. Boyd, ET AL
801 South Rancho Drive, C-1
Las Vegas, Nevada 89106

RE: A-2-86(A)

Dear Mr. Boyd:

Please be advised that your parcel of land containing approximately 24.13 acres, generally located on the southeast corner of Lake Mead Boulevard and Rancho Drive, has been annexed to the City of Las Vegas, effective November 28, 1986.

A copy of Annexation Ordinance #3255 is attached for your reference.

Sincerely,

DEPARTMENT OF COMMUNITY
PLANNING AND DEVELOPMENT
HAROLD P. FOSTER, DIRECTOR

A handwritten signature in black ink, appearing to read "R. S. Genzer". The signature is fluid and cursive, with a checkmark-like flourish at the end.

ROBERT S. GENZER
Principal Planner

HPF:RSG:erh

Attachment:
Annexation Ordinance



MAYOR BILL BRIARE

COUNCILMEN
RON LURIE
AL LEVY
BOB NOLEN
W. WAYNE BUNKER

CITY MANAGER
ASHLEY HALL

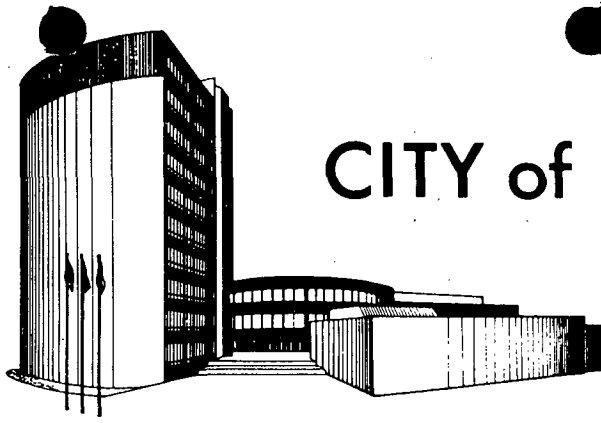

CITY of LAS VEGAS

December 18, 1986

Mrs. Mabel Snyder
Clark County Tax Assessor's Office
Mapping Division
309 South 3rd Street
Las Vegas, Nevada 89155

RE: Annexation A-2-86(A)

Dear Mrs. Snyder:

Please be advised that a parcel of land containing approximately 24.13 acres, generally located on the southeast corner of Lake Mead Boulevard and Rancho Drive, has been annexed to the City of Las Vegas, effective November 28, 1986.

A location map and a copy of Annexation Ordinance #3255 are attached for your reference.

Sincerely,

DEPARTMENT OF COMMUNITY
PLANNING AND DEVELOPMENT
HAROLD P. FOSTER, DIRECTOR

A handwritten signature in black ink, appearing to read "Robt. S. G.", written over a horizontal line.

ROBERT S. GENZER
Principal Planner

HPF:RSG:erh

Attachments:

1. Location Map
2. Annexation Ordinance



MAYOR BILL BRIARE

COUNCILMEN
RON LURIE
AL LEVY
BOB NOLEN
W. WAYNE BUNKER

CITY MANAGER
ASHLEY HALL

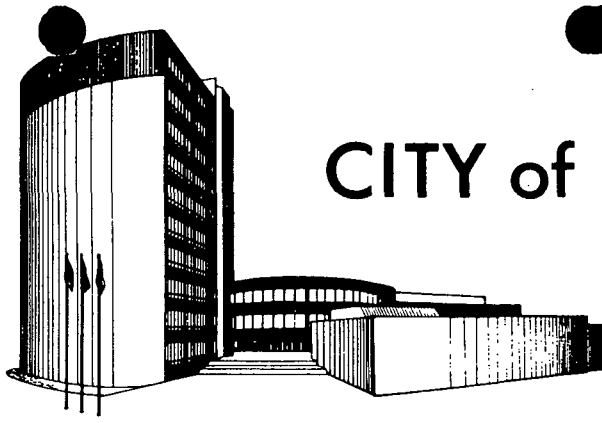

CITY of LAS VEGAS

December 18, 1986

Clark County Elections Department
400 Las Vegas Boulevard South
Las Vegas, Nevada 89101

RE: Annexation A-2-86(A)

Gentlemen:

Please be advised that a parcel of land containing approximately 24.13 acres, generally located on the southeast corner of Lake Mead Boulevard and Rancho Drive, has been annexed to the City of Las Vegas, effective November 28, 1986.

A location map, a copy of Annexation Ordinance #3255, and a copy of the survey map are attached for your reference.

Sincerely,

DEPARTMENT OF COMMUNITY
PLANNING AND DEVELOPMENT
HAROLD P. FOSTER, DIRECTOR

ROBERT S. GENZER
Principal Planner

HPF:RSG:erh

Attachments:

1. Location Map
2. Annexation Ordinance
3. Survey Map



MAYOR BILL BRIARE

COUNCILMEN
RON LURIE
AL LEVY
BOB NOLEN
W. WAYNE BUNKER

CITY MANAGER
ASHLEY HALL

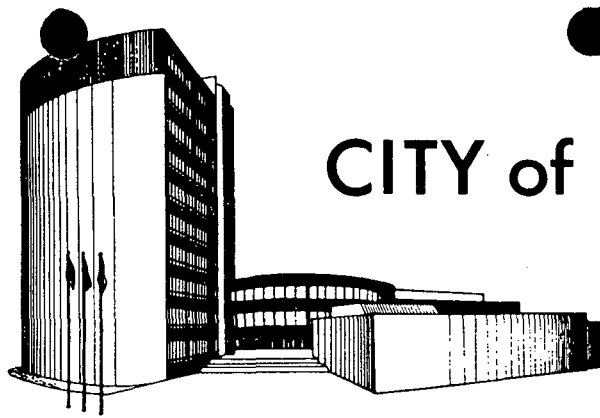

CITY of LAS VEGAS

December 18, 1986

Mr. Richard Stites, Controller
Southwest Gas Corporation
5241 Spring Mountain Road
Las Vegas, Nevada 89114-5015

RE: Annexation A-2-86(A)

Dear Mr. Stites:

Please be advised that a parcel of land containing approximately 24.13 acres, generally located on the southeast corner of Lake Mead Boulevard and Rancho Drive, has been annexed to the City of Las Vegas, effective November 28, 1986.

A location map and a copy of Annexation Ordinance #3255 are attached for your reference.

Sincerely,

DEPARTMENT OF COMMUNITY
PLANNING AND DEVELOPMENT
HAROLD P. FOSTER, DIRECTOR

ROBERT S. GENZER
Principal Planner

HPF:RSG:erh

Attachments:

1. Location Map (Three Copies)
2. Annexation Ordinance



MAYOR BILL BRIARE

COUNCILMEN
RON LURIE
AL LEVY
BOB NOLEN
W. WAYNE BUNKER

CITY MANAGER
ASHLEY HALL

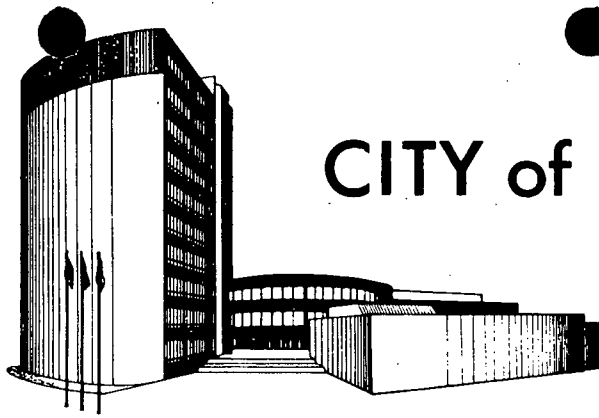

CITY of LAS VEGAS

December 18, 1986

Ms. Shirley Myron
Nevada Power Company
Manager of Office Services
P. O. Box 230
Las Vegas, Nevada 89151

RE: Annexation A-2-86(A)

Dear Ms. Myron:

Please be advised that a parcel of land containing approximately 24.13 acres, generally located on the southeast corner of Lake Mead Boulevard and Rancho Drive, has been annexed to the City of Las Vegas, effective November 28, 1986.

A location map and a copy of Annexation Ordinance #3255 are attached for your reference.

Sincerely,

DEPARTMENT OF COMMUNITY
PLANNING AND DEVELOPMENT
HAROLD P. FOSTER, DIRECTOR

A handwritten signature in black ink, appearing to read "R. S. Genzer". The signature is fluid and cursive, written over the typed name below.

ROBERT S. GENZER
Principal Planner

HPF:RSG:erh

Attachments:

1. Location Map
2. Annexation Ordinance



INTER-OFFICE MEMORANDUM

December 18, 1986

TO: BUILDING & SAFETY BUSINESS ACTIVITY ELECTRICAL SERVICES DIV., GEORGE FERRIS FIRE SERVICES, RAY PEEPLES & PAULA LEMKE LAND DEVELOPMENT, JOEL HARRIS RIGHT-OF-WAY ACQUISITION	FROM: DEPARTMENT OF COMMUNITY PLANNING AND DEVELOPMENT HAROLD P. FOSTER, DIRECTOR <i>GW</i> ROBERT S. GENZER PRINCIPAL PLANNER
SUBJECT: ANNEXATION A-2-86(A) WILLIAM S. BOYD, ET AL	COPIES TO: CENTEL, DENNIS DOULDER CENTEL, MARGARET McMILLAN CURRENT PLANNING DIV., JOHN HERBERT

Please be advised that a parcel of land containing approximately 24.13 acres, generally located on the southeast corner of Lake Mead Boulevard and Rancho Drive, has been annexed to the City of Las Vegas, effective November 28, 1986.

A location map and a copy of Annexation Ordinance #3255 are attached for your reference.

HPF:RSG:erh

Attachment:

1. Location Map
2. Annexation Ordinance

1
2
3
4
5
6
7
8
9
10
11
12
13
14
15
16
17
18
19
20
21
22
23
24
25
26
27
28
29
30
31
32

Bill No. 86-52

ORDINANCE NO. 3255

AN ORDINANCE EXTENDING THE CORPORATE LIMITS OF THE CITY OF LAS VEGAS, NEVADA, TO INCLUDE WITHIN, ANNEX TO AND MAKE A PART OF SAID CITY CERTAIN SPECIFICALLY DESCRIBED TERRITORY ADJOINING AND CONTIGUOUS TO THE CORPORATE LIMITS OF SAID CITY; DECLARING SAID TERRITORY AND THE INHABITANTS THEREOF TO BE ANNEXED TO SAID CITY AND SUBJECT TO ALL DEBTS, LAWS, ORDINANCES AND REGULATIONS IN FORCE IN SAID CITY; ORDERING A MAP OR PLAT OF SAID DESCRIBED TERRITORY TO BE RECORDED IN THE OFFICE OF THE COUNTY RECORDER OF THE COUNTY OF CLARK, STATE OF NEVADA; DESIGNATING THE ZONING CLASSIFICATION(S) APPLICABLE TO SAID TERRITORY; PROVIDING FOR OTHER MATTERS PROPERLY RELATING THERETO; AND REPEALING ALL ORDINANCES AND PARTS OF ORDINANCES IN CONFLICT HEREWITH.
(Annexation A-2-86(A))

Sponsored by:
Councilman Ron Lurie

Summary: Annexes property described generally as located on the south-east corner of Lake Mead Boulevard and Rancho Drive.

THE CITY COUNCIL OF THE CITY OF LAS VEGAS DOES HEREBY
ORDAIN AS FOLLOWS:

SECTION 1: The corporate limits of the City of Las Vegas, Nevada, are hereby extended to include, annex to, and make a part of the City of Las Vegas, Nevada, the following described real property, to-wit:

That portion of the Southeast Quarter (SE 1/4) of Section 19, Township 20 South, Range 61 East, M.D.M., in the County of Clark, State of Nevada, described as follows:

BEGINNING at the Northeast corner of the Southeast Quarter (SE 1/4) of said Section 19; thence along the North line of said Southeast Quarter (SE 1/4), South 89°25'22" West a distance of 1287.34 feet to the Northeasterly line of RANCHO DRIVE (U.S. Highway No. 95); thence along said Northeasterly line of RANCHO DRIVE, South 36°21'22" East a distance of 1603.78 feet to the South line of the Northeast Quarter (NE 1/4) of the Southeast Quarter (SE 1/4) of said Section 19; thence along said South line, North 89°56'15" East a distance of 328.01 feet to the East line of said Southeast Quarter (SE 1/4); thence along said East line, North 00°22'30" East a distance of 1304.24 feet to the POINT OF BEGINNING.

SECTION 2: That said City Council has determined and does hereby determine, that said described territory meets the requirements provided by law for annexation to the City of Las

THIS IS A COPY

CERTIFIED AS A TRUE COPY
Carol A. Hawley

CAROL ANN HAWLEY
CITY CLERK
CITY OF LAS VEGAS, NEVADA

11-25-86

(6 pages)

1 Vegas for the following reasons:

2 A. The area to be annexed was contiguous to the
3 City's boundaries at the time the annexation pro-
4 ceedings were instituted;

5 B. More than one-eighth (1/8) of the aggregate
6 external boundaries of the area are contiguous to the
7 City of Las Vegas;

8 C. The territory proposed to be annexed is not
9 included within the boundaries of another incor-
10 porated city or within the boundaries of any unin-
11 corporated town as those boundaries existed as of
12 July 1, 1983;

13 D. The City of Las Vegas is eligible to annex the
14 area described in this report since the landowners
15 have signed a petition requesting annexation to
16 the City, said petition constituting one hundred
17 percent (100%) of the owners of record of individual
18 lots or parcels of land within the annexation area.

19 SECTION 3: The City of Las Vegas will provide police
20 protection through the Las Vegas Metropolitan Police Department,
21 fire protection, street maintenance, and library services
22 immediately upon annexation. Garbage collection by the company
23 franchised by the City will also be provided immediately. The
24 City sanitary sewer system will serve the proposed annexation
25 area. Any connection to or extension of this sewer line to serve
26 the annexation area shall be at the expense of the landowners.
27 Other services, such as participation in the City's recreational
28 programs, special educational classes and programs, public works
29 planning, building inspections, and other City Hall services
30 will also be available immediately. Utilities such as gas,
31 electricity, telephone, and water are provided by private utility
32 companies and other services to the area will not be affected by

A-2-86(A)

1 annexation. Street paving, curbs and gutters, sidewalks and
2 street lights which are not in place at the time of annexation
3 will be installed in the presently developed areas upon the
4 request of the property owners and at their expense by means
5 of special assessment districts. Such improvements will be
6 extended into the undeveloped areas as development takes place
7 and the need therefor arises, and will be located according to
8 the needs of the area at that time. Such installations will
9 also be made at the expense of the property owners, either by
10 means of special assessment districts or as prerequisites to the
11 approval of subdivision plats or the issuance of building permits,
12 re-zonings, zone variances or special use permits.

13 SECTION 4: The annexation of said described territory
14 shall become effective on the 28th day of November, 1986, and on
15 such date the City of Las Vegas will have the funds appropriated
16 in sufficient amount to finance the extension into said described
17 territory of police protection, fire protection, street
18 maintenance, street sweeping, and street lighting maintenance.

19 SECTION 5: Said described territory, together with the
20 inhabitants and property thereof, shall, from and after the
21 28th day of November, 1986, be subject to all debts, laws,
22 ordinances and regulations in force in the City of Las Vegas and
23 shall be entitled to the same privileges and benefits as other
24 parts of said City, and shall be subject to municipal taxes levied
25 by the City of Las Vegas, Nevada.

26 SECTION 6: The City Engineer of the City of Las Vegas,
27 Nevada, is hereby instructed to cause to be prepared an accurate
28 map or plat of said described territory and to record the same,
29 together with a certified copy of this ordinance in the office of
30 the County Recorder of Clark County, Nevada, which said recording
31 shall be done prior to the 28th day of November, 1986.

32 SECTION 7: That portion of the said described territory

1 which heretofore has been zoned H-2 (County of Clark classifica-
2 tion), and which extends from the centerline of Rancho Drive
3 easterly 660 feet, is hereby classified as C-2 (City of Las
4 Vegas classification), which is deemed to be the City equivalent
5 of said County classification. The remaining portion of the said
6 described territory, which heretofore has been zoned R-E (County
7 classification) is hereby classified as N-U (City classification),
8 which is deemed to be the City equivalent of said County classifi-
9 cation.

10 SECTION 8: If any section, subsection, subdivision,
11 paragraph, sentence, clause or phrase in this ordinance or any
12 part thereof, is for any reason held to be unconstitutional, or
13 invalid or ineffective by any court of competent jurisdiction,
14 such decision shall not affect the validity or effectiveness of
15 the remaining portions of this ordinance or any part thereof. The
16 City Council of the City of Las Vegas hereby declares that it
17 would have passed each section, subsection, subdivision, para-
18 graph, sentence, clause or phrase thereof irrespective of the
19 fact that any one or more sections, subsections, subdivisions,
20 paragraphs, sentences, clauses or phrases be declared unconstitu-
21 tional, invalid or ineffective.

22 SECTION 9: All ordinances or parts of ordinances,
23 sections, subsections, phrases, sentences, clauses or paragraphs
24 . . .
25 . . .
26 . . .
27 . . .
28 . . .
29 . . .
30 . . .
31 . . .
32 . . .

1 contained in the Municipal Code of the City of Las Vegas, Nevada,
2 1983 Edition, in conflict herewith are hereby repealed.

3 PASSED, ADOPTED and APPROVED this 19th day of
4 November, 1986.

5 APPROVED:



9 By Ron Lurie
10 RON LURIE, MAYOR PRO TEM

11 ATTEST:

12 Carol Ann Hawley
13 CAROL ANN HAWLEY, City Clerk

14
15
16
17
18
19
20
21
22
23
24
25
26
27
28
29
30
31
32

Approved
11-21-86

1 The above and foregoing ordinance was first proposed and read by
2 title to the City Council on the 15th day of October,
3 1986, and referred to the following committee composed of
4 Councilmen Lurie and Levy
5 for recommendation; thereafter the said committee reported
6 favorably on said ordinance on the 19th day of November,
7 1986, which was a regular meeting of said Council;
8 that at said regular meeting, the proposed ordinance
9 was read by title to the City Council as first introduced and
10 adopted by the following vote:

11
12 VOTING "AYE" Councilmen: Bunker, Nolen and Mayor Pro Tem Lurie
13 VOTING "NAY" Councilmen: None
14 ABSENT: EXCUSED: Mayor Briare and Councilman Levy

15 APPROVED:

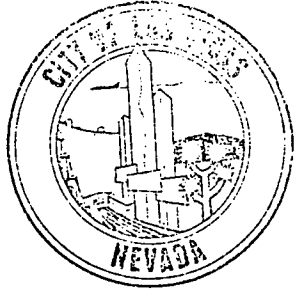

16
17 By Ron Lurie
18 RON LURIE, MAYOR PRO TEM

19 ATTEST:
20
21 Carol Ann Hawley
22 CAROL ANN HAWLEY, City Clerk

23
24
25
26
27
28
29
30
31
32 A-2-86(A)

CLARK COUNTY NEVADA
JOAN L. SWIFT, RECORDER
RECORDED AT REQUEST OF
- 6 -
Nov 26 10 59 AM '86
FEE _____ DEPUTY _____
OFFICIAL RECORDS
BOOK _____ INSTRUMENT _____

861126 00742

AGENDA DOCUMENTATION

Date: September 24, 1986

TO: The City Council

FROM: Val Steed *Val Steed*
Deputy City Attorney

SUBJECT: Bill No.
Annexation No. A-2-86(A)

PURPOSE/BACKGROUND

The proposed ordinance annexes certain real property located on the southeast corner of Lake Mead Boulevard and Rancho Drive. The annexation process has now been completed in accordance with the NRS and the final date of annexation (November 28, 1986) is set by this ordinance.

The following is pertinent information:

Annexation No.	A-2-86(A)
Property Located:	On the southeast corner of Lake Mead Boulevard and Rancho Drive.
Petitioned By:	William S. Boyd, et al. 801 S. Rancho Drive C-1 Las Vegas, Nevada 89103
Acreage:	Approximately 24.13 acres
Zoned:	H-2 and R-E (County classification) C-2 and N-U (City equivalent)

FISCAL IMPACT

None

RECOMMENDATIONS

This Bill should be submitted to a Recommending Committee for review, hearing and recommendation to the City Council for final action.

Agenda Item

Empty box for agenda item tracking.

1
2
3
4
5
6
7
8
9
10
11
12
13
14
15
16
17
18
19
20
21
22
23
24
25
26
27
28
29
30
31
32

Bill No.

ORDINANCE NO. _____

AN ORDINANCE EXTENDING THE CORPORATE LIMITS OF THE CITY OF LAS VEGAS, NEVADA, TO INCLUDE WITHIN, ANNEX TO AND MAKE A PART OF SAID CITY CERTAIN SPECIFICALLY DESCRIBED TERRITORY ADJOINING AND CONTIGUOUS TO THE CORPORATE LIMITS OF SAID CITY; DECLARING SAID TERRITORY AND THE INHABITANTS THEREOF TO BE ANNEXED TO SAID CITY AND SUBJECT TO ALL DEBTS, LAWS, ORDINANCES AND REGULATIONS IN FORCE IN SAID CITY; ORDERING A MAP OR PLAT OF SAID DESCRIBED TERRITORY TO BE RECORDED IN THE OFFICE OF THE COUNTY RECORDER OF THE COUNTY OF CLARK, STATE OF NEVADA; DESIGNATING THE ZONING CLASSIFICATION(S) APPLICABLE TO SAID TERRITORY; PROVIDING FOR OTHER MATTERS PROPERLY RELATING THERETO; AND REPEALING ALL ORDINANCES AND PARTS OF ORDINANCES IN CONFLICT HEREWITH.
(Annexation A-2-86(A))

Sponsored by:
Councilman Ron Lurie

Summary: Annexes property described generally as located on the south-east corner of Lake Mead Boulevard and Rancho Drive.

THE CITY COUNCIL OF THE CITY OF LAS VEGAS DOES HEREBY
ORDAIN AS FOLLOWS:

SECTION 1: The corporate limits of the City of Las Vegas, Nevada, are hereby extended to include, annex to, and make a part of the City of Las Vegas, Nevada, the following described real property, to-wit:

That portion of the Southeast Quarter (SE 1/4) of Section 19, Township 20 South, Range 61 East, M.D.M., in the County of Clark, State of Nevada, described as follows:

BEGINNING at the Northeast corner of the Southeast Quarter (SE 1/4) of said Section 19; thence along the North line of said Southeast Quarter (SE 1/4), South 89°25'22" West a distance of 1287.34 feet to the Northeasterly line of RANCHO DRIVE (U.S. Highway No. 95); thence along said Northeasterly line of RANCHO DRIVE, South 36°21'22" East a distance of 1603.78 feet to the South line of the Northeast Quarter (NE 1/4) of the Southeast Quarter (SE 1/4) of said Section 19; thence along said South line, North 89°56'15" East a distance of 328.01 feet to the East line of said Southeast Quarter (SE 1/4); thence along said East line, North 00°22'30" East a distance of 1304.24 feet to the POINT OF BEGINNING.

SECTION 2: That said City Council has determined and does hereby determine, that said described territory meets the requirements provided by law for annexation to the City of Las

1 Vegas for the following reasons:

2 A. The area to be annexed was contiguous to the
3 City's boundaries at the time the annexation pro-
4 ceedings were instituted;

5 B. More than one-eighth (1/8) of the aggregate
6 external boundaries of the area are contiguous to the
7 City of Las Vegas;

8 C. The territory proposed to be annexed is not
9 included within the boundaries of another incor-
10 porated city or within the boundaries of any unin-
11 corporated town as those boundaries existed as of
12 July 1, 1983;

13 D. The City of Las Vegas is eligible to annex the
14 area described in this report since the landowners
15 have signed a petition requesting annexation to
16 the City, said petition constituting one hundred
17 percent (100%) of the owners of record of individual
18 lots or parcels of land within the annexation area.

19 SECTION 3: The City of Las Vegas will provide police
20 protection through the Las Vegas Metropolitan Police Department,
21 fire protection, street maintenance, and library services
22 immediately upon annexation. Garbage collection by the company
23 franchised by the City will also be provided immediately. The
24 City sanitary sewer system will serve the proposed annexation
25 area. Any connection to or extension of this sewer line to serve
26 the annexation area shall be at the expense of the landowners.
27 Other services, such as participation in the City's recreational
28 programs, special educational classes and programs, public works
29 planning, building inspections, and other City Hall services
30 will also be available immediately. Utilities such as gas,
31 electricity, telephone, and water are provided by private utility
32 companies and other services to the area will not be affected by

A-2-86(A)

1 annexation. Street paving, curbs and gutters, sidewalks and
2 street lights which are not in place at the time of annexation
3 will be installed in the presently developed areas upon the
4 request of the property owners and at their expense by means
5 of special assessment districts. Such improvements will be
6 extended into the undeveloped areas as development takes place
7 and the need therefor arises, and will be located according to
8 the needs of the area at that time. Such installations will
9 also be made at the expense of the property owners, either by
10 means of special assessment districts or as prerequisites to the
11 approval of subdivision plats or the issuance of building permits,
12 re-zonings, zone variances or special use permits.

13 SECTION 4: The annexation of said described territory
14 shall become effective on the 28th day of November, 1986, and on
15 such date the City of Las Vegas will have the funds appropriated
16 in sufficient amount to finance the extension into said described
17 territory of police protection, fire protection, street
18 maintenance, street sweeping, and street lighting maintenance.

19 SECTION 5: Said described territory, together with the
20 inhabitants and property thereof, shall, from and after the
21 28th day of November, 1986, be subject to all debts, laws,
22 ordinances and regulations in force in the City of Las Vegas and
23 shall be entitled to the same privileges and benefits as other
24 parts of said City, and shall be subject to municipal taxes levied
25 by the City of Las Vegas, Nevada.

26 SECTION 6: The City Engineer of the City of Las Vegas,
27 Nevada, is hereby instructed to cause to be prepared an accurate
28 map or plat of said described territory and to record the same,
29 together with a certified copy of this ordinance in the office of
30 the County Recorder of Clark County, Nevada, which said recording
31 shall be done prior to the 28th day of November, 1986.

32 SECTION 7: That portion of the said described territory

1 which heretofore has been zoned H-2 (County of Clark classifica-
2 tion), and which extends from the centerline of Rancho Drive
3 easterly 660 feet, is hereby classified as C-2 (City of Las
4 Vegas classification), which is deemed to be the City equivalent
5 of said County classification. The remaining portion of the said
6 described territory, which heretofore has been zoned R-E (County
7 classification) is hereby classified as N-U (City classification),
8 which is deemed to be the City equivalent of said County classifi-
9 cation.

10 SECTION 8: If any section, subsection, subdivision,
11 paragraph, sentence, clause or phrase in this ordinance or any
12 part thereof, is for any reason held to be unconstitutional, or
13 invalid or ineffective by any court of competent jurisdiction,
14 such decision shall not affect the validity or effectiveness of
15 the remaining portions of this ordinance or any part thereof. The
16 City Council of the City of Las Vegas hereby declares that it
17 would have passed each section, subsection, subdivision, para-
18 graph, sentence, clause or phrase thereof irrespective of the
19 fact that any one or more sections, subsections, subdivisions,
20 paragraphs, sentences, clauses or phrases be declared unconstitu-
21 tional, invalid or ineffective.

22 SECTION 9: All ordinances or parts of ordinances,
23 sections, subsections, phrases, sentences, clauses or paragraphs
24 . . .
25 . . .
26 . . .
27 . . .
28 . . .
29 . . .
30 . . .
31 . . .
32 . . .

1 contained in the Municipal Code of the City of Las Vegas, Nevada,
2 1983 Edition, in conflict herewith are hereby repealed.

3 PASSED, ADOPTED and APPROVED this _____ day of
4 _____, 1986.

5 APPROVED:

6
7 By _____
8 WILLIAM H. BRIARE, Mayor

9 ATTEST:

10
11 _____
12 CAROL ANN HAWLEY, City Clerk

13
14
15
16
17
18
19
20
21
22
23
24
25
26
27
28
29
30
31
32

1 The above and foregoing ordinance was first proposed and read by
2 title to the City Council on the ____ day of _____,
3 1986, and referred to the following committee composed of
4 Councilmen _____ and _____
5 for recommendation; thereafter the said committee reported
6 favorably on said ordinance on the ____ day of _____,
7 1986, which was a _____ meeting of said Council;
8 that at said _____ meeting, the proposed ordinance
9 was read by title to the City Council as first introduced and
10 adopted by the following vote:

11
12 VOTING "AYE" Councilmen: _____

13 VOTING "NAY" Councilmen: _____

14 ABSENT: _____

15 APPROVED:

16
17 By _____
18 WILLIAM H. BRIARE, Mayor

19 ATTEST:

20
21 _____
22 CAROL ANN HAWLEY, City Clerk

23

24

25

26

27

28

29

30

31

32

NOTICE TO PUBLISH

Las Vegas, Nevada

Date: November 19, 1986

TO: LAS VEGAS SUN

FROM: CITY CLERK

SUBJECT: PUBLICATION OF BILL NO. 86-52 ORDINANCE NO. 3255 ANNEXATION NO. A-2-86(A)
ANNEXES PROPERTY DESCRIBED GENERALLY AS LOCATED ON THE SOUTHEAST CORNER OF LAKE MEAD
BOULEVARD AND RANCHO DRIVE.

Please publish the attached LEGAL NOTICE

ON THE FOLLOWING DATES: Saturday, November 22, 1986 (one time only)

and send me three copies of the Affidavit of Publication at your earliest convenience. (No later than seven (7) days following final publication.)

Carol A. Hawley
CITY CLERK

cc: Finance Department - Accounts Payable
City Attorney - (on Ordinances only)
Community Planning & Development

1
2
3
4
5
6
7
8
9
10
11
12

Bill No. 86-52

ORDINANCE NO. 3255

AN ORDINANCE EXTENDING THE CORPORATE LIMITS OF THE CITY OF LAS VEGAS, NEVADA, TO INCLUDE WITHIN, ANNEX TO AND MAKE A PART OF SAID CITY CERTAIN SPECIFICALLY DESCRIBED TERRITORY ADJOINING AND CONTIGUOUS TO THE CORPORATE LIMITS OF SAID CITY; DECLARING SAID TERRITORY AND THE INHABITANTS THEREOF TO BE ANNEXED TO SAID CITY AND SUBJECT TO ALL DEBTS, LAWS, ORDINANCES AND REGULATIONS IN FORCE IN SAID CITY; ORDERING A MAP OR PLAT OF SAID DESCRIBED TERRITORY TO BE RECORDED IN THE OFFICE OF THE COUNTY RECORDER OF THE COUNTY OF CLARK, STATE OF NEVADA; DESIGNATING THE ZONING CLASSIFICATION(S) APPLICABLE TO SAID TERRITORY; PROVIDING FOR OTHER MATTERS PROPERLY RELATING THERETO; AND REPEALING ALL ORDINANCES AND PARTS OF ORDINANCES IN CONFLICT HEREWITH.
(Annexation A-2-86(A))

Sponsored by:
Councilman Ron Lurie

Summary: Annexes property described generally as located on the south-east corner of Lake Mead Boulevard and Rancho Drive.

The above and foregoing ordinance was first proposed and read by title to the City Council on the 15th day of October, 1986, and referred to the following committee composed of Councilmen Lurie and Levy for recommendation; thereafter the said committee reported favorably on said ordinance on the 19th day of November, 1986, which was a regular meeting of said Council; that at said regular meeting, the proposed ordinance was read by title to the City Council as first introduced and adopted by the following vote:

VOTING "AYE" Councilmen: Bunker, Nolen and Mayor Pro Tem Lurie
VOTING "NAY" Councilmen: None
ABSENT: EXCUSED: Mayor Briare and Councilman Levy

COPIES OF THE COMPLETE ORDINANCE ARE AVAILABLE FOR PUBLIC INFORMATION IN THE OFFICE OF THE CITY CLERK, 10TH FLOOR, CITY HALL, 400 EAST STEWART AVENUE, LAS VEGAS, NEVADA.

INTER-OFFICE MEMORANDUM

Date

Nov. 26, 1986

TO:

RIGHT-OF-WAY ACQUISITION,
DEPARTMENT OF PUBLIC WORKS

FROM:

ROBERT S. GENZER, SENIOR PLANNER
DEPARTMENT OF COMMUNITY PLANNING
AND DEVELOPMENT

SUBJECT:

RECORDATION: A-2-86(A)
WILLIAM S. BOYD, ET AL

COPIES TO:

Subject Annexation MUST BE RECORDED BEFORE Nov. 27, 1986.

Please return a Recorded Copy for our files.

Thank you.

RSG:jrm

Attachment

NOTICE TO PUBLISH

Las Vegas, Nevada

Date: OCTOBER 28, 1986

TO: LAS VEGAS SUN

FROM: CITY CLERK

SUBJECT: PUBLICATION OF BILL NO. 86-52 ANNEXATION NO. A-2-86(A)

ANNEXES PROPERTY DESCRIBED GENERALLY AS LOCATED ON THE SOUTHEAST CORNER OF LAKE MEAD BOULEVARD AND RANCHO DRIVE.

Please publish the attached Legal Notice

ON THE FOLLOWING DATES: Thursday, October 30, 1986 (one time only)

and send me three copies of the Affidavit of Publication at your earliest convenience. (No later than seven (7) days following final publication.)

Carol A. Hawley
CITY CLERK

cc: Finance Department - Accounts Payable
City Attorney - (on Ordinances only)
Community Planning & Development

Bill No. 86-52

1
2
3
4
5
6
7
8
9
10
11
12

AN ORDINANCE EXTENDING THE CORPORATE LIMITS OF THE CITY OF LAS VEGAS, NEVADA, TO INCLUDE WITHIN, ANNEX TO AND MAKE A PART OF SAID CITY CERTAIN SPECIFICALLY DESCRIBED TERRITORY ADJOINING AND CONTIGUOUS TO THE CORPORATE LIMITS OF SAID CITY; DECLARING SAID TERRITORY AND THE INHABITANTS THEREOF TO BE ANNEXED TO SAID CITY AND SUBJECT TO ALL DEBTS, LAWS, ORDINANCES AND REGULATIONS IN FORCE IN SAID CITY; ORDERING A MAP OR PLAT OF SAID DESCRIBED TERRITORY TO BE RECORDED IN THE OFFICE OF THE COUNTY RECORDER OF THE COUNTY OF CLARK, STATE OF NEVADA; DESIGNATING THE ZONING CLASSIFICATION(S) APPLICABLE TO SAID TERRITORY; PROVIDING FOR OTHER MATTERS PROPERLY RELATING THERETO; AND REPEALING ALL ORDINANCES AND PARTS OF ORDINANCES IN CONFLICT HEREWITH.
(Annexation A-2-86(A))

Sponsored by:
Councilman Ron Lurie

Summary: Annexes property described generally as located on the south-east corner of Lake Mead Boulevard and Rancho Drive.

At a City Council meeting

October 15, 1986

BILL NO. 86-52 WAS READ BY TITLE
AND REFERRED TO RECOMMENDING COMMITTEE:

COUNCILMEN Lurie

and Levy

COPIES OF THE COMPLETE ORDINANCE ARE AVAILABLE FOR PUBLIC INFORMATION IN THE OFFICE OF THE CITY CLERK, 10TH FLOOR, CITY HALL, 400 EAST STEWART AVENUE, LAS VEGAS, NEVADA.

INTER-OFFICE MEMORANDUM

Sept. 23, 1986

TO:

Harold Foster, Director
Community Planning & Development

FROM:

George F. Ogilvie
George F. Ogilvie,
City Attorney

SUBJECT:

Ordinance Request Memorandum
-- Annexation A-2-86(A)

COPIES TO:

Val Steed

RECEIVED
SEP 24 1986
PLANNING AND
DEVELOPMENT

This will acknowledge your ordinance request memorandum regarding the above subject. This request has been assigned to Val Steed and he should have it completed no later than 4:30 p.m. on October 3, 1986, to be placed on the agenda for the City Council meeting of October 15, 1986. If the urgency of this matter requires an earlier answer, or if you have any questions, please feel free to contact him.

/ph

CITY OF LAS VEGAS
ORDINANCE REQUEST MEMORANDUM

September 11, 1986

DATE

TO: CITY MANAGER	FROM: HAROLD P. FOSTER, DIRECTOR DEPARTMENT OF COMMUNITY PLANNING
SUBJECT OF ORDINANCE: A-2-86(A)	APPROVED TO FORWARD: CITY MANAGER DATE:
SPONSOR: DATE:	DATE TO CITY ATTORNEY: DATE TO SUBMITTING DEPT:

INTER-OFFICE MEMORANDUM

9-11-86

TO:

GEORGE OGILVIE
CITY ATTORNEY

FROM:

HAROLD P. FOSTER, DIRECTOR
DEPARTMENT OF COMMUNITY PLANNING
AND DEVELOPMENT

SUBJECT:

ANNEXATION A-2-86(A)
WILLIAM S. BOYD, ET AL
ORDINANCE PREPARATION

COPIES TO:

ROBERT S. GENZER

Please prepare an ordinance with an effective date of November 28, 1986 for the subject annexation. This annexation is under the alternate annexation provisions provided for by N.R.S. 268.597.

The annexation area is generally located on the southeast corner of Lake Mead Boulevard and Rancho Drive, containing approximately 24.13 acres of land. The County zoning is H-2 from the centerline of Rancho Drive easterly 660 feet, with the remainder of the property zoned R-E. The City's zoning equivalent would be C-2 (H-2 area) and N-U (R-E area).

Please send us a copy of the ordinance when it is completed. It is requested that the first reading of this ordinance be scheduled for October 15, 1986, with a final reading on November 19, 1986, City Council meetings.

HPF:RSG:jp

w/Attachment

September 10, 1986

TO:

Community Planning and Development

FROM:

Public Works
Survey Division

RECEIVED
SEP 11 1986
PLANNING AND
DEVELOPMENT
2h

SUBJECT:

A-2-86 (A)

COPIES TO:

Right-of-Way Design
Survey

Attached is the requested legal description for use in the subject ~~vacation~~.

ANNEXATION

C. D. Peterson
C. D. PETERSON, R.L.S.

CDP/grc

Attachment

**CITY OF LAS VEGAS
DEPARTMENT OF PUBLIC WORKS
RIGHT OF WAY
LEGAL DESCRIPTION**

Tax Parcel No. _____

Document No. _____

Vesting A-2-86 (A)Section NE 1/4, SE 1/4, Sec. 19, T.20S., R.61E., M.D.M.

Street/Subdivision _____

Requested cdp Written bb Checked mwb Proofread b.e. & jdu
8-18-86 8-18-86

That portion of the Southeast Quarter (SE 1/4) of Section 19, Township 20 South, Range 61 East, M.D.M., in the County of Clark, State of Nevada, described as follows:

BEGINNING at the Northeast corner of the Southeast Quarter (SE 1/4) of said Section 19; thence along the North line of said Southeast Quarter (SE 1/4), South 89°25'22" West a distance of 1287.34 feet to the Northeasterly line of RANCHO DRIVE (U.S. Highway No. 95); thence along said Northeasterly line of RANCHO DRIVE, South 36°21'22" East a distance of 1603.78 feet to the South line of the Northeast Quarter (NE 1/4) of the Southeast Quarter (SE 1/4) of said Section 19; thence along said South line, North 89°56'15" East a distance of 328.01 feet to the East line of said Southeast Quarter (SE 1/4); thence along said East line, North 00°22'30" East a distance of 1304.24 feet to the POINT OF BEGINNING.

INTER-OFFICE MEMORANDUM

Date

July 24, 1986

TO:

RIGHT-OF-WAY DESIGN

FROM:

SURVEY DIVISION

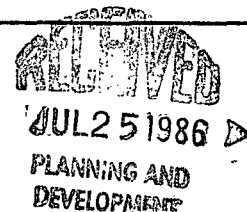

SUBJECT:

WILLIAM S. BOYD, ET AL
A-2-86A

COPIES TO:

SURVEY
COMMUNITY PLANNING & DEVELOPMENT

Please prepare a Record of Survey Map and prepare a legal description for the subject annexation. Copies of the request and the survey notes are attached.

C. D. Peterson
C. D. PETERSON, R.L.S.

CDP/grc

Attachment

MAYOR BILL BRIARE

COUNCILMEN
RON LURIE
AL LEVY
BOB NOLEN
W. WAYNE BUNKER

CITY ATTORNEY
GEORGE F. OGILVIE

CITY MANAGER
ASHLEY HALL

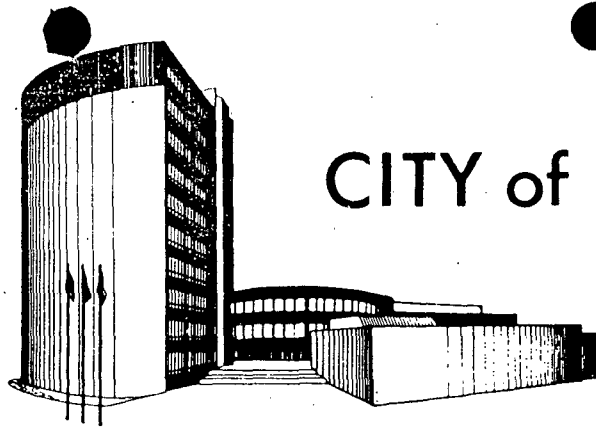

CITY of LAS VEGAS

April 30, 1986

Mr. William S. Boyd, ET AL
801 South Rancho Drive, C-1
Las Vegas, Nevada 89103

RE: A-2-86(A)

Dear Mr. Boyd:

Your Petition for Annexation of property located on the southeast corner of Lake Mead Boulevard and Rancho Drive containing approximately 22.06 acres, was considered by the Planning Commission on April 22, 1986.

The Planning Commission unanimously voted to recommend APPROVAL.

After further review, this annexation will be forwarded to the City Council for final action. You will receive notification of this meeting.

Sincerely,

DEPARTMENT OF COMMUNITY PLANNING
AND DEVELOPMENT

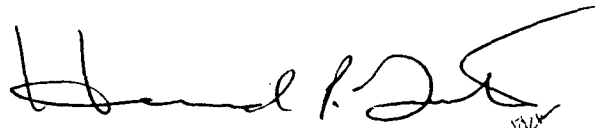
HAROLD P. FOSTER, DIRECTOR

HPF:erh



AGENDA

City of Las Vegas

April 22, 1986

PLANNING COMMISSION

Page 7

COUNCIL CHAMBERS • 400 EAST STEWART AVENUE

PHONE 386-6301

COMMISSION ACTION

ITEM

4. A-2-86(A) - WILLIAM S. BOYD, ET AL

Request for annexation of property generally located on the southeast corner of Lake Mead Boulevard and Rancho Drive, 22.06 acres.

Staff Recommendation: APPROVAL

Bugbee -
APPROVED
Unanimous
(Kennedy excused)

MR. FOSTER stated this property abuts Rancho to the west. It has County H-1 and R-E zoning and would come into the City as C-2 and N-U. Staff did not request the applicant to attend this meeting.

No one appeared to represent the application.

(7:58-7:59)



Department of
Comprehensive Planning

Zoning Division

PUBLIC SERVICES BUILDING
401 SOUTH FOURTH STREET
LAS VEGAS, NEVADA 89101
(702) 386-4314

April 16, 1986

Mr. Robert Genzer
Dept. of Community Planning/Development
400 E. Stewart Avenue
Las Vegas, NV 89101

RE: A-2-86 (A)

This is to verify that the above referenced annexation area is presently zoned as follows:

660 feet from the centerline of Rancho Drive to the East, is zoned H-2 (General Highway Frontage) District. The remainder of the property is zoned R-E (Rural Estates Residential) District.

At this time there are no pending applications.

JOYCE AVERY,
Sr. Zoning Specialist

RECEIVED
APR 18 1986
PLANNING AND
DEVELOPMENT

LAS VEGAS METROPOLITAN POLICE DEPARTMENT

MEMORANDUM

Date: 04-15-86

To : HAROLD P. FOSTER, DIRECTOR/COMMUNITY PLANNING & DEVELOPMENT
Subject : A-2-86 (A)

This department has no objections as long as this meets the requirements of the City.

O. A. STEELE, LIEUTENANT
TRAFFIC SECTION

OAS:cp



INTER-OFFICE MEMORANDUM

Date

April 10, 1986

TO: PUBLIC WORKS (DOUG PETERSON, 4th Fl.) FIRE SERVICES, ALARM OFFICE (P. LEMKE) METROPOLITAN POLICE DEPT. (TRAFFIC) ELECTRICAL SERVICES (GEORGE FERRIS)	FROM: DEPARTMENT OF COMMUNITY PLANNING AND DEVELOPMENT HAROLD P. FOSTER, DIRECTOR GV ROBERT S. GENZER PRINCIPAL PLANNER
SUBJECT: ANNEXATION - A-2-86(A) SUBMITTED BY - WILLIAM S. BOYD, ET AL.	COPIES TO: 

Please provide your comments regarding the subject Annexation Petition for property generally located:

Southeast corner of Lake Mead Boulevard and Rancho Drive

containing approximately 22.06 acres of land.

In particular, we need to know if sewer and drainage, as well as other facilities will be adequate to handle this proposed annexation. This petition for annexation will be heard at the April 22, 1986 Planning Commission meeting, so your comments would be appreciated as soon as possible.

Attached is a map for your reference.

HPF:RSG:jrm

Attachments:
Location Map

Public Works:
Location Map
Deed
Petition

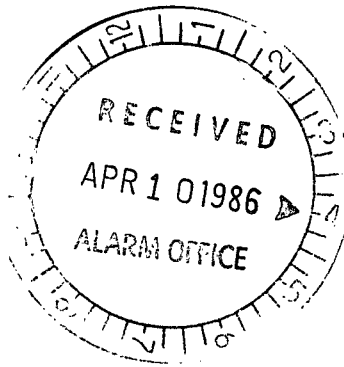

No Comment

Jim Gilbert
Planning Aide
4-10-86

CITY OF LAS VEGAS

Date _____

INTER-OFFICE MEMORANDUM

TO: DOUG PETERSON
DEPARTMENT OF PUBLIC WORKS (4TH FLOOR)

FROM: DEPARTMENT OF COMMUNITY PLANNING
AND DEVELOPMENT
HAROLD P. FOSTER, DIRECTOR
CV
ROBERT S. GENZER
PRINCIPAL PLANNER

SUBJECT: ANNEXATION
A-2-86(A) WILLIAM S. BOYD, ET AL.
REQUEST FOR LEGAL DESCRIPTION
AND SURVEY MAP

COPIES TO:
✓ C. E. GILPIN

RECEIVED
APR 14 1986
PLANNING AND
DEVELOPMENT

The above-referenced Annexation has been initiated at the request of the City of Las Vegas; therefore, please provide a proper legal description and survey map.

We would appreciate receiving this data as soon as possible in order to schedule this Annexation for first Ordinance reading.

HPF:RSG:jrm

Attachment: Location Map

*No Comment
Gil*

INTER-OFFICE MEMORANDUM

April 11, 1986

TO: PUBLIC WORKS (DOUG PETERSON, 4th Fl.) FIRE SERVICES, ALARM OFFICE (P. LEMKE) METROPOLITAN POLICE DEPT. (TRAFFIC) ELECTRICAL SERVICES (GEORGE FERRIS)	FROM: DEPARTMENT OF COMMUNITY PLANNING AND DEVELOPMENT HAROLD P. FOSTER, DIRECTOR <i>CV</i> ROBERT S. GENZER PRINCIPAL PLANNER
SUBJECT: ANNEXATION - A-2-86(A) SUBMITTED BY - WILLIAM S. BOYD, ET AL.	COPIES TO:

PLEASE NOTE - The annexation mailed to you yesterday was numbered incorrectly.
The number should have been A-2-86(A) as above.

jm

NORTH LAS VEGAS
AIR TERMINAL



RANCHO
DR.

CAREY RD.

A-2-86(A)
LAKE MEAD BLVD.

VEGAS DR.

BONANZA RD.

DECATUR BLVD.

MICHAEL WAY

VIEW BLVD.

HWY.

GSON

13

18

17

16

24

19

20

21

25

30

29

28

'N' ST

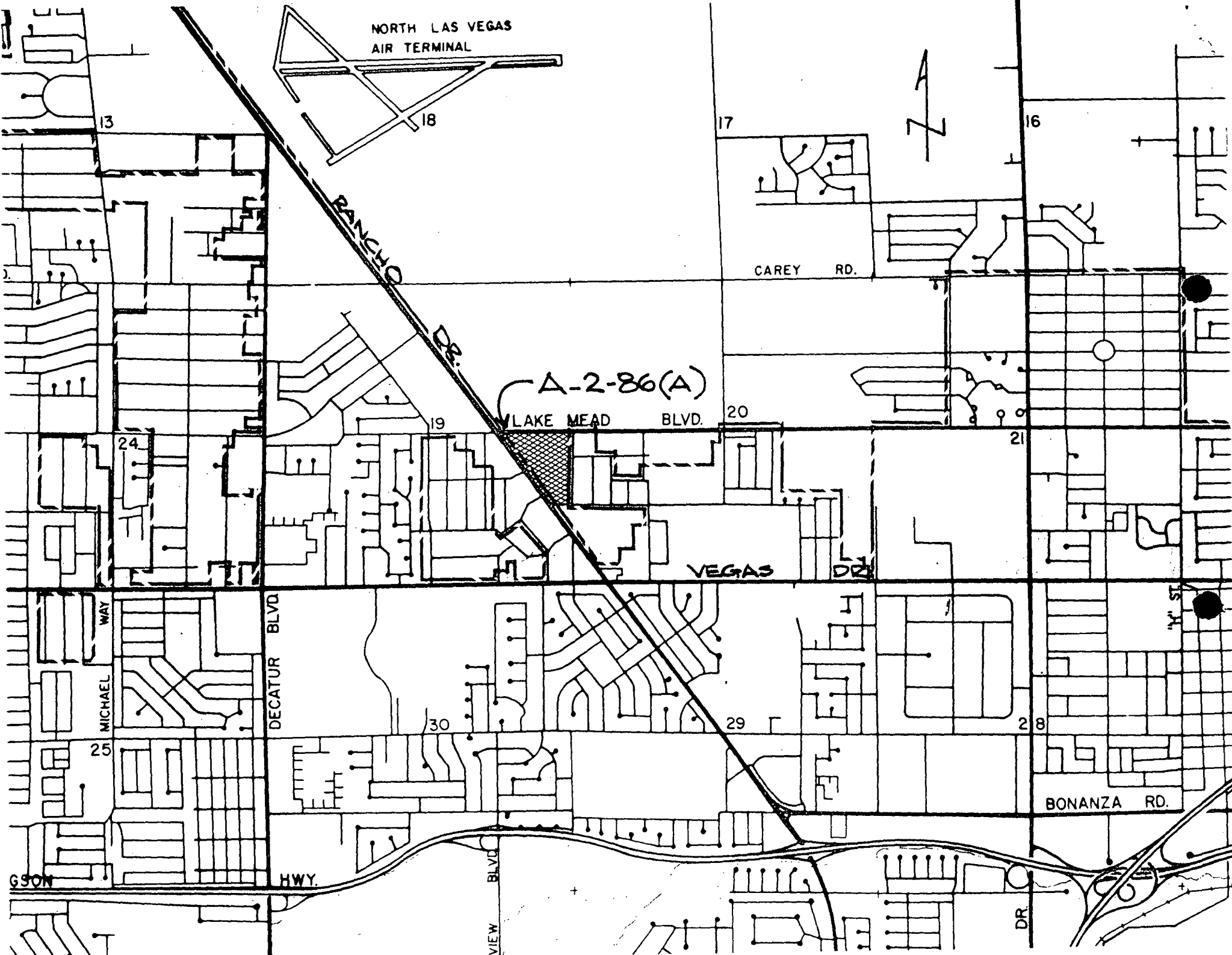

INTER-OFFICE MEMORANDUM

April 10, 1986

TO: PUBLIC WORKS (DOUG PETERSON, 4th Fl.) FIRE SERVICES (RAY PECHLES) FIRE SERVICES, ALARM OFFICE (P. LEMKE) METROPOLITAN POLICE DEPT. (TRAFFIC) ELECTRICAL SERVICES (GEORGE FERRIS)	FROM: DEPARTMENT OF COMMUNITY PLANNING AND DEVELOPMENT HAROLD P. FOSTER, DIRECTOR GV ROBERT S. GENZER PRINCIPAL PLANNER
SUBJECT: ANNEXATION - A-1-86(A) SUBMITTED BY - WILLIAM S. BOYD, ET AL.	COPIES TO:

Please provide your comments regarding the subject Annexation Petition for property generally located:

Southeast corner of Lake Mead Boulevard and Rancho Drive

containing approximately 22.06 acres of land.

In particular, we need to know if sewer and drainage, as well as other facilities will be adequate to handle this proposed annexation. This petition for annexation will be heard at the April 22, 1986 Planning Commission meeting, so your comments would be appreciated as soon as possible.

Attached is a map for your reference.

HPF:RSG:jrm

Attachments:
 Location Map

Public Works:
 Location Map
 Deed
 Petition

CITY OF LAS VEGAS

Date

INTER-OFFICE MEMORANDUM

TO: DOUG PETERSON
DEPARTMENT OF PUBLIC WORKS (4TH FLOOR)

FROM: DEPARTMENT OF COMMUNITY PLANNING
AND DEVELOPMENT
HAROLD P. FOSTER, DIRECTOR
CS
ROBERT S. GENZER
PRINCIPAL PLANNER

SUBJECT: ANNEXATION
A-2-86(A) WILLIAM S. BOYD, ET AL.
REQUEST FOR LEGAL DESCRIPTION
AND SURVEY MAP

COPIES TO:
C. E. GILPIN

The above-referenced Annexation has been initiated at the request of the City of Las Vegas; therefore, please provide a proper legal description and survey map.

We would appreciate receiving this data as soon as possible in order to schedule this Annexation for first Ordinance reading.

HPF:RSG:jrm

Attachment: Location Map

MAYOR BILL BRIARE

COUNCILMEN
RON LURIE
AL LEVY
BOB NOLEN
W. WAYNE BUNKER

CITY ATTORNEY
GEORGE F. OGILVIE

CITY MANAGER
ASHLEY HALL

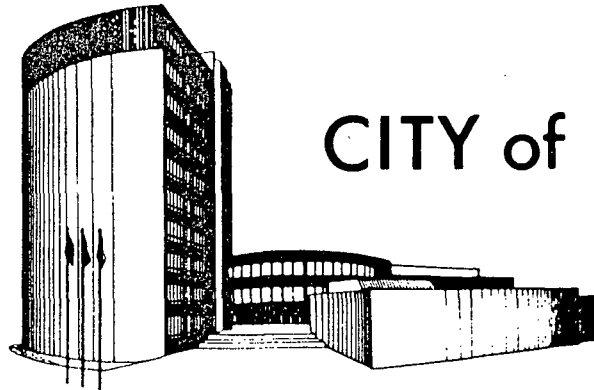

CITY of LAS VEGAS

April 10, 1986

Susan French Neiry
Clark County Comprehensive Planning
Bridger Building, 7th Floor
225 Bridger Avenue
Las Vegas, Nevada 89155

RE: ANNEXATION - A-2-86(A)

Dear Ms. Neiry:

Attached is a location map for a new annexation request, A-2-86(A),
submitted by William S. Boyd, et al.

We are forwarding this for your information only, as per your request.

Sincerely,

DEPARTMENT OF COMMUNITY PLANNING
AND DEVELOPMENT
HAROLD P. FOSTER, DIRECTOR

ROBERT S. GENZER
PRINCIPAL PLANNER

HPF:RSG:jrm

Attachment: Location Map



MAYOR BILL BRIARE

COUNCILMEN
RON LURIE
AL LEVY
BOB NOLEN
W. WAYNE BUNKER

CITY ATTORNEY
GEORGE F. OGILVIE

CITY MANAGER
ASHLEY HALL

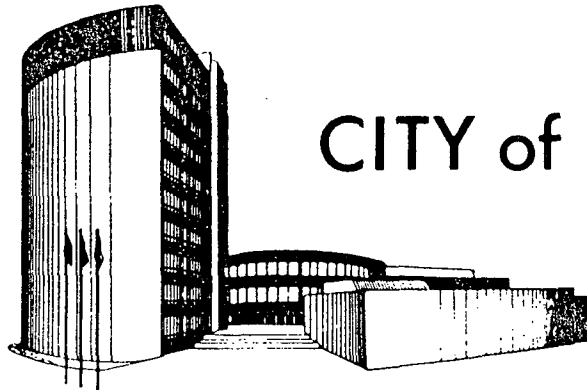

CITY of LAS VEGAS

April 10, 1986

ANNEXATION TRANSMITTAL

Mr. Greg Borgel, Zoning Coordinator
Clark County Department of
Building and Zoning
401 South Fourth Street
Las Vegas, Nevada 89101

RE: Annexation A-2-86(A) WILLIAM S. BOYD, ET AL.

Dear Mr. Borgel:

An annexation request has been submitted to the City of Las Vegas on property generally located on the southeast corner of Lake Mead Boulevard and Rancho Drive

containing approximately 22.06 acres

Please advise us of the present zoning for this property, as well as any resolutions of intent that have been approved, giving the zoning case number and date of expiration.

Attached is a copy of the location map for your reference.

We would appreciate receiving this information at your earliest convenience.

Sincerely,

DEPARTMENT OF COMMUNITY PLANNING
AND DEVELOPMENT
HAROLD P. FOSTER, DIRECTOR

ROBERT S. GENZER
PRINCIPAL PLANNER

HPF:RSG:jrm

Attachment: Location Map



RECEIVED

PETITION FOR ANNEXATION

TO THE HONORABLE WILLIAM H. BRIARE,
MAYOR OF THE CITY OF LAS VEGAS, NEVADA

APR 9 2 55 PM '86
1985
Carl A. Harty
CITY CLERK

and

BOARD OF COUNCILMEN OF THE CITY OF LAS VEGAS, NEVADA

Gentlemen:

The undersigned, being owners of real property situate within the boundaries of the territory hereinafter described, do hereby petition your honorable Board to annex and include within the corporate limits of the City of Las Vegas, Nevada, pursuant to the provisions of the Nevada Revised Statutes 268.570-268.608 inclusive, the territory being more particularly described as follows: to-wit:

A portion of the Northeast Quarter of the Southeast Quarter of Section 19, Township 20 South, Range 61 East, M.D.M., Clark County, Nevada.

NO. OF ACRES TO BE ANNEXED: 22.06

GENERAL LOCATION OF ANNEXATION AREA: Southeast Corner of Lake Mead
Boulevard and Rancho Drive

Respectfully submitted,

NAME (Print)

SIGNATURE:

William S. Boyd ETAL

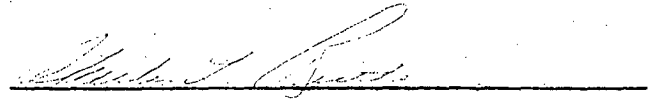

ADDRESS: 801 S. Rancho Drive C-1

TELEPHONE #: 302-4411

Las Vegas, NV 89103

300-290-004

**Additional property owners may sign on an attached sheet.

A copy of the Deed of Ownership is required.

HAN:jk

A-2-86 (A)

Deferred

GRANT, BARGAIN, SALE DEED

THIS INDENTURE WITNESSETH: That ELDA CLARK CRANE, a widow

in consideration of \$ 10.00 the receipt of which is hereby acknowledged, do hereby Grant, Bargain, Sell and Convey to WILLIAM S. BOYD, a married man, as to an undivided 20% interest, SAM A. BOYD, Trustee of the Sam A. Boyd Family Trust dated May 4, 1978 as to an undivided 20% interest **

all that real property situate in the _____ County of Clark
State of Nevada, bounded and described as follows:

That portion of the Southeast Quarter (SE 1/4) of Section 19, Township 20 South, Range 61 East, M.D.B. & M., lying North and East of the U. S. Highway No. 95, and more particularly described as follows:

BEGINNING at the East Quarter corner of said Section 19; thence South 89°55' West along the North boundary of said Quarter Section 1284.2 feet to a point in the Northerly right-of-way line of said Highway 95; thence South 35°11' East a distance of 1620.6 feet to the Northwest corner of that certain parcel of land conveyed by JAMES A CRANE, et ux, to D. G. RICHARDSON by Deed recorded November 16, 1948 as Document No. 300188, Clark County, Nevada records; thence North 89°20'50" East along the North line of the said conveyed parcel a distance of 326.63 feet to a point on the East line of said Section 19; thence North 1°28' East a distance of 1301.82 feet more or less to the POINT OF BEGINNING.

EXCEPTING THEREFROM the North 30 feet, the East 30 feet and the South 30 feet of said land as granted to the County of Clark for road and incidental purposes by Document No. 85257 recorded August 1, 1956 in Book 103 of Official Records, Clark County, Nevada.

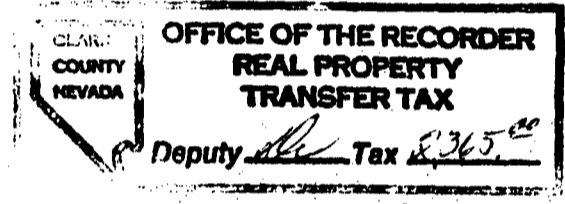

- SUBJECT TO:
1. Taxes for the current fiscal year.
 2. Reservations, restrictions, conditions, rights of way and easements of record.

**LUD J. CORRAO and PATRICIA A. CORRAO, Husband and wife as joint tenants as to an undivided 20% interest, CALIFORNIA HOTEL & CASINO, a Nevada Corporation, as to an undivided 20% interest, PERRY B. WHITT and ARMINTA WHITT, as Trustees under Trust Agreement dated January 8, 1979, as to an undivided 10% interest, WARREN L. NELSON and NORMA K. NELSON as Trustees of the Warren L. and Norma K. Nelson 1979 Living Trust, as to an undivided 5% interest, and CHARLES L. RUTHE and JOANNE M. RUTHE, Trustees of the Charles L. Ruthe and Joanne M. Ruthe Family Trust dated January 19, 1979, as to an undivided 5% interest

Together with all and singular the tenements, hereditaments and appurtenances thereunto belonging or in anywise appertaining.

Witness my hand this 25th day of January, 1982
Elda Clark Crane
Elda Clark Crane

STATE OF NEVADA }
County of Clark } ss.
On this 25th day of January, 1982,
personally appeared before me, a Notary Public in and for said
County and State, _____
Elda Clark Crane

Known to me to be the person described in and who executed the foregoing instrument, who acknowledged to me that s/he executed the same freely and voluntarily and for the uses and purposes therein mentioned.

Nancy S. Wilder
Notary Public in and for said County and State.

NANCY S. WILDER
Notary Public - State of Nevada
CLARK COUNTY

ESCROW NO. 93088 NW
WHEN RECORDED MAIL TO: William S. Boyd, et al, c/o 801 So. Rancho Rd., Las Vegas, Nv. 89102

CLARK COUNTY NEVADA
JOAN L. SWIFT, RECORDER
RECORDED AT REQUEST OF
LAWYERS TITLE OF LAS VEGAS, INC.
JAN 25 11 45 AM '82
FEE 4.00 DEPUTY DR
OFFICIAL RECORDS
BOOK INSTRUMENT