

--- PAVEMENT LINE

RESIDENTIAL CHILDREN'S PROGRAM FOR 116
DESIGNED FOR
PHYSICALLY HANDICAPPED
(2000 S.F.)

--- PLAY AREA

GENERAL PURPOSE, ASSEMBLY
AND TEACHING FACILITIES (7000 S.F.)

ADMINISTRATION
(2000 S.F.)

SHOWING 80'± SERVICE OR 11000 S.F. OF STRUCTURE

RESIDENTIAL ADULT PROGRAM FOR 93 DESIGNED FOR LIGHT MENTALLY (2000 S.F.)

NO SIGNAGE IN THIS ZONE SHOULD NOT EXCEED 10% OF LENGTH OF PROPERTY
- ON STREET WITH NO WINDOWS OR OPENINGS WITHIN 10' OR 10' REFRANCE WITH 10' SET BACK AT FUTURE STREET -

ON 4047 AVENUE

THIS PROJECT SHALL INCLUDE
A FULLY DEVELOPED LANDSCAPE DESIGN

10' SETBACK

10' SETBACK



Play Area

Handwritten notes and scribbles on the right side of the plan, including the word 'Play Area' written vertically.

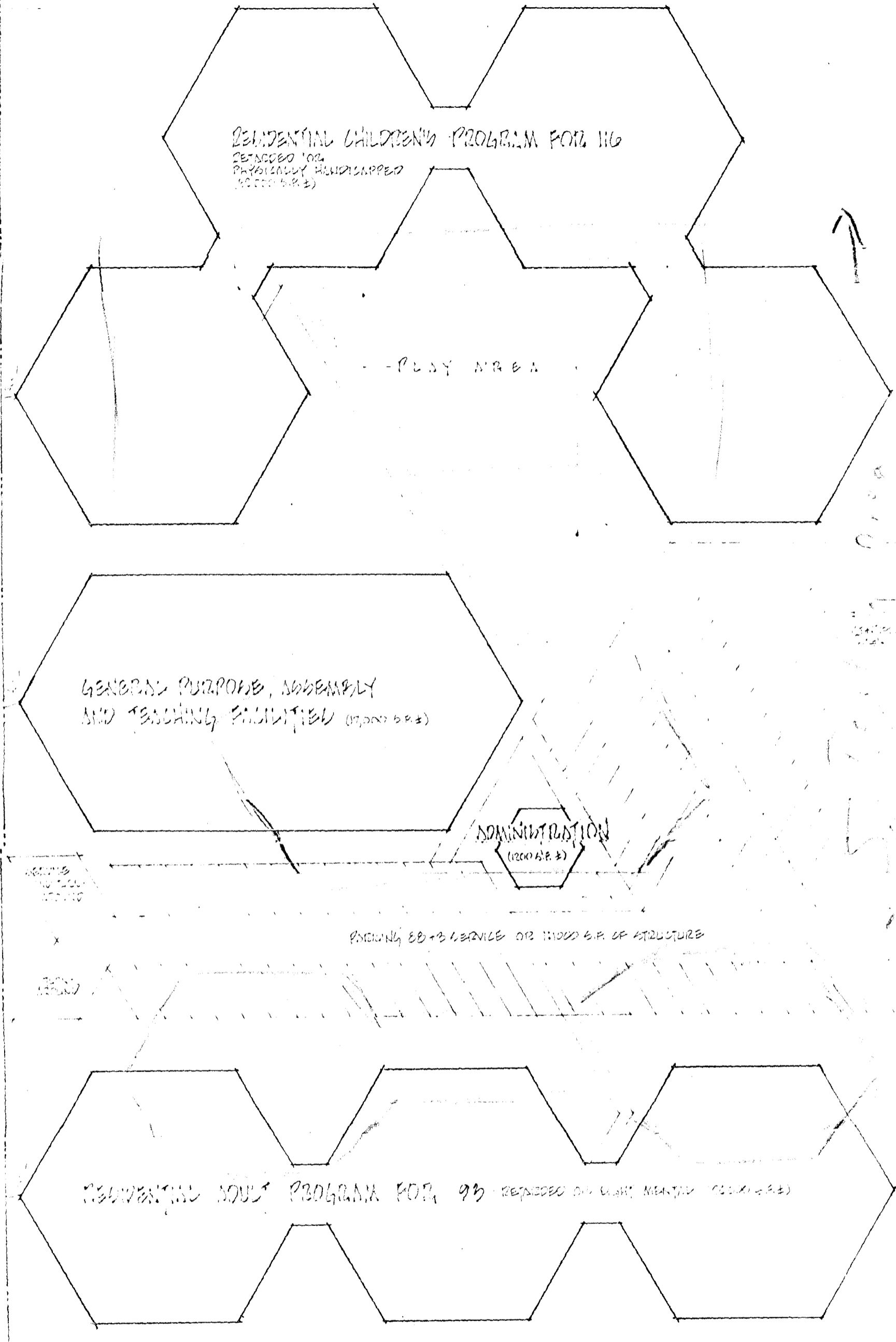

200000 200000

250000

FUTURE DEVELOPMENT

FUTURE STREET (600000)

NORTH
115.000'



PORTION TO BE DEVELOPED

54450'

12000'

13000'

DAISY AVENUE

ALL OWNED PROPERTY
AND SUBJECT PROPERTY
IN DEVELOPMENT