

SCALE: 1" = 40' HORIZ.
1" = 4' VERT.

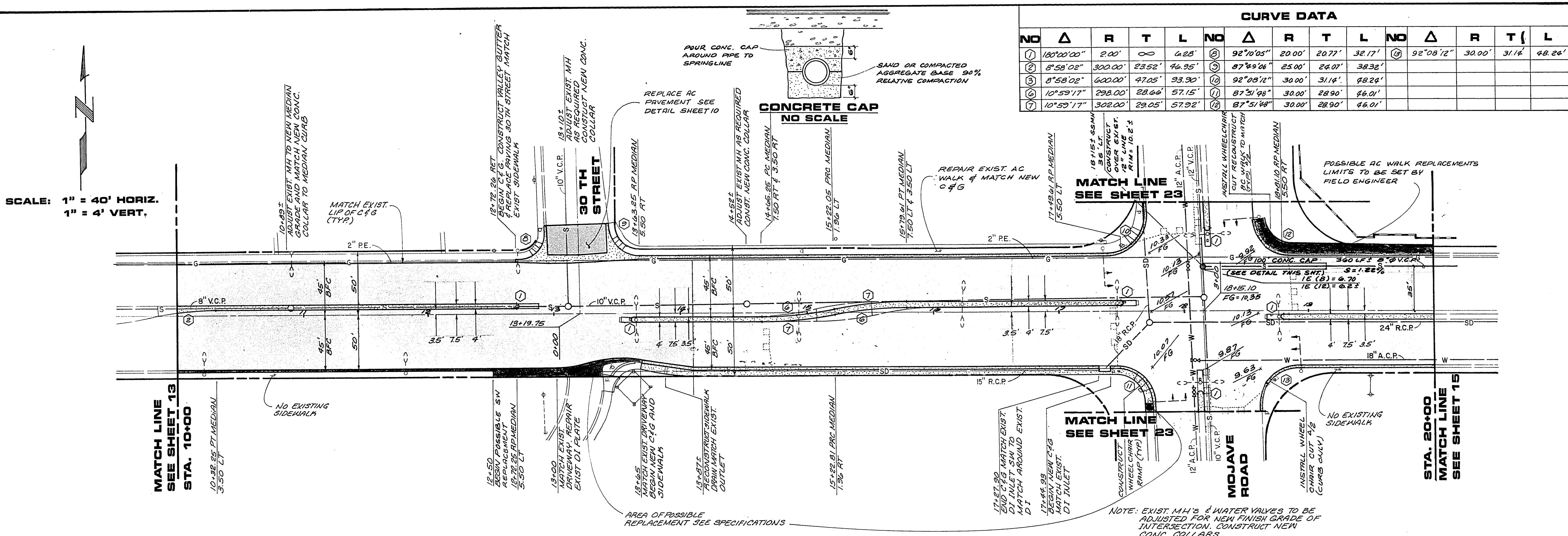

CURVE DATA														
NO	Δ	R	T	L	NO	Δ	R	T	L	NO	Δ	R	T	L
1	180°00'00"	200'	∞	625'	8	92°10'05"	20.00'	20.77'	32.17'	9	92°08'12"	30.00'	31.14'	48.24'
2	8°58'02"	300.00'	23.52'	46.95'	9	87°49'06"	25.00'	24.07'	38.32'					
3	8°58'02"	600.00'	47.05'	93.90'	10	92°08'12"	30.00'	31.14'	48.24'					
4	10°59'17"	298.00'	28.66'	57.15'	11	87°31'48"	30.00'	28.90'	46.01'					
5	10°59'17"	302.00'	29.05'	57.92'	12	87°51'48"	30.00'	28.90'	46.01'					

REVISIONS

NO.	DESCRIPTION/DATE	BY
1	TC CHANGE 2/2/84	

8/4/84

SPARKS, NEVADA
LAS VEGAS, NEVADA
SEATTLE, WASHINGTON

incorporated

SEA
ENGINEERS/PLANNERS

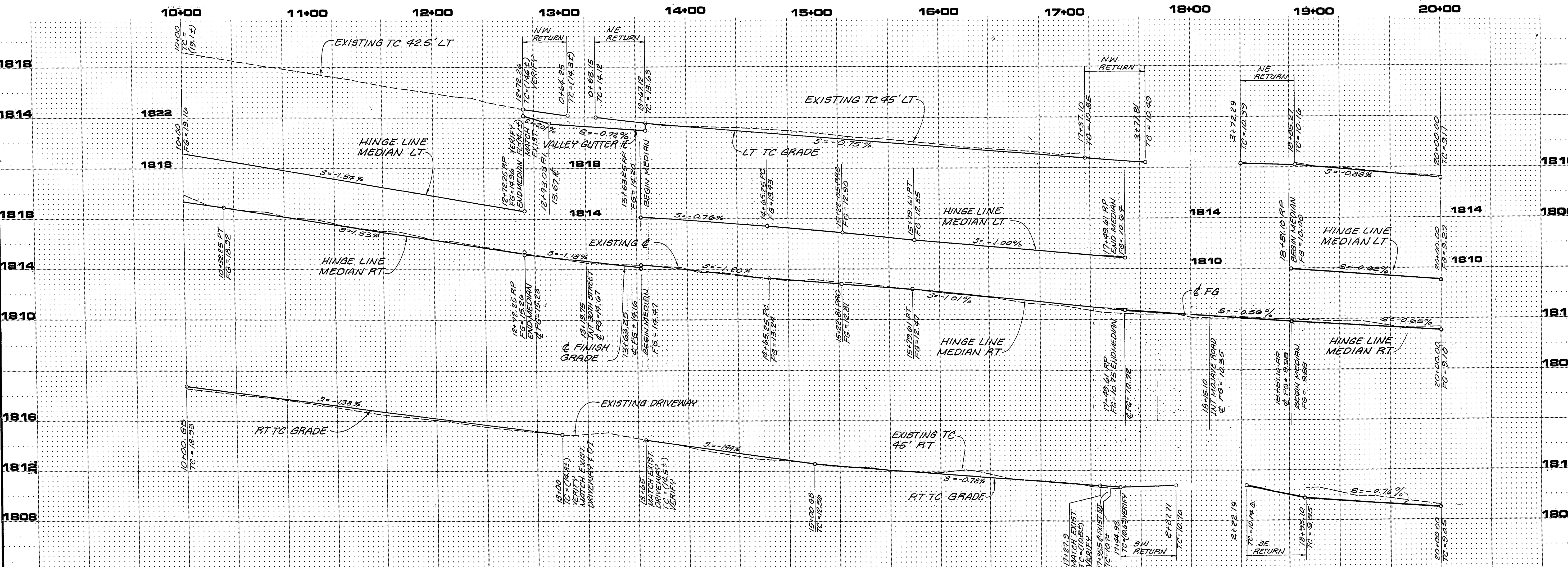

CITY OF LAS VEGAS
STEWART AVENUE
28TH STREET TO NELLIS BOULEVARD
RECONSTRUCTION PLAN & PROFILE
10+00 TO 20+00

JOB NO. 2-241-005-821
DESIGNED KA
DRAWN JR
COMP.
CHECKED
DATE FEBRUARY, 1984
SHEET NO.

14

15 OF 47 SHEETS

164-26 107-VB19C