

SCALE: 1"=40' HORIZ.
1"=4' VERT.

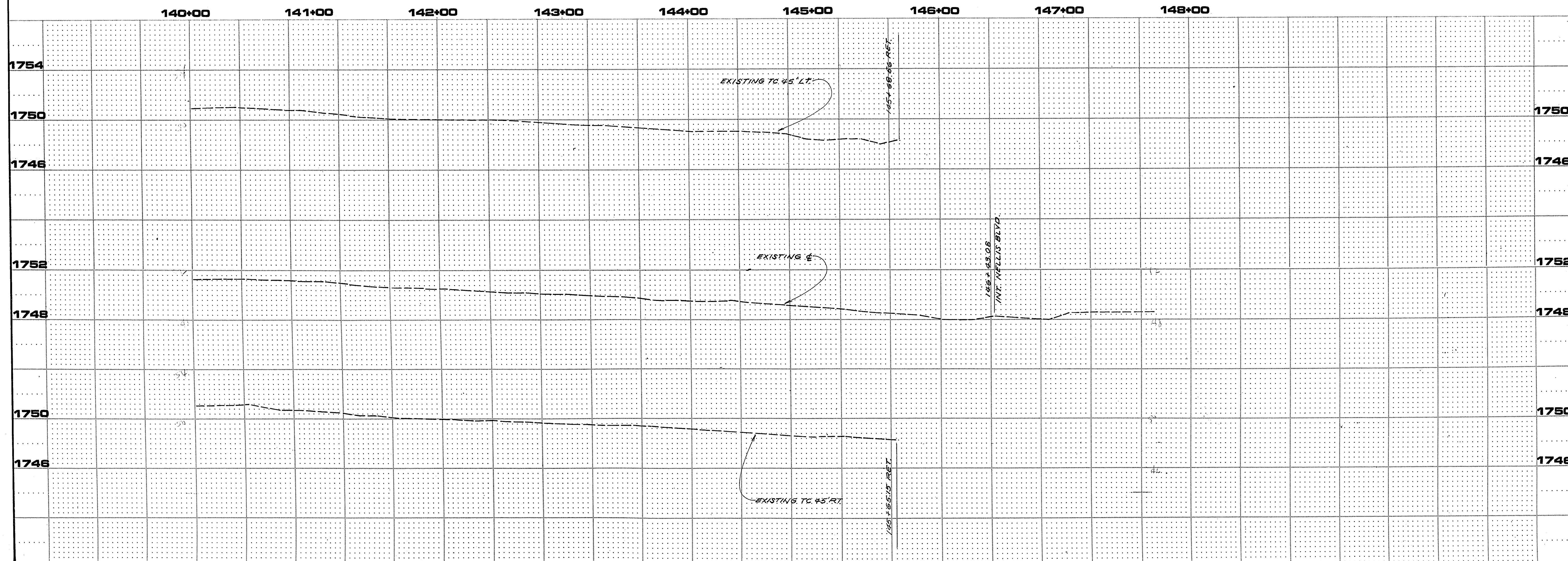

REVISIONS		
NO.	DESCRIPTION/DATE	BY

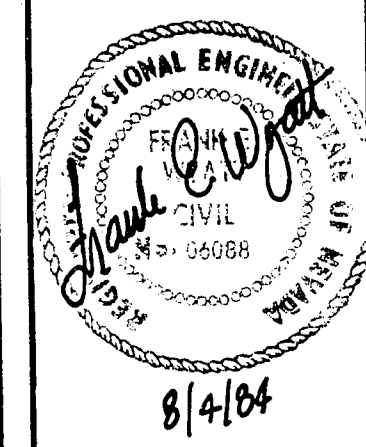

SPARKS, NEVADA
LAS VEGAS, NEVADA
SEATTLE, WASHINGTON
ENGINEERS/PLANNERS

CITY OF LAS VEGAS
STEWART AVENUE
28TH STREET TO NELLIS BOULEVARD
REPAIR PLAN & PROFILE
140+00 TO 146+43

JOB NO. 2-241-005-821
DESIGNED KA
DRAWN ARC
COMP.
CHECKED
DATE FEBRUARY, 1984
SHEET NO.
29
30 OF 47 SHEETS

16-4-43 107-V819C