

MATCH EXIST. STRIPING

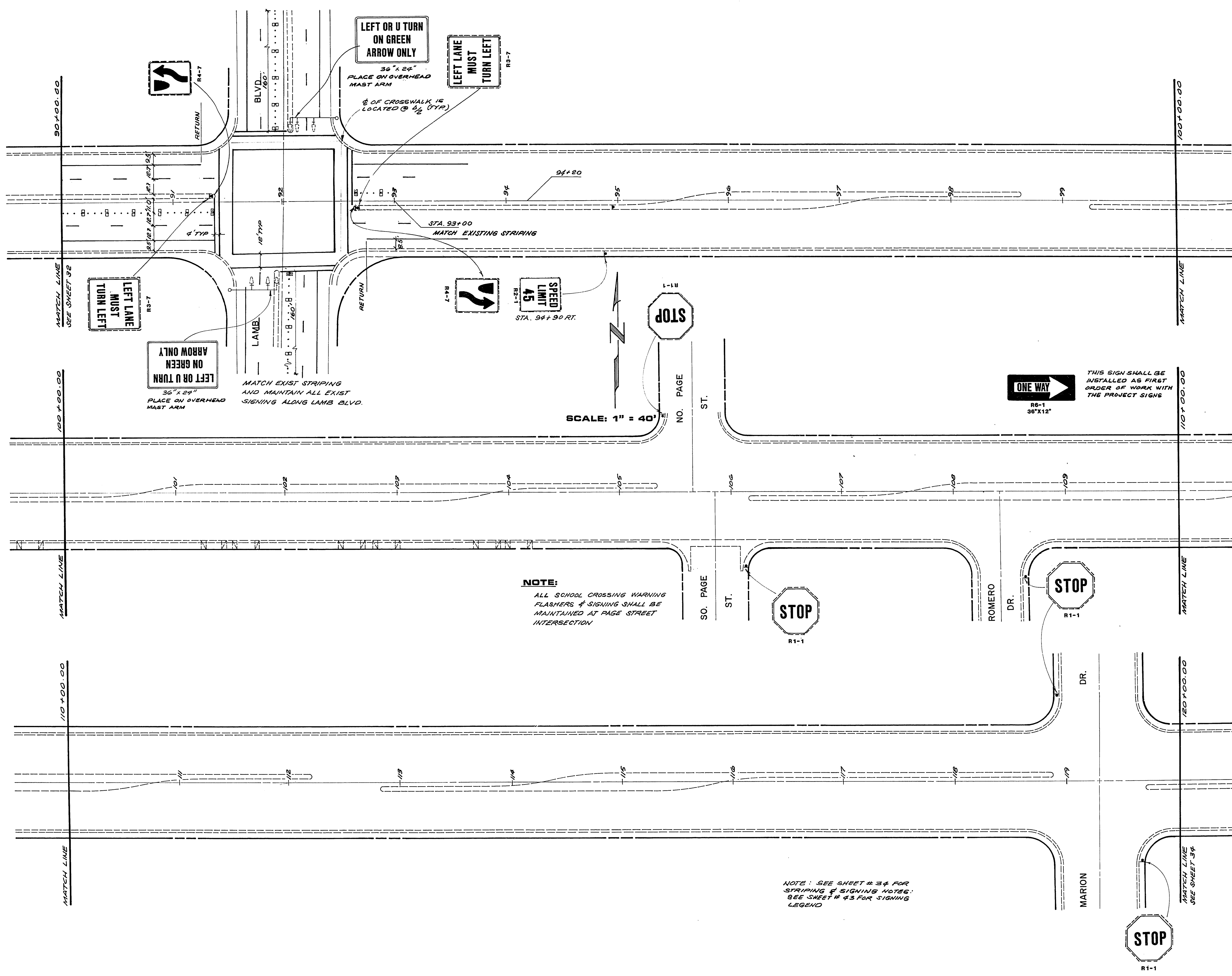

LEFT LANE MUST TURN LEFT

LEFT OR U TURN ON GREEN ARROW ONLY

LEFT OR U TURN ON GREEN ARROW ONLY

LEFT LANE MUST TURN LEFT

SPEED LIMIT 45

STOP

ONE WAY

STOP

STOP

NOTE:
 ALL SCHOOL CROSSING WARNING FLASHERS & SIGNING SHALL BE MAINTAINED AT PAGE STREET INTERSECTION

NOTE: SEE SHEET # 34 FOR STRIPING & SIGNING NOTES. SEE SHEET # 43 FOR SIGNING LEGEND

SCALE: 1" = 40'

THIS SIGN SHALL BE INSTALLED AS FIRST ORDER OF WORK WITH THE PROJECT SIGNS

REVISIONS		
NO.	DESCRIPTION/DATE	BY

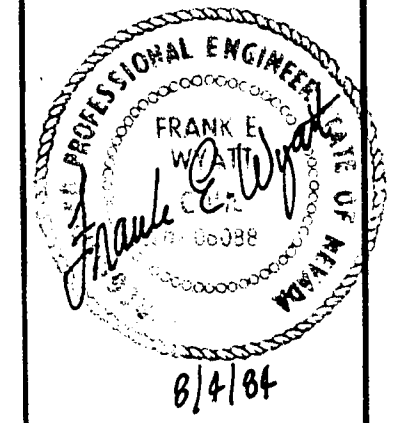

SPARKS, NEVADA
 LAS VEGAS, NEVADA
 SEATTLE, WASHINGTON
 ENGINEERS/PLANNERS

CITY OF LAS VEGAS
STEWART AVENUE
 28TH STREET TO NELLIS BOULEVARD
STRIPING AND SIGNING PLAN
 90+00 TO 94+40

JOB NO. 2-241-005-821
DESIGNED KA
DRAWN AC
COMP.
CHECKED
DATE FEBRUARY, 1984

33

34 OF 47 SHEETS

BRUNING 44132

16-0-47 107-VB19C