

SPECIFIC TRAFFIC SIGNAL NOTES
CITY OF LAS VEGAS
INTERSECTION OF OGDEN AVE. & 7TH STREET

1. THE CONTRACTOR SHALL INSTALL CROSSWALKS (STRIPE WIDTH = 12"), STOP BARS (STRIPE WIDTH = 24") AND SIGNS AS IDENTIFIED ON THE PLANS. SEE USD NO. 254. REMOVE THE EXISTING PAINTED CROSSWALK AND PREPARE THE PLANTMIX SURFACE OF THE STOP BARS BY SAND BLASTING. PLACE TYPE I FILM CROSSWALK IN PLACE OF THE EXISTING PAINTED CROSSWALK. (SEE SHEET 4/6).

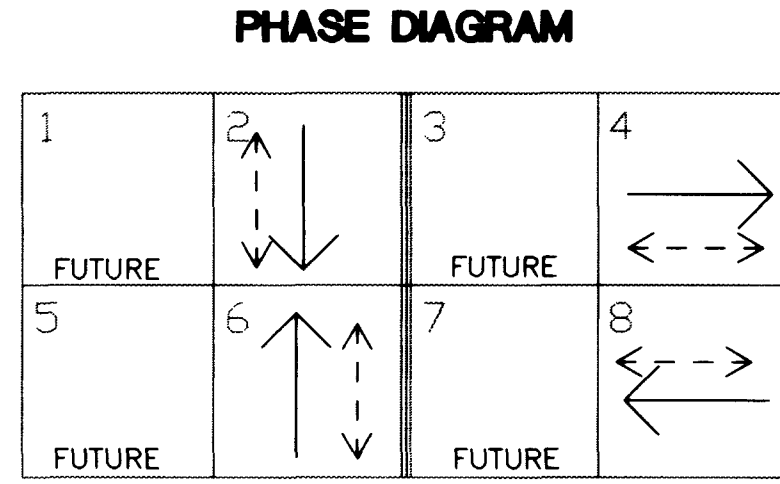

CONFLICT FLASH SHALL BE ALL RED.

PLACE ALL NEW SIGNAL POLES OUT OF SIDEWALK AREA, OR WIDEN SIDEWALK TO PROVIDE 5' PEDESTRIAN PATH.

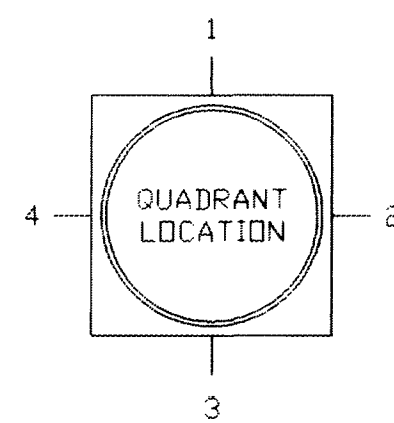

SIGN SCHEDULE		
POLE	INTERNALLY ILLUMINATED STREET NAME SIGN**	BLOCK NUMBER SIGN LEGEND
A	OGDEN	E 700
B	7th ST.	S 100
C	OGDEN	E 600
D	7th ST.	S 200

SEE USD NO. 404.417 AND NO. 404.420. BLOCK NUMBER SIGN TO BE CENTERED ON ILLUMINATED STREET NAME SIGN. **SIGNS TO BE 6-FOOT WIDE.

FOR THE BLOCK NO. SIGN SUPPORT, USE "SIGNFIX" CANTILEVER SIGN SYSTEM WITH "V-BACK" OR EQUIVALENT. THE SUPPORTS ARE TO BE THE ENTIRE LENGTH OF THE SIGN, TOP AND BOTTOM.

THE MANUFACTURER OF SIGNFIX CANTILEVER SIGN SYSTEMS CAN BE LOCATED AT:

BAND-IT - IDEX, INC.
 A Unit of IDEX Corporation
 P.O. Box 16307
 Denver, Colorado 80216-0307 USA
 Ph: 303-320-4555
 FAX: 303-333-6549

WIRE & CABLE		FROM	TO	VIA CONDUIT													
				1	2	3	4	5	6	7	8	9	10	11	12	13	14
3 #4, 1 #8	SERVICE PEDESTAL	CONTROLLER		X													
25C #14	CONTROLLER	POLE B			X	X											
VIDEO	CONTROLLER	POLE B			X	X											
OPTICOM	CONTROLLER	POLE B			X	X											
2#10,#8GND.	CONTROLLER	POLE B			X	X											
MICROWAVE CABLES	CONTROLLER	POLE A		X	X			X									
25C #14	CONTROLLER	POLE A		X	X			X									
VIDEO	CONTROLLER	POLE A		X	X			X									
OPTICOM	CONTROLLER	POLE A		X	X			X									
2#10,#8GND.	CONTROLLER	POLE A		X	X			X									
25C #14	CONTROLLER	POLE C		X		X				X							
VIDEO	CONTROLLER	POLE C		X		X				X							
2#10,#8GND.	CONTROLLER	POLE C		X		X				X							
25C #14	CONTROLLER	POLE D		X	X		X	X									
VIDEO	CONTROLLER	POLE D		X	X		X	X									
2#10,#8GND.	CONTROLLER	POLE D		X	X		X	X									
3 #3/0 AWG THW	HP POLE	SVC. PED.	X														
FUTURE STREET LIGHT CONDUIT	#5 PB W/PULL STRING	#3.5 PB										X					
FUTURE STREET LIGHT CONDUIT	#3.5 PB W/PULL STRING	#3.5 PB										X					
FUTURE STREET LIGHT CONDUIT	#5 PB W/PULL STRING	EXIST PB										X					
FUTURE STREET LIGHT CONDUIT	SERVICE W/PULL STRING	#3.5 PB										X					
NO. - SIZE OF CONDUIT				1-3	1-2	1-5	3-1	1-3	1-3	1-3	1-2	1-2	1-2	1-2	1-2	1-2	1-2

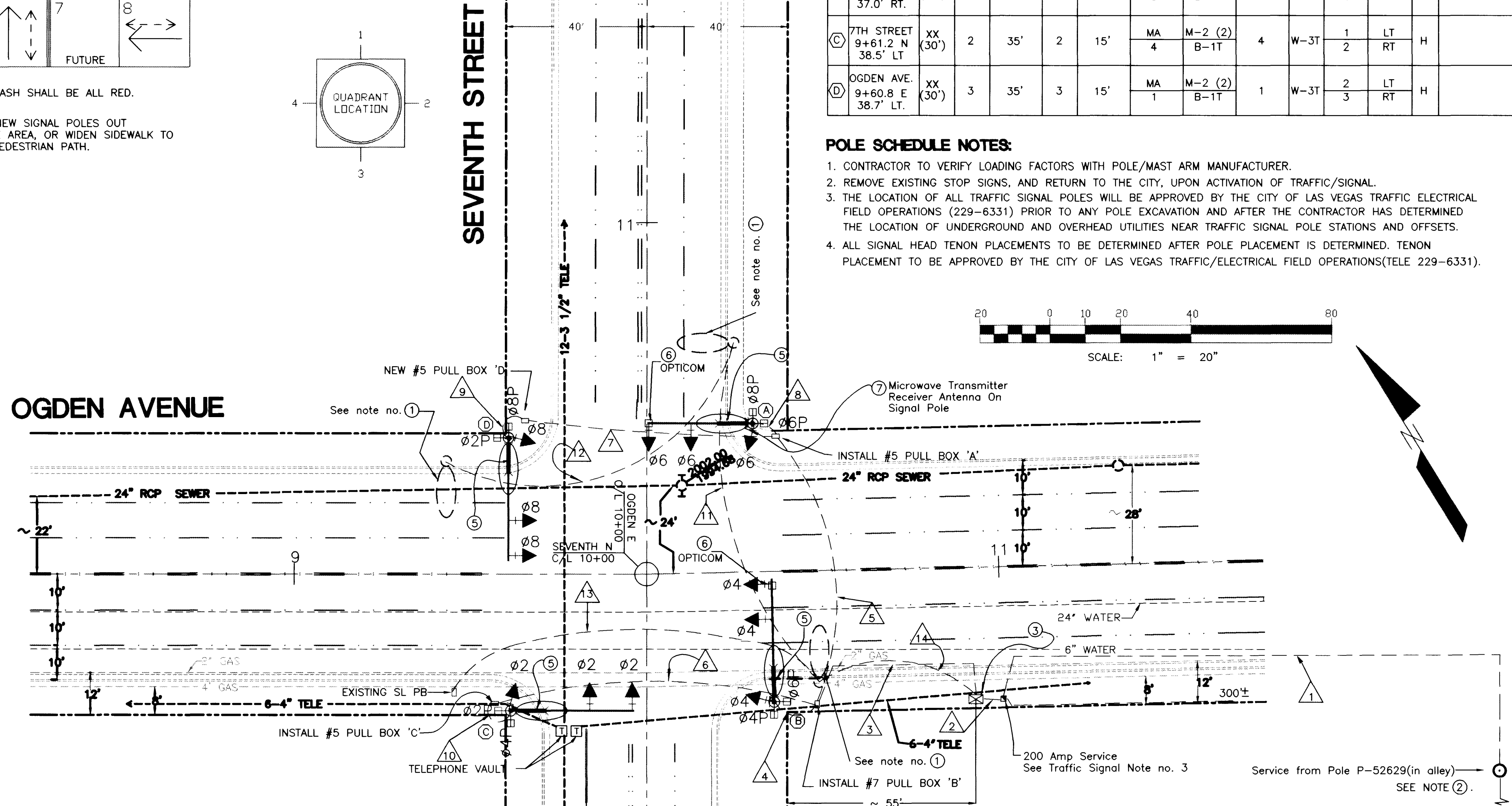

POLE SCHEDULE												
NO.	STATION	TYPE	POLE		SIGNALS (VIB)		SIGNALS (PED)		PUSHBUTTON		REMARKS	
			SIGNAL ARM QUAD.	LLUM. ARM QUAD.	QUAD.	TYPE	QUAD.	TYPE	QUAD.	ARROW		
A	7TH STREET 10+42.9 N 33.1' RT.	XX (30')	4	30'	4	15'	MA 2	M-2 (2) B-1T	2	W-3T	3 4 LT RT	H
B	OGDEN AVE. 10+35.5 E 37.0' RT.	XX (30')	1	35'	1	15'	MA 3	M-2 (2) B-1T	3	W-3T	4 1 LT RT	H
C	7TH STREET 9+61.2 N 38.5' LT	XX (30')	2	35'	2	15'	MA 4	M-2 (2) B-1T	4	W-3T	1 2 LT RT	H
D	OGDEN AVE. 9+60.8 E 38.7' LT.	XX (30')	3	35'	3	15'	MA 1	M-2 (2) B-1T	1	W-3T	2 3 LT RT	H

POLE SCHEDULE NOTES:

- CONTRACTOR TO VERIFY LOADING FACTORS WITH POLE/MAST ARM MANUFACTURER.
- REMOVE EXISTING STOP SIGNS, AND RETURN TO THE CITY, UPON ACTIVATION OF TRAFFIC/SIGNAL.
- THE LOCATION OF ALL TRAFFIC SIGNAL POLES WILL BE APPROVED BY THE CITY OF LAS VEGAS TRAFFIC ELECTRICAL FIELD OPERATIONS (229-6331) PRIOR TO ANY POLE EXCAVATION AND AFTER THE CONTRACTOR HAS DETERMINED THE LOCATION OF UNDERGROUND AND OVERHEAD UTILITIES NEAR TRAFFIC SIGNAL POLE STATIONS AND OFFSETS.
- ALL SIGNAL HEAD TENON PLACEMENTS TO BE DETERMINED AFTER POLE PLACEMENT IS DETERMINED. TENON PLACEMENT TO BE APPROVED BY THE CITY OF LAS VEGAS TRAFFIC/ELECTRICAL FIELD OPERATIONS(TELE 229-6331).

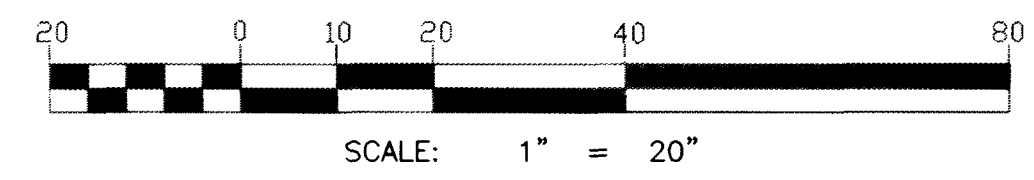

CONSTRUCTION NOTES:

- REMOVE EXISTING STREET LIGHT. REMOVE EXISTING FOUNDATION 18" MINIMUM BELOW FINISHED GRADE. CUTOFF ANCHOR BOLTS FLUSH WITH FOUNDATION. INSTALL NO. 3 1/2 PULL BOX OVER CONDUITS, EXCEPT IN THE SOUTHEAST CORNER, INSTALL A NO. 5 PULL BOX OVER CONDUITS. STREET LIGHT CONTINUITY MUST BE MAINTAINED AT ALL TIMES. ALL SALVAGE MATERIAL MUST BE RETURNED TO 3104 EAST BONANZA. CALL BEFORE RETURNING 229-6331
- CONTRACTOR NEEDS TO CONTACT NEVADA POWER TO VERIFY THE EXACT SERVICE TIE IN LOCATION. THE CONTRACTOR IS TO PROVIDE THE CONDUIT WITH ELBOW AND RISER AT THE BASE OF THE POLE. THE CONDUCTORS ARE TO CONTINUE (NO SPLICES) A LENGTH UP THE POLE TO TIE INTO THE SECONDARY POWER. THE CONTRACTOR IS TO COORDINATE THE INSTALLATION OF THE CONDUCTORS WITH NEVADA POWER AND THEIR "U SHAPED" CONDUCTOR COVER.
- INSTALL 80 CONTROLLER IN TYPE 'R' CABINET ACCORDING TO USS. INSTALL CABINET NEXT TO R.O.W. LINE. INSTALL 'R' CONTROLLER CABINET ACCORDING TO USD NO. 404.307.
- INSTALL SIGNS PER SIGN SCHEDULE.
- THE VIDEO DETECTION SYSTEM WILL BE VIDEOTRAC 900 OR AUTOSCOPE 2004. EACH VIDEO CAMERA WILL HAVE POWER (3 -#14 S/O CORD) AND 8281 COAXIAL CABLE DIRECTLY FROM THE CABINET. CAMERAS WILL BE MOUNTED ON THE TOP MOST POINT OF THE LUMINAIRE ARM. "BNC" CONNECTORS ARE THE ONLY ACCEPTABLE TERMINATION OF CABLES.
- THE CONTRACTOR SHALL PROVIDE AND INSTALL EMERGENCY VEHICLE PRE-EMPTION EQUIPMENT FOR FIRE PRE-EMPTION AS SPECIFIED IN THE CONTRACT BID DOCUMENTS, INSTALLATION OF EQUIPMENT IS CONSIDERED PART OF THE CONTROLLER EQUIPMENT. THE OPTICAL DETECTORS SHALL BE MOUNTED ON TOP OF THE SIGNAL HEAD (SEE PLANS).
- THIS INTERSECTION WILL BE CONNECTED TO THE LVACTS SYSTEM VIA MICROWAVE LINK FROM OGDEN AND 6TH STREET. THE MICROWAVE TRANSMITTER-RECEIVER ANTENNA FOR OGDEN AND 7TH WILL BE MOUNTED ON SIGNAL POLE "A". THE CONTRACTOR IS ALSO RESPONSIBLE TO PROVIDE AND INSTALL TRANSMITTER-RECEIVER AND INTERFACE MODULE ON THE SOUTHWEST CORNER AT OGDEN AND 6TH STREET. THE MODULES WILL BE MOUNTED USING THE MANUFACTURERS MOUNTING BRACKET WITH METAL BAND-IT STRAPS (SINGLE WRAP). THE ACTUAL MOUNTING LOCATIONS WILL BE SUBJECT TO LINE-OF-SIGHT CONDITIONS AND PRIOR APPROVAL BY CITY OF LAS VEGAS, TRAFFIC/ELECTRICAL FIELD OPERATIONS(TELE 229-6331).

DATE: _____

REVISIONS: _____

SCALE (H) 1"=20'

SCALE (V) 1"=20'

W.A. # _____

DESIGN BY J.L.C.

DATE MAY 1997

ENGINEERING DESIGN SECTION

CITY ENGINEER: DENNIS ANDERSON, P.E.

PROJECT MANAGER: JOE L. CHRISTENSEN, P.E.

DEPARTMENT OF PUBLIC WORKS

PROJECT: **BID NO. 97.1730.22-RH**

SHEET: **TRAFFIC SIGNAL PLAN**

OGDEN AND 7TH STREET

NO. 9315

9-19-97

DRAWING NO. **208-V427**

3

6

107-13121

K:\ENG\DESIGN\TRAFFIC SIGNAL\BID97.1730.22-RH\3-6_760-PLAN.010 P11_S90 19 16 04 58 1997

