

NOTE: All reference monuments are 1-3/8" Brass caps in top of curb unless noted.

SURVEYOR'S CERTIFICATE

SCALE: 1"=100'

I, Rita M. Lumos, a Professional Land Surveyor registered in the State of Nevada, do hereby state that this map consisting of two sheets accurately delineates the results of a survey made under my direct supervision at the instance of the City of Las Vegas, and that the points found or set are shown hereon. This survey is not in conflict with the requirements of NRS 278.010 through 278.630 inclusive. (This survey is not a subdivision.) This survey was completed in April, 1993.

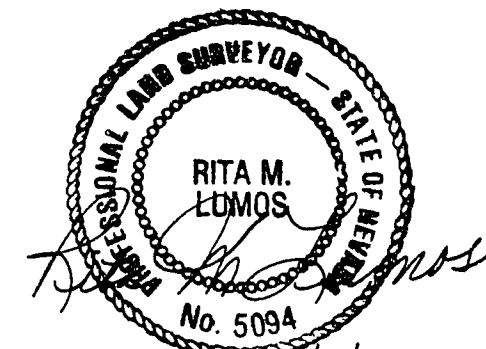

RITA M. LUMOS, P.L.S.
NEVADA CERTIFICATE NO. 5094

BASIS OF BEARINGS:

The south line of the SW 1/4 of Section 36, T 20 S, R 81 E, M.D.M., bears N 89°32'30" W as shown on the plat of Amended Sunrise Tract 1, Book 2, Page 79 of Plats, Official Records of Clark County, Nevada.

REFERENCES: CLARK COUNTY, NEVADA, OFFICIAL RECORDS

1	Plat, Amended Sunrise Tract No. 1	Book 2, Page 79
2	Plat, Sunrise Acres	Book 2, Page 23
3	Plat, Las Vegas Spectrum (Commercial Subd.)	Book 43, Page 10
4	Plat, East Park Industrial Subd.	Book 10, Page 69
5	Record of Survey	File 41, Page 60
6	Plat, Meadow Acres Amended	Book 2, Page 13
7	Plat, Amended Auto Park Tract	Book 1, Page 20
8	Parcel Map	File 29, Page 28
9	Parcel Map	File 39, Page 34
10	Plat, Sandhill Estates 1	Book 11, Page 99
11	Plat, Woodbury Medical Center	Book 31, Page 48
12	Plat, Meadow Homes Un. 1	Book 7, Page 5
13	Plat, Pinewood 2	Book 21, Page 13
14	Plat, Pinewood 3	Book 23, Page 22
15	Parcel Map	File 36, Page 28
16	Record of Survey	File 53, Page 90
17	Plat, CG Plaza	Book 28, Page 28
18	Record of Survey	File 62, Page 40
19	Plat, Winterwood Townhomes	Book 29, Page 78
20	Plat, Hawaiian Park Un. 1	Book 6, Page 80

LEGEND

- = Set Type I Monument : Brass Cap in Well Mon., PLS 5094
- = Set Type II Monument : Brass Cap in Conc., PLS 5094
- △ = Set Type III Monument : 2" Alum. Cap., C.V., PLS 5094
- = Reference markers, found or set as shown
- () = Record measurements w/ references as shown by ○
- = Fnd. and accepted points as shown

NOTE : The purpose of this survey is to replace monuments destroyed during a resurfacing project by the Nevada Department of Transportation. All existing monuments were traversed and referenced prior to construction. An analysis of the location of the previous monuments was made, conflicts resolved, and new monuments set, where necessary, when construction was completed.

ANY SUBSEQUENT CHANGES TO THIS MAP SHOULD BE EXAMINED AND MAY BE DETERMINED BY REFERENCE TO THE COUNTY RECORDER'S CUMULATIVE MAP INDEX. (NRS 278.5695)

SHEET 1 OF 2

RECORD OF SURVEY OF EAST CHARLESTON BLVD. BETWEEN 25TH STREET AND NELLIS BLVD. IN SECTION 36, T20S, R61E; SECTIONS 31 & 32, T20S, R62E; SECTION 1, T21S, R61E; SECTIONS 5 & 6, T21S, R62E; CLARK COUNTY M.D.M. NEVADA		FILE NO. 01024 FILED AT THE REQUEST OF THE CITY OF LAS VEGAS DATE 5/13/93 AT 16:33 FILE 66 PAGE 52
DRAWN BY: ME CHECKED BY: [Signature] DATE: APRIL 1993	OFFICIAL RECORDS BOOK NO. 930513 CLARK COUNTY, NEVADA, RECORDS JOAN L. SWIFT, RECORDER FEE 0.00 DEPUTY [Signature]	