

William F. Pennington
3/5/87

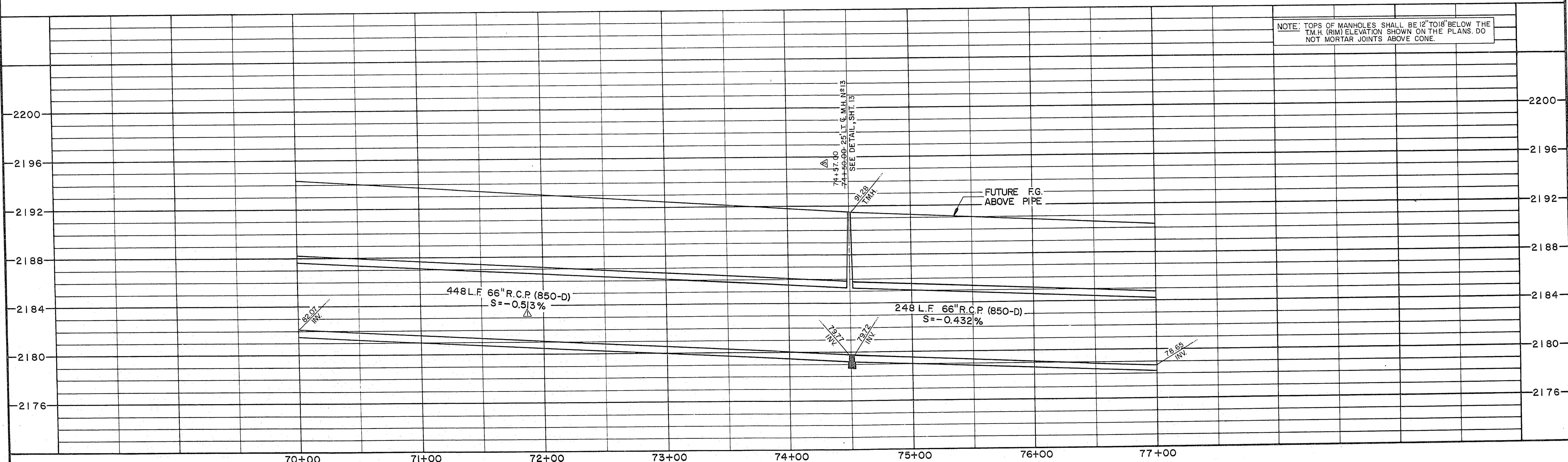

NOTE: TOPS OF MANHOLES SHALL BE 12" TO 18" BELOW THE T.M.H. (RIM) ELEVATION SHOWN ON THE PLANS. DO NOT MORTAR JOINTS ABOVE CONE.

REV. NO.	DATE	DESCRIPTION	APPROVED
1	6/18/87	REVISED SLOPE OF PIPE DUE TO SHIFTED M.H. N°15 - SHT. 8	K.T.L.
2	10/6/88	CHANGED DURING CONSTRUCTION	

DESIGNED BY: *W. Pennington, K. Lambert*
 DRAWN BY: *J.T.S.*
 CHECKED BY: *William F. Pennington*

CLARK COUNTY NEVADA
DEPARTMENT OF PUBLIC WORKS

SMOKE RANCH ROAD
 STORM DRAIN PLAN AND PROFILE
 STA. 70+00 TO STA. 77+00

SCALE	HORZ.: 1" = 40' VERT.: 1" = 4'	DRAWING NO.	L-750A	
PROJECT NO.	830524R	SHT.		9 OF 13
FIELD BOOK	281,341,595,596			