

SURVEYOR'S CERTIFICATE

I, GENE D. KRAMETBAUER, A PROFESSIONAL LAND SURVEYOR IN THE STATE OF NEVADA, AS AN AGENT FOR VTN - NEVADA, HEREBY CERTIFY THAT THE SURVEY OF THE LAND SHOWN HEREON WAS MADE UNDER MY DIRECT SUPERVISION AT THE INSTANCE OF VTN NEVADA. THIS MAP DOES NOT CONSTITUTE A SUBDIVISION AS DEFINED BY NEVADA STATE LAW.

Gene D. Krametbauer
GENE D. KRAMETBAUER
P.L.S. 6201

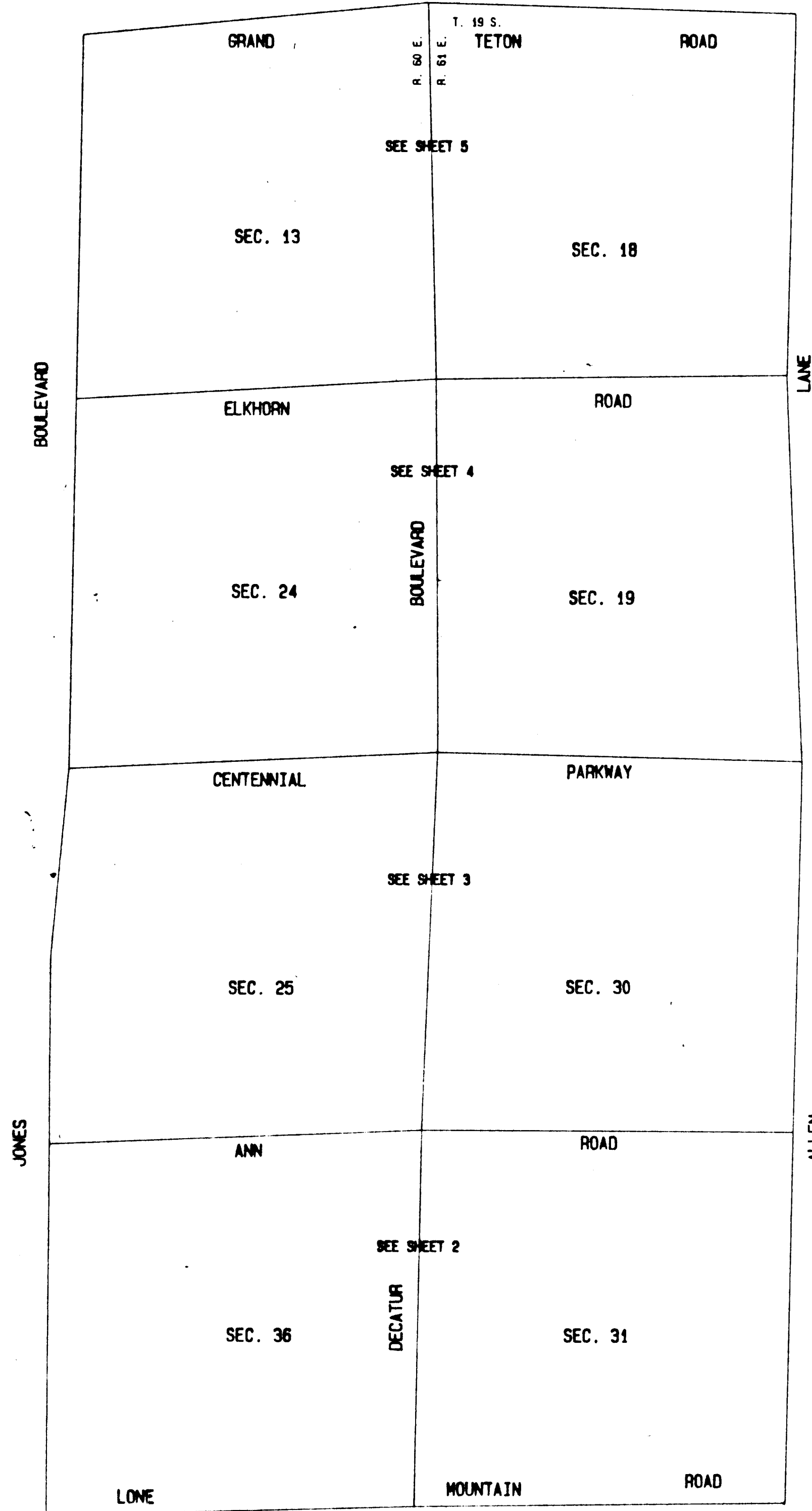
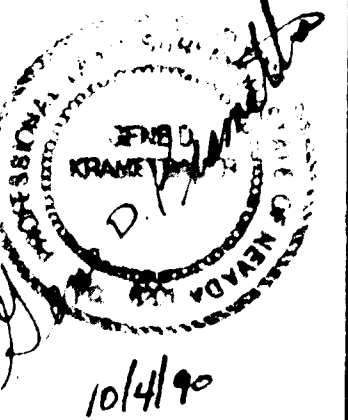

BASIS OF BEARINGS

THE NEVADA STATE PLANE COORDINATE SYSTEM EAST ZONE MODIFIED (NAD 83) WITH A GRID ELEVATION OF 2000 FEET

LEGEND

- LI COURSE NUMBER
- △ SET REBAR & AL. CAP PLS 6201
- BOUNDARY LINE
- CALCULATED LINE PER BLM SURVEY

NOTE

THIS MAP REFLECTS THE CORRELATION BETWEEN THE PROPERTY LINE LOCATIONS AS SHOWN ON A MAP ON FILE IN RECORD OF SURVEYS FILE 52 PAGE 70, RECORDED 10-18-89, CLARK COUNTY NEVADA, SAID MAP PREPARED AND RECORDED IN ACCORDANCE WITH THE ORDER FOR ENTRY OF JUDGEMENT AND DECREE, CASE NUMBERS A233462 AND A274127 RECORDED SEPTEMBER 21, 1989, AND THE ALIQUOT LINES OF SECTIONS 13, 24, 25 AND 36, T. 19 S., R. 60 E., AND SECTIONS 18, 19, 30 AND 31, T. 19 S., R. 61 E., M.D.M., BASED ON THE DECATUR ALIGNMENT, SHOWN ON THAT CERTAIN DEPENDENT RESURVEY PLAT OF T. 19 S., R. 61 E., EXECUTED BY NEIL R. FORSYTH, CADASTRAL SURVEYOR, BEGINNING MARCH 15, 1990, AND COMPLETED ON APRIL 17, 1990, UNDER SPECIAL INSTRUCTIONS DATED MARCH 13, 1990, FOR GROUP NO. 683, NEVADA, UNITED STATES DEPARTMENT OF THE INTERIOR, BUREAU OF LAND MANAGEMENT, AND ALL OTHER ACCEPTED SURVEYS

ANY SUBSEQUENT CHANGES TO THIS MAP SHOULD BE EXAMINED AND MAY BE DETERMINED BY REFERENCE TO THE COUNTY RECORDER'S CUMULATIVE MAP INDEX NRS 278.5695

VTN CONSULTING ENGINEERS * PLANNERS LAS VEGAS, NEVADA		NO. 00786	
RECORD OF SURVEY FOR VTN NEVADA SEC'S 13, 24, 25, 26, T. 19 S., R. 60 E., & SEC'S 18, 19, 30, 31, T. 19 S., R. 61 E., M.D.M., CLARK COUNTY, NEVADA		FILED AT THE REQUEST OF VTN NEVADA	
		DATE 10-10-90 AT 13:27H FILE 57 PAGE 05 OF SURVEYS	
SCALE: NONE		OFFICIAL RECORDS BOOK NO 901010	
NO. NO. 3742	DATE 7/90	CLARK COUNTY, NEVADA RECORDS.	
		JOAN L. SWIFT, RECORDER	
		FEES 10.00 DEPUTY GMA	
		SHEET 1	OF 5

3522

FILE 57 PAGE 05
055-620

14-34