

SUMMERLIN VILLAGE 7 "HALF ACRES" - "MOUNTAIN TRAILS"

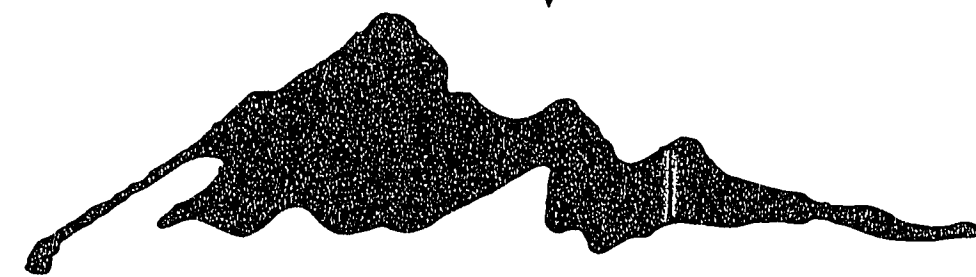

IMPROVEMENT PLANS PARCEL K-2

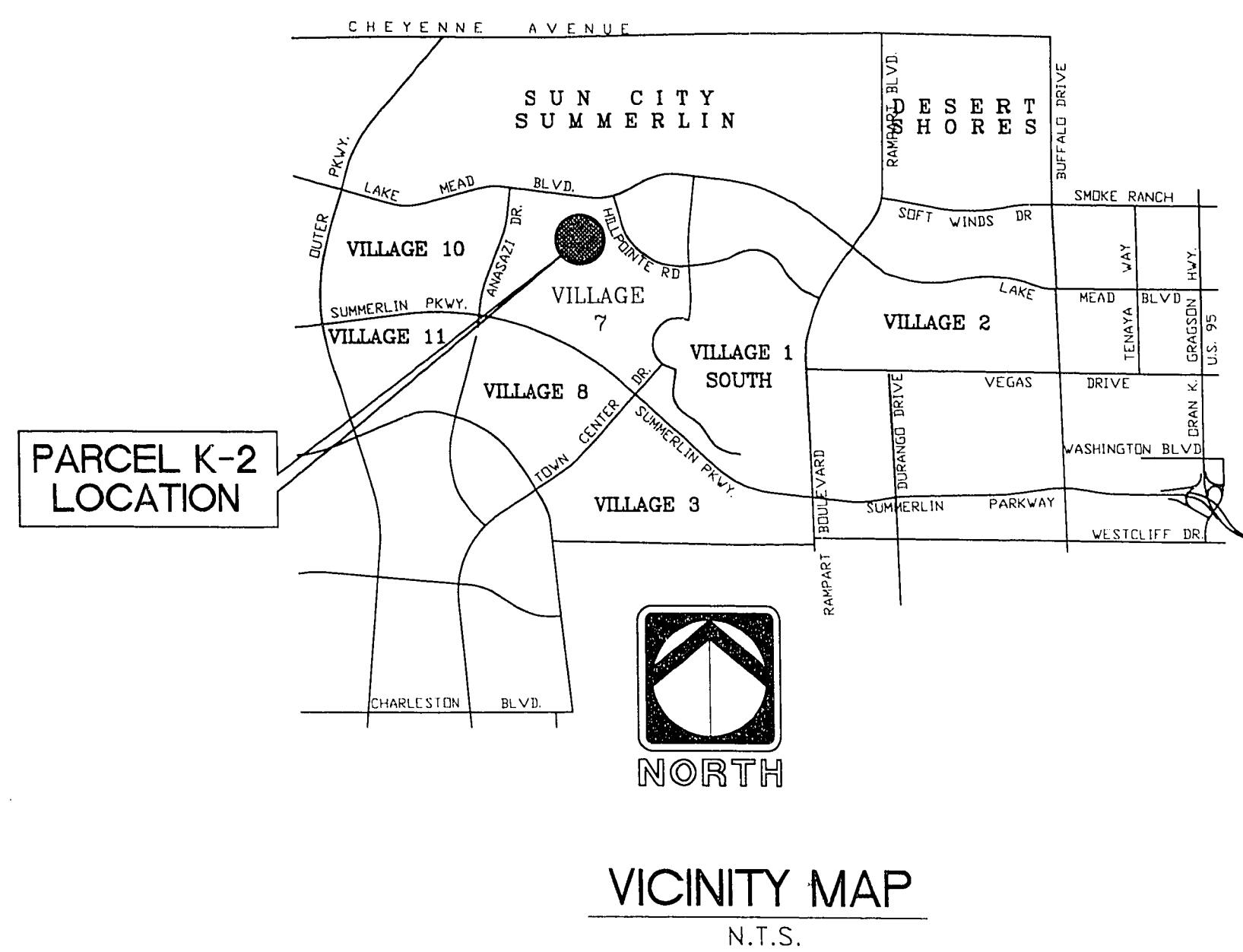
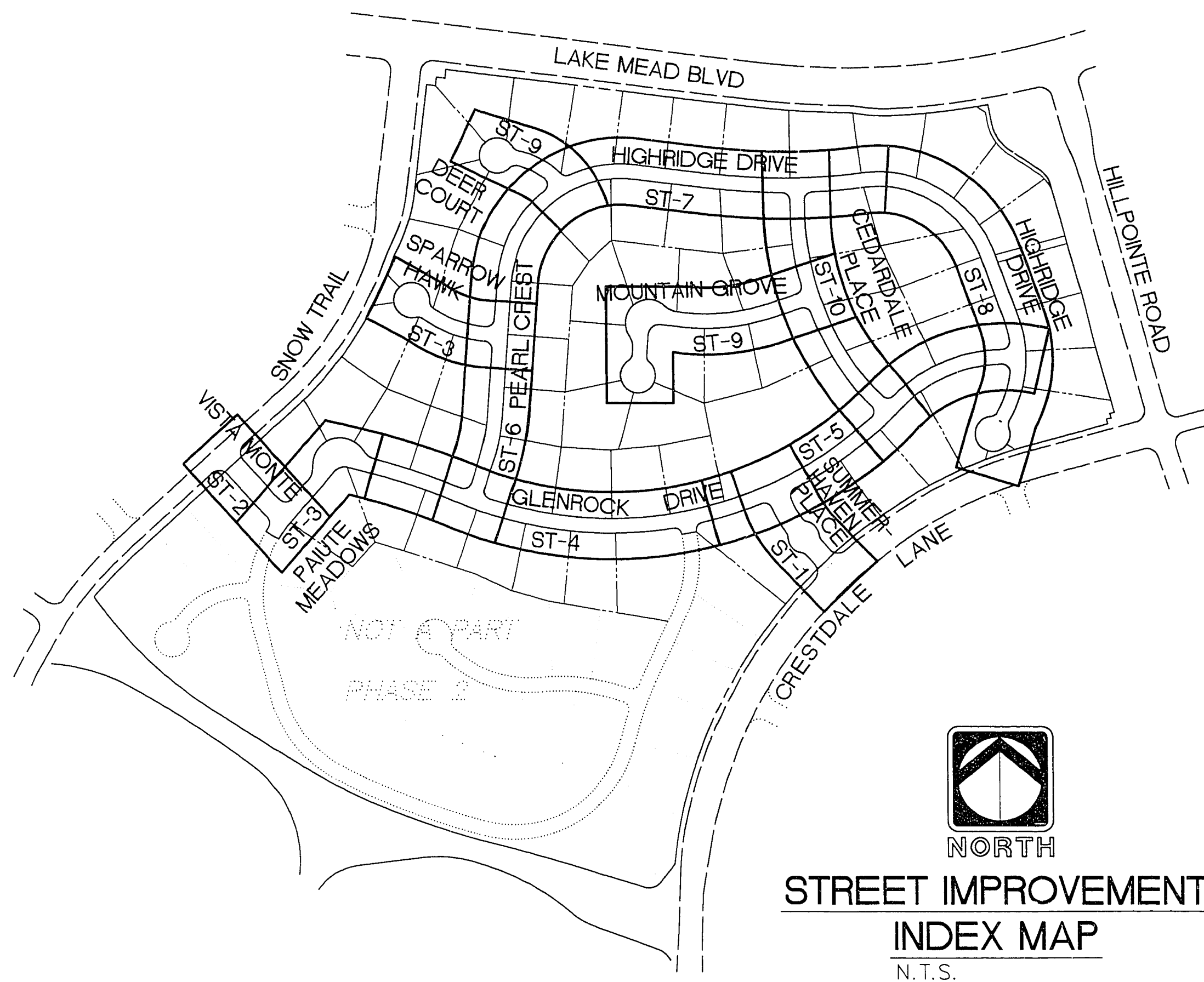
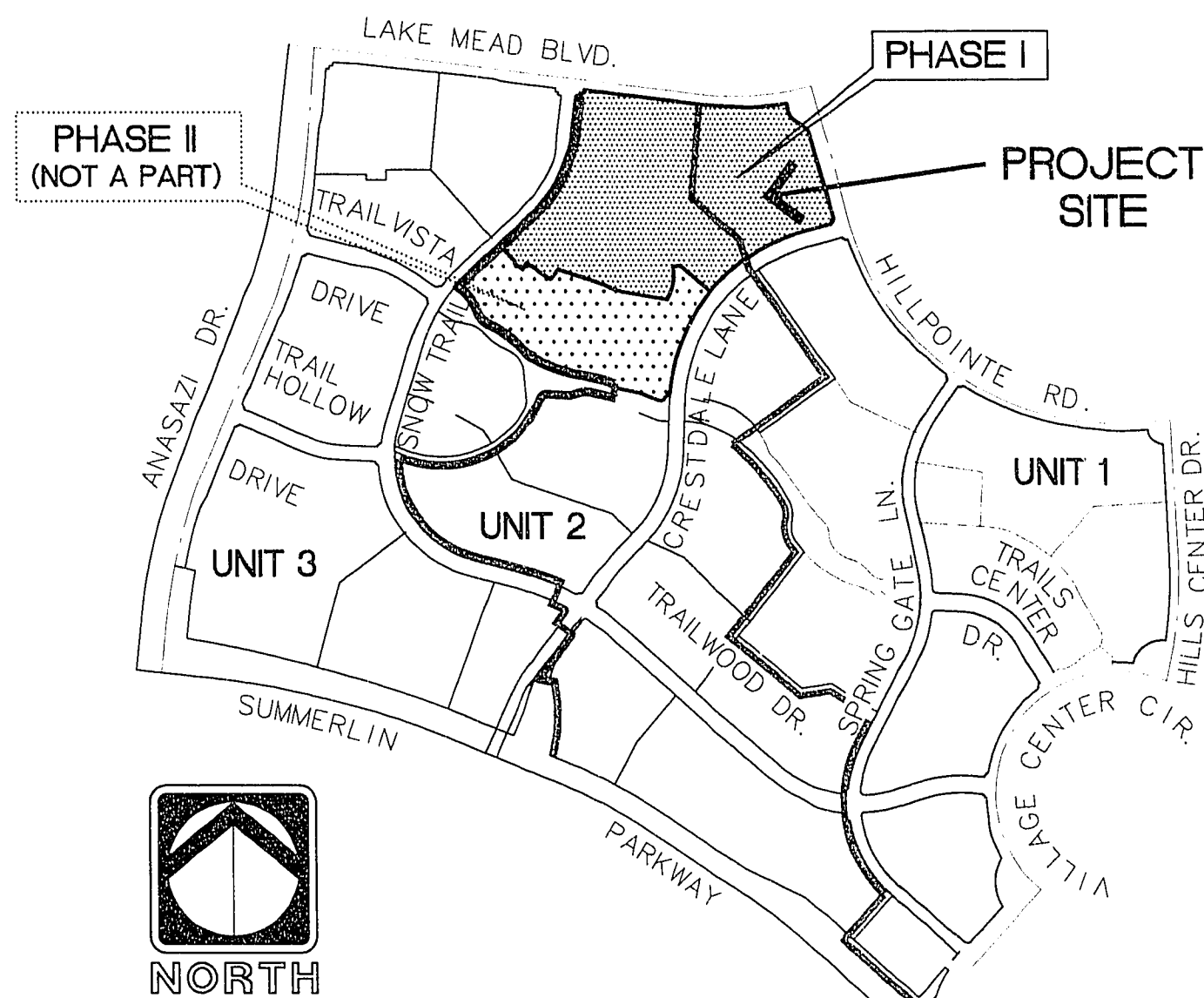
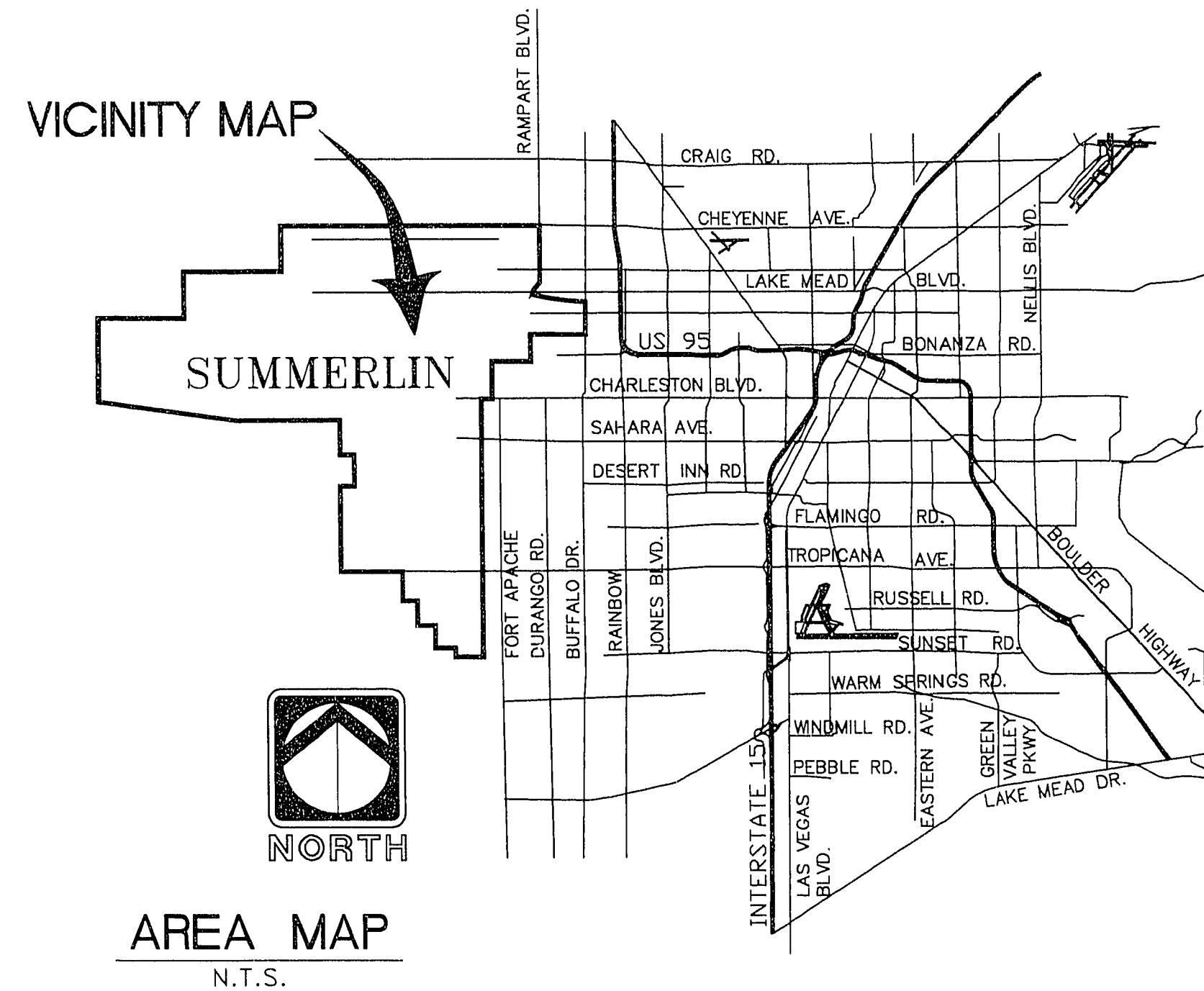

SHEET INDEX

SHT. NO.	TITLE
----------	-------

GENERAL INFORMATION DRAWINGS

- 1 CG-1 COVER SHEET
- 2 CG-2 GENERAL NOTES, CONSTRUCTION NOTES, APPROVALS

UTILITY PLANS

- 3 MW-1 WATER IMPROVEMENT PLAN (WEST PORTION)
- 4 MW-2 WATER IMPROVEMENT PLAN (EAST PORTION)
- 5 MU-1 MASTER UTILITY PLAN (WEST PORTION)
- 6 MU-2 MASTER UTILITY PLAN (EAST PORTION)

PRIVATE STREET / PUBLIC SEWER IMPROVEMENT PLANS

- 7 ST-1 SUMMERHAVEN PLACE STREET PLAN & PROFILE
- 8 ST-2 VISTA MONTE STREET PLAN & PROFILE
- 9 ST-3 PAIUTE MEADOWS & SPARROW HAWK PLAN & PROFILE
- 10 ST-4 GLENROCK DRIVE PLAN & PROFILE (PARTIAL)
- 11 ST-5 GLENROCK DRIVE PLAN & PROFILE (PARTIAL)
- 12 ST-6 PEARL CREST STREET PLAN & PROFILE
- 13 ST-7 HIGHRIDGE DRIVE PLAN & PROFILE (PARTIAL)
- 14 ST-8 HIGHRIDGE DRIVE PLAN & PROFILE (PARTIAL)
- 15 ST-9 DEER COURT & MOUNTAIN GROVE COURT PLAN & PROFILE
- 16 ST-10 CEDARDALE PLACE PLAN & PROFILE
- 17 U-1 STORM DRAIN \ SEWER PLAN & PROFILE (COMMON LOT K)

DETAIL SHEETS

- 18 DE-1 TYPICAL STREET SECTIONS & DETAILS
- 19 DE-2 DETAILS

GRADING PLANS

- 20 GP-1 GRADING PLAN
- 21 GP-2 GRADING PLAN
- 22 GP-3 GRADING PLAN
- 23 GP-4 GRADING PLAN
- 24 GP-5 GRADING PLAN

STREET LIGHTING PLANS

- 25 E-1 ELECTRICAL SCHEDULES AND LEGEND
- 26 E-2 ELECTRICAL DETAILS
- 27 E-3 ELECTRICAL DETAILS

21A GP-2A ENTRY WALL DETAIL
10/5/95

Call before you Dig
1-800-227-2600

SHT. NO.	TITLE
1	CG-1 COVER SHEET
2	CG-2 GENERAL NOTES, CONSTRUCTION NOTES, APPROVALS
3	MW-1 WATER IMPROVEMENT PLAN (WEST PORTION)
4	MW-2 WATER IMPROVEMENT PLAN (EAST PORTION)
5	MU-1 MASTER UTILITY PLAN (WEST PORTION)
6	MU-2 MASTER UTILITY PLAN (EAST PORTION)
7	ST-1 SUMMERHAVEN PLACE STREET PLAN & PROFILE
8	ST-2 VISTA MONTE STREET PLAN & PROFILE
9	ST-3 PAIUTE MEADOWS & SPARROW HAWK PLAN & PROFILE
10	ST-4 GLENROCK DRIVE PLAN & PROFILE (PARTIAL)
11	ST-5 GLENROCK DRIVE PLAN & PROFILE (PARTIAL)
12	ST-6 PEARL CREST STREET PLAN & PROFILE
13	ST-7 HIGHRIDGE DRIVE PLAN & PROFILE (PARTIAL)
14	ST-8 HIGHRIDGE DRIVE PLAN & PROFILE (PARTIAL)
15	ST-9 DEER COURT & MOUNTAIN GROVE COURT PLAN & PROFILE
16	ST-10 CEDARDALE PLACE PLAN & PROFILE
17	U-1 STORM DRAIN \ SEWER PLAN & PROFILE (COMMON LOT K)
18	DE-1 TYPICAL STREET SECTIONS & DETAILS
19	DE-2 DETAILS
20	GP-1 GRADING PLAN
21	GP-2 GRADING PLAN
22	GP-3 GRADING PLAN
23	GP-4 GRADING PLAN
24	GP-5 GRADING PLAN
25	E-1 ELECTRICAL SCHEDULES AND LEGEND
26	E-2 ELECTRICAL DETAILS
27	E-3 ELECTRICAL DETAILS

RECOMMENDED	DATE	REV	DATE	DESCRIPTION
1	11-14-95	1	11-14-95	APP. SHEET 21A TO SET
2	1-21-96	1	1-21-96	REVISE SHEET LAST PLAN APPROVALS
3	12-27-94	1	12-27-94	ISSUE FOR CONSTRUCTION CONTRACT 2/1/95

ENGINEER-IN-CHARGE OF NEVADA PROFESSIONAL ENGINEERS BOARD
GARY R. BUSBY
CIVIL ENGINEER No. 10530

THE KEITH COMPANIES NEVADA
4082 SO. INDUSTRIAL RD. LAS VEGAS, NV 89103 (702) 733-0350

SUMMERLIN VILLAGE 7
"HALF ACRES" - "MOUNTAIN TRAILS"
COVER SHEET

SHEET
CG-1

12-27-94 SHT 1 OF 27

11-14-95 107-4371