

CONSTRUCTION NOTES

STREET IMPROVEMENTS

- 1) CONSTRUCT 2" ASPHALT PAVEMENT WITH 4" TYPE II AGGREGATE BASE OVER 7" TYPE I AGGREGATE BASE
- 2) CONSTRUCT CONCRETE SIDEWALK PER SUMMERLIN STANDARD DRAWING S-72
- 3) CONSTRUCT 6" "L" TYPE CONCRETE CURB AND GUTTER PER SUMMERLIN STANDARD DRAWING S-47
- 4) CONSTRUCT "A" TYPE CONCRETE ISLAND CURB PER SUMMERLIN STANDARD DRAWING S-50
- 7) CONSTRUCT CONCRETE CROSS GUTTER PER SUMMERLIN STANDARD DRAWING S-64
- 8) INSTALL TYPE III MONUMENT PER SUMMERLIN STANDARD DRAWING S-85
- 9) INSTALL 1-6" AND 2-4" SDR 35 PVC IRRIGATION SLEEVES
- 10) INSTALL 2-4" SDR 35 PVC IRRIGATION SLEEVES
- 11) CONSTRUCT 6" "L" TYPE CONC. CURB AND GUTTER CASE NO. 2 PER SUMMERLIN STD. S-50
- 13) CONSTRUCT CURB DEPRESSION FOR FUTURE SIDEWALK RAMP PER SIS STD. S-75
- 14) TRANSITION FROM 8" TO 6" CURB AROUND RETURN
- 15) INSTALL 6" ST. NAME SIGN PER UNIFORM STD. DWG. CLARK COUNTY AREA STD. DWG. 250 (N.I.C.)
- 16) INSTALL 9" ST. NAME SIGN PER UNIFORM STD. DWG. CLARK COUNTY AREA STD. DWG. 250
- 17) INSTALL 1 R1-1 STOP SIGN (30" X 30")
- 18) INSTALL WHITE STOP LINE MARKER PER SIS STD. 78 MODIFIED WITH THERMO PLASTIC

NOTES:

- 1.) ADD 2000 FEET TO ALL GRADES SHOWN ON PLAN VIEW
- 2.) FOR WORK IN SNOW TRAIL SEE SHEET 12 OF VILLAGE 7 UNIT 3 PLANS COLV DRAWING NO. 107Y-4271-3
- 3.) ALL SEWER, WATER, AND STORM DRAIN FACILITIES SHOWN HEREON ARE PUBLIC UNLESS OTHERWISE NOTED.
- 4.) SIDEWALK AND WHEEL CHAIR RAMPS IN ENTRY WILL BE CONSTRUCTED PER LANDSCAPE PLANS.
- 5.) ALL STREETS ARE PUBLIC UTILITY EASEMENTS AND CITY OF LAS VEGAS SEWER EASEMENTS

CURVE NUMBERS ARE SHOWN $\text{\textcircled{O}}$ ON PLANS

CURVE DATA				
CURVE	RADIUS	LENGTH	TANGENT	DELTA
1	30.00'	47.12'	30.00'	90°00'00"
2	273.00'	19.06'	9.53'	04°00'01"
3	30.00'	47.12'	30.00'	90°00'00"
4	327.00'	30.03'	15.03'	05°15'43"
5	6.00'	18.85'		180°00'00"
6	294.00'	18.94'	9.48'	03°41'31"
7	6.00'	18.85'		180°00'00"
8	306.00'	19.72'	9.86'	03°41'31"
9	300.00'	34.84'	17.44'	06°39'14"
10	20'	32.34'	20.95'	92°39'13"
11	20'	28.14'	16.97'	80°37'14"

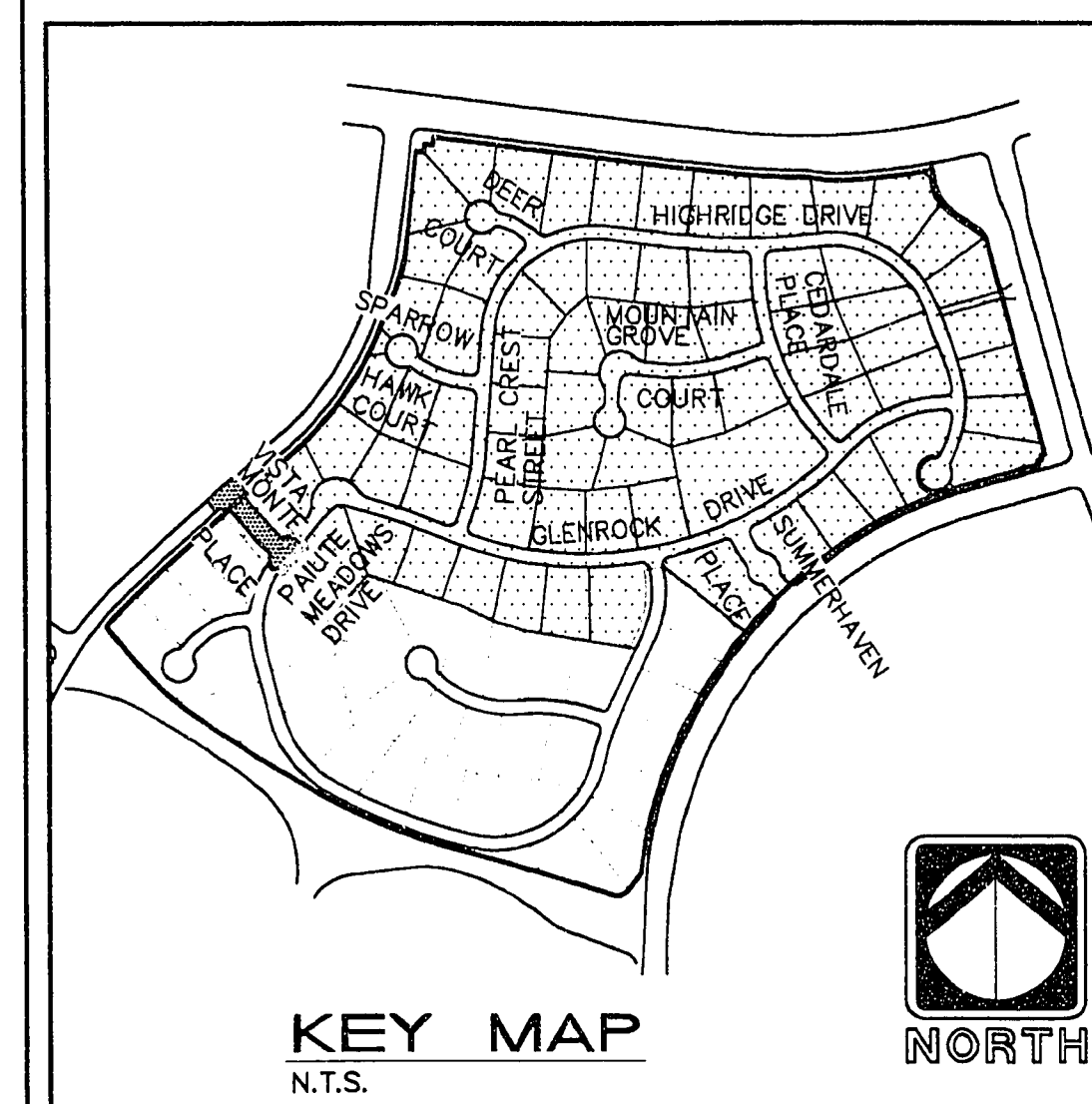

0 20 40 80
1 inch = 20 ft.

12-27-94 SHEET 8 OF 27

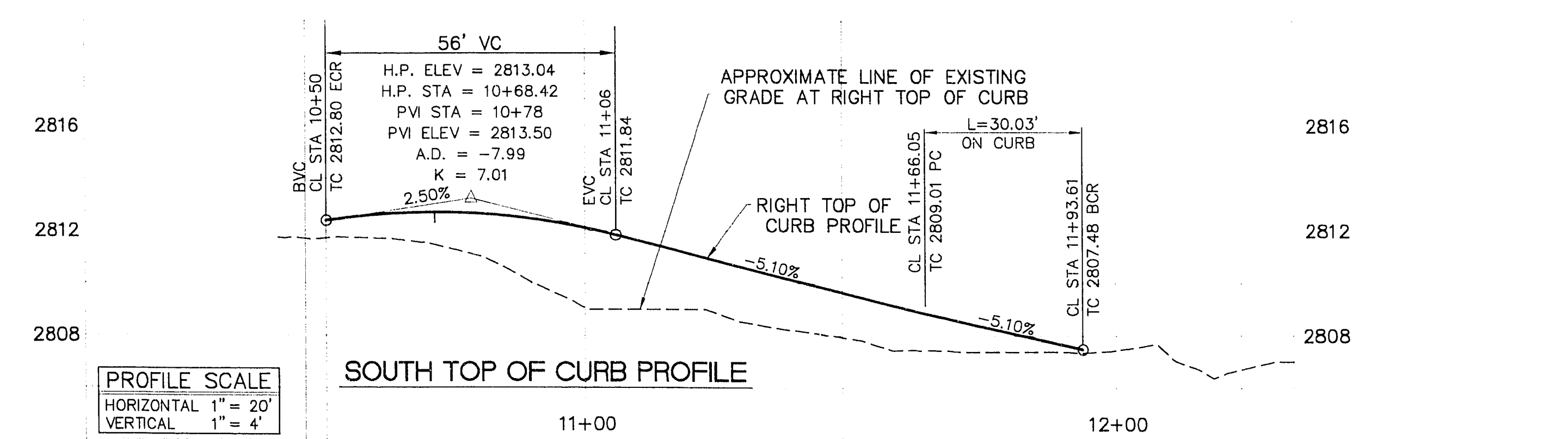
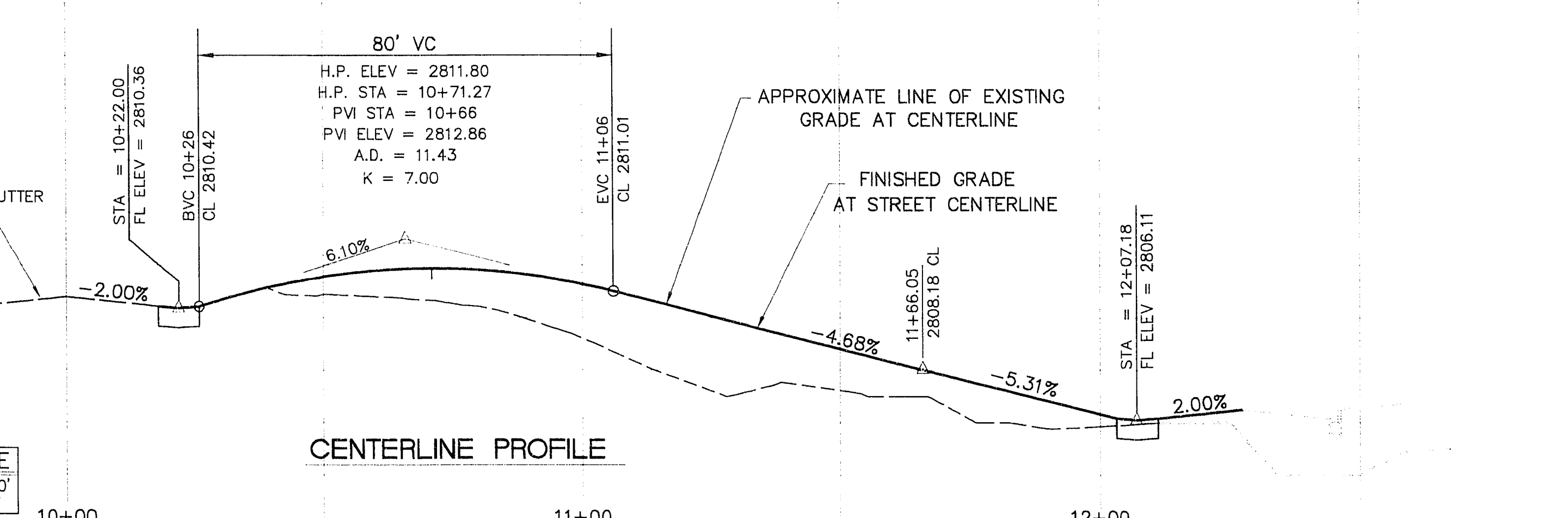
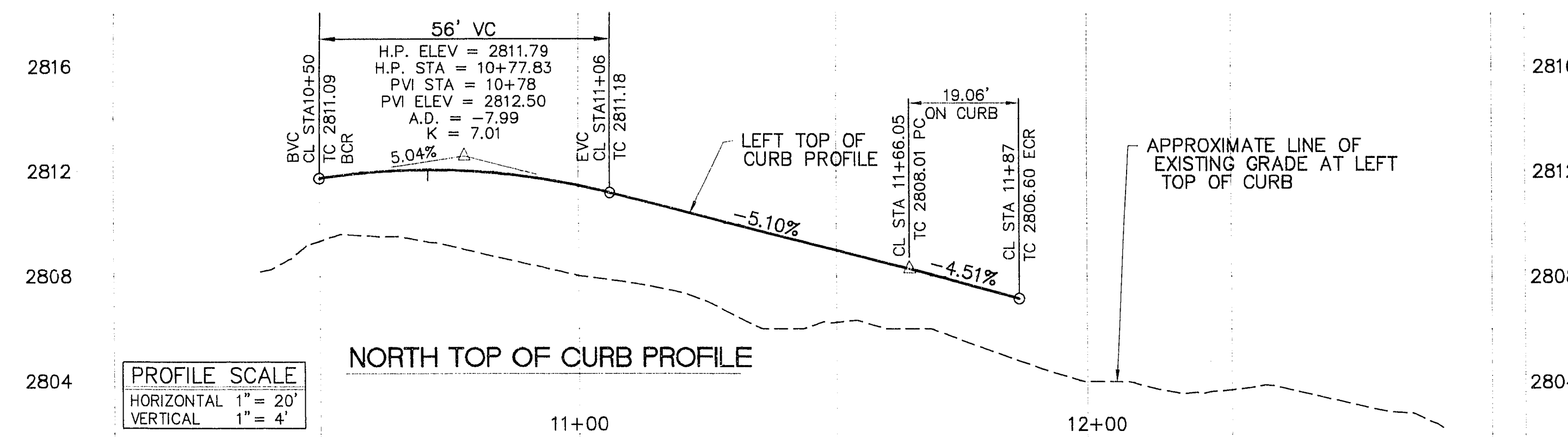

CURB RETURN 1
TC ELEV. @ 1/4 PTS.
A 809.38 TC 7.5" CF
B 809.76 TC 0" CF
C 811.19 TC 6.5" CF

CURB RETURN 3
TC ELEV. @ 1/4 PTS.
D 812.20 TC 6.5" CF
E 811.79 TC 0" CF
F 812.65 TC 7.5" CF

CURB RETURN 10
TC ELEV. @ 1/4 PTS.
G 805.92 TC 6" CF
H 805.78 TC 0" CF
I 806.71 TC 6" CF

CURB RETURN 11
TC ELEV. @ 1/4 PTS.
J 807.23 TC 6" CF
K 806.64 TC 0" CF
L 807.15 TC 6" CF

5. 33045101P.51051212. Tue Feb 14 13:45:24 1995. SURGED - 59. MATHEMAT. IC. SOLID 11.6. UP-485-50410
 CP DESIGNED BY: B0011 46-05-2 441 2.2 DICTATOR DRIVER BY: MERRICK-PACKARD 1.0

	RECOMMENDED DATE: 1-10-95
THE KEITH COMPANIES NEVADA 4082 SO. INDUSTRIAL RD. LAS VEGAS, NV 89103 (702) 793-0350	SUMMERLIN VILLAGE 7 HALF ACRES - "MOUNTAIN TRAILS" VISTA MONTE PLACE PLAN AND PROFILE (PRIVATE STREET) STA 10+00 - END
ENGINEER	SHEET ST-2

11-19-214

107Y-4371