

DESIGNED BY: [Signature]  
 CHECKED BY: [Signature]  
 NO. [Signature]  
 DATE: 5/11/98  
 REVISION: REVISE STREET NAMES PER FINAL MAP #8 5/11/98

ABRAMS AVENUE  
 WASHINGTON & SANDHILL  
 UNIT 1  
 REX & FRAN CALLAWAY FAMILY TRUST  
 CITY OF LAS VEGAS, NEVADA

ORION ENGINEERING AND SURVEYING, INC.  
 2700 CHANDLER AVENUE, SUITE B-1  
 LAS VEGAS, NEVADA 89120  
 (702) 739-5921 FAX (702) 739-5929

SHEET 6  
 of 9

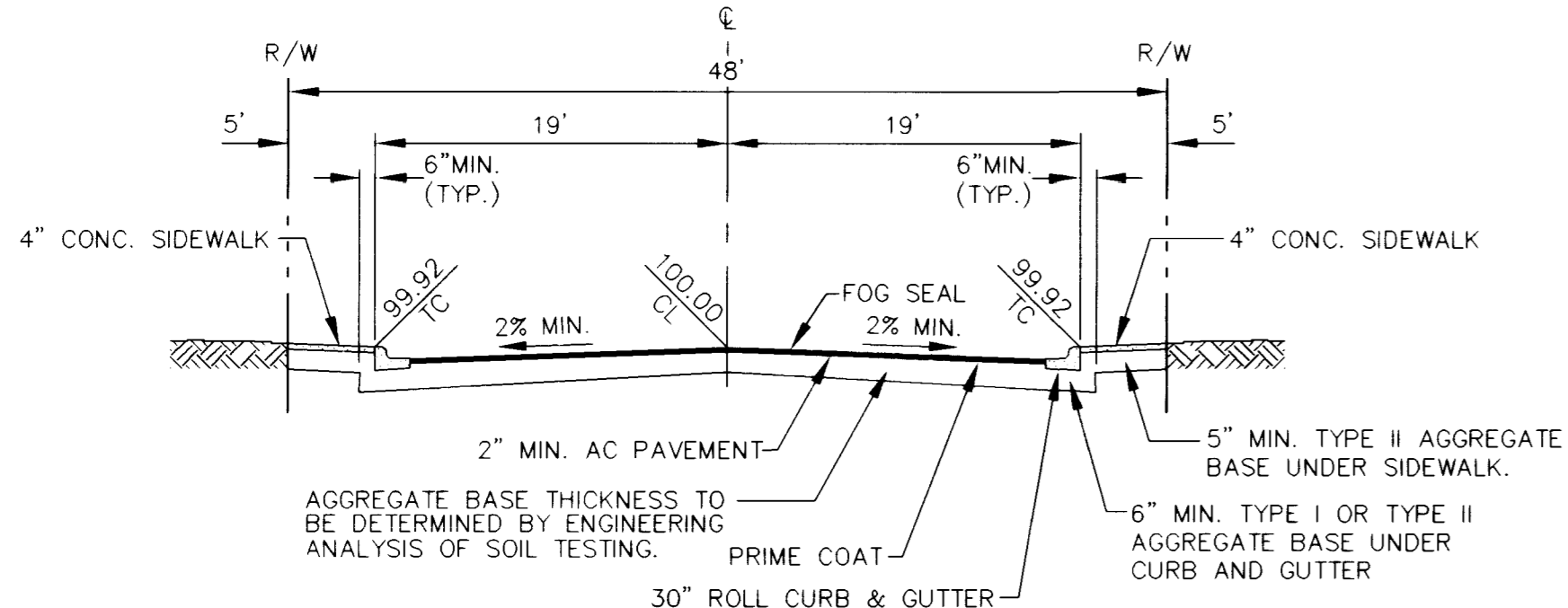
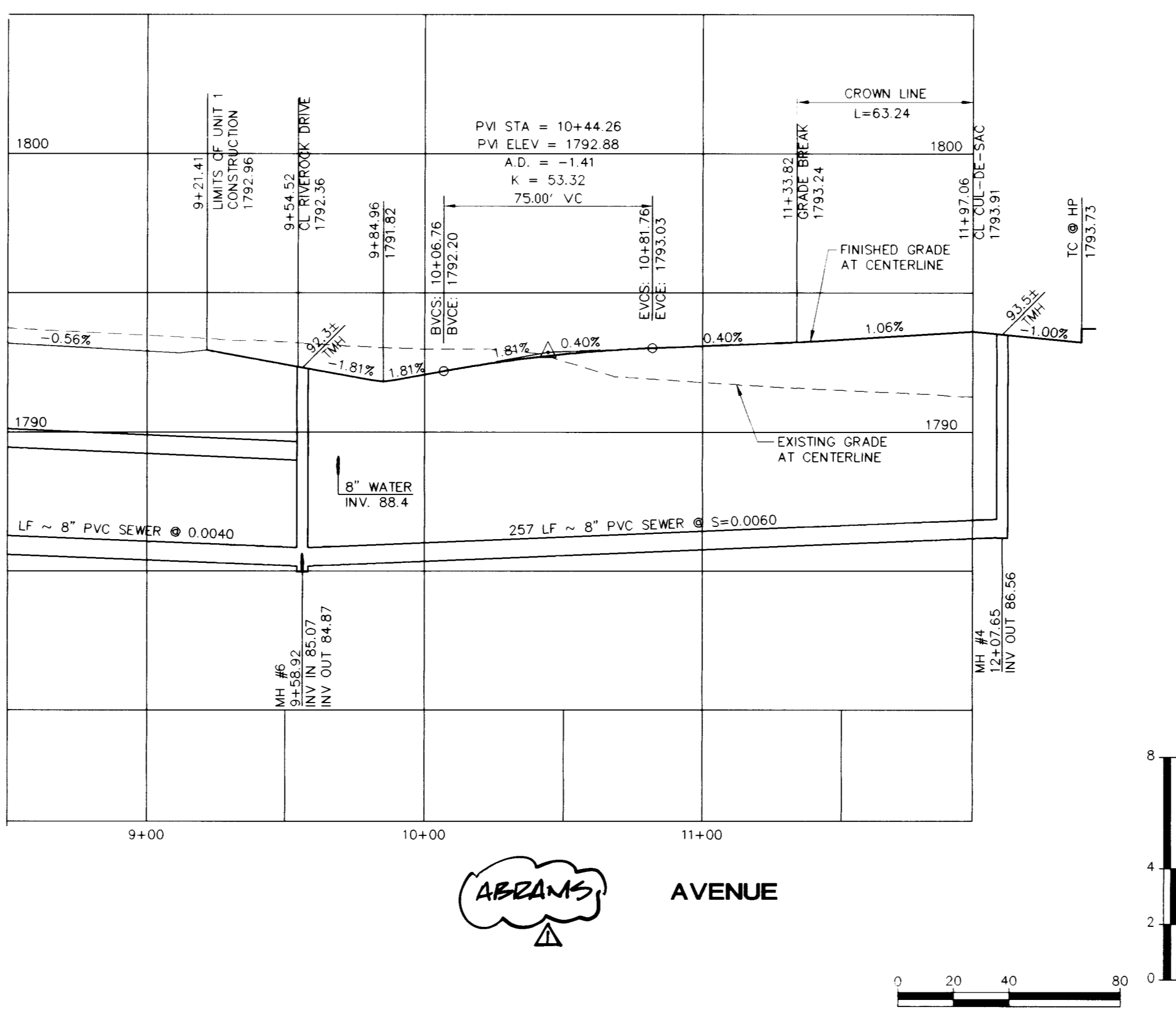
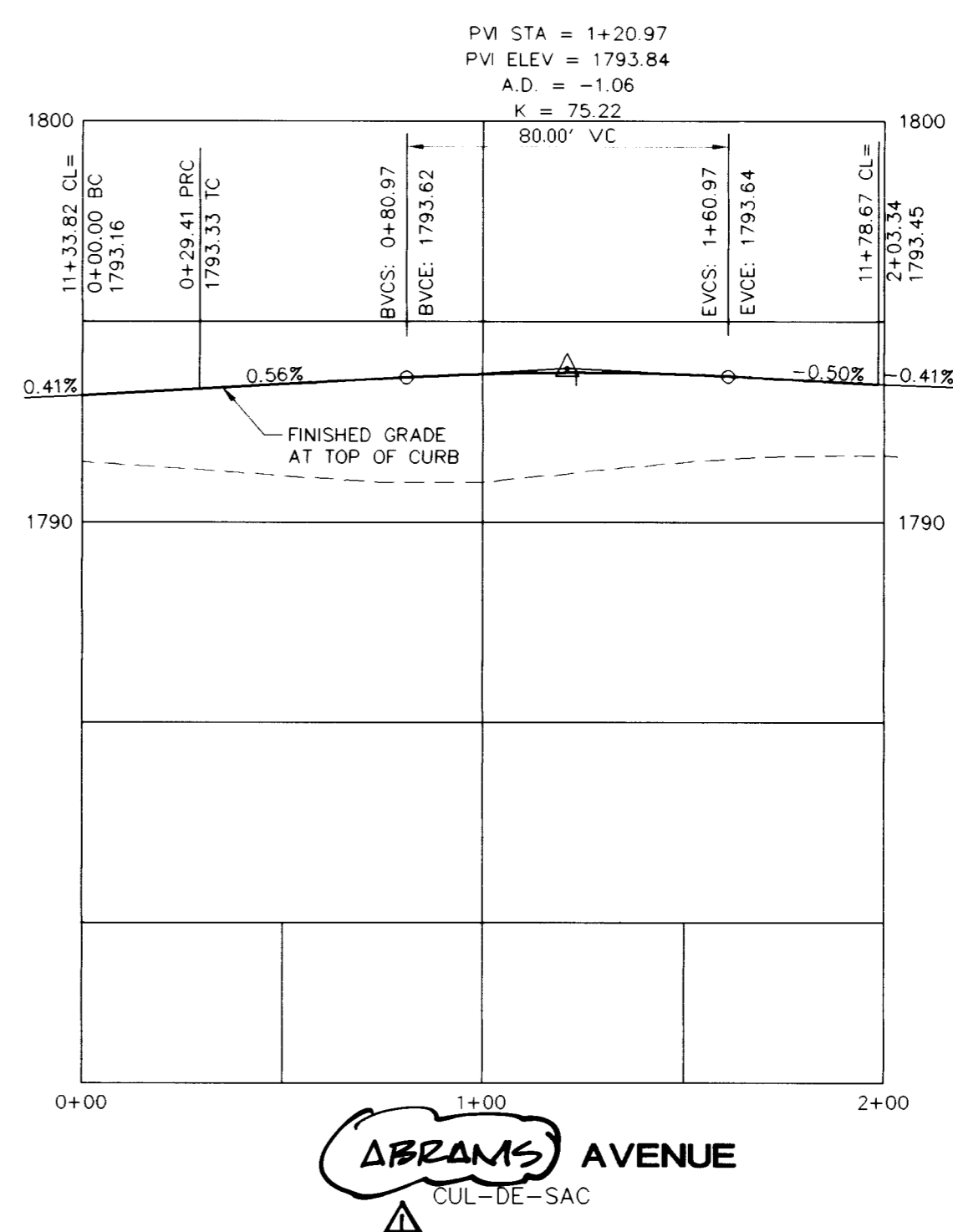

48' TYPICAL STREET SECTION  
 NO SCALE

BACK OF CURB DATA

CURVE	RADIUS	LENGTH	TANGENT	DELTA
C1	2940.39'	83.08'	41.54'	01°37'08"
C2	2940.39'	35.27'	17.63'	00°41'14"
C3	2940.39'	13.63'	6.81'	00°15'56"
C4	25.00'	29.41'	16.67'	67°24'05"
C5	39.00'	10.61'	5.34'	15°53'58"
C6	39.00'	37.77'	20.51'	65°29'03"
C7	39.00'	22.36'	11.50'	32°50'58"
C8	39.00'	20.82'	10.66'	30°35'10"
C9	39.00'	20.82'	10.66'	30°35'10"
C10	39.00'	20.82'	10.66'	30°35'10"
C11	39.00'	20.16'	10.31'	29°36'47"
C12	39.00'	15.83'	8.02'	23°15'15"
C13	2902.39'	9.78'	4.89'	00°11'35"
C14	2902.39'	36.13'	18.07'	00°42'48"
C15	2902.39'	36.13'	18.07'	00°42'48"
C16	2902.39'	36.13'	18.07'	00°42'48"
C17	2902.39'	36.13'	18.07'	00°42'48"
C18	2902.39'	36.13'	18.07'	00°42'48"
C20	2900.89'	36.12'	18.06'	00°42'48"
C21	2900.89'	22.05'	11.02'	00°26'08"
C22	20.00'	34.84'	23.76'	89°45'54"
C23	20.00'	27.44'	16.37'	78°35'45"
C24	100.00'	63.24'	32.72'	57°17'45"

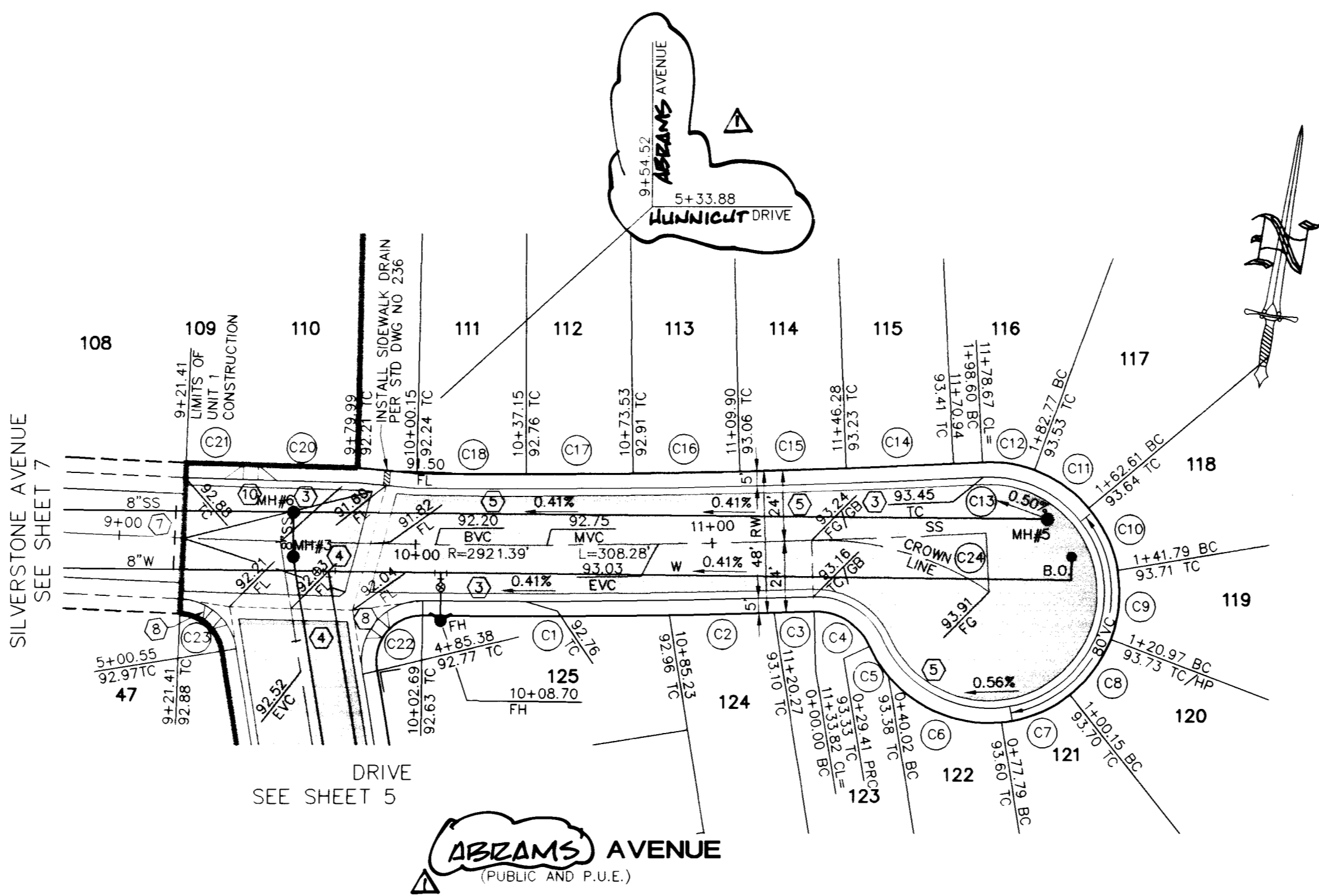

**DISCLAIMER NOTE**

UTILITY LOCATIONS SHOWN HEREON ARE APPROXIMATE ONLY. IT SHALL BE THE CONTRACTOR'S RESPONSIBILITY TO DETERMINE THE EXACT HORIZONTAL AND VERTICAL LOCATION OF ALL EXISTING UNDERGROUND OR OVERHEAD UTILITIES PRIOR TO COMMENCING CONSTRUCTION. NO REPRESENTATION IS MADE THAT ALL EXISTING UTILITIES ARE SHOWN HEREON. THE ENGINEER ASSUMES NO RESPONSIBILITY FOR UTILITIES NOT SHOWN OR UTILITIES NOT SHOWN IN THEIR PROPER LOCATION.

Avoid cutting underground utility lines. If's costly:  
**Call before you Dig**  
 1-800-227-2600  
 (NEVADA SERVICE ONLY)

Avoid overhead power line contact.  
**Call before you Overhead**  
 1-702-593-6111  
 (NEVADA POWER COMPANY AND SAFFO SERVICES CONTRACTORS)

- CONSTRUCTION NOTES**
- CONSTRUCT 2" AC PAVEMENT OVER 12" GRAVEL BASE
  - CONSTRUCT 3" AC PAVEMENT OVER 14" GRAVEL BASE
  - CONSTRUCT ROLL CURB AND GUTTER PER STD. DWG #217A
  - 8" CROSS GUTTER PER STD. DWG #228
  - CONSTRUCT 5" SIDEWALK PER STD. DWG #234
  - CONSTRUCT SIDEWALK RAMP PER STD. DWG # 235, CASE I, A=6.5 AND B=6
  - CONSTRUCT INTERUM GRAVEL ACCESS ROAD PER STD. DWG #209 6" TYPE II OVER 6" TYPE I AGGREGATE BASE
  - CONSTRUCT SIDEWALK RAMP PER STD. DWG # 235, CASE I, A=6.5 AND B=6.5

**BENCHMARK** (N.A.V.D. 88)  
 B.M. NO. 26 STATION 0002 2105WS  
 FOUND RIVET AND SQUARE ALUMINUM PLATE IN TOP OF CURB, N. NORTHEAST CORNER OF OWENS AVENUE AND LAMB BOULEVARD, NEAR THE PC OF OWENS AVENUE (ELEVATION = 1792.13 (846.2440m)) (NAVD88 DATUM)

