

CITY OF LAS VEGAS FIRE DEPT. NOTES

- ALL WORK SHALL BE DONE IN STRICT ACCORDANCE WITH THE CITY OF LAS VEGAS FIRE DEPARTMENT "HYDRANT SPECIFICATIONS", "HYDRANT INSTALLATION SPECIFICATIONS", AND ORDINANCE #3944.
- AUTHORIZED HYDRANTS FOR THIS PROJECT ARE:
 - A. KENNEDY GUARDIAN
 - B. MUELLER A-423 CENTURIAN
 - C. CLOW MODEL 2546 MEDALLION
- ON ANY NEW HOME OR BUILDING INSTALLATION, ACCESSIBLE FIRE HYDRANTS SHALL BE INSTALLED BEFORE COMBUSTIBLE CONSTRUCTION COMMENCES AND SAID FIRE HYDRANTS SHALL BE IN GOOD WORKING ORDER WITH AN ADEQUATE WATER SUPPLY.
- CONTRACTOR SHALL PLACE A BLUE REFLECTIVE MARKER AT CENTERLINE OF STREET ADJACENT TO FIRE HYDRANT AS REQUIRED IN ORDINANCE #3944 TO IDENTIFY FIRE HYDRANT LOCATIONS.
- CALL THE LAS VEGAS BUILDING DEPARTMENT AT 229-2071 FOR UNDERGROUND INSPECTION, PRESSURE AND FLUSH VERIFICATION OF ALL FIRE HYDRANTS AND FIRE LINES BEFORE COVERING.
- PAINTING OF THE CURBS AND HYDRANT AND ANY WORK NECESSARY FOR PROTECTION OF HYDRANTS FROM PHYSICAL DAMAGE PER #3944 SHALL BE COMPLETED BEFORE APPROVAL BY THE CITY OF LAS VEGAS FIRE DEPARTMENT.
- A PERMIT IS REQUIRED FROM THE FIRE DEPARTMENT FOR ON-SITE WATERLINE AND FIRE HYDRANT. THE PERMIT AND CONTRACTOR'S MATERIAL AND TEST CERTIFICATE FOR UNDERGROUND PIPING FORM SHALL BE OBTAINED FROM THE FIRE PROTECTION ENGINEER PRIOR TO ANY WORK BEGINNING.
- PRIVATE FIRE HYDRANTS SHALL BE PAINTED RED.
- A FLOW TEST MUST BE WITNESSED BY THE FIRE DEPARTMENT PRIOR TO OCCUPANCY FOR VERIFICATION OF REQUIRED ON-SITE WATER SUPPLY.
- ALL ON-SITE FIRE MAIN MATERIALS MUST BE U.L. LISTED AND F.M. APPROVED.
- FIRE HYDRANT SPACING:
 - RESIDENTIAL - 500 FEET UNSPRINKLERED, 1000 FEET SPRINKLERED.
 - COMMERCIAL, INCLUDING MULTI-FAMILY - 300 FEET UNSPRINKLERED, 600 FEET SPRINKLERED.
- WHERE NEW WATER MAINS ARE EXTENDED ALONG STREETS, WHERE HYDRANTS ARE NOT NEEDED FOR PROTECTION OF STRUCTURES, FIRE HYDRANTS SHALL BE SPACED AT MAXIMUM 1,000 FOOT SPACING TO PROVIDE FOR TRANSPORTATION HAZARDS.
- NO FIRE HYDRANT SHALL BE LOCATED WITHIN THE REQUIRED RADIUS OF A CUL-DE-SAC OR WITHIN 20 FEET OF THE PERIMETER OF THE RADIUS OF THE CUL-DE-SAC.
- NO FIRE HYDRANT SHALL BE LOCATED WITHIN 6 FEET OF ANY CURB RETURN, DRIVEWAY, POWER POLE, STREET LIGHT OR OTHER OBSTRUCTION.
- TWO SOURCES OF SUPPLY ARE REQUIRED WHENEVER THERE ARE 4 OR MORE FIRE HYDRANTS INSTALLED ON A SINGLE SYSTEM.
- NOT MORE THAN 2 HYDRANTS CAN BE OUT OF SERVICE DUE TO SINGLE MAIN BREAK.
- FIRE APPARATUS ACCESS ROAD SHALL HAVE AN UNOBSTRUCTED WIDTH OF NOT LESS THAN 20 FEET PROVIDED NO PARKING IS ALLOWED, NOT LESS THAN 28 FEET IF PARALLEL PARKING IS ALLOWED ON ONE SIDE, AND NOT LESS THAN 36 FEET IF PARALLEL PARKING IS ALLOWED ON BOTH SIDES, VERTICAL CLEARANCE SHALL NOT BE LESS THAN 13 FEET 6 INCHES.
- THE TURNING RADIUS FOR ANY FIRE APPARATUS ACCESS ROAD AND/OR FIRE LANE, PUBLIC OR PRIVATE SHALL BE NOT LESS THAN 45 FEET OUTSIDE RADIUS AND 22 FEET INSIDE RADIUS.
- A FIRE APPARATUS ROAD SHALL BE REQUIRED WHEN ANY PORTION OF AN EXTERIOR WALL OF THE FIRST STORY IS LOCATED MORE THAN 150 FEET FROM A FIRE DEPARTMENT VEHICLE ACCESS (SEE EXCEPTIONS IN UFC 94, SECTION 902.2).
- ALL DEAD END FIRE APPARATUS ACCESS ROADS AND/OR FIRE LANES PUBLIC OR PRIVATE IN EXCESS OF 150 FEET IN LENGTH SHALL BE PROVIDED WITH AN APPROVED TURNAROUND AREA. SEE ORDINANCE #3944.
- ACCESS ROADS SHALL BE MARKED BY PLACING APPROVED SIGNS AT THE START OF THE DESIGNATED FIRE LANE, ON SIGN AT THE END OF THE FIRE LANE AND WITH SIGNS AT INTERVALS OF 100 FEET ALONG ALL DESIGNATED FIRE LANES. SIGNS TO BE PLACED ON BOTH SIDES OF AN ACCESS ROADWAY IF NEEDED TO PREVENT PARKING ON EITHER SIDE. SIGNS TO BE INSTALLED NO HIGHER THAN 10 FEET OR LESS THAN 6 FEET FROM ROADWAY LEVEL. THE CURBS ALONG OR ON THE PAVEMENT OR CEMENT CURB IS NOT PRESENT, SHALL BE PAINTED WITH RED WEATHER RESISTANT PAINT IN ADDITION TO THE SIGNS.
- ELECTRICALLY CONTROLLED ACCESS GATES SHALL BE PROVIDED WITH AN APPROVED EMERGENCY VEHICLE DETECTOR/RECEIVER SYSTEM. SAID SYSTEM SHALL BE INSTALLED IN ACCORDANCE WITH THE CITY OF LAS VEGAS GUIDELINES FOR AUTOMATIC EMERGENCY VEHICLE ACCESS GATES.

LAS VEGAS VALLEY WATER DISTRICT STANDARD NOTES

- No work shall begin until the water plans have been released for construction by the LVVWD. Following water plan approval, 48 hour notice shall be given to the LVVWD Communication Support Center (258-7171) prior to the start of construction. Notice must be given by 2:00 p.m. the business day prior to a LVVWD inspection.
- All work shall conform to LVVWD Standard Plates, Drawings and Specifications, and the uniform Design and Construction Standards for Water Distribution Systems (UDACS), latest edition.
- All work, except as modified by these plans or by Note 2, shall be done in accordance with the most current draft or edition of the Uniform Standard Specifications for Public Works Construction Offsite Improvement, Clark County area.
- A single pipe material shall be used throughout the project unless otherwise approved by the LVVWD.
- All service laterals two (2) inches in diameter and smaller shall be copper tubing with LVVWD approved service saddles.
- All water meter boxes shall be located outside of driveway areas.
- All valves shall be located outside of driveways, valley and curb gutters.
- The following requirements must be met in the event a water line and sanitary or storm sewer line cross:
 - a. A minimum eighteen (18) inch vertical separation (outside to outside) must be maintained when the water line is installed over the sanitary or storm sewer line. If the vertical separation cannot be maintained or the water line must be placed under the sanitary or storm sewer line, the sanitary or storm sewer line must be constructed with one of the following or, as shown on these plans:
 - a. Potable water supply quality material,
 - b. Encasement, with four (4) inch concrete (minimum)
 - c. Sleeving with potable water supply quality pipe
 - Each provision must extend along the sanitary or storm sewer, on either side of the main, a minimum 10 foot distance perpendicular to the water main exterior.
- Warning tape shall be required over all mains, all six (6) inch diameter and larger service laterals, and any service lateral not installed perpendicular to the main in accordance with Standard Plate No. 27.
- All water facilities shall be filled, disinfected, pressure tested, flushed, filled and an acceptable water sample obtained, prior to connection to the LVVWD's distribution system.
- The contractor must obtain all meters two (2) inches and smaller from LVVWD Central Stores. Telephone 258-3152 forty-eight (48) hours prior to pickup.
- Construction may interrupt service, with LVVWD approval and proper notification, between the hours of 10 PM and 6 AM, Sunday through Thursday. Circumstances may require temporary service feeds be installed, without LVVWD reimbursement. Any temporary service feed must have prior LVVWD approval.
- All water facility construction materials used must be as listed on the LVVWD's Pre-Approved Materials and Manufacturers Listing for New Facilities, latest revision, or specifically approved on these plans. Revised: APRIL 25, 1995

APPROVED FOR CONSTRUCTION

LAS VEGAS VALLEY WATER DISTRICT DATE

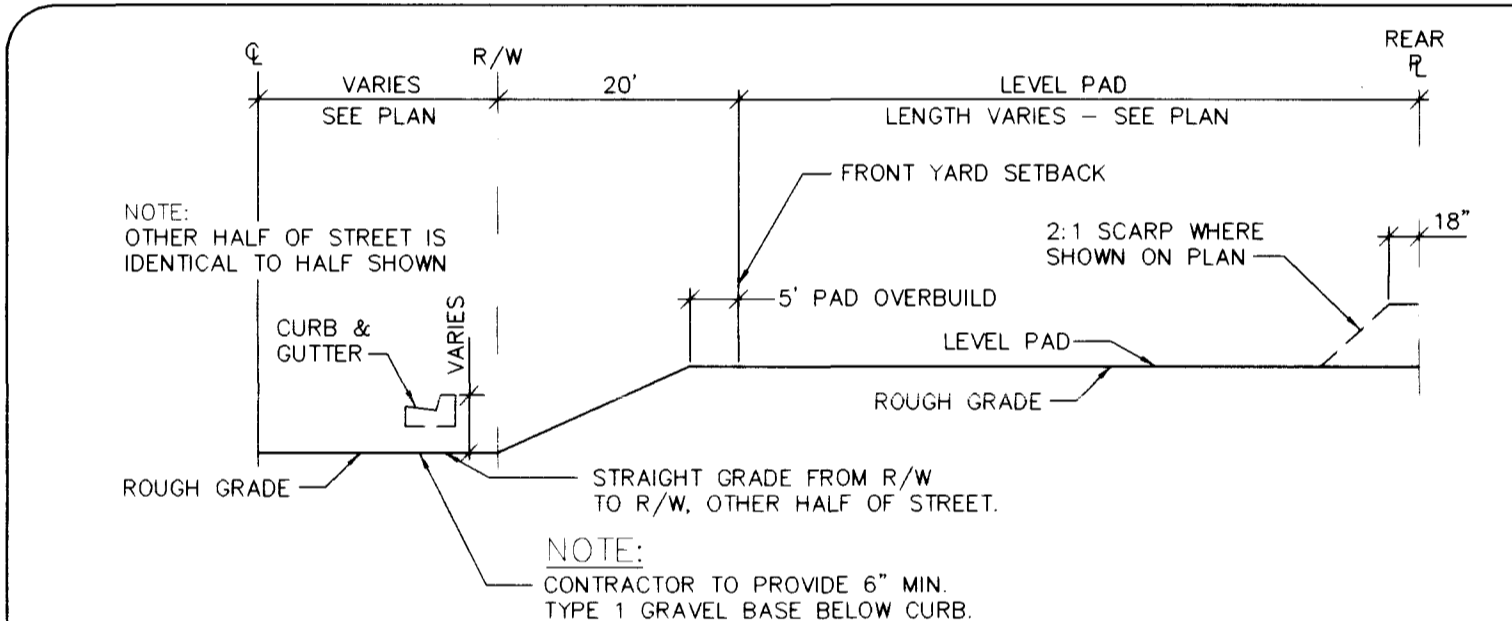

TYPICAL GRADING SECTION N.T.S.

CITY OF LAS VEGAS SEWER NOTES

- ALL CONSTRUCTION AND MATERIALS SHALL BE IN ACCORDANCE WITH THE LATEST EDITION OF THE DESIGN AND CONSTRUCTION STANDARDS FOR WASTEWATER COLLECTION SYSTEMS AND THE UNIFORM STANDARD SPECIFICATIONS FOR PUBLIC WORKS CONSTRUCTION OFF-SITE IMPROVEMENTS, CLARK COUNTY AREA, NEVADA, AS AMENDED. IN ALL CASES, THESE STANDARDS SHALL SUPERSEDE THE UNIFORM STANDARD SPECIFICATIONS. IT WILL BE THE RESPONSIBILITY OF THE CONTRACTOR TO BE AWARE OF THE CONTENTS OF THE ABOVE SPECIFICATION BOOKS.
- IT SHALL BE THE CONTRACTOR'S RESPONSIBILITY TO PERFORM CONSTRUCTION AS PER PLANS. ANY ADDITIONS, DELETIONS, OR CHANGES SHALL MEET WITH THE APPROVAL OF THE CONTROLLING AGENCY.
- CHISEL "S" OR "C" IN CURBS WHERE SEWER OR GAS LATERALS PASS UNDER THE CURB.
- POLYVINYL (PVC) SEWER PIPE SHALL MEET ASTM D-3034 SDR 35 SPECIFICATIONS, INSTALLED WITH SAND BEDDING AND BACKFILL OF TYPE II GRAVEL.
- ALL MANHOLES IN PAVED STREETS 80' R/W AND LARGER, SHALL HAVE CONCRETE COLLARS.
- TEE SADDLES SHALL BE USED TO CONNECT SEWER LATERALS TO EXISTING MAIN LINES UP TO 12" DIA. SIZE CONNECTIONS TO 15" OR LARGER MAINS SHALL REQUIRE SPECIAL PROCEDURES.
- A SEWER MAIN CROSSING OVER A WATER MAIN OR LESS THAN 18" UNDER A WATER MAIN, MUST BE REINFORCED CONCRETE ENCASED FOR A DISTANCE NOT LESS THAN TEN FEET (10') TO EACH SIDE OF THE CENTERLINE OF THE WATER MAIN.
- ALL CONTRACTORS INSTALLING SEWER MAINS THAT WILL BE UNDER THE JURISDICTION OF THE CONTROLLING AGENCY MUST BE CLASS "A" CONTRACTORS.
- THE CITY OF LAS VEGAS WILL NOT ACCEPT ANY SEWER MAINS WHICH HAVE A VERTICAL DEFLECTION OF MORE THAN ONE TENTH (0.1) OF A FOOT FROM THE APPROVED CONSTRUCTION PLANS. SEWER MAINS FOUND TO EXCEED THIS TOLERANCE WILL HAVE TO BE REPAIRED OR REMOVED AND REPLACED TO THE SATISFACTION OF THE CITY ENGINEER PRIOR TO ACCEPTANCE BY THE CITY.

REVISED 10/91

SETBACK TABLE

MAJOR ROW	48'	51'	60'	80'	100'
MINOR ROW	48'	51'	60'	80'	100'
48'	A = 30' B = 30' C = 30' D = 30'	A = 30' B = 30' C = 30' D = 30'	A = 30' B = 30' C = 30' D = 30'	A = 30' B = 30' C = 30' D = 30'	A = 30' B = 30' C = 30' D = 30'
51'	A = 30' B = 30' C = 30' D = 30'	A = 30' B = 30' C = 30' D = 30'	A = 30' B = 30' C = 30' D = 30'	A = 30' B = 30' C = 30' D = 30'	A = 30' B = 30' C = 30' D = 30'
60'	A = 30' B = 30' C = 30' D = 30'	A = 30' B = 30' C = 30' D = 30'	A = 30' B = 30' C = 30' D = 30'	A = 30' B = 30' C = 30' D = 30'	A = 30' B = 30' C = 30' D = 30'
80'	N/A	N/A	A = 30' B = 30' C = 30' D = 30'	A = 30' B = 30' C = 30' D = 30'	A = 30' B = 30' C = 30' D = 30'
100'	N/A	N/A	N/A	A = 30' B = 30' C = 30' D = 30'	A = 30' B = 30' C = 30' D = 30'

GENERAL NOTES

ALL INTERSECTIONS WHERE THE CLASSIFICATION OF MAJOR AND MINOR STREETS CANNOT BE PERMANENTLY ESTABLISHED, EACH LEG OF THE INTERSECTION MUST BE ANALYZED AS IF THE SIGHT VISIBILITY ZONE Labeled "MIN" IN THE SETBACK TABLE ARE NOT REQUIRED. AT "T" INTERSECTIONS, THE TURNING LEG WILL ALWAYS BE THE MINOR STREET.

CURVING ROADWAYS AND ROADWAYS WITH INTERSECTING ANGLES GREATER THAN 10 DEGREES MUST BE ANALYZED USING 90, 90, 90 DEGREE INTERSECTIONS, AND THE CURB POSITIONS AS SHOWN IN THE INFORMATION ABOVE.

APPROVAL OF A SIGHT VISIBILITY ZONE DIFFERENT THAN THAT SHOWN HEREIN SHALL REQUIRE A ZONING VARIANCE APPLICATION SUBMITTED BY THE OWNER AND A SIGHT VISIBILITY ANALYSIS PREPARED AND SUBMITTED BY A CIVIL ENGINEER REGISTERED IN THE STATE OF NEVADA.

THE AREA WITHIN THE LIMITS OF THE ARC AND THE CHORD AT THE CURB RETURN SHALL BE ADDED TO THE SIGHT VISIBILITY ZONE AT EACH CORNER OF EVERY INTERSECTION, EXCEPT FOR 100' + 100' INTERSECTIONS OR GREATER.

BASIS FOR ANALYSIS

THE FOLLOWING CRITERIA SHALL BE USED AS THE BASIS FOR DESIGN OF SIGHT VISIBILITY ZONES.

ASHUTO PUBLICATION OF "A PRACTICE ON GEOMETRIC DESIGN OF HIGHWAYS AND STREETS", 1990 EDITION, CHAPTER 10, USING THE MOST RESTRICTIVE SIGHT LINE DERIVED FROM EACH OF THE THREE POSSIBLE CROSSING MANEUVERS (STOPPED CONDITION):

- CASE IA - CROSSING MANEUVER
- CASE IB - LEFT TURN MANEUVER ONTO A MAJOR STREET
- CASE IC - RIGHT TURN MANEUVER ONTO A MAJOR STREET

THE ANALYSIS SHOULD USE THE GREATER OF THE FOLLOWING: DESIGN SPEED + POSTED SPEED LIMIT PLUS FIVE (5) FEET OR POSTED SPEED LIMIT DIVIDED BY 0.85. CAR AND EYE POSITIONS AS SHOWN ABOVE.

TABLE 1 INTERSECTION SIGHT VISIBILITY ZONE

LEGEND

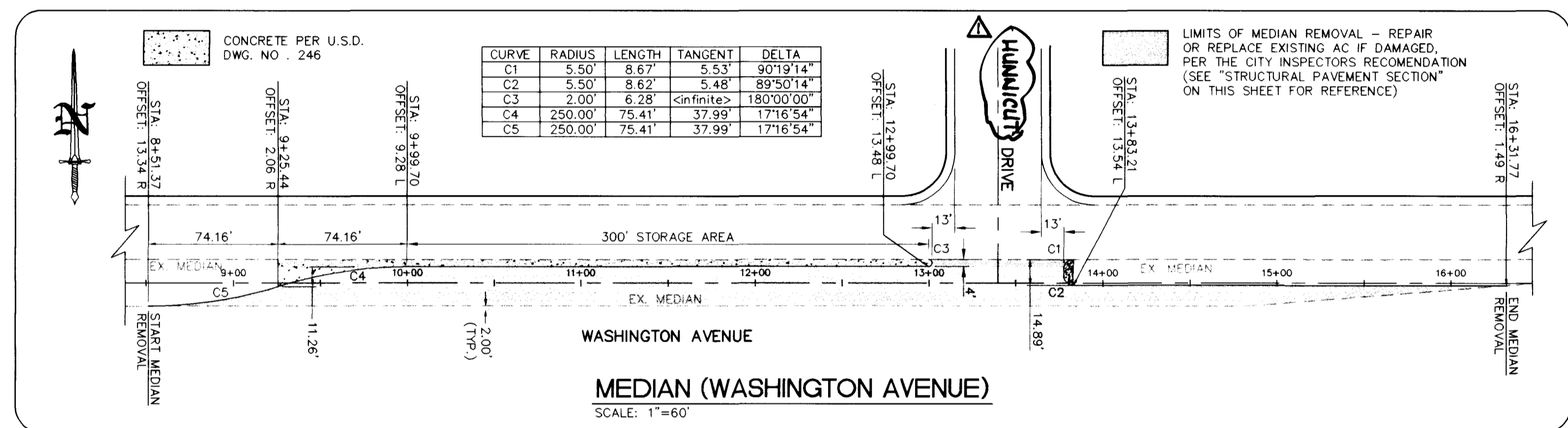
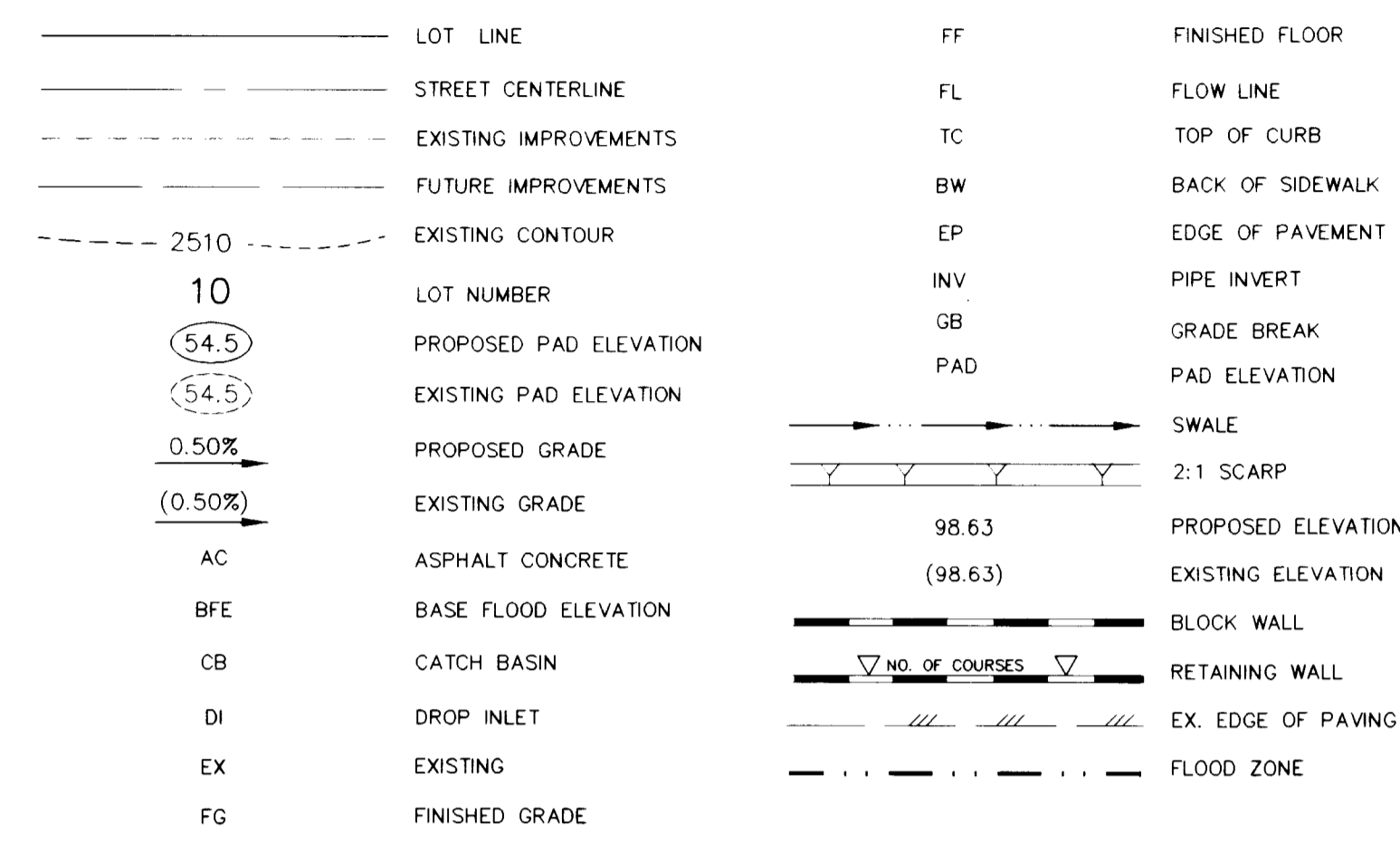

CITY OF LAS VEGAS STREETLIGHT NOTES

- ALL STREET LIGHTING INSTALLATIONS SHALL CONFORM TO THE LATEST ISSUE OF THE STANDARD DETAILS AND SPECIFICATIONS OF THE CITY OF LAS VEGAS AND SHALL ALSO CONFORM TO THE UNIFORM STANDARD SPECIFICATIONS FOR PUBLIC WORKS CONSTRUCTION OF OFF-SITE IMPROVEMENTS, CLARK COUNTY AREA, 1986 UNLESS OTHERWISE NOTED.
- SEE UNIFORM STANDARD DRAWINGS FOR PUBLIC WORKS CONSTRUCTION CITY OF LAS VEGAS, DRAWING NO. 318.
- ALL HAND HOLE COVERS MUST BE INSTALLED, POLE CAPS POURED, AND PULL BOX LIDS BOLTED DOWN PRIOR TO ENERGIZING CIRCUIT. ALL WIRE MUST HAVE THE INSULATION.

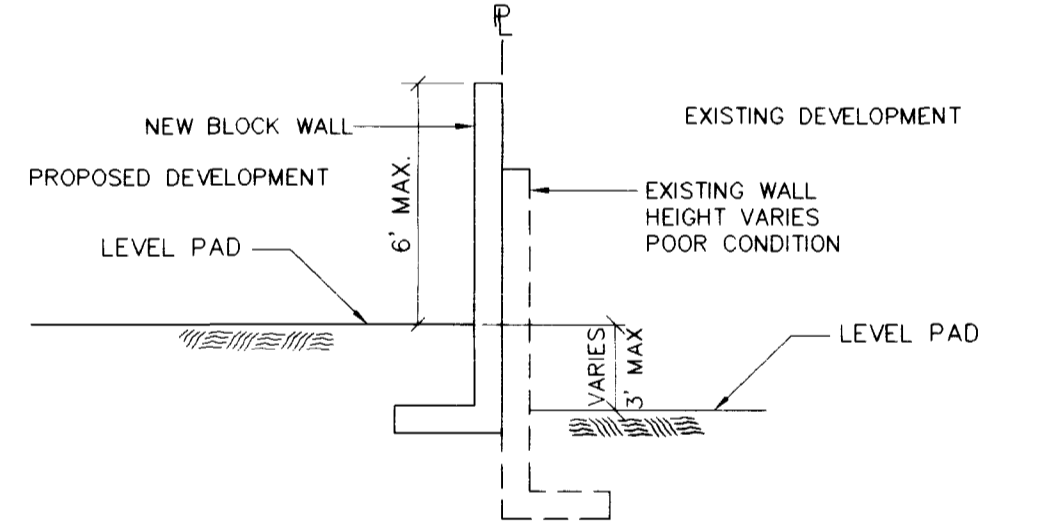

BOUNDARY CROSS SECTION - EAST N.T.S.

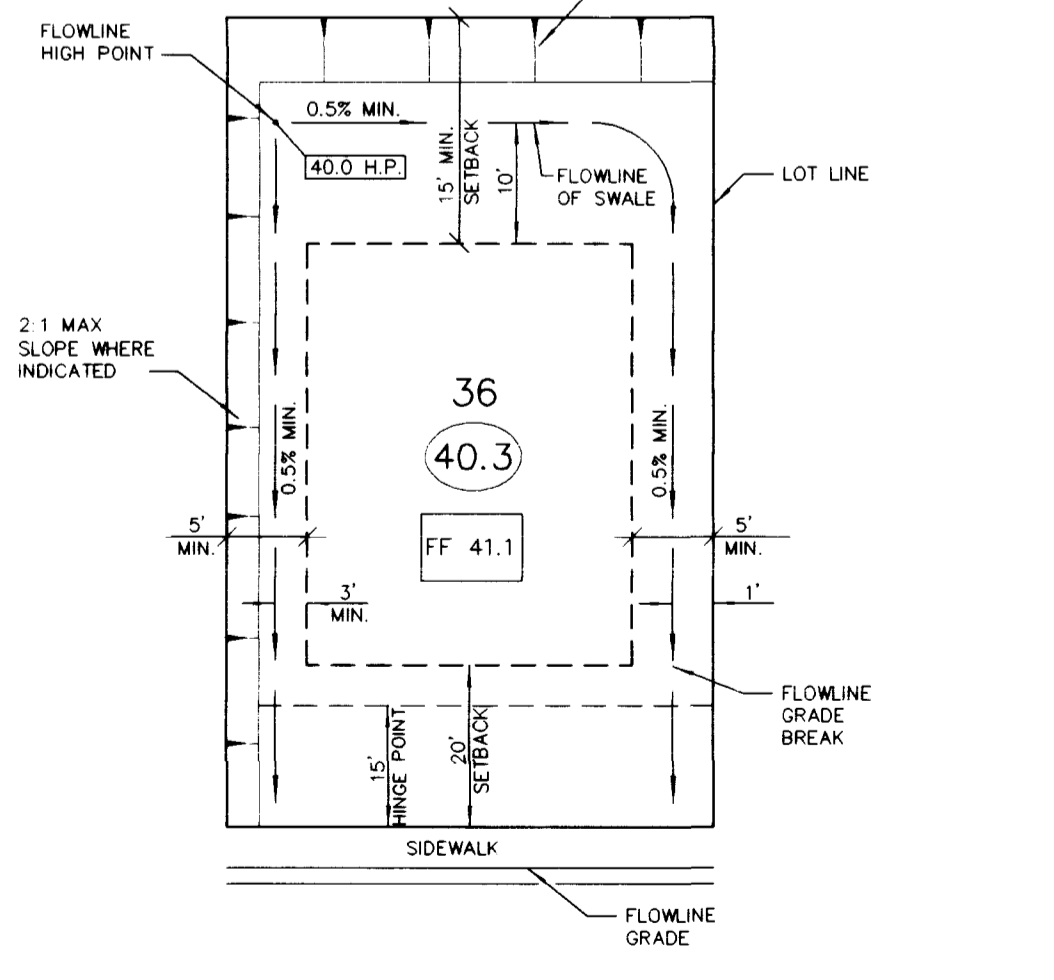

TYPICAL LOT GRADING SCHEMATIC N.T.S.

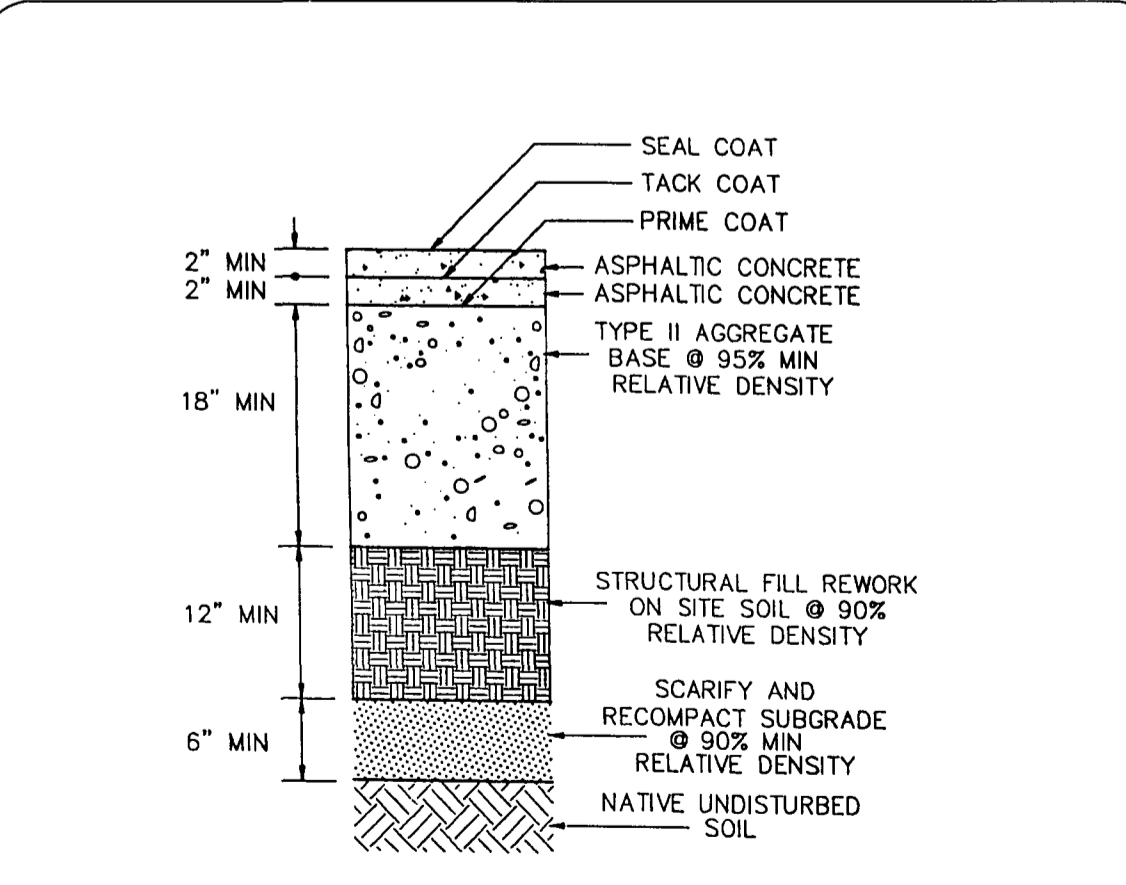

STRUCTURAL PAVEMENT SECTION - DETAIL NO. 1 N.T.S.

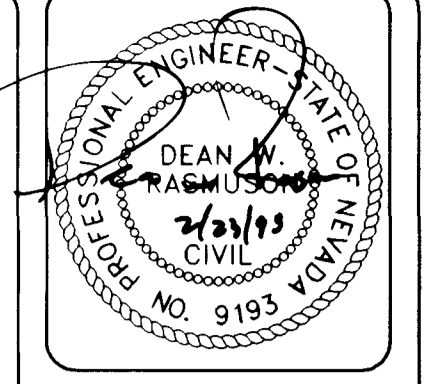

DESIGNED BY: DATE: DRAWN BY: JOB NUMBER: 020-6001
 CHECKED BY: REVISION: BY: DATE: REVISE STREET NAMES PER FINAL MAP AS SHOWN
 REVISE SIGHT VISIBILITY DETAIL RCP 5/18/98

NOTES AND DETAILS
 WASHINGTON & SANDHILL
 UNIT 1
 REX & FRAN CALLAWAY FAMILY TRUST
 CITY OF LAS VEGAS, NEVADA

ORION ENGINEERING AND SURVEYING, INC.
 2700 CHANDLER AVENUE, SUITE B-1
 LAS VEGAS, NEVADA 89120
 (702) 739-5921 FAX (702) 739-5929

