

NOTE:  
STATIONING ALONG KNUCKLE IN THIS AREA  
IS TAKEN FROM BACK OF CURB (N2I CENTERLINE).  
(SEE STATION EQUATION)

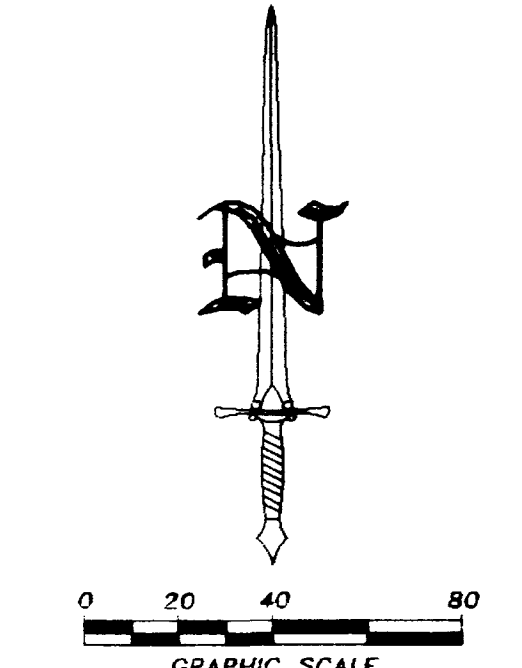
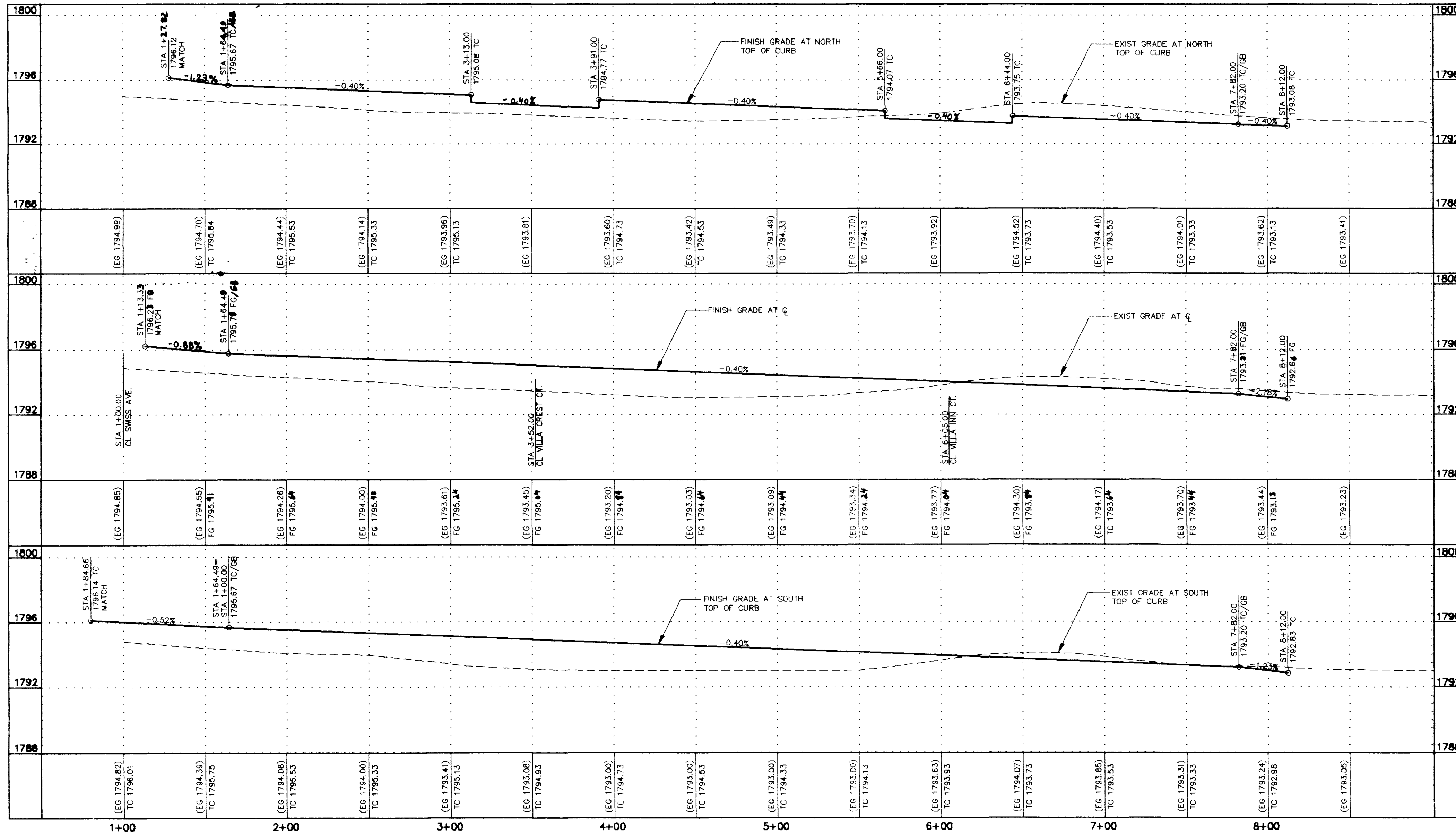

**BASIS OF BEARINGS**

BEING THE SOUTH LINE OF THE SOUTHEAST QUARTER (SE 1/4) OF THE  
NORTHEAST QUARTER (NE 1/4) OF SECTION 30, T.20S., R.62E., M.D.M.,  
CITY OF LAS VEGAS, CLARK COUNTY, NEVADA. SAID LINE BEARS  
N. 89°53'26" E.

**BENCHMARK**

NORTH AMERICAN VERTICAL DATUM 1988 (NAVD88)  
B.M. NO. 14 STATION 2LV02 3056  
FOUND RIVET AND SQUARE ALUMINUM PLATE IN TOP OF CURB, IN THE  
SOUTHWEST CORNER OF SANDHILL RD. AND HARRIS AVE.

ELEVATION = 1785.134 FEET  
544.8623 METERS

**LINE TABLE**

LINE	DIRECTION	DISTANCE
L3	S89°39'10"E	166.50'
L6	S89°39'10"E	166.00'
L10	S89°39'10"E	173.50'
L11	S89°39'10"E	647.51'

**CURVE TABLE**

CURVE	RADIUS	LENGTH	TANGENT	DELTA
C4	20.00'	31.42'	20.00'	90°00'00"
C5	20.00'	31.42'	20.00'	90°00'00"
C9	20.00'	31.42'	20.00'	90°00'00"
C10	20.00'	31.42'	20.00'	90°00'00"
C12	25.00'	12.55'	6.41'	28°46'19"
C14	25.00'	19.63'	10.36'	45°00'00"
C15	58.00'	72.10'	42.02'	73°46'19"

NOTE:  
ALL CURVE AND LINE TABLE INFORMATION IS  
TAKEN FROM THE BACK OF CURB. (TYPICAL)

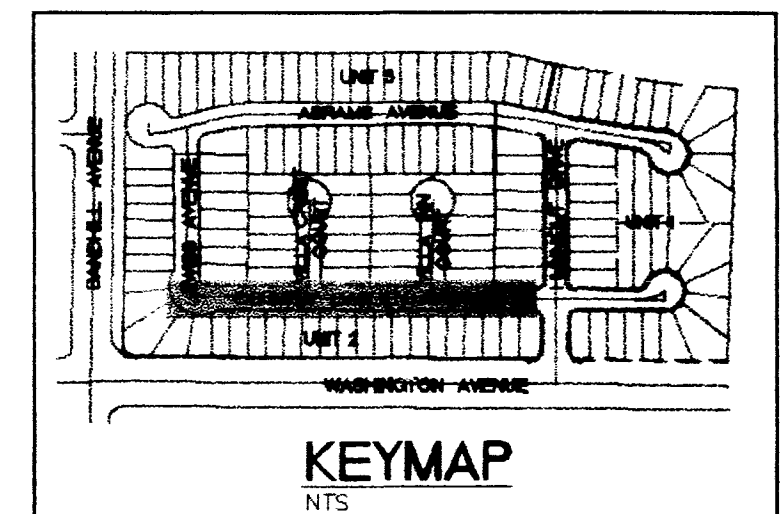

**CONSTRUCTION NOTES**

- 1. INSTALL CASE 1 SIDEWALK RAMP PER CLARK COUNTY AREA STANDARD DWG. NO. 235
- 2. INSTALL 8 FOOT VALLEY GUTTER PER CLARK COUNTY AREA STANDARD DWG. NO. 228

**DISCLAIMER NOTE**

UTILITY LOCATIONS SHOWN HEREON ARE APPROXIMATE ONLY. IT SHALL BE THE CONTRACTOR'S RESPONSIBILITY TO DETERMINE THE EXACT HORIZONTAL AND VERTICAL LOCATION OF ALL EXISTING UNDERGROUND OR OVERHEAD UTILITIES PRIOR TO COMMENCING CONSTRUCTION. NO REPRESENTATION IS MADE THAT ALL EXISTING UTILITIES ARE SHOWN HEREON. THE ENGINEER ASSUMES NO RESPONSIBILITY FOR UTILITIES NOT SHOWN IN THEIR PROPER LOCATION.

Avoid cutting underground utility lines. It's costly.  
**Call before you Dig**  
1-800-227-2600  
UNDERGROUND SERVICE (UES)

Avoid overhead power line contact.  
**Call before you Overhead**  
1-702-593-6111  
RENEW POWER (RPOWER) AND SAFETY SERVICES (RPOWER)

HELLER DEVELOPMENT COMPANIES  
CALIFORNIA • NEVADA  
8453 Paradise Blvd., Suite 9  
Northridge, CA 91324 (818) 727-2656

ORION ENGINEERING AND SURVEYING, INC.  
3088 E. SUNSET ROAD, SUITE 9  
JASPER, NEVADA 89120  
(702) 739-5921 FAX (702) 739-5929

Washington & Sandhill - Unit 2

SHEET: 05-20-98  
DESIGNED BY: RGF  
CHECKED BY: MAB  
PROJECT NO: 022-801  
SCALE: HORIZ: 1" = 40'  
VERT: 1" = 4'

10 OF 16 SHEETS  
DRAWING NO. 1074-4556-2

