

# WASHINGTON & SANDHILL - UNIT 1

BEING A PORTION OF THE SOUTH HALF (S1/2) OF THE SOUTHWEST QUARTER (SW1/4) OF THE NORTHEAST QUARTER (NE1/4) OF SECTION 30, T.20S., R.62E., M.D.M., CITY OF LAS VEGAS, CLARK COUNTY, NEVADA

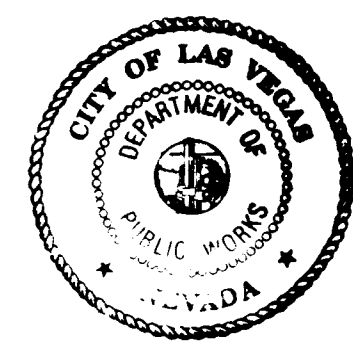

## CERTIFICATE OF OWNERSHIP AND EASEMENT DEDICATION

HELLER DEVELOPMENT COMPANY DOES HEREBY CERTIFY THAT WE ARE THE OWNERS OF THE PARCEL OF LAND WHICH IS SHOWN UPON THE PLAT OF WASHINGTON & SANDHILL - UNIT 1, AND DOES HEREBY CONSENT TO THE PREPARATION AND RECORDATION OF THE PLAT AND DOES HEREBY OFFER AND DEDICATE ALL PUBLIC STREETS, RIGHTS-OF-WAY, AND EASEMENTS AS INDICATED AND OUTLINED HEREON, TO THE CITY OF LAS VEGAS FOR THE USE OF THE PUBLIC. NO PART OF THE PARCELS MARKED "NOT A PART OF THIS SUBDIVISION" IS OFFERED FOR DEDICATION.

FURTHERMORE, THE UNDERSIGNED OWNER OF THE WITHIN PLATTED LANDS DOES HEREBY GRANT AND CONVEY TO NEVADA POWER COMPANY AND SPRINT, JOINTLY AND SEVERALLY, AND TO SOUTHWEST GAS CORPORATION, LAS VEGAS VALLEY WATER DISTRICT AND COMMUNITY CABLE T.V., INC., AND TO THEIR RESPECTIVE SUCCESSORS AND ASSIGNS: (I) A PERMANENT EASEMENT WITHIN THE AREA SHOWN AS COMMON ELEMENTS; (II) A THREE-FOOT WIDE EASEMENT ON ALL SIDE PROPERTY LINES AND UNDERGROUND SERVICES TO METER PANELS; (III) A FIVE-FOOT WIDE EASEMENT ON ALL PROPERTY LINES ABUTTING PUBLIC STREETS TO INCLUDE ACCESS TO ABOVE GROUND TRANSFORMER PADS AND ABOVE GROUND TELEPHONE EQUIPMENT PADS WITHIN THE PLATTED LANDS; (IV) A TWO-FOOT WIDE EASEMENT AROUND TRANSFORMER PADS AND ABOVE GROUND TELEPHONE EQUIPMENT PADS WITHIN THE PLATTED LANDS; FOR THE CONSTRUCTION, MAINTENANCE, OPERATIONS AND FINAL REMOVAL OF STREET LIGHTS, FIRE HYDRANTS, UNDERGROUND POWER, TELEPHONE, GAS, WATER AND CABLE T.V. LINES AND APPURTENANCES, TOGETHER WITH THE RIGHT OF INGRESS TO AND EGRESS FROM THESE EASEMENTS.

FURTHER, THE UNDERSIGNED OWNER HEREBY GRANTS AND CONVEYS TO THE CITY OF LAS VEGAS AND TO ITS SUCCESSORS AND ASSIGNS A FIVE-FOOT WIDE EASEMENT ADJACENT TO ALL PROPERTY LINES WHERE LOTS OR COMMON AREAS ABUT PUBLIC STREETS FOR PURPOSES OF PLACING PUBLIC FIRE HYDRANTS AND PUBLIC STREET LIGHTS AND AN ADDITIONAL EASEMENT OF UP TO TWO FEET IN RADIUS FROM EACH FIRE HYDRANT AND STREET LIGHT, TO EXTEND BEYOND THE FIVE-FOOT EASEMENT IF NECESSARY, TOGETHER WITH THE RIGHT OF INGRESS TO AND EGRESS FROM THESE EASEMENTS.

Richard Heller 4-22-98  
RICHARD HELLER - PRESIDENT DATE

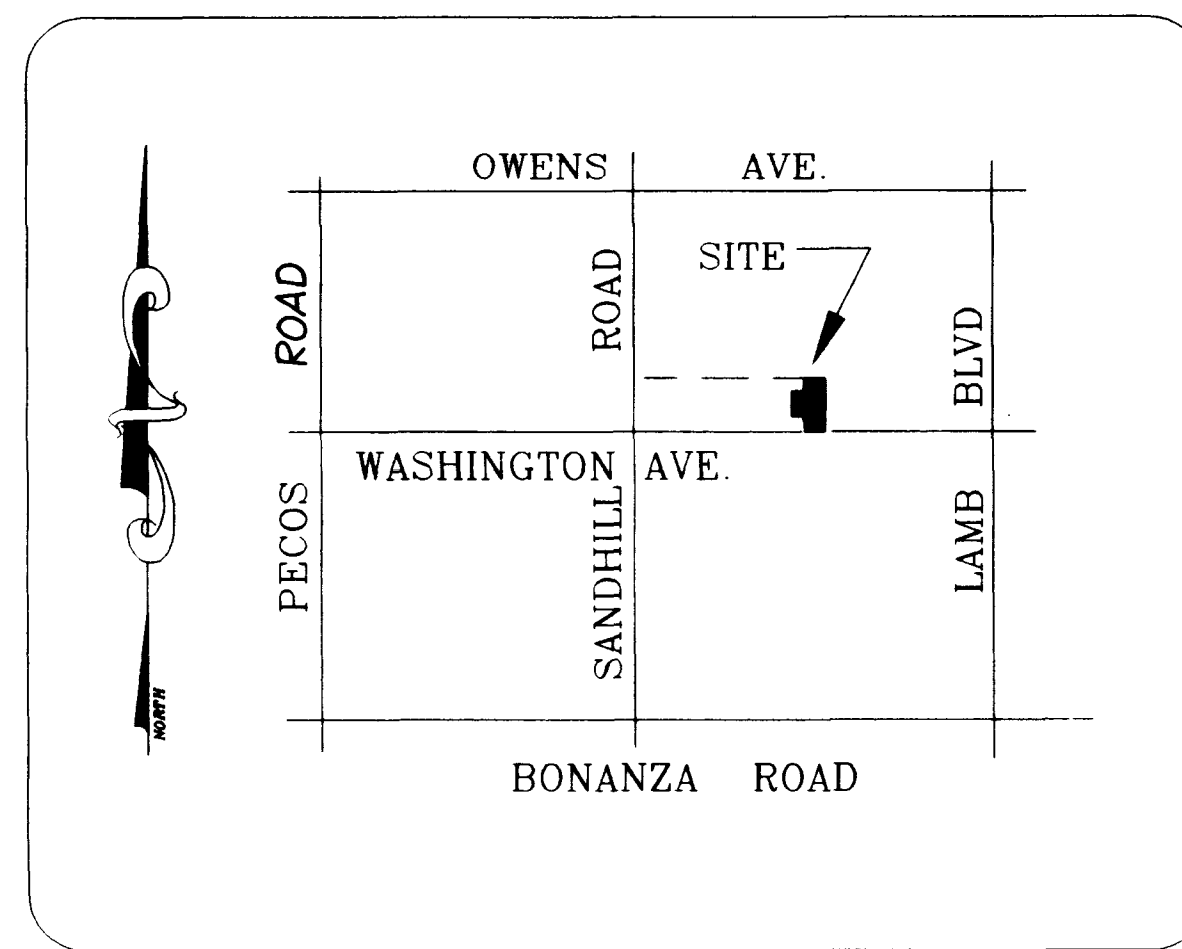

VICINITY MAP

## LEGAL DESCRIPTION A.P.No 140-30-601-009

BEING A PORTION OF THE SOUTH HALF (S1/2) OF THE SOUTHWEST QUARTER (SW1/4) OF THE NORTHEAST QUARTER (NE1/4) OF SECTION 30, T.20S., R.62E., M.D.M., CITY OF LAS VEGAS, CLARK COUNTY, NEVADA, MORE PARTICULARLY DESCRIBED AS FOLLOWS:

COMMENCING AT THE SOUTHEAST CORNER OF SAID SOUTH HALF (S1/2); THENCE ALONG THE EAST LINE OF SAID SOUTH HALF (S1/2), N.02°04'29"E., 50.02 FEET TO THE SOUTHWEST CORNER OF THE VILLAGE AT WASHINGTON AS DEPICTED UPON A FINAL MAP FILED OF RECORD IN BOOK 28 PAGE 09 OF PLATS, OFFICIAL RECORDS, CLARK COUNTY, NEVADA, SAID POINT ALSO BEING THE POINT OF BEGINNING; THENCE ALONG THE WEST BOUNDARY OF SAID VILLAGE AT WASHINGTON N.02°04'29"E., 563.67 FEET TO A POINT ON A NONTANGENT CURVE CONCAVE NORTHERLY HAVING A RADIUS OF 2795.89 FEET, A RADIAL LINE TO SAID POINT BEARS S.03°53'27"W., SAID CURVE BEING THE SOUTH LINE OF A 150.00 FOOT WIDE RIGHT OF WAY GRANTED TO THE CITY OF LAS VEGAS BY DEED FILED OF RECORD IN BOOK 382 AS INSTRUMENT NO. 341210 AND DATED 11-21-1973; THENCE NORTHWESTERLY ALONG SAID SOUTH RIGHT OF WAY AND CURVE THROUGH A CENTRAL ANGLE OF 06°42'42" ALONG AN ARC LENGTH OF 327.52 FEET TO A POINT, A RADIAL LINE TO SAID POINT BEARS THE NEXT DESCRIBED COURSE; THENCE DEPARTING SAID SOUTH RIGHT OF WAY S.10°36'09"W., 100.00 FEET TO A POINT ON A CURVE CONCAVE NORTHERLY HAVING A RADIUS OF 2895.89 FEET, A RADIAL LINE TO SAID POINT BEARS THE LAST DESCRIBED COURSE; THENCE NORTHWESTERLY ALONG SAID CURVE THROUGH A CENTRAL ANGLE OF 01°08'56" ALONG AN ARC LENGTH OF 58.07 FEET, A RADIAL LINE TO SAID POINT BEARS THE NEXT DESCRIBED COURSE; THENCE S.11°45'05"W., 51.00 FEET TO A POINT ON A CURVE CONCAVE SOUTHWESTERLY HAVING A RADIUS OF 15.00 FEET, A RADIAL LINE TO SAID POINT BEARS THE LAST DESCRIBED COURSE; THENCE SOUTHEASTERLY ALONG SAID CURVE THROUGH A CENTRAL ANGLE OF 78°35'45" ALONG AN ARC LENGTH OF 20.58 FEET TO A POINT OF TANGENCY; THENCE S.00°20'50"W., 141.75 FEET; THENCE N.89°39'10"W., 100.00 FEET; THENCE S.00°20'50"W., 208.80 FEET; THENCE S.89°39'10"E., 80.50 FEET TO A POINT OF CURVATURE WITH A CURVE CONCAVE SOUTHWESTERLY HAVING A RADIUS OF 15.00 FEET; THENCE SOUTHEASTERLY ALONG SAID CURVE THROUGH A CENTRAL ANGLE OF 90°00'00" ALONG AN ARC LENGTH OF 23.56 FEET TO A POINT OF TANGENCY; THENCE S.00°20'50"W., 60.00 FEET TO A POINT OF CURVATURE WITH A CURVE CONCAVE NORTHWESTERLY HAVING A RADIUS OF 25.00 FEET; THENCE SOUTHWESTERLY ALONG SAID CURVE THROUGH A CENTRAL ANGLE OF 90°00'00" ALONG AN ARC LENGTH OF 39.27 FEET TO A POINT OF CUSP, SAID POINT BEING A POINT ON THE NORTH RIGHT OF WAY LINE OF WASHINGTON AVENUE (PRESENTLY 100.00 FEET IN WIDTH); THENCE ALONG SAID NORTH RIGHT OF WAY LINE S.89°39'10"E., 410.35 FEET TO THE POINT OF BEGINNING.

PARCEL CONTAINS 5.59 ACRES MORE OR LESS AS DETERMINED BY COMPUTER METHOD.

## SURVEYOR'S CERTIFICATE

I, KEVIN E. MOTT, A PROFESSIONAL LAND SURVEYOR REGISTERED IN THE STATE OF NEVADA, ACTING AS AGENT FOR ORION ENGINEERING AND SURVEYING, INC. CERTIFY THAT:

- THIS PLAT REPRESENTS THE RESULTS OF A SURVEY CONDUCTED UNDER MY DIRECT SUPERVISION AT THE INSTANCE OF HELLER DEVELOPMENT COMPANY.
- LANDS SURVEYED LIE WITHIN SOUTH HALF (S 1/2) OF THE SOUTHWEST QUARTER (SW 1/4) OF THE NORTHEAST QUARTER (NE 1/4) OF SECTION 30, T.20S., R.62E., M.D.M., CITY OF LAS VEGAS, CLARK COUNTY, NEVADA AND THE SURVEY WAS COMPLETED ON MARCH 28, 1998.
- THIS PLAT COMPLIES WITH THE APPLICABLE STATE STATUTES AND ANY LOCAL ORDINANCES IN EFFECT ON THE DATE THAT THE GOVERNING BODY GAVE ITS FINAL APPROVAL.
- THE MONUMENTS DEPICTED ON THE PLAT WILL BE OF THE CHARACTER SHOWN AND OCCUPY THE POSITIONS INDICATED BY 3-25-99 AND AN APPROPRIATE FINANCIAL GUARANTEE WILL BE POSTED WITH THE GOVERNING BODY BEFORE RECORDATION TO ASSURE THE INSTALLATION OF THE MONUMENTS.

KEVIN E. MOTT, P.L.S.  
PROFESSIONAL LAND SURVEYOR  
NEVADA LICENSE No. 8662

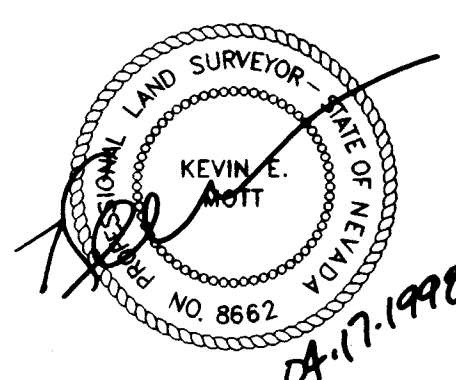

## CERTIFICATE OF CITY SURVEYOR

I, RITA M. LUMOS, CITY SURVEYOR OF THE CITY OF LAS VEGAS, DO HEREBY CERTIFY THAT I HAVE EXAMINED THE FINAL SUBDIVISION MAP OF "WASHINGTON & SANDHILL - UNIT 1" AND I AM SATISFIED THAT THE MAP IS TECHNICALLY CORRECT. MONUMENTS HAVE NOT BEEN SET, BUT A PROPER FINANCIAL GUARANTEE HAS BEEN DEPOSITED TO GUARANTEE THEIR SETTING ON OR BEFORE 3-25-99.

Rita M. Lumos 4/9/98  
RITA M. LUMOS, P.L.S. No. 5094  
CITY SURVEYOR,  
LAS VEGAS, NEVADA

## CERTIFICATE OF PLANNING COMMISSION/DIRECTOR OF PLANNING AND DEVELOPMENT APPROVAL

I CERTIFY THAT THIS FINAL MAP SUBSTANTIALLY COMPLIES WITH THE TENTATIVE MAP AND ANY APPROVED ALTERATIONS THEREOF; THAT THE MAP COMPLIES WITH APPLICABLE STATUTORY AND ORDINANCE PROVISIONS; THAT ALL CONDITIONS IMPOSED UPON THE FINAL MAP HAVE BEEN MET; AND THAT THE MAP WAS APPROVED AND THE PARCELS HEREIN WERE ACCEPTED BY THE PLANNING COMMISSION OF THE CITY OF LAS VEGAS, NEVADA, ON THE 5th DAY OF December, 1998.

Theresa O'Donnell 4/5/98  
THERESA O'DONNELL  
DIRECTOR OF PLANNING AND DEVELOPMENT AND  
SECRETARY OF THE PLANNING COMMISSION DATE

## DISTRICT BOARD OF HEALTH CERTIFICATE

THIS FINAL MAP IS APPROVED BY THE CLARK COUNTY DISTRICT BOARD OF HEALTH. THIS APPROVAL CONCERNS SEWAGE DISPOSAL, WATER POLLUTION, WATER QUALITY AND WATER SUPPLY FACILITIES AND IS PREDICATED UPON PLANS FOR A PUBLIC WATER SUPPLY AND A COMMUNITY SYSTEM FOR DISPOSAL OF SEWAGE.

Edmund J. Wojcik 4-24-98  
EDMUND J. WOJCICK  
DISTRICT BOARD OF HEALTH DATE

## BASIS OF BEARINGS

BEING THE SOUTH LINE OF THE SOUTHWEST QUARTER (S1/4) OF THE NORTHEAST QUARTER (NE 1/4) OF SECTION 30, T.20S., R.62E., M.D.M., CITY OF LAS VEGAS, CLARK COUNTY, NEVADA. SAID LINE BEARS N.89°39'10"W. PER R1 & R3.

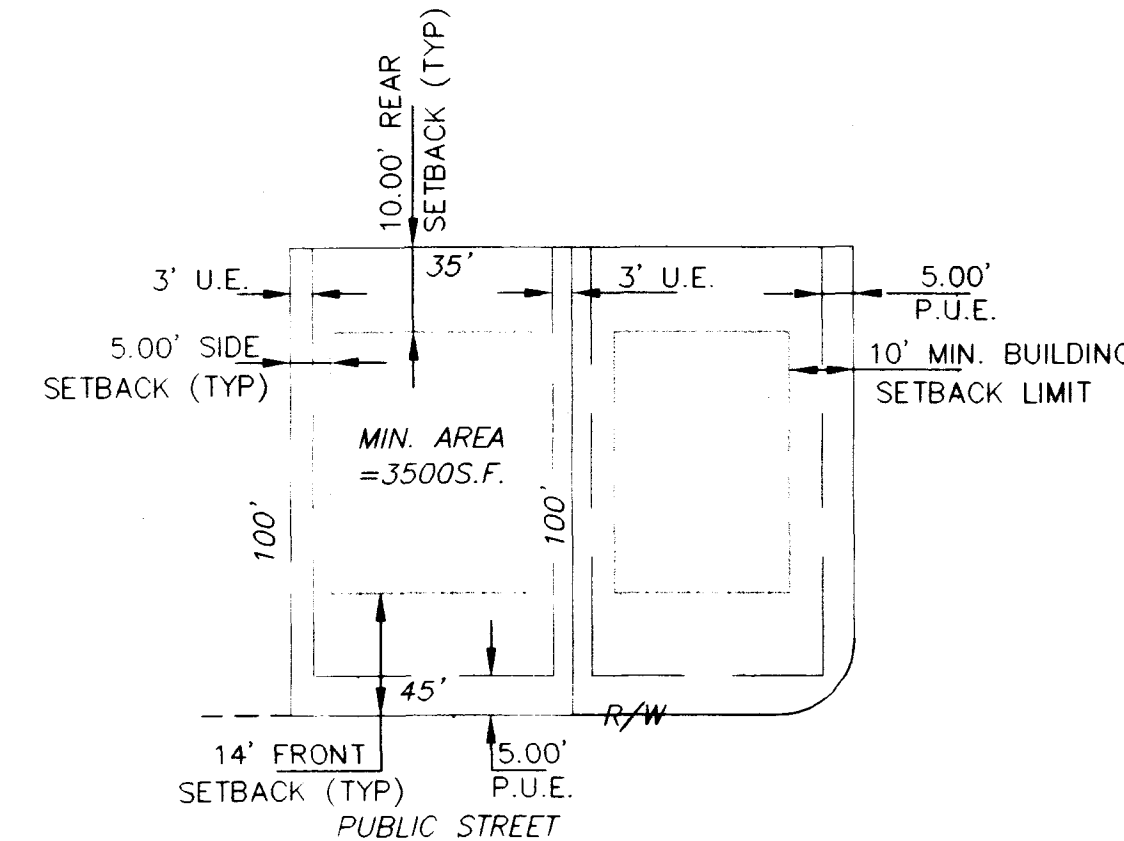

TYPICAL LOT DETAIL

NOT TO SCALE

## RECORDER'S NOTE

ANY SUBSEQUENT CHANGES TO THIS MAP SHOULD BE EXAMINED AND MAY BE DETERMINED BY REFERENCE TO THE COUNTY RECORDER'S CUMULATIVE MAP INDEX, N.R.S. 278.5695

**Orion**  
ORION ENGINEERING AND SURVEYING, INC.  
3068 EAST SUNSET, SUITE 9  
LAS VEGAS, NEVADA 89120  
(702) 739-5921 FAX (702) 739-5929  
020.8001\WSFMS1.DWG SHEET 1 OF 3 SHEETS

FM-174-96  
NO. 11  
FILED AT THE REQUEST OF  
ORION ENGINEERING  
AND SURVEYING, INC.  
DATE 4-17-98 AT 11:00 A.M.  
BOOK 11 PAGE 11  
OF PLATS  
OFFICIAL RECORDS BOOK  
NO. 11  
CLARK COUNTY, NEVADA  
RECORDS  
JUDITH A. VANDEVER, RECORDER  
FEE 1.10 - 0.00 DEPUTY

## ACKNOWLEDGMENT

STATE OF NEVADA SS  
COUNTY OF CLARK  
THIS INSTRUMENT WAS ACKNOWLEDGED BEFORE ME ON 4/22/98 BY  
Richard Heller as President of Heller Development Company

Angela R. Scott  
ANGELA R. SCOTT  
NOTARY PUBLIC IN AND FOR  
SAID COUNTY AND STATE  
MY COMMISSION EXPIRES 3/28/99

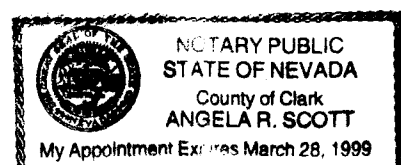

## DIVISION OF WATER RESOURCES CERTIFICATE

THIS FINAL MAP IS APPROVED BY THE DIVISION OF WATER RESOURCES OF THE DEPARTMENT OF CONSERVATION AND NATURAL RESOURCES CONCERNING WATER QUANTITY SUBJECT TO THE REVIEW AND APPROVAL ON FILE IN THIS OFFICE.

Robert Coache, P.E. 4-23-98  
ROBERT COACHE, P.E.  
DIVISION OF WATER RESOURCES

## CERTIFICATE OF EASEMENT RECIPIENTS

WE, THE HEREIN NAMED EASEMENT RECIPIENTS APPROVE THE GRANT OF THE DESIGNATED EASEMENTS.

Larry Norman 4-21-98  
COMMUNITY CABLE T.V., INC.  
LARRY NORMAN DATE

Yolanda M. Benito 4-21-98  
NEVADA POWER COMPANY  
YOLANDA M. BENITO DATE

James F. Stokes 4-20-98  
SPRINT CENTRAL TELEPHONE-NEVADA  
JAMES F. STOKES DATE

Clark G. McCarrell 4-21-98  
SOUTHWEST GAS CORPORATION  
CLARK G. MCCARRELL DATE

Gary Lange 4-20-98  
LAS VEGAS VALLEY WATER DISTRICT  
GARY LANGE DATE

Dennis Anderson 5-26-98  
CITY OF LAS VEGAS  
DENNIS ANDERSON DATE

## WASHINGTON &amp; SANDHILL - UNIT 1

CERTIFICATE OF OWNERSHIP  
AND EASEMENT INDENTURE

THIS CERTIFICATE OF OWNERSHIP AND EASEMENT INDENTURE is made this 1st day of August, 1984, by and between the City of Washington, a political subdivision of the State of Idaho, and the City of Sandhill, a political subdivision of the State of Idaho.

WHEREAS, the City of Washington, by its duly authorized officers and agents, has caused to be prepared and recorded in the County of Blaine, Idaho, a certain plat of land, to-wit: a plat of land containing a certain lot, to-wit: Lot 7, in Block 1, in the City of Sandhill, Idaho, and

WHEREAS, the City of Sandhill, by its duly authorized officers and agents, has caused to be prepared and recorded in the County of Blaine, Idaho, a certain plat of land, to-wit: a plat of land containing a certain lot, to-wit: Lot 7, in Block 1, in the City of Sandhill, Idaho, and

IN WITNESS WHEREOF, the City of Washington, by its duly authorized officers and agents, has hereunto set its hand and seal, and the City of Sandhill, by its duly authorized officers and agents, has hereunto set its hand and seal, this 1st day of August, 1984.

## ACKNOWLEDGMENT

BEFORE ME, the undersigned authority, on this 1st day of August, 1984, personally appeared \_\_\_\_\_, known to me to be the person whose name is subscribed to the foregoing instrument, and acknowledged to me that he executed the same for the purposes and consideration therein expressed.

Notary Public  
My Comm. Exp. 12/31/85

## AFFIDAVIT OF EASEMENT BENEFICIARIES

I, the undersigned, being of legal age and sound mind, do hereby certify that I am the owner of the property described in the foregoing instrument, and that I have read and understand the contents thereof, and that I have executed the same for the purposes and consideration therein expressed.

Notary Public  
My Comm. Exp. 12/31/85

## CERTIFICATE OF EASEMENT BENEFICIARIES

I, the undersigned, being of legal age and sound mind, do hereby certify that I am the owner of the property described in the foregoing instrument, and that I have read and understand the contents thereof, and that I have executed the same for the purposes and consideration therein expressed.

Notary Public  
My Comm. Exp. 12/31/85

Notary Public  
My Comm. Exp. 12/31/85

Notary Public  
My Comm. Exp. 12/31/85

Notary Public  
My Comm. Exp. 12/31/85

Notary Public  
My Comm. Exp. 12/31/85

Notary Public  
My Comm. Exp. 12/31/85

THIS IS A PORTION OF THE MAP (PLAN) OF THE EASEMENT GRANTED (PLAT) OF THE FOREGOING (PLAT) OF SECTION 24, T.28N., R.20E., S.24E., CITY OF SANDHILL, BLAINE COUNTY, IDAHO.

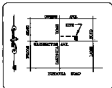

TYPICAL MAP

## LEGAL DESCRIPTION A.P.M. 110-00-001-000

THIS IS A PORTION OF THE MAP (PLAN) OF THE FOREGOING (PLAT) OF SECTION 24, T.28N., R.20E., S.24E., CITY OF SANDHILL, BLAINE COUNTY, IDAHO.

WHEREAS, the City of Sandhill, by its duly authorized officers and agents, has caused to be prepared and recorded in the County of Blaine, Idaho, a certain plat of land, to-wit: a plat of land containing a certain lot, to-wit: Lot 7, in Block 1, in the City of Sandhill, Idaho, and

WHEREAS, the City of Sandhill, by its duly authorized officers and agents, has caused to be prepared and recorded in the County of Blaine, Idaho, a certain plat of land, to-wit: a plat of land containing a certain lot, to-wit: Lot 7, in Block 1, in the City of Sandhill, Idaho, and

## SUBMITTER'S CERTIFICATE

I, the undersigned, being of legal age and sound mind, do hereby certify that I am the owner of the property described in the foregoing instrument, and that I have read and understand the contents thereof, and that I have executed the same for the purposes and consideration therein expressed.

1. I, the undersigned, being of legal age and sound mind, do hereby certify that I am the owner of the property described in the foregoing instrument, and that I have read and understand the contents thereof, and that I have executed the same for the purposes and consideration therein expressed.
2. I, the undersigned, being of legal age and sound mind, do hereby certify that I am the owner of the property described in the foregoing instrument, and that I have read and understand the contents thereof, and that I have executed the same for the purposes and consideration therein expressed.
3. I, the undersigned, being of legal age and sound mind, do hereby certify that I am the owner of the property described in the foregoing instrument, and that I have read and understand the contents thereof, and that I have executed the same for the purposes and consideration therein expressed.

Notary Public  
My Comm. Exp. 12/31/85



## CERTIFICATE OF CITY SUNDOWN

I, the undersigned, being of legal age and sound mind, do hereby certify that I am the owner of the property described in the foregoing instrument, and that I have read and understand the contents thereof, and that I have executed the same for the purposes and consideration therein expressed.

Notary Public  
My Comm. Exp. 12/31/85

CERTIFICATE OF PLANNING COMMISSION/  
SECTION OF PLANNING AND DEVELOPMENT  
APPROVAL

I, the undersigned, being of legal age and sound mind, do hereby certify that I am the owner of the property described in the foregoing instrument, and that I have read and understand the contents thereof, and that I have executed the same for the purposes and consideration therein expressed.

Notary Public  
My Comm. Exp. 12/31/85

## SUBMITTER BOARD OF HEALTH CERTIFICATE

I, the undersigned, being of legal age and sound mind, do hereby certify that I am the owner of the property described in the foregoing instrument, and that I have read and understand the contents thereof, and that I have executed the same for the purposes and consideration therein expressed.

Notary Public  
My Comm. Exp. 12/31/85

## SEAL OF CHAIRMAN

I, the undersigned, being of legal age and sound mind, do hereby certify that I am the owner of the property described in the foregoing instrument, and that I have read and understand the contents thereof, and that I have executed the same for the purposes and consideration therein expressed.

Notary Public  
My Comm. Exp. 12/31/85

Notary Public  
My Comm. Exp. 12/31/85

Notary Public  
My Comm. Exp. 12/31/85

Notary Public  
My Comm. Exp. 12/31/85

Notary Public  
My Comm. Exp. 12/31/85

Notary Public  
My Comm. Exp. 12/31/85

Notary Public  
My Comm. Exp. 12/31/85

## SUBMITTER'S NOTE

I, the undersigned, being of legal age and sound mind, do hereby certify that I am the owner of the property described in the foregoing instrument, and that I have read and understand the contents thereof, and that I have executed the same for the purposes and consideration therein expressed.



ORION ENGINEERING AND PLANNING, INC.  
AND SANDHILL, BLAINE COUNTY, IDAHO  
110-00-001-000  
BLAINE COUNTY, IDAHO



FORM 17-24-86

RECORD OF THE RECORD OF  
BLAINE COUNTY, IDAHO  
DATE: 12/31/85  
BOOK: 110-00-001-000  
PAGE: 17-24-86